

- ① Output Neutral Wire (White Line)
- ② Connection Fan Live Wire (Black Line)
- ③ Connection Lamp Live Wire (Blue Line)
- ④ Input Neutral Wire (White Line)
- ⑤ Input Live Wire (Black Line)
- ⑥ Antenna Wire (Can be cut! Can be connected)

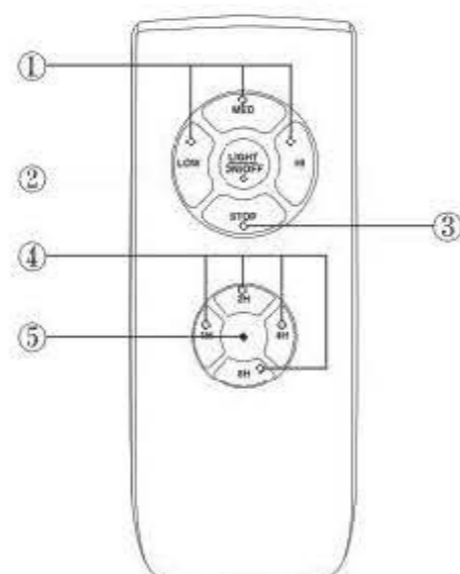

- ① Fan Speed Control
- ② Lamp Switch
- ③ Fan Shutdown
- ④ Timer
- ⑤ Switch Indicator

Battery Replacement: 3A/12V

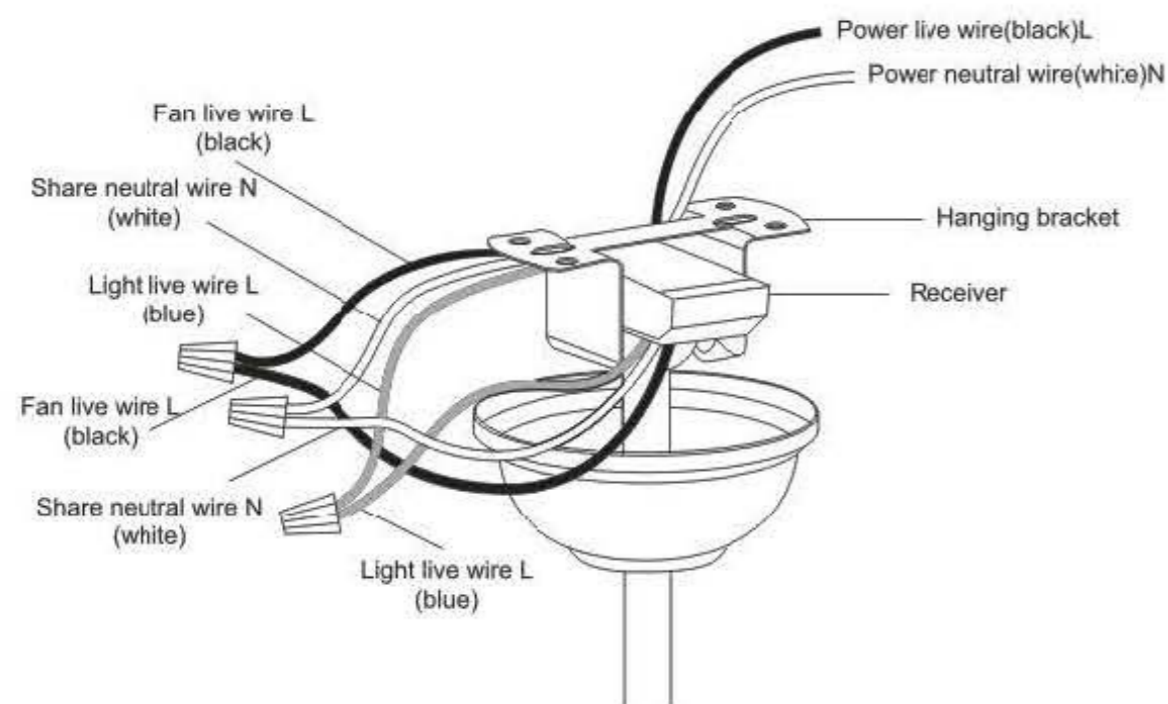

IF THE REMOTE CONTROL CANNOT BE USED NORMALLY, PLEASE PRESS AND HOLD THE MIDDLE AND LOW BUTTONS AT THE SAME TIME WITHIN 5 SECONDS AFTER THE PRODUCT IS POWERED ON, UNTIL YOU HEAR TWO BEEPS TO SUCCEED. IF IT DOESN'T WORK, PLEASE TRY AGAIN.

1. Please allow a moment between each operation.
2. Please handle the transmitter with care, be sure not to drop or expose it to water, high humidity or place where is too close to a heating element. Improper handling may result in malfunction and void the warranty.

CEILING FAN LAMP REMOTE CONTROLLER USER MANUAL

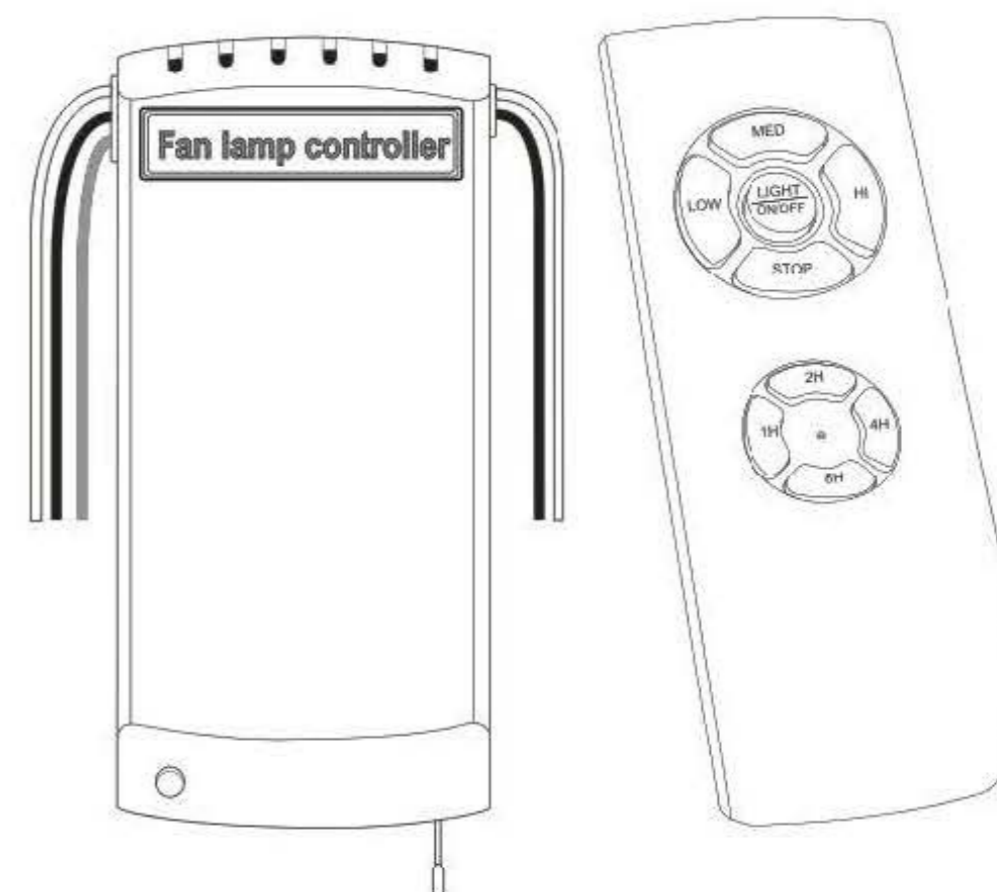

FCC Warning

This device complies with Part 15 of the FCC Rules. Operation is subject to the following two conditions:

(1) This device may not cause harmful interference, and (2) this device must accept any interference received, including interference that may cause undesired operation.

NOTE 1: This equipment has been tested and found to comply with the limits for a Class B digital device, pursuant to part 15 of the FCC Rules. These limits are designed to provide reasonable protection against harmful interference in a residential installation. This equipment generates uses and can radiate radio frequency energy and, if not installed and used in accordance with the instructions, may cause harmful interference to radio communications. However, there is no guarantee that interference will not occur in a particular installation. If this equipment does cause harmful interference to radio or television reception, which can be determined by turning the equipment off and on, the user is encouraged to try to correct the interference by one or more of the following measures:

- Reorient or relocate the receiving antenna.
- Increase the separation between the equipment and receiver.
- Connect the equipment into an outlet on a circuit different from that to which the receiver is connected.
- Consult the dealer or an experienced radio/TV technician for help.

NOTE 2: Any changes or modifications to this unit not expressly approved by the party responsible for compliance could void the user's authority to operate the equipment.