

PRUVEEO

ACTIVATE AND GET TWO YEARS WARRANTY

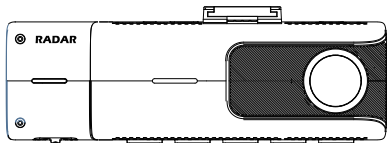

R316RD



Scan the QR code or visit pruveeo.com/pages/wty to learn more
If you have any questions, please contact us with no hesitation at
support@pruveeo.us for quick solutions.

Safety information

To prevent injury to yourself or others, or damage to your device, read all safety information before using.



Warning

Failure to comply with safety warnings and regulations can result in serious injury or death.

PRUVEEO Dash Cam is not intended to be touched, modified, or calibrated while operating a vehicle. PRUVEEO is not responsible for any damages resulting from the user's misuse of the camera.

Do not use damaged power cords or plugs, or loose electrical sockets. Faulty connections can cause electric shock or fire.

Do not touch the car charger with wet hands or disconnect the charger by pulling the cord. Doing so may result in electrocution.

Do not use a bent or damaged car charger. Doing so may cause electric shock or fire.

Do not use your device while it is charging or touch your device with wet hands. Doing so may cause electric shock.

- **Use only manufacturer-approved chargers, accessories, and supplies.**
 - Use only the manufacturer-approved charger specifically designed for your device. Using an incompatible charger can cause serious personal injury or damage to your device.
 - PRUVEEO cannot be responsible for the user's safety when using accessories or supplies that are not approved by PRUVEEO.
- **Do not drop the charger or device, or subject them to impact. Handle and dispose of the charger and device with care.**
 - Never crush or puncture the device.
 - Never dispose of the device in a fire.
 - Never place the device in or on heating devices, such as microwave ovens, stoves, or radiators. The device may explode if overheated. Follow all local regulations when disposing of a used device.
 - Avoid exposing the device to high external pressure, which can lead to an internal short circuit and overheating.
- **Protect the device and charger from damage.**
 - Avoid exposing your device to excessive cold or heat. Extreme temperatures can damage the device and reduce the charging capacity and life of your device.
 - Do not allow children or animals to bite or chew the device. Doing so can result in fire or explosion, and small parts can be a choking hazard. If children use the device, make sure they use the device properly.
 - Never use a damaged charger.



Caution

Failure to comply with safety precautions and regulations can result in property damage, serious injury, or death.

Do not use your device near other electronic devices. Most electronic devices use radio frequency signals. Your device may interfere with other nearby electronic devices.

Do not use your device near other devices that emit radio signals, such as sound systems or radio towers. Radio signals from these may cause your device to malfunction.

Do not expose the device to heavy smoke or fumes. Doing so may damage the outside of the device or cause it to malfunction.

If you notice strange smells or sounds coming from your device, or if you see smoke or liquid leaking from the device, stop using the device immediately and take it to a PRUVEEO Service Center. Failure to do so may result in fire or explosion.

For your safety, do not operate the controls of this product while driving. The window mount is needed when using the dash cam in a car. Make sure that you place the dash cam in a location where it will not obstruct the driver's view.

Always keep the camera lens clean, and ensure that the lens is not blocked by any object or placed near any reflective material. If the car's windshield is tinted with a dark coating, recording quality may be affected.

Your device is recommended for use and storage within a temperature range of 15 degrees Fahrenheit to 150 degrees Fahrenheit, and a humidity range of 10% to 80%.

If your device becomes overheated, allow it to cool down before use. Prolonged exposure of skin to an overheated device may cause low-temperature burn symptoms, such as red spots or areas of darker pigmentation.

Install mobile devices and equipment with caution.

- Ensure that any mobile devices or related equipment installed in your vehicle are securely mounted.
- Avoid placing your device and accessories in or near an airbag deployment area. Improperly installed wired equipment can cause serious injury in a situation where airbags inflate rapidly.

Do not drop your device or subject your device to impact. If the device is bent, deformed, or damaged, malfunction may occur.

Do not attempt to disassemble, repair, or modify your device.

- Any changes or modifications to your device can void your manufacturer's warranty. If your device needs servicing, take it to an authorized PRUVEEO Service Center.

Clean your device and charger by wiping it with a towel or eraser. Do not use chemicals or detergents. Doing so can discolor or corrode the outside of the device, and may result in electric shock or fire.

Do not distribute copyright-protected material. Doing so without the permission of the content owners may violate copyright laws. The manufacturer is not responsible or liable for any legal issues that result from the user's illegal use of copyrighted material.

(applicable in countries with separate waste collection systems)



Waste Electrical & Electronic Equipment

This symbol, found on the device, accessories, or accompanying literature, indicates that the product and its electronic accessories (e.g. charger, headset, USB cable) should not be disposed of with other household waste.

To prevent possible harm to the environment or human health from uncontrolled waste disposal, please separate these items from other types of waste and recycle them responsibly to promote the sustainable reuse of material resources.

Household users should contact either the retailer where they purchased this product, or their local government office, for information on where and how they can take these items for environmentally safe recycling.

Business users should contact their supplier and check the terms and conditions of the purchase contract. This product and its electronic accessories should not be mixed with other commercial wastes for disposal.

Some content and services accessible through this device belong to third parties and are protected by copyright, patent, trademark, and/or other intellectual property laws. Such content and services are provided solely for your personal non-commercial use.

You may not use any content or services in a manner that has not been authorized by the content owner or service provider. Without limiting the foregoing, unless expressly authorized by the applicable content owner or service provider, you may not modify, copy, republish, upload, post, transmit, translate, sell, create derivative works, exploit, or distribute in any manner or medium any content or services displayed through this device.

"THIRD PARTY CONTENT AND SERVICES ARE PROVIDED "AS IS." PRUVEEO DOES NOT WARRANT CONTENT OR SERVICES SO PROVIDED, EITHER EXPRESSLY OR IMPLIEDLY, FOR ANY PURPOSE. PRUVEEO EXPRESSLY DISCLAIMS ANY IMPLIED WARRANTIES, INCLUDING BUT NOT LIMITED TO, WARRANTIES OF MERCHANTABILITY OR FITNESS FOR A PARTICULAR PURPOSE. PRUVEEO DOES NOT GUARANTEE THE ACCURACY, VALIDITY, TIMELINESS, LEGALITY, OR COMPLETENESS OF ANY CONTENT OR SERVICE MADE AVAILABLE THROUGH THIS DEVICE AND UNDER NO CIRCUMSTANCES, INCLUDING NEGLIGENCE, SHALL PRUVEEO BE LIABLE, WHETHER IN CONTRACT OR TORT, FOR ANY DIRECT, INDIRECT, INCIDENTAL, SPECIAL OR CONSEQUENTIAL DAMAGES, ATTORNEY FEES, EXPENSES, OR ANY OTHER DAMAGES ARISING OUT OF, OR IN CONNECTION WITH, ANY INFORMATION CONTAINED IN, OR AS A RESULT OF THE USE OF ANY CONTENT OR SERVICE BY YOU OR ANY THIRD PARTY, EVEN IF ADVISED OF THE POSSIBILITY OF SUCH DAMAGES."

Third-party services may be terminated or interrupted at any time, and PRUVEEO makes no representation or warranty that any content or service will remain available for any period. Content and services are transmitted by third parties using networks and transmission facilities over which PRUVEEO has no control. Without limiting the generality of this disclaimer, PRUVEEO expressly disclaims any responsibility or liability for any interruption or suspension of any content or service made available through this device.

PRUVEEO is neither responsible nor liable for customer service related to the content and services. Any question or request for service relating to the content or services should be made directly to the respective content and service providers.

This device complies with part 15 of the FCC Rules. Operation is subject to the Following two conditions:

This device may not cause harmful interference, and this The device must accept any interference received, including interference that may cause undesired operation.

This equipment has been tested and found to comply with the limits for a Class B digital device, pursuant to part 15 of the FCC Rules. These limits are designed to provide reasonable protection against harmful interference in a residential installation. This equipment generates, uses and can radiate radio frequency energy and, if not installed and used in accordance with the instructions, may cause harmful interference to radio communications. However, there is no guarantee that interference will not occur in a particular installation. If this equipment does cause harmful interference to radio or television reception, which can be determined by turning the equipment off and on, the user is encouraged to try to correct the interference by one or more of the following measures:

- Reorient or relocate the receiving antenna.
- Increase the separation between the equipment and receiver.
- Connect the equipment into an outlet on a circuit different from that to which the receiver is connected.
- Consult the dealer or an experienced radio/TV technician for help.

Caution: Any changes or modifications not expressly approved by the party Responsible for compliance could void the user's authority to operate the equipment.

This equipment complies with FCC radiation exposure limits set forth for an uncontrolled environment. This transmitter must not be co-located or operating in conjunction with any other antenna or transmitter.

This equipment should be installed and operated with minimum distance 20cm between the radiator & your body.

We recommend that you read this manual carefully before using the dash cam, and then read it again with the dash cam in your hands to familiarize yourself with its many features. The dash cam is constantly being improved over time, so the specifications of the dash cam may change.

Please note that each button has multiple functions, so please be careful which buttons you press for each mode/function. There is no need to get frustrated as you should only have to do this once to set it up the way you want.

1. Please make sure that the dash cam is switched off when inserting or removing a Micro SD card to avoid damage.
2. Please make sure that the Micro SD card is inserted correctly. If it is backward, it may damage the dash cam and the card.
3. If the Micro SD Card is not compatible with the dash cam, please DO NOT insert it again, as you will damage the card and the dash cam. Please buy the correct card and then try again.
4. The dash cam supports the micro SD card from 32GB to the max capacity of 256GB.
5. Adjust the position of the lens to make sure you can properly record what you want.
6. We recommend the high endurance 128GB or 256G MicroSDXC memory card for this dash cam (www.amazon.com/dp/B0C1NL4BS8). Please DO NOT use "Generic Class 10" cards from third parties. They are NOT designed for 4K resolution front and rear dual channel dash cam.
7. In the video recording mode, if you want to press the Menu / Mode button, please stop video recording first.
8. We recommend to use the factory default settings, once the MENU is set, connect the car charger to the unit and insert the card. When the car starts, the unit will automatically start recording. When the car is turned off, the unit will automatically stop recording. Please note that the car's cigarette lighter socket has no power when the ignition is turned off.

9. This dash cam must be always connected to a power source via a 5V charger as there is no built-in battery.
10. If you set the SCREEN SAVER option to ON, the dash cam will continue to record in video recording mode when the screen is turned off. You can turn on the screen by pressing the power button once.
11. If you want to play the videos, we recommend that you remove the micro SD card and insert it into your PC with a card reader. We recommend using the VLC video player on Windows OS and Movist + VLC on MAC OS.
12. After several weeks of daily recording, you may need to format your Micro SD card - if this happens, please note that you will lose all your files, so please make a backup copy on your computer in a unique dash cam folder that you have created.
13. If your dash cam crashes / screen goes black, the phenomenon may be caused by improper operation or crash, please press the R = Reset button, the hole at the top corner, gently with a cocktail stick. Just like you would do for a computer, printer, phone, etc.
14. The dash cam only supports micro SD cards with FAT32 file format. Please format your micro SD card on the dash cam before using it.
15. Currently, GPS technology struggles to get signals and accuracy indoors. There are two main reasons why GPS can't be used indoors: low signal strength and low accuracy.

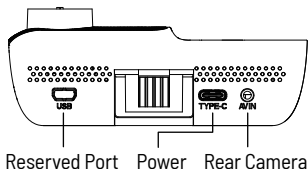
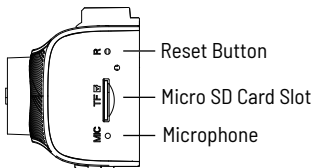

1. Power Button / Screen On/Off Button
2. Menu Button / Mode Switch Button
3. UP / Wi-Fi On/Off / Emergency Lock
4. Down / Screen Switching / Audio On/Off
5. Confirm Button / Video On/Off / Take Photo
6. Radar Off / High Sensitivity / Low Sensitivity

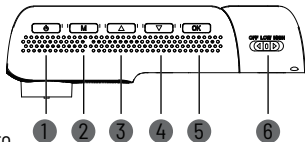

Button	Functions
	<ul style="list-style-type: none"> • Short press to turn the screen on or off • Press and hold for 3 seconds to turn the dash cam on or off
	<ul style="list-style-type: none"> • Please stop the video recording first • Short press to enter the dash cam settings • Press and hold for 3 seconds to switch between video recording and playback modes • In playback mode, short press to display the delete/lock/unlock
	<ul style="list-style-type: none"> • Short press to move UP in the settings • Short press to turn the Wi-Fi on/off in standby mode • Press and hold for about 3 seconds to manually lock/unlock the video file during recording

Button	Functions
	<ul style="list-style-type: none"> • Short press to move DOWN in the settings • Short press to switch the image between the two cameras • Press and hold for 3 seconds to turn the audio recording on/off
OK	<ul style="list-style-type: none"> • Short press to confirm a selection in the settings • Short press to start/stop the video recording • Press and hold for about 3 seconds to take a photo
RADAR	<ul style="list-style-type: none"> • Toggle to switch between off, high sensitivity and low sensitivity. • Please DO NOT plug the radar without using the ACC hardwire kit
R	<ul style="list-style-type: none"> • Press and hold for 5 seconds to reset the device if operates erratically, hangs up or freezes

What's in the box



Suction Cup Mount
(Built-in GPS Logger)



Packing Box



User Manual



ACC Hardwire Kit

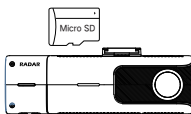

Dash Cam & Radar & Micro
SD Card (In the card slot)



Rear Camera



Cable Adhesive Spacer



Cable Management Tool

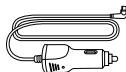

Car Power Connector

Place the dash cam on the mount carefully route the power cable around the windscreen and tuck it in under the trim.

Plug the power cord into a 12V DC power outlet or the car cigarette lighter.

Connect the power cord to the camera. The camera will auto-start recording once powered on.

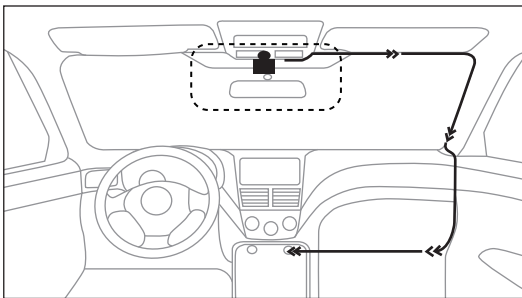

The dash cam is automatically powered on when plugged into a 12V accessory socket or cigarette lighter and receives a charge (i.e.: the vehicle is started).

To turn the device on manually, press and hold the power button until the welcome screen appears.

The camera will automatically start recording when powered on.

You will need to insert a memory card before you can begin recording. Before inserting or removing a memory card, first ensure you've powered down the dash cam. Gently push the memory card in until you hear a click, and allow the spring release to push the card out.

Power the dash cam by connecting the charger to the car cigarette lighter and dash cam. Ensure the dash cam records to your memory card properly and without error. Before you start using a new memory card, you must format the card within the camera using the format function. Always back up important data stored on the memory card before formatting.

Mount the rear camera and dash cam as shown below. Use the provided rear camera cable to connect the rear camera to the front camera.

To install the rear camera of a dash cam, follow these detailed steps:

1. Find a suitable mounting position for the rear camera, typically on the rear windscreen. Ensure that there is a clear view of the rear of the vehicle.
2. Thoroughly clean the mounting surface with an alcohol wipe to ensure proper adhesion.
3. Use the supplied 3M Adhesive Mount Kit to secure the rear camera in place.
4. Route the rear camera cable along the interior trim, headliner, and pillars towards the front of the vehicle. Use cable clips or tucks to secure the cable neatly.
5. Connect the rear camera cable to the appropriate connector on the main dashboard camera unit.
6. Adjust the angle and position of the rear camera as required for optimum viewing.
7. If the image is upside down, you can switch the rear camera mirror option on or off in the dash cam settings.
8. Secure any loose cables with cable ties or bungee cords to prevent interference with vehicle operation.

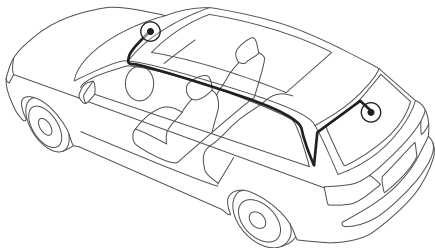

Please scan the QR code with your mobile phone or open the following URL in your browser to view the installation video for the dash cam and rear camera.



t.ly/w5JSE

08

Millimeter Wave Radar Installation

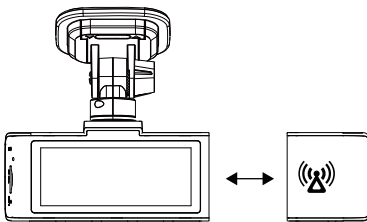

The millimeter wave radar can be pulled out. Hold the dash cam with one hand and the radar with the other hand, and use them to pull outwards to remove the radar.

Caution

Please DO NOT plug the radar without using the ACC hardwire kit.



STEP 1

Clean the windshield area where you plan to place the suction cup mount.

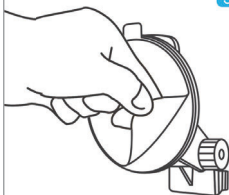

STEP 2

Peel off the plastic protective film on the suction cup mount.

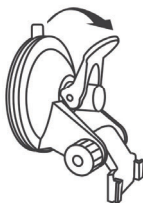

STEP 3

Ensure the locking lever is in the UP position.

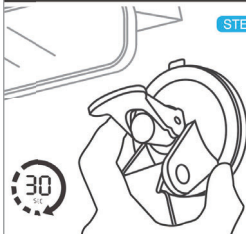

STEP 4

Press the mount's button down with good force. This is what creates the suction.

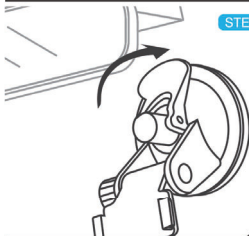

STEP 5

Rotate the mount's lever down to lock it.

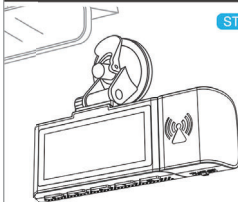

STEP 6

Try and move the mount to check for stability. Attach the dash cam to the mount and adjust the recording angle.

10

Inserting the Memory Card

Your device accepts memory cards with a maximum capacity of 256 GB. Depending on the memory card manufacturer and type, some cards may not be compatible with your device. Using an incompatible card may damage the unit or the memory card, or corrupt the data stored on it.

Please face the screen of the Dash Cam.

- Insert a memory card with the gold-colored contacts facing you.
- Push the memory card into the slot until it clicks.

It is recommended that you reformat a memory card each time you transfer videos from it to a computer, or at least once a month.

Reformatting a memory card keeps important elements of the data and file structure clean, which helps prevent error messages and missing images. Reformatting also restores the memory card, which can help prevent it from becoming corrupted.

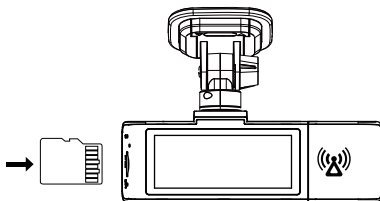

11

Removing the Memory Card

1. Press the OK button to stop recording first.
2. Press and hold the power button to turn off the device.
3. Gently push in and release the memory card until it unlocks.

PLEASE DO NOT remove the memory card while the device is transferring or accessing information. Doing so may result in data loss, corruption, or damage to the memory card or device. PRUVEEO is not responsible for any loss, including loss of data, resulting from the use of damaged memory cards.

12

Formatting the Memory Card

1. Press the OK button to stop recording first.
2. Press the M button to enter settings.
3. Press the UP or DOWN button to navigate to the "Format" option.
4. Press the UP or DOWN button to make your selection.
5. Press OK to format the SD card.

Please format the card on the dash cam before using it. Before formatting a memory card, always remember to make backup copies of all important data stored on the device. The manufacturer's warranty does not cover loss of data due to user actions.

13

Parking Monitor and Radar Instruction

This dash cam uses millimeter-wave radar and an ACC hardwire kit to realise the parking monitoring function, which is the best parking monitoring solution on the market.

The radar can only work properly if it is powered by the ACC hardwire kit. If you use an ordinary power cord, please do not connect the radar, the radar will not work.

When the ACC hardwire kit detects that the engine is switched off, the dash cam will stop recording and enter the parking monitoring mode. If the radar detects a moving object, the dash cam will quickly start recording within 2 seconds until there is no moving object around the vehicle. It will then automatically stop recording and return to parking monitoring mode.

This dash cam is the first to use the Quick Start software. Most dash cams on the market take around 1 minute to start recording.

The millimeter wave radar can detect moving objects within 20 feet of the vehicle. The ACC hardwire kit has a low-voltage protection function and will not drain the vehicle battery.

Loop Recording

When Loop Recording mode is activated, the unit continuously deletes older video as new video is recorded, so that the last few hours of video is retained.

A 128G memory card can store approximately 9 hours of video. Any video older than this will be replaced with a new video. (Note: any locked video files on the memory card will remain protected and will not be automatically deleted during loop recording).

It is recommended that you reformat a memory card every time you transfer videos from it to a computer, or at least once a month. This keeps important elements of the data and file structure clean, which helps prevent error messages and missing videos.

Remember to always make backup copies of all important data stored on the device. The manufacturer's warranty does not cover loss of data due to user actions.

1. Press the M button to enter settings.
2. Press the UP or DOWN button to navigate to the "Loop Recording" option.
3. Press the OK button to view the selection: 1minute/2minutes/3minutes/Off.
4. Press the UP or DOWN button to make your selection.
5. Press the OK to confirm your selection.
6. Press the M button to exit.
7. It is recommended to use the 1 minute option.

Video Resolution

The resolution of the front camera can be set to 4K or 2K, and the resolution of the rear camera is 1080P. We recommend using 2K+1080P.

Gravity Sensing

If a change in gravity is detected, such as a car crash, the G-sensor will accident, the G-sensor will signal the camera and an automatic file lock will be placed on the current video, preserving your most important footage.

Note: Locked video files won't be deleted by Loop Recording, they will remain on the memory card until they are manually deleted or the card is formatted.

1. Press the M button to enter settings.
2. Press the UP or DOWN button to navigate to the "Gravity Sensing" option.
3. Press the OK button to view the selection: High/Middle/Low/Close.
4. Press the UP or DOWN button to make your selection.
5. Press the OK to confirm your selection.
6. Press the M button to exit.
7. It is recommended to use the Low option.

Date Stamp

You have the option to display the date and time in your videos. Note that the date and time stamp cannot be removed from videos if this feature was enabled when they were recorded.

1. Press the M button to enter settings.
2. Press the UP or DOWN button to navigate to the "Date Stamp" option.
3. Press the OK button to view the selection: On/Off.
4. Press the UP or DOWN button to make your selection.
5. Press the OK to confirm your selection.
6. Press the M button to exit.
7. It is recommended to use the On option.

Recording Audio

You can choose to record audio with video or turn off the microphone so that all recorded video is muted.

1. Press the M button to enter settings.
2. Press the UP or DOWN button to navigate to the "Recording Audio" option.
3. Press the OK button to view the selection: On/Off.
4. Press the UP or DOWN button to make your selection.
5. Press the OK to confirm your selection.
6. Press the M button to exit.
7. It is recommended to use the On option.

Alternatively, you can use a hotkey shortcut for this function. Press and hold the DOWN button to mute/unmute the microphone for video recording.

Exposure

Adjust the camera's exposure value to make the recorded video brighter or darker according to your preference.

1. Press the M button to enter settings.
2. Press the UP or DOWN button to navigate to the "Exposure" option.
3. Press the OK button to view the selection: +0.0, +1/3, -1/3, etc.
4. Press the UP or DOWN button to make your selection.
5. Press the OK to confirm your selection.
6. Press the M button to exit.

Light Frequency

This option should be set according to the power supply specification used in your country or geographical region.

1. Press the M button to enter settings.
2. Press the UP or DOWN button to navigate to the "Light Frequency" option.
3. Press the OK button to view the selection: 50Hz/60Hz.
4. Press the UP or DOWN button to make your selection.
5. Press the OK to confirm your selection.
6. Press the M button to exit.
7. It is recommended to use the 60Hz option.

WDR (Wide Dynamic Range)

When enabled, this feature automatically adjusts exposure settings to improve recording quality in particularly bright or dim environments, resulting in balanced lighting and clearer recorded video.

1. Press the M button to enter settings.
2. Press the UP or DOWN button to navigate to the "WDR" option.
3. Press the OK button to view the selection: On/Off.
4. Press the UP or DOWN button to make your selection.
5. Press the OK to confirm your selection.
6. Press the M button to exit.
7. It is recommended to use the On option.

Rear Mirroring

If the rear camera image is left and right reversed, you can use this option to flip the image.

1. Press the M button to enter settings.
2. Press the UP or DOWN button to navigate to the "Rear Mirroring" option.
3. Press the OK button to view the selection: On/Off.
4. Press the UP or DOWN button to make your selection.
5. Press the OK to confirm your selection.
6. Press the M button to exit.
7. It is recommended to use the On option.

Format

Performing this operation will format the memory card and erase all files.

Note: Locked video will also be deleted, so make sure you have backed up your important footage before formatting the card.

Please format your micro SD card on the dash cam before using it.

1. Press the M button to enter settings.
2. Press the UP or DOWN button to navigate to the "Format" option.
3. Press the UP or DOWN button to make your selection.
4. Press OK to format the SD card.
5. Press the M button to exit.

Screen Saver

Select a time for the screen to remain lit after the recording starts.

1. Press the M button to enter settings.
2. Press the UP or DOWN button to navigate to the "Screen Saver" option.
3. Press the OK button to view the selection: 10 seconds/30 seconds/1 minute/Close.
4. Press the UP or DOWN button to make your selection.
5. Press the OK to confirm your selection.
6. Press the M button to exit.

Alternatively, you can use a hotkey shortcut for this function. While in Capture mode, press the Power button to turn on/off the LCD screen.

Language

Use the following procedure to change the language of the unit.

1. Press the M button to enter settings.
2. Press the UP or DOWN button to navigate to the "Language" option.
3. Press the OK button to view the selection: English etc.
4. Press the UP or DOWN button to make your selection.
5. Press the OK to confirm your selection.
6. Press the M button to exit.

Parking Monitor (Parking Mode)

Parking Mode allows you to monitor your parked vehicle. When the engine is turned off, a hardwire kit is used to provide continuous power and protect your car battery from draining.

1. Press the M button to enter settings.
2. Press the UP or DOWN button to navigate to the "Parking Monitor" option.
3. Press the OK button to view the selection: Radar/Off.
4. Press the UP or DOWN button to make your selection.
5. Press the OK to confirm your selection.
6. Press the M button to exit.
7. It is recommended to use the Radar option.

System Volume

Increase or decrease the volume of your dash cam.

1. Press the M button to enter settings.
2. Press the UP or DOWN button to navigate to the "System Volume" option.
3. Press the OK button to view the selection: High/Middle/Low/Close.
4. Press the UP or DOWN button to make your selection.
5. Press the OK to confirm your selection.
6. Press the M button to exit.
7. It is recommended to use the Middle option.

Key Sound

Allows you to turn the device's button sound effect on or off.

1. Press the M button to enter settings.
2. Press the UP or DOWN button to navigate to the "Key Sound" option.
3. Press the OK button to view the selection: On/Off.
4. Press the UP or DOWN button to make your selection.
5. Press the OK to confirm your selection.
6. Press the M button to exit.
7. It is recommended to use the On option.

Date and Time

Use the following procedure to change the time and date of the unit.

1. Press the M button to enter settings.
2. Press the UP or DOWN button to navigate to the "Date and Time" option.
3. Press the OK button to view the current date and time.
4. Press the UP or DOWN button to make your selection.
5. Press the OK to confirm your selection.
6. Press the M button to exit.

Set Time Zone

Updates the time automatically with your time zone.

1. Press the M button to enter settings.
2. Press the UP or DOWN button to navigate to the "Set Time Zone" option.
3. Press the OK button to view the current time zone.
4. Press the UP or DOWN button to make your selection.
5. Press the OK to confirm your selection.

Daylight Saving

Enable / Disable Daylight Saving Time

1. Press the M button to enter settings.
2. Press the UP or DOWN button to navigate to the "Daylight Saving" option.
3. Press the OK button to view the selection: On/Off.
4. Press the UP or DOWN button to make your selection.
5. Press the OK to confirm your selection.
6. Press the M button to exit.
7. It is recommended to use the Off option.

GPS Speed Unit

Select the GPS speed unit (GPS logger on the suction cup mount)

1. Press the M button to enter settings.
2. Press the UP or DOWN button to navigate to the "GPS Speed Unit" option.
3. Press the OK button to view the selection: KM/H/MPH/Off.
4. Press the UP or DOWN button to make your selection.
5. Press the OK to confirm your selection.
6. Press the M button to exit.
7. It is recommended to use the MPH option.

GPS Information

Shows the current status of receiving satellite signals

1. Press the M button to enter settings.
2. Press the UP or DOWN button to navigate to the "GPS Information" option.
3. Press the OK button to view the GPS information.
4. Press the M button to exit.

Wi-Fi

The dash cam transmits Wi-Fi signals and the cell phone receives them, sending data back and forth. You can use the free APP to change the dash cam's settings, browse videos, or download them to your cell phone.

1. Press the M button to enter settings.
2. Press the UP or DOWN button to navigate to the "Wi-Fi" option.
3. Press the OK button to view the selection: On/Off.
4. Press the UP or DOWN button to make your selection.
5. Press the OK to confirm your selection.
6. Press the M button to exit.

Alternatively, you can use a hotkey shortcut for this function. Short press the UP key to toggle the WiFi function on and off.

Wi-Fi Band

This option allows you to change the frequency band for data transmission between your mobile device and the dash cam. The 5G band has faster transmission speeds.

1. Press the M button to enter settings.
2. Press the UP or DOWN button to navigate to the "Wi-Fi Band" option.
3. Press the OK button to view the selection: 5G/2.4G.
4. Press the UP or DOWN button to make your selection.
5. Press the OK to confirm your selection.
6. Press the M button to exit.

Restore Factory Settings

Performing this operation will reset all of your device's settings to their original values. Note: All custom settings will be lost.

1. Press the M button to enter settings.
2. Press the UP or DOWN button to navigate to the "Restore Factory Settings" option.
3. Press the UP or DOWN button to make your selection.
4. Press the OK to confirm your selection.
5. Press the M button to exit.

Wi-Fi Connection Guide

With the dash cam's built-in Wi-Fi, you can change the dash cam's settings and play and download recorded videos using the APP on your cell phone.

If you want to see the GPS track of the video, please download the video to your phone first, then the GPS track will be displayed.

The effective working distance of Wi-Fi is 15 feet.

Downloading the Wi-Fi App

- The Wi-Fi app is available for free download from the Apple App Store™ and Google Play Store™.

- Android users: Go to the Google Play Store™, search for GFG CAM, download and install, and follow these instructions to connect and operate the Wi-Fi.

- iPhone users: Enter the Apple App Store™, search for GFG CAM, download and install, and follow this user guide to connect the Wi-Fi and operate.

To pair the camera with your device

1. Turn on the dash cam, please stop recording first by pressing the OK button, then you can operate other buttons, short press the UP button to start the Wi-Fi function, you can also start the Wi-Fi function via the menu.

2. The LCD screen will display the Wi-Fi SSID and password.

3. Search for a Wi-Fi hotspot on your smartphone/tablet, select the network and you will be prompted for a password; enter '12345678' to proceed, once connected, only the Wi-Fi function key can be used, press and hold the Wi-Fi key to exit the Wi-Fi function.

4. Open the GFG CAM application on your smartphone/tablet, then you can use the APP.



You can also scan the QR code to download the GFG CAM APP

Video Playback

You can play videos on a device or a computer.

To play a video on the computer, either use an SD card adapter. To play a video using an SD card adapter, remove the memory card and insert it into an SD card adapter. Insert the adapter into the computer.



event



photo



version



video

Event folder: Used to store the gravity-sensitive locked video files.

Photo folder: Used to store the photos.

Version folder: Used to store the system files, please do not delete it.

Video folder: Used to store the video files recorded by the dash cam.



Front



Rear

The video files and photos recorded by the dash cam are stored in the folders above.

To play a video on the dash cam, please short press the OK button to stop recording first, then press and hold the M button to switch to Playback mode. Use the UP and DOWN buttons to scroll to the desired video. Press OK to play and pause, and press M to exit the current video playback.

GPS Video Playback

You can play back your recordings in a special application that lets you view speed and location information along with your footage.

Windows:

Please download and install the software from our official website below.

<https://pruveeo.com/pages/download>

Mac OS:

Visit the Apple App Store™, search for 'GXPlayer', download and install.

Access Video Files:

Insert the micro SD card into your computer to access the video files.

To open a GPS video file:

1. Once you've opened the application, navigate to the top menu bar and click File > Open to browse your files.
2. Browse to the video file you want to add to the playback queue, select it, and click Open to load it into the application. You can also select multiple videos at once.
3. After a short loading time, the (first) video should start playing automatically, with real-time speed and location information displayed in the right panels.



Warm Tips:

After many analyses, we found that most of the dash cam problems are caused by the card because the speed and number of erasing and writing of the memory card cannot meet the requirements.

Therefore, we recommend our High Endurance 128GB or 256G MicroSDXC memory card for this dash cam, which can make the dash cam more stable, reliable and work continuously for a long time.

128G Link: www.amazon.com/dp/B0C1NL4BS8

256G Link: www.amazon.com/dp/B0C1NN48HT

***PLEASE DO NOT USE "Generic Class 10" cards from third party suppliers. They are NOT made for 4K resolution front and rear dual channel dash cam.**

15

ACC Hardwire Installation

If you want to use the parking monitoring function, you must use both the radar and the ACC hardwire kit. If the ACC hardwire kit is not connected, the radar will not work.

Caution

Please DO NOT plug the radar without using the ACC hardwire kit.

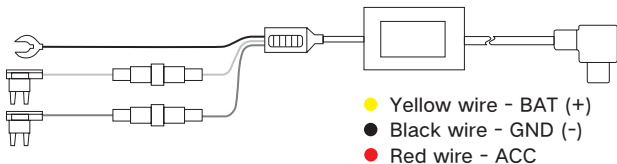

To install, connect the red wire to your car's ACC (accessory) fuse, the black wire to the metal ground or negative pole, and the yellow wire to the positive pole of the battery. Make sure all connections are secure and insulated to prevent short circuits.

The ACC Hardwire Kit keeps your dash cam's parking monitor working. Keeps it powered even when the engine is off, protecting your vehicle at all times. Built-in intelligent low voltage protection system. If your car's battery voltage drops to 11.8V or 23.5V, the ACC hardwire kit will cut the power, leaving you with enough power to start your car the next time. With the ACC detection feature, the dash cam will automatically switch to parking mode when the vehicle's engine is off, and switch back to normal recording when the vehicle's engine is on.

As a precaution, it's essential to disconnect the vehicle's battery before installation to avoid any electrical mishaps. If you're unfamiliar with your car's electrical system, a professional installer is recommended. Always refer to your vehicle's fuse box and owner's manual for specific installation instructions. Safety first!

Warm tips:

Make sure all connections are secure, tuck away any excess wires and make sure they are safely routed to avoid interference with vehicle controls.

As the installation method is different for each vehicle, it is not possible to provide more detailed installation instructions. If you encounter any problems during installation, please search the YouTube website for the specific vehicle model and installation instructions for the hardwire kit.



t.ly/21NNu

Please scan the QR code with your mobile phone or visit the following URL in your browser to refer to the ACC Hardwire Kit installation video.

ACTIVATE AND GET TWO YEARS WARRANTY



Scan the QR code or visit
pruveeo.com/pages/wty to learn more.

**Contact us here, we have professional
customer service!**

Official Website: <http://pruveeo.us>

Email: support@pruveeo.us

If you have any questions, please feel free to contact us at



Email



Official Site

FCC Warning:

This equipment has been tested and found to comply with the limits for a Class B digital device, pursuant to part 15 of the FCC Rules. These limits are designed to provide reasonable protection against harmful interference in a residential installation. This equipment generates, uses and can radiate radio frequency energy and, if not installed and used in accordance with the instructions, may cause harmful interference to radio communications. However, there is no guarantee that interference will not occur in a particular installation. If this equipment does cause harmful interference to radio or television reception, which can be determined by turning the equipment off and on, the user is encouraged to try to correct the interference by one or more of the following measures:

- Reorient or relocate the receiving antenna.
- Increase the separation between the equipment and receiver.
- Connect the equipment into an outlet on a circuit different from that to which the receiver is connected.
- Consult the dealer or an experienced radio/TV technician for help.

Caution: Any changes or modifications to this device not explicitly approved by manufacturer could void your authority to operate this equipment.

This device complies with part 15 of the FCC Rules. Operation is subject to the following two conditions:

(1) This device may not cause harmful interference, and (2) this device must accept any interference received, including interference that may cause undesired operation.

This equipment complies with FCC radiation exposure limits set forth for an uncontrolled environment. This equipment should be installed and operated with minimum distance 20cm between the radiator and your body.