

Attentions

- ▶ Please use the original or manufacturer specified attachments or accessories.
- ▶ Please do not disassemble products, so as not to cause trouble or safety hazards
- ▶ Do not use this product in the place near the water source, do not place this product in the damp place
- ▶ Due to improper use of product damage, odor, smoke and other phenomena, please immediately terminate the use, and send to professional maintenance personnel
- ▶ Do not place the product in a strong electromagnetic wave, strong static electricity and easy condensation
- ▶ Please do not place the magnetic stripe card (including credit card, telephone card, bank card, boarding card, etc.) near the product, Otherwise, it will be damaged by the magnetic field
- ▶ If you use a wireless charger in an area with weak network signals, your mobile device may not be able to receive the network
- ▶ Do not place metal, magnet, magnetic stripe card and other foreign matters between the mobile device and the wireless charger, otherwise, the mobile device will not charge normally or be damaged due to overheating
- ▶ If a thick protective shell is installed for the mobile device, the wireless charging may not work properly. If the cover is thick, remove it, and then put the mobile device on the wireless charger for charging

Main features

- ▶ Smart home wireless charger charge any equipment that accord with Qi wireless charging standard
- ▶ High definition and super large digital LCD screen time display
- ▶ Perpetual Calendar Up to Year 2099
- ▶ Time format in optional 12/24 HR
- ▶ Day of week in 8 languages
- ▶ Bed light brightness can be adjustment in 3 levels or OFF
- ▶ Backlight brightness can be adjustment in 3 gears or OFF
- ▶ Daily Alarm clock and snooze function
- ▶ Snooze setting (5/10/15/20/25/30 minutes or OFF)
- ▶ Temperature unit in optional °C /°F
- ▶ Temperature measurement ranges: -9.9°C (14.2°F) ~ 50°C (122°F)
- ▶ Humidity measurement ranges: 20%RH ~ 95%RH
- ▶ Power Supply:
 - Battery: CR2032 (keep the time can go on after the external power supply is disconnected)
 - INPUT : DC5V—2A DC9V—3A
- ▶ Wireless charging output: MAX.15W

Appearance description

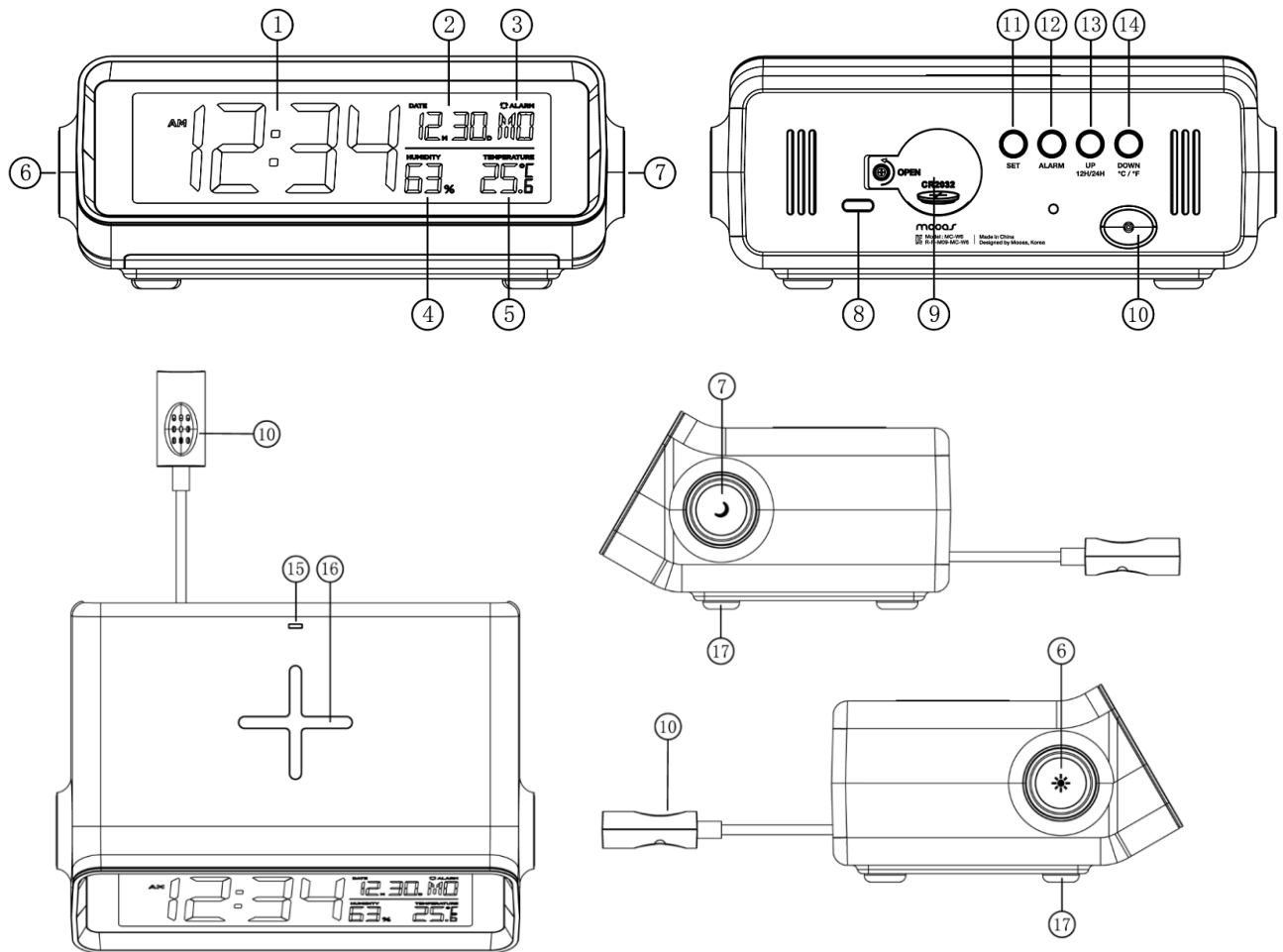

- | | |
|--|--|
| ① : Time | ⑩ : Temperature and humidity sensor |
| ② : Date | ⑪ : 【SET】 button |
| ③ : Day of week | ⑫ : 【ALARM】 button |
| ④ : Humidity | ⑬ : 【+】 and 12/24HR switch button |
| ⑤ : Temperature | ⑭ : 【-】 and °C/°F switch button |
| ⑥ : Backlight brightness adjust button | ⑮ : Charging status indicator |
| ⑦ : Bed light brightness adjust button | ⑯ : Antiskid pad of mobile device wireless charger |
| ⑧ : Type-C input socket | ⑰ : 【SNOOZE】 and Alarm ON/OFF button |
| ⑨ : Battery compartment cover | |

Initial operation

- ▶ Open the battery compartment cover ⑨
- ▶ Install the CR2032 battery in the correct polarity direction
- ▶ Insert the TYPE-C interface of the power output cable into the product power socket ⑧.

Clock settings

- ▶ Press and hold the 【SET】 button ⑪ for 2 seconds, the **HOUR** start to flash, and press 【+】 or 【-】 buttons to set the correct HOUR, hold the 【+】 or 【-】 buttons for 2 seconds can be adjusted quickly.

► Press the **【SET】** button to confirm the item has been set and go to the next one, the sequence of setting items is as follows:

HOUR → MINUTE → Format of DATE (D/M or M/D) → YEAR → MONTH → DATE → Language of week

► Press **SET** button to confirm the last item to end the setting procedures, then it will return to the normal mode.

► When choosing the 12HR format, if “AM” is displayed before the hours, it means that the hour is ante meridiem, if “PM” is displayed before the hours, it means that the hour is post meridiem.

► The 8 languages that show week abbreviations are listed below:



LANGUAGE	ENGLISH	GERMAN	ITALIAN	FRENCH	NETHERLANDS	ESPANA	DENMARK	RUSIA
DAY	EN	GE	IT	FR	NE	ES	DA	RU
SUNDAY	SU	SO	DO	DI	ZO	DO	SO	BC
MONDAY	MO	MO	LU	LU	MA	LU	MA	PH
TUESDAY	TU	DI	MA	MA	DI	MA	TI	BT
WEDNESDAY	WE	MI	ME	ME	WO	MI	ON	CP
THURSDAY	TH	DO	GI	JE	DO	JU	TO	YT
FRIDAY	FR	FR	VE	VE	VR	VI	FR	NT
SATURDAY	SA	SA	SA	SA	ZA	SA	LO	CB

F.Y.I.:

► If there is no valid operation within 20 seconds, it will automatically return to normal time mode from the set mode.

Daily alarm settings

► Press **【ALARM】** button ⑫ once, the clock will switch to the alarm time display for 5 seconds.

► Press **【SNOOZE】** button ⑬ can be turn on or off the alarm, LCD display the icon  **ALARM** mean that the alarm function is ON, the icon  **ALARM** disappears from the LCD mean that the alarm function is OFF.

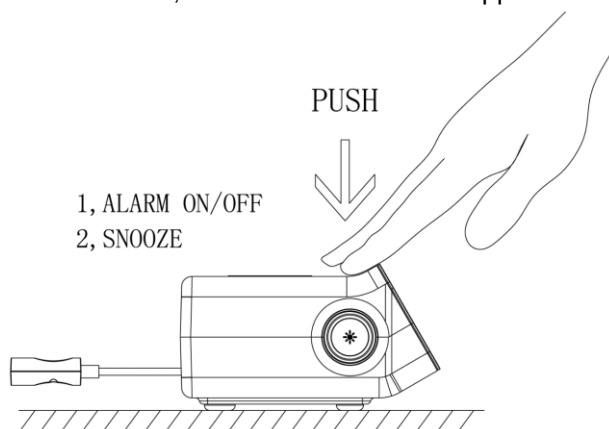

► Press and hold **【ALARM】** button for 2 seconds, the hours of the ALARM time starts to flash, and press **【+】** or **【-】** buttons to set the required HOUR, hold the **【+】** or **【-】** buttons for 2 seconds can be adjusted quickly.

► Press **【ALARM】** button to confirm the item has been set and go to the next one, the sequence of setting items is as follows:

Alarm HOUR → Alarm MINUTE → SNOOZE time

► Press **【ALARM】** button to confirm your setting and to end the setting procedure.

► The alarm will sound for 2 minutes if you do not deactivate it by pressing any button. In this case the alarm will be

repeated automatically after 24 hours.

- ▶ When the alarm is ringing, press any buttons except **【SNOOZE】** to stop the alarm signal. It is not necessary to reactivate the alarm. It will ring again this time next day.
- ▶ When the alarm is ringing, press the button **【SNOOZE】** the alarm mode will to get to snooze mode. The alarm signal sounds again after the snooze time of you set.

F.Y.I.:

- ▶ If there is no valid operation within 20 seconds, it will automatically return to normal time mode from the alarm time set mode.

Backlight brightness settings

- ▶ Touch the button ⑥ to adjust the brightness of backlight, the brightness level is divided into light, middle, dark and off.

Bed light brightness settings

- ▶ Touch the button ⑦ to turn ON/OFF or adjust the brightness of bed light, the brightness level is divided into light, middle, dark.

Temperature unit switch

- ▶ Press the button **【-】** ⑭ to switch the temperature unit in °C or °F.

Time format switch

- ▶ Press the button **【+】** ⑬ to switch the time format in 12HR or 24HR.

Wireless charging

- ▶ Place the mobile device which supporting Qi standard on the antiskid pad ⑩ middle of wireless charger correctly, the red indicator light on.

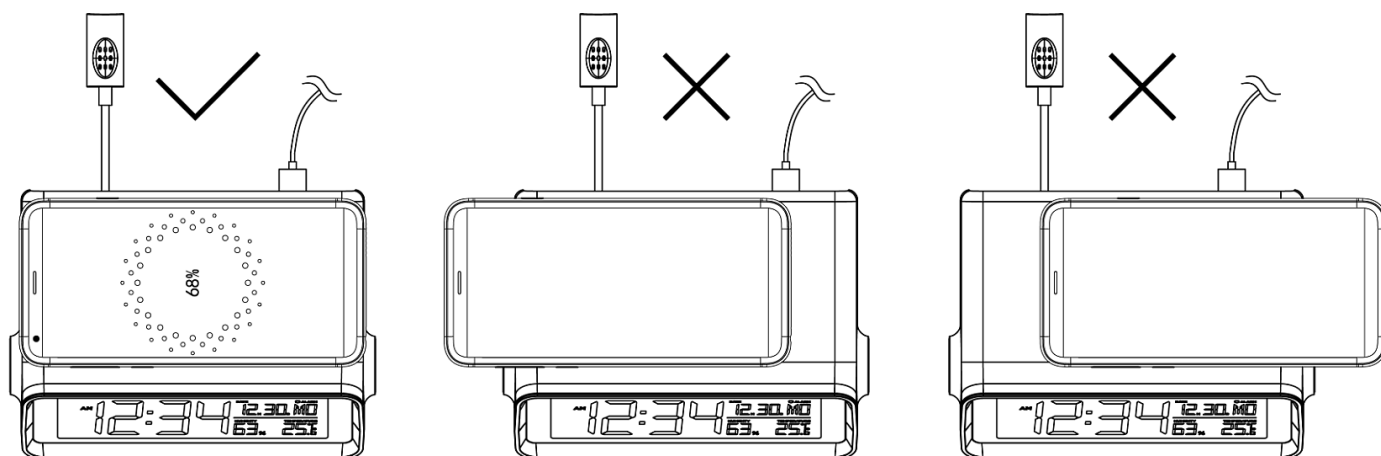

- ▶ The indicator light is red when charging normally and green when fully charged (currently only supported by some Samsung mobile devices). The red indicator light flashes when metal or similar items are detected.

MC-W6 User Manuals

FCC Attentions

This device complies with part 15 of the FCC Rules. Operation is subject to the following two conditions: (1) this device may not cause harmful interference, and (2) this device must accept any interference received, including interference that may cause undesired operation.

Any changes or modifications not expressly approved by the party responsible for compliance could void the user's authority to operate the equipment.

NOTE: This equipment has been tested and found to comply with the limits for a Class B digital device, pursuant to Part 15 of the FCC Rules. These limits are designed to provide reasonable protection against harmful interference in a residential installation. This equipment generates, uses and can radiate radio frequency energy and, if not installed and used in accordance with the instructions, may cause harmful interference to radio communications. However, there is no guarantee that interference will not occur in a particular installation.

If this equipment does cause harmful interference to radio or television reception, which can be determined by turning the equipment off and on, the user is encouraged to try to correct the interference by one or more of the following measures:

- Reorient or relocate the receiving antenna.
- Increase the separation between the equipment and receiver.
- Connect the equipment into an outlet on a circuit different from that to which the receiver is connected.
- Consult the dealer or an experienced radio/TV technician for help.

To maintain compliance with FCC's RF Exposure guidelines, This equipment should be installed and operated with minimum 20cm distance between the radiator and your body: Use only the supplied antenna.