

Bone Conduction Headphone

Model : K8

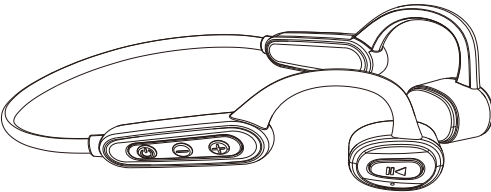

Instructions

OVERVIEW

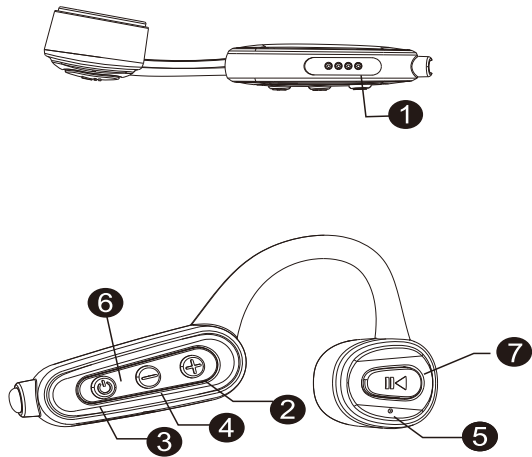

- 1.Magnetic Charging and Date Sync Port
- 2.Next song/Volume Up(Long Press)
- 3. Power ON/OFF and MODE Switch Button
- 4.Previous Song/Volume Down(Long Press)
- 5.Microphone
- 6.LED Indicator
- 7. PLAY/PAUSE/ANSWER/HANG-UP(MFB Button)

Basic Operations

Power ON/OFF:Press and hold the ③ button 3 seconds for Power ON or Power OFF.Automatically enter MP3 mode after Power On.Click once for Mode switch. (Double-click quickly after Power ON to change language)

BT MODE:Press the Power button once to switch to BT mode when music playing.Then you will hear the tone.Led flashing blue and red lights, you can connected with K8 use your phone via Bluetooth. It will POWER OFF automatically after 5 minutes if you do not have any operating.

ANSWER/REJECT:Click once the MFB to answer phone calls when there are incoming after bluetooth connected ,click again to hang up calls.Quickly click twice to reject when call incoming.

Mp3 MODE: Press and hold the power button for 3 seconds, the Blue LED light flash, and then turn to playback mode. Connect the USB Charging/Transfer cable into your computer's USB port (your computer will automatically recognize K8 flash disk). Adding, copying and deleting songs on your headphone player are like using USB flash disk. (Note:Power ON first for data sync before connect PC)

VOLUME:Long press (2 sec) the +/- button to volume up or volume down.Single press the vol +/- to skip forward or backward songs.

PAUSE/PLAY: While music is playing, click the Play Key to pause,and then click again to re-play songs.The playlists of the songs will be arranged in the order in which of the copied files go to named K8 disk. Long press will turn into phone's intelligent voice-activated.

CHARGING:Use the original charging cable (included) to charge the headphone. Red LED means it's charging. When charging is completed the red LED will turn into blue.The charger voltage rating shouldn't exceed 5V.

OTG Download: Download music songs use your own OTG adapter cable. Connect headphones with the original data cable and then turn on your headphone . Copying the songs as the flash disk as usual after it recognized. (Note : The OTG function need you phone support)

RESET: Press and hold the power button for 10 seconds to force reset

ISSUE SOLVE

- 1.The headphone will automatically disconnect when the protective mechanism is activated over the temperature, and it will reconnect for your data sync later.
- 2. If the operating loss of control will not switch on/off, press and hold the power button for 10 seconds to reset.
- 3. If the LED does not light up or could not be recognized after connected the cumputer,need to check the USB cable is correct or not and whether the USB cable is fully inserted(Do not use an extension cord, need to use the original data cables plug directly into the charger or computer USB interface)

WEARING

- 1.Charging time shouldn't over 2hours,and you'd better charging once a month at least .Don't forget keep dry.
- 2.Please use the original cable for charging and data sync, if not will be damaged the headphone.
- 3.Choose the eject device after download data completed.

Specifications:

BT Version: 5.0

Audio format support:mp3,wma.wav,ape,flac

Adapter Output voltage rating: DC 5V

Battery Capacity: 300mA

Charging time: 2 hrs(at least once a month)

Transmission range: 33 ft

MAC&PC Compatible

Microphone sensitivity : 37±2db

Package Contents:

1 x BT Bone Conduction Headphone

1 x USB charging/transfer Cable

1 x User Guide

1 x Silicone Adjustable Headband

This device complies with part 15 of the FCC Rules. Operation is subject to the following two conditions: (1) this device may not cause harmful interference, and (2) this device must accept any interference received, including interference that may cause undesired operation.

Any changes or modifications not expressly approved by the party responsible for compliance could void the user's authority to operate the equipment.

NOTE: This equipment has been tested and found to comply with the limits for a Class B digital device, pursuant to Part 15 of the FCC Rules. These limits are designed to provide reasonable protection against harmful interference in a residential installation. This equipment generates, uses and can radiate radio frequency energy and, if not installed and used in accordance with the instructions, may cause harmful interference to radio communications. However, there is no guarantee that interference will not occur in a particular installation.

If this equipment does cause harmful interference to radio or television reception, which can be determined by turning the equipment off and on, the user is encouraged to try to correct the interference by one or more of the following measures:

- Reorient or relocate the receiving antenna.
- Increase the separation between the equipment and receiver.
- Connect the equipment into an outlet on a circuit different from that to which the receiver is connected.
- Consult the dealer or an experienced radio/TV technician for help.

The device has been evaluated to meet general RF exposure requirement. The device can be used in portable exposure condition without restriction