

多功能对战遥控坦克说明书

一、产品清单



遥控车x1



2.4G遥控器x1



注水瓶x1



产品推广视频



产品操作视频

二、功能介绍



三、充电说明

- 1.这个新的电池组，需要充电后才能使用。
- 2.先把电池组的电线插头插在充电器的插头里，再把充电器插头插在插座上。（如图1）
- 3.电池充满电量所需时间为90-150分钟，充电插头带充电指示灯，充电中为红灯长亮绿灯闪烁，充满时绿灯长亮红灯熄灭。不要过量充电，过长时间的充电也不会使电量增加。
- 4.定期检查玩具和电池，充电线的电线、插头，这些配件如有破损应停止使用，直到修好或换新后方可使用。



图1

四、功能说明

对频：将遥控坦克车电源开关拨至“ON”位置，此时灯光慢闪，车子进入对频模式；同时长按遥控器开关按钮，对频成功，车子默认驱动模式，功能可以正常控制。

开关按键	长按3秒开机，指示灯闪烁，遥控器进入对频模式。
前进和后退	左摇杆向上或向下推，遥控车前进或后退；保持左摇杆向上或向下推，遥控车则一直保持前进或后退。
左旋转/右旋转	将右摇杆向左或向右推，遥控车向左旋转或向右旋转
左横行/右横行	按住遥控器左边按键，遥控车向左横行，按住遥控器右边按键，遥控车向右横行
灯光/喷雾	短按按键开关灯光；长按按键开关遥控车喷雾模式，遥控车直行时尾部自动喷雾。（喷雾模式下请提前往遥控车尾部注水孔加满水）
音乐开关	短按按键播放音乐，再次短按切换音乐，再按一次关闭音乐。
一键演示	短按按键，遥控车进入功能自动演示模式

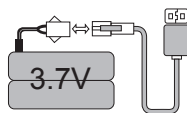
五、遥控器电池安装

- 遥控器：**
- 1.用十字螺丝刀松开电池盖上的螺丝，打开电池盖。
 - 2.按电池座的正负极装入2节1.5VAA电池。
 - 3.盖好电池盖，并将螺丝拧紧。

- 遥控车：**
- 1.打开车底电池盖，把可充电电池组连接到电源接口装入电池仓里。
 - 2.盖上电池盖，并用螺丝刀拧紧。

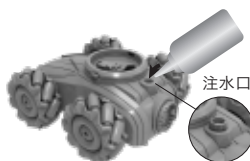

拧开遥控车尾部注水孔盖子，使用注水瓶往注水孔里加水，加满水后拧紧盖子。

MULTIFUNCTION BATTLE REMOTE CONTROL TANK INSTRUCTION

1、PARTS LIST



Remote Control Car *1



2.4g Remote Control *1



Water Bottle*1



Promotion Vedio



Operate Video

2、FUNCTION INTRODUCE

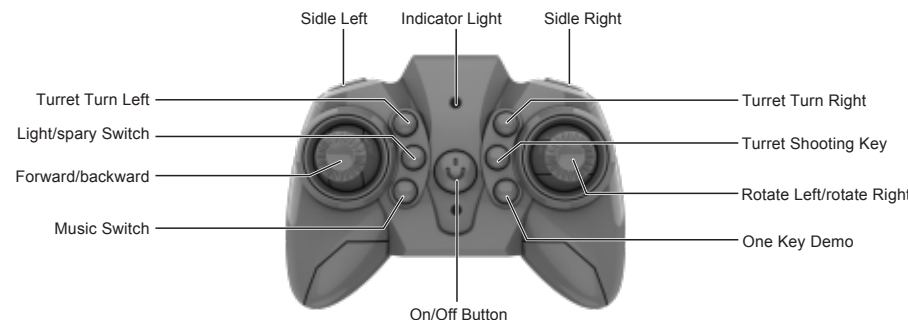

3、CHARGE INSTRUCTIONS

- a.Before use the new battery , please charge it.
- b.Connect the bettery and the charger, then plug the charger into the socket.(As shown in figure 1)
- c.Fully charged need 90-150 minute.There have indicator light on the charging plug, the red light on and green light flash when charging,the green light on and red light off once fully charged. Don't overcharge,this couldn't increase the electric quantity.
- d.Check the toys, batteries, charging wires and plugs regularly. If any of those accessories is damaged, stop using them until they are repaired or replaced.

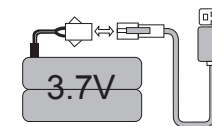

Figure 1

4、FUNCTION INSTRUCTIONS

Frequency connection: Put the power switch of vehicle to "ON", the light flash slowly and the vehicle into frequency connection model; and long press the switch button of the remote control at the same time, frequency connection succeed.The vehicle default drive modle, the function can be normal control.

Switch Button	Long press 3 seconds to start up, the indicator light flash and remote control enters the frequency connection modle.
Forward/backward	Push the left rocker up or down, vehicle go forward or backward.Keep the left rocker up or down, vehicle always go forward or backward.
Rotate Left/rotate Right	Push the right rocker left or right,vehicle rotate left or rotate right.
Side Left/side Right	Hold down the "side" button on left, vehicle side to the left;hold down the "side" button on right, vehicle side to the right.
Light/spary	Press the button ON/OFF light; press and hold the button ON/OFF spary (Open spary mode,the rear of vehicle automatic spray.Please add water in advance on spary mode).
Music Switch	Press the button one times play music,press second times switch the music,press the third times close the music.
One Key Demo	Press the button, the vehicle start one key demo to show all function.

5、Battery Installation Instructions

- Remote control：**
- a. Please use a screwdriver to loosen the screws on the battery cover and open it.
 - b.Please put 2pcs 1.5V AA battery according positive and negative into the battery holder.
 - c.Close the battery cover and tighten the screws

- RC car：**
- a.Please open the battery cover on vehicle bottom, connect the built-in battery into the power interface and put into the batter holder.
 - b.close the cover and tighten the screws.

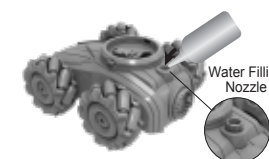

Open the cover,use the water bottle add water into the water filling nozzle, after full water close the cover.

多功能对战坦克软弹炮台功能说明书

一、产品清单

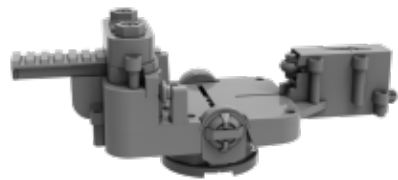

软弹炮台x1



弹夹x1



红外线装置x1



软弹x1包



产品推广视频



产品操作视频

二、软弹炮台功能说明

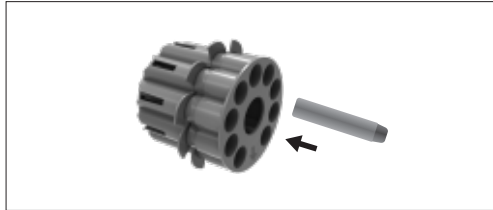

1.将EVA软弹装入弹夹

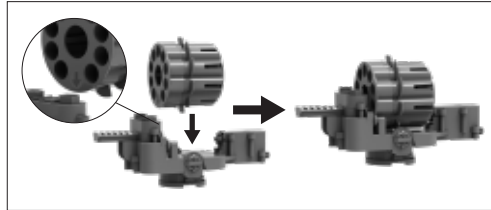

2.将弹夹一端的三角标识对准炮台正中间的卡槽位，按压卡位，将弹夹组装到炮台上，取出弹夹直接向上提拉取出。

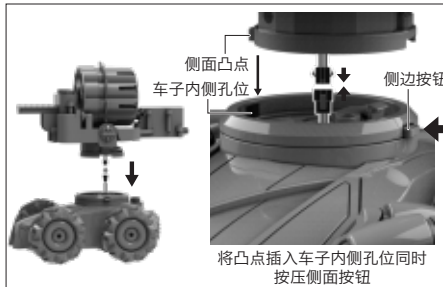

将凸点插入车子内侧孔位同时按压侧面按钮

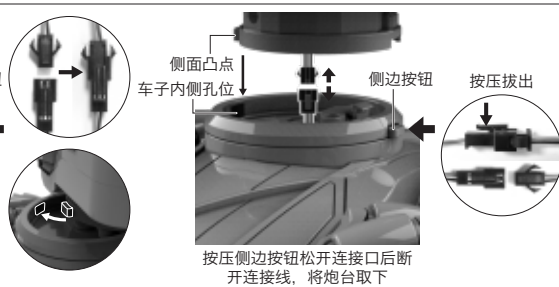

按压侧面按钮松开连接口后断开连接线，将炮台取下

3.将炮台底部电线接口连接到遥控车对应电线接口上，找到炮台连接口侧面凸点，将凸点对准车子连接口孔位，并同时按压遥控车连接口侧面按钮，将炮台组装到遥控车上。拆卸炮台则重新按压侧面按钮，松开连接口并断开炮台与遥控车的连接线，将炮台取下。更换其他功能炮台请重复以上操作。

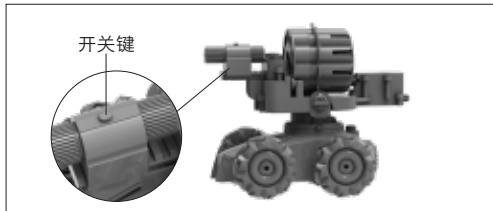

4.将红外线装置沿锯齿轴平行装到炮台上，打开红外线装置上方开关，发射红外射线。

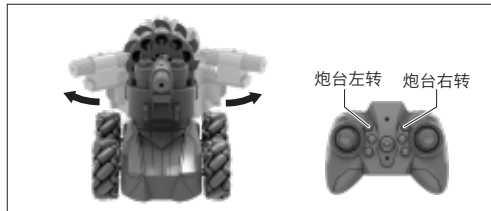

5.遥控车与遥控器对频成功后，长按遥控器左侧按钮，炮台向左转动；长按右侧按钮，炮台向右转动。

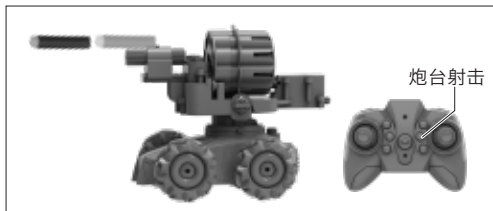

6.炮台射击功能：紧按按键炮台发射软弹，长按按键连续打弹。



7.语音控制与一键演示模式下，炮台“打弹”射击功能为连续打弹。

MULTIFUNCTION BATTLE REMOTE CONTROL TANK (EVA BULLET TURRET) FUNCTION INSTRUCTION

1、PARTS LIST

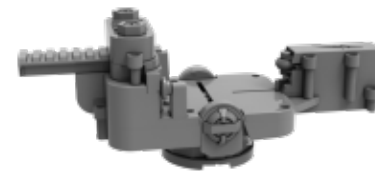

Eva Bullet Turret *1



Ammunition Clip*1



Infrared Ray Equipment*1



Eva Bullet*1



Promotion Video



Operate Video

2、EVA BULLET TURRET FUNCTION INSTRUCTION

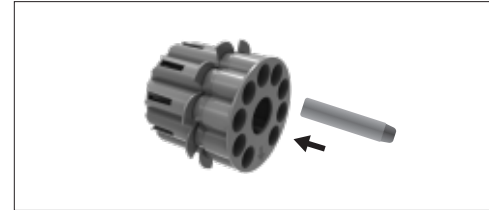

Put eva bullet into ammunition clip.

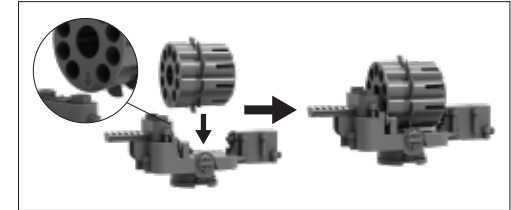

There have a arrow mark on the ammunition clip, make it face to the slot in the middle of the turret,hold down the ammunition clip into the turret.lift up to remove the ammunition clip.

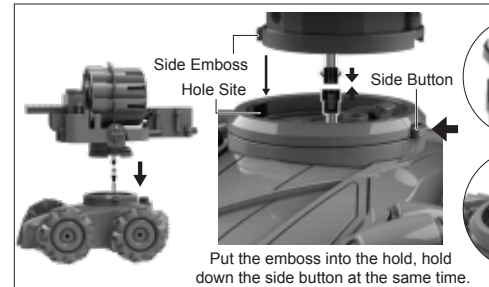

Put the emboss into the hold, hold down the side button at the same time.

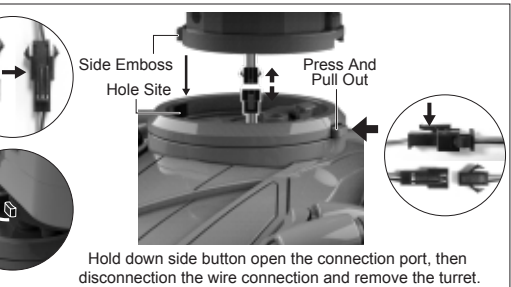

Hold down side button open the connection port, then disconnection the wire connection and remove the turret.

Connect the turret wire connection to the vehicle's,there have a emboss on the side of turret connection port, put it into the hold in the side of the vehicle connection port, hold down the side button at the same time,and complete installation. Hold down the side button again and disconnect the wire connection between the turret and vehicle to remove the turret.Change other turret please repeat the preceding operations.

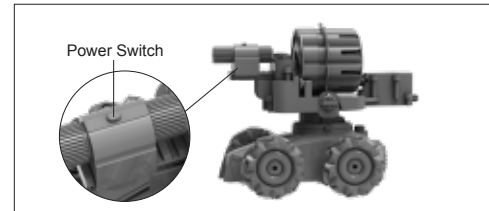

Loading the infrared ray equipment to the turret, press the power switch, emit infrared.

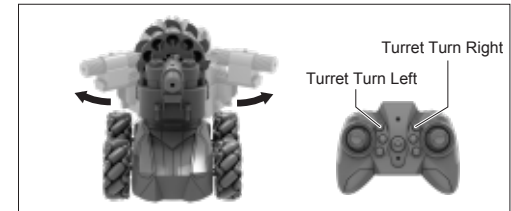

After frequency connection succeed, hold down the remote control left side button, the turret turn left;hold down the right side button, turret turn right.



Turret shooting function: press button the turret shooting EVA bullet, press and hold the button, turret continuous fire.



Under the voice control and one key demo modle, the shooting function of the turret would be continuous fire.

多功能对战坦克水弹炮台功能说明书

一、产品清单



二、水弹炮台功能说明



1.将吸水弹适量倒入小瓶里，加满水，放置一段时间，等吸水弹泡发完成后过滤掉瓶中多余水分。

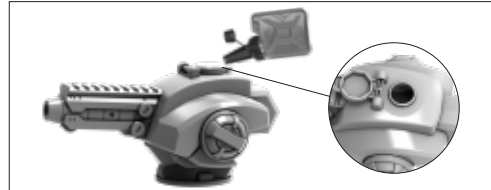

2.打开炮台顶部装弹口盖子，将水弹装入炮台弹仓并按压盖好盖子。游戏后请取出弹仓内剩余水弹，并清洁弹仓。重新组装玩要请重复以上操作。注意加水弹时不要把水加进去，防止电路板短路。

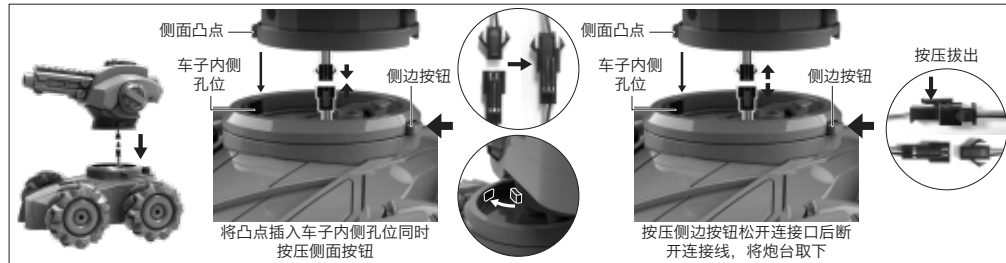

3.将炮台底部电线接口连接到遥控车对应电线接口上，找到炮台连接口侧面凸点，将凸点对准车子连接口孔位，并同时按压遥控车连接口侧面按钮，将炮台组装到遥控车上。拆卸炮台则重新按压侧面按钮，松开连接口并断开炮台与遥控车的连接线，将炮台取下。更换其他功能炮台请重复以上操作。

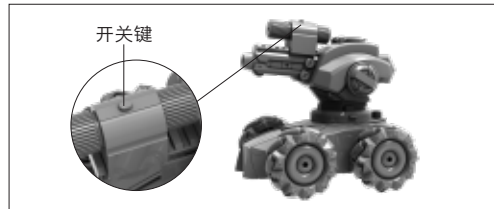

4.将红外线装置沿锯齿轴平行装到炮台上，打开红外线装置上方开关，发射红外射线。

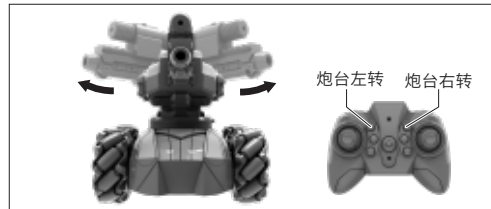

5.遥控车与遥控器对频成功后，长按遥控器左侧按钮，炮台向左转动；长按右侧按钮，炮台向右转动。



6.炮台射击功能：紧按按键炮台发射水弹，长按按键炮台连续打弹。



7.语音控制与一键演示模式下，炮台“打弹”射击功能为连续打弹。

MULTIFUNCTION BATTLE REMOTE CONTROL TANK (WATER BULLET TURRET) FUNCTION INSTRUCTION

1、PARTS LIST



2、WATER BULLET TURRET FUNCTION INSTRUCTION



Put some water bullet into container and add water,let it sit for a while,filter out the excess water in the bottle after the water bullet imbibe complete

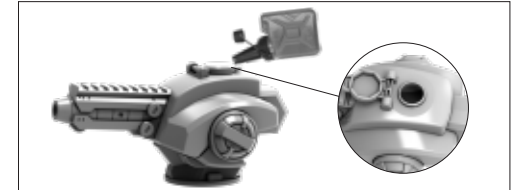

Open the cover on the top of turret,put the water bullet in and close the cover.After the game, please take out the remaining water bombs in the magazine and clean the magazine. Reassemble play please repeat the above steps.Do not add water when adding water bomb to prevent circuit board short circuit.

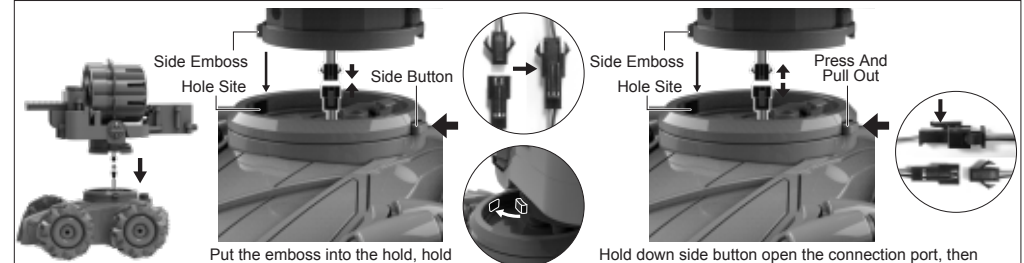

Connect the turret wire connection to the vehicle's,there have a emboss on the side of turret connection port, put it into the hold in the side of the vehicle connection port, hold down the side button at the same time,and complete installation. Hold down the side button again and disconnect the wire connection between the turret and vehicle to remove the turret.Change other turret please repeat the preceding operations.

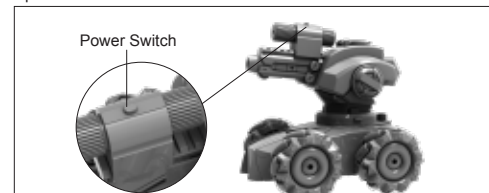

Loading the infrared ray equipment to the turret, press the power switch, emit infrared.

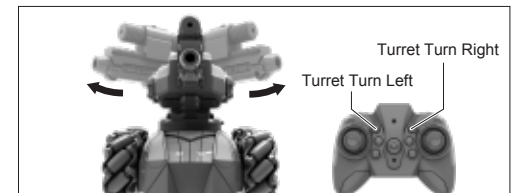

After frequency connection succeed, hold down the remote control left side button, the turret turn left; Hold down the right side button, turret turn right.



Turret shooting function: press button the turret shooting water bullet, press and hold the button, turret continuous fire.

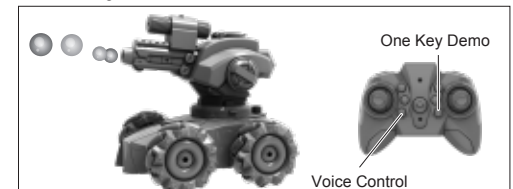

Under the voice control and one key demo mdle, the shooting function of the turret would be continuous fire.

多功能对战坦克泡泡炮台功能说明书

一、产品清单



泡泡炮台x1



泡泡水瓶子x1



泡泡浓缩液x2

二、泡泡炮台功能说明



1.将泡泡水适量倒入小瓶里（泡泡水为浓缩液体可以适量添加清水），拧紧盖子。



2.打开炮台尾部弹仓盖子，拉出弹仓里2条软管，将软管分别插入瓶子盖上对应圆孔并将装满泡泡水的瓶子装入弹仓内（如图），关上弹仓盖子。注意软管尽可能都装入瓶中，并保持软管通畅，避免挤压堵塞影响功能。游戏后请将泡泡水瓶子从弹仓里取出，并清洁内部残余液体。重新组装玩耍请重复以上操作。

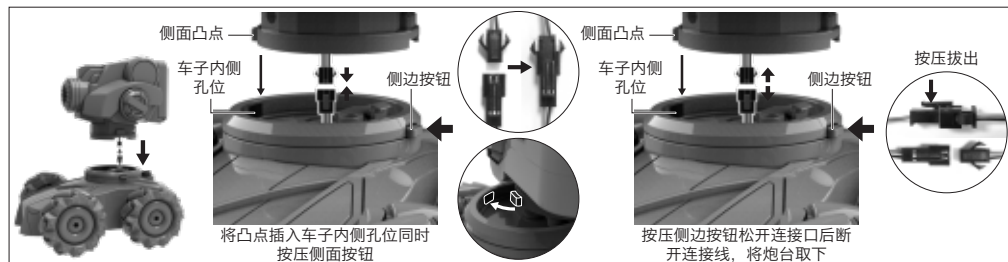

3.将炮台底部电线接口连接到遥控车对应电线接口上，找到炮台接口侧面凸点，将凸点对准车子连接口孔位，并同时按压遥控车连接口侧面按钮，将炮台组装到遥控车上。拆卸炮台则重新按压侧面按钮，松开连接口并断开炮台与遥控车的连接线，将炮台取下。更换其他功能炮台请重复以上操作。

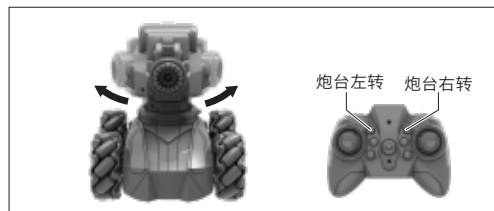

4.遥控车与遥控器对频成功后，长按遥控器左侧按钮，炮台向左转动；长按右侧按钮，炮台向右转动。



5.炮台射击功能：长按按键，炮台持续喷射泡泡。



6.语音控制与一键演示模式下，炮台“打弹”射击功能为连续喷射泡泡



产品推广视频



产品操作视频

MULTIFUNCTION BATTLE REMOTE CONTROL TANK (BUBBLE TURRET) FUNCTION INSTRUCTION

1、PARTS LIST

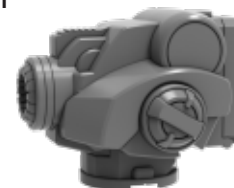

Bubble Turret*1



Bubble Water Container*1



Bubble Concentrated Solution*2

2、BUBBLE TURRET FUNCTION INSTRUCTION



Put some bubble water into the container(It is concentrated solution and could be add some water), close the cap.

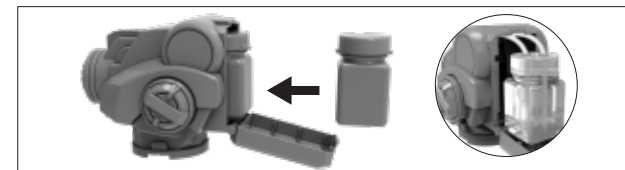

Open the door at the back of turret,pull out two pieces hose inside, and put them into the bubble water container, and put the container into the magazine(as show in figure),close the door. Put the hoses into bottle as far as possible, and keep the hoses unobstructed to avoid squeezing and blocking affect the function. After the game, remove the container from the magazine and clean the magazine. Reassemble play please repeat the above steps.

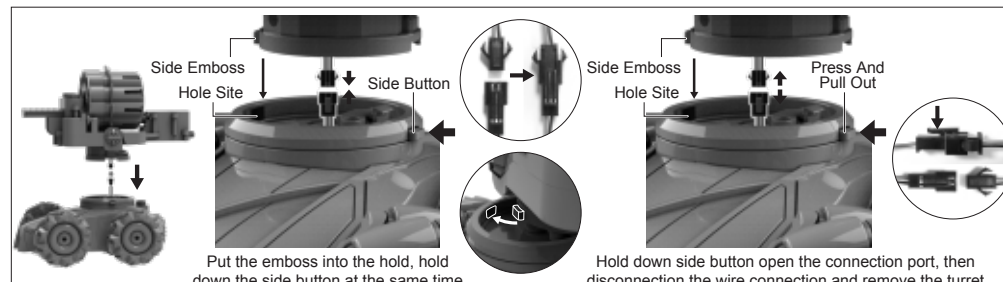

Connect the turret wire connection to the vehicle's,there have a emboss on the side of turret connection port, put it into the hold in the side of the vehicle connection port, hold down the side button at the same time,and complete installation. Hold down the side button again and disconnect the wire connection between the turret and vehicle to remove the turret.Change other turret please repeat the preceding operations.

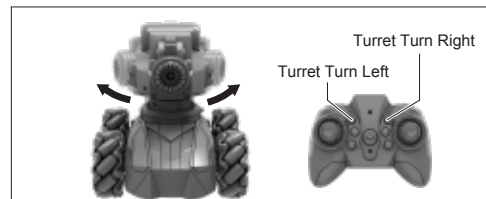

After frequency connection succeed, hold down the remote control left side button, the turret turn left;hold down the right side button, turret turn right.

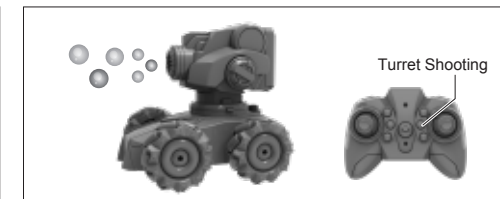

Turret shooting function:press and hold the button, turret continuous fire.



Under the voice control and one key demo mode, the shooting function of the turret would be continuous fire.



Promotion Vedio



Operate Video

多功能遥控坦克手表说明书

一、手表功能示意图

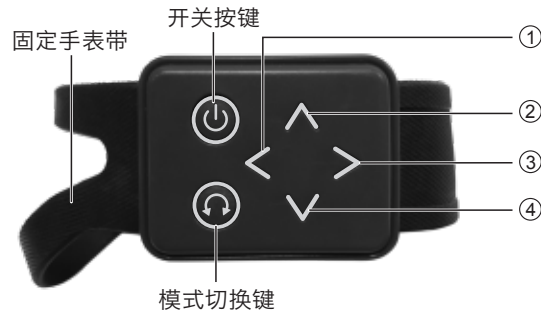

二、功能说明

开关按键: 短按按键开机, 表盘指示灯闪烁。对频成功后表盘指示灯循环闪烁进入待机模式, 再次短按按键, 单个或多个指示灯长亮, 进入驱动模式。游戏中短按开关机按键, 切换待机/驱动模式, 长按按键关机, 指示灯熄灭。

对 频: 将遥控坦克车电源开关拨至“ON”位置, 此时车灯慢闪, 车子进入对频模式; 同时按下手表开关按键, 对频成功, 表盘按键指示灯循环闪烁进入待机模式, 再次短按手表开关按键, 单个或多个指示灯长亮, 车子进入驱动模式, 功能可以正常控制。

模式切换键:

第一模式	按下模式切换按键 ① 灯亮 进入第一模式	前进 后退 向左横行 向右横行	手势向前—— 指示灯亮, 遥控车前进 手势向后—— 指示灯亮, 遥控车后退 手势向左—— 指示灯亮, 遥控车向左横行 手势向右—— 指示灯亮, 遥控车向右横行
第二模式	按下模式切换按键 ① ② 灯亮 进入第二模式	前进 后退 向左旋转 向右旋转	手势向前—— 指示灯亮, 遥控车前进 手势向后—— 指示灯亮, 遥控车后退 手势向左—— 指示灯亮, 遥控车向左旋转 手势向右—— 指示灯亮, 遥控车向右旋转
第三模式	按下模式切换按键 ① ② ③ 灯亮 进入第三模式	前进 后退 炮台向左转 炮台向右转	手势向前—— 指示灯亮, 遥控车前进 手势向后—— 指示灯亮, 遥控车后退 手势向左—— 指示灯亮, 炮台向左转 手势向右—— 指示灯亮, 炮台向右转
第四模式	按下模式切换按键 ① ② ③ ④ 灯亮 进入第四模式	开关/切换音乐 自动演示 开关喷雾 开光灯光	手势向前—— 指示灯亮, 开关及切换音乐 手势保持向后—— 指示灯亮, 遥控车进入自动演示模式 手势向左—— 指示灯亮, 开关喷雾 手势向右—— 指示灯亮, 开关灯光

射击功能: 左右连续摇晃手表, 炮台发射子弹。(任意模式下, 均可操作射击功能)

三、手表穿戴示意图 (右手)

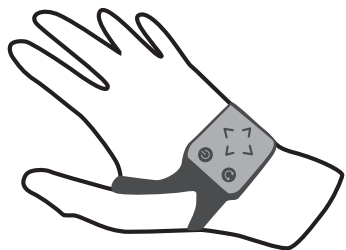

四、充电说明 (下图)

将手表关机后, 使用配送的安卓充电线, 将Micro接口端插入手表侧面USB充电口并接通电源。充电时, 表盘红色指示灯亮, 充满电表盘指示灯熄灭。



MULTIFUNCTION REMOTE CONTROL TANK(WATCH)INSTRUCTION

1.Watch Function Diagram

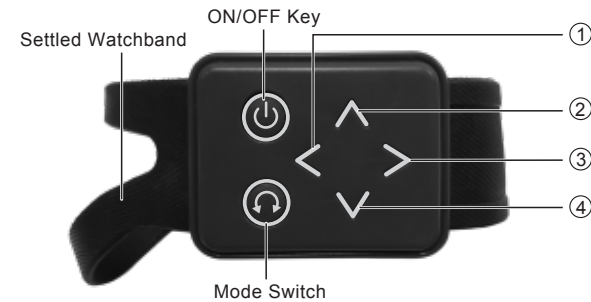

2.Function Introduce

ON/OFF Key: Press the ON/OFF key to starting up the watch,the dail indicator light flash.After frequency connection succeed,the dail indicator light cycle flash and the watch into standby mode, to press ON/OFF key again,one or several indicator light on,vehicle enter drive mode. Short press ON/OFF key to switch standby/drive mode in the game, long press close the watch and indicator light off.

Frequency Connection: Put the power switch of vehicle to "ON", the light flash slowly and the vehicle into frequency connection model; and short press the ON/OFF key of the watch at the same time, frequency connection succeed,the dail indicator light cycle flash and the watch into standby mode,short press ON/OFF key again, one or several indicator light on,vehicle enter drive mode, the function can be normal control.

Mode Switch:

First Mode	Press mode switch button, light ① on and enter first mode	Forward Backward Sidle Left Sidle Right	Gesture forward, 指示灯亮, remote control car go forward Gesture backwards, 指示灯亮, remote control car backward Gesture to the left, 指示灯亮, remote control car sidle to the left Gesture to the right, 指示灯亮, remote control car sidle to the right
Second Mode	Press mode switch button, light ① ② on and enter second mode	Forward Backward Rotate Left Rotate Right	Gesture forward, 指示灯亮, remote control car go forward Gesture backwards, 指示灯亮, remote control car backward Gesture to the left, 指示灯亮, remote control car rotate to the left Gesture to the right, 指示灯亮, remote control car rotate to the right
Third Mode	Press mode switch button, light ① ② ③ on and enter third mode	Forward Backward Turret Turn Left Turret Turn Right	Gesture forward, 指示灯亮, remote control car go forward Gesture backwards, 指示灯亮, remote control car backward Gesture to the left, 指示灯亮, turret turn left Gesture to the right, 指示灯亮, turret turn right
Fourth Mode	Press mode switch button, light ① ② ③ ④ on and enter fourth mode	ON/OFF/SWITCH music Auto-Show ON/OFF Spray ON/OFF Light	Gesture forward, 指示灯亮, to open,switch or close music and sound Gesture keep backwards, 指示灯亮, the remote control car enter auto-show mode Gesture to the left, 指示灯亮, to open or close the spray of the vehicle Gesture to the right, 指示灯亮, to open or close the light of the vehicle

Shooting Function: keep shake the watch from side to side,the vehicle start shooting.
(Shooting function can be operated in any mode)

3.Watch wearing diagram (right hand).

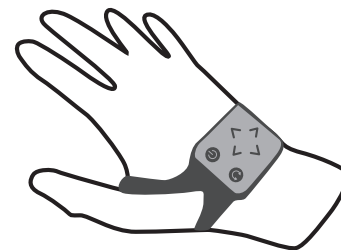

4.Charge Instructions(Below Picture).

After close the watch, use the supplied Android charging cable,connect the Micro port of charging line into USB charge port on the side of the watch and switch on the power. The dial red indicator light is on when charging, and the light off when fully charged.



FCC Compliance Statements

This device complies with Part 15 of the FCC Rules. Operation is subject to the following two conditions: (1) this device may not cause harmful interference, and (2) this device must accept any interference received, including interference that may cause undesired operation.

Note: This equipment has been tested and found to comply with the limits for a Class B digital device, pursuant to Part 15 of the FCC Rules. These limits are designed to provide reasonable protection against harmful interference in a residential installation. This equipment generates, uses and can radiate radio frequency energy and, if not installed and used in accordance with the instructions, may cause harmful interference to radio communications. However, there is no guarantee that interference will not occur in a particular installation.

If this equipment does cause harmful interference to radio or television reception, which can be determined by turning the equipment off and on, the user is encouraged to try to correct the interference by one or more of the following measures:

- Reorient or relocate the receiving antenna.
- Increase the separation between the equipment and receiver.
- Connect the equipment into an outlet on a circuit different from that to which the receiver is connected.
- Consult the dealer or an experienced radio/TV technician for help.

Caution: Changes or modifications not expressly approved by the party responsible for compliance could void the user's authority to operate the equipment.

This equipment complies with FCC radiation exposure limits set forth for an uncontrolled environment. This transmitter must not be co-located or operating in conjunction with any other antenna or transmitter.