



USER MANUAL

CELLO 2

Getting Started

Important Safety Instructions

Read these operating instructions carefully before using the unit. Follow all the safety instructions listed below. Keep these operating instructions handy for future reference.

1. Read these instructions.
2. Keep these instructions.
3. Heed all warnings.
4. Follow all instructions.
5. Do not use this apparatus near water.
6. Clean only with a dry cloth.
7. Do not block any ventilation openings. Install in accordance with the manufacturer's instructions.
8. Do not install near any heat sources such as radiators, stoves, refrigerator or other apparatus of this kind.
9. Do not install on top of amplifiers or other apparatus that produce heat.
10. Make sure that you are using the correct electrical socket for your plugs, do not force to insert your plug to a socket if it doesn't fit.
11. Protect the power cord and/or power adapter and power adapter cord from being walked on or pinched, particularly at plugs, convenience receptacles, and the point where they exit from the apparatus.
12. Unplug this unit during lightning storms or when unused for long periods of time.
13. Refer all servicing to qualified service personnel. Servicing is required when the unit has been damaged in any way, such as the power-supply cord or plug is damaged, liquid has been spilled or objects have fallen into the apparatus, the apparatus has been exposed to rain or moisture, does not operate normally, or has been dropped.

Contents

Getting Started	
Important Safety Instructions	1
Precaution	1
Installation	2
Remote Control	3
Accessories	3
Description	
Front and Rear Panel	4
Microphone	5
Remote Controller	6
Connections	
Connecting to Power Supply	7
Connecting Video Out to Monitor	7
Connecting Audio Out to Amplifier	7
Connecting 5.1 CH Audio Out to Amplifier	7
Connecting Microphones	8
Other Connections	9
Operation	
Basic Karaoke Operation	9-10
Special Operation	10
Karaoke Setup	11
Miscellaneous	
Troubleshooting	12
Specification	13

Precautions

TO REDUCE THE RISK OF ELECTRIC SHOCK, DO NOT REMOVE THE COVER.
NO USER-SERVICEABLE PARTS ARE INSIDE. REFER SERVICING TO QUALIFIED SERVICE PERSONNEL.

	CAUTION RISK OF ELECTRIC SHOCK DO NOT OPEN	
The lightning flash and Arrowhead within the triangle is a warning sign alerting you of dangerous voltage inside the product.	Caution: to reduce the risk of electric shock, do not remove cover. No user serviceable parts inside. Refer servicing to qualified service personnel.	The explanation point within the triangle is a warning sign alerting you of important instructions accompanying the product.

Do not install this equipment in a confined space such as a bookcase or similar areas.
WARNING: TO REDUCE THE RISK OF FIRE OR ELECTRIC SHOCK, DO NOT EXPOSE THIS UNIT TO RAIN OR MOISTURE.

Installation

Warnings

- Only Use 110V or 220V power outlet
- When connecting to other devices, please read the other device's user manual. Improper connection may cause fire, electrical leakage and/or electric shock.
- Install the unit with at least 10cm of distance from the wall and enough space from other materials to avoid fire and/or electric shock.
- Do not puncture or damage the power cord or place any material near or on the power cord that may cause damage to it; this may cause fire, electrical leakage and/or electric shock.
- Do not use a multi-plug in one outlet, if you must, do not exceed more than 200W. Especially, do not use electric heater, TV set, hair dryer, electric cooker in one multi-plug, this may cause fire from electric leakage.
- Do not place metal objects such as hairpins and coins on and in the product, this may cause fire, electric leakage, and/or electric shock.
- Do not handle the power cord head when unplugging, it may cause electrocution, fire, or electric shock.
- Do not re-use damaged power cord. Do not use power outlet if it is not fixed firmly. It may cause fire, electric leakage, and/or electric shock.
- Unplug the power cord when unit is not in use for a long time. It may cause fire.
- Do not touch the power cord during thunder and lightning.
- When moving the unit, unplug the power and disconnect all wirings and devices. It may cause injury, fire, electric leakage, and/or electric shock. It may also cause damage to the unit and other devices.
- If unit has fallen or has been damaged, unplug the power cord, if not, it may cause fire, electric leakage, and/or electric shock.
- When you hear suspicious sounds, smell of something burning, or see smoke, turn off the unit and unplug the power cord immediately, using gloves or dry cloth.
- Do not disassemble or modify the unit. It may cause fire, electric leakage, and/or electric shock.

- Do not install the unit at places with high humidity.
- Do not place any vessel containing liquid on top of the unit.
- Do not install in areas with high heat. Especially, do not place the power cord close to heat source, it may cause fire electrical leakage and/or electric shock.
- Do not install the unit under direct sunlight, this may cause deformation, discoloration of the unit, and heat which may cause fire, malfunction, and/or electric shock.
- Do not touch the unit or the power cord with wet hands; it may cause electric shock, leakage, malfunction, damage, and/or fire.
- Do not spray water, beverage or alcohol on unit; this may cause fire, electric leakage, and/or electric shock.
- Do not move the product suddenly from a cold area to a hot area. Moisture may build and may cause malfunction. In this case, turn the power-off and leave unit in an area with temperature of 25 degrees for 1-2 hours before operating again.

- Do not deform, twist, bend, or heat the power cord.
- Do not hit the product nor place microphone or other objects on the product with force; it may damage, deterioration, it may also produce strange loud sounds.
- Do not move the unit when there is an object on top of it, it may cause injury from falling objects and from debris.
- Do not push the buttons by force, it may cause damage and/or malfunction.
- Do not step on or hang the unit. Especially keep the unit from reach of children. It may cause injury if it may fall or from debris.

- Safely install the unit first before attempting to plug the power cord; if not, it may cause malfunction, electric shock and/or injury.
- Do not install the unit at places that has extreme vibration or where the unit may be inclined.
- Install the unit on a safe and stable area that can hold the unit's weight. Do not install on high places to avoid damage.
- Install TV, with enough distance from speakers or other devices that emits magnetic forces.
- Do not place the product on top of audio amplifier. It may cause fire, electric leakage, and/or electric shock that may come from malfunction of the other device.
- Do not place the product on dusty areas; it may cause fire.
- Do not block or close ventilation slots on product casing. Build up of heat may cause fire.
- Before turning on the unit, reduce the volume from amplifier, loud sound may cause ear injury or shock.

Remote Control

Remote Control Operational Range

Point the remote controller at the unit remote sensor then press buttons.
Distance: about 7 meters from remote controller to unit remote sensor.
Angle: about 30 degrees on each direction from the front of the unit remote sensor

Remote Control Battery Installation

Detach the battery cover at the back of the remote controller, and insert 2 (two) AAA size batteries with + and - aligned correctly.
Do not expose batteries to heat or moisture

Accessories

Check and identify accessories

Note: photo may vary from actual units



Description

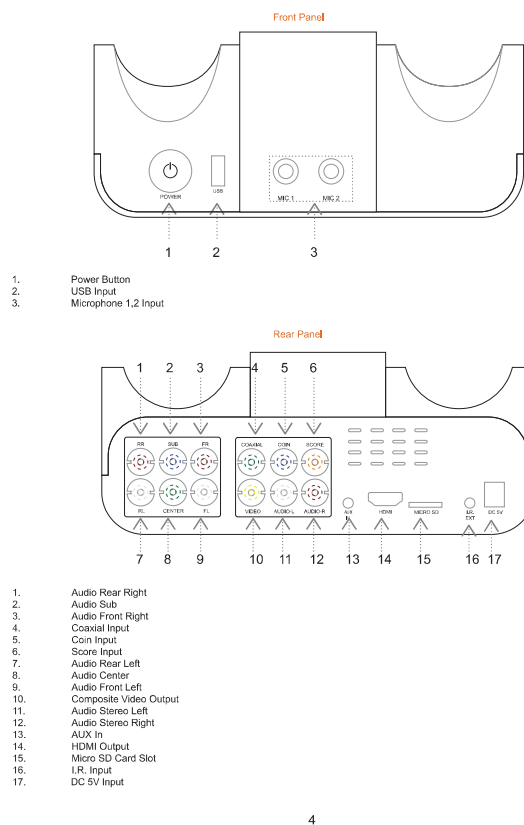

Description



Remote Controller

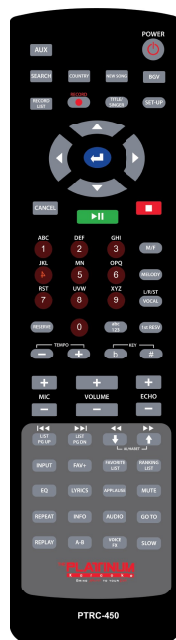

#	Button	Function
1	AUX	Switch to AUX mode
2	POWER	Power On/Off
3	SEARCH	Open and Closes On-Screen Song List
4	COUNTRY	Toggle COUNTRY on the Song List
5	NEW SONG	Opens and Closes New Song List
6	BGV	BGV(Background Video)Change
7	REC.LIST	Opens and Closes Recorded Song List
8	RECORD	Record Singing (MIC Music only)
9	TITLE/SINGER	Sort the Song List by Title or Singer
10	SET-UP	Enter or Close Setup Mode
11	ARROW ▲▼	Highlight Song Line by Line on the Song List
12	ARROW ◀▶	Changes Song type Sections
13	◀	Confirm Key to Play and Other
14	CANCEL	Cancel Wrong Song Number Input Delete Reserve Sing in Queue
15	▶▶	Start Song Playback Temporary Pause Playback Temporary
16	■	Stop Playback
17	NUMBERS(0-9)	Numbers & Initial Letter Input
18	M/F	Male/Female
19	Melody	Melody On/Off
20	VOCAL (L/R/ST)	Vocal On/Off
21	abc 123	Change Alphabet to Numerical Change Numerical to Alphabet
22	1st RESV	Reserve a certain Song at priority in queue
23	RESERVE	Reserve Songs in queue
24	KEY(+/-)	Toggle Song Pitch
25	TEMPO(+/-)	Toggle Song Speed
26	ECHO(+/-)	Toggle Echo
27	VOLUME(+/-)	Toggle Volume
28	MIC(+/-)	Toggle Mic Volume
29	ALPHABET ▲▼	Alphabet ▲: Move Song List from Z to A direction. Alphabet ▼: Move Song List from A to Z direction.
30	LIST PG ▲▼	Move Song List to Next or Previous Page
31	RANKING LIST	Opens and Closes Rank Song List
32	FAVORITE LIST	Opens and Closes Favorite Song List
33	FAV	Save Favorite Songs in the Favorite Song List
34	INPUT	Option to Select Karaoke Input Source
35	MUTE	Mute On/Off
36	APPLAUSE	Applause On/Off at Karaoke Idle Mode
37	LYRICS	Lyric On/Off
38	EQ	EQControl (Classic/Jazz/Rock/Pop/Ballad/Disco/Normal)
39	GO TO	Go To Time
40	AUDIO	Select Audio Format
41	INFO	Displays Currently Playing Song's Information
42	REPEAT	Repeat One/All/Random/Off
43	SLOW	Slow Current Media
44	VOICE FX	Toggle Microphone Effects
45	A-B	Mark Point A to Point B
46	REPLAY	Replays Current Media

Connections

Connecting to the Power Supply

Plug the Power Adapter to wall socket.
Press the Power button to switch the unit on.
Power adapter can operate on AC 110V and 220V – 50/60Hz supply.

Connecting Video Out to Monitor

Can use either Composite or HDMI video output

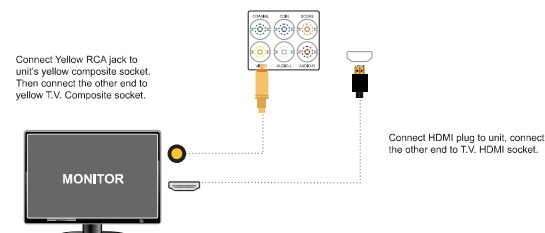

Connecting Audio Out to Amplifier

Connect red and white RCA audio plugs to unit, then connect the other ends to T.V. Audio sockets.

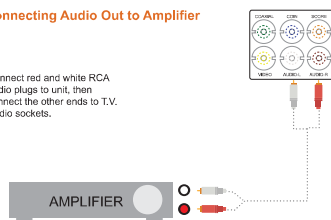

7

Connections

Connecting 5.1ch Audio Out to Amplifier

Connect RCA plugs to designated sockets on unit and on surround amplifier.
ex: center to center, sub to sub

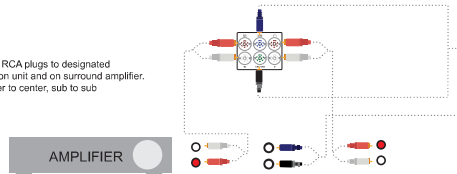

Connecting Microphones

When connecting microphone to the unit, turn down amplifier or unit microphone volume to avoid sudden loud noises. This is also to protect speakers and amplifier from damage

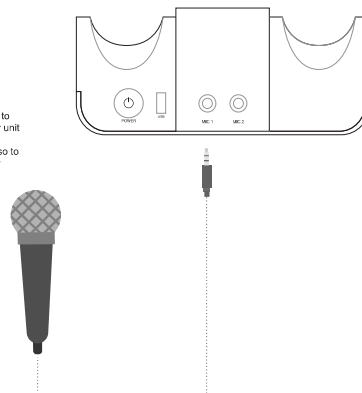

Note:
To prevent feedback noise, avoid placing your hand on top (windscreen) of the microphone, and also do not point the microphone directly to the direction of the speakers.
To further avoid feedback and unwanted noises, dial down on the amplifier volume and gradually dial up to reach optimal sound level.

8

Connections

Connecting with USB Devices

Media playback function is possible when connecting USB Flash Drive on the unit.

To play media from USB, press INPUT button and select USB

Supported File Formats	MIDI, MPEG1 (*.MPG, *.DAT), DivX (*.AVI), XviD (*.AVI), MP3, WMA, JPEG (*.JPG)
Supported File System	FAT32 System only
Supported Devices	USB Memory 2.0 or USB Memory 1.1 USB HDD
<p>USB HDD must be connected to an auxiliary power source for proper operation. Turn on the HDD power before attaching it to the unit and must pull out the HDD first before turning the unit off.</p> <p>Note: - High Resolution Video files may not be played properly on this unit. - Some MP3 Players may not operate depending on their file system - Unit may not support some types or brands of USB Memory - Do not pull out USB device when in playback - Unit may not recognize USB device when using USB extension cable</p>	

Connecting with I.R. Input

User can connect extension Infrared sensor using 3.5mm jack.

Connecting with DC 5V Input

User can connect manufacturer approved devices that requires DC 5V power supply on this socket.

Basic Karaoke Operation

Power

Switches the unit on and off.

Play

Search or select desired song then press PLAY or ENTER button

Pause

Use this function to momentarily pause current song playing.

Reserve

Select desired song or input its song number then press RESERVE to queue the song

1ST Reserve

This function reserves the selected song on top of the queue.

Cancel

Press CANCEL button to cancel previously reserved song, by inputting the song number and pressing CANCEL.

Stop

Press STOP button to stop current song playing

Microphone Volume Control

Mic Volume on the remote controls the volume level of the microphone.

Echo Control

Mic Echo on the remote controls the echo level of the microphone.

9

Basic Karaoke Operation

Key

Song Pitch can be adjusted higher or lower by KEY button.

Tempo

Song Speed can be adjusted faster or slower by TEMPO button.

Volume

Overall Music Volume can be adjusted louder or quieter by VOLUME button.

Arrow Keys

This keys is used to navigate song searching and other functions.

Repeat

The mode includes One Song, Repeat One, Repeat All, Random playback.

- One Song: this is the system's default mode; this mode plays only a selected song.
- Repeat One: it enables to play selected song repeatedly.
- Repeat All: it enables to play next songs subsequently by song numbers after playing selected song.
- Random: it enables to play in randomized order.

Male/Female (M/F)

This function sets the music tone to MALE or FEMALE pitch.

Melody

This controls loudness of melody.

Vocal

This turns the Song Vocals on and off.

Numeric/Alphabet Buttons

These buttons are used to input song numbers, and also for typing in title/singer names in song search window.

Search

Using this function will bring up the SONG SEARCH Window. In this window, user can view songs contained in the unit.

- Songs can be viewed by Country, Type, by Title, and by Singer.
- New Songs can also be viewed separately.
- Recorded Songs can be viewed by pressing REC. LIST.
- RANKING show list of song most sung or played.

BGV

By pressing this button, user can change the Background Video of the unit.

EQ

This changes the pre-set EQ sounds.

Mute

This temporarily turns off and on volume output of the unit.

Special Operation

Aux

This enables the unit to switch from KARAOKE mode to AUX mode.
User can connect their phone using 3.5mm jack to the unit to play songs.

Record

User can record their song and vocals by using this function.

- Select a song number, then press RECORD button.
- User may stop recording at any time by pressing the STOP button.
- User may view and play their Recorded Song by accessing it thru the REC. LIST

USB Media Playback

Press INPUT button and select USB to go to Media Player

10

Karaoke Setup

Score Check

Off: Turns the score function off.
Random: The system will randomly give score.
Mic Input: The system will check for microphone input to generate score.

Minimum Score

Toggles low, middle and high settings

Score Display Time

Toggles score display time from 2, 4 or 6 seconds

Fanfare

Off: turns off the score sound
On: turns on the score sound

Ranking Table

Turns the ranking function on and off.

Background Video

Let's user: select the default BGV
Sexy: turns the SEXY BGV on and off

Greeting Display

OFF: System will not display greetings.
ON: System will display greetings.
EDIT: User can write their personalized greeting in this section.

Lyric Color

Auto: Lyric color changes randomly
User: User can select desired lyric color

Lyrics Basic Color

User can select lyric color from 8 different colors.

Lyrics Marking Color

User can select lyric marking color from 8 different colors.

Lyric Alignment

Left/Right: First lyric line will be displayed from the left side of the screen, and second line on the right side of the screen
Center: Both lyric lines will be displayed at the center of the screen.

Lyric Shadow

Off: lyrics are displayed without shadow
On: lyrics are presented with shadow to help with reading.

Coin Mode

Off: Free Play
Credit Song: Turns Coin mode on
Credit Time: Turns Time mode on

Credit Song

Coin Unit: Can select how many coins needed to credit a song
Coin Credit Song: Can select how many songs are credited equivalent to number of coin

Credit Time

Coin Unit: This is set at 1 coin.
Coin Credit Time: Can select how much time is credited for 1 coin; 3.5,10,15 minutes to 1,2,3,4 hours

Password Change

User can change the Setup default password to their desire.
Default password is 0000 (zero, zero, zero, zero).

11

Trouble Shooting

Before requesting service for this unit, check the chart below for a possible cause of the problem you are experiencing. Some simple checks or a minor adjustment on your part may eliminate the problem and restore proper operation.

Symptom	Action
No power	•Insert the AC power plug securely into the power outlet.
No picture	•Ensure that the equipment is connected properly.
No Sound Distorted Sound	• Ensure that the input setting for the TV is "Video". • Ensure that the equipment is connected properly. • Ensure that the input settings for the TV and stereo system are correct.
Picture is distorted during rapid advance or rapid reverse.	• The picture will be somewhat distorted at times: this is normal.
No operations can be performed with the remote control.	• The picture will be somewhat distorted at times: • Check the batteries are installed with the correct polarities (+ and -) • The batteries are depleted. Replace them with new ones. • Point the remote control at the remote control sensor and operate. • Operate the remote control unit at a distance of not more than 7 meters from the remote control sensor. • Remove obstacles between the remote control and remote control sensor.
No key operation (by the unit and/or the remote control) is effective.	• Set the POWER button to OFF and then back to ON. Alternatively, Turn off the power, disconnect the power plug and then reconnect it. (The player may not be operating properly due to lightning, static electricity or some other external factor.)

When Cleaning



- Do not try to open the unit to clean the inside by your self; this type of servicing may only be done by authorized service personnel.
- Don't use water, kerosene, paint thinner, benzene to clean the exterior of the unit.
- The unit is recommended to be cleaned internally every year; this may be done in authorized service centers.
- Dirt and debris may accumulate inside the unit over time, and this may cause malfunction, and maybe even fire.
- When cleaning the exterior of the unit, turn it off and unplug it from the power source to avoid electrocution, shock or injury.

12

Features and Specification

FEATURES	Multiple Background Videos On Screen Song Search AUX 5.1 Audio Channel Support Intelligent Scoring Recording Function Supports Music and Video Playback via USB Interface Thousands of English and OPM Karaoke Songs
INTERFACE	Micro SD Card Slot USB 2.0 Slot Digital Video Output 2 Wired Microphone Input Jacks Infrared Remote Sensor I.R. Extension Jack Composite Video Out RCA Audio Out 5.1 Surround Out Coin-in Jack Score-in Jack
STORAGE	Micro SD Card
POWER	100-240V ~ 0.4A Max 50/60Hz 5V --- 2A 10 watts

This device complies with Part 15 of the FCC Rules. Operation is subject to the following two conditions: (1) this device may not cause harmful interference, and (2) this device must accept any interference received, including interference that may cause undesired operation.

NOTE: This equipment has been tested and found to comply with the limits for a Class B digital device, pursuant to Part 15 of the FCC Rules. These limits are designed to provide reasonable protection against harmful interference in a residential installation. This equipment generates, uses and can radiate radio frequency energy and, if not installed and used in accordance with the instructions, may cause harmful interference to radio communications. However, there is no guarantee that interference will not occur in a particular installation.

If this equipment does cause harmful interference to radio or television reception, which can be determined by turning the equipment off and on, the user is encouraged to try to correct the interference by one or more of the following measures:
— Reorient or relocate the receiving antenna.
— Increase the separation between the equipment and receiver.
— Connect the equipment into an outlet on a circuit different from that to which the receiver is connected.
— Consult the dealer or an experienced radio/TV technician for help.

Warning: changes or modifications not expressly approved by the party responsible for compliance could void the user's authority to operate the equipment.

13