



User Manual

DOG HOUSE HEATER



Download and Install APP

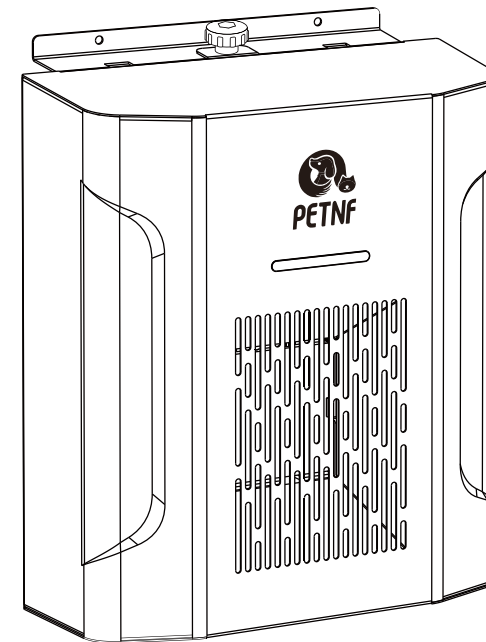

- Please read this manual carefully before use.
- The company reserves the right to interpret the instructions.
- The appearance of the product is subject to the actual product.



Warning:

In order to prevent the occurrence of danger, please make sure that the heater is not covered by other objects when using.

In order to serve you better, please read this manual carefully before use and keep it properly for future maintenance.

It is normal for the peculiar smell to start up for the first time, and it will volatilize within a few minutes after starting up. Please feel free to use it.

*This Dog House Heater can ONLY be used with the voltage specified on the heater's nameplate(120V~60HZ).

*DO NOT alter the heater or cord in any way. This greatly increases your risk of fire and voids all warranty.

*When installing, placing, and using the electric heater, please DO NOT cover the air outlet and inlet of the electric heater, and ensure that the flammable materials are more than 1 meter away from the electric heater to avoid the electric heater from overheating and causing a fire.

*Please DO NOT place the electric heater close to other heat sources.

*Please DO NOT use this electric heater in the following places: near natural gas or gas pipelines, near the use and storage of paint or other flammable liquids.

*In order to avoid burns during or after use of this heater, please DO NOT let your bare skin touch it; if you need to move it, please turn it off and wait for its surface to cool down.

*Please DO NOT cover the heater with clothing or other items.

*Please DO NOT put any foreign objects or metal objects into the air inlet or outlet of the dog house heater, as this may cause electric shock, fire, or damage to the heater.

*Please DO NOT immerse the heater in water or let water enter the inside of the electric heater, which may cause electric shock.

*If the heater fails, please contact us in time or send it to a qualified service station.

*Please DO NOT touch the electric heater when your hands are wet.

*The most common cause of overheating of the electric heater is the accumulation of dust or fluff. Please make sure to clean the electric heater regularly when it is not powered on.

*Please do not install electric heaters next to windows with curtains to prevent electric shock or fire.

*Please DO NOT use frosted materials to clean the electric heater. The electric heater can be cleaned with a cloth soaked in hot soapy water and wrung out. Before cleaning the heater, make sure that the heater is POWER OFF.

*Please DO NOT switch on the power supply before the heater is fully installed or adjusted.

1. Download the App



Please download "PetNF Smart" from App Store, Google Play or our website (www.petnf.com/mobile-app). You can also scan the QR to download the App.

www.petnf.com/mobile-app

2. Add the device

Please follow the APP prompts to connect the PetNF Dog House Heater. If it fails, please long press the ⏻ button for 5S until the 📶 flashes and try to reconnect again.

3.App operation

**After the device is connected successfully,
all functions can be controlled and set through the App.**

VOICE CONTROL: Amazon Alexa

1. Add device in the "PetNF Smart" App and keep it online.
2. Login your Amazon account in "Amazon Alexa" App.
3. Open the "PetNF SMART" APP, switch to the "My" page, and click the "Alexa" link.
4. Click "Sign in with Amazon" and then follow the instruction to link the skill.
5. Then you can control the device through Amazon Alexa.

VOICE CONTROL: Google Assistant

1. Log in your Google account in Google Home.
2. Open the "PetNF SMART" APP, switch to the "My" page, and click the "Google Assistant" link.
3. Click "Link with Google Assistant" and it will take you to an authorization page. Click "Agree and link".
4. Now you can control the device through Google Home.

Operation Guide

After power on, the buzzer will sound once and enter the standby state to display the ambient temperature, and display.

1. Power button "⏻"

- 1) In standby mode, press the power button "⏻" (quick response) to enter the working state, the digital screen shows the ambient temperature.
- 2) In the working state, press the power button "⏻" (response after release) and then enter the shutdown state.

2. Temperature adjustment key "⬆" "⬇" "⬆" "⬇"

- 1) Press "⬆" or "⬇" in normal operation, the set temperature will be displayed and flashing, and the temperature unit symbol °C or °F will light up, and enter the temperature setting mode. At this time, the temperature setting can be adjusted by pressing the key "⬆" or "⬇". The temperature is set cyclically within the range of 5°C-45°C, and after three seconds of no operation, confirm and exit the temperature adjustment mode to display the ambient temperature.

When the set temperature is 2°C higher than the ambient temperature, the product starts to heat and the heating symbol 2 lights up. When the temperature is lower than the ambient temperature, the product stops heating, and the heating symbol 2 goes out. Set temperature with power-down memory function;

- 2) Long press "⬆" for three seconds to enter the °C / °F icon switch, and the ambient temperature value switch.

- 3) In the working state, long press "⬇" for three seconds to enter the timer shutdown mode, the icons ⬆ and ⬇ flash (do not affect the display of other icons), and the temperature adjustment key "⬆" or "⬇" 0H-24H cycle increases and decreases the adjustment time. After three seconds of inactivity, it will automatically confirm and return to the environment display window.

3. Combination key "⬆" "⬇"

Press "⬆" "⬇" at the same time to turn on or cancel the child lock in working condition.

WiFi function (without WiFi version does not have this function)

Press "⏻" for five seconds to reset the WiFi, the WiFi symbol is always on when the WiFi connection is successful, and it flashes when it is not connected.

Note:

E1: The product host is not well connected to the controller

E3: The product has a short-circuit fault

*This dog house heater is not suitable for use in exposed outdoor or humid places.

*Please DO NOT use next to bathtubs, showers, swimming pools or other liquids.

*Fix the electric heater on the wall or install it in the correct position, also keep the heater upright.

*Please DO NOT wind up the power cord during use to avoid heat build-up in the power cord, which may cause danger.

*The power extension cord is not recommended for this electric heater.

*Please make sure to cut off the power supply when the heater is not in use.

*Please keep the power cord and fixed cables away from the high temperature surface of the heater.

*Please DO NOT wrap the power cord somewhere or twist the power cord into a bundle, which may cause the insulator of the power cord to weaken or fail. Please make sure that the power cord does not come into contact with any sharp objects.

*Please DO NOT store the heater without cooling.

*Please DO NOT install the electric heater under the electrical outlet.

*To avoid the possibility of electric shock or fire, please ensure that the power cord and electric heater are not exposed or immersed in rain or any other liquid.

*Please use the heater in accordance with these instructions. To avoid causing fire, electric shock or injury, do not use other manufacturer's product instructions for use with this dog house heater.

*Warning: Changes or modifications to this unit not expressly approved by the party responsible for compliance could void the user's authority to operate the equipment.

*This device complies with Part 15 of the FCC Rules. Operation is subject to the following two conditions: (1) this device may not cause harmful interference, and (2) this device must accept any interference received, including interference that may cause undesired operation.

*Shielded cables must be used with this unit to ensure compliance with the Class B FCC limits.

*Note: This equipment has been tested and found to comply with the limits for a Class B digital device, pursuant to part 15 of the FCC Rules. These limits are designed to provide reasonable protection against harmful interference in a residential installation. This equipment generates, uses and can radiate radio frequency energy and, if not installed and used in accordance with the instructions, may cause harmful interference to radio communications. However, there is no guarantee that interference will not occur in a particular installation. If this equipment does cause harmful interference to radio or television reception, which can be determined by turning the equipment off and on, the user is encouraged to try to correct the interference by one or more of the following measures:

- Reorient or relocate the receiving antenna.
- Increase the separation between the equipment and receiver.
- Connect the equipment into an outlet on a circuit different from that to which the receiver is connected.
- Consult the dealer or an experienced radio/TV technician for help.

*To maintain compliance with FCC's RF exposure guidelines, the distance must be at least 20cm between the radiator and your body, and fully supported by the operating and installation configurations of the transmitter and its antenna(s).

Product List

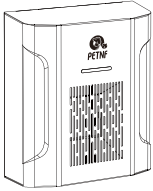
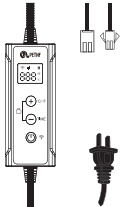
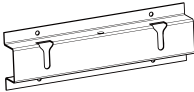
		
Safety bolt	Screws	

Product Specifications

Model Number: PF2021006	Rated Power:300W
Rated Voltage:120V/60Hz	Product Dimensions: 9.1*10.3*5 in 230*261*128mm

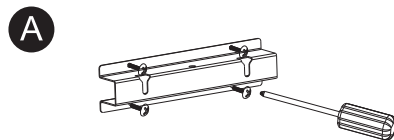
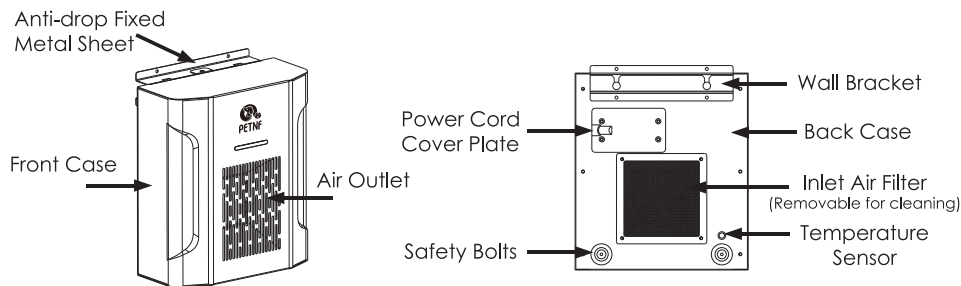

A: First, use the screws in the accessory bag to fix the pegboard parallel to the pre-installed position of the equipment. It is recommended that the optimal height for installation is greater than the height of the pet.

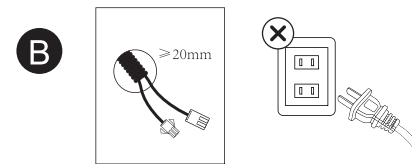

B: Choose a best position on the wall (near the end of the power cord) and drill a 20mm diameter round hole (whether to drill according to actual needs). Do not connect the power first.

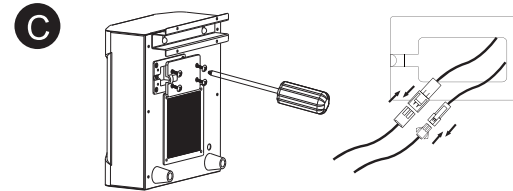

C: The junction box surface screws using a cross screwdriver counterclockwise twist out, unplug the internal connector, and then the connector from the wall into the interior, plug the connector into the power cord into the pressure slot, close the cover locking screws.

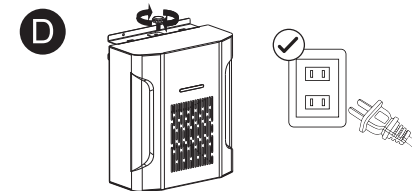

D: Hang the equipment according to the corresponding holes, and tighten the safety bolts clockwise. Hang the controller in a suitable place (the waterproof level of the controller reaches IP44, try to avoid long-term use in rain). The heating device can be used normally after the power is turned on.

Product Features

Heating	Shutdown Timer
Temperature Adjustment	Smart Wifi Function (optional)

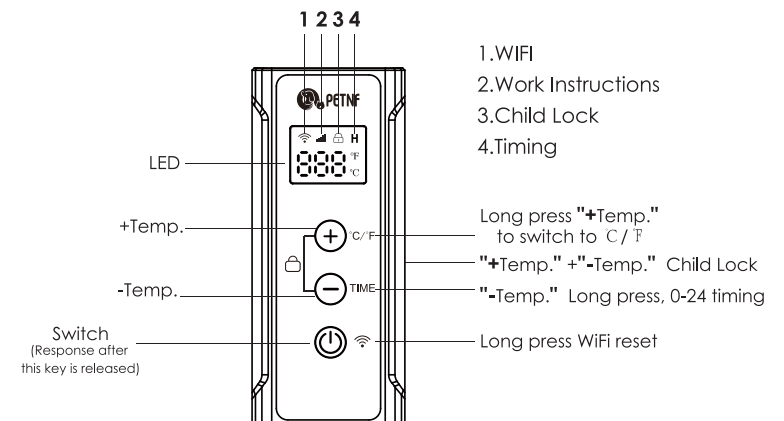

This device complies with part 15 of the FCC Rules. Operation is subject to the following two conditions: (1) this device may not cause harmful interference, and (2) this device must accept any interference received, including interference that may cause undesired operation.

Any changes or modifications not expressly approved by the party responsible for compliance could void the user's authority to operate the equipment.

NOTE: This equipment has been tested and found to comply with the limits for a Class B digital device, pursuant to Part 15 of the FCC Rules. These limits are designed to provide reasonable protection against harmful interference in a residential installation. This equipment generates, uses and can radiate radio frequency energy and, if not installed and used in accordance with the instructions, may cause harmful interference to radio communications. However, there is no guarantee that interference will not occur in a particular installation.

If this equipment does cause harmful interference to radio or television reception, which can be determined by turning the equipment off and on, the user is encouraged to try to correct the interference by one or more of the following measures:

- Reorient or relocate the receiving antenna.
- Increase the separation between the equipment and receiver.
- Connect the equipment into an outlet on a circuit different from that to which the receiver is connected.
- Consult the dealer or an experienced radio/TV technician for help.

The device has been evaluated to meet general RF exposure requirement. The device can be used in portable exposure condition without restriction