

# WIFI smart remote control heater



Instant Warmth, Effortless Comfort.  
Your Electric Heater.

Please read this instruction manual carefully before use



## IMPORTANT INSTRUCTIONS

**When using electrical appliances, basic precautions should always be followed to reduce the risk of fire, electric shock, injury to persons, and hyperthermia, including the following:**

- ❗ Children under 3 years of age must not be left near the appliance without supervision.
- ❗ Children between 3 and 8 years old may only switch the appliance on and off, providing it is placed or installed in its normal operating position and they are supervised, or have been instructed in using the appliance safely and understand the hazards.
- ❗ Children must not play with the appliance.
- ❗ Cleaning and user maintenance must not be carried out by children unless supervised. The appliance may be used by children over 8 years of age and persons with reduced physical, sensory or mental capabilities, or lacking experience or knowledge, providing they are supervised, or have received instruction in safe use of the appliance and understand the hazards.
- ❗ The appliance must not be placed directly beneath a power socket. Do not use the appliance in rooms containing a bath, shower, swimming pool, or close to basins or water couplings, when it is not approved for this purpose.
- ❗ This heater is hot when in use. To avoid burns, do not let bare skin touch hot surfaces. If provided, use handles when moving this heater. Keep combustible materials, such as furniture, pillows, bedding, papers, clothes, and curtains at least 3 feet (0.9m) from the front of the heater and keep them away from the sides and rear.
- ❗ Do not insert or allow foreign objects to enter any ventilation or exhaust opening as this may cause an electric shock or fire, or damage the heater.
- ❗ To prevent a possible fire, do not block air intakes or exhaust in any manner. Do not use on soft surfaces, like a bed, where openings may become blocked.



## THE FOLLOWING BEHAVIORS ARE PROHIBITED

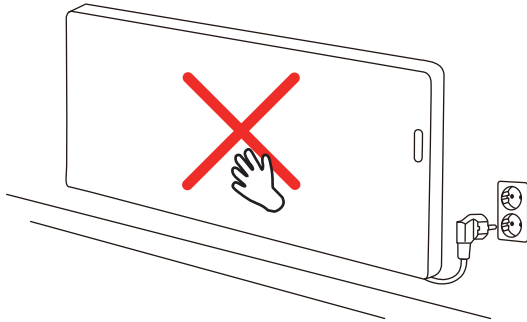

While the heater is working, Do not touch the surface of the heater

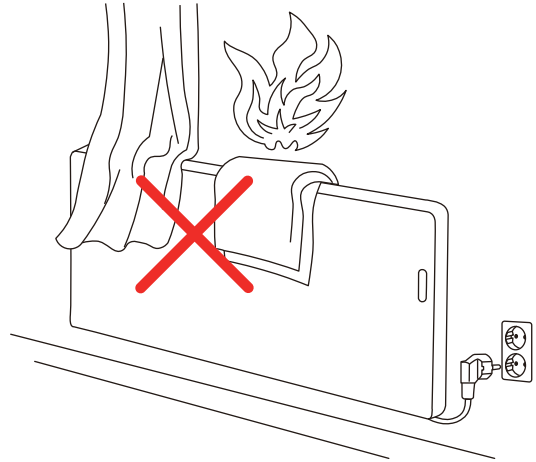

The heat sink is strictly prohibited from hanging objects, Such as clothes, towels, etc

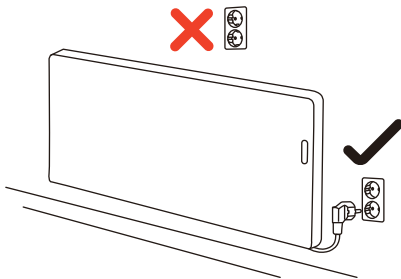

The socket should not be placed above the heater



Do not use in humid environment

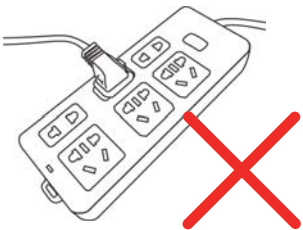

Do not use power strips or extension cords to avoid plug damage caused by excessive power.

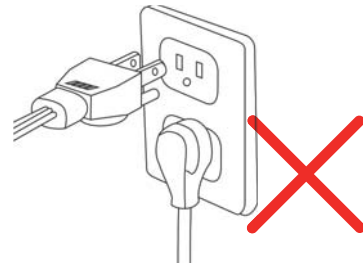

Overload electrical circuits: Avoid plugging in multiple high-powered devices on the same circuit.

## PRODUCT INSTALLATION

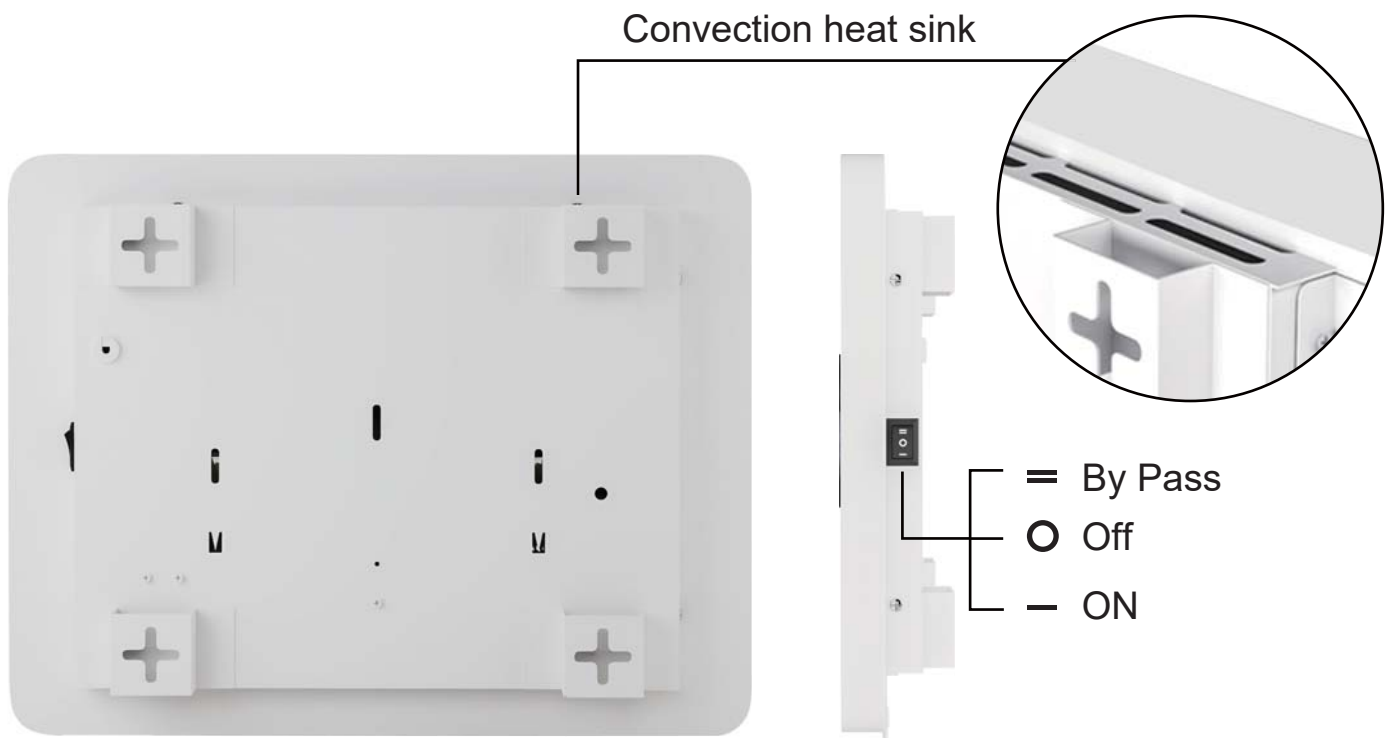
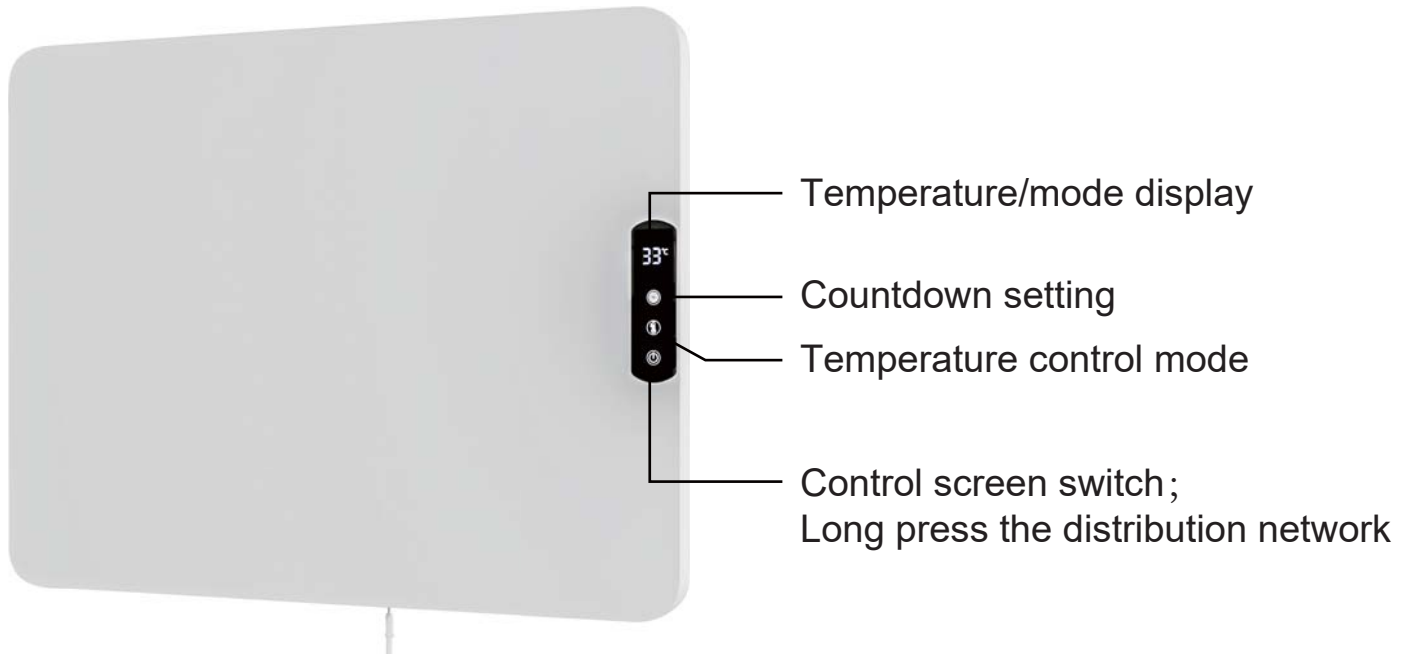



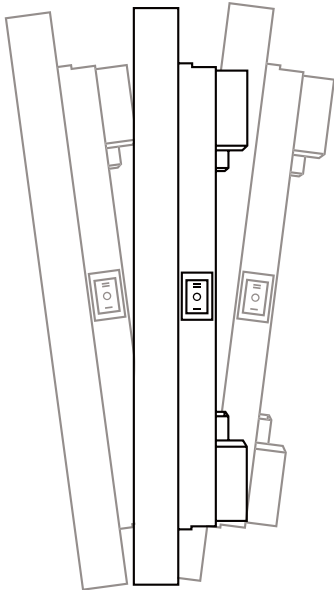

## Power-off design for tilting

Automatic power-off protection in case of toppling or overheating ensures efficient heating while also emphasizing safety protection, allowing you and your family to enjoy worry-free heating.

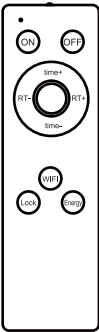

## Packaging accessories

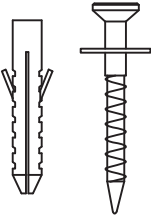
			
Heater	Remote control	Instruction Manual	Plug & Screw

## The description of the temperature controller display

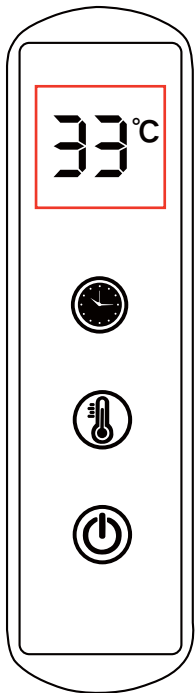

CF – Comfort Mode	33°C – Working temperature °C
EC – ECO mode	33°F – Working temperature °F
PC – Program-controlled mode	CL – Child Lock
bt – BOOST Fast mode	30 – Fast mode time 30、60、90min
OP – The window mode is enabled	OF – Open the window for detection and close
AN – Frost-proof activation	AF – Frost-proof off
IH – Countdown time	

## How is the equipment connected to the network

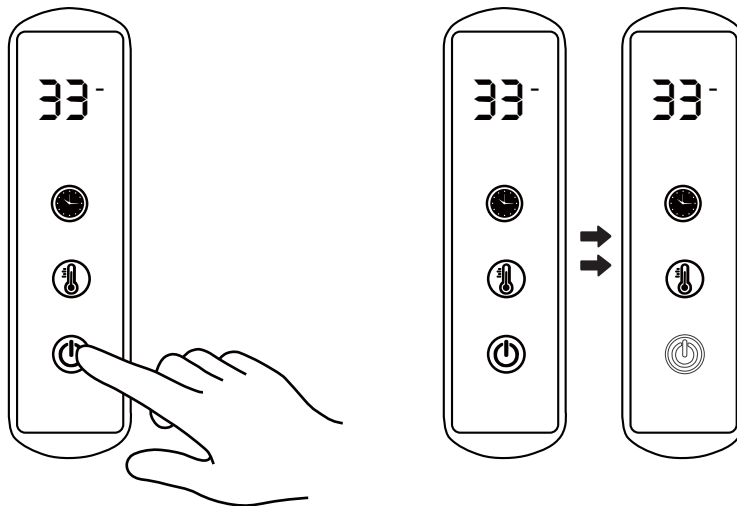

wifi Distribution & Reset: Press and hold the power button on the power-on status control panel to reset the wifi distribution. The wifi indicator light uses the slow flashing of the power button to indicate. For devices that have not been networked, the power button will flash slowly for 3 minutes each time they are turned on and enter the standby network configuration state. If there is no network configuration after 3 minutes, the power button will remain on constantly. For devices that have been successfully networked, the power button light will remain on constantly.



## Anti-frost function

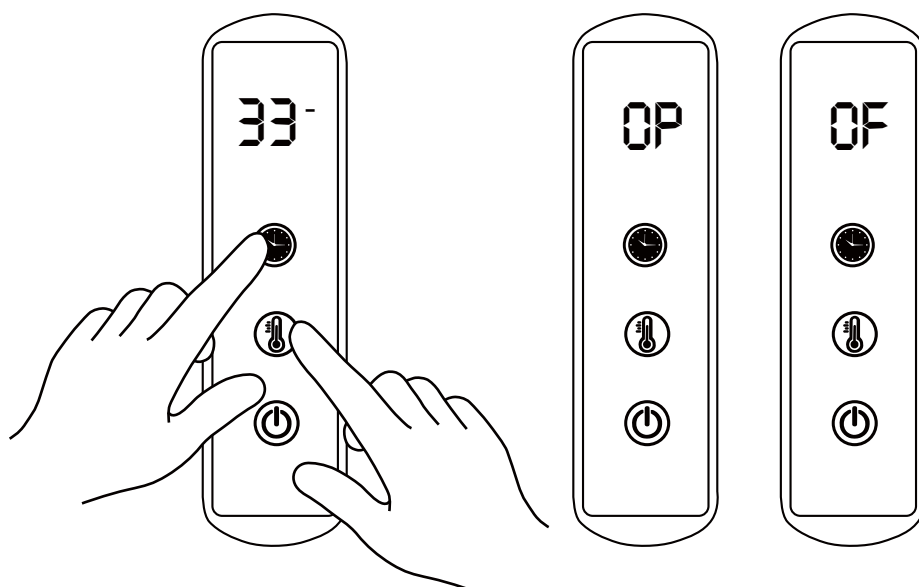

Window opening inspection: Press and hold the clock and temperature keys to turn on/off the window opening detection



## Child lock function

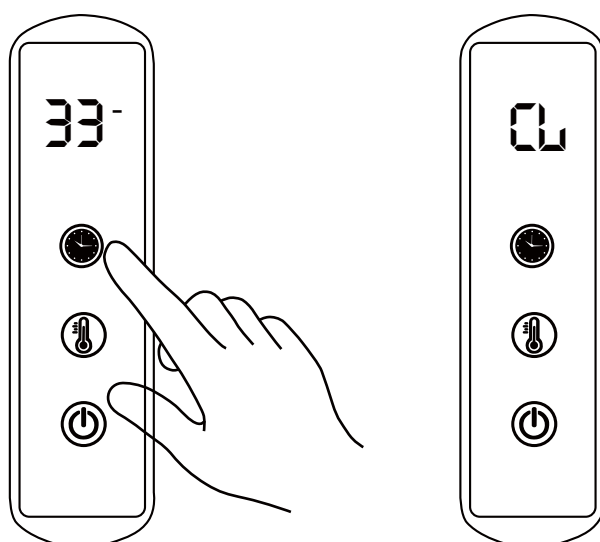

Child lock function: Press and hold the clock key on the control panel for 3 seconds simultaneously to open or close the child lock. After opening, there is no response when operating the touch panel or remote control, and the digital screen displays "CL".

## Analysis of Remote Control Functions

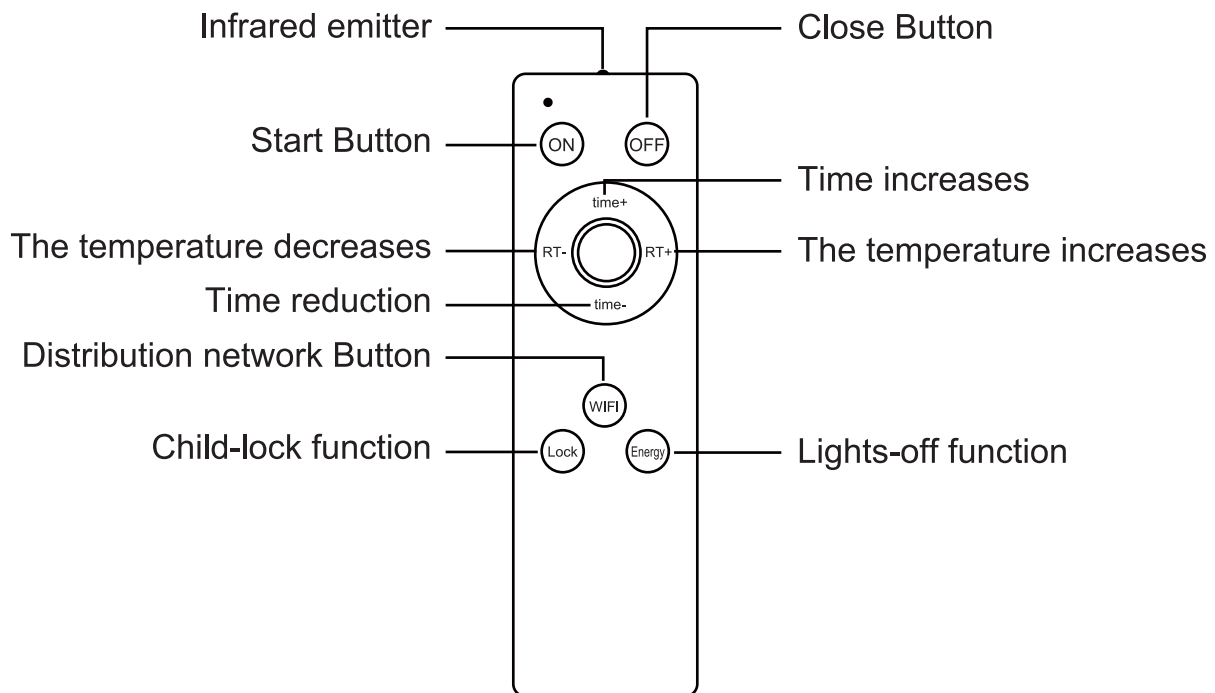

## Mode Specification

PC= Program control mode bt= boost Mode EC= ECO Mode CF=Comfort Mode CL= Child lock

## Function description of the heater

**Program control mode:** Press and hold the circular middle button on the remote control for 3 seconds to switch gears, then press the temperature adjustment button to adjust the value to High/Middle/Low. After switching gears, it will flash 4 times without any operation and return to normal display.

**BT fast mode:** Press the clock key remote control timing plus or minus key to switch 30/60/90 minutes, the three working time are 100% full power heating, ignoring the temperature setting, after the minute timing ends, it will automatically switch to comfort mode to continue running;

**Temperature calibration:** Setting range: -9 degrees ~ 9 degrees. In standby mode, press and hold the temperature button for 5 seconds to enter the temperature compensation setting. After entering, if there is no operation for 5 seconds, the current parameters will be automatically confirmed and the standby mode will be restored after exiting.



**Lights-off function:** You can turn off the digital screen and button lights. Press and hold the Energy button on the remote control for 3 seconds to enter the lights-off state (only the power button is on). Next time, press the button on the touch panel or press the power button on the remote control to light up everything.

**Child lock function:** Press and hold the clock and temperature buttons on the control panel for 3 seconds at the same time to turn on the child lock. After turning it on, the touch panel and remote control will not respond, and the digital screen will display CL.

**Celsius Fahrenheit temperature switching:** Control panel switching operation: In standby mode, long press the clock button to switch between Fahrenheit display and Celsius display. After entering, the °C icon or °F icon will be displayed. Press the temperature button to switch. If there is no operation, it will flash 4 times to automatically confirm and resume standby mode.

**Restore factory settings** In the app, click Restore factory settings or long press the clock button to restore factory settings: After the factory settings are restored, the default setting for comfort mode is 22°C and the timer is always on for 0 hours;

## Function description of the heater

**Wi-Fi network configuration & reset:** Press and hold the Wi-Fi button on the remote control for 3 seconds to reset Wi-Fi network configuration. Press and hold the power button on the control panel in the boot state to reset Wi-Fi network configuration; the power indicator light flashes slowly with the power button. If the device is not configured, the power button flashes slowly for 3 minutes each time it is turned on to enter the network configuration state. After 3 minutes, if there is no network configuration, the power button will be on normally. If the device is successfully configured, the power button light will be on normally.

Window opening mode use OP represents, anti-freeze mode is represented by AF: In standby mode, long press the clock and temperature keys to enter the background setting, OP flashes slowly, press the clock key to switch OP/AF, press the temperature key to confirm to enter this setting, select the switch on for on and oF for off, press the temperature key to switch the switch, after no operation, flash 4 times to automatically confirm the current setting and restore to standby mode;



## Download the SMART LIFE APP

Download the Smart Life app from the App Store or Google Play. Open the app and create a new account with email.



Available on the  
**App Store**



GET IT ON  
**Google Play**

1. Once connect successfully, the will be light up.
2. When you fail to connect, The power indicator light will flash or disappear .  
Please check your phone is that already connected to 2.4 GHz WiFi and Bluetooth.  
If yes, please close and reset program and proceed to the first step to reconnect.



## How to connect SMART LIFE

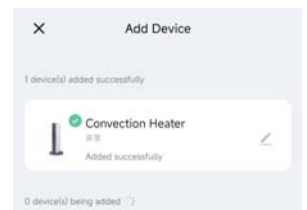
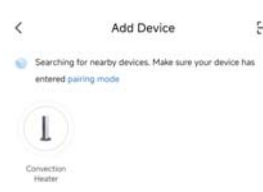
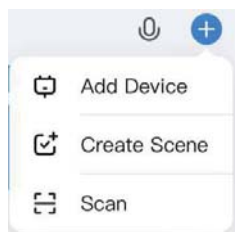

Connect your  
phone To 2.4  
GHz Wi-Fi

Tap the“+”  
button on the  
right upper corner  
and then tap  
“Add Device

Wait for the  
device to be  
searched, then  
tap the “Add”  
button

Confirm wifi  
information,  
successfully  
connected



## How to connect Alexa

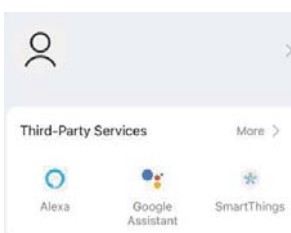

Find "Third- Party Services" in the "Me" section of the SMART LIFE and click on the Alexa icon to be redirected to the Alexa app for linking.

## Reset wifi and programs

With the product linked to power, turn off the control panel screen with the power button. Then press and hold the power button for 5 seconds, the product starts flashing, wait for 15 seconds to complete the reset.

xpslt  
xjui



Amazon, Alexa and all related logos are trademarks of Amazon.com, Inc. or its affiliates.

## APP FUNCTION

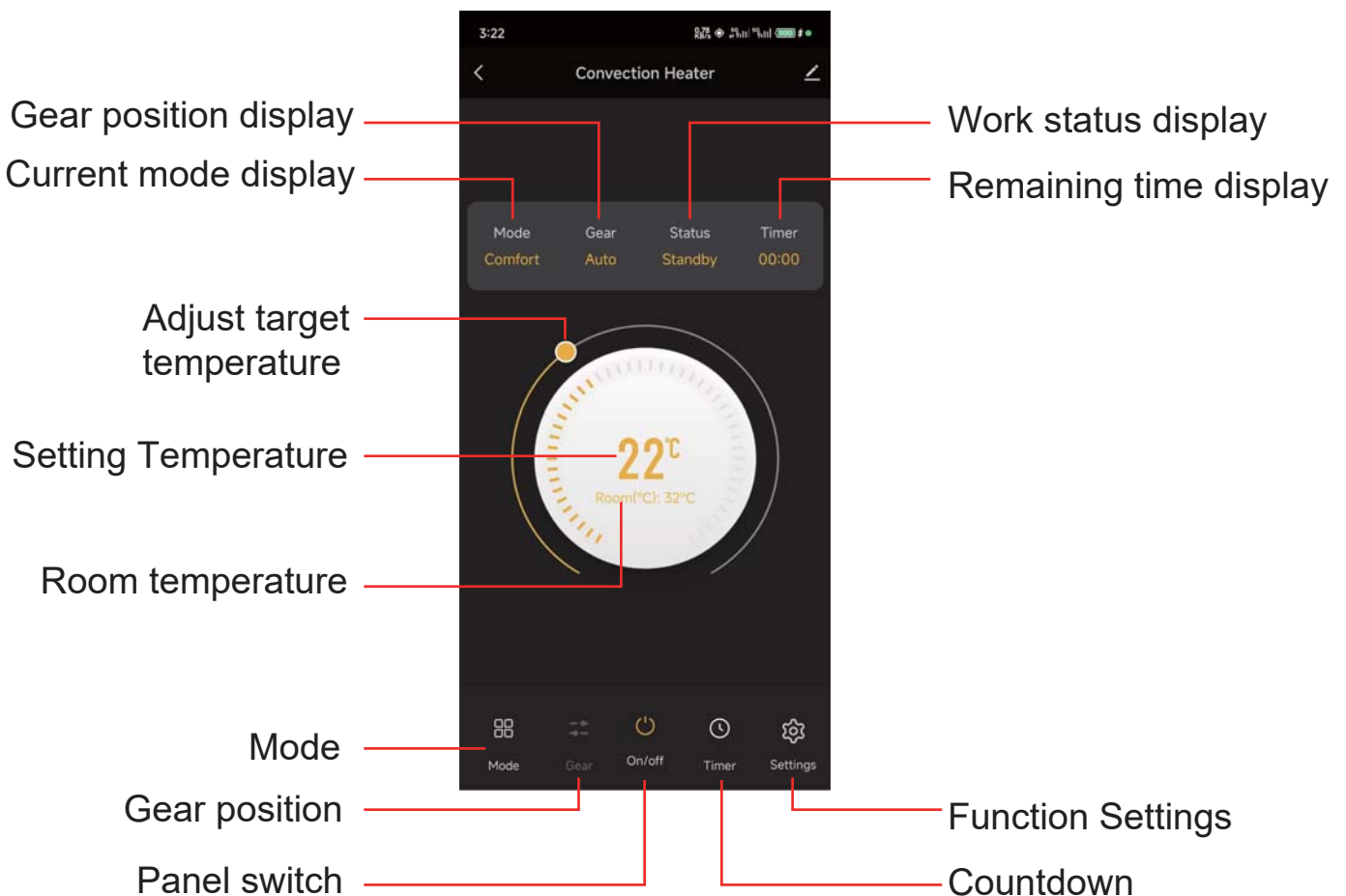

## Power on/off



Tap the on/off button to switch the heater on or off.

## Temperature adjustment



Move the point to adjust the heating temperature

## Heating mode

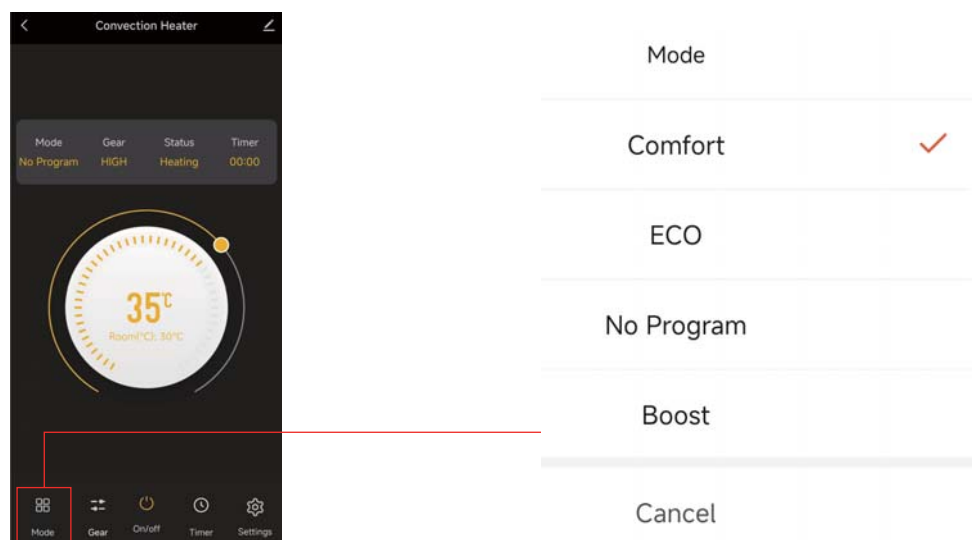

Tap the Mode button to switch between 3 heating modes.



## Analysis of Heating Mode

### Boost mode



- Fast heating with full power and disregard the temperature settings.
- 30-90min later will switch to comfort mode automatically.
- In this mode, setting the cloud timing function will disable the Boost mode.

### Comfort mode



(72°F/22°C)

- The default value is 86°F /30 °C in the first using.

### ECO mode



(63°F/17°C)

- The default value is 77 °F/25 °C in the first using.

Making good use of the three modes can enable you to experience a comfortable temperature in a more energy-efficient way.



## Gear

Gear

---

Auto

---

LOW

---

MED

---

HIGH 

---

Cancel

Four heating Settings are available for your selection.



## Appointment shutdown setting

Timer

18h
19h
20h
21h
22h
23h
24h

Cancel

Tap the shutdown button to select 0-24h later to turn off time.



## Settings



Turn on/off the Child lock function

Enable the window opening detection function

Activate the anti-frost function

Select the temperature unit

Enable temperature compensation

Set the upper limit of temperature

Set the lower limit of temperature

Cloud timing

factory data reset

## Cloud timing

< Add Schedule Save

08 12

AM 09 13

PM 10 14

Repeat Once >

Note >

Notification ☐

On/off ON >

Set Temperature 5 >

< Schedule

Time variance is  $\pm 30s$

AM 9:24 ☒

Once  
On/off:ON Set Temperature:5

PM 1:21 ☒

Once  
On/off:ON Set Temperature:5

PM 5:25 ☒

Once  
On/off:ON Set Temperature:5

Add Schedule

Long press  
the task to  
delete it

You can create multiple scheduled start/stop tasks again.

## Adjusting your Room size

You can adjust the heating algorithm of the heater based on the size of the room or your location to make it closer to the actual temperature.

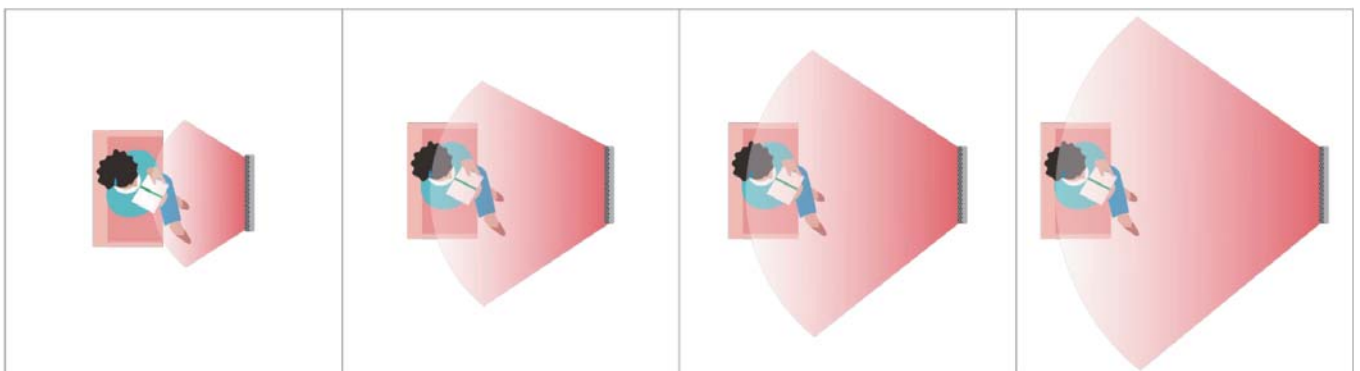

**Small**  
Algorithm reduces  
by 0°F (0°C)

**Medium**  
Algorithm reduces  
by 4°F (2°C)

**Large(Default)**  
Algorithm reduces  
by 8°F (4°C)

**Extra large**  
Algorithm reduces  
by 12°F (6°C)

## Accessories introduction



Screws and plastic expansion pipes



Hole position drawing

## Installation graphics and text

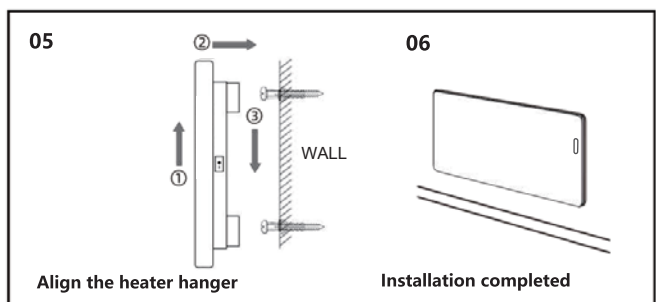
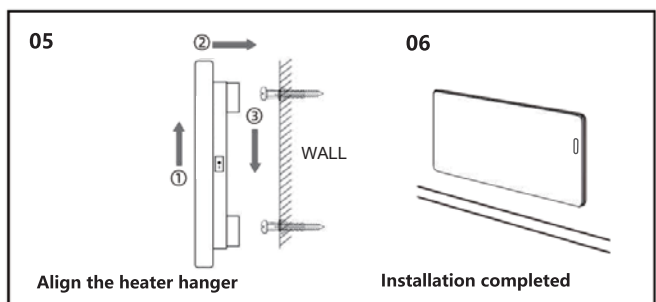
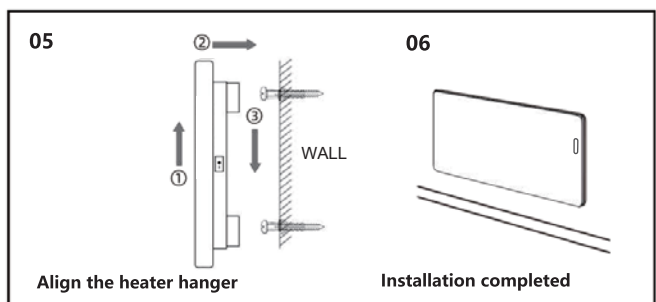
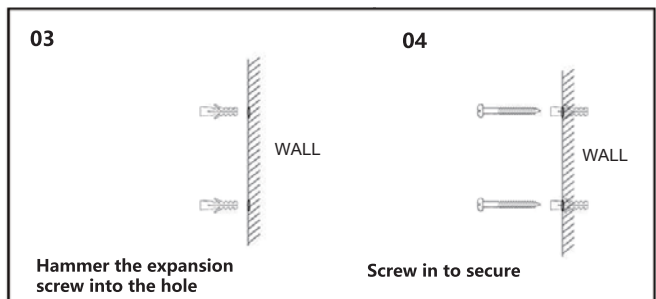
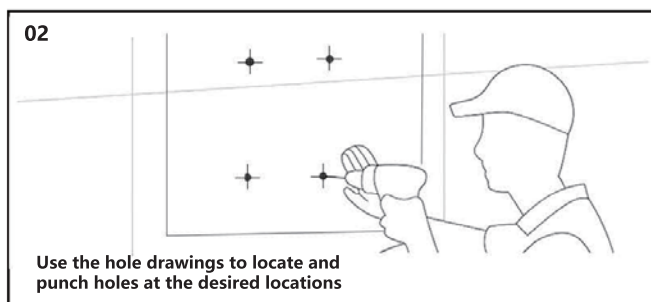
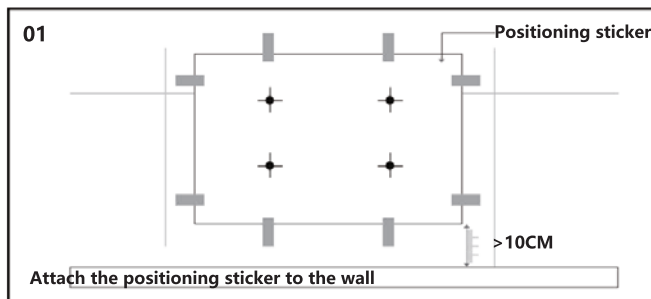

**DONGGUAN RUNHU INTELLIGENT TECHNOLOGY CO.,LTD**

12-3, 2nd Ind. Zone, Changping Park, East Ind. Zone, Shahukou  
Village, Changping Town Dongguan Guangdong China



Note: The remote control of this product is controlled by infrared function

FCC Statement:

This device complies with part 15 of the FCC Rules. Operation is subject to the following two conditions:

- (1) This device may not cause harmful interference, and
- (2) this device must accept any interference received, including interference that may cause undesired operation.

This equipment has been tested and found to comply with the limits for a Class B digital device, pursuant to part 15 of the FCC Rules. These limits are designed to provide reasonable protection against harmful interference in a residential installation. This equipment generates, uses and can radiate radio frequency energy and, if not installed and used in accordance with the instructions, may cause harmful interference to radio communications. However, there is no guarantee that interference will not occur in a particular installation. If this equipment does cause harmful interference to radio or television reception, which can be determined by turning the equipment off and on, the user is encouraged to try to correct the interference by one or more of the following measures:

- Reorient or relocate the receiving antenna.
- Increase the separation between the equipment and receiver.
- Connect the equipment into an outlet on a circuit different from that to which the receiver is connected.
- Consult the dealer or an experienced radio/TV technician for help.

Caution: Any changes or modifications not expressly approved by the party responsible for compliance could void the user's authority to operate the equipment.

This equipment complies with FCC radiation exposure limits set forth for an uncontrolled environment. This transmitter must not be co-located or operating in conjunction with any other antenna or transmitter.

RF exposure warning:

This equipment complies with radiation exposure limits set forth for an uncontrolled environment. This equipment should be installed and operated with Minimum distance 20cm between the radiator and your body.