

# **User Manual**

Wireless Vertical Ergonomic Mouse



Model:IWG-SGM01

## Package includes

- ▶ Wireless Mouse \*1
- ▶ Product Manual \*1
- ▶ Charging Cable \*1
- ▶ 2.4G Receiver \*1

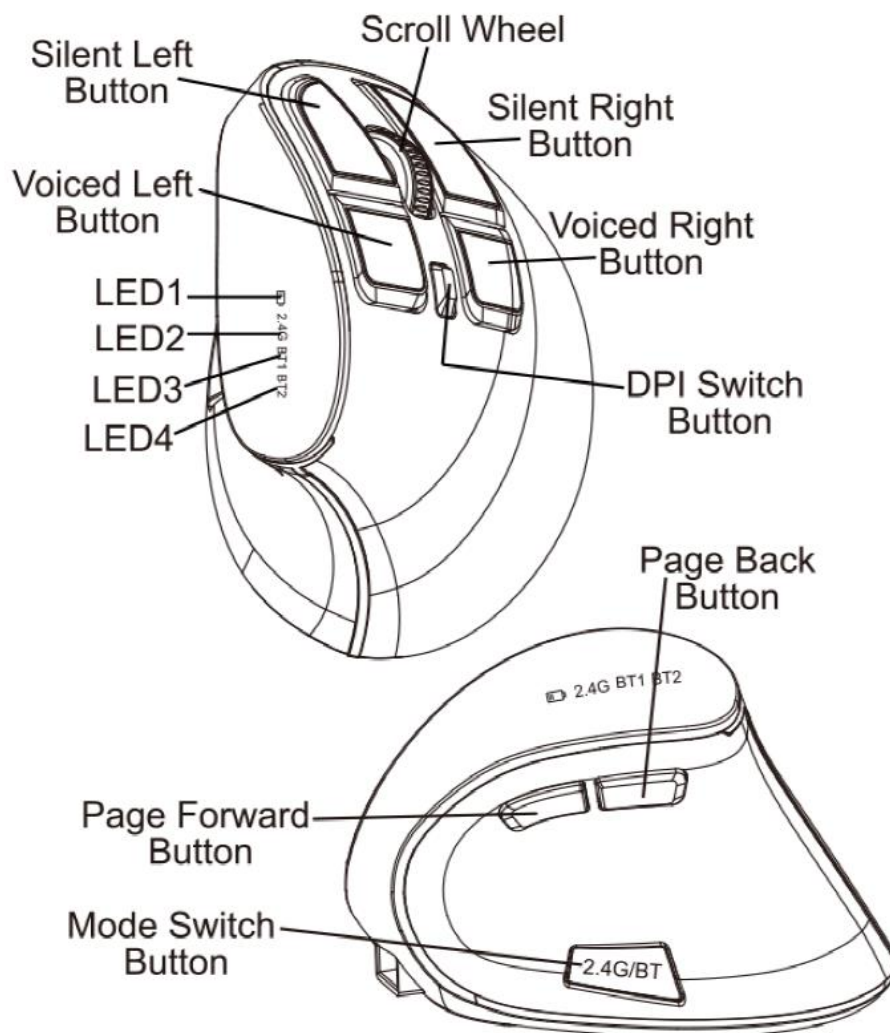

LED1 : Charging/Low Battery Indicator

LED2 : 2.4G Mode Indicator

LED3 : BT1 Mode Indicator

LED4 : BT2 Mode Indicator

**LED Indicator Light:**

Charging: When charging, LED 1 red light will stay on and will turn off after fully charged.

Low Power Indicator: LED 1 red light flashes slowly.

## Product Specifications

DPI: 1000/1600 (default) / 2400

Weight: 120g

Battery Capacity: 500mAh

Working current : 5mA

Working time : 100h

Range: 10m

Sleep Mode: Enters into sleep mode after 30 minutes  
of inactivity

Compatible Systems: Windows XP, Windows 7, Windows 10,  
Mac OS, Android, iPad OS, IOS

**Notice:**

BT 5.0 Mouse can only be used on Windows 8, Windows 10, Mac OS X 10.10, Android 4.3 or higher.

BT 3.0 Mouse and 2.4G are compatible with Windows XP, Windows 7, Windows 10, Mac OS 10.10 or higher.

## 2.4G Wireless Mode Connection

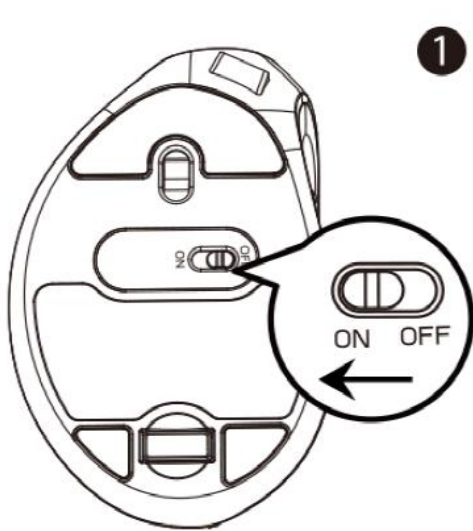

1. Turn on the power switch to "ON".



2. Take out the USB dongle and insert into your computer.

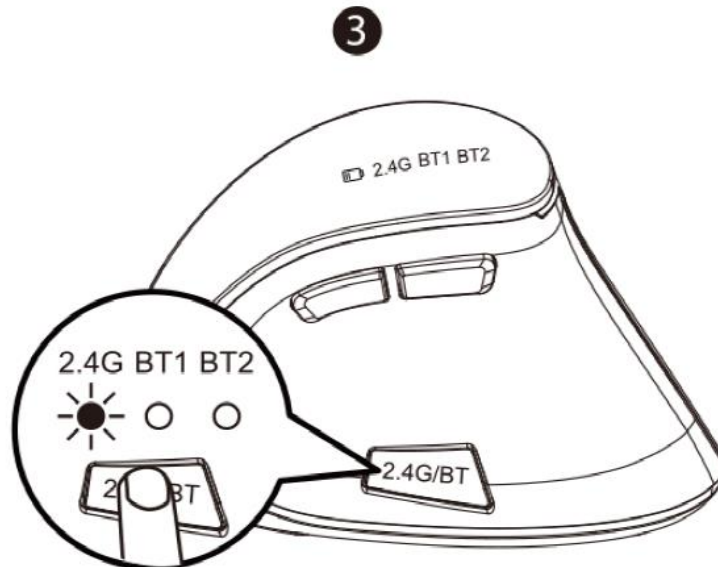

3. Press the switch button to 2.4G, green light on, indicating you have successfully connected to 2.4G mode.

## Bluetooth Mode Pairing Step

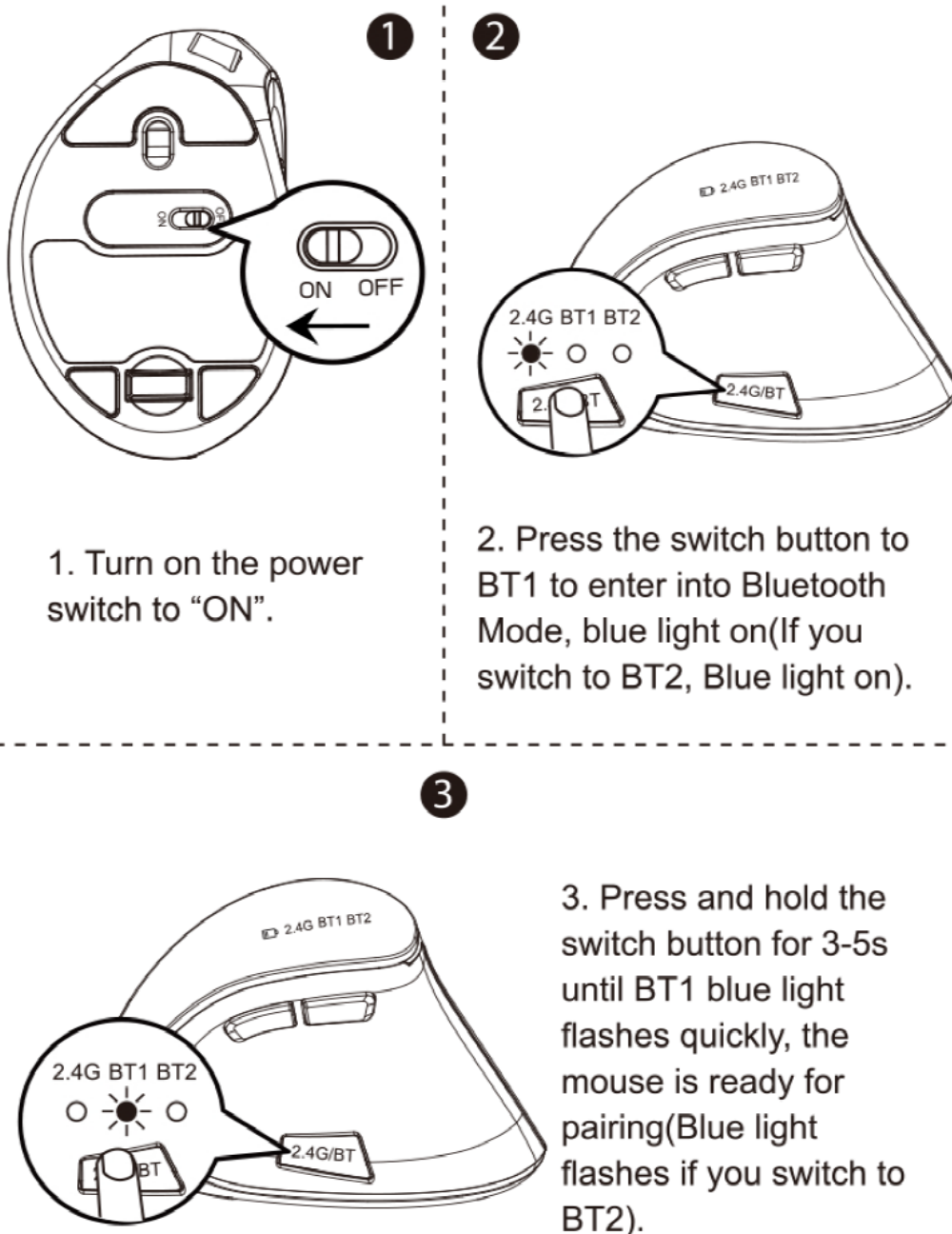

1. Turn on the power switch to "ON".

2. Press the switch button to BT1 to enter into Bluetooth Mode, blue light on (If you switch to BT2, Blue light on).

3. Press and hold the switch button for 3-5s until BT1 blue light flashes quickly, the mouse is ready for pairing (Blue light flashes if you switch to BT2).

when you first switch into Bluetooth mode, if the indicator light flashes quickly, indicating that the mouse has entered into pairing status, waiting to connect.

## iPad/iPhone System

\* Mouse function is only supported on iPadOS 13 / iOS 13 or later.

Please complete the Bluetooth mode pairing step1/2/3 before pairing.

- 4 Turn on bluetooth, click "BT5.0 Mouse". It is recommended to choose BT 5.0 Mouse connection.

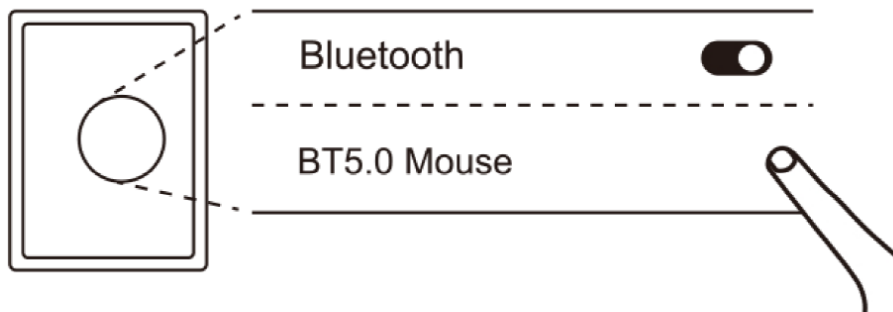

- 5 Click Pair.

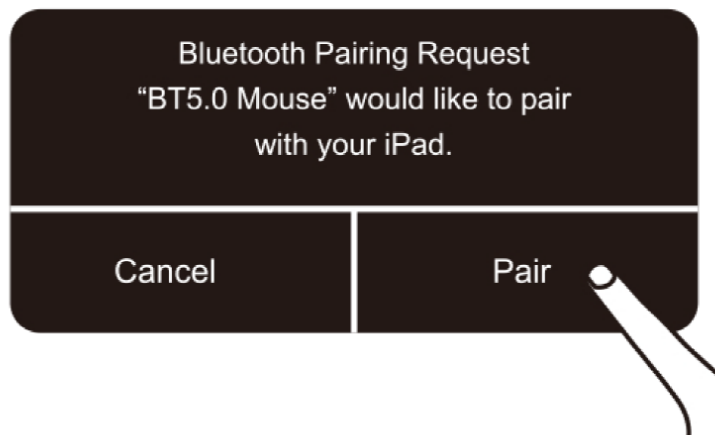

6

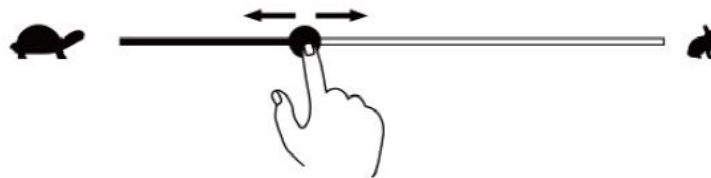
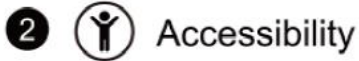

You can adjust mouse sensitive level in iPad's system setting.

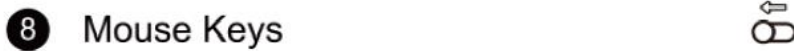
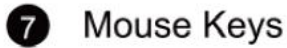

Please make sure the  
Mouse Keys are off.



## Windows 10 System

Please complete the Bluetooth mode pairing step1/2/3 before pairing.

- 4 Click “Bluetooth Device”.

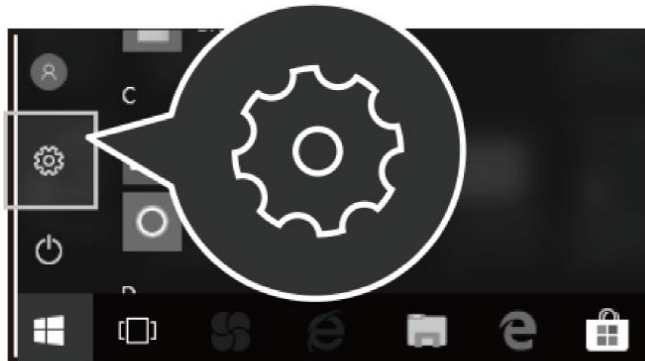

- 5 Click “Add or remove a Bluetooth device”.

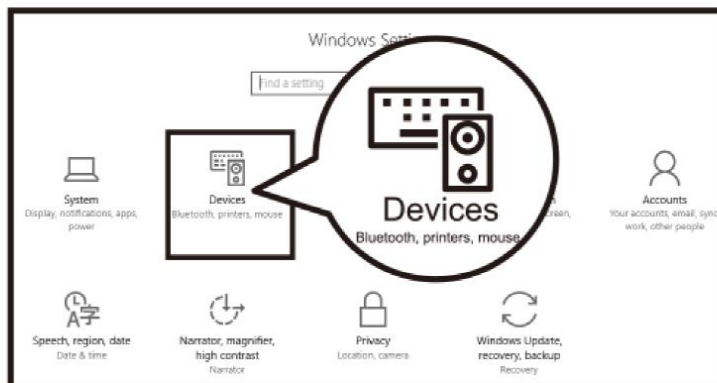

- 6 Your computer will automatically search for "BT5.0 Mouse" and then click "Pair". It is recommended to choose BT 5.0 Mouse connection.

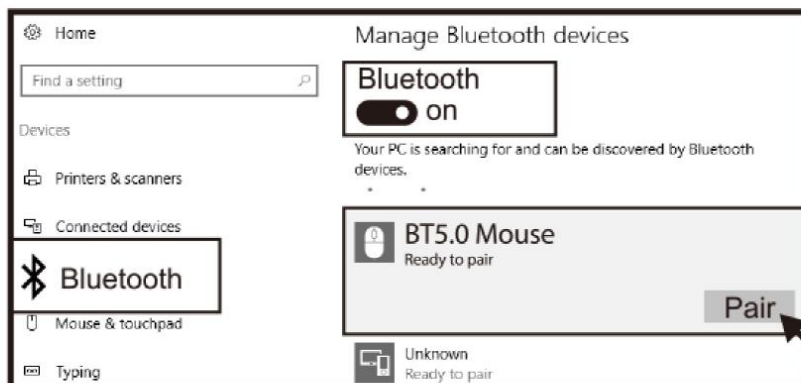



- 7 "BT5.0 Mouse" is connected and you can use the mouse.

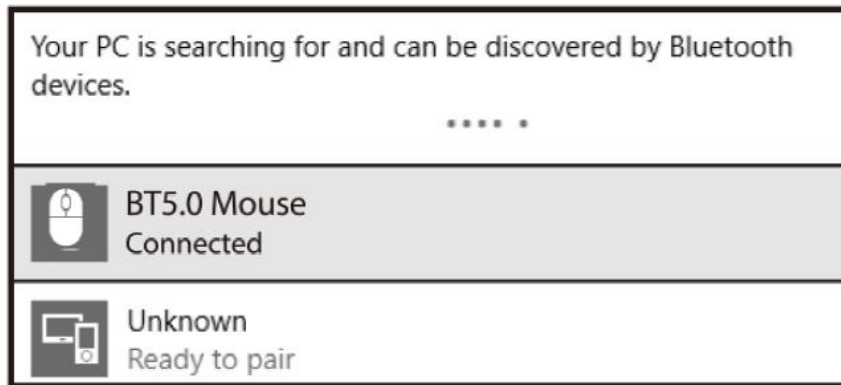

## Mac OS System

Please complete the Bluetooth mode pairing step1/2/3 before pairing.

- 4 Click "System Preferences" on Mac.



- 5 Click "Bluetooth" in "System Preferences".

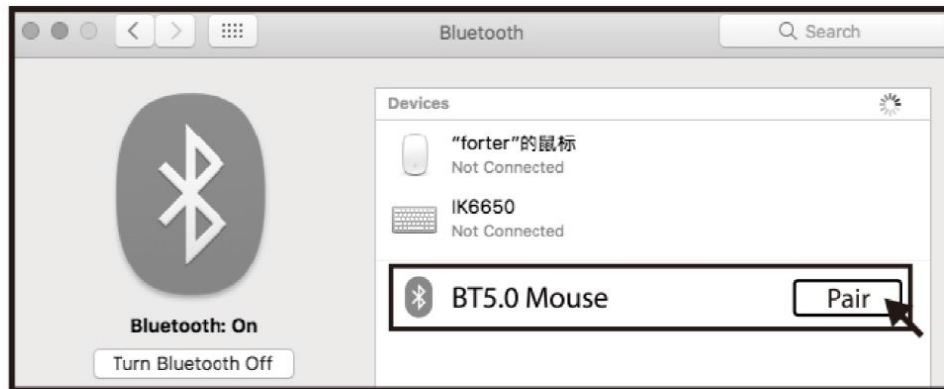

- 6 Your computer will automatically find "BT5.0 Mouse", then click "Pair", and you can use it after installation.  
It is recommended to choose BT 5.0 Mouse connection.

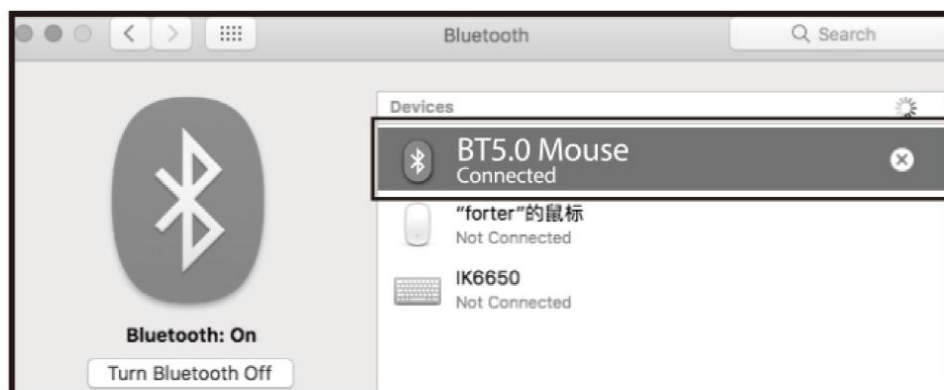

## Android System

Please complete the Bluetooth mode pairing step1/2/3 before pairing.

- 4 Click "Settings", turn on Bluetooth.

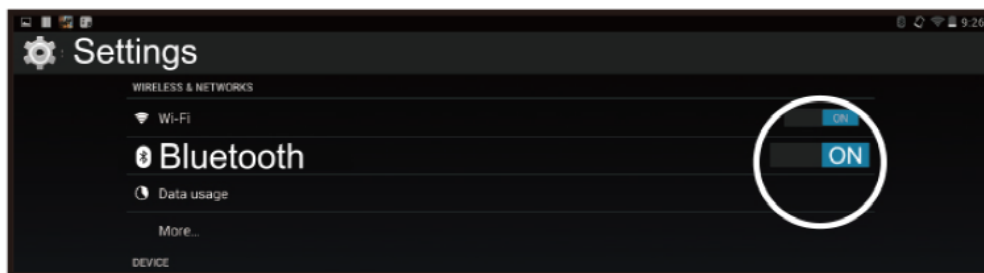

- 5 Your computer will automatically search for "BT5.0 Mouse" and then click "Pair". It is recommended to choose BT 5.0 Mouse connection.

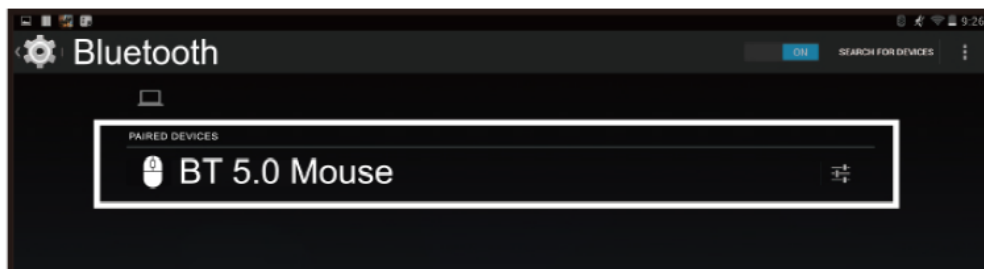

- 6 "BT5.0 Mouse" is connected and you can use the mouse.

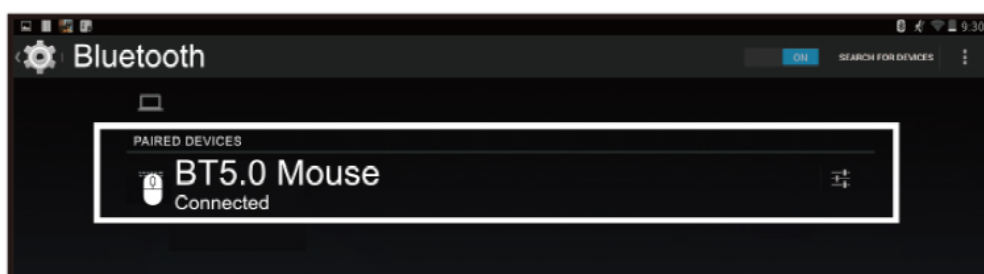

## Mode switching instructions

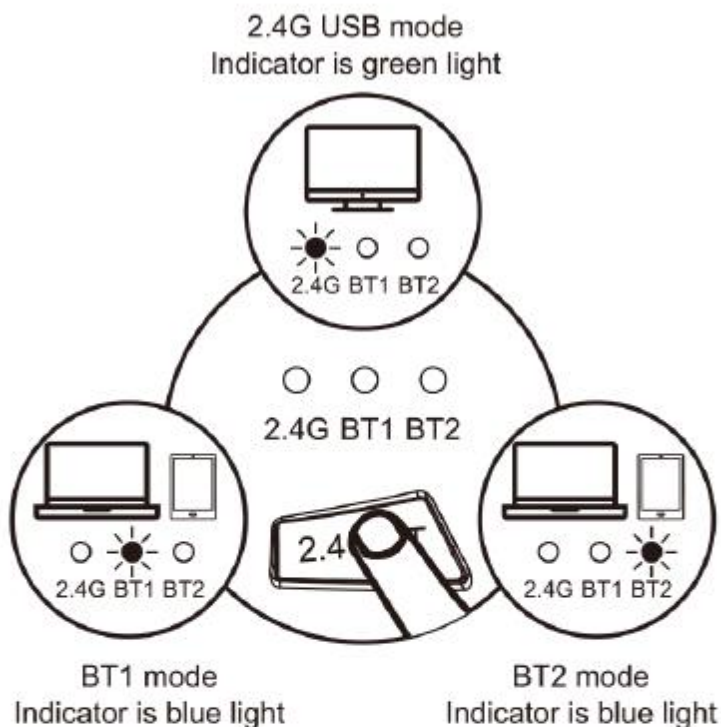

### 2.4G Connection

Press the switch button to 2.4G, green light on, you have switched to 2.4G mode.

### Switch to Bluetooth Mode(Take BT 1 for example)

1. Press the switch button to BT1, blue light on.
2. Press and hold the switch button for 3-5s until BT1 blue light flashes quickly, the mouse is ready for pairing.
3. "BT 5.0 Mouse" shows connected, now you are ready to go.
4. You can repeat above steps if you switch to BT2.

## LED light indication

Charging: LED1 red light keeps on, and turns off when fully charged.

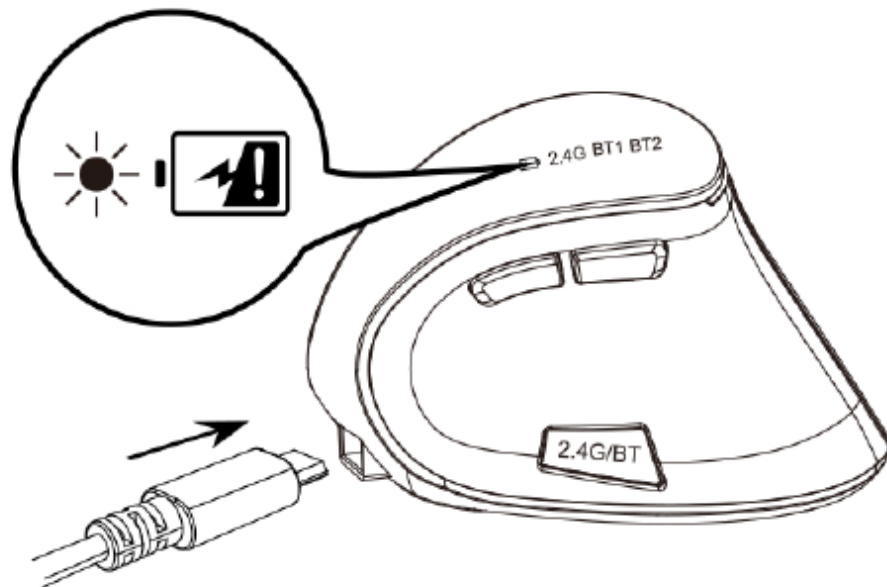

### Warm Reminder:

The mouse will enter into sleep mode after 30 minutes of inactivity, you can click any key to wake up.

## Frequently asked questions

Q1: What should I do if the Bluetooth connection fails?

A1: Please try to reconnect after removing other connected Bluetooths from your device, or turn off the mouse and turn back on, then reopen the device to connect to the mouse.

Q2: What should I do if the mouse sensor has lag problem?

A2: Please try to turn off the mouse and then turn back on or fully charge it before use.

Q3: What should I do if the mouse does not respond?

A3: If you turn on the mouse power switch and the mouse indicator light does not light up, please turn off the mouse and fully charge it.

## FCC Warning

Any Changes or modifications not expressly approved by the party responsible for compliance could void the user's authority to operate the equipment.

This device complies with part 15 of the FCC Rules.

Operation is subject to the following two conditions: (1)

This device may not cause harmful interference, and (2) this device must accept any interference received, including interference that may cause undesired operation.

FCC Radiation Exposure Statement:

This equipment complies with FCC radiation exposure limits set forth for an uncontrolled environment.

Changes or modifications to this unit not expressly approved by the party responsible for compliance could void the user's authority to operate the equipment.

NOTE: This equipment has been tested and found to comply with the limits for a Class B digital device, pursuant to Part 15 of the FCC Rules. These limits are designed to provide reasonable protection against harmful interference in a residential installation. This equipment generates uses and can radiate radio frequency energy and, if not installed and used in accordance with the instructions, may cause harmful interference to radio communications. However, there is no guarantee that interference will not occur in a particular installation. If this equipment does cause harmful interference to radio or television reception, which can be determined by turning the equipment off and on, the user is encouraged to try to correct the interference by one or more of the following measures:

- Reorient or relocate the receiving antenna.
- Increase the separation between the equipment and receiver.
- Connect the equipment into an outlet on a circuit different from that to which the receiver is connected.
- Consult the dealer or an experienced radio/TV technician for help.

This device and its antenna(s) must not be co-located or operation in conjunction with any other antenna or transmitter.