



Multifunctional Wireless Charging Station

User Manual

Product Overview

Please read this user manual carefully before using this product and keep it properly.

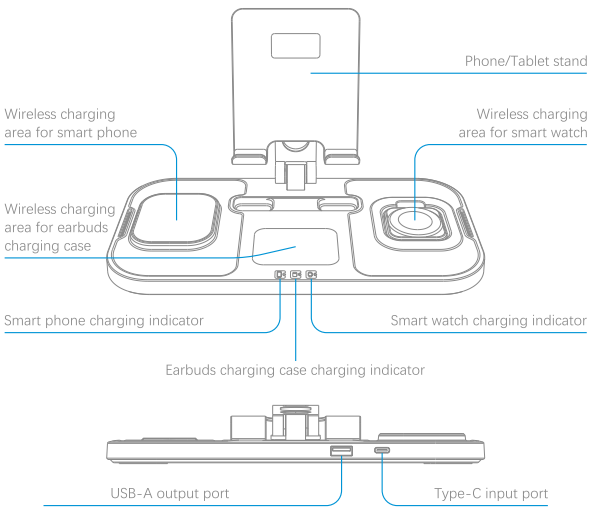

Compatible

Smart phone: All Qi compatible smart phones
Earbuds: All Qi compatible earbuds charging cases
Smart watch: For specific compatible models, see pictures or text descriptions on the website.

Indicator Light Guide

Charging status	Plugged in	Standby	Charging	Fully Charged	Detected
Indicator Light	All lights up once	OFF	Light always on	Light always on	White light flashes

How To Use The Product

1. Connect the product to the power supply;

2. Place your phone, earbuds charging case and watch on the device for wireless charging;
3. Connect the charging cable to the USB-A port of this product to charge other devices.

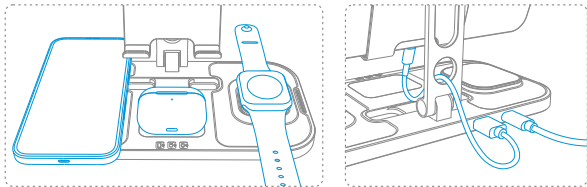

Specification

Input: DC 9V/3.6A (Max)
Charging Watch Output: 2.5W (Max)
USB-A Output: 10W (Max)
Charging Smart phone Output: 15W (Max)
Charging Earbuds Output: 5W (Max)

Package contents

Wireless charging station*1
0.5m(1.6ft)charging cable*1
36W charging adapter*1
User manual*1
1.5m(4.9ft)charging cable*1
Warranty card*1

Important Reminder

1. Please use the power adapter included with this product to charge your devices, otherwise it may not be possible to charge all devices at the same time. The supplied power adapter prohibits charging devices other than this product.
2. Any phone case or earbuds case thicker than 5mm will stop this charger from working properly.
3. The placement angle of the aluminium stand is 0-90°, more than 90° may cause the whole product to fall backwards.

Warning

1. Do not disassemble or change the internal structure of this product by yourself to avoid danger.
2. Please use this product in the temperature range of 0°C -40°C (32°F -104°F). Do not use this product in high temperature and humid place to avoid equipment failure.
3. Do not place metallic foreign objects in the wireless charging area.
4. Do not throw this product into the fire otherwise may cause the equipment to catch fire or explode.
5. This product contains sensitive electronic components, and can be damaged, impair functionality, or cause injury if dropped, burned, punctured, crushed.
6. Do not expose this product to high temperature or around heat generating devices such as heaters, microwave ovens, ovens, etc.
7. Do not allow children or pets to swallow this product to avoid injury or other hazards.
8. Radio waves generated by this product may interfere with pacemakers, defibrillators, or other medical devices. Maintain a safe distance of separation between your medical device and this product. Consult your physician and medical device manufacturer for information specific to your medical device. Stop using this product if you suspect it is interfering with your pacemaker, defibrillator, or any other medical device.
9. Please comply with local regulations for the disposal of this product and its accessories, and support recycling operations.

FCC Statement

This device complies with part 15 of the FCC Rules. Operation is subject to the following two conditions: (1) this device may not cause harmful interference, and (2) this device must accept any interference received, including interference that may cause undesired operation. Any changes or modifications not expressly approved by the party responsible for compliance could void the user's authority to operate the equipment.

NOTE: This equipment has been tested and found to comply with the limits for a Class B digital device, pursuant to Part 15 of the FCC Rules. These limits are designed to provide reasonable protection against harmful interference in a residential installation. This equipment generates, uses and can radiate radio frequency energy and, if not installed and used in accordance with the instructions, may cause harmful interference to radio communications. However, there is no guarantee that interference will not occur in a particular installation.

If this equipment does cause harmful interference to radio or television reception, which can be determined by turning the equipment off and on, the user is encouraged to try to correct the interference by one or more of the following measures:

- Reorient or relocate the receiving antenna.
 - Increase the separation between the equipment and receiver.
 - Connect the equipment into an outlet on a circuit different from that to which the receiver is connected.
 - Consult the dealer or an experienced radio/TV technician for help.
- To maintain compliance with FCC's RF Exposure guidelines, This equipment should be installed and operated with minimum distance between 20cm the radiator your body. Use only the supplied antenna.