

Carplay Ai Box , User Manual

1. Car Smart Box hardware and software:

CarSmart Box is equipped with a TF card slot, which can expand the TF card, and the system supports up to 128G TF card.

Standard version coverage area: Asia Pacific (including mainland China, HongKong, Macao and Taiwan, Southeast Asian countries), the whole of Europe, Australia, New Zealand, South America, Middle East and Mediterranean countries, the above regional major carriers.

2. guide direction :

WIFI 802.11a/b/g/n/AC, 2.4G+5G

Note: 5G band (W52) indoor use only.

MIFI (Mobile WiFi) function, Car Smart Box can be used as a Mobile WiFi router, to other network devices to provide WiFi hot spot.

Master Bluetooth: complete Bluetooth protocol stack on the cellphone side, support to connect all kinds of Bluetooth devices.

Slave Bluetooth, support the connection of mobile phone Bluetooth, provide Bluetooth hands-free phone, mobile phone Bluetooth music transmission and other functions.

Android 13, wireless CarPlay and wireless Android Auto, iPhone mirror, android phone mirror,.....

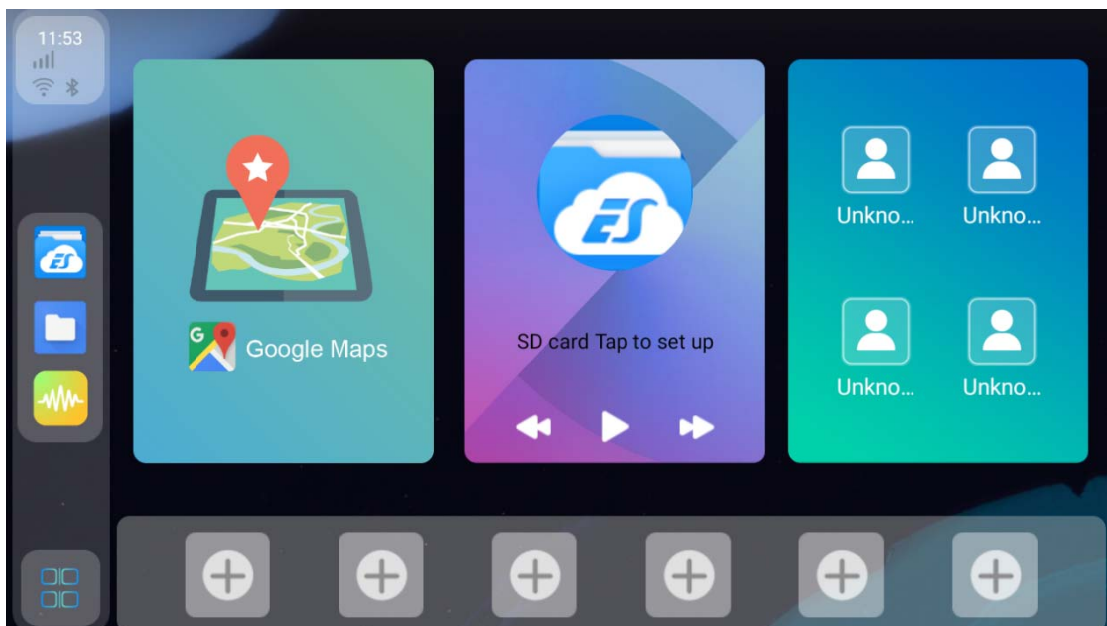

Marks : Car Smart Box is working on the cars which have carplay built-in and we have tested car models. USB plug in and play.

3.How to connect Car Smart Box's Bluetooth phone

You can search for "Car Smart Box" from the mobile phone, or search for mobile phones from "Car Smart Box".

From the mobile phone, you can find the bluetooth device name "Car Smart Box", then complete the Bluetooth pairing connection.

From Car Smart Box, Click the "BT Phone" icon:

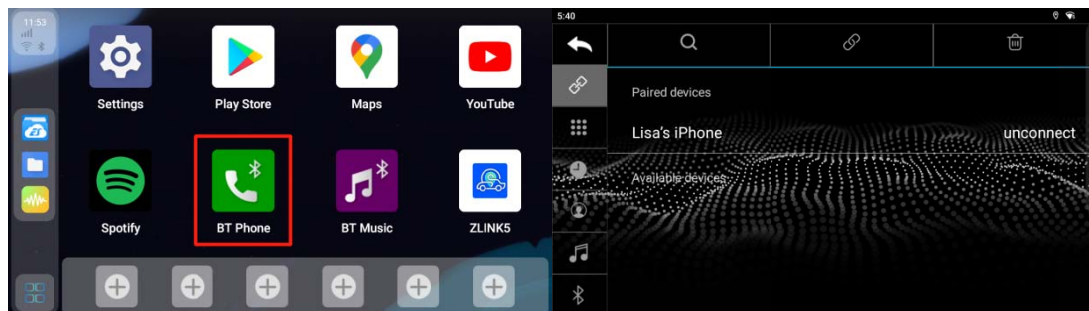

Search the mobile phone, Click to select the mobile phone to be connected, Click the pairing connection button to complete the pairing and connection

4.How to use wireless Carplay?

Click the "ZLINK5" icon to enter the wireless Carplay connection.

Then Car Smart Box will automatically switch to the hotspot sharing mode (at this time, the WiFi switch is automatically turned off), share a hotspot, and send the hotspot name and password to the iPhone via Bluetooth. The iPhone establishes a wireless CarPlay connection with Car Smart Box through the hotspot shared by Car Smart Box.

After the connection is completed, Car Smart Box's slave bluetooth will be automatically turned off, and WiFi will also be automatically turned off (because it has been switched to hotspot sharing mode). Then, you will enter the Carplay UI.

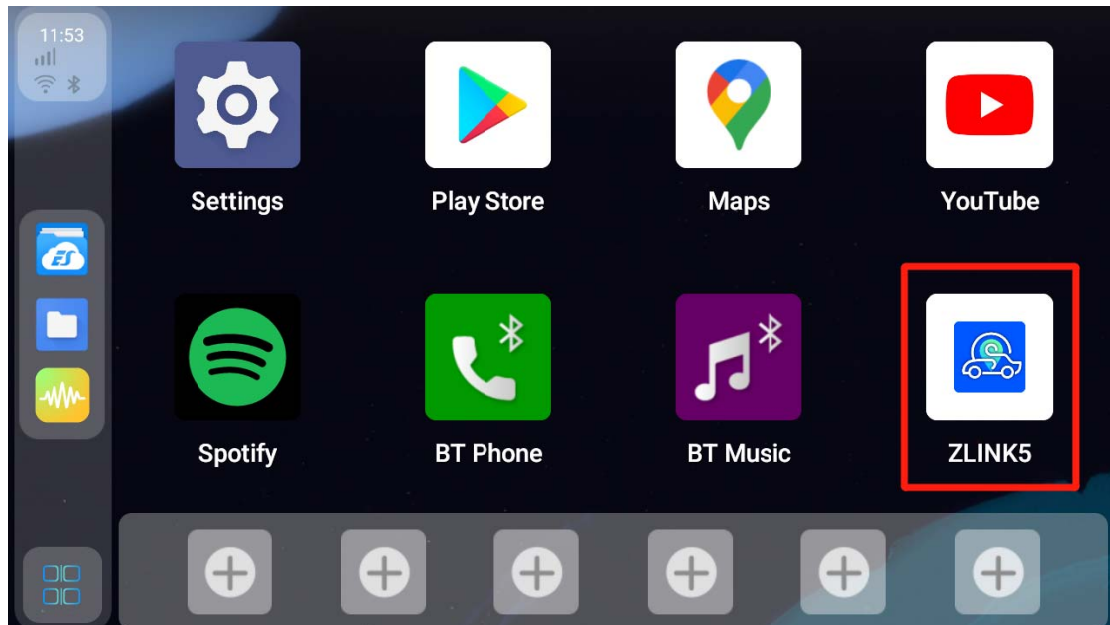

At the CarPlay UI, click the car icon, or click the suspension ball, expand, click the HOME icon, you can return to the launcher of Car Smart Box.

If you completely close the ZLINK5 app, Car Smart Box's slave bluetooth will automatically turn on and reconnect to your iPhone. But Car Smart Box is still in hotspot sharing mode and will not automatically switch back to WiFi mode. If you need to use WiFi now, you can pull down the status bar and turn it on directly through the WiFi switch in the status bar.

When the Bluetooth connection is disconnected, open ZLINK5 and click "Settings":

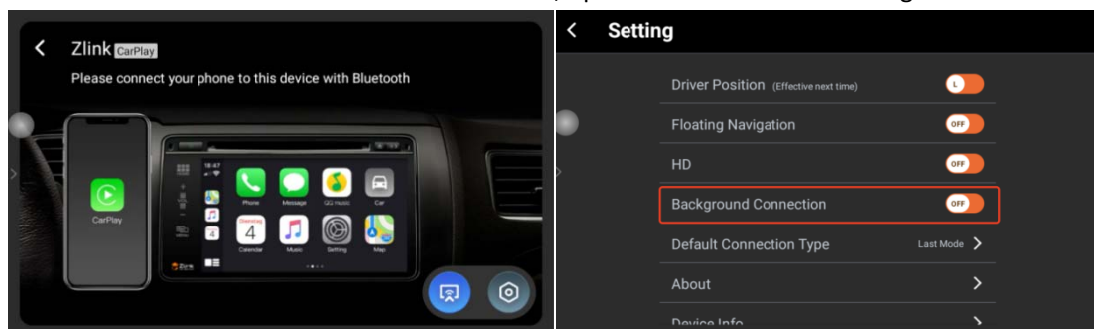

If you want to automatically enter wireless Carplay after connecting to Bluetooth, you can turn on the "wireless Carplay automatic connection" switch.

5. Android phone how to use BT Phone and wireless Android Auto (Android 11 mobile phone to support wireless Android Auto function)

Click the "BT phone" icon to connect the Android mobile phone with the bluetooth module (slave bluetooth, BT5.0) on the Car Smart Box. After one connection, every time the Car Smart Box starts, it will automatically connect with the bluetooth of the Android mobile phone .

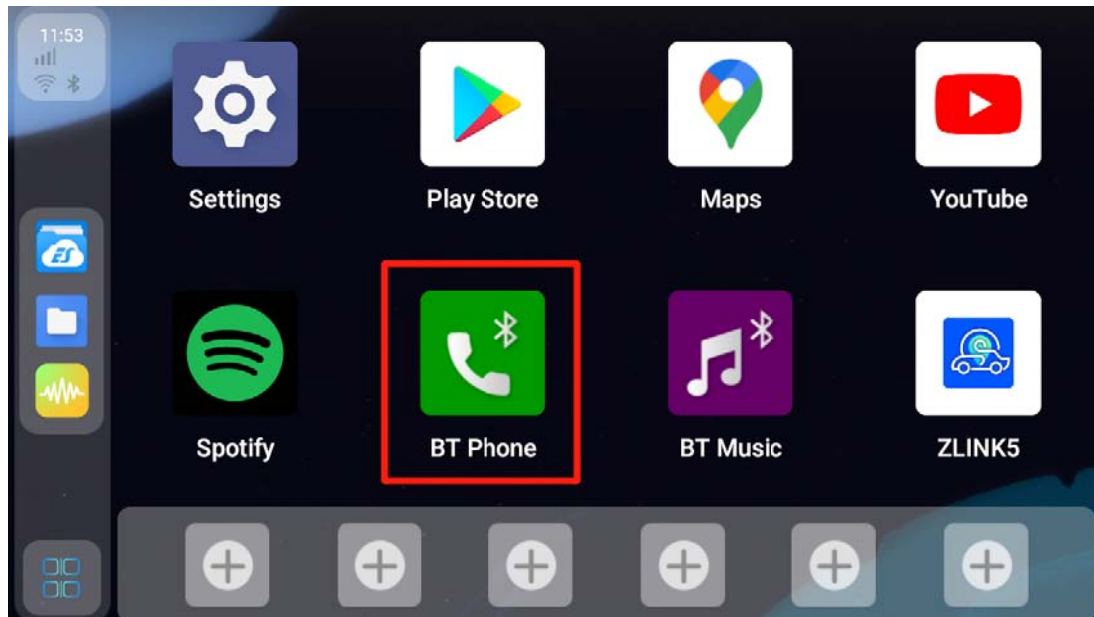

Click the "ZLINK5" icon to enter the wireless Android Auto connection.

Then Car Smart Box will automatically switch to the hotspot sharing mode (at this time, the WiFi switch is automatically turned off), share a hotspot, and send the hotspot name and password to the Android Phone via Bluetooth. The Android Phone establishes a wireless Android Auto connection with Car Smart Box through the hotspot shared by Car Smart Box.

After the connection is completed, Car Smart Box's slave bluetooth will be automatically turned off, and WiFi will also be automatically turned off (because it has been switched to hotspot sharing mode). Then, you will enter the Android Auto UI.

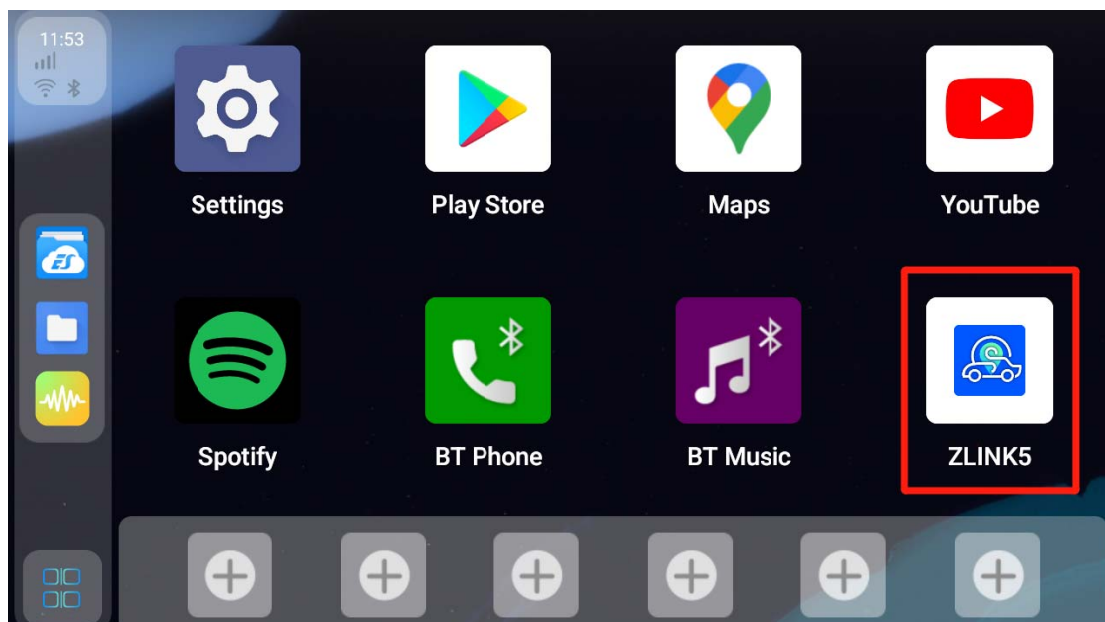

At the Android Auto UI, click the car icon, or click the floating ball, expand, click the HOME icon, you can return to the launcher of Car Smart Box.



Marks : Please note the wireless android auto is support the android phone which have wireless android auto function only .

For example :Wireless projection is compatible with these Android versions:

Any phone with Android 11.0

A Google or Samsung phone with Android 10.0

A Samsung Galaxy S8, Galaxy S8+ or Note 8, with Android 9.0

If you completely close the ZLINK5 app, Car Smart Box's slave bluetooth will automatically turn on and reconnect to your Android Phone. But Car Smart Box is still in hotspot sharing mode and will not automatically switch back to WiFi mode. If you need to use WiFi now, you can pull down the status bar and turn it on directly through the WiFi switch in the status bar.

6.About Car Smart Box's setting options

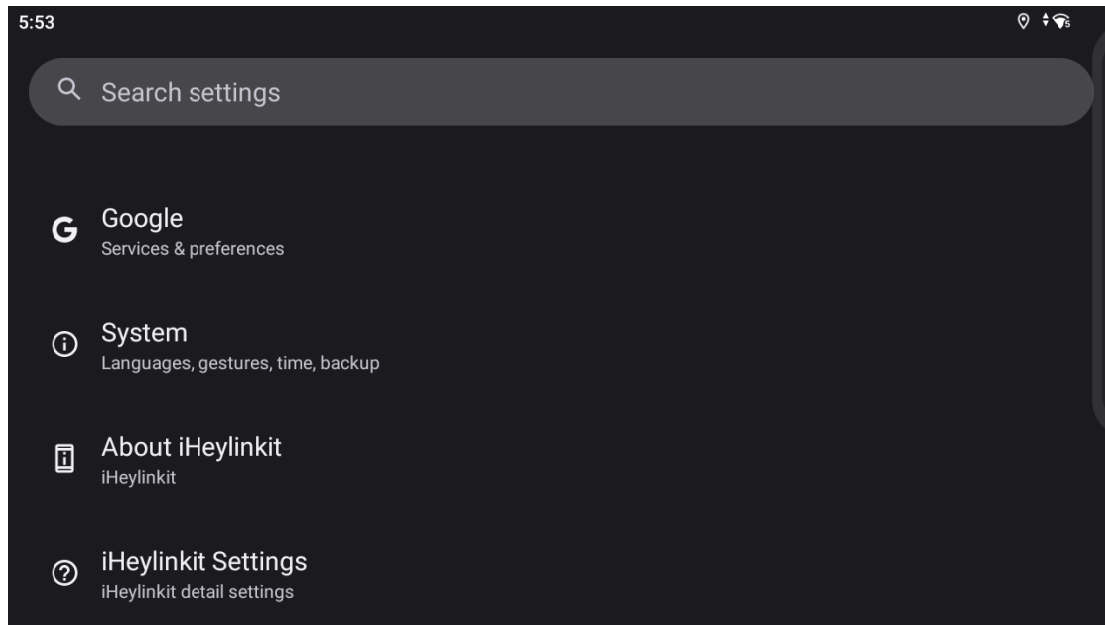

Navigation app setup: Allows you to specify an APP to join our navigation software whitelist, and the system handles the sound type of this APP in accordance with the navigation software.

Voice assist: Allows you to specify an APP to use the original car's voice button (long press for 3 seconds) or the voice button on the floating ball to wake up.

Use the OEM GPS data: If this option is checked, the GPS data output from the OEM navigation hardware can be used. If the test is OK, the GPS antenna can not be plugged in. The vehicle does not have navigation hardware, or has navigation hardware, but does not implement GPS data transmission function specified in carplay standard protocol, then you can't check this option, you can only connect the GPS antenna to obtain GPS data.

Copy log file to SD Card: Copy the log of startup and system operation to SD card, mainly for R&D and debugging.

Warning:

This device complies with Part 15 of the FCC Rules. Operation is subject to the following two conditions: (1) this device may not cause harmful interference, and (2) this device must accept any interference received, including interference that may cause undesired operation.

Changes or modifications not expressly approved by the party responsible for compliance could void the user's authority to operate the equipment.

NOTE: This equipment has been tested and found to comply with the limits for a Class B digital device, pursuant to Part 15 of the FCC Rules. These limits are designed to provide reasonable protection against harmful interference in a residential installation. This equipment generates uses and can radiate radio frequency energy and, if not installed and used in accordance with the instructions, may cause harmful interference to radio communications. However, there is no

guarantee that interference will not occur in a particular installation. If this equipment does cause harmful interference to radio or television reception, which can be determined by turning the equipment off and on, the user is encouraged to try to correct the interference by one or more of the following measures:

- Reorient or relocate the receiving antenna.
- Increase the separation between the equipment and receiver.
- Connect the equipment into an outlet on a circuit different from that to which the receiver is connected.
- Consult the dealer or an experienced radio/TV technician for help.

NOTE: This device and its antenna(s) must not be co-located or operation in conjunction with any other antenna or transmitter

RF Exposure Statement

To maintain compliance with FCC's RF Exposure guidelines, This equipment should be installed and operated with minimum distance of 20cm the radiator your body. This device and its antenna(s) must not be co-located or operation in conjunction with any other antenna or transmitter