

BLUETOOTH SPEAKER

MODEL: XG21008

PRODUCT INSTRUCTIONS

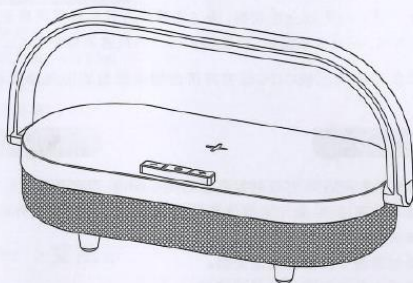

Thank you very much for choosing our products, please read the instructions carefully before using the product.



FEATURES

- Exquisite and Practical
- Phone Stand Function
- Adjustable Lighting Angle
- Charging Distance $\leq 8\text{mm}$
- Wireless Charging
- Wire Charging
- TWS Interconnect
- Wireless Speaker
- Handsfree
- Carry Conveniently
- Lamp

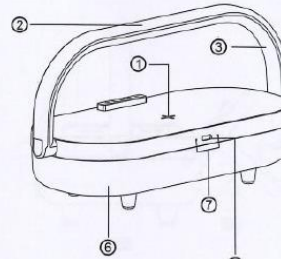
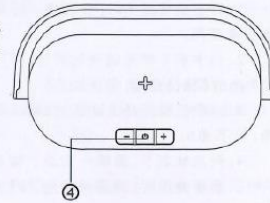

APPEARANCE CHARACTERISTICS

- ① Wireless Charging Reference Point
- ② On/off and Dimming
- ③ Lampshade
- ④ Function Button
- ⑤ Type-c Interface
- ⑥ Speaker Cavity
- ⑦ Indicator Light (Blue and Red)

01

OPERATION METHOD

1. Plug the USB data cable to the 5V \rightarrow 3A 9V \rightarrow 2A power adapter, and connect the other end to the Type-C interface.
2. After the product is powered on, the product indicator red light stays on.
3. Place the device that needs to be charged in the charging indication area of the product. the blue light is always on, and it enters the charging state.

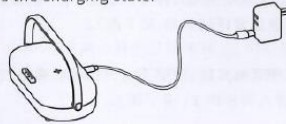

HANDLE ROTATION ANGLE DESCRIPTION

Warning: The handle rotation Angle is within 270° as shown in the picture. Do not rotate 360°.

Rotation range 270°

Do not rotate handle 360°



02

LIGHT TOUCH FUNCTION

- ▶ Touch the first time to start the light 10% brightness.
- ▶ Touch the second time to change the light 70% brightness.
- ▶ Touch the third time to change the light 70% brightness.
- ▶ Touch the fourth time to turn off the light.

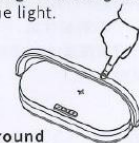

BUTTON FUNCTION

[⏻] Power switch/play/pause hands-free calling/TWS stereo surround

Press and hold for 5 seconds to turn on the speaker. in the playback state, short press to pause the song, short press again to play the song. when there is a phone call, short press to answer the call, long press for 2 seconds to reject the call; In the power-on state, press and hold for 5 seconds to power off. double-click the power button of any speaker to enter the TWS pair speaker mode.

[+] Volume up/next song

In the playback state, short press to increase the volume, and "most volume" will occur when the volume is maximized. long press will play the next song.

[-] Volume down/last song

In the playback state, short press in order to decrease the volume, long press will play the previous song.

03

TURN ON YOUR SPEAKER AND USE

In the off state, [⏻] press the play button for about 5 seconds, and there is a beep sound, indicating that the speaker is searching for pairing, the blue light flashes quickly. At this time, turn on the bluetooth function of your mobile phone. In the bluetooth device, search for bluetooth click to select the [iGaur S10] device name and it automatically enters the pairing. After the pairing is successful, there will be a beep and the blue light will be on.

If you are not using the speaker, please press and hold the [⏻] power button for 5 seconds to shut down to avoid power consumption.

Notes:

- Model: XG21008A (without built-in Li-battery). It can be used only when it is plugged in.
- Model: XG21008B (without built-in Li-battery+without bluetooth speaker). It can be used only when it is plugged in.

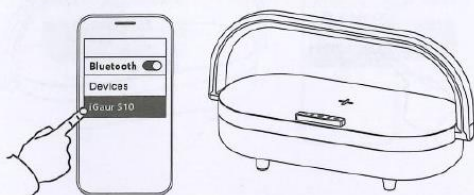

04

TWS INTERCONNECT

1. Double-click the power switch of any speaker to enter two pair speaker mode. waiting for about 8 seconds, the two speakers are interconnected. after the connection is successful, the blue light of the main unit flashes quickly and the blue light of the slave unit stays on. the main unit keeps pairing with the mobile phone bluetooth and realize the surround effect of left and right stereo channels.

2. Double-click the power switch of any speaker to turn off TWS pair speaker mode, and you can play music separately.

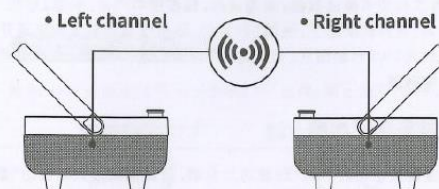

05

PHONE HOLDER OPERATING INSTRUCTIONS

1. Lean the phone on the handle and tilt it to a comfortable angle to play the video. after the Bluetooth is connected to the speaker, the speaker source of the mobile phone is output to the speaker amplifier to enjoy the super bass surround effect. **See picture 1**

2. Rotate the handle to the back of the speaker, tilt the wireless charging surface of the speaker to a comfortable angle, you can wirelessly charge the phone while playing and watching the video, the phone speaker source is output to the speaker for amplification and enjoy the super bass surround effect. **See picture 2**

3. When the thickness of the phone is too high, the buttons cannot support the phone and need to be installed with accessories put the heightened button on the original button. **See picture 3**

Button Accessories

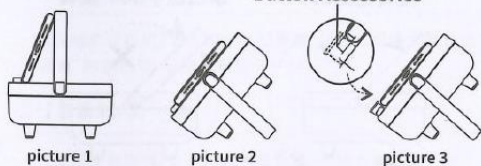

06

CARRYING OUT INSTRUCTIONS

Built-in 5000mAh lithium battery power supply, carry conveniently

1. When going out and using it, press and hold the power button [⏻] for 5 seconds to turn on, and all functions can be used normally.

2. When the mobile phone does not have the wireless charging function, you can use Type-C cable to insert the speaker Type-C interface charging.

See picture a

3. When the mobile phone has wireless charging function, it can be charged directly on the speaker charging panel.

See picture b

4. When turned on, the speaker is always in the search state and can be connected and paired.

5. When not in use, be sure to press and hold the power button [⏻] for 5 seconds to shut down to avoid power consumption.

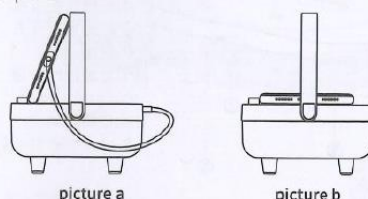

07

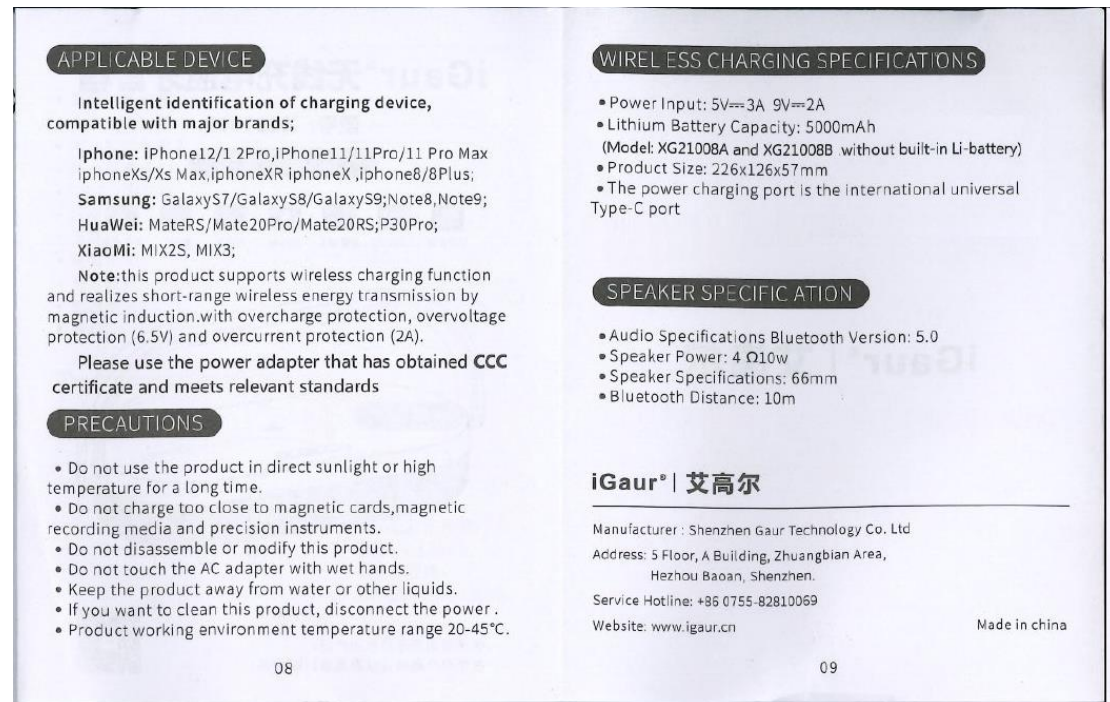

FCC Statement

This equipment has been tested and found to comply with the limits for a Class B digital device, pursuant to Part 15 of the FCC Rules. These limits are designed to provide reasonable protection against harmful interference in a residential installation. This equipment generates uses and can radiate radio frequency energy and, if not installed and used in accordance with the instructions, may cause harmful interference to radio communications. However, there is no guarantee that interference will not occur in a particular installation. If this equipment does cause harmful interference to radio or television reception, which can be determined by turning the equipment off and on, the user is encouraged to try to correct the interference by one or more of the following measures:

- Reorient or relocate the receiving antenna.
- Increase the separation between the equipment and receiver.
- Connect the equipment into an outlet on a circuit different from that to which the receiver is connected.
- Consult the dealer or an experienced radio/TV technician for help.

This device complies with part 15 of the FCC Rules. Operation is subject to the following two conditions:

- (1) This device may not cause harmful interference, and (2) this device must accept any interference received, including interference that may cause undesired operation.

Changes or modifications not expressly approved by the party responsible for compliance could void the user's authority to operate the equipment.