

LED Bluetooth Light Manual

Product name	LED Bluetooth Light
Support system	Android 4.4 and above/iOS 10.0 and above
Connection mode	Bluetooth 5.0

Lamp assembly

Installation method one (side clip)

Insert the bracket from one side of the light board, then move it to a suitable position, and finally snap it to the fish tank and tighten the screws



Installation method two (bracket type)

Insert the two brackets from one side of the light board, then move them to a suitable position, and finally snap them to the fish tank and tighten the screws



Installation method three (suction cup type)

Clip the suction cup into the light board, and then attach it to the inner wall of the fish tank



Suction cup effect:



Connection diagram

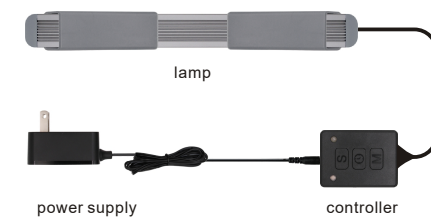

Product Features

Controller

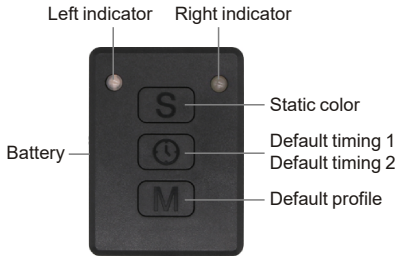

Indicator status:

Left indicator

Red: channel custom color
Blue: static color
Yellow: default timing 2
White: custom timing

Green: profile
Cyan: default timing 1
Purple: custom mode

Right indicator

Turn off the lights after N hours

Lamp Specifications

Light source type: LED
Input: AC100-240V 50/60Hz
Lighting angle: 180°
Light bar material: aluminum alloy
Working environment temperature: -20℃+40℃

Light color: WRGB
Output: DC12V

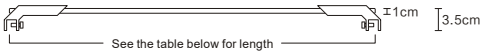

Length	Total current/power	RGB+white lamp beads	Luminous flux
18cm	0.45A/5W	3+3	180~200LM
28cm	0.65A/7.8W	6+6	360~400LM
38cm	0.85A/10.2W	9+9	540~600LM
48cm	1.08A/13W	12+12	720~800LM
58cm	1.25A/15W	15+15	900~1000LM
68cm	1.42A/17W	18+18	1080~1150LM
78cm	1.53A/18.5W	21+21	1260~1350LM
88cm	1.64A/20W	24+24	1440~1550LM
98cm	1.8A/22W	27+27	1620~1800LM
108cm	2.04A/24W	30+30	1800~1920LM
118cm	2.1A/26W	33+33	1980~2100LM
128cm	2.15A/26.5W	36+36	2100~2160LM
138cm	2.21A/27W	39+39	2100~2200LM
148cm	2.26A/27.5W	42+42	2160~2280LM

RGB lamp beads

Model 5050
Voltage R:2.0~2.4v
G:3.0~3.6v
B:3.0~3.6v
Power 1.5w
Brightness R:3000~5000mcd
G:5500~6000mcd
B:2000~3000mcd
Wavelength R:620~625nm
G:520~530nm
B:450~460nm

Cool white lamp beads

Model 5730
Voltage 3.0~3.3v
Current 150ma
Power 0.5w
Brightness 50~60lm
Color Temperature 12000~15000k
Color Rendering Index: 80~85ra

Download APP

Please search for "LED LAMP" in major application markets or scan the QR code below.



☆First of all, you need to turn on the Bluetooth function of your mobile phone.
☆Android phone users, also turn on the location function and allow permissions.

Instructions

On the homepage interface, manually pull down to refresh, the APP automatically searches for nearby devices, and clicks the "LED SMART" device to enter the lighting control interface.

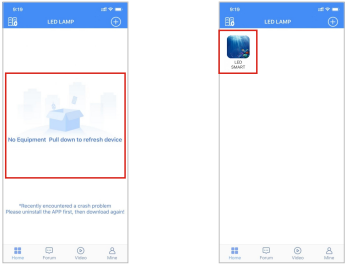

1. Color: There are two parts, the color wheel and the monochrome. The color wheel can choose the color of the light, and the monochrome can adjust the brightness of the white light.

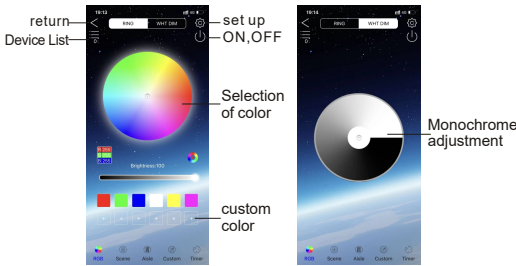

2. Scenario: There are various modes, choose the mode you want.



3. Channel: red, green, blue, white can be adjusted separately



4. Custom: You can add color storage, and then select a mode to adjust brightness and speed.



5. Timing: You can set the time; the mode includes two modes: jump and gradient; drag left and right to set the time, and drag up and down to set the color value.

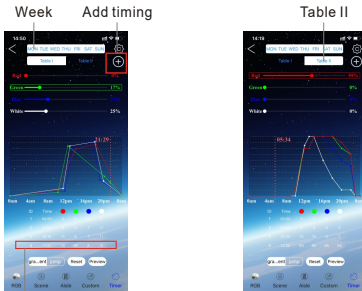

11:21, red: 30, green: 46, blue: 8, white: 12

Add timing method one

Click the new button to enter the setting interface, set the time and red, green and blue, and click the save button after completion.

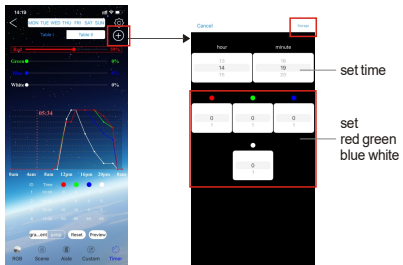

Add timing method 2

Select red, then click and drag on the graph to the ideal time and color value, (horizontal is time, vertical is color) other colors as well

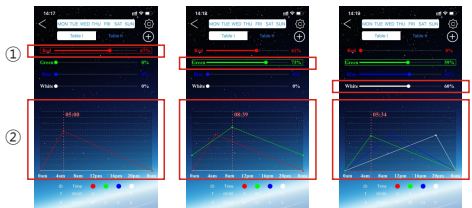

FCC Warning Statement

Changes or modifications not expressly approved by the party responsible for compliance could void the user's authority to operate the equipment. This equipment has been tested and found to comply with the limits for a Class B digital device, pursuant to Part 15 of the FCC Rules. These limits are designed to provide reasonable protection against harmful interference in a residential installation. This equipment generates uses and can radiate radio frequency energy and, if not installed and used in accordance with the instructions, may cause harmful interference to radio communications. However, there is no guarantee that interference will not occur in a particular installation. If this equipment does cause harmful interference to radio or television reception, which can be determined by turning the equipment off and on, the user is encouraged to try to correct the interference by one or more of the following measures:

- Reorient or relocate the receiving antenna.
- Increase the separation between the equipment and receiver.
- Connect the equipment into an outlet on a circuit different from that to which the receiver is connected.
- Consult the dealer or an experienced radio/TV technician for help.

This device complies with part 15 of the FCC Rules. Operation is subject to the following two conditions:

- (1) This device may not cause harmful interference, and
- (2) this device must accept any interference received, including interference that may cause undesired operation.

RF Exposure Statement

To maintain compliance with FCC's RF Exposure guidelines, this equipment should be installed and operated with minimum distance of 20cm the radiator your body. This device and its antenna(s) must not be co-located or operation in conjunction with any other antenna or transmitter.