

5.5cm

1. Get the FasLink app

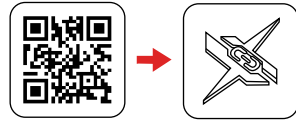

visit obdresource.com/apps or scan the QR code

2. Plug P02 into the OBD port

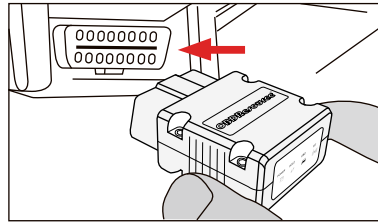

OBD port is usually in driver's footwell

3. Turn the ignition to the "Key On, Engine Off" position

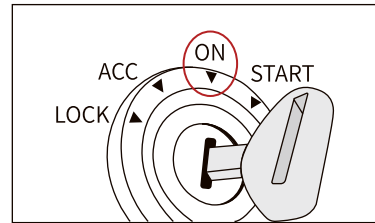

4. Enable bluetooth on the phone, tap "CONNECT" in FasLink X



5. Tap "OBDII" bluetooth device

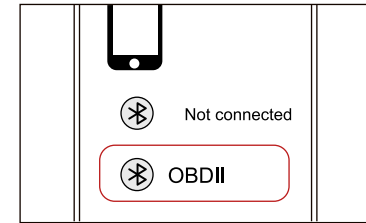

6. "CONNECTED": ready to test

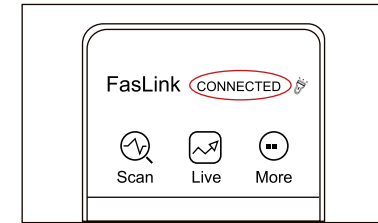

5.5cm

5.5cm



Share your experience

Leave review

www.obdresource.com



Did we mess up?

Let our friendly support team make it right

info@obdresource.com

Troubleshooting

Unable to connect to vehicle:

Make sure the ignition is in the "ON" position.

Unable to pair:

Make sure connect P02 internal App, DO NOT pair bluetooth in Phone settings.

P02 Bluetooth device not appearing in FasLink device list on Android phone:

Please plug out and re-insert the device to car OBDII port. End the FasLink X app then restart. If you paired the P02 in phone settings, un-pair it before running app.

Scan QR code



Join Facebook group
try our new product for **FREE!**

www.facebook.com/groups/200454611099255

P02 Getting Started

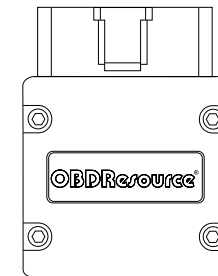

5.5cm

FCC Warning

This device complies with part 15 of the FCC Rules. Operation is subject to the following two conditions:
(1) This device may not cause harmful interference, and (2) this device must accept any interference received, including interference that may cause undesired operation.

Any Changes or modifications not expressly approved by the party responsible for compliance could void the user's authority to operate the equipment.

Note: This equipment has been tested and found to comply with the limits for a Class B digital device, pursuant to part 15 of the FCC Rules. These limits are designed to provide reasonable protection against harmful interference in a residential installation. This equipment generates uses and can radiate radio frequency energy and, if not installed and used in accordance with the instructions, may cause harmful interference to radio communications. However, there is no guarantee that interference will not occur in a particular installation. If this equipment does cause harmful interference to radio or television reception, which can be determined by turning the equipment off and on, the user is encouraged to try to correct the interference by one or more of the following measures:

- Reorient or relocate the receiving antenna.
- Increase the separation between the equipment and receiver.
- Connect the equipment into an outlet on a circuit different from that to which the receiver is connected.
- Consult the dealer or an experienced radio/TV technician for help.

This equipment complies with FCC radiation exposure limits set forth for an uncontrolled environment. This equipment should be installed and operated with minimum distance 20cm between the radiator & your body.