

Wireless TV Headphones

User Manual

M98A



EU Importer: E-CrossStu-GmbH
Address: Mainzer Landstr.69, 60329 Frankfurt am Main, Germany

Manufacturer: HONGKONG ZHINYU TECHNOLOGY CO., LIMITED
Address: FLAT/RM A 12/F ZJ 300, 300 LOCKHART ROAD, WAN CHAI, HONG KONG

IN THE BOX



① Headphones×1

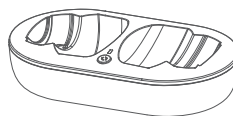

② Charging dock / transmitter×1

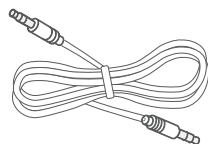

③ 3.5mm audio cable×1



④ RCA adapter cable×1



⑤ USB-C cable×1

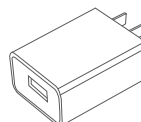

⑥ USB wall charger×1

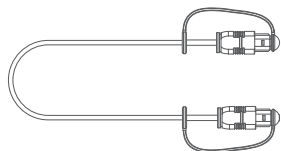

⑦ Optical audio cable×1

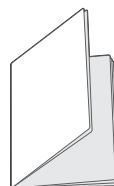

⑧ User manual×1

PRODUCT OVERVIEW

● Headphones

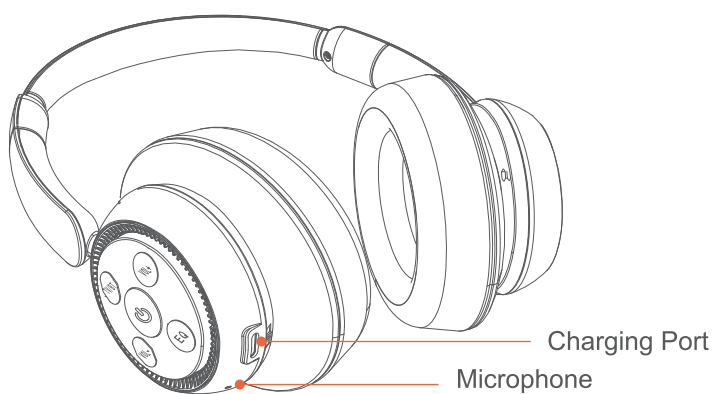
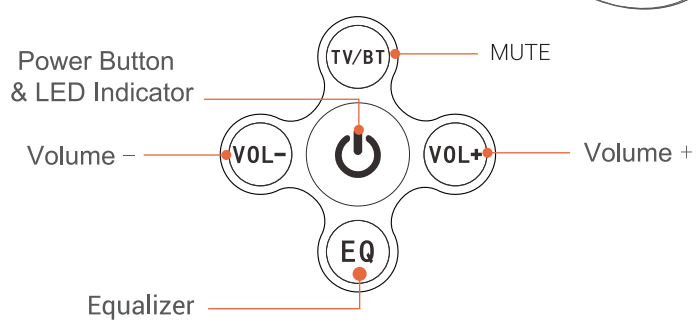

● Charging Dock / Transmitter

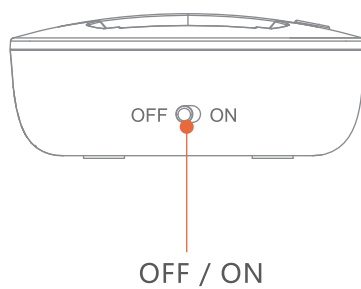
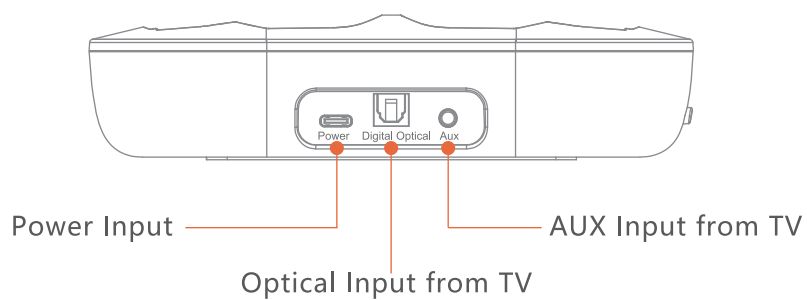
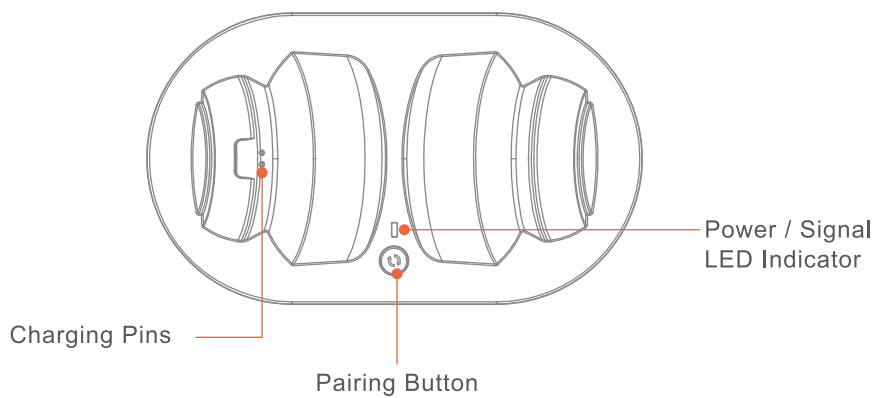

CHARGING THE HEADPHONES

Fully charge the headphones before using them for the first time and It is recommended to use Method 1 for charging.

Method 1:

Charging the headphones using the charging dock / transmitter.

1. Plug the Type-C end of the USB-C cable into the power input port on the charging dock, and the USB-A end into the USB wall charger (included). Connect the charger to a power source.
2. Place the headphones on the charging dock. The headphones' LED indicator stays red during charging and turns green when fully charged.



Notes:

- Tighten the sliding arms of the headphones before placing them on the charging dock for charging.

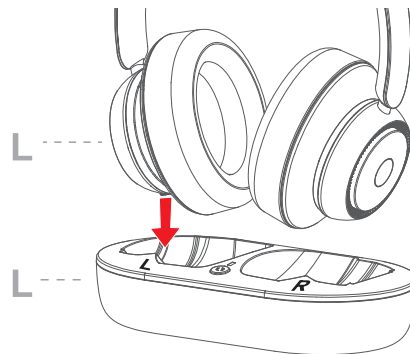
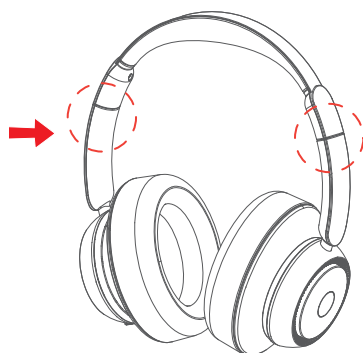

- Ensure that the headphones is placed in the correct orientation on the charging dock: Place the left earcup in the left recess of the charging dock and ensure full contact between the headphones and the charging dock. The LED indicator stays red during charging.

Method 2:

Charging the headphones using the wall charger and USB-C cable.

1. Plug the Type-C end of the USB-C cable into the power input port on the headphones, and the USB-A end into the USB wall charger (included). Connect the charger to a power source.
2. The LED indicator stays red during charging and turns green when fully charged.

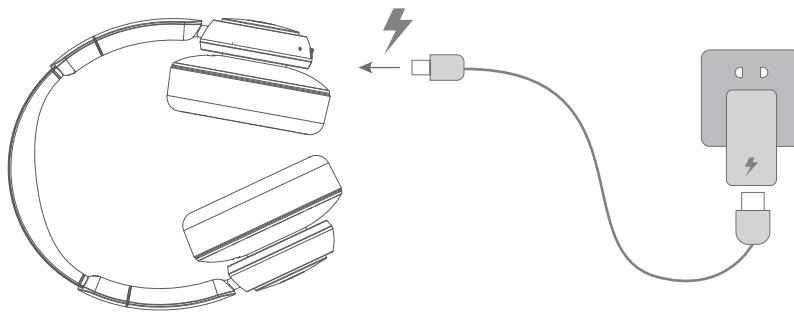

Notes:

- The charging dock does not have a built-in battery and needs to connect to a USB wall charger for power supply.
- When the headphones battery is low, they will voice prompt "Low battery" every 10 minutes until the headphones power off.
- For subsequent charges, place the headphones directly on the charging dock without turning them off. When you remove the headphones from the charging dock, they will automatically power on and connect to the transmitter.
- When you put the headphones on the charging dock for charging, the LED indicator of the headphones stays red and turns green when fully charged. If the LED indicator stays white or flashes, it indicates that the headphones are not properly placed and cannot be charged. Please adjust the position of the headphones for charging.

USING THE HEADPHONES

There are four methods to connect the transmitter to a TV. If your TV has an optical output, it is recommended to use the optical audio cable for connection.

Method 1: Connect the transmitter to a TV using the optical audio cable.

Method 2: Connect the transmitter to a TV using the RCA adapter cable.

Method 3: Connect the transmitter to a TV using the 3.5mm audio cable.

Method 4: Connect the transmitter to a TV using the USB-C cable.

Connecting the transmitter to a TV using the optical audio cable.

Method 1

- 1 Plug the Type-C end of the USB-C cable into the power input port on the transmitter, and the USB-A end into the USB wall charger (included). Connect the charger to a power source and switch the transmitter power switch to ON. The LED indicator on the transmitter turns red.
- 2 Connect one end of the digital optical cable to the optical input port of the transmitter and the other end to your TV's optical output port.

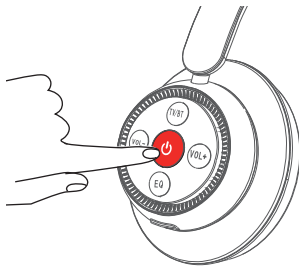
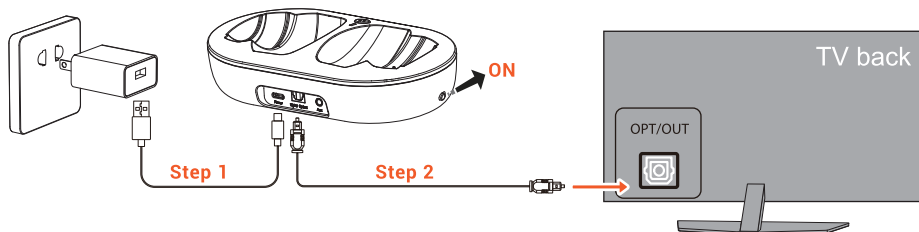

- 3 Turn on the headphones.

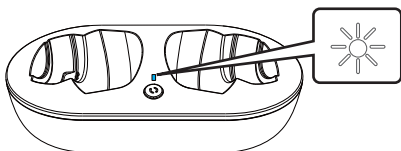

- 4 When the connection is successful, the LED indicators on the headphones and the transmitter stay white and you will hear a voice prompt "TV connected".

Notes:

- If the transmitter powers on later than the headphones, the headphones will automatically search for the transmitter, and the LED indicator on the headphones flashes white.
- The headphones will automatically power off after 10 minutes if they fail to connect to the transmitter.
- The optical audio cable is composed of glass and plastic; therefore, do not fold and bundle the optical audio cable to avoid damage.

Connecting the transmitter to a TV using the RCA adapter cable

Method 2

- 1** Plug the Type-C end of the USB-C cable into the power input port on the transmitter, and the USB-A end into the USB wall charger (included). Connect the charger to a power source and switch the transmitter power switch to ON. The LED indicator on the transmitter turns red.
- 2** Connect one end of the 3.5mm audio cable to the Aux port of the transmitter and the other end to the RCA adapter cable. Plug the RCA adapter cable to your TV's RCA audio output port.

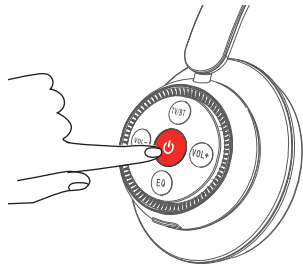
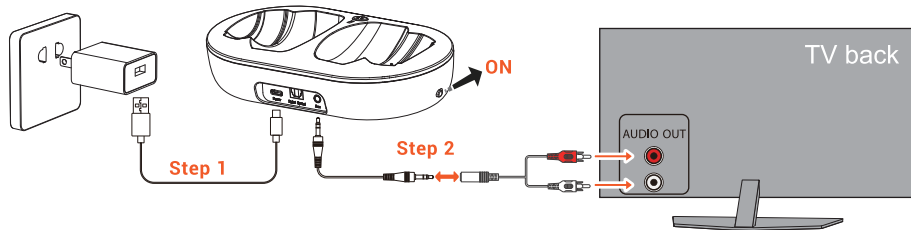

- 3** Turn on the headphones.

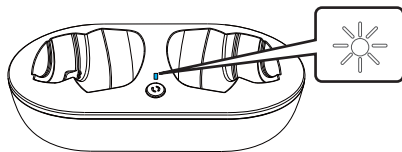

- 4** When the connection is successful, the LED indicators on the headphones and the transmitter stay white and you will hear a voice prompt "TV connected".

Note:

- When connecting the transmitter to a computer using the 3.5mm audio cable, use the included USB wall charger rather than the USB port on your computer for power supply to avoid noise interference.

Connecting the transmitter to a TV using the 3.5mm audio cable.

Method 3

- 1** Plug the Type-C end of the USB-C cable into the power input port on the transmitter, and the USB-A end into the USB wall charger (included). Connect the charger to a power source and switch the transmitter power switch to ON. The LED indicator on the transmitter turns red.
- 2** Connect one end of the 3.5mm audio cable to the Aux port of the transmitter and the other end to your TV's audio output port.

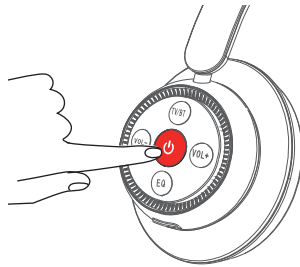
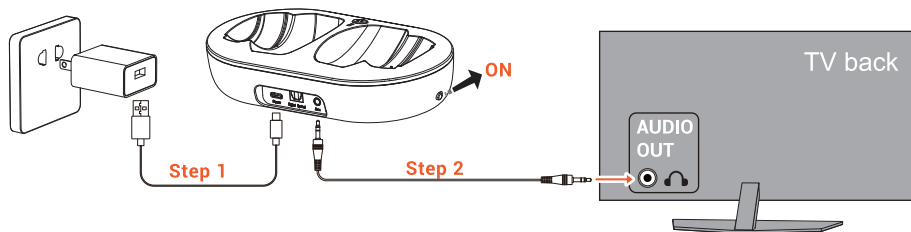

- 3** Turn on the headphones.

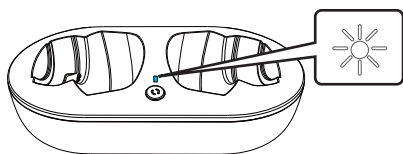

- 4** When the connection is successful, the LED indicators on the headphones and the transmitter stay white and you will hear a voice prompt "TV connected".

Connecting the transmitter to a TV using the USB-C cable

Method 4

1 For newer TVs, the USB port has the function of outputting digital audio signals. Plug the Type-C end of the USB-C cable into the charging port on the transmitter, and the USB-A end into the TV's USB digital audio signal output port. There is no need to use a power adapter, 3.5mm audio cable, RCA audio adapter cable, or optical audio cable.

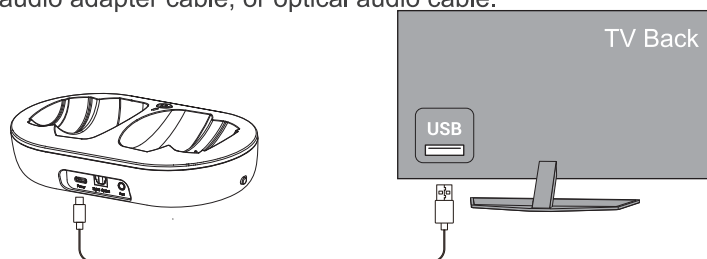

Note: This method is not applicable if your TV's USB port does not have the function of outputting digital audio signals. Please refer to the TV's instruction manual to determine whether the USB port has digital audio signal output capabilities. If it doesn't have digital audio signal output capabilities or the headphones don't sound when connected, use another method for connection.

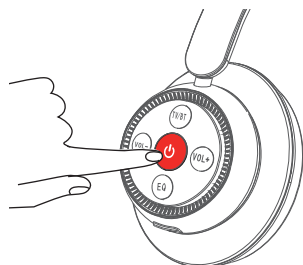

2 Turn on the TV and switch the transmitter power switch to ON.

3 Turn on the headphones.

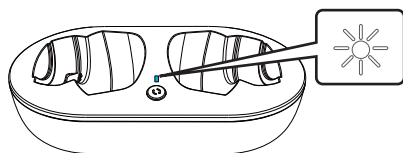

4 When the connection is successful, the LED indicators on the headphones and the transmitter stay white and you will hear a voice prompt "TV connected".

SPECIFICATIONS

- Operating Voltage: 5V/1A
- Battery Capacity: 500mAh
- Charging Time: About 3 hours
- Working Temperature: -10°C to 40°C

FAQs

Q: No sound comes from headphones, what should I do?

A: Check if the transmitter LED indicator stays white,

if NOT, do the following checks:

- Make sure the transmitter is connected to a power source.
- Make sure the transmitter have been turned on.
- Make sure the headphones have been turned on.
- Make sure the headphones is not in Bluetooth mode.

If the transmitter LED indicator stays white, do the following checks:

- If your TV has RCA outputs, please make sure the RCA adapter cable is plugged into RCA output ports behind the TV. Do not plug it into any RCA input ports behind the TV.

- If your TV has an optical output, please make sure the optical cable is plugged into the optical output port behind the TV. Do not plug it into any optical input port behind the TV.
- If your TV has a 3.5mm audio output, please make sure the 3.5mm audio cable is plugged into the audio-out port behind the TV. Do not plug it into any audio-in port behind the TV.
- Please make sure that your audio device is turned on and in play mode.
- If connecting the transmitter to a TV with a 3.5mm audio-out port, please do not mute your TV.
- Connect the headphones to your phone's 3.5mm audio output port to see if there is sound from the headphones.

If there is still no sound comes from headphones, please contact us.

Q: The volume is not loud enough, what should I do?

A: Turn up the volume of your headphones and TV to the maximum level.

Q: The headphones cannot be charged, what should I do?

A: Check if the headphones LED indicator is red during charging, if not, do the following checks:

- Make sure the charging dock is connected to a power source.
- Make sure the left and right earcups are oriented correctly when placed on the charging dock for charging.
- Make sure the charging contacts on the headphones match well with the charging pins on the charging dock.

Q: Sound only comes from headphones. What should I do if I need sound coming from headphones and TV simultaneously?

A: Please refer to the steps of the following methods for connecting the transmitter to a TV.

- **Method 1:** Connect the Transmitter to a TV using the optical audio cable.
- **Method 2:** Connect the Transmitter to a TV using the RCA adapter cable.

IMPORTANT SAFETY INSTRUCTIONS

- Use of headphones will impair your ability to hear other sounds. Use caution while using your headphones when you are engaging in any activity that requires your full attention.
- If you have a pacemaker or other electrical medical devices, you should consult your physician before using this product.
- This package contains small parts that may be hazardous to children and should be kept out of reach from children. This product is not a toy – never allow children to play with this product. Always store the product out of reach from children. The bags themselves or the many small parts they contain may cause choking if ingested.
- Never try to dismantle the product yourself, or push objects of any kind into the products, as this may cause short circuits which could result in a fire or electric shock.
- None of the components can be replaced or repaired by users. Only authorized dealers or service centers may open the product. If any parts of your product require replacement for any reason, including normal wear and tear or breakage, please contact us.
- Avoid exposing your product to heat and humidity to protect against damage to the product or injury to you.
- Keep all products, cords, and cables away from operating machinery.
- If the product overheats, if the product has been dropped or damaged, if the product has a damaged cord or plug, or if the product has been dropped in a liquid, discontinue use and contact us.
- Do NOT use in areas where there are explosive hazards.
- Do NOT submerge the headphones in water. Do NOT expose the headphones to moving water (e.g., from a faucet, etc.).
- Do NOT wear the headphones while showering or bathing, or when participating in water sports, e.g., swimming, water skiing, surfing, etc.
- This product contains magnetic material. Consult your physician on whether this might affect your implantable medical device.
- Leaving the product in hot or cold places, such as in a closed car in the summer and winter conditions, will reduce the capacity and lifetime of the headphones.
- Dispose of the product according to local standards and regulations.
- **Remember:** Always drive safely, avoid distractions and follow local laws!

Using the headphones while operating a motor vehicle, motorcycle, watercraft or bicycle may be dangerous, and is illegal in some jurisdictions, just as use of the headphones with both ears covered while driving is not permitted in certain jurisdictions. Check your local laws. Use with caution while using your headphones when you are engaging in any activity that requires your full attention. While engaging in any such activity, removing the headphones from your ear or turning off your headphones will keep you from being distracted, so as to avoid accident or injury. Do not take notes or read documents while driving.

WARRANTY

We strive to build our products with the highest attention to detail and craftsmanship. However, sometimes there are occurrences of a defect, so we are happy to offer a ONE-year hassle-free warranty to all our devices as we continue to make amazing products. Please contact us if you have any questions about our devices.

CARE AND MAINTENANCE

Only clean this product with a slightly damp, lint-free cloth and do not use aggressive cleaning agents.

Battery Warnings

- 1, Disposal of a battery into fire or a hot oven, or mechanically crushing or cutting of a battery, that can result in an explosion.
- 2, Leaving a battery in an extremely high temperature surrounding environment that can result in an explosion or the leakage of flammable liquid or gas
- 3, The battery subjected to extremely low air pressure that may result in an explosion or the leakage of flammable liquid or gas.
- 4, Replacement of a battery with an incorrect type that can result in an explosion or the leakage of flammable liquid or gas.
- 5, Battery cannot be subjected to extremely high or low temperatures, low air pressure at high altitude during use, storage or transportation.

FCC ID: 2A598-M98A

NOTE: This equipment has been tested and found to comply with the limits for Class B digital devices, in alignment with section 15 of the FCC Rules. These limits are designed to provide reasonable protection against harmful interference in a residential installation. This equipment generates uses and can radiate radio frequency energy and, if not installed and used in accordance with the instructions, may cause harmful interference to radio communications. However, there is no guarantee that interference will not occur in a particular installation. If this equipment does cause harmful interference to radio or television reception, which can be determined by turning the equipment off and on, the user is encouraged to try to correct the interference by one or more of the following measures:

- Reorient or relocate the receiving antenna.
- Increase the separation between the equipment and receiver.
- Connect the equipment into an outlet on a circuit different from that to which the receiver is connected.
- Consult the dealer or an experienced radio/TV technician for help.

Changes or modifications not expressly approved by the party responsible for compliance could void the user's authority to operate the equipment.

This device complies with Part 15 of the FCC Rules. Operation is subject to the following two conditions:

- (1) this device may not cause harmful interference, and
- (2) this device must accept any interference received, including interference that may cause undesired operation.

FCC RF exposure statement:

The equipment complies with FCC radiation exposure limits set forth for an uncontrolled environment. This equipment should be installed and operated with minimum distance between 20cm the radiator your body.