



USER MANUAL

Car LED Strip Light



Please scan this QR code, or download the "istrip" APP in iPhone store or Google play store.

Features

1. Adjust color LED strips with 60,000 colors to change color and brightness and adjust monochrome LED strips to change brightness and color temperature.
2. Play music or turn on a sound playback device, you can let the light change the color and brightness with the rhythm of music, the music rhythm beautiful.
3. Inside multiple setting mode for color change and control LED strips without mobile.
4. long distance control with omni-directional antenna, and many-to-many group control mode.
5. Once the connection is successful connect automatically next time.

Specifications

Dynamic mode	4 modes
Static Color	8colors
PWM Grade	256 levels
Brightness Grade	8 levels
Speed Grade	8 levels
Working Voltage	DC 5-24V
Remote distance	> 15m at open area
Package Includes	2 x 35 inch light strips, 2 x 47 inch light strips, 1 x control box, 1 set of adhesive, clips, cable ties and screws, 1 x user manual

2-Line Strip Design Fits Your Car Easily

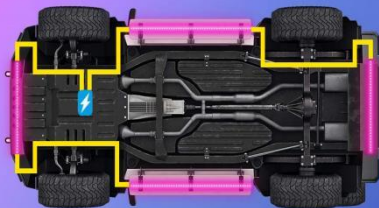
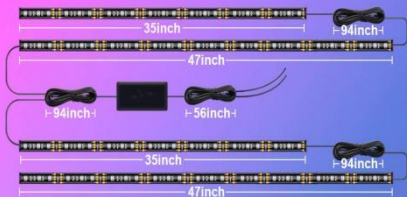

How to Install?



1.Power on to check light



2.Wipe the surface



3.Stick it on clean, dry place



4.Reinforce by zip ties and screws

Note: You can connect the power cord to Cigarette lighter, car battery, or any 12V battery. The red wire is positive pole, the black wire is negative pole.

How to Set Up the App?

Open the app, click the icon: Click “Allow” to enable your Bluetooth.

1.  Settings: You can set rhythm, RGB sort, code, shake, change skin.

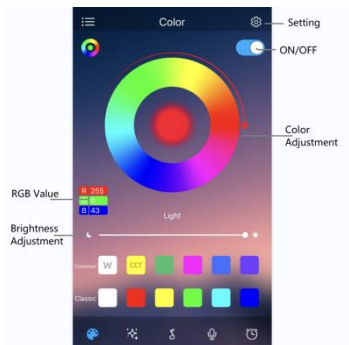

2. ❄ Mode Interface: You can choose mode, adjust the speed, brightness you want.

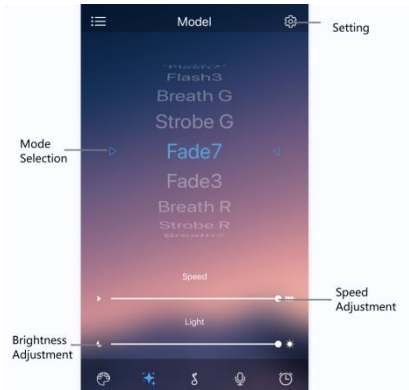

3. 🎵 Music Interface: In music mode, the color changes by your mobile phone music; In microphone mode, the color changes by exterior sound.

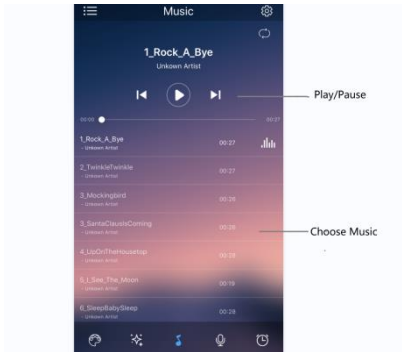

4.  **Timing Function:** You can plan the time to turn on or turn off the light strip.

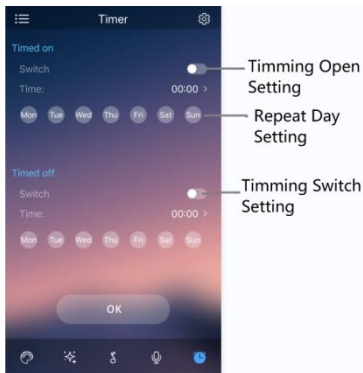

Question & Answer

1. Do they stay one color ?

-- Yes, this light strip supports a solid color and RGB color.

2. If the light turns on by itself, what is the reason?

-- You need to make sure the APP is not accidentally getting hit and turning it on.

3. There would be a problem if I connect them to the cigarette lighter?

-- No problem, you can connect this exterior car light to the car battery, or cigarette lighter.

4. How do I get my phone to connect to the lights?

-- Download and open the App. Click "Allow" to enable your Bluetooth.

5. If the item stops working after a few days, what should I do?

-- Please **Contact Us** for customer service.

Warm Tips

1. The sensor has to be put on or near the speaker.
2. Please wipe clean the surface of the place before you install the Car LED Strip Lights. Use zip ties to tighten up wires.

Quality Warranty

FOVAL Car LED Light with **24 Months** quality warranty. If any problem, please feel free to contact us by Amazon, or

Email: fovalservice@outlook.com

Our professional team will solve your problem within 12 hours! Thanks for your support!

FCC Requirement

Any changes or modifications not expressly approved by the party responsible for compliance could void the user's authority to operate the equipment.

This device complies with Part 15 of the FCC Rules. Operation is subject to the following two conditions:

- (1) this device may not cause harmful interference, and
- (2) this device must accept any interference received, including interference that may cause undesired operation.

Note: This equipment has been tested and found to comply with the limits for a Class B digital device, pursuant to Part 15 of the FCC Rules. These limits are designed to provide reasonable protection against harmful interference in a residential installation. This equipment generates, uses, and can radiate radio frequency energy, and if not installed and used in accordance with the instructions, may cause harmful interference to radio communications. However, there is no guarantee that interference will not occur in a particular installation. If this equipment does cause harmful interference to radio or television reception, which can be determined by turning the equipment off and on, the user is encouraged to try to correct the interference by one or more of the following measures:

- Reorient or relocate the receiving antenna.
- Increase the separation between the equipment and receiver.
- Connect the equipment into an outlet on a circuit different from that to which the receiver is connected.
- Consult the dealer or an experienced radio/TV technician for help.