

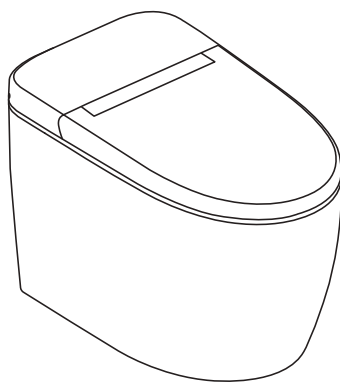



# Instruction Manual

T181 SERIES

Smart Toilet



- 
- ※ Please read this Instruction Manual before installing or using your product.
  - ※ Please keep this Instruction Manual properly in a safe place for future reference.

# Table of Contents

Safety precautions.....	1
Component list.....	4
Specification.....	5
Parts names.....	6
Product drawing .....	7
Power and water connection.....	7
Installation precaution.....	8
Product installation.....	9
Instructions for Remote Control Installation.....	14
Remote Control Panel Using Instruction.....	15
Other Functions Instruction.....	15
Cleaning & maintenance.....	16
How to do?.....	17
Trouble shooting.....	18
Maintenance service sheet.....	19



# Safety Precautions

To prevent damage to the unit and possible injury to users, please follow the safety warnings. Please be sure to carefully read through the user's manual before installation. Keep the user's manual after installation to refer to for troubleshooting advice.

## Symbols And Meanings

 WARNING	Could result in serious injury or death.
---	--

The following symbols are used to indicate important safety precautions when using the product.

	Prohibited.
	Pay close attention; caution.



## WARNING



Prohibited

It is not allowed to continue using if the product has some breakdown:

Product heat abnormally;

Product is smoking;

Product has abnormal sound and smell;

Product is leaking, broken or damaged;

Toilet pan is blocked, etc.

When the breakdown happens, if it do not handle in time and continue using, it might trigger the problems like electric shock, injury, firing or water penetration inside the room, etc.

Banana oil, gasoline, putty-powder, nylon brush or other (non-neutral) detergent is not allowed to clean the plastic parts like toilet seat cover, otherwise it might trigger chemical reaction or leakage, damage the product and cause people injury.

Loosen electric outlet is not allowed as it might trigger electric shock or firing.

It is not allowed to pull out and plug in the electric plug by wet hand as it might trigger electric shock or firing.

It is not allowed to touch the electric plug when it is thundering and lighting as it might trigger electric shock.

It is not allowed to use other electric resource, the load of using electric outlet could not be too big, as it might trigger firing due to over-heat.

Detergent, water, wash detergent or urine is not allowed to spot into body and electric outlet, as it might trigger electric shock or firing.

It is not allowed to let child standing or put heavy goods on the seat and cover, toilet pan or seat body, heavy hitting or knocking is not allowed.

It is not allowed to disassemble, repair this product, (it must go for professional repair person service if it is necessary to repair), otherwise, it might cause the damage to this product.

Do not randomly damage the electric plug and electric line, if the electric line, electric plug is damaged, please do not use it any longer or repair by oneself, it must be repaired by professional person, otherwise, it might trigger short-circuit, electric shock, firing.

If the power cord is not long enough, please do not use a extension cord.

The stove or lighted cigarette is not allowed to be placed next to the toilet pan, cigarette butt etc is not allowed to be thrown into toilet pan.

Do not block the air openings of the product. Keep the air openings free of lint, hair, and the like.

Do not use while bathing.



## WARNING

When using in shower room, please install air exchange equipment to ensure the air in the shower room not too moist. This product is electric products, it is not allowed to install it in the place that is easy high wet, easy split by water, otherwise it might trigger electric shock or fire.

Please ensure to cut off the electric power before washing this product, do not use water to directly wash this product, otherwise it might trigger the electric shock or fire.

Please put and use this product in the shadow, must not put directly beneath the sun, otherwise it might cause the color-fading, or burn the surface of product due to the instability of temperature.

Do not use industrial water, wastewater, seawater, reclaimed water and other sewage, otherwise it may cause skin inflammation and other problems.

Persons (including children) with physical, perceptual, intellectual disabilities or lack of experience and common sense need to use the product under the guidance or supervision of someone else, or they may cause electric shock, injury or fire.

Please notice the assembly location of electric wiring plug, electric plug should be the water-proof plug. Assembly location of electric plug must be over 0.5m(19.7in) above the floor, and far away from shower, bathtub, otherwise it might cause electricity leakage.



Caution

When installing this product, please remove the old hose assemblies owned by users and install them with new hose assemblies. Do not reuse the old hose assemblies to avoid related safety problems.

The grounding wire of this product must conform to the stipulated construction mode, and the three-level grounding structure must be grounded, otherwise the use of this product is prohibited.

Electric plug need to plug in the electric with air switch.

In the same room where this product is installed, a switch of water inlet angle valve needs to be installed at a location within reach. It is used in emergency situations to cut off the waterway of this product without the aid of tools; otherwise, unexpected failures of this product may occur and it will cause user loss.

If you have not used this product for a long time, please close the angle valve, press the water release button to drain the water of ceramic itself and cut off the power; When using the product again, please wash first to prevent water quality problems and skin diseases.

When the outside air temperature is lower than 0°C, in order to prevent water leakage caused by external filter and other accessories likely freezing, please be sure to close the water inlet valve and drain the left water; If pipe has been frozen, please raise the room temperature and wait for pipe normal then use the toilet, otherwise the product may not be used normally.

# Component list

## SMART TOILET

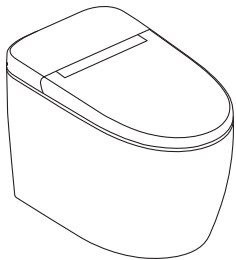

SEALING RING



TEFLON TAPE



15/16-14UNS ADAPTER



USER MANUAL

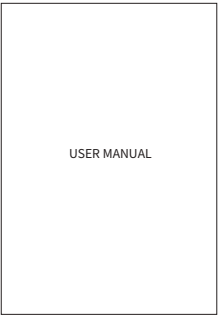

INLET VALVE

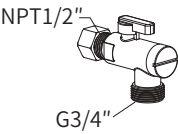

REMOTE CONTROL



# Specifications

Rated voltage		120V~ 60Hz			
Power cord length		About 1.2m (49 in)			
Seat	Surface temperature	4 levels adjustable, room temperature about 107°F			
	Safety device	Thermal fuse			
Toilet	Flush consumption	1.28Gpf/4.8Lpf			
	Flushing mode	Siphon jet			
	Rough-in	305mm (12.0 in)			
Rated power	63W	Maximum power	70W	Waterproof level	IPX4
Water supply temperature	39°F-95°F	Ambient temperature	37°F-104°F	Net weight	About 34.7kg (about 76.5 lb)
Dimension	About 680 * 390 * 443 mm (About 26.8 * 15.4 * 17.4 in)	Water supply pressure	Minimum necessary dynamic pressure: 0.16MPa (flow rate 20L/Min) Maximum static pressure: 0.75MPa		

- ※1:Rated power: Set the seat temperature to the highest level under the conditions of an ambient temperature of 68°F±41°F, inlet water static pressure 0.18MPa±0.02MPa, Turn on the flush function, and test the average power within 60 seconds.
- ※2:Maximum power: Set the seat temperature to the highest level under the conditions of an ambient temperature of 73°F±35°F, an inlet static pressure of 0.18MPa±0.02MPa, Turn on the flush function and continue to work stably at the maximum power for a cleaning cycle.
- ※3:Water consumption test: Test the water consumption separately under the water pressure 0.16Mpa and 0.55Mpa three times. Get six values in total,then divide the sum by six and the average is the nominal water consumption.



# Parts Names

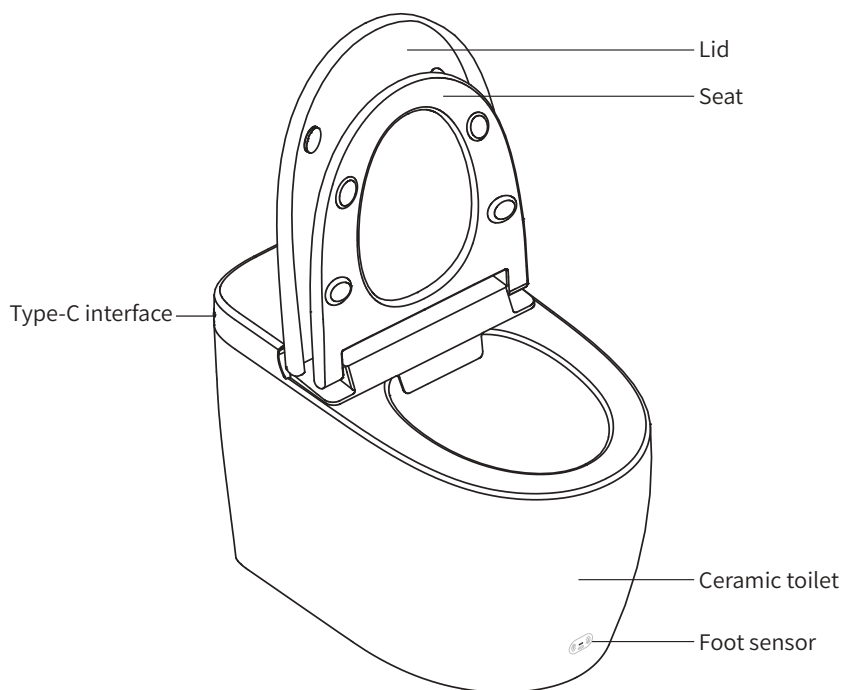

# Product Drawings

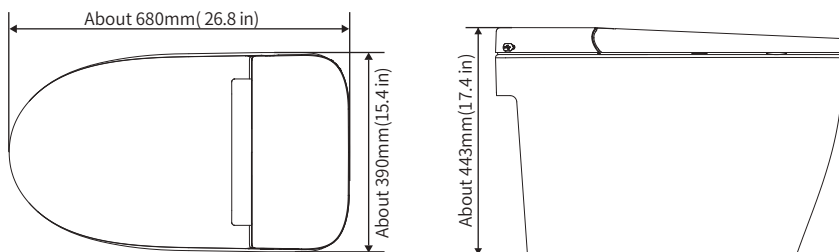

## Power and Water Supply Connection

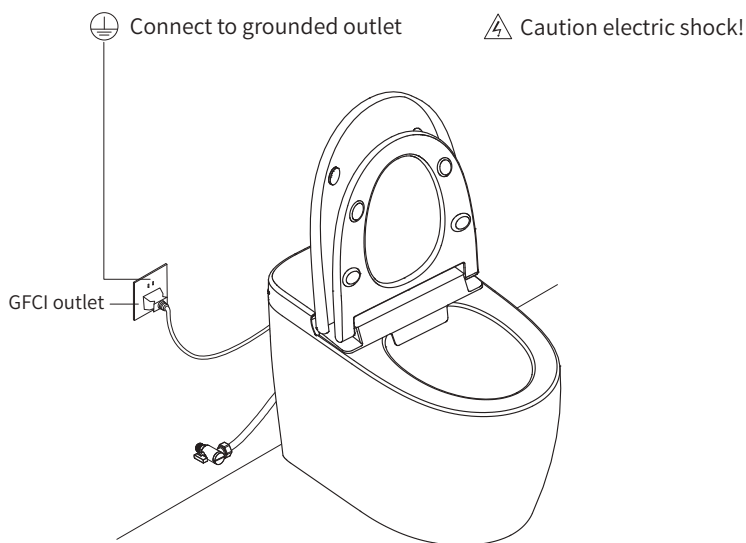

- ※ If the power cord is not long enough, please use extension line which is made by certificated manufacturers.
- ※ Only for reference.

# Installation Precaution

We reserve the right to change, update, modify, alter, redesign this manual/product or its policies without prior notice!

We shall not be liable for any injuries or property damages in connection with this product during installation or use of the product!

The product must be installed by a fully insured and licensed plumber only. Installation of the product by anyone other than fully insured and licensed plumber shall void limited warranty. We recommend that the licensed plumber have experience in the installation of the product.

During unpacking the product and prior to installation inspect your new product for any damages or missing parts. Do not attempt to install or operate the product if the product is damaged.

## Installation Tools

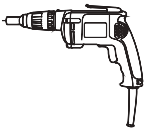

Hammer Drill

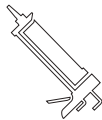

Caulking Gun



Tape Measure

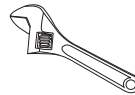

Adjustable Wrench



Pliers

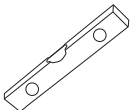

# Product Installation

## 1. Install the water inlet valve

Clean the ground and dry the water before installation. Mark the central lines of the draining outlet, and install the inlet valve on the wall.

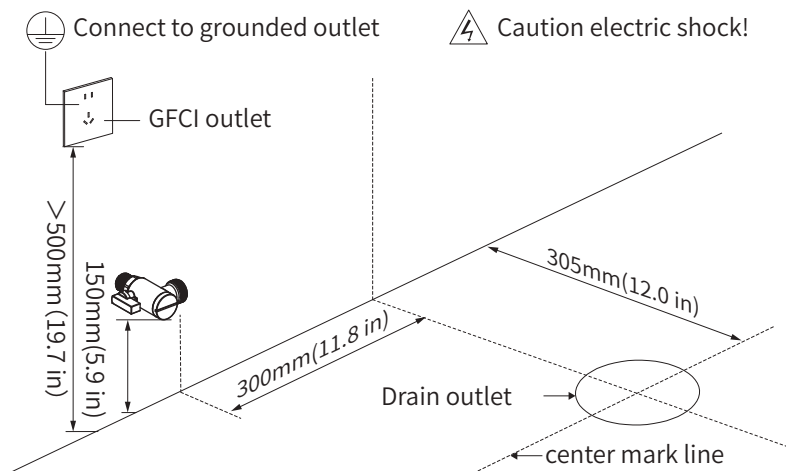

## 2. Mark the curve of ceramics

Align the drain hole of ceramic with the central line. Mark the curve of ceramics for later installation.

Silicone sealant application: Glue the outline with silicone sealant.

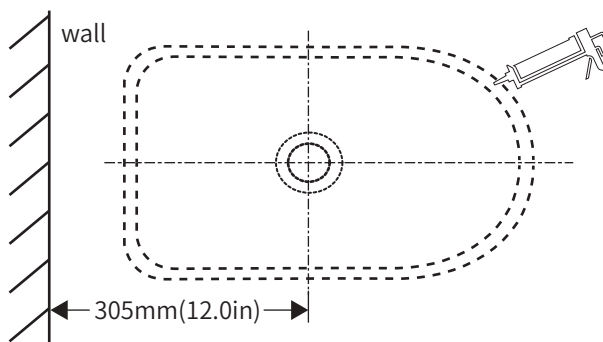

# Product Installation

## 3.Toilet installation(Method 1)

### ① Sealing ring installation

Gently tilt the toilet sideways until it rests on the side surface.

Install the sealing ring evenly along the outlet, and the small end of the sealing ring facing the toilet.

Glue the edge of toilet bottom with silicone sealant, place the toilet base along the outline and position the toilet base.

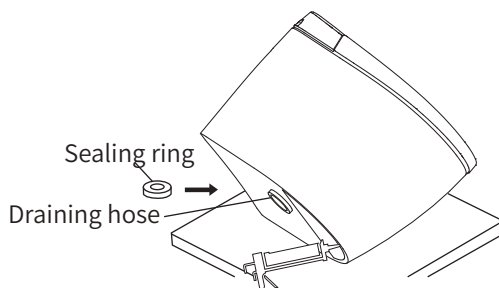

### ② Toilet (ceramic) installation

Lift the toilet, take the floor drain as a reference, align the ceramic body of the toilet with the ceramic contour line drawn on the ground, and slowly put the ceramic on the ground so that the two marks overlap. After overlapping, press the ceramic down (can be pressed by the weight of the human body) so that the sealing ring fully contacts the ground.

※Do not move the ceramic or shake it left and right after the marks are overlapped, otherwise the seal produced by the sealing ring may be damaged and cause water leakage.

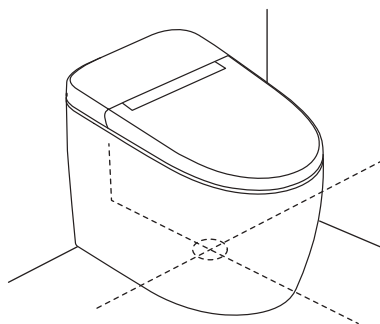

# Product Installation

## 4.Toilet installation(Method 2)

### ① Remove the bidet seat

Remove the fixing screws of the toilet; remove the connecting pipes and wires of the toilet, separate the bidet seat from the toilet.

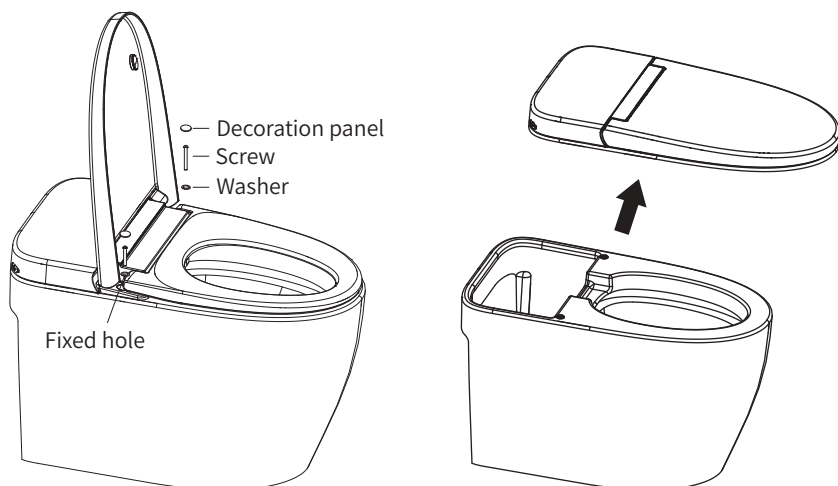

### ② Sealing ring installation

Place the sealing ring onto the flange.

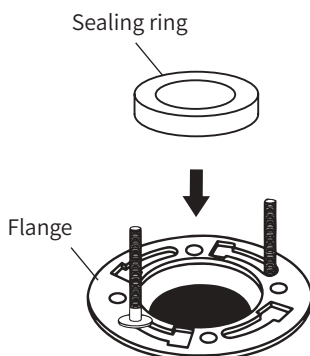

# Product Installation

## ③ Ceramic installation

Glue the edge of toilet bottom with silicone sealant.

Line up the toilet base over the flange screws.

Place the toilet base and secure the flange bolts.

Glue the edge of toilet bottom with silicone sealant, place the toilet base along the outline and position the toilet base.

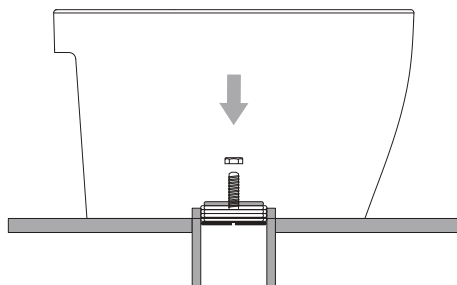
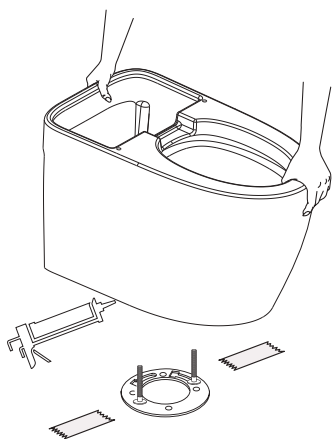

## ④ Bidet seat installation

Adjust the bidet seat to match the toilet, use screws to fix the bidet seat on the toilet.

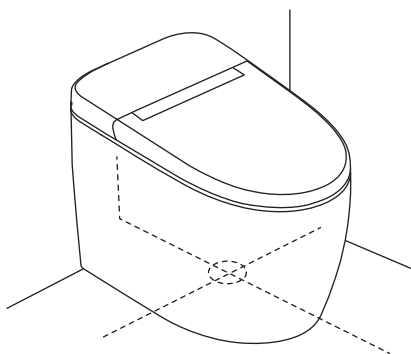
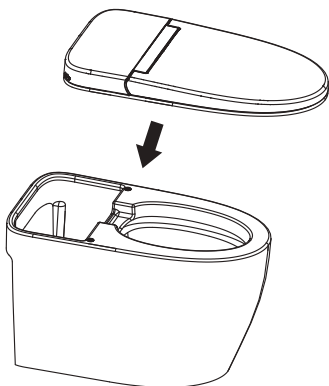

# Product Installation

## 5. Connect the water inlet valve and filter

As shown in the following figures.

### NOTE:

Do not use the smart toilet immediately after installation, use it after 48 hours.

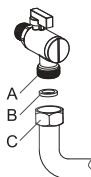

1. Install the part A water inlet valve.
2. Connect part B and part C to the part A water inlet valve.
3. Finished, connect to the power.

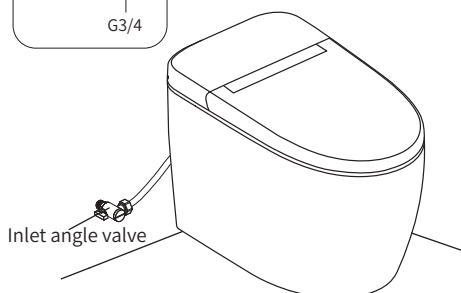

## 6. Connect to the power

Only connect this product to a properly grounded outlet.

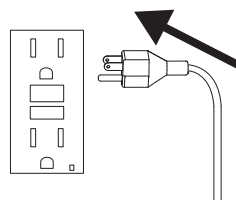

## 7. Using the product for the first time

- ① Connect to the power and open the water inlet valve.

Check every function buttons of the remote control (only flush function) and side control. such as LED, seat temp adjustment, etc.



# Instructions for Remote Control Installation

Base, Lock, Unlock, Coin, Edge, Battery Insulation Sheet, Code Pairing Button, Arrow Mark, Double Side Adhesive Tape, 1 to 1.5 meters above the ground

1. Use a coin or other objects to turn the base counterclockwise about 10° to unlock the base and then use fingernail or sharp objects to remove the base.
2. Pull out the insulation sheet of the battery to make the remote connect to the power.
3. Code Pairing: After the remote and toilet are powered on and self-tested, press and hold the code pairing button for about 5 seconds. After a long "beep" prompt tone heard, the code pairing is completed.
4. Re-install the base and then use a coin or other objects to turn the base about 10° clockwise to lock the base.
5. Clean the dust, oil stains, water droplets, etc. on the wall and wipe them clean.
6. Tear off the white sticker on the double-side adhesive tape on the back.
7. Choose a location close to the toilet (1 meter to 1.5 meters above the ground, adjust the height according to actual usage). Press the remote firmly against the wall evenly and let it sit for 24 hours.

## Battery Replacement Instructions

1. Use a coin or other objects to turn the base counterclockwise about 10° to unlock the base and then use fingernail or sharp objects to remove the base.
2. Take out the CR2032 button battery.
3. Insert the new battery.
4. Re-install the base and then use a coin or other objects to turn the base about 10° clockwise to lock the base.

# Remote Control Panel Using Instructions

REMOTE CONTROL

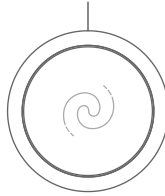

## ■ Flush

- Press the button to flush the toilet.

## Other Functions Instruction

### ■ Kick sensing

- Gently touch the foot sensor to activate the auto flushing function.

### ■ Pre-wetting

- Once sitting on the seat, the pre-wetting function will be activated to help reduce waste build-up.

# Maintenance and Cleaning

## Maintenance and cleaning of toilet lid and seat

1. Turn off the power, close the water outlet valve.
2. Use soft cloth to clean the lid and seat.
  - ※Be careful not to allow water to get inside or leave detergent in the gap between the top unit and the bowl unit.
  - ※Avoid using materials that will damage the surface. Clean the surface with a soft and wet cloth.
  - ※Corrosive chemicals or cosmetics (such as cleaners containing abrasive compounds and aftershave) can not be used to clean the lid and seat.
3. Turn on the power, open the the water outlet valve.

## Maintenance and cleaning of the toilet bowl

1. Turn off the power.
2. Use toilet brush and toilet detergent to clean the bowl.
  - ※Corrosive chemicals (such as cleaners containing abrasive compounds and strongly acidic cleaners or strong alkaline cleaners) should not be used to clean the bowl.
  - ※Wire brush or abrasive nylon scrubbing brush should not be used to clean the bowl.
3. Turn on the power.

## Cleaning The Water Filter

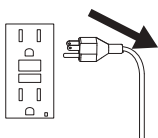

- ① Turn off the power  
Close the water outlet  
valve.

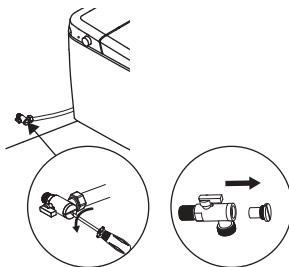

- ② Remove the water-inflow filter from  
the inlet hose.
- ③ Take out the filter by using a flat-blade  
screwdriver to unscrew the filter .



- ④ Remove the filter and rinse it with  
clean water.
- ⑤ Install the filter screen as it is, be  
sure to tighten it, otherwise it will  
cause water leakage.

# How to do?

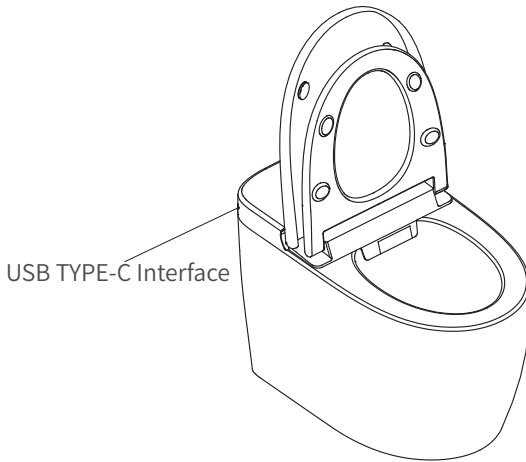

## **1. When the toilet can not flush automatically due to power outage.**

Connect the smart toilet with power bank through the TPYE-C interface.

## **2. When the toilet can not flush automatically due to water outage.**

- ① Flush the sewage in the toilet away with basin.
- ② After flushing, add water to the toilet to avoid stinking.

## **3. When the product is left unused for long time**

- ① Turn off the power, and close the Angle valve, drain the water in the inlet hose.
- ② Especially in winter, the water inside the hose of the toilet should be discharged to avoid freezing.

# Trouble Shooting

Phenomenon	Reasons	Measures
The product out of work	Whether the power supply is plugged in.	Insert the plug or detect the power socket.
	Power outage.	Wait until the power supply restored.
Water comes out unexpectedly from the inlet hose.	The inlet hose is defect.	Replace the inlet hose.
The toilet seat does not get warm.	The seat sensor does not sense someone sitting.	Sit on the toilet seat properly.
	Low seat temperature.	Use the side control to adjust seat temperature.
The toilet does not flush.	Water is not available from the water supply.	Taking water to flush.
	The water supply valve is not fully open.	Check the Angle valve.
The sewage can not be flushed away completely.	The water supply valve is not fully open.	Check the Angle valve.
	The water filter is clogged.	Clean the filter.
	The water supply pressure is weak.	Check the water supply.
	Flushing may be difficult due to the consistency of the waste material.	Flush the toilet again. If the bowl is not cleaned with a flushing, remove the stains with a brush or other tools.
There is residue on the bowl unit surface.	Oil and other hard-to-see grime may stick to the bowl unit surface.	Clean the bowl with a non-abrasive toilet detergent.
The remote control fail to control the toilet.	Low battery.	Replace with new batteries.
	Battery polarities are mounted reversely.	Reinstall properly.
	The remote control is too far from the toilet.	Get close to the toilet.
LED light doesn't turn on.	The indoor light is too bright.	Please turn off the indoor light and close the curtain.
The top unit is unstable.	There is clearance between the toilet seat cushion and the bowl.	It's common phenomenon.
Water is leaking from pipe joints.	Pipe joints are loose.	Tighten the hose.
	Pipe joints keep leaking.	Close the water outlet valve and replace a new hose.

## ※ Notice

When encountering a problem, please read the above common troubleshooting carefully, and follow the solution instructions for product maintenance;

Please contact professional maintenance personnel, dealers or LEIVI after-sale service team in time to seek help. There may be differences between the contents of this manual and the actual product, and the actual product shall prevail.

# Maintenance Service Sheet

Product		Product code	
The selling store		Purchase date	
Province	City	Dealer ( signature ):	
Maintenance content			
<p><b>Free maintain regulation:</b></p> <p>1. LEIVI warrants its products to be free from defects in materials and workmanship during normal use when properly installed and serviced, for a period of three (3) years from date of purchase. This limited warranty is extended only to the ORIGINAL PURCHASER of the product and is not transferable to any third party, including but not limited to any subsequent purchaser or owner of the product. This warranty applies only to LEIVI product is purchased and installed in USA and Canada.</p> <p>2. LEIVI's obligations under this warranty are limited to repair, replacement or other appropriate adjustment, at LEIVI's option, of the product or parts found to be defective in normal use, provided that such product was properly installed, used and serviced in accordance with instructions. LEIVI reserves the right to make such inspections as may be necessary in order to determine the cause of the defect.</p> <p>3. This warranty does not apply to the following items:</p> <p>a) Damage or loss sustained in a natural calamity such as fire, earthquake, flood, thunder, electrical storm, etc.</p> <p>b) Damage or loss resulting from any accident, unreasonable use, misuse, abuse, negligence, improper care, or maintenance of the product.</p> <p>c) Damage or loss resulting from sediments or foreign matter contained in a water system.</p> <p>d) Damage or loss resulting from the quality of water in the region where the product is used.</p> <p>e) Damage or loss resulting from improper installation or from installation of the product in a harsh and/or hazardous environment, or improper removal, repair or modification of the product.</p> <p>f) Damage or loss resulting from electrical surges or lightning strikes or other acts which are not the fault of LEIVI or which the product is not specified to tolerate, including failure to use the factory equipped cord and plug or use of a loose or faulty electrical outlet or use of a current or socket other than a 120V, 60Hz electrical current from a GFI (ground, fused) socket.</p> <p>g) Damage or loss resulting from normal and customary wear and tear, such as gloss reduction, scratching or fading over time due to use, cleaning practices or water or atmospheric conditions, including but not limited to, the use of bleach, alkali, acid cleaners, dry (powder) cleaners or any other abrasive cleaners or the use of metal or nylon scrubbers.</p>			
<p>Executive standard: CONFORMS TO UL STD. 1431/UL STD. 1591 ASME A112.4.2-2021</p> <p>Warranty period: within three years from the purchase date</p>			

- Due to the constant improvement about our products, we will keep the final interpretation of products change.
- If the products you bought exist differences from the instruction, please in kind prevail.



**NOTE:** This equipment has been tested and found to comply with the limits for a Class B digital device, pursuant to Part 15 of the FCC Rules. These limits are designed to provide reasonable protection against harmful interference in a residential installation. This equipment generates uses

and can radiate radio frequency energy and, if not installed and used in accordance with the instructions, may cause harmful interference to radio communications.

However, there is no guarantee that interference will not occur in a particular installation. If this equipment does cause harmful interference to radio or television reception, which can be determined by turning the equipment off and on, the user is encouraged to try to correct the interference by one or more of the following measures:

- Reorient or relocate the receiving antenna.
- Increase the separation between the equipment and receiver.
- Connect the equipment into an outlet on a circuit different from that to which the receiver is connected.
- Consult the dealer or an experienced radio/TV technician for help.



**Xiamen Hanzun E-Commerce Co., Ltd.**

Add: Room 902, No. 370, Chengyi Street,  
Phase III Software Park, Torch High-tech District,  
Xiamen City, Fujian Province, China.

Email: [support@ileivi.com](mailto:support@ileivi.com)

Website: [www.ileivi.com](http://www.ileivi.com)

Made in china

### FCC Caution :

This device complies with part 15 of the FCC Rules. Operation is subject to the following two conditions: (1) This device may not cause harmful interference, and (2)

this device must accept any interference received, including interference that may cause undesired operation.

Any Changes or modifications not expressly approved by the party responsible for

compliance could void the user's authority to operate the equipment.

Note: This equipment has been tested and found to comply with the limits for a Class

B digital device, pursuant to part 15 of the FCC Rules. These limits are designed to provide reasonable protection against harmful interference in a residential installation.

This equipment generates uses and can radiate radio frequency energy and, if not installed and used in accordance with the instructions, may cause harmful interference

to radio communications. However, there is no guarantee that interference will not

occur in a particular installation. If this equipment does cause harmful interference to

radio or television reception, which can be determined by turning the equipment off

and on, the user is encouraged to try to correct the interference by one or more of the

following measures:

- Reorient or relocate the receiving antenna.

- Increase the separation between the equipment and receiver.

- Connect the equipment into an outlet on a circuit different from that to which the

receiver is connected.

- Consult the dealer or an experienced radio/TV technician for help.

The device has been evaluated to meet general RF exposure requirement. The device

can be used in portable exposure condition without restriction