

尺寸: 95*50mm折页, 材质: 128克铜版纸+单色印

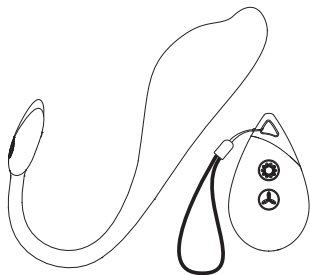

User manual

Please read this manual carefully before using the product.
This product is only for people over 18 years of age.



EN

Specifications

Model: A0373

Materials: Liquid silicone

Motor: 1 unit

Vibration modes: 9

Rate voltage: 3.7V

Charger: 5V /1A ,2A

Size: 230*39*39mm

Accessories: 1*USB charging cable,1*manual,
1*lanyard

Warn: do not use a charger over 5V to charge the product

Charging diagram

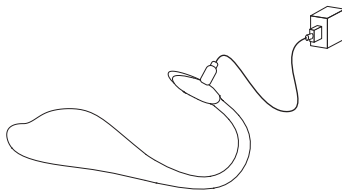

The indicator light is blinking while charging. The indicator light is always on when full charged.

Features

Press A button 2 seconds to turn on/off the toy,press shortly to change the vibration modes.

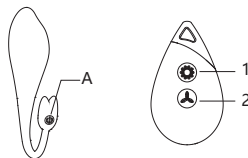

Remote distance: $\leq 10M$

Press shortly 1 to change the modes.
Press shortly 2 to pause.

Remote control disassembly diagram:

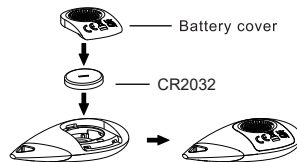

Note

- 1, Please charge fully the product before the first use.
- 2, Please use the product with lubricant for a better experience.

This device complies with part 15 of the FCC Rules. Operation is subject to the following two conditions: (1) this device may not cause harmful interference, and (2) this device must accept any interference received, including interference that may cause undesired operation.

Any changes or modifications not expressly approved by the party responsible for compliance could void the user's authority to operate the equipment.

NOTE: This equipment has been tested and found to comply with the limits for a Class B digital device, pursuant to Part 15 of the FCC Rules. These limits are designed to provide reasonable protection against harmful interference in a residential installation. This equipment generates, uses and can radiate radio frequency energy and, if not installed and used in accordance with the instructions, may cause harmful interference to radio communications.

However, there is no guarantee that interference will not occur in a particular installation. If this equipment does cause harmful interference to radio or television reception, which can be determined by turning the equipment off and on, the user is encouraged to try to correct the interference by one or more of the following measures:

- Reorient or relocate the receiving antenna.
- Increase the separation between the equipment and receiver.
- Connect the equipment into an outlet on a circuit different from that to which the receiver is connected.
- Consult the dealer or an experienced radio/TV technician for help.

The device has been evaluated to meet general RF exposure requirement. The device can be used in portable exposure condition without restriction