

Remote control mounted on handlebar

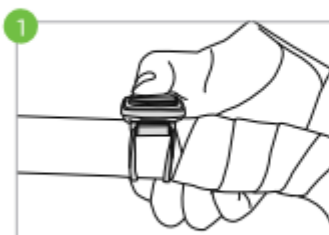

Place the CUTE EYE near the top of the seatpost

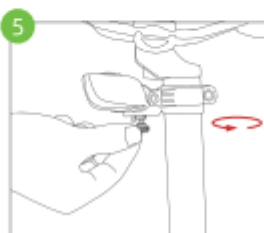
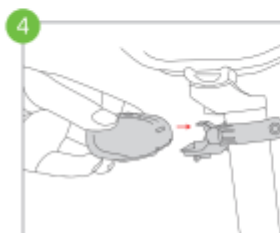
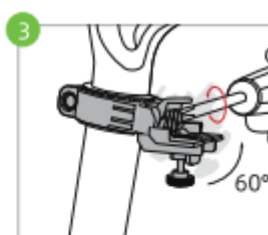
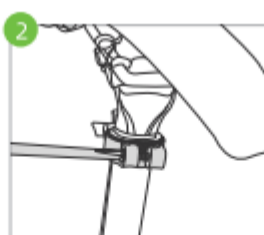

Remove light body

Slightly press the fixed buckle and take out the light body.

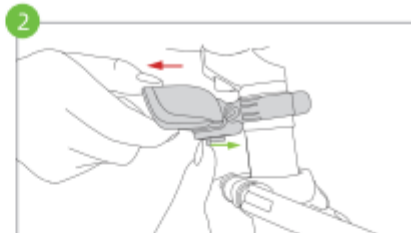
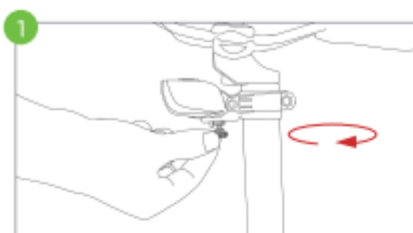



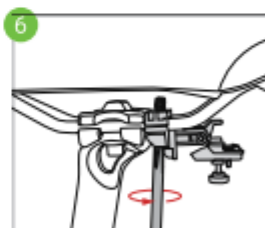
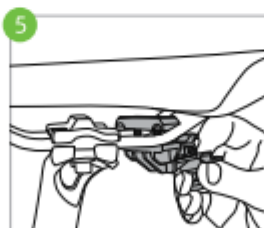
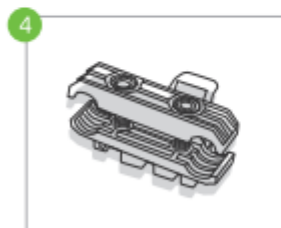
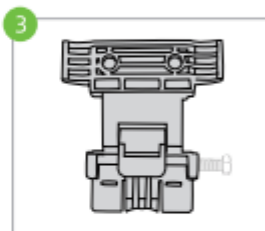
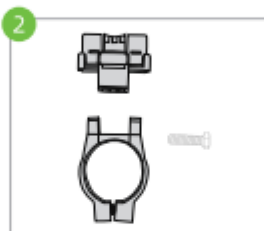
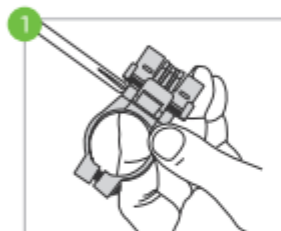

Secure on saddle rail

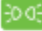

Buttons and functions

 **Short press:** the laser light is always on/flashing/off.

 **Short press:** light mode switch.
Long press: the tail light turns off. If there is no movement for 30 minutes, the tail light will enter the automatic shutdown state. You must long press  to turn it on again.

 **Short press:** turn left.
Short press again: stop left turn signal.
 **Short press:** turn right.
Short press again: stop right turn signal.

 **Short press:** change light mode.
Long press: turn on.
Long press again: turn off.

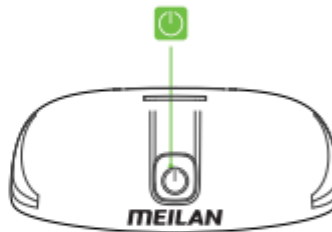
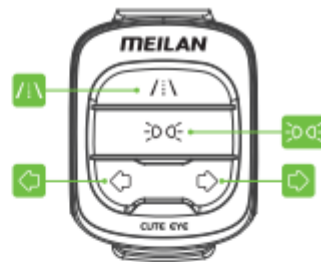

How to pair ?

Remote control and tail light pairing

Turn off Cute Eye. Long press and hold  until two yellow lights appear on the right (Cute Eye is in the pairing mode). Short press any button on the remote control and start pairing. Cute Eye is successfully paired when it appears full yellow light mode.

Enable and disable automatic brake warning function

Switch automatic brake warning functions in the charging state. Press and hold  button for 1 second, if four red lights in the middle flashing irregularly, it means the automatic brake function has been enabled; if four red lights in the middle stay on, it means automatic brake function has been disabled.

Cute Eye uses a built-in chip to intelligently detect the occurrence of braking behavior. Due to the diversity of road conditions and personal usage habits, 100% accurate detection is currently not available. If it affects your using experience, please turn off this function.

Reminder: this product uses lasers that comply with the American UL standard in the global area. Laws and regulations may apply to some European countries, the products sold by sellers may not contain laser light function. Please pay attention to the notification.

Specifications

1. Battery type: rechargeable 18650 lithium battery, 2500 mAh
2. Wireless transmission method: Bluetooth BLE
3. Working frequency band: 2.4G HZ
4. Ambient temperature: -10 to 40 °C
5. Waterproof level: IPX6

Charging

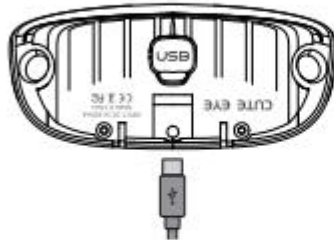

TYPE-C port, input DC 5V 500mA

Replacement of remote control battery

Please replace the battery in the remote control when the LED no longer lights up. The remote control is powered by a CR2032 button battery. Please use a standard brand battery. The battery has positive and negative polarity. Please install it in the correct way.

Unlock the buckle of the plastic shell as shown in the figure down below. Take out the circuit board and the battery to place the new one.

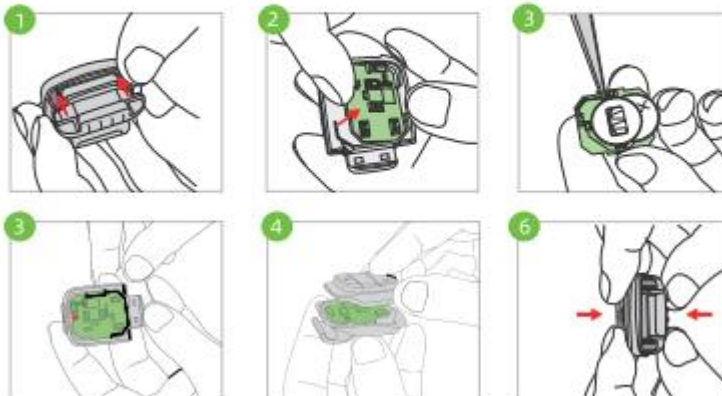

Safety statement and warranty

1. Do not throw used batteries into water or an uncontrolled natural environment. Do not place this product on fire or in an extremely high temperature environment.
2. When the product is not used continuously for six months, please charge it at least once before using.
3. This product is suitable to use from light to moderate rain. Do not use the product in the heavy rain or immerse it in water.
4. The automatic turning function provided by this product is only an auxiliary reminder function. Due to temporary change of the road or uncontrollable factors in product itself, the turning indication may violate your actual driving direction. Please do not take Cute Eye's turning indication as the main safety guarantee. Consumers shall bear the personal and property safety losses caused thereby.
5. This product was developed in accordance with the EN300328V1.9.1 standard. Please observe the local laws and regulations when using it in different countries and regions.
6. The product is guaranteed for one-year warranty for non-human damage (from the date of sale), and the accessories are not covered by the warranty. You can contact the after-sales service through MEILAN global distributors or by writing to MEILAN.

FCC Warning

This device complies with part 15 of the FCC rules. Operation is subject to the following two conditions: (1) this device may not cause harmful interference, and (2) this device must accept any interference received, including interference that may cause undesired operation.

Changes or modifications not expressly approved by the party responsible for compliance could void the user's authority to operate the equipment.

NOTE: This equipment has been tested and found to comply with the limits for a Class B digital device, pursuant to part 15 of the FCC Rules. These limits are designed to provide reasonable protection against harmful interference in a residential installation. This equipment generates uses and can radiate radio frequency energy and, if not installed and used in accordance with the instructions, may cause harmful interference to radio communications. However, there is no guarantee that interference will not occur in a particular installation. If this equipment does cause harmful interference to radio or television reception, which can be determined by turning the equipment off and on, the user is encouraged to try to correct the interference by one or more of the following measures:

- Reorient or relocate the receiving antenna.
- Increase the separation between the equipment and receiver.
- Connect the equipment into an outlet on a circuit different from that to which the receiver is connected.
- Consult the dealer or an experienced radio/TV technician for help.

Radiation Exposure Statement

The device has been evaluated to meet general RF exposure requirement. The device can be used in portable exposure condition without restriction.