

Change number paper

Take out the transparent plexiglass cover in the front of the receiver, then put a number paper inside the paper slot. And then put back the cover.

Note: While do the pairing operation, take out the cover and paper firstly.

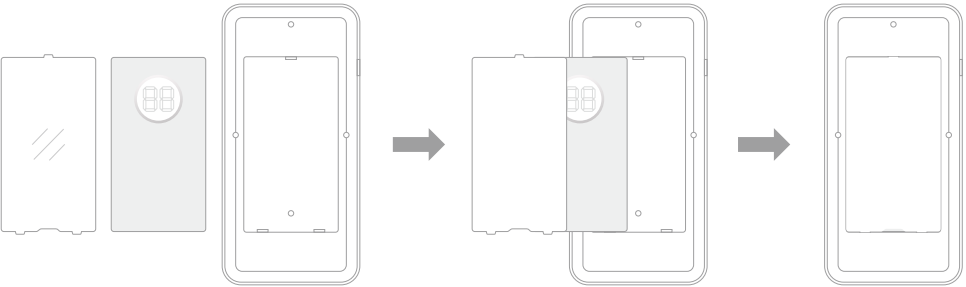

Queue Wireless Calling System User Manual

Contact us

ORDER PLACED

TOTAL
\$****.***

SHIP TO

ORDER # *****
[Order Details](#) | [Invoice](#)

Delivered *****
Signed by: *****



**** Restaurant Pager System with ** pcs Coaster Pagers and 1 pc Keypad
Call Button Extensible Wireless Queue Calling System for Food Court Church Clinic
Shop Cafe
Sold by: *****
\$****.***

Buy it again

View your item

Track package

Return or replace items

Problem with order

Share gift receipt

[Archive order](#)

***** storefront
★★★★★ 98% positive in the last 12 months (59 ratings)
***** is committed to providing each customer with the highest standard of customer service

Have a question for *****?
Ask a question

Feedback

Returns & Refunds

Shipping

Policies

Help

Products

★★★★★
"Arrived now"
By ***** on November 20, 2019.

★★★★★
"Pretty nice"
By ***** on November 16, 2019.

★★★★★
"Arrived on time."
By ***** on November 15, 2019.

★★★★★
"Pretty good! Happy with the order."
By ***** on October 29, 2019.

★★★★★
"Tremendous seller."
By ***** on October 28, 2019.

	30 days	90 days	12 months	Lifetime
Positive	100 %	95 %	98 %	98 %
Neutral	0 %	0 %	0 %	0 %
Negative	0 %	5 %	2 %	2 %
Count	10	22	59	59

Wireless calling system

Queue Wireless Calling System User Manual

Summary

Thank you for choosing the queue wireless calling system. The revolutionary paging system provides the best solution to avoid long waiting lineup. It will help tremendous users to reduce labor cost and improve the efficiency. The frequent using scenarios are restaurant, cafe, foodcourt, auto shop, clinic, and church nursery, etc.

The long signal range of the device enables guests to walk around during the waiting period. As a result, it will help to keep the place quiet and uncrowded. The system will satisfy different customers' requirements by providing various settings, such as different alert modes, group calling, mute base sound.

Features

- ◆ Six choices of alert modes: Combinations of sound, flashing and vibration.
- ◆ Customize different calling numbers from 1 - 998 by repair them.
- ◆ Build-in rechargeable lithium battery provides long operation life.
- ◆ Mute sound for base: Type 000 and press "CALL".
- ◆ Group call for all the pagers: Type 999 and press "CALL".
- ◆ For long distance calling, please pull out the antenna.

Technical data

Receiver	
Operation Voltage	DC3.7V (Rechargeable lithium battery)
Charging Voltage	DC5V
Operation Frequency	433.92MHz
Standby Current	1 ± 0.5mA
Operation Current	100±20mA
Receive Sensitivity	-117dBm ± 2dBm
Battery Capacity	250 mAh
Decoder	Learning Code (AM)

Transmitter	
Operation Voltage	Dv7 5V/2A Power Adapter
Operation Frequency	433.92MHz
Standby Current	24±5mA
Transmit Current	100±30mA
Encoder	Learning Code (AM)

Diagram of receiver

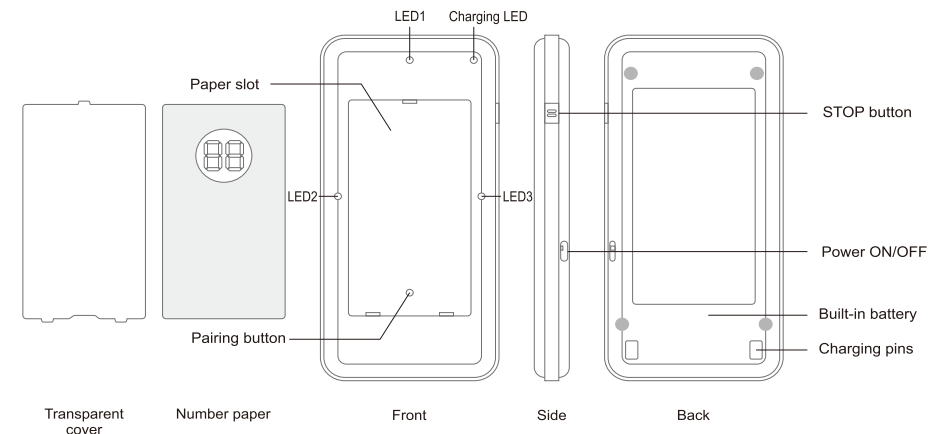

Button function

- 【Power】** The upper position is Power ON,
The lower position is Power OFF.
- 【Pairing】** Step 1: Switch the power to "OFF" position.
Step 2: Keep holding the "STOP" button.
Step 3: Switch the power back to "ON" position while holding the "STOP" button at the same time.
Step 4: Release the "STOP" button. Now you have already change to the next mode.
Step 5: Repeat the procedures until you find the right mode you need.
- 【Mode】** 1) Vibration Buzzer Flashing
2) Vibration Flashing
3) Buzzer Flashing
4) Buzzer Only
5) Flashing Only
6) Vibration Only

FCC Warning:

Changes or modifications not expressly approved by the party responsible for compliance could void the user's authority to operate the equipment. This equipment has been tested and found to comply with the limits for a Class B digital device, pursuant to Part 15 of the FCC Rules. These limits are designed to provide reasonable protection against harmful interference in a residential installation. This equipment generates uses and can radiate radio frequency energy and, if not installed and used in accordance with the instructions, may cause harmful interference to radio communications. However, there is no guarantee that interference will not occur in a particular installation. If this equipment does cause harmful interference to radio or television reception, which can be determined by turning the equipment off and on, the user is encouraged to try to correct the interference by one or more of the following measures:

- - Reorient or relocate the receiving antenna.
- - Increase the separation between the equipment and receiver.
- - Connect the equipment into an outlet on a circuit different from that to which the receiver is connected.
- - Consult the dealer or an experienced radio/TV technician for help.

This device complies with part 15 of the FCC Rules. Operation is subject to the following two conditions: (1) This device may not cause harmful interference, and (2) this device must accept any interference received, including interference that may cause undesired operation.