

USER MANUAL

Upgraded 7" Standard Car Stereo

Important ! Test before Installation

Built-in Carplay



Customer service:

We have done our best to deliver a high-quality product and we'll continue doing so, doing so, recommend does not to install the product yourself.

We recommend having it professionally installed by a certified professional.

If you decide to install the unit by yourself please do read the user manual carefully and follow the installation steps.

Do not hesitate to get in touch with us if you meet any difficulties installing the unit we are always available to answer any of your questions and more than happy to take your suggestions.

We try our best to be as responsive as possible, you can always get in touch with us through:

- 1. Your order on Amazon, Contact Seller Service. Reply within 24 hours.
- 2. Email Service: Reply within 24 hours.

Reply within 12 hours except for the weekend.

Also the QA part on the product detailed page, it will include youtube links that solves frequently asked question. 95% of the questions would resolve after checking it.

About This Manual

To entirely understand how to properly install and use your new product, it is recommended to read this entire user's manual and keep it in a safe place for future reference.

Read the Entire Manual

- Keep The Manual
- Follow All Instructions
- Clean with A Dry Cloth Only
- Do Not Use Or Operate Near Water
- Do Not Defeat Any Safety Features

Important Tips

- 1.Test the unit before installation.
- 2.Use the reset hole if your car stereo malfunctions.
- 3.Check our Contact Us info at the last page of the User's manual.

Catalogue

Customer Service Contact

Rear Interface Description Page 2 to 3
Test

- 1.Test the car stereo
- 2.Test rear view camera Page 4 to 6

Installation Page 6 to 8
Description of key jack

- 1.Jack shows
- 2.The key that Page 10 to 11

Mirror Link Function Connection

Note: There are a small number of phones with high configuration that are not suitable for this function

- 1.Iphone
 - 2.Android Page 12 to 16
- function Carplay..... Page 17 to 19

REAR INTERFACE DESCRIPTION

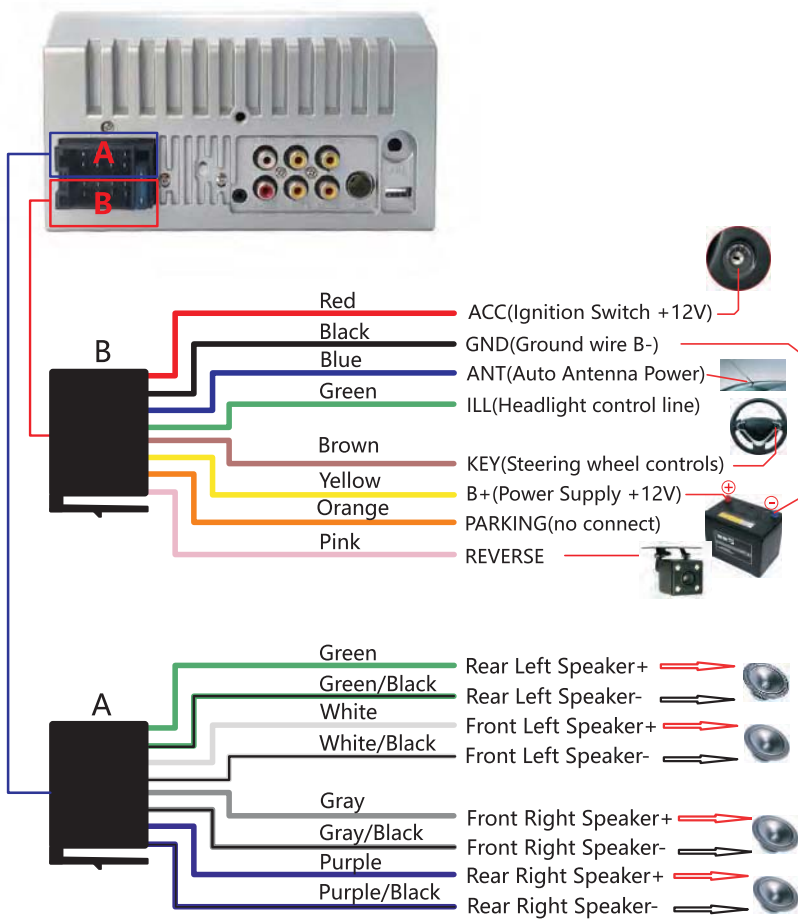

REAR INTERFACE DESCRIPTION

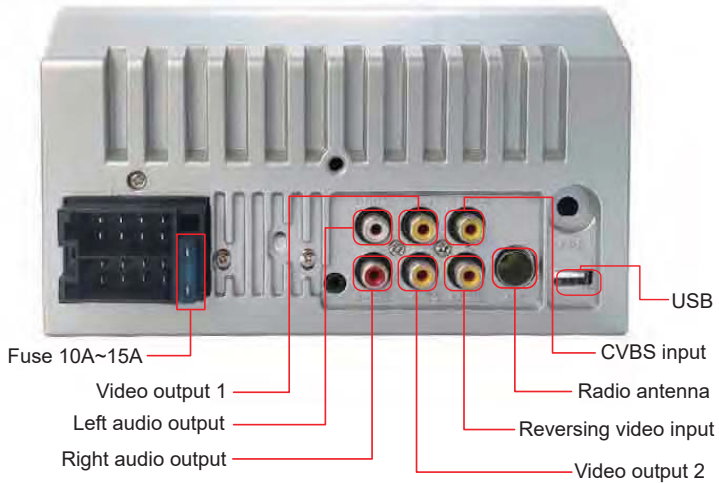

Test

A quick simple test before the installation is to confirm that the device is working normally and as expected. In case there is a wrong step in the subsequent installation, which causes it to fail to work. If you perform a successful test but the unit did not work after installing it please recheck the installation steps.

Step1

Test car stereo: ①The red and yellow wires of the car stereo combine together firstly and then connected to the positive pole of the battery, ② The black wire is connected to the negative pole of the battery. ③ 2 seconds later, check the car stereo, if the screen is lighting up, it means the car stereo is proper functioning.

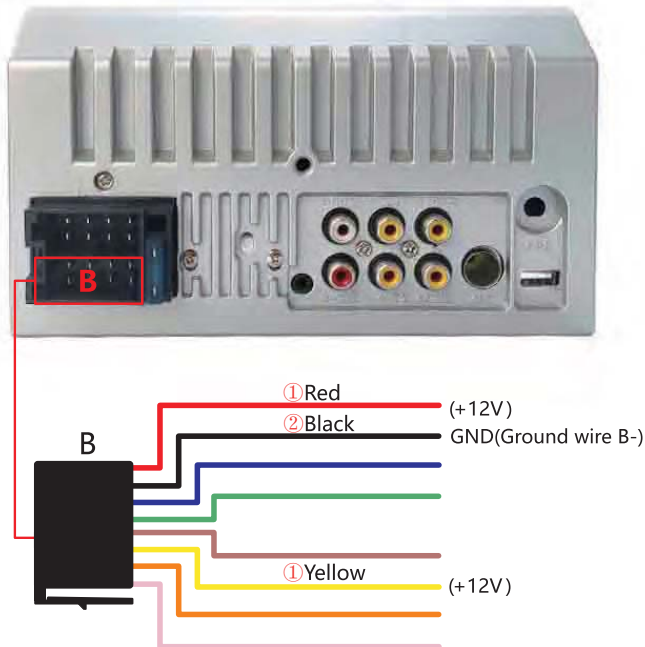

4

Step2

Test rear view camera: Holding the Step 1 connection. ④ and then the pink wire is connected with the top red wire of the rear view camera, ⑤ The middle red wire and the bottom red wire of the rear view camera combine together and then connected to the ① (which the red and yellow wires connected to the positive pole of the battery). ⑥ The black wire of rear view camera is connected to ② (which the black wire is connected to the negative pole of the battery). At this time, if the camera lights up, and the car stereo shows the reverse image, it means rear view camera is proper functioning.

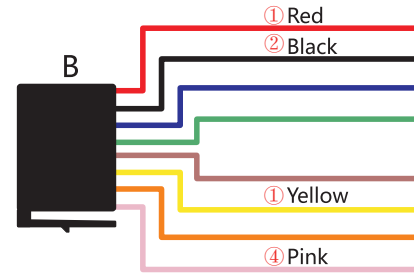

5

Full show of the Realistic connection photo:

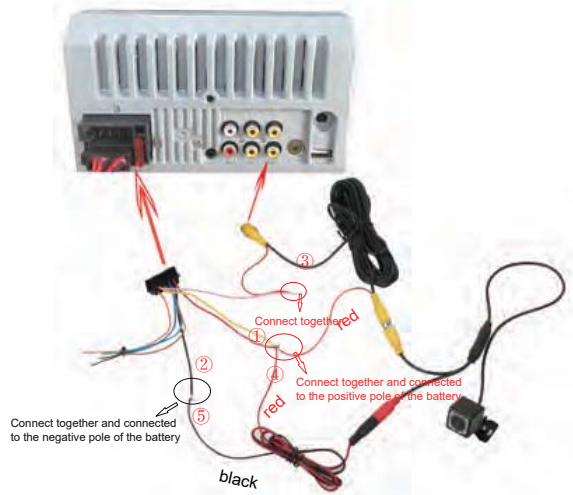

After completing the steps of the test, the car stereo is ready to be installed in your car.

Installation:

Note:

1. When using the rear view reversing function, the system will automatically disconnect the link with the mobile phone, such as calls & music in Bluetooth mode, phone mirror link, which is normal. 2. If your car does not intend to use the rear-view reversing function, please keep disconnecting the ③ part to avoid disturbing the normal use of the car stereo.

WIRE CONNECTION

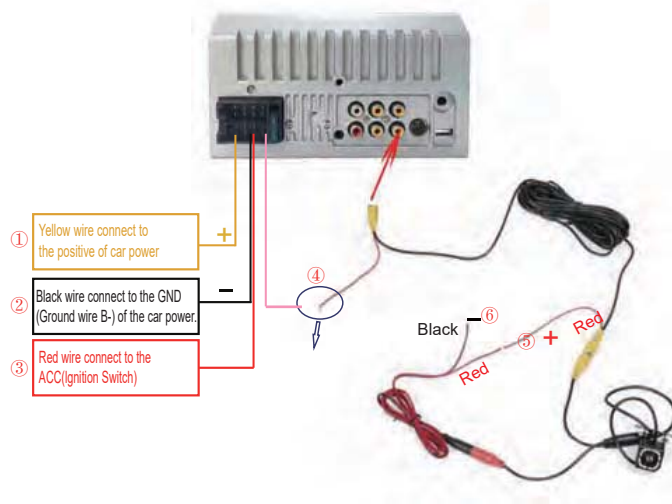

(This part is installed at the rear of the car)

- ④ combine the pink wire of the car stereo with the top red wire of the rear camera.
- ⑤ Combine the two red wire together and connect it to the positive pole of the reversing headlight.
- ⑥ connect it to the negative pole of the reversing headlight.

MACHINE INSTALLATION

The size of this car stereo is universal, suitable for most cars, and can be easily installed by following the steps below. But if you find that the unit is not suitable for your car, please consider these four methods. You may need three aftermarket accessories to complete your installation: · Double DIN dash kit for (your car model). · Wire harness (Connects car wiring to stereo wiring) for (your car model). · Antenna adapter for (your car model). You can find the correct aftermarket accessories by searching the year, make, and model of your vehicle on Amazon or Google. · Or you would need to mill the original frame of your car.

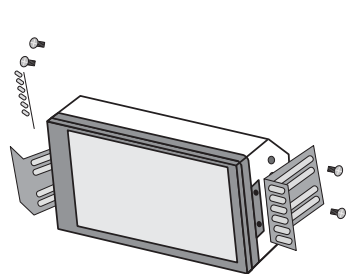

Step 1

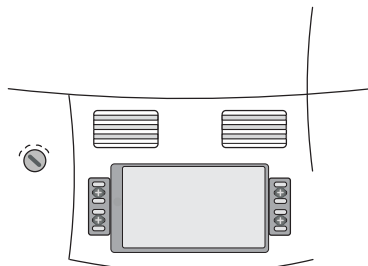

Step 2

CARPLAY FUNCTION

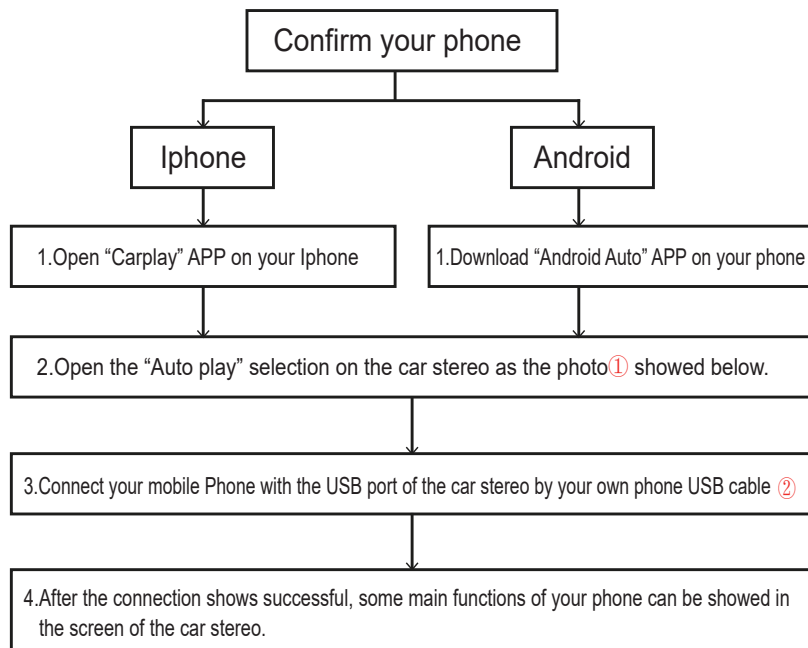

Jack shows

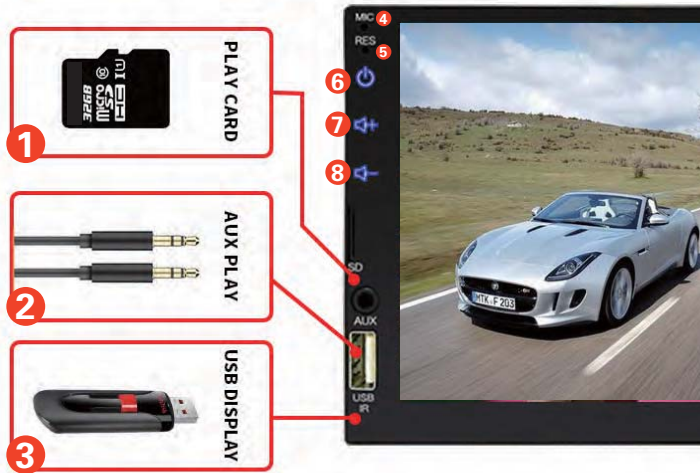

- | | | |
|------------------|----------------|----------------------|
| 1. SD card. | 2. AUX socket. | 3. USB port. |
| 4. Power on. | 5. reset. | 6. The power switch. |
| 7. The volume +. | | 8. The volume -. |

Remote control in detail



- | | |
|----------------------------|--------------------------|
| 1. Switch button | 7. The volume and |
| 2. Function transformation | 8. The answer key |
| 3. USB/TF card playback | 9. Hang up button |
| 4. Automatic search band | 10. last song |
| 5. menu | 11. The volume reduction |
| 6. next song | 12. Play/Pause |
| | 13. Sound mode selection |

— 4.Mirror Link for iPhone

Note:

If your phone is iPhone X or above the phone link function won't work.

- 1.Only when the display mode of the phone is on" landscape", then the display of the car stereo can be displayed in full screen.
2. Bluetooth must be connected, then the audio on the mobile phone can be synchronized to the car stereo.
3. When the phone screen is turned off, the display of the car stereo will also be turned off at the same time.

1. Use the original data cable to connect the car stereo and mobile phone with.
2. When the phone pops up a dialog box: "Trust This Computer? ", Select "Trust" to enter the interconnect mode.
- 3.Match the Blue tooth if you need to use the audio

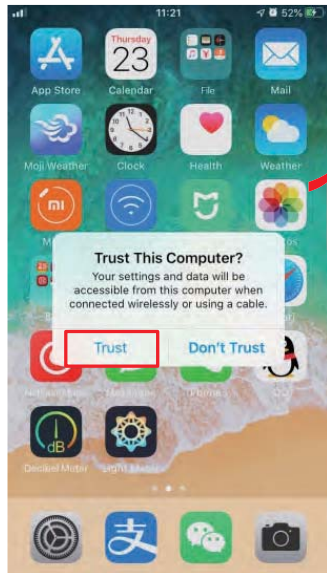

12

— 4.Mirror Link for Android

Note:

If your phone is running Android version 10.1 or above the phone link function won't work.

- 1.Only when the display mode of the phone is on" landscape", then the display of the car stereo can be displayed in full screen.
2. Bluetooth must be connected, then the audio on the mobile phone can be synchronized to the car stereo.
3. When the phone screen is turned off, the display of the car stereo will also be turned off at the same time

- 1.Find"System"on your phone setting.

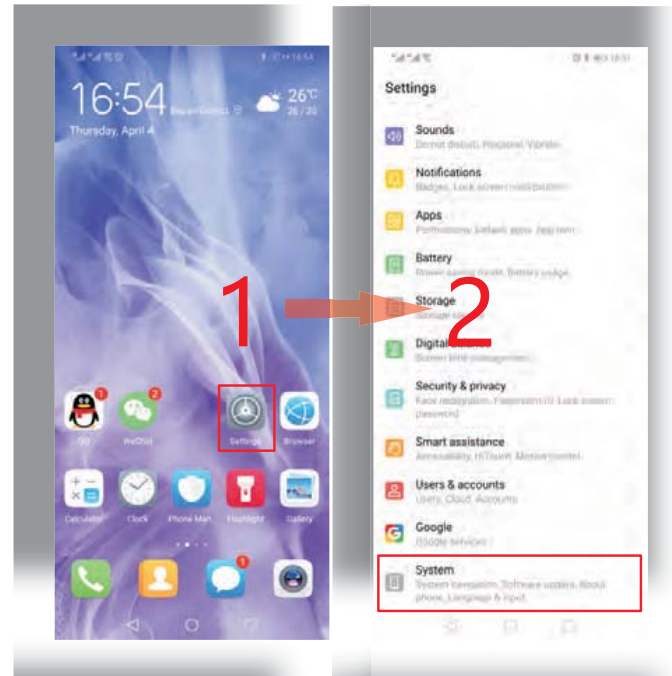

13

2. Find the "About phone" and click Enter. Click on the "Build number" continuously until the phone screen displays "You are already a developer".

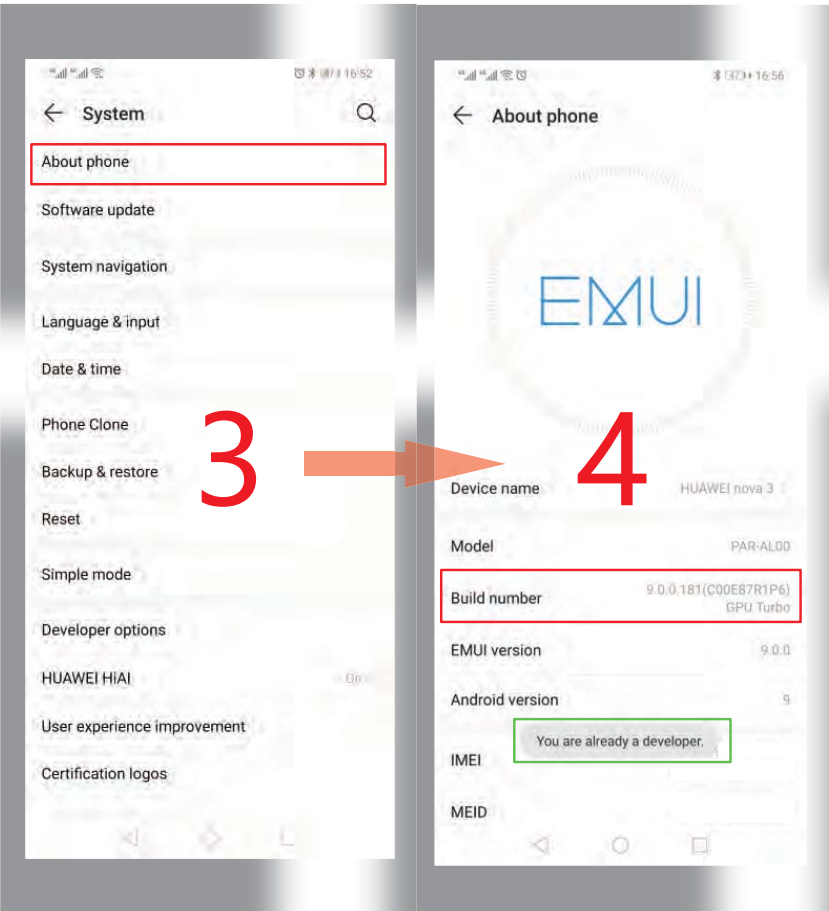

3. Go back to the "System" interface, find "Developer options", and click Go to find "USB debugging" and turn this feature on.

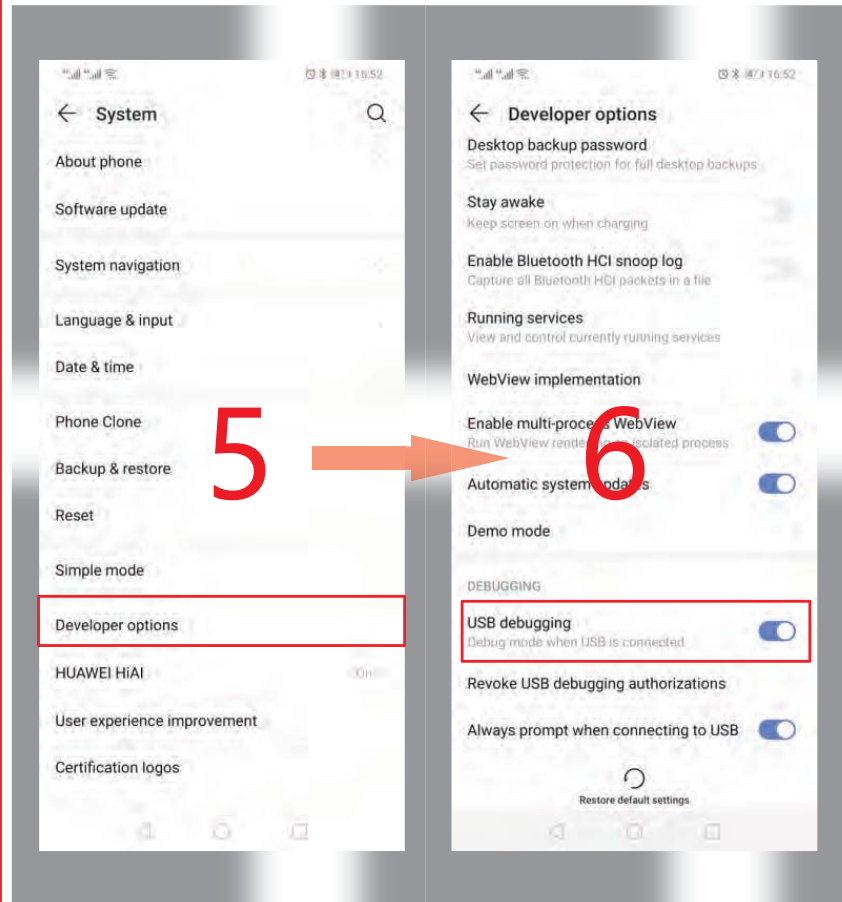

4.Connect the phone and the car stereo with the USB cable, and the dialog box "Allow USB debugging" will pop up on the phone. Click the "OK" button.



FUNCTIONAL DESCRIPTION

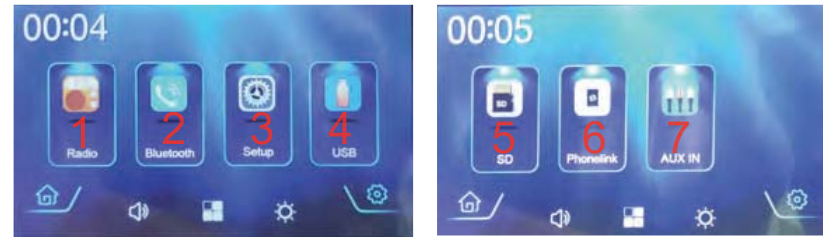

- 1.RADIO: Touch to enter the radio mode to listen to the radio station.
- 2.Bluetooth: Touch to enter Bluetooth mode.
- 3.Settings: Touch to enter system settings.
- 4.USB is a USB flash drive
- 5.SD card slot
- 6.Ponelink: Compatible for the IOS system and Android system
- 7.AUX IN: Plug in the AUX hole on the front of the machine.

[RADIO FUNCTION]



1. Press the button repeatedly to fine tune the radio frequency point to the desired position of the user.
2. Store the station number of the station 1~6 display area, and touch the number to select the corresponding station to listen to. Press and hold the number key to store the current frequency point (displayed in area 10) to the corresponding station number.
3. When the button is touched, the machine automatically scans the full-band frequency and stores the effective station on the stations 1~6 of FM1~FM3. Up to 18 stations can be stored. During the scanning process, touch this button again to stop scanning.
4. Touch the button to switch between local signals and distant signals. A criterion for judging the signal strength of an effective station during the scanning process.
5. Radio frequency display area.

Built-in Carplay

Other features:

1. Double screen interactive
2. USB connection
3. Mobile Internet



This device complies with part 15 of the FCC Rules. Operation is subject to the following two conditions: (1) this device may not cause harmful interference, and (2) this device must accept any interference received, including interference that may cause undesired operation.

Any changes or modifications not expressly approved by the party responsible for compliance could void the user's authority to operate the equipment.

NOTE: This equipment has been tested and found to comply with the limits for a Class B digital device, pursuant to Part 15 of the FCC Rules. These limits are designed to provide reasonable protection against harmful interference in a residential installation. This equipment generates, uses and can radiate radio frequency energy and, if not installed and used in accordance with the instructions, may cause harmful interference to radio communications.

However, there is no guarantee that interference will not occur in a particular installation.

If this equipment does cause harmful interference to radio or television reception, which can be determined by turning the equipment off and on, the user is encouraged to try to correct the interference by one or more of the following measures:

- Reorient or relocate the receiving antenna.
- Increase the separation between the equipment and receiver.
- Connect the equipment into an outlet on a circuit different from that to which the receiver is connected.
- Consult the dealer or an experienced radio/TV technician for help.

The device has been evaluated to meet general RF exposure requirement. The device can be used in portable exposure condition without restriction