



## X10 Fingerprint Touchscreen Bluetooth Door Lock User Manual



### Customer Service:

Email: [scyanlock@hotmail.com](mailto:scyanlock@hotmail.com)

[www.scyanelectronics.com](http://www.scyanelectronics.com)

©2020 Scyan Electronics LLC V4.0

Scyan Electronics

## Contents

1. Registration	3
2. Lock management	3
3. Program the lock	4
4. How to unlock	6
5. How to delete a lock	6
6. Gateway management	6
7. Pair with Amazon Alexa	7
8. Pair with Google Home	9
9. Reset System	9
10. Set up the lock without APP	10
11. Door Preparation	11
12. Lock Installation	12
13. Product return	17
14. Firmware Update	18

**NOTE:** Use your phone camera to scan following QR code to download APP. You may search “TTLock” from Apple store or Google play if the QR code doesn’t work.



**Important note:** Activating the screen first, before enter number.

To activate the screen, use one of the Two options below:

1. Touch screen with palm or back of hand until digits illuminate.
2. Touch screen with three or more fingers until digits illuminate.

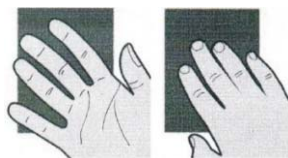

**Download user log online:** <https://lock.sciener.com>

## Features

- Scyan smart door lock is a great solution for residential house, airbnb, short-term rental hosts, and rental property management. sharing access is easier than ever with Scyan smart lock’s ability. To generate passcode from you mobile APP.
- Multiple ways to Unlock: Fingerprint, Code, Card (Key Fob), APP, Key, Remote via Gateway and alexa (**Gateway and Alexa device are optional, Sold Separately**).
- Store up to 120 fingerprint users, 250 passcodes, 1000 Cards (Key Fobs). Store up to 2000 audit trail logs.
- Lock management via APP and voice prompt, make lock setup easier than ever.
- Remote Control: After pairing with Gateway (**Optional, Sold Separately**), you can unlock your smart door lock anywhere anytime, as well as set up codes remotely and check real-time access logs.
- Built-in touch active fingerprint sensor: One touch to unlock.
- Mute: Offer option to turn off voice prompt via APP.
- Support passage mode: Stay at “unlock” during the passage mode.
- Memory function: “Power run-out” will not cause the loss of enrolled Fingerprint(s), User Code(s) and Cards (Key Fob(s)).
- Auto lock as long as you close door. Auto lock time can be set via APP.
- Easy installation in minutes with just a Phillips screwdriver. No Drills Needed. No Locksmith Needed. Reversible lever, fit both left-handed and right-handed door. Reversing lever controlled by key.
- “Schlage C key” as an override key.
- 9V battery may be attached as an additional power source.
- Double-shell heavy duty construction design.
- APP show battery level.

## Specifications

- Semiconductor Fingerprint sensor: The flexibility to adapt to any condition whether it is dry fingers, wet fingers, light texture fingerprints fingers, and old fingers, all have high recognition rate.
- Supported phone operating systems: IOS 7.0 or later, Android 4.3 or later.
- Bluetooth: 4.1 BLE.
- Adjustable backset 2 3/8” or 2 3/4”.
- Fit door thickness between 1 3/8” and 2 1/4”.
- Operation temperature from -4°F (-20°C) to 158°F (70°C).
- All weather door lock.
- Powered by 4 AA Alkaline batteries (NOT included).
- One year limited manufacturer’s warranty.

Manage the lock via the TTLock APP. Use the APP to program Fingerprint, Passcode, IC Card (Key Fob), unlock, lock, firmware upgrade, check operation records, etc. Search the TTLock APP either from Apple store or Google Play, download and install it.

## 1. Registration

Tap upper right, register an account by using a mobile phone number or email address. **Please select country code first** when you use your phone number to register an account. The verification code will be sent via text message or email. The registration will be successful after the verification.

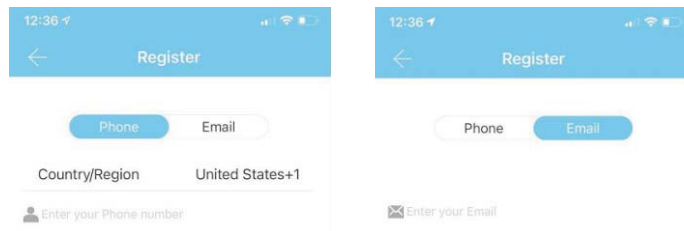

After login your account, set up security question. When you login from a new device, you need to answer security question.

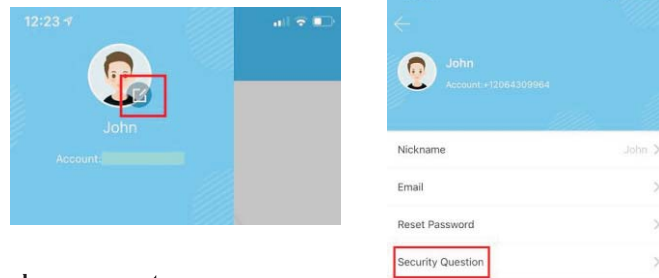

## 2. Lock management

In order to manage the lock, the lock must be enrolled in the APP first. The APP account owner will be an administrator of the lock. You have to delete the lock from the APP account if you want to transfer the lock to another APP account. The lock must be nearby your phone when you do so.

When you log in to the lock APP, the APP will prompt you to pair a lock with your phone if there is no lock paired with your account.

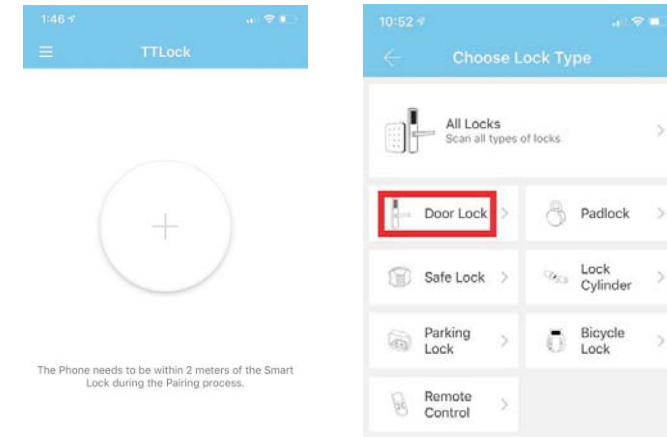

Tap upper left from lock management page to pair a lock with your phone if there is already a lock enrolled with the APP.

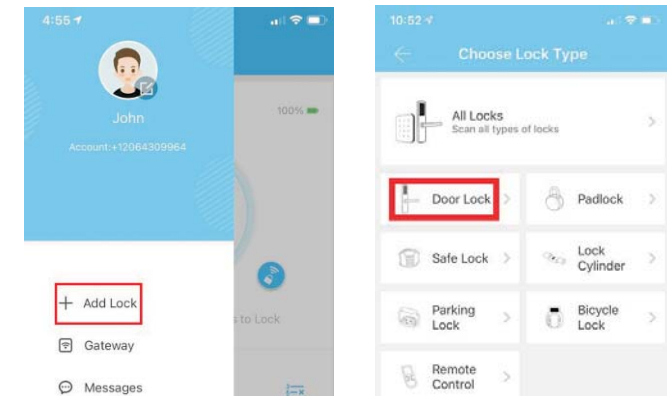

After pairing with lock, assign a name for the lock, for example, X10 or front door.

## 3. Program the lock

Tap icon to program the lock in order to set up the Fingerprint, Passcodes, and IC Card. Tap upper right to show sub-menu. Follow the instructions to program.

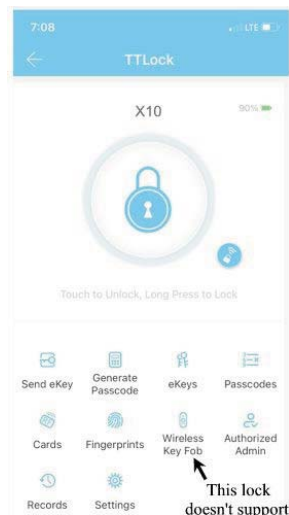

In order to create a customized Passcode (user code), please tap “Custom”.

After you generate a passcode, the passcode must be used to unlock the lock at least one time in 24 hours. Tap upper right if you want to send code to somebody who is nearby the lock. You may tap passcode to change the passcode.

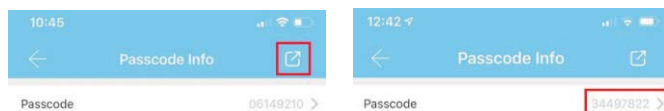
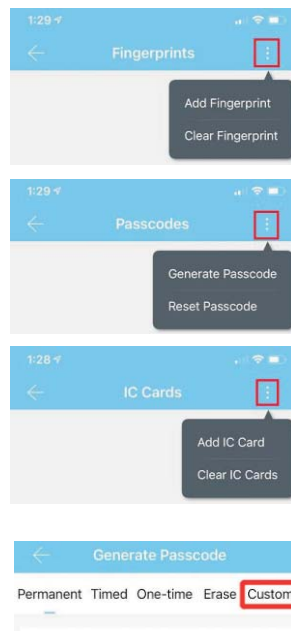

To delete Fingerprint, Passcode and IC card, touch user name and swipe from right to left, the delete button will show up.

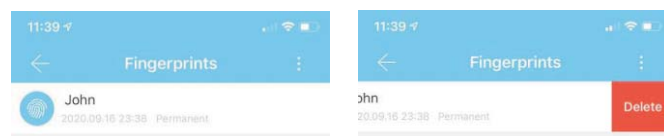

The administrator can create a sub-administrator. When the authorization is successful, sub-administrator can send ekey, passcodes, and more. However, the sub-administrator can not create an administrator.

User can upgrade the lock firmware from the APP when it is necessary. The upgrade needs to be done via your phone nearby the lock. When the upgrade is successful, the original key, passcode, IC card, and fingerprint will remain in system. Please refer “14. Firmware Update” on page 18.

#### 4. How to unlock

On the Lock:

- Fingerprint: Place enrolled fingerprint on the sensor.
- Passcode: Input code than press #.
- IC Card: Place IC Card (Key Fob) on center of touch pad.
- Touch keypad to unlock when set up in APP.

Unlock via APP:

- Unlock by touching the lock icon when you are nearby the lock

Unlock remotely via APP (Gateway required, **sold separately**):

- Unlock by touching the remote icon.

Unlock via Alexa (Gateway and Echo device required, **sold separately**):

- Unlock by talking to Alexa.
- **Passage Mode:** You may set up passage mode in a specified periods. The lock will keep unlock in the periods. For example, if you want the lock keep unlock from Monday to Friday and 8 am to 5 pm. You need to unlock by fingerprint, Code, Card (Key Fob) or App to unlock. The lock will keep unlock until 5 pm. The lock will lock itself after 5 pm automatically. You may press #, or use App to lock the lock during passage mode.

#### 5. How to delete a lock

Tap “Settings” in lock management page, delete button on bottom of page.

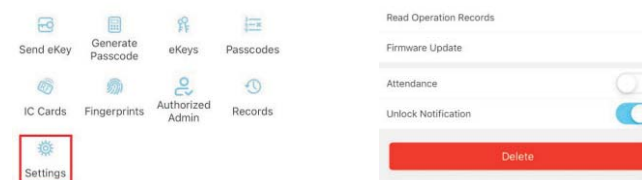

There is other features and settings. The user can learn from APP.

#### 6. Gateway management

**NOTE: The gateway is an optional add-on, it does NOT come with the lock. It is sold separately. You may purchase it at [www.scyanelectronics.com](http://www.scyanelectronics.com)**

After the lock paired with your phone, you can manage the lock via Bluetooth

connection when your phone is nearby the lock. The gateway is a bridge between the lock and WIFI router. You can manage the lock remotely via internet. Gateway can be used to unlock, delete or modify the passcodes, check unlock log and calibrate the lock clock.

- A. Connect your phone to the router which the gateway is connected to.
- B. Tap upper left from lock management page then tap “Gateway”. Click upper right “+”, select G2, plug gateway to power outlet (Unplug and plug again if the gate has been plugged power outlet). Select your router then input the router password and assign a name for gateway.
- C. The gateway will connect to router if password is correct. And the lock will connect to the gateway too.

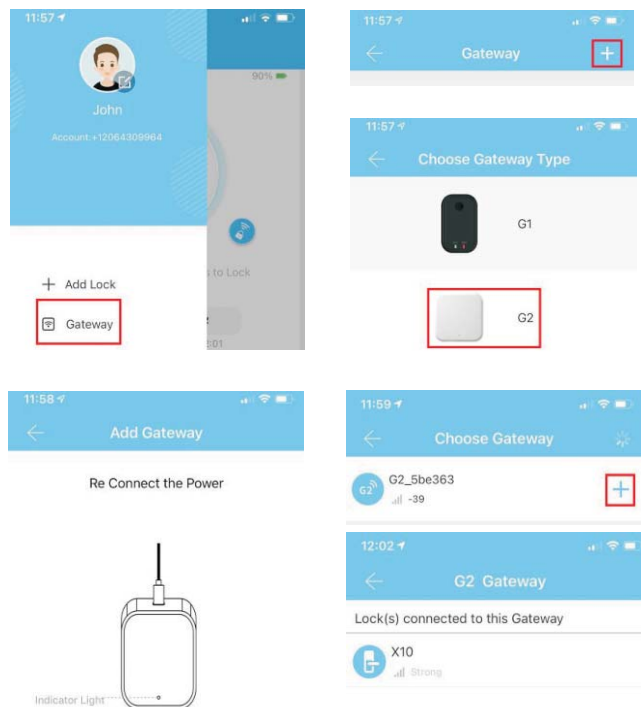

## 7. Pair with Amazon Alexa

In order to pair with Alexa, the gateway need to pair with the lock and router first,

then pairing with echo device. Please note that **Gateway does not come with lock.**

### Gateway sold separately.

- 7.1. Log in your amazon Alexa account.
- 7.2. Tap “More” on the bottom in the Alexa APP. Tap “Skills & Game”. Search “ttlock”. Tap “TTLock”. Tap “ENABLE TO USE”.

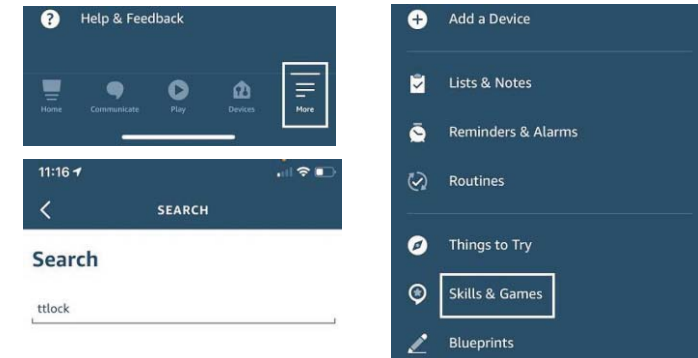

7.3. Log in your TTLock account. Please include “+”, country code (USA and Canada are 1), area code and phone number if your account name is your phone number. For example, +18886667777 for USA and Canada customer. Enter your email address if you use an email to register TTLock account. Enter your password. The TTLock account will link to your Alexa account if password is correct.

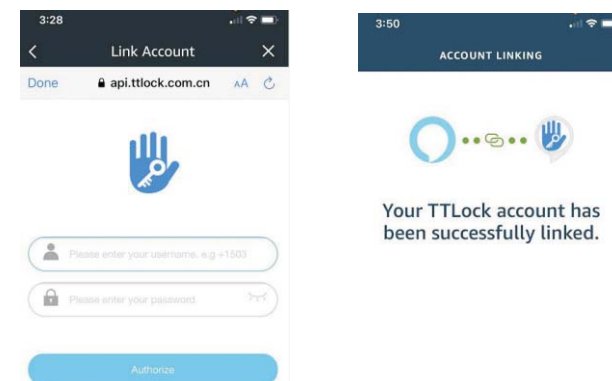



7.4. Tap “Devices”, “Locks”, Tap your lock then tap upper top “Setting” . Enable “Unlock by voice”, create your voice code. You can unlock by voice now.

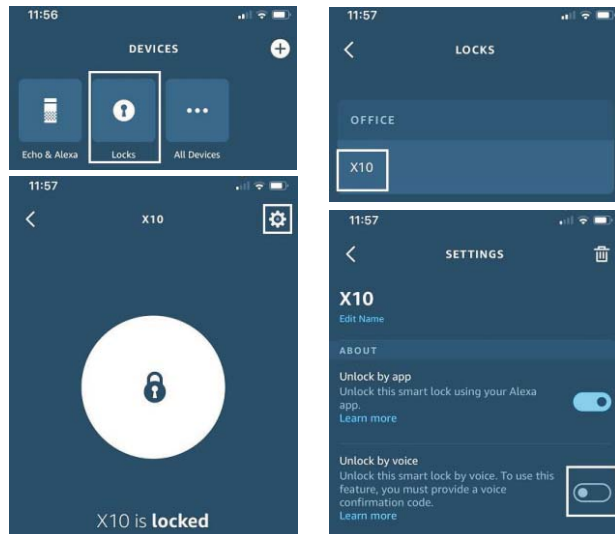

## 8. Google Home

In order to pair with Google home, the gateway need to pair with the lock and router first, then with Google home hub. Please note that **Gateway does not come with lock. Gateway sold separately.**

- 8.1. Make sure you have installed Google Home APP and hub.
- 8.2. Click the "+" Add button on the upper left of the APP to setup device.
- 8.3. In setup device page, choose "Works with Google" to manage accounts page.
- 8.4. Search for "ScienerSmart", and Enter your TTLock Account in the Authorize page.
- 8.5. Set Google Home Security Code in TTLock APP. You will be asked for this code when you unlock with Google home.

## 9. Reset System

To reset the system, press the reset button and hold until you hear “Input initiation passcode”. Input 000#. All fingerprints, codes, IC cards and administrator code are removed after reset. The reset button is inside of battery compartment.

## 10. Set up the lock without APP

You may set up the lock on the lock if you don’t have mobile phone or don’t want to use your mobile phone.

- 10.1. Reset system:  
Press and hold reset button until you hear “Input initiation passcode”, input 000#.
- 10.2. Set up administrator code:  
Press reset button, then release. Ignore voice prompt. Input desired administrator code (4-8 digits), then press #, input administrator code again, then press #.
- 10.3. Change administrator code:  
Press \*12#, input current administrator code#, input new administrator code, Then press #. input new administrator code again, then press #.
- 10.4. Enroll fingerprint:  
Input \*85#, input administrator code, then press #. Following voice prompt to enroll fingerprint.
- 10.5. Delete fingerprint:  
Input \*70#, input administrator code, then press #. All fingerprint will be deleted.
- 10.6. Add code:  
Input \*85#, input administrator code, then press #. Input code, then press #, input Code again then press #.
- 10.7. Delete Code:  
Input \*71#, input administrator code, then press #.
- 10.8. Change Code:  
Input \*10#, input current Code, press #, input new Code, press #, input Code again, press #.
- 10.9. Add IC Card:  
Input \*85#, input administrator code, then press #. Following voice prompt to enroll Card.
- 10.10. Delete IC Card  
Input \*69#, input administrator code, then press #.
- 10.11. Passage mode:  
Unlock, input 123# before the lock locked. The lock will keep unlock until the lock unlock again.

**User log could be downloaded to your computer.** Visit <https://lock.sciener.com> then login your account. You can review and download user log.

## 11. Door Preparation

Tools needed for new installation: Pencil, Chisel, Tape Measure, Hammer, Phillips Screwdriver, 1" (25 mm) & 1/8" (3 mm) Drill Bits, 2 1/8" (54 mm) Hole Boring Bit, Power Drill.

### 1. Marking the door.

- 1.1 Mark the centerline of the door and jamb (frame) (see fig. 1).
- 1.2 Stand so the door swings towards you.

### 2. Drill holes on door (see fig. 2).

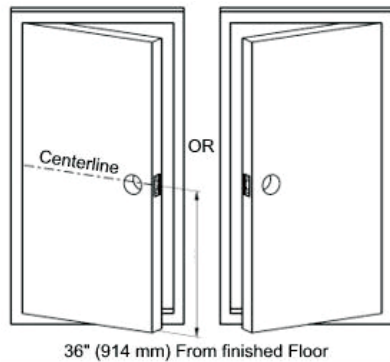

Fig. 1

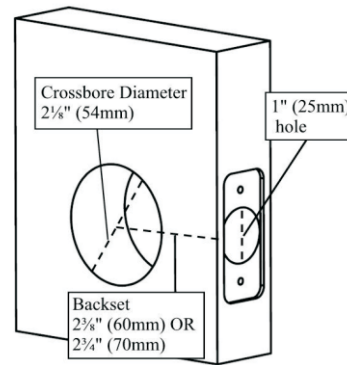

Fig. 2

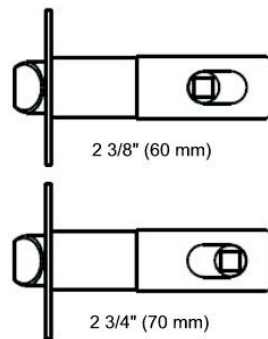

fig. 3

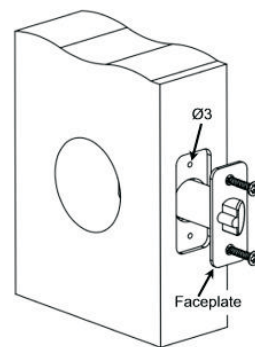

fig. 4

### 3. Installing the Latch.

- 3.1 Move latch spindle (with square hole) to adjust backset to fit either 2 3/8" (60

mm) or 2 3/4" (70 mm) (see fig.3).

3.2 Use faceplate as a pattern for mortise and pilot hole. The faceplate should fit flush (see fig. 4).

3.3 Install as shown for appropriate latch type. Ensure bevel faces doorjamb.

### 4. Preparing the door jamb (frame) (see fig. 5).

4.1 Mark centerlines on jamb exactly opposite to the center of the latch hole.

4.2 Make rectangular holes as shown.

4.3 Use the strike as a pattern for the mortise and pilot hole. Strike should fit the flush.

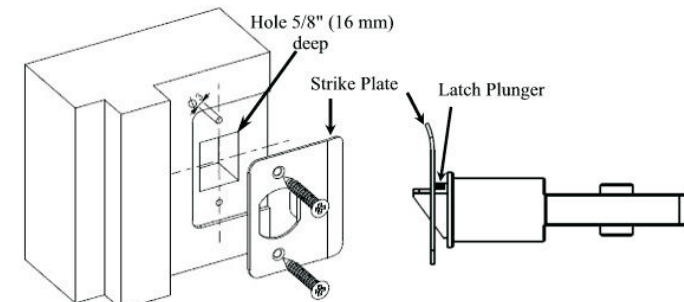

fig.5

## 12. Lock Installation

Accessories for installation:

- |                     |                         |                     |
|---------------------|-------------------------|---------------------|
| (A) Key             | (F) Latch               | (K) Mounting Screws |
| (B) Outside Lever   | (G) Latch/Strike Screws | (L) Inside Lever    |
| (C) Cylinder        | (H) Strike              | (M) Cover           |
| (D) Outside chassis | (I) Inside chassis      | (N) Cover Screw     |
| (E) Lever Catch     | (J) Allen Screw         | (O) Allen Wrench    |

The lock comes with two (K) Mounting Screws M5x60 2 3/8" (60 mm) long, one (N) M4x25 1" (25 mm) long Cover Screw, one (J) Allen Screw, one (E) Lever Catch and four (G) Latch/Strike Screws.

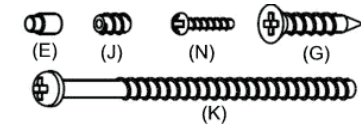

**Note:** The lock fit door thickness between 1 3/8" and 2 1/4". Contact manufacturer to order M5x50 (2", 50 mm) screw if your door thickness is less than 1 3/8".

### IMPORTANT NOTES:

- Use Phillips Screwdriver, **DO NOT** use a power drill for lock installation !
- Install and test lock with door open to avoid being locked out.

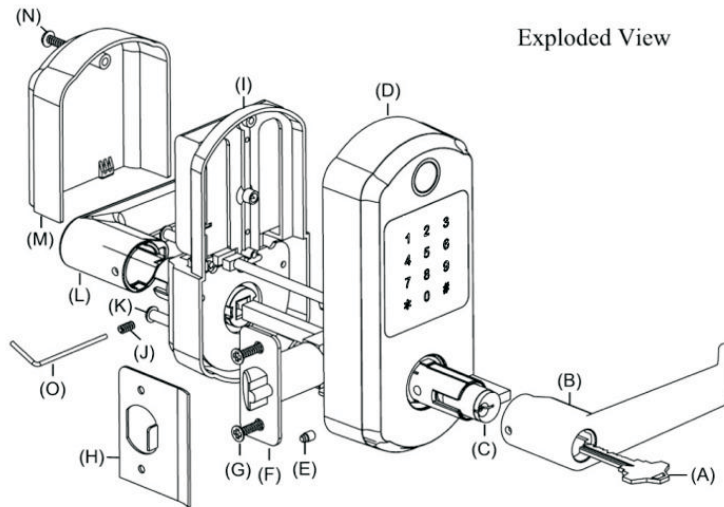

### 1. Installing the lock on the door

1.1 The dent should be on the 12-clock position (see fig. 1), if not, rotate Square Spindle to let the dent be on the 12-clock position.

1.2 Install the outside chassis unit (see fig. 2). Slide wire through the hole on the door. Slide square spindle and poles smoothly through the holes in the latch. Make sure to keep the outside chassis vertically aligned during installation. Check latch setting and door dimensions if there are any problems.

1.3 Make sure to keep the inside of the chassis vertically aligned during installation. Connect and arrange the wires to ensure that they are not pinched or crushed at any point during installation. The Square Spindle should slide smoothly into the square hole on Lever Spindle (see fig. 3).

1.4 Insert Mounting Screws to mounting hole on the inside chassis (see fig. 4). Screws should slide smoothly through the hole on door. Use the Philip Screwdriver to drive two screws into the mounting hole on mounting poles.

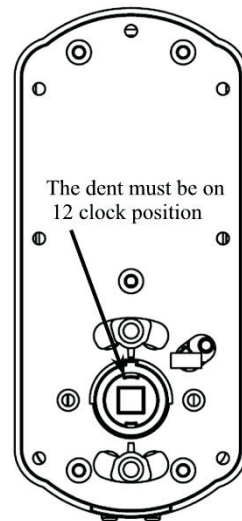

fig. 1

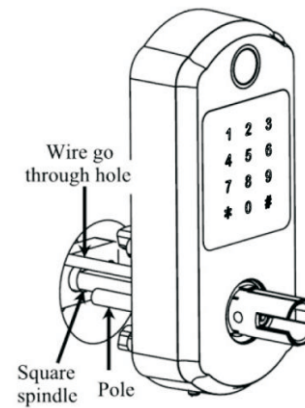

fig. 2

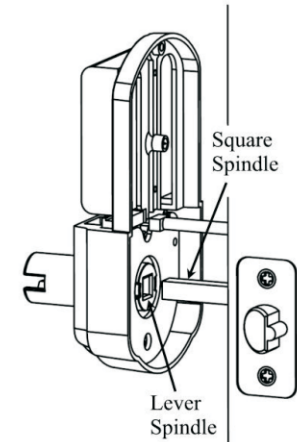

fig. 3

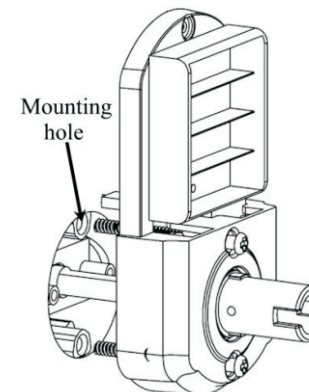

fig. 4

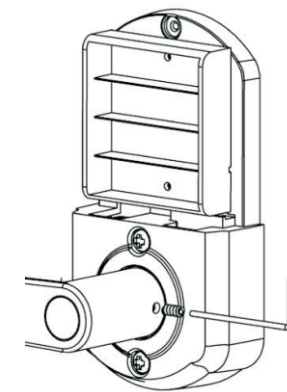

fig. 5

### 2. Setting up inside Lever:

Put Lever on Lever Spindle then use Allen Wrench to put in Allen Screw (see fig. 5). Take Allen Screw off then pull out Lever when you want to remove Lever.

### 3. Set up outside Lever:

You may set up lever for either left-handed or right-handed door.



**3.1 Rotate inner Spindle by Screwdriver to make the Cylindrical Protrusions horizontally aligned (see fig. 6). (Please also refer picture on page 17 and 18).**

3.2 Insert Lever Catch into the right side hole of the Lever Spindle completely if your door is left-handed (see fig. 7a), otherwise put it in the left side hole (see fig. 8a). **The big end of the Lever Catch goes into the hole first.**

3.3 Insert Cylinder into the Lever Spindle. The Cylinder's tail should be pointed towards the left if you want to set the lock as left-handed (see fig. 7b), otherwise the Cylinder's tail should point right (see fig. 8b).

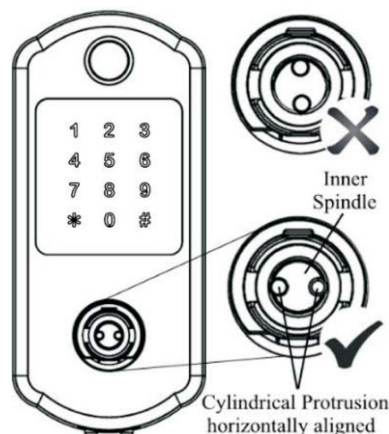

fig. 6

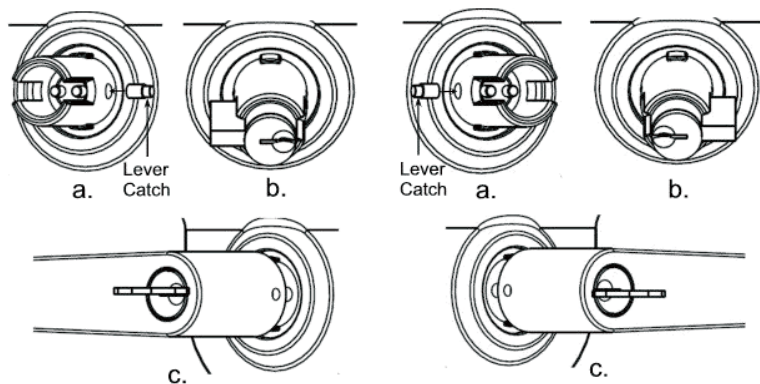

fig. 7

fig. 8

3.4 Put the lever on the Lever Spindle (see fig. 7c or 8c). The lever should stop half way when you push the Lever in. **(Caution: Refer fig. 6 to do step 3.1 and 3.2 if Cylinder is stuck in lever or if the key can't be inserted completely and rotated.)** Insert key into the Cylinder, rotate the key **CLOCKWISE** 90° (see fig. 9a). Continue rotating the key while pushing the lever until the lever is pushed in (see fig. 9b). The

key range of rotation is from 80° to 120°. Rotate the key counter **CLOCKWISE** (see fig. 9c) then take the key out (see fig. 9d). The Lever will stay on the lock and can't be pulled out after Lever is set up properly.

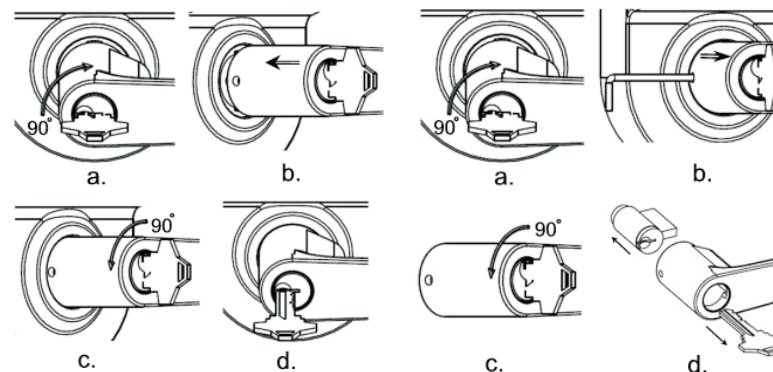

fig. 9

fig. 10

3.5 Removing the Lever (if necessary): Insert the key into Cylinder then rotate the key **CLOCKWISE** 90°, using Allen Wrench or a paper clip to push Lever Catch in then pull the lever out (see fig. 10). Rotate the key **COUNTER CLOCKWISE** 90° then take key out. Use Screwdriver to rotate Cylindrical Protrusions, then the Lever Catch will protrude. Take the Lever Catch out and keep it in a safe place.

3.6 Switching Levers (if necessary): Levers can be reversed to extend toward the hinges. Refer 3.5 to remove lever then following 3.1 to 3.4 to set up lever.

4. Install 4 brand new AA Alkaline batteries (NOT included, do not use rechargeable batteries). **Alkaline Batteries Warning**, DO NOT install backwards, charge, put in fire, or mix with other battery types, as these may explode or leak causing injury. Replace all batteries at the same time.

5. Slide cover down then tighten cover screw (see figure 11).

6. **Testing lock:** Rear lever should be pushed down and lifted up. Enter default code 123456 then press # if the lock is on unlocked status. The lock will lock by itself after 5 second, otherwise check if latch is broken.

7. **Caution:** Please install strike plate that included in the package. The existing strike must be removed if there is one on



fig. 11

the door jamb (frame). Check the operation of the latch by ensuring that the latch plunger stops against the strike plate and does not slide into the strike opening when the door is closed (see fig. 12). If that situation occurs, then a total lockout may occur. This situation will void our warranty of the complete lock mechanism. If necessary, correct the door over-travel by using the rubber bumper (see fig. 13). You may buy the rubber bumpers from your local hardware store.

8. Lock removal: Reverse step 5, 4 and 2. Refer to step 3.5 to remove outside Lever. Reverse step 1.4 and 1.3 to remove outside chassis and inside chassis from the door.

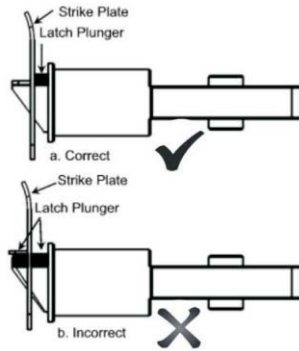

fig. 12

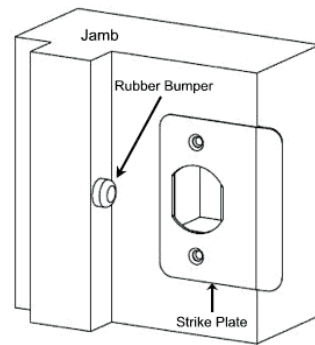

fig. 13

### 13. Product return:

Please refer to installation instructions to remove lock from door, remove levers from lock. Put them back in the original package. **Thanks for your help !**

### 14. Firmware Update:

User could update Firmware via App when new version is available.

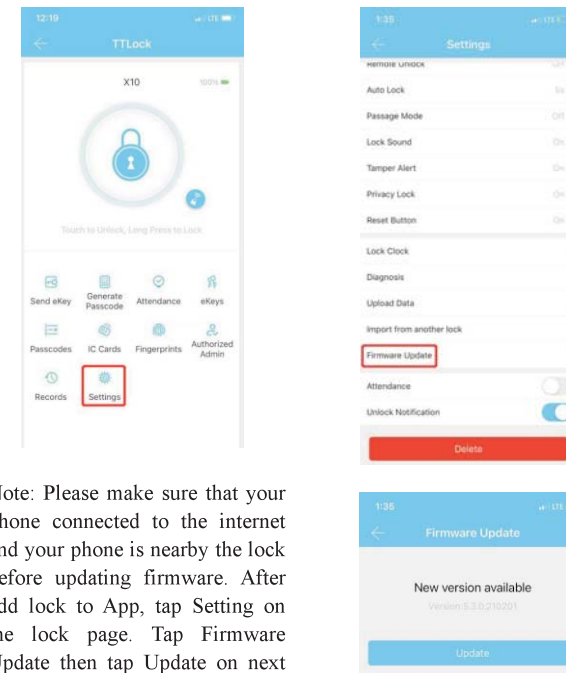

Note: Please make sure that your phone connected to the internet and your phone is nearby the lock before updating firmware. After add lock to App, tap Setting on the lock page. Tap Firmware Update then tap Update on next page.

## **FCC Statement**

This device complies with part 15 of the FCC Rules. Operation is subject to the following two conditions: (1) This device may not cause harmful interference, and (2) this device must accept any interference received, including interference that may cause undesired operation.

Note: This equipment has been tested and found to comply with the limits for a Class B digital device, pursuant to part 15 of the FCC Rules. These limits are designed to provide reasonable protection against harmful interference in a residential installation. This equipment generates, uses and can radiate radio frequency energy and, if not installed and used in accordance with the instructions, may cause harmful interference to radio communications. However, there is no guarantee that interference will not occur in a particular installation. If this equipment does cause harmful interference to radio or television reception, which can be determined by turning the equipment off and on, the user is encouraged to try to correct the interference by one or more of the following measures:

- Reorient or relocate the receiving antenna.
- Increase the separation between the equipment and receiver.
- Connect the equipment into an outlet on a circuit different from that to which the receiver is connected.
- Consult the dealer or an experienced radio/TV technician for help.

Note: The Grantee is not responsible for any changes or modifications not expressly approved by the party responsible for compliance. such modifications could void the user's authority to operate the equipment.

The device has been evaluated to meet general RF exposure requirement.

To maintain compliance with FCC's RF exposure guidelines, the distance must be at least 20 cm between the radiator and your body, and fully supported by the operating and installation configurations of the transmitter and its antenna(s).