

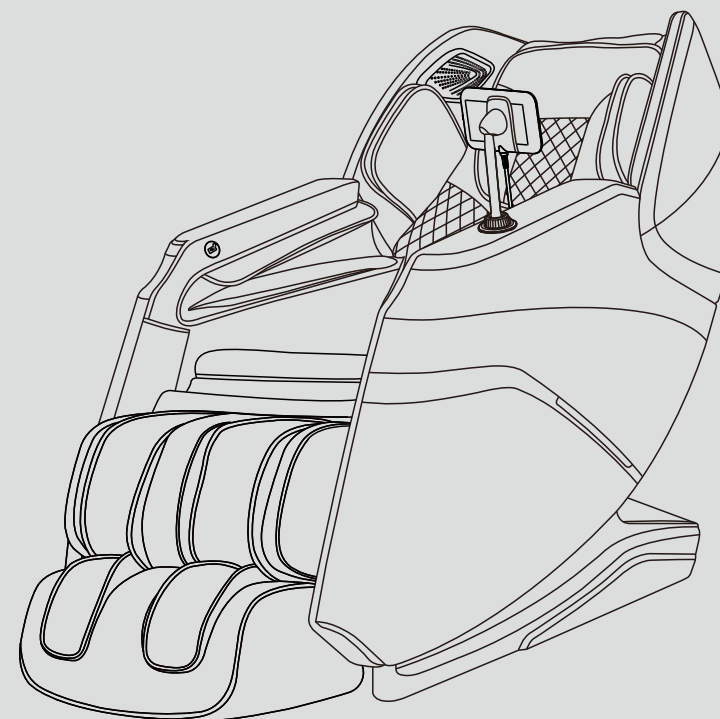

MT336 MASSAGE CHAIR

OPERATION INSTRUCTIONS

SAVE THESE INSTRUCTIONS



FCC Statement:

This device complies with part 15 of the FCC Rules. Operation is subject to the following two conditions: (1) This device may not cause harmful interference, and (2) this device must accept any interference received, including interference that may cause undesired operation.

This equipment has been tested and found to comply with the limits for a Class B digital device, pursuant to part 15 of the FCC Rules. These limits are designed to provide reasonable protection against harmful interference in a residential installation. This equipment generates, uses and can radiate radio frequency energy and, if not installed and used in accordance with the instructions, may cause harmful interference to radio communications. However, there is no guarantee that interference will not occur in a particular installation. If this equipment does cause harmful interference to radio or television reception, which can be determined by turning the equipment off and on, the user is encouraged to try to correct the interference by one or more of the following measures:

- Reorient or relocate the receiving antenna.
 - Increase the separation between the equipment and receiver.
 - Connect the equipment into an outlet on a circuit different from that to which the receiver is connected.
 - Consult the dealer or an experienced radio/TV technician for help.
- Caution: Any changes or modifications not expressly approved by the party responsible

for compliance could void the user's authority to operate the equipment. This equipment complies with FCC radiation exposure limits set forth for an uncontrolled environment. This transmitter must not be co-located or operating in conjunction with any other antenna or transmitter.

This equipment should be installed and operated with minimum distance 20cm between the radiator & your body.

Thanks for purchasing this product. Please read this manual instruction carefully in order to know how to use this product correctly before operation. Please pay more attention to some important safety warning and keep this manual book properly for future use.

Note: Our company reserves the right to change and explain the design of the product. If there is some difference between the product function in market circulation and the description in the manual, it is a normal update of the product, and our company will not inform you otherwise. The specific product function and color shall prevail in kind.

CONTENTS

Safety and Maintenance	02
Safety Warning	04
Name of Components	06
Function	07
Introduction of remote controller	08
Method of Usage	09
I. Turn on the power supply of this product	09
II. Massage Function Control Operation	09
III. Voice control function	21
IV. Turn off the power and stop massage	22
V. The calf installation	22
VI. Controller bracket installation instructions	23
VII. Instructions for removal and use of head cushion and backrest	24
VIII. Floor Protection	24
IX. Method of movement	25
Product Specification	25

Safety and Maintenance

1. Important Safety Warnings

- Do not allow children to touch any movable part of this product.
- Use the well-grounded power supply unit suitable for this product.
- Pull out the plug after use or before cleaning to avoid any physical injury or damage to the product.
- Operate this product as instructed in this manual.
- Do not use any parts or accessories which are not recommended.
- Do not use this product outdoors.
- Please read the Operation Instructions carefully before operation.
- Never use this product for any other purpose not listed herein.
- 20 minutes of usage each time is recommended.
- Do not use this product if the leather is broken or damaged.
- Do not use this product if the cover or leather is broken or damaged.
- Do not use this product if the radiator hole is covered or blocked.
- Do not drop anything into this product.
- Never fall asleep while using this product.
- Do not use this product if you are drunk or feel unwell.
- Do not use this product within one hour after a meal.
- Do not use this product with excessive force to avoid any injury.
- Do not carry any fragile, explosive, or combustible material in your pocket, such as a mobile phone and lighter when using the massage chair.

2. Operating Environment

- Do not use this product in a very moist environment such as the bathroom.
- Stop using this product immediately when the ambient temperature changes sharply.
- Do not use this product in any heavily-dusty or caustic environment.
- Do not use this product in a small space or a place without good ventilation.
- The normal room temperature ranges from 0 °C to 35 °C.
- Do not use this product in an excessively humid room such as a bathroom. Use it at a relative humidity between 20% and 80%.
- Do not use this product outdoors.
- Avoid direct sunlight.
- Keep this product away from any heat source such as a stove and air outlet of an air conditioner.
- Do not use this product during thunder or lightning weather.
- Do not use this product in dusty places.

3. The following populations should not use this product:

- Patients with osteoporosis.
- Patients with heart disease or wearing electronic medical devices such as a pacemaker.
- People who have a fever.
- Pregnant women or women on their menstrual period.
- Patients who are injured or have a skin disease.
- When unsupervised, any children are under the age of 14 and those unconscious are not allowed to use this product.
- People who are told by their physicians to have rest or who feel unwell.
- People whose bodies are wet are forbidden to use this product.
- This product has a hot surface. Persons insensitive to heat must pay attention when using this product.

Safety and Maintenance

4. Safety Precautions

- Check whether voltage is consistent with the specification of this product.
- Never insert or pull out the plug with a wet hand.
- Do not let water flow into this product to avoid electric shock or cause damage to this product.
- Do not pull the power cord when plugging or unplugging it. Rough handling is forbidden.
- Do not damage the wire or modify the circuit of this product.
- Do not clean live parts of this product with a wet cloth such as a power switch and plug.
- Be away from this product in case of power failure to avoid any injury if power is restored suddenly.
- Stop using this product at once while it works abnormal, and consult your local supplier.
- Stop using this product if you feel unwell, and consult your health care practitioner.
- This product is not intended for use by persons (including children) with reduced physical, sensory or mental capabilities, or lack of experience and knowledge, unless they have been given supervision or instruction concerning the use of this product by the personnel responsible for their safety. Children should be supervised to ensure that they do not play with this product.
- If the power cord is damaged, it must be replaced by the manufacturer, its service agent or similarly qualified staff in order to avoid hazards.

5. Product Service and Maintenance

- This product should be maintained by the service center designated by the manufacturer only. No user should disassemble or maintain it without permission.
- Do not forget to turn off the main power switch after usage.
- Do not use this product if the power socket becomes loose.
- If this product will be left unused for a long period of time, it is necessary to roll up the power cord of this product and store this product in a dry and dust-free environment.
- Do not store this product at a high temperature or near open flame. Avoid prolonged exposure to direct sunshine.
- Please clean this product with dry cloth. Never use thinner, benzene or alcohol.
- The mechanical components of this product are specially designed and manufactured, so no special maintenance is needed.
- Do not use a sharp object to stab at this product.
- Do not roll or pull this product on any uneven ground. Instead, it should be lifted before moving.
- Please use this product intermittently. Do not keep it working continuously for a long period of time.

6. Solutions to Ordinary Malfunctions

- If the motor sounds during operation of this product, this is the normal operation sound.
- If the controller cannot work normally, check whether the plug and the power socket are connected reliably, and whether the power switch is turned on.
- If the rated working time is over, this product will automatically activate the power-off button; If this product keeps operating for a long period of time, the temperature protector will stop this product automatically. The product can be used again after half an hour.

7. Storage Conditions

- Storage room temperature: -5 °C to 35 °C.
- Relative humidity (RH) between 20% and 80%; free of corrosive gases, and a well-ventilated room.

Use safety warning

! Warning

When the footrest lifting, people should not apply pressure on the footrest to avoid the massage chair falling forward to damage the product or cause personal injuries.

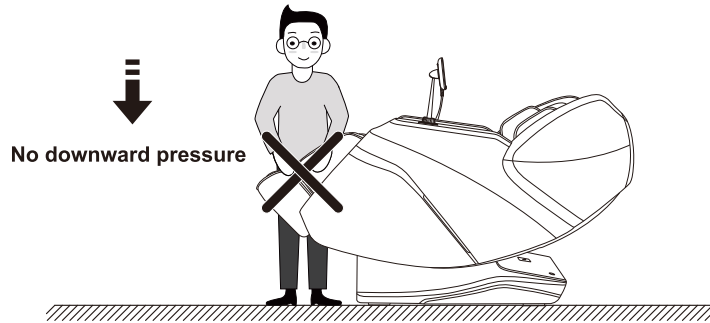

! Warning

Before sitting on the massage chair, Please make sure the massage hand cannot place in the seat position, so as avoiding the massage hand to damage the product or cause personal buttocks injuries.

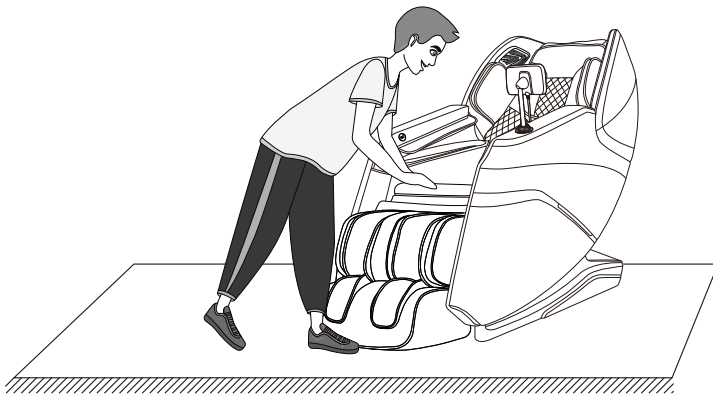

Use safety warning

! Warning

Do not strive to pull out the touch screen control cable or power cord during standby or power-on state to avoid product damaged or electrocution accidents. Advise you unplug the controller cable and power cord and store properly if you do not use the chair.

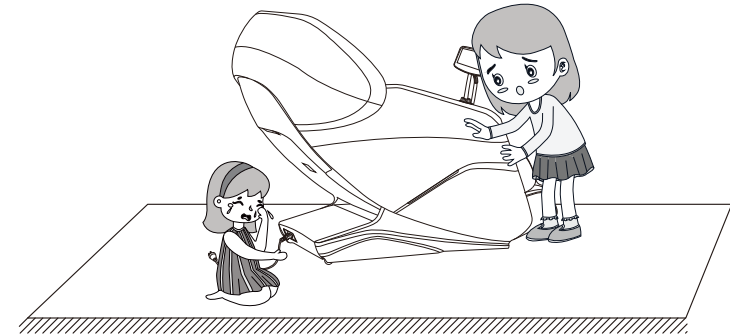

! Warning

When turning on the zero-gravity lying function, be sure to notice whether there are children or pets under the massage table under the bottom of the calf and the backrest to stay or play to avoid product damage and personal injury.

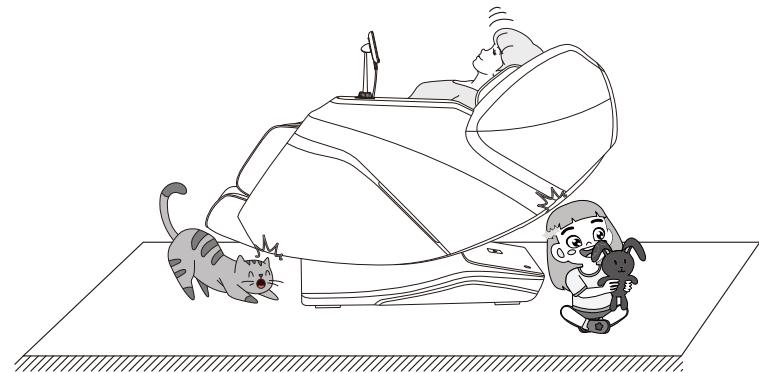

Name and function of components

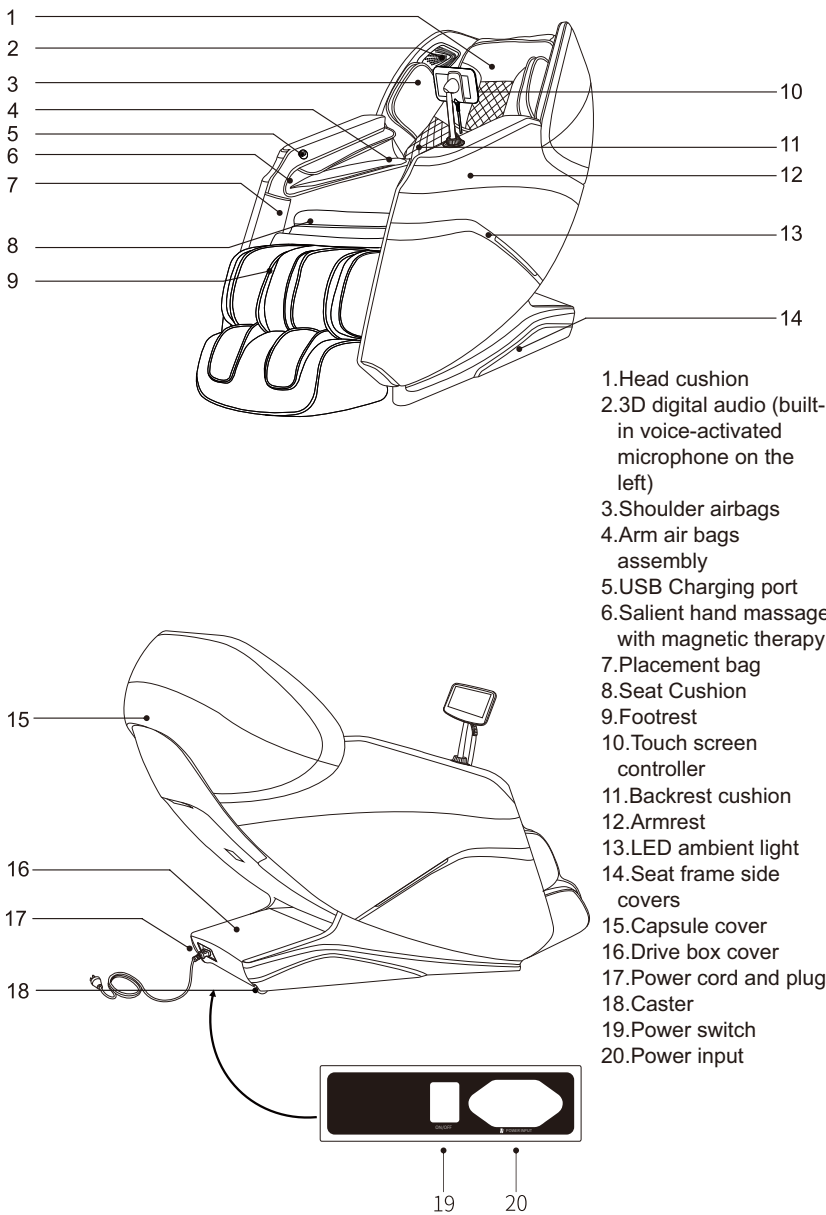

Function

- This product is designed with a set of back roller that can walk up and down and are driven by four wheels.
- There are nine simulation massage techniques including kneading, tapping, kneading&tapping , shiatsu, Knocking, 3D kneading(3D I), 3D tapping(3D II), 3D kneading&tapping (3DIII),3D Shitasu(3D IV).
- Equipped with automatic shoulder detection.
- Equipped with fifteen automatic massage functions: including comfort, relax, stretch, neck&shoulder, back&waist, full body, spine care, fatigue recovery, meridian treatment , sedentary stretch, goodnight sleep, leisure wellness, sports healing, elderly massage, body balance.
- With manual massage function :full body, spot, partial, upper, lower five kinds of back massage parts can be selected; the speed of each massage technique can be adjusted in five levels; in spot and partial, the mechanical hand can adjust the upper and lower positions ; In addition to the kneading function, the width of the mechanical hand can be wide, medium and narrow three levels.
- Air pressure massage function: three modes can be selected : full air, upper air and lower air; Three levels of intensity selection.
- With foot roller massage function.
- The calf frame with electric telescopic adjustment function, which can adapt to different people's heights.
- With back graphene heating function.
- The backrest frame recline uses slide rail technology to keep zero space against the wall, maximizing space savings.
- Music playback system with 3D digital audio built into the left and right speaker covers. Bluetooth function of smart devices can be used to play music with a wireless connection.
- Equipped with intelligent voice recognition function.
- Left and right palm air bags with Bump massage and magnetic therapy functions.
- Equipped with Touch screen controller.
- USB charging function is provided on the right armrest.
- Both side armrests are equipped with LED ambient lights.
- Automatic seat-up function and automatic reset for back roller when power off .

Introduction of remote controller

Introduction of remote controller



Note: The touch screen controller display color, massage function and the typesetting sequence of massage function icons, please refer to the actual display!

- 1、Bluetooth switch key
- 2、Time adjustment key
- 3、Status
- 4、Shoulder position adjust key
- 5、Massage status
- 6、Air pressure intensity
- 7、Manual, customise, angle adjustment, setting function keys
- 8、Power switch key
- 9、Automatic massage function key
- 10、Massage on/off key
- 11、3D massage function keys
- 12、Run/pause key

Method of usage

I.Power on the whole machine

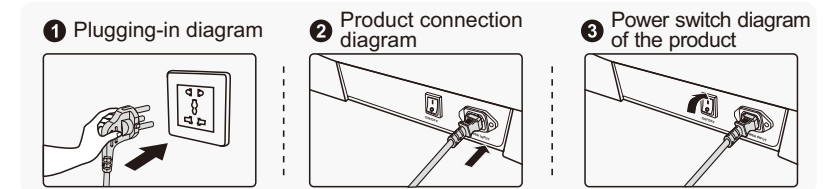

II.Message function control operation

1.Start Massage(on/off key)

- In the standby or reset status of the massage chair, the logo will be displayed in lock screen time, press the on/off key to enter the waiting for automatic mode selection interface, and enter the automatic mode "comfort massage" automatically if there without any confirmation within 20s.
- When the massage chair is not in standby and non-reset status, press the on/off key will turn off the massage, and the massage chair will standby after resetting.



- 1)VIP program:comfort, relax, stretch, neck&shoulder, back&waist.
- 2)Health care program:full body, spine care, fatigue recovery, meridian treatment , sedentary stretch.
- 3)Special program:goodnight sleep, leisure wellness, sports healing, elderly massage, body balance.

- After choose any automatic mode, the position of backrest and calf frame will be adjusted to the set angle. If you press the "X" key, it will enter to the shoulder position detection directly .
- After the angle adjusted, the massage chair will enter into shoulder position detection automatically and waiting for complete. If you press the "X" key, you will enter the manual shoulder adjustment interface directly.

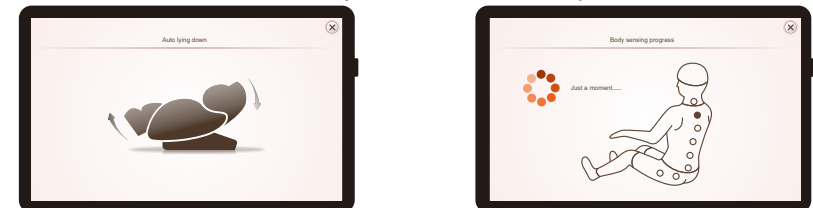

Method of usage

• After the shoulder position is detected, the buzzer will prompt with "DiDi" sound. If it is different from the actual shoulder position, adjust it to the appropriate position by pressing the "Up key" or "Down key" manually. The shoulder position can be adjusted in 11 levels. If without any adjustment within 10 seconds, it will start massage function automatically. Or press the "ok" key directly to start massage immediately. If the shoulder position cannot be detected, chair will start massage at the default shoulder position height.

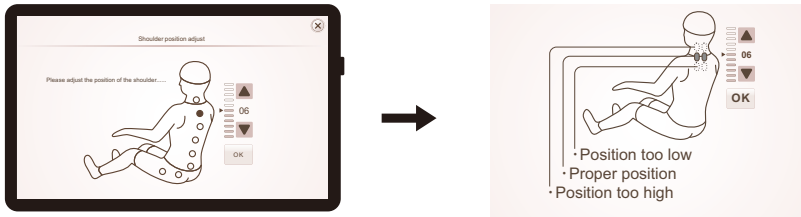

Key	Description
	Adjust the position of the back roller upward to make it reach the appropriate shoulder position.
	Adjust the position of the back roller downwards to make it reach the appropriate shoulder position.

2.Pause key

• When the massage function is running, press the "Pause" key to stop all massage functions temporarily; press the "Pause" key again, the massage function continues to run the massage function. If the pause time exceeds 20 minutes, all massage functions will turned off automatically.

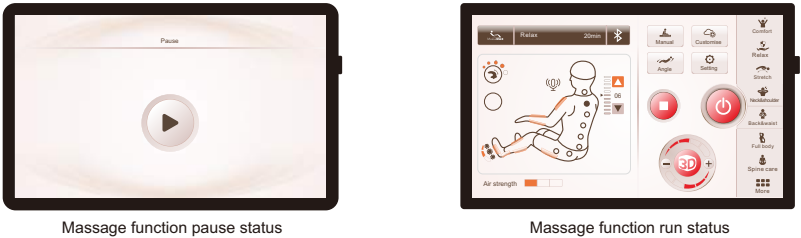

Run/pause key	Description
Pause	Running status, press this key to pause all current massage functions.
Running	In the pause status, press this key continue to run the massage function as pause before.

Method of usage

3.Message intensity (3D key)

• In the massage information interface, press the "-" or "+" key of the 3D icon to adjust the massage intensity of back roller. There are 5 levels.



Note:

• Message intensity: 3D message intensity, means back roller go forwarder or backward. The intensity adjusts the specific whole area. Turn on to detect the body shape, and the intensity of each massage point has been detected. If you feel the intensity of a massage point needs to be adjusted, you can adjust it through this key. In automatic and manual mode, the massage intensity can be adjusted at any time.

4.Automatic function

• There are three types of automatic massage scenes with different characteristics in automatic mode:
1)VIP Auto Program:comfort, relax, stretch, neck&shoulder, back&waist.
2)Healthcare Auto Program:full body, spine care, fatigue recovery, meridian treatment , sedentary stretch.
3)Special Auto Program:goodnight sleep, leisure wellness, sports healing, elderly massage, body balance.



Method of usage

	Function	Description
VIP	Comfort	The most comfortable massage experience.
	Relax	Gentle and comfortable deep massage to relieve physical fatigue and relax the body.
	Stretch	The calf frame and the backrest frame are used to lift and lower the legs and waist, which can effectively relieve fatigue, relieve joint pain and restore vitality.
	Neck& shoulder	The unique massage technique for the shoulders and neck helps to promote blood circulation, relieve neck and shoulder pain, and improve blood supply to the brain.
	Back& waist	Focus on the massage with the back and waist,relieve back pain.
	Full body	Through the holistic massage of the whole body muscles, you can quickly wake up the various functions of the body and start a new day full of vitality.
Healthcare	Spine care	The unique massage techniques for the shoulders and vertebrae help to promote blood circulation, relieve neck and shoulder pain, and improve blood supply to the brain.
	Fatigue recovery	Improve the fatigue and soreness of the whole body, relax the back and limbs, improve microcirculation, and quickly relieve fatigue.
	Meridian treatment	To clear the meridians, quickly improve the body's microcirculation, enhance immunity.
	Sedentary stretch	For prolonged sitting, massage can increase the amount of physical activity, release stress and improve body function.

Method of usage

Special	Goodnight sleep	Through the massage for the twelve acupuncture points, it can help the body to adjust the balance, quickly improve sleep, and improve sleep quality.
	Leisure wellness	Quickly recover from physical fatigue after exercise.
	Sports healing	Effective massage for the buttocks and thighs can help shape the body and reduce the accumulation of excess body fat.
	Elderly massage	Effective massage for the lower back, buttocks, thighs, play the role of self-cultivation, adjust the various indicators of the body.
	Body balance	Release stress, relieve fatigue, relax mind, relax muscles, balance body and mind, adjust the mood, and help sleep.

5.Manual Mode

- Press the “Manual” key to enter the manual massage function selection interface, including massage functions such as technique, speed and width, air pressure mode, air pressure intensity, foot roller, voice control, and heating.
- Click the “X” icon to close the manual massage interface



Manual massage function selection interface

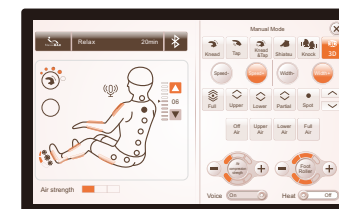

Manual massage function interface

Method of usage

1).Manual Technique

- In the manual massage function interface, select the manual massage technique, massage area, speed and width.
- Manual Technique: including kneading, tapping, kneading&tapping, shiatsu, knocking, 3D kneading(3D I), 3D tapping(3D II), 3D kneading&tapping (3DIII),3D Shitasu(3D IV), nine different massage techniques. The width of the back roller can be adjusted in the status of tapping, knocking, shiatsu, and stopping. The massage speed can be adjusted in all other massage techniques except stop. You can also click the "X" icon to close the manual massage interface.



Function	Back roller adjustment	
Knead	Speed and intensity are adjustable.	• 5 levels of speed could be adjusted • 3 levels of width could be adjusted • 5 levels of intensity could be adjusted
Tap	Speed, width and intensity are adjustable.	
Knead&Tap	speed and intensity are adjustable.	
Shiatsu	Speed, width and intensity are adjustable.	
Knock	Speed, width and intensity are adjustable.	
3D(3D II, 3D IV)	Speed, width and intensity are adjustable.	
3D(3DI, 3DIII)	Speed and intensity are adjustable.	

Method of usage

2).Manual- Massage area

- Manual(Massage area): include spot, partial, full, upper,lower.
- Click the corresponding massage area icon to select the personalized massage function. You can also click the "X" icon to close the manual massage interface.



Function	Description
Spot	Fixed position for spot massage.
Partial	Round-trip massage for a small massage area.
Upper	Round trip massage for the upper back.
Lower	Round trip massage for the lower back.
Full	Round trip massage for the full back.
Up key	The massage position can be adjusted upward in spot or partial mode.
Down key	The massage position can be adjusted downward in spot or partial mode.

Method of usage

3).Manual-air pressure

- Manual (air pressure): including upper body air pressure, lower body air pressure, and whole body air pressure massage functions. Click the corresponding air pressure function icon to turn on the corresponding massage function. Adjust the air pressure by clicking the "−" or "+" button. You can also click the "✕" icon to close the manual message interface.

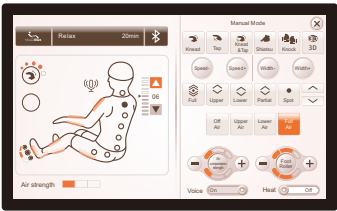

Manual massage function - air pressure selection interface

Strength − +		
Level1	Level2	Level3
When the upper air pressure, lower air pressure or full air pressure are turned on, the air pressure massage intensity can be adjusted, with a total of 3 intensity levels.		

4).Manual - foot roller

- Press the "Foot Roller" key to choose to turn on or off the foot roller massage function. Click "−" or "+" to adjust the roller speed, and the speed can be adjusted in three levels. You can also click the "✕" icon to close the manual message interface.

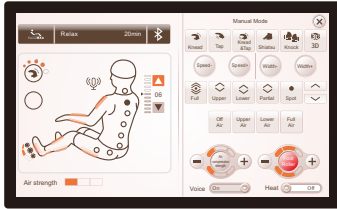

Manual massage function - foot roller selection interface

Function	Description
	Press this key to turn on or off the foot roller massage.

Method of usage

5).Manual-heating

- Click the "Heat ON" button to turn on or off the heating function, and it will be warm after 3 minutes of turning on.
- Click the "✕" icon to close the manual message interface.

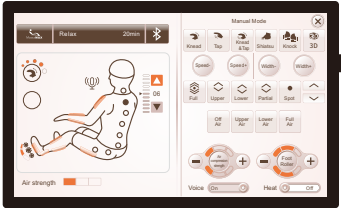

Manual massage function - heat therapy selection interface

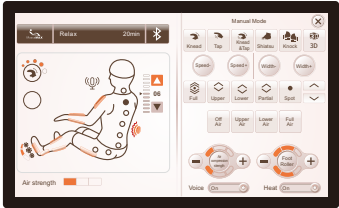

Hyperthermia opening interface

Function	Description
	Press this key to turn the heating function on or off.

6.Customise

- Click the "Customise" button icon to enter the custom memory function selection interface, including Save I, Save II, Save III and other recall functions.
- Select to save or use message functions by clicking .
- Save: Store all the current techniques, air pressure, angle, and other massage functions.
- Use: Recall previously stored techniques, air pressure, angle, and other massage functions.
- Click the "✕" icon to close the custom memory interface.



Custom storage selection interface



Custom storage interface

Method of usage

7.Angle adjustment

- Click the "Angle" button icon to enter the angle adjustment selection interface, including linked seat-up, linked seat-down, calf-up, calf-down, zero gravity, foot adjust.
- Click the "X" icon to close the angle adjustment interface.

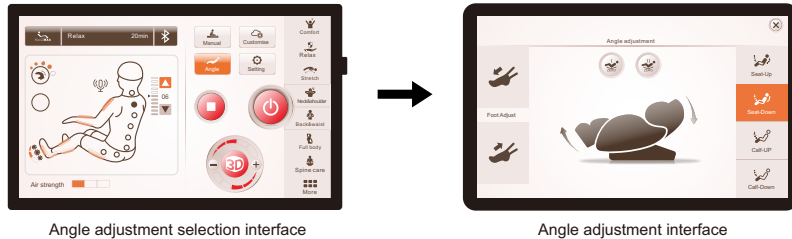

1).Zero gravity adjustment

Key	Description
	Press the key to adjust the position of the footrest and backrest frame to zero gravity I position.
	Press the key to adjust the position of the footrest and backrest frame to zero gravity II position.

2).Lying angle adjustment

Key	Description
	Calf-up key: Press and hold it, the footrest rises slowly, and release it to stop rising. After the calf-up is completed, it will detect the length of the foot automatically .
	Calf-down key: Press and hold it to lower it slowly, and release it to stop descending. After the calf-down is completed, it will detect the length of the foot automatically .
	Seat-up key: Press and hold it to raise the backrest slowly, while the footrest slowly descends, release it to stop the backrest frame from rising or the footrest to descend; after the linked seat-up action is completed, the footrest will automatically detect the foot length.
	Seat-down key: Press and hold it to lower the backrest slowly, while the footrest slowly rises, release it to stop the backrest falling or the footrest rising; after the linked seat-down is completed, the footrest will automatically detect the foot length .

Method of usage

3).Foot adjustment of extension

Key	Description
	Footrest shortening key: Manually adjust the footrest shortening; press and hold this key to move the footrest slowly upwards, release it to stop.
	Footrest lengthening key: Manually adjust the footrest lengthening; press and hold this button to Lengthen the footrest slowly, release it to stop.

8.Setting

- Click the "Setting" button icon to enter the setting selection interface, including brightness, screen off, sound, serial number, language.
- Click the "X" icon to close the setting interface.

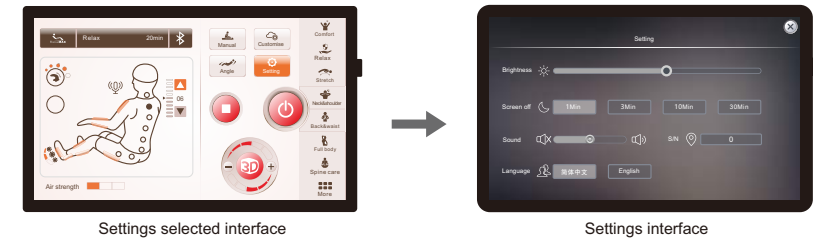

01). Brightness

- Select the brightness slider, slide left and right to adjust the brightness of the backlight.

02). Screen off

- Select the screen off button, with 1 minute, 3 minutes, 10 minutes or 30 minutes.

03). Sound

- Click the "Speaker with X" icon to turn off the key sound, and click "Speaker" to turn on the key sound.

04). Language

- Language selection.

05). Serial number

- Display current device information.

Method of usage

9. Bluetooth

- Click the "Bluetooth" icon to enable or disable the Bluetooth function. "Bluetooth off" means the Bluetooth is off, and "Bluetooth on" means the Bluetooth is on.
- After pairing and connecting a music source device with Bluetooth function (such as mobile phone, MID tablet, etc.) to the Bluetooth module of the message chair, the music played by the source device can be wirelessly transmitted to the speaker of the message chair through Bluetooth system to play.



Bluetooth interface is not turned on

Bluetooth switch button	
Bluetooth off	
Bluetooth on	

Note: Please control the Bluetooth switch on the main interface. On the manual, angle adjustment or custom interface, the Bluetooth function cannot be turned on and off.

10. Time adjustment

- Click the "20min" icon to adjust the message time function. Each press adds 5 minutes, which cannot exceed 40 minutes. If it exceeds 40 minutes, it will return to the minimum time setting.

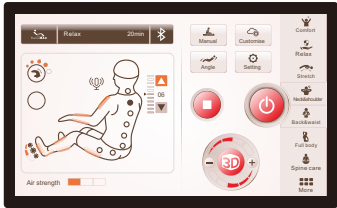

Time adjustment interface

Time adjustment key	

Note: Please adjust the message time on the main interface. On the manual, angle adjustment or custom interface, the timing function cannot be adjusted.

Method of usage

III. Voice control function

- When the message chair is turned on or in standby status, say "Hi Alice" to wake up the voice-activated function.
- The message chair will reply "I am here" after the wake-up is successful, please say the corresponding voice-activated entry within 6 seconds, and the message chair can realize the corresponding voice-activated function after the reply; if no voice-activated words are spoken correctly for more than 6 seconds, the voice control function is automatically turned off and needs to be re-awakened.

Note: When waking up the voice control function, the speech rate should not be too fast, and the language command should be issued according to the voice control entry.

· Voice control entry

Voice control entry		
Wake-up word: "Hi Alice" or "Hey Alice", answer: "I'm here".		
NO	Voice control entry	Answer entry
1	Massage on	Answer: Ok, massage on
2	Massage close	Answer: Ok, massage close
3	Comfort massage	Answer: Ok, comfort massage
4	Relax massage	Answer: Ok, relax massage
5	Full body massage	Answer: Ok, full body massage
6	Neck and shoulder massage	Answer: Ok, neck and shoulder massage
7	Back and waist massage	Answer: Ok, back and waist massage
8	Stretch massage	Answer: Ok, stretch massage
9	Open the air pressure	Answer: OK, open the air pressure
10	Close the air pressure	Answer: OK, close the air pressure
11	Up the seat position	Answer: Ok, up the seat position
12	Down the seat position	Answer: Ok, down the seat position
13	Change the other mode	Answer: Ok, change the other mode
14	Go little down	Answer: Ok, go little down
15	Go little up	Answer: Ok, go little up
16	Fixed massage	Answer: Ok, fixed massage
17	Stop adjustment	Answer: Ok, stop adjustment

Method of usage

IV. Turn off the power and stop massage

- When pressing the power button during the massage, it will stop all the massage functions immediately. the backrest and footrest will go back to the default position. And when the massage time up, the massage hands will go back to the default position, all the massage function will stop. The backrest and footrest will not go back to the default position.
- Cut off the power of the whole machine, Figure(switch power off).



V. The calf installation

- After connecting wires and the air hose between the chair seat and the leg rest, unfasten the fixed pipe belt and insert the connecting part into the seat frame(figure 1).
- Place the round tube from calf left and right sides to the legs brackets(figure 2).

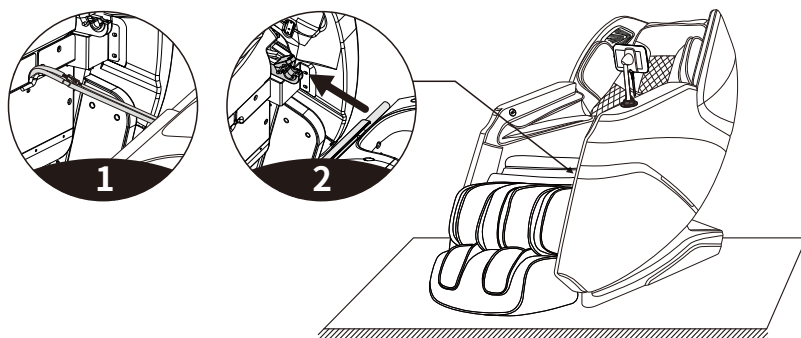

Method of usage

- Then turn the legs fixing cover over the round tube on both sides of the legs (figure 3).
- Then use 2 pcs screws fix the legs on the massage chair, turn up and down to check if there are any problems, the wires and air hose get stuck or not, finish the installation.(figure 4)

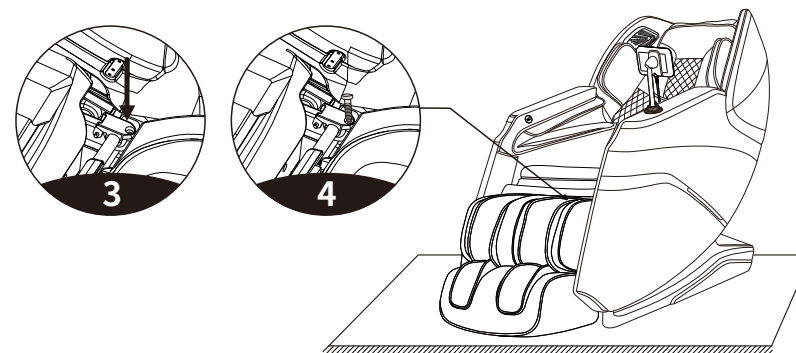

VI. Controller bracket installation instructions

After the screw thread on the support knob of the controller rest assembly aligns to the screw thread position of the support mounting seat on the armrest of the massage chair, just turn clockwise and screw tightly for fixation.

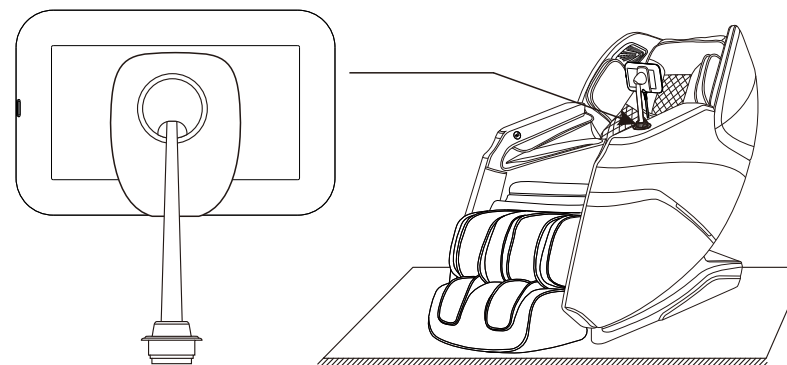

Method of usage

VII.Instructions for removal and use of head cushion and backrest

· The use of the head cushion can reduce the intensity of kneading massage on the neck and shoulders.You can decide whether to use the head cushion according to your own needs(the head cushion is recommended).The backrest and the back cushion are connected by a zipper (1). The head cushion and the backrest are connected by a zipper (2).

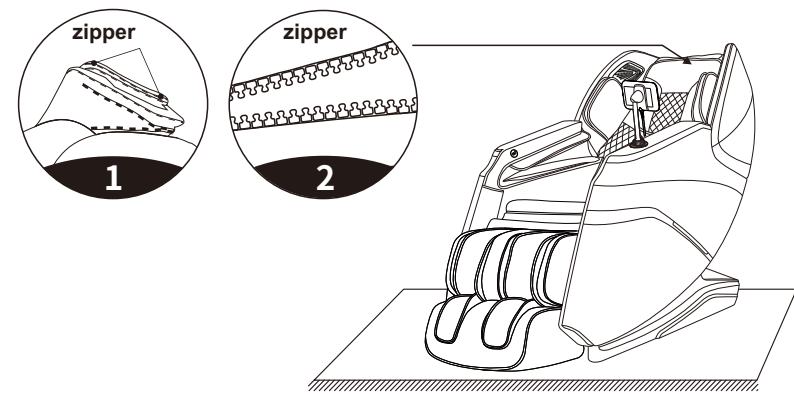

VIII.Floor Protection

· Put the heavy massage chairs on the wood floor for a may damage the floor,so please place a carpet or other object to avoid this damage.

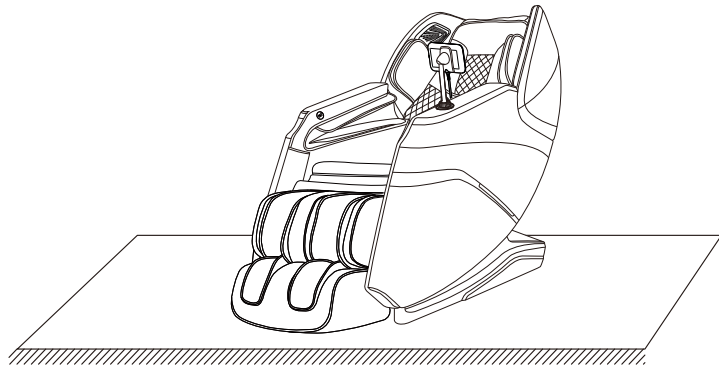

Caution: Do not move the chairs with its wheels on wood floor, rough ground or in a narrow space.Two people are required to lift the chair. During the lifting period,take the calf rest end sealing plate and backrest cover grooves as the force-bearingpoint(Please do not lift armrest directly.)

Method of usage

IX.Method of movement

· Make sure that all wires are far above the ground. Tilt the backrest backward to a certain degree(with the gravity center resting on the wheels), push the chair forward or backward with your hands and finally resume the chair to the normal position in a slow and gentle manner.(Note: During movement you must turn off the power first and then unplug the power cord and the controller cord.)

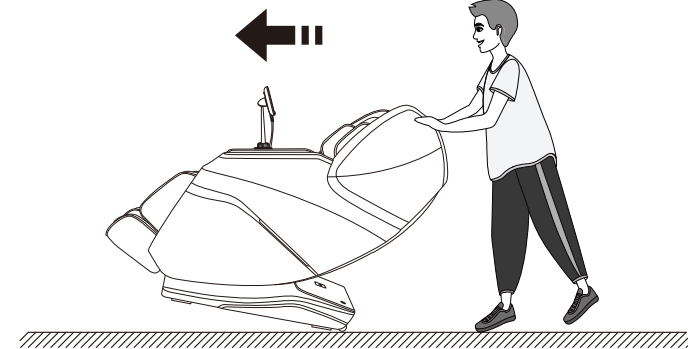

Warning

Massage chair rear wheels are only suitable for short distance movement for long distances, please use other assistive tools to move the massage chair .

Product specification

Model: MT336
Name: Massage Chair
Rated voltage: 110-120V~ 60Hz ☐
220-240V~ 50Hz/60Hz ☐
Rated power input:120W
Rated time: 20Min
Safety structure: Class I

Material introduction: PVC, PA, steel parts and electric & electron parts

MATERIAL	PU	LEATHER	CLOTH	WOOD