

SMART CURTAIN ROBOT

(WiFi Single Version)



catalog

1. Contents	01
2. Accessories List	02
3. Preparation before Use	03
4. Accessories Replacement	04
5. Track Installation	05
6. Roman Rod Installation	06
7. APP Connection	07
8. APP Settings	08
9. FQA	09

2. Accessories List

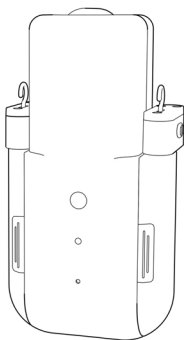

①Host*1

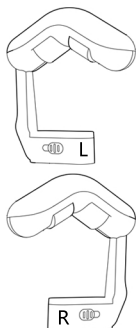

②Roman rod accessories*2



③Wireless Gateway

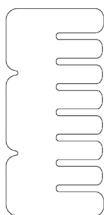

④Telescopic rod accessories*1

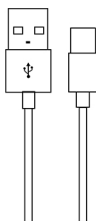

⑤Data cable*1

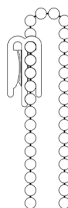

⑥Traction rope*1

Purpose

①Host: device to control the movement of curtains.

②Roman rod accessories: adapted for the installation of Roman rod tracks.

③Wireless gateway: connect to WiFi and support smart home linkage (such as mobile phone App control).

④Telescopic rod accessories: used for the interface position of the Roman rod telescopic rod.

⑤Data cable: for charging the host.

⑥ Traction rope: a traction auxiliary tool when installing perforated Roman rod curtains.

3. Preparation before use

1. Curtain machine diagram

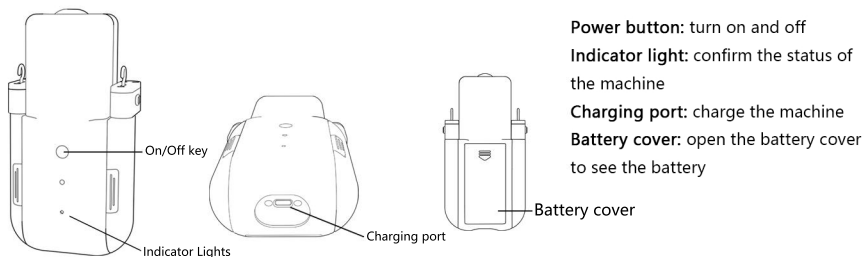

Power on: Press the curtain machine power button once to turn on the curtain machine

Power off: Long press the smart curtain machine power button for 3 seconds, the red light will turn on, and the machine will turn off

Indicator light status during charging:

When charging: the smart curtain robot indicator light is red, fully charged: the smart curtain robot indicator light is blue

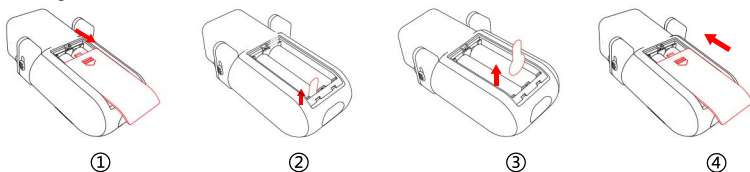

Note: Before use, you need to remove the battery insulation sheet, as shown in the figure

① Push down and remove the battery cover

②③ Remove the battery insulation sheet

④ Push the battery cover up and close it

2. Wireless Gateway

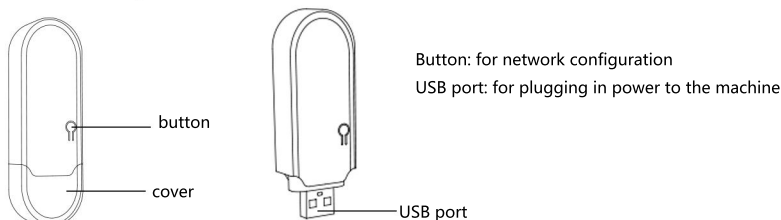

Note: The gateway needs to be plugged in. You need to remove the wireless gateway cover and plug the gateway into a 5V power supply. Press the button twice quickly and the wireless gateway will enter the network configuration state.

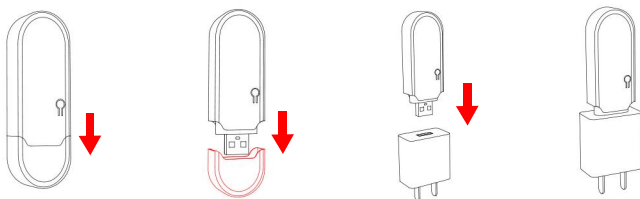

4. How to replace accessories

If it is a Roman rod track, replace the hook accessories on the side cover with Roman rod accessories as shown in the figure

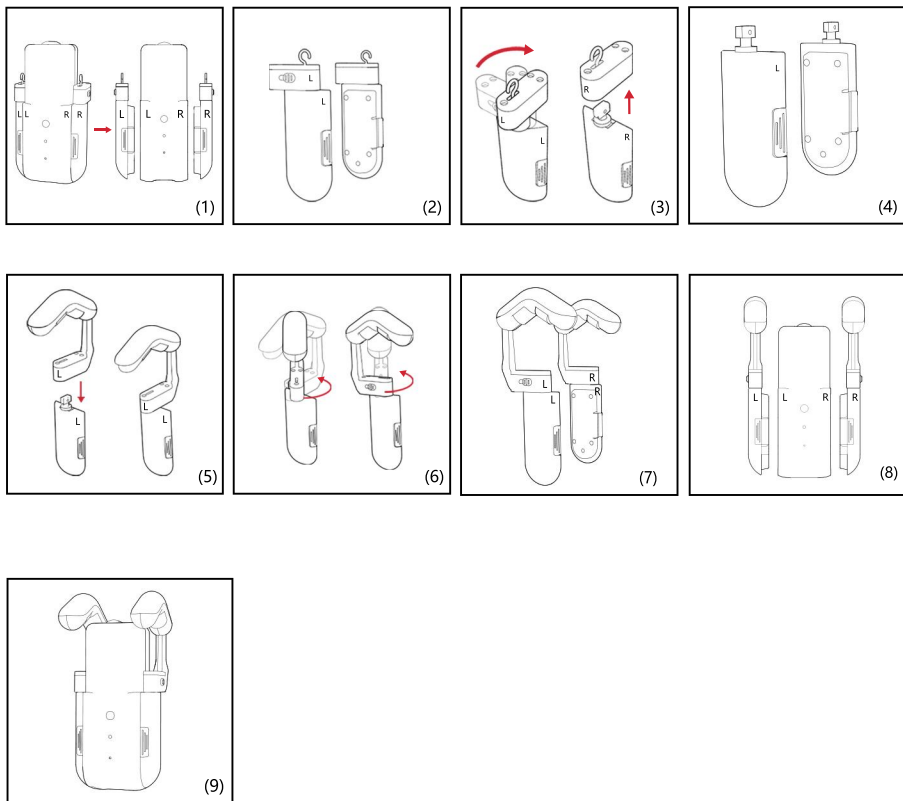

Note: When replacing accessories, pay attention to the left and right of the accessories, L is left, R is right

(1)(2)Remove the side cover of the smart curtain robot

(3)(4)Rotate the hook accessories on the side cover inward 90° and pull out the hook accessories

(5)Install the Roman rod accessories on the side cover as shown above

(6)(7)Rotate the Roman rod accessories outward 90°

(8)Put the machine in the middle of the Roman rod side cover

(9)Close the side cover and the installation is complete

5. Track installation

Step 1: Check your track, choose accessories and install

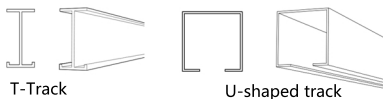

Note: U-shaped and T-shaped tracks need to be used with hook accessories

Step 2: Installation

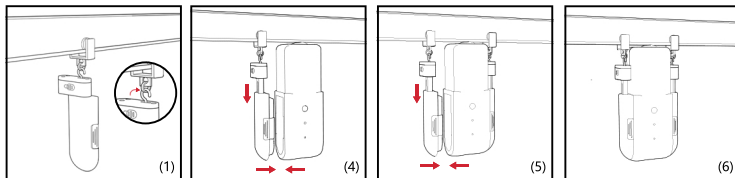

- (1) Remove the side cover of the machine and hang the side cover hook on the track ring
- (2) Remove the other side cover of the machine and hang the side cover hook on the track ring
- (3) Pull down the side cover
- (4) Place the machine next to the side cover and close the side cover
- (5) Pull down the other side cover and close the side cover
- (6) Installation completed

Step 3: The installation steps are as follows

As shown in the picture, close the curtains first, and then face the curtain machine out of the window. Install it between the first and second rings

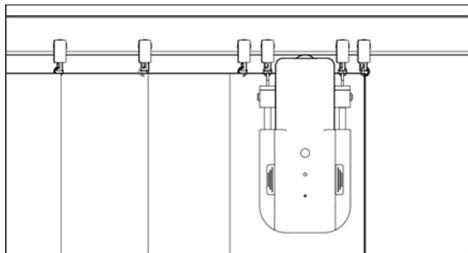

Step 4: Installation

Note: If there are no extra track balls, please follow the steps below.

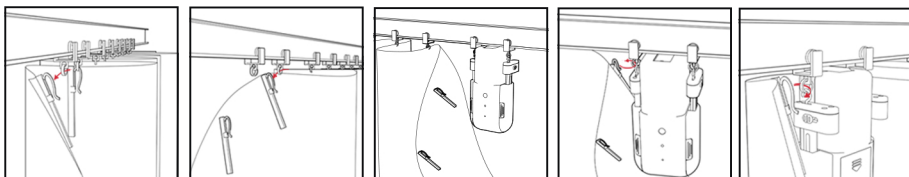

6. Roman rod installation

Step 1:

Confirm whether your Roman rod size is suitable and select the appropriate accessories

Size: 8-40mm

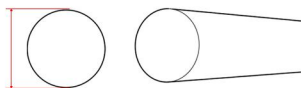

Step 2: Replace accessories. Please refer to page 4-5 for replacement accessories.

Step 3: Installation①

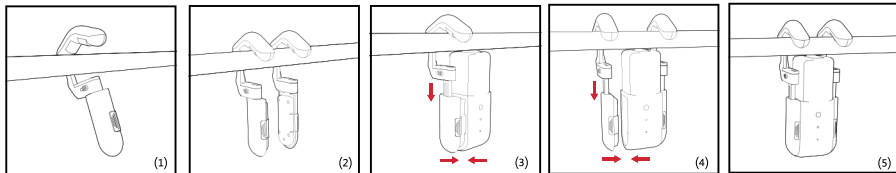

- (1) Tilt the Roman rod side cover and install it on the Roman rod track
- (2) Tilt the Roman rod side cover and install the other side cover on the Roman rod track
- (3) Pull down the Roman rod side cover
- (4) Place the smart curtain robot next to the side cover and close the side cover
- (5) Installation completed

Step 3: Installation ②

As shown in the picture, close the curtains first, and then face the curtain machine out of the window. Install it between the first and second rings

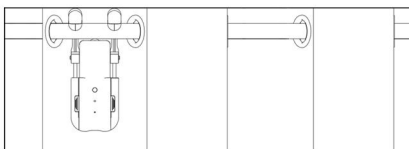

Step 3: Install the traction rope

Note: Perforated Roman rod curtains need to be installed with a traction rope before use. As shown in the figure below, install the traction rope at the top of the curtain and finally cut off the remaining traction rope.

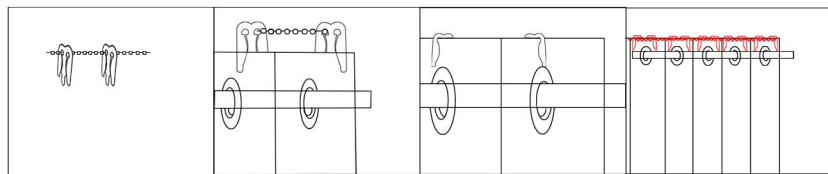

Step 4: Telescopic Rod Accessories

If your smart curtain cannot pass smoothly through the rod telescopic rod connection, we provide a rod connector to solve this problem, as shown in the picture

Remove the protective film from Rod Connector.

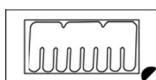

Wrap Rod Connector around the rod slowly while applying pressure to the segment of the metal plate against the thinner end of the rod.

7. APP connection steps

Step 1: APP installation

Download Smart Life or Tuya APP in the App Store,
or scan the QR code to download the APP,
install and register



Chinese version



International version

Step 2: Preparation before use

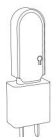

Connect the gateway to a 5V power supply.
Press the power button on the host to turn it on, and install it on the curtain rail.
When you hear a beep, the host and gateway are paired successfully.
Connect your phone to WiFi (2.4G),

Step 3: Connect to APP

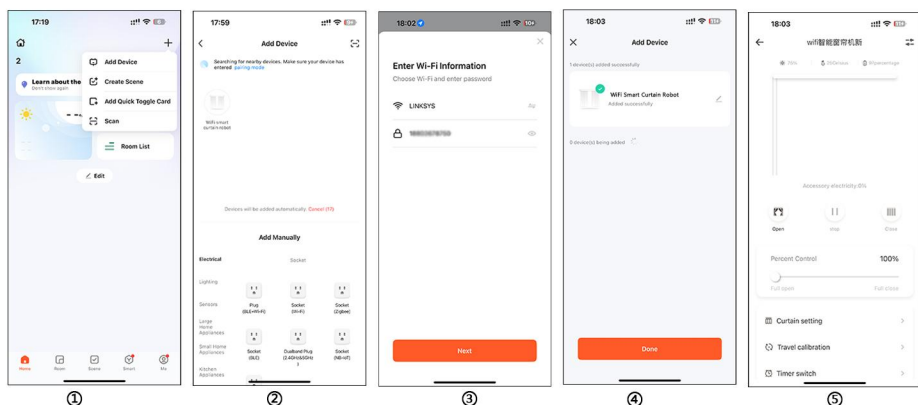

- ① Open the APP, quickly press the wireless gateway button twice, click the "+" in the upper right corner to add a device
- ② Search for "WiFi Smart Curtain Robot", click "WiFi Smart Curtain Robot"
- ③ Enter the WiFi password, click "Next"
- ④ Add the motor "Done"
- ⑤ Go to the curtain machine page, the connection is complete

Step 4: APP illustration

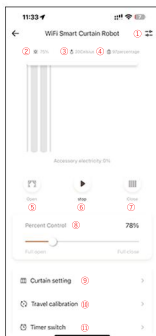

Note before use: You need to calibrate the stroke before use
(The calibration stroke requires a complete walk on the track)

- ① Device information: You can view the device information
 - ② Luminosity: The light intensity sensed by the device
 - ③ Temperature: The temperature sensed by the device
 - ④ Battery: The device battery
 - ⑤ Open: Open the curtains
 - ⑥ Pause: Pause
 - ⑦ Close: Close the curtains
 - ⑧ Percentage: The percentage of the curtain switch
 - ⑨ Curtain settings: Mode switching, luminosity settings, temperature settings,
 - ⑩ Stroke calibration: Calibrate the stroke of the curtain track
- Timer switch: Set the timer switch curtain

8. Settings Page

1. Curtain settings

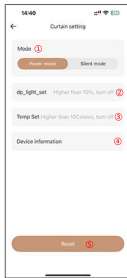

① Mode switch

Power mode: The machine has greater power and louder sound, so it can push heavier curtains

Silent mode: The machine has less power and quieter sound.

It can push lighter curtains

② Brightness setting: Set it higher than N% to close the curtains

③ Temperature setting: Set it higher than N% to close the curtains

④ Device information: You can view device information

⑤ Reset: Reset all settings of the APP

2. Stroke calibration

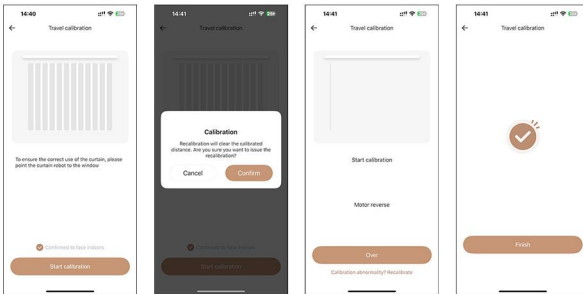

1. Close the curtains first, and hang the smart curtain machine facing the window between the first ring and the second ring. Click to start calibration

2. Recalibrate the stroke, and the previous stroke will be automatically cleared

3. Click to start calibration, the curtain machine will start to open the curtains, and click to complete the calibration after the curtains are fully opened

(If the curtain machine is in the opposite direction, click the motor reverse direction, click to start calibration, and click to complete the calibration after the curtains are fully opened)

4. The calibration is successful, click to complete

3. Timing settings

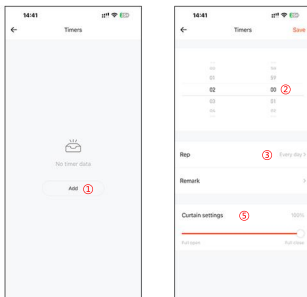

① Click to add

② Set the specific time of the switch

③ Set the switch repetition time (Monday-Sunday)

④ The percentage of the switch

9. FAQ

1. The app is connected, but cannot be controlled

Answer: (1) The distance between the gateway and the curtain motor is too far (10 meters in an open space, do not use the gateway and the curtain motor with a wall).

(2). The curtain motor is reset due to misoperation. It needs to be re-paired with the gateway. Press the host for 5 seconds and the red light flashes to shut down. After the red light goes out, press the curtain motor button to turn it on.

After turning on, press it twice in a row to pair it. When the curtain motor is paired with the gateway, there will be a beep sound and the pairing is successful. Then the app can be controlled normally.

2. After it is fully charged, the app power display is still 0

Answer: After it is fully charged, you need to wait for the curtain machine to feedback the power to reconnect to the app. The power will be displayed normally after 5 minutes

3. The gateway is powered on, but the App cannot connect

Answer: Unplug the gateway and plug it in again. After plugging it in, press the gateway twice in a row to re-connect the network.

6. The curtain cloth through the Roman rod hole cannot be dragged

Answer: Is the traction rope in the package not installed? Please install it according to the installation method of the pull bead.

7. The telescopic rod of the Roman rod track cannot pass

Answer: Have you installed the telescopic rod accessories in the product packaging? Install them according to the telescopic rod accessories.

8. Cannot be dragged in silent mode

Answer: The power will be attenuated by 40% in silent mode. If the curtain is too heavy, please use the power mode.

9. The switch direction is reversed after removing the charging

Answer: The installation direction is reversed. Please change the machine left and right.

Product pairing method: To re-pair the product, press the curtain master and slave machine buttons 5 times in a row in the power-on state, and then the red light will beep three times and then enter the factory setting.

The red light goes out to indicate that the recovery is complete. After restoring the factory settings, the host is in the off state.

1. Pairing the host with the remote control: Press the curtain host to turn on, and press the curtain host button twice in a row after turning on to enter the pairing mode. After long pressing the OPEN button on the remote control The host beeps, and the pairing is successful.

2. Pairing the host with the gateway: Press the curtain host to turn on, and press the curtain host button twice to enter the pairing mode. After the gateway is powered on, press and hold the button for 5 seconds and the red light will light up. The host will beep and the pairing is successful. Pairing the host with the slave: Press the curtain host to turn on, and press the curtain host button twice to enter the pairing mode. Press and hold for 8 seconds from the off state and the blue light will flash slowly. After the host and the slave are paired, they will beep accordingly, indicating that the pairing is successful.

This device complies with Part 15 of the FCC Rules. Operation is subject to the following two conditions: (1) this device may not cause harmful interference, and (2) this device must accept any interference received, including interference that may cause undesired operation

NOTE: This equipment has been tested and found to comply with the limits for a Class B digital device, pursuant to Part 15 of the FCC Rules. These limits are designed to provide reasonable protection against harmful interference in a residential installation. This equipment generates, uses and can radiate radio frequency energy and, if not installed and used in accordance with the instructions, may cause harmful interference to radio communications. However, there is no guarantee that interference will not occur in a particular installation.

If this equipment does cause harmful interference to radio or television reception, which can be determined by turning the equipment off and on, the user is encouraged to try to correct the interference by one or more of the following measures:

- Reorient or relocate the receiving antenna.
- Increase the separation between the equipment and receiver.
- Connect the equipment into an outlet on a circuit different from that to which the receiver is connected.
- Consult the dealer or an experienced radio/TV technician for help.

Warning: changes or modifications not expressly approved by the party responsible for compliance could void the user's authority to operate the equipment

The devices has been evaluated to meet general RF exposure requirement , the device can be used in portable exposure condition without restriction