

# Tatazone | LED STRIP LIGHT

## User Manual

1

**FCC STATEMENT**  
This device complies with Part 15 of the FCC Rules. Operation is subject to the following two conditions: (1) This device may not cause harmful interference, and (2) This device must accept any interference received, including interference that may cause undesired operation. This equipment has been tested and found to comply with the limits for a Class B digital device, pursuant to part 15 of the FCC Rules. These limits are designed to provide reasonable protection against harmful interference in a residential installation. This equipment generates, uses and can radiate radio frequency energy and, if not installed and used in accordance with the instructions, may cause harmful interference to radio communications. However, there is no guarantee that interference will not occur in a particular installation. If this equipment does cause harmful interference to radio or television reception, which can be determined by turning the equipment off and on, the user is encouraged to try to correct the interference by one or more of the following measures:  
—Reorient or relocate the receiving antenna.  
—Increase the separation between the equipment and receiver.  
—Connect the equipment into an outlet on a circuit different from that to which the receiver is connected.  
—Consult the dealer or an experienced radio/ TV technician for help.  
**FCC Radiation Exposure Statement:**  
This equipment complies with FCC radiation exposure limits set forth for an uncontrolled environment. In order to avoid the possibility of exceeding the FCC radio frequency exposure limits, Human proximity to the antenna shall not be less than 20cm(8 inches)during normal operation.  
That changes or modifications not expressly approved by the party responsible for compliance could void the user's authority to operate the equipment.

## 2 Installation Step

**Warmly reminded: Noted: test the light strip before install.**

a. Wipe the surface to make sure it's clean and dry.



b. Peel off the protective film on the tape, stick the light strip on and press over it firmly.

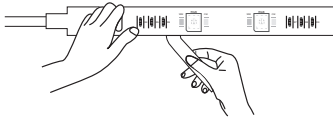

c. The wire bend it around corner.

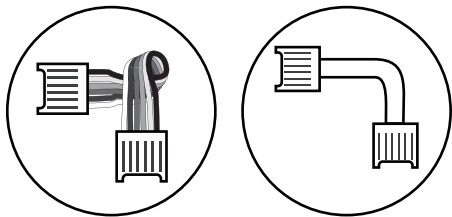
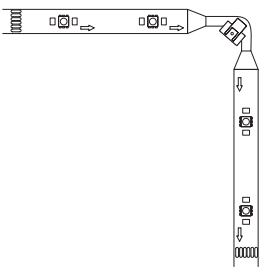

How to turn the corner?

d. Connect bluetooth.

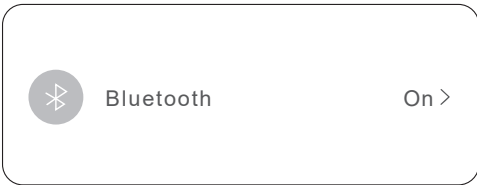

e. Holding controller button until strip light fast flashing.

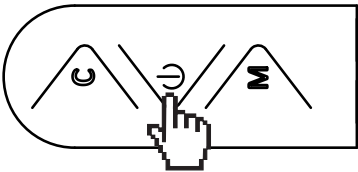

f. Check the App, click “go to add”.



g. The device added successfully.

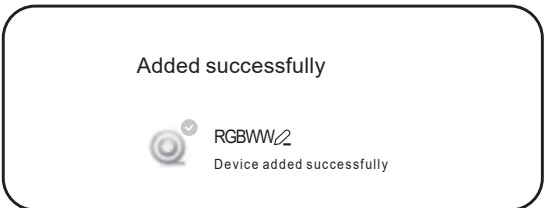

c. Peel off the protective film on the control box and stick it on.

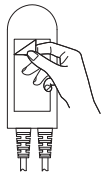
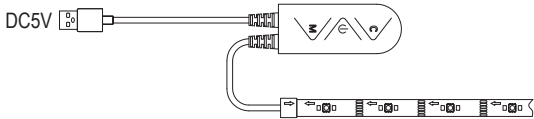

d. Power on the strip lights and start using.

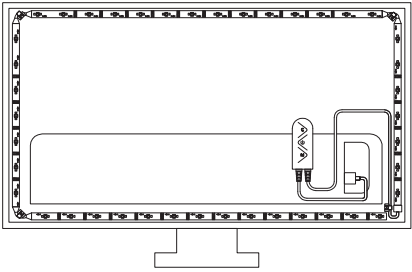

## 3 Connecting Diagram

a.

1. Connect the strip light to bluetooth controller
2. Connect the strip light to TV USB port.

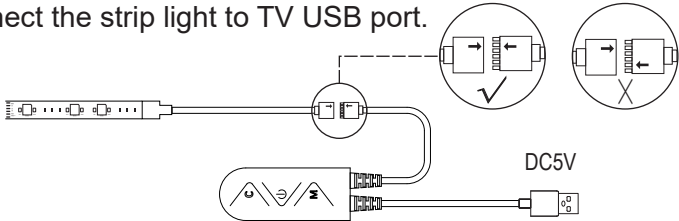

b.Download Tuya App on the Apple store, Google Play.

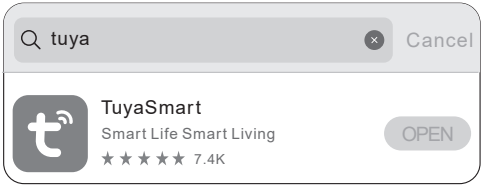

c.Register account, and login in.

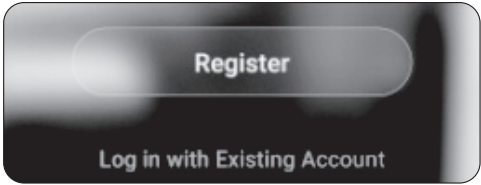

## 4 Controller Functions

a. Controller

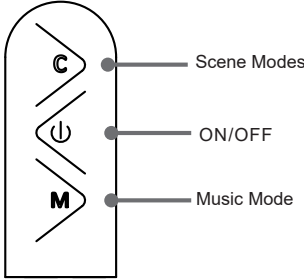

b. RF Remote

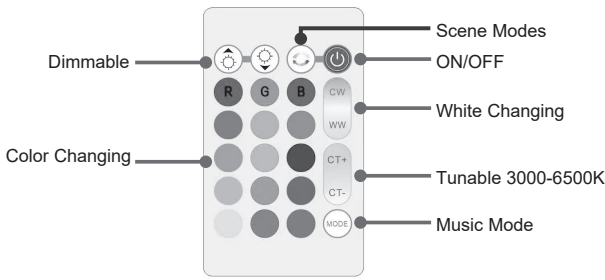

c. Replace Battery

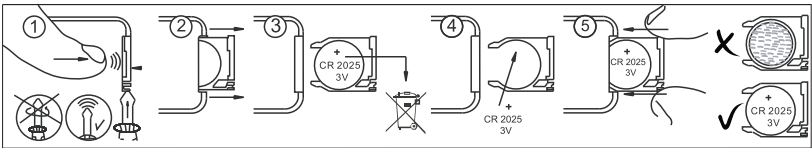

## 5 Troubleshooting

Why the light strip not light up?

- 1.Check the plug whether arrow to arrow.
- 2.The power of TV USB port is not 5V/1A, you can use the usb phone charger as the power supply.

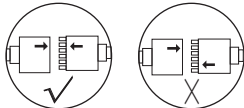

Why the remote not working?

Pull the battery out of battery compartment, and then push it in.

Why the light strip light up automatically?

- 1.The unstable power supply voltage of the TV leads to frequent resetting of the device chip module, youcan use a phone charger as a power supply to solve this problem, if still not working, pls send email to our email box.
- 2.Check if the timer function is set.
- 3.Delete the device and connect it again.

Why the light strip flashing?

The power of tv usb port is not enough.

## 6 How to contact us?

- 1.Email: support@tatazone-led.com
- 2.Open Amazon order page, click “Contact the seller”.