

# User Manual

## 1 FCC STATEMENT

This device complies with Part 15 of the FCC Rules. Operation is subject to the following two conditions: (1) This device may not cause harmful interference, and (2) This device must accept any interference received, including interference that may cause undesired operation.

This equipment has been tested and found to comply with the limits for a Class B digital device, pursuant to part 15 of the FCC Rules. These limits are designed to provide reasonable protection against harmful interference in a residential installation. This equipment generates, uses and can radiate radio frequency energy and, if not installed and used in accordance with the instructions, may cause harmful interference to radio communications. However, there is no guarantee that interference will not occur in a particular installation. If this equipment does cause harmful interference to radio or television reception, which can be determined by turning the equipment off and on, the user is encouraged to try to correct the interference by one or more of the following measures:

- Reorient or relocate the receiving antenna.
- Increase the separation between the equipment and receiver.
- Connect the equipment into an outlet on a circuit different from that to which the receiver is connected.
- Consult the dealer or an experienced radio/ TV technician for help.

That changes or modifications not expressly approved by the party responsible for compliance could void the user's authority to operate the equipment.

## Cutting.

## 2

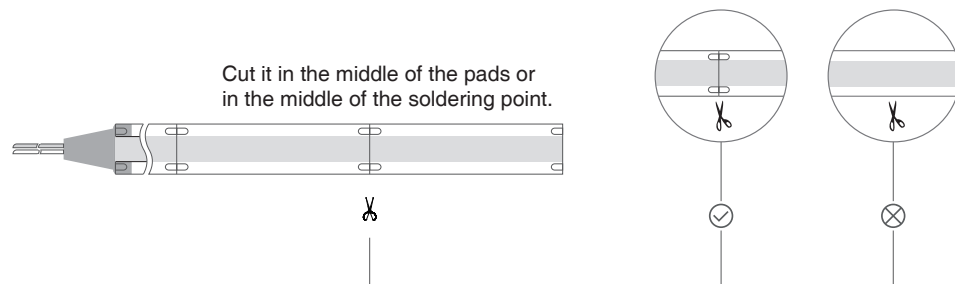

## 3 Installation Step.

a. Choose a dry, clean and smooth surface.



Knitted/Wool fabrics



Dusty wall



Rough plastic surface



Frosted glass

b. Wipe the surface to make sure it's clean and dry.



c. Peel off the protective film on the tape, stick the light strip on and press over it firmly.

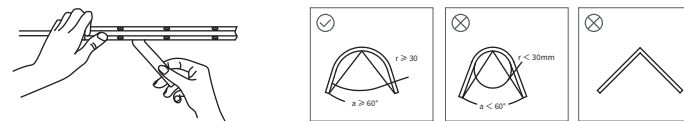

d. Power on the COB light strip and begin using.

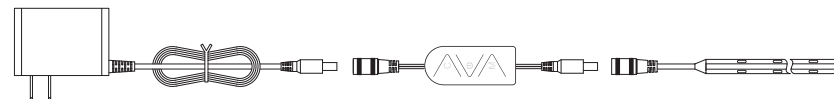

## 4 Controller Functions.

a. Controller

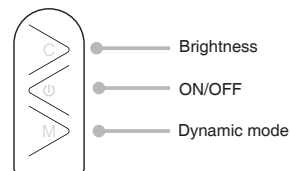

b. Remote Control

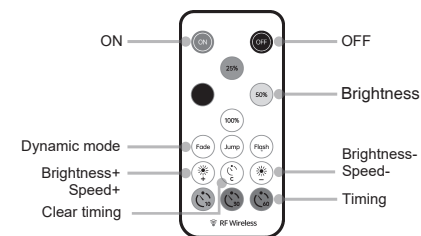

c. Replace Battery

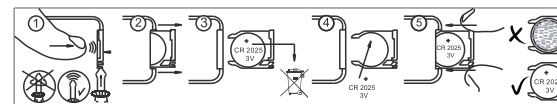

## 5 How to set each remote to work separately?

Noted: If you've two or more of this kit, unplug the power supply of other set when you pair the remote.



Pair Remote

Hold "10%" and "50%" button at the same time for 3s, and then release the button, the light flashing 3 times, successful.



Unpair Remote

Hold the "Off" button until the light flashing 3 times.

## How to fix the light strip auto turn on or auto flashing?

Pair the remote would fix this problem.

## 6 How to contact us?

1. Email: [support@tatazone-led.com](mailto:support@tatazone-led.com)

2. Open Amazon order page, click "Contact the seller".