

# Motorcycle Dash Cam



## MD30 User Manual

English/Deutsche/Français/Italiano/Español/日本語

Version: V1.0

# MD30 Motorcycle Dash Cam

Thank you for purchasing MD30 motorcycle camera. In order to better experience this product, please read this user manual carefully before using, and keep this manual well. Hope our product can meet your needs and we will serve you for a long time.

## 1 Structure Introduction

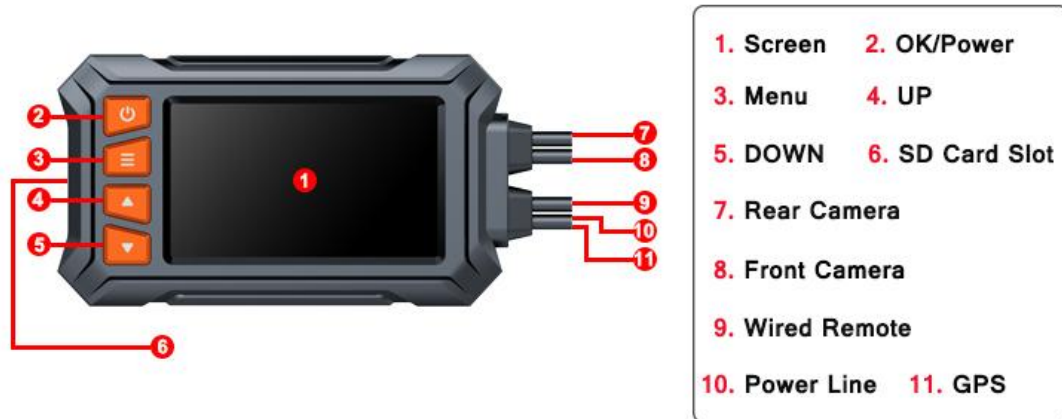

## 2 Key Description

### 1. Power Button/OK Button

When the device is powered on, long press this button to turn on/off. When the device is in the recording state, short press this button to pause recording/start recording. Short press this button on the setting interface to confirm the options.

### 2. Setting Button

When the device is in standby mode, short press this button to enter the main menu settings. When the machine is in standby mode, long press the button to review videos/pictures.

### 3. UP Button

When the device is powered on, short press this button to switch the image interface between front and rear camera. In the setting menu interface, short press this button to switch the setting items.

### 4. DOWN Button

When the device is powered on, short press the button to view the WIFI account and password, long press the button to turn off/on the WIFI. In the menu setting interface, short press

this button to switch the setting items.

### 3 Memory Card Installation



Please use a small screwdriver to loosen the screws and remove the cover, and insert the micro sd card into the card slot in the correct direction. It is recommended to use a high-speed memory card of class10, U3 or above.

### 4 Device Installation

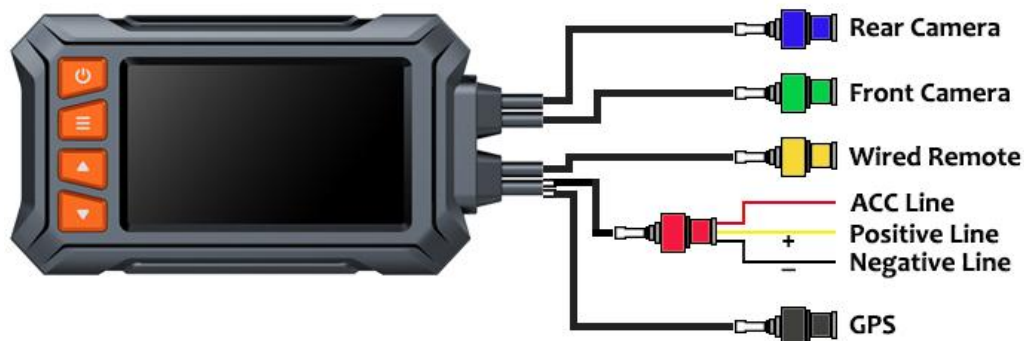

#### 1. Install the host

Select the location you would like to install the host. Since the host support waterproof, it can be installed on the handle bar via using bracket. Also you can place the host under the seat, or in the storage box behind the seat.

#### 2. Install the cameras

Location a position that will allow the best view.

① Ensure the mount is secure and will not interfere with the operation of the vehicle. Consider the range of motion on the front forks of a motorcycle as well as the amount of vertical wheel travel.

② Tighten the camera in the lens fixing ring with screws, install the cameras in any angle since the cameras can rotate inside the camera brackets. Also the supplied brackets can

tilt within a large degree for your convenience. Install the camera mounts via using the already placed adhesive, or using screws or zip ties to install these mounts.

⑤ Hidden the camera cable safely in the motorcycle and route it back to the main device location. Ensure the cables are not subjected to a pinch point or in an area that will expose it to high temperature from the engine.

### 3. Install GPS Module and remote control

Locate a position to install GPS module that can expose it to the sky. Use the attached strap to fix the remote control to the handle of the motorcycle, which is convenient for you to manually operate to capture, lock files, and record voice. Finally hide the excess cables inside the motorcycle.

### 4. Install power cord

There is two types to install the supply power:

- ① Using 5 volt, 2A or above output USB port to connect with the host via USB cable.
- ② Connect the host via using the supplied 12 volt to 5 volt converter power cord, and perform the power connection according to the following steps:
  - Connect the red wire to ignition, accessory port, fuse box or other regulated power.
  - Connect the yellow wire to positive of motorcycle's battery.
  - Connect the black wire to negative of motorcycle's battery.

The installation diagram is shown in the figure below:

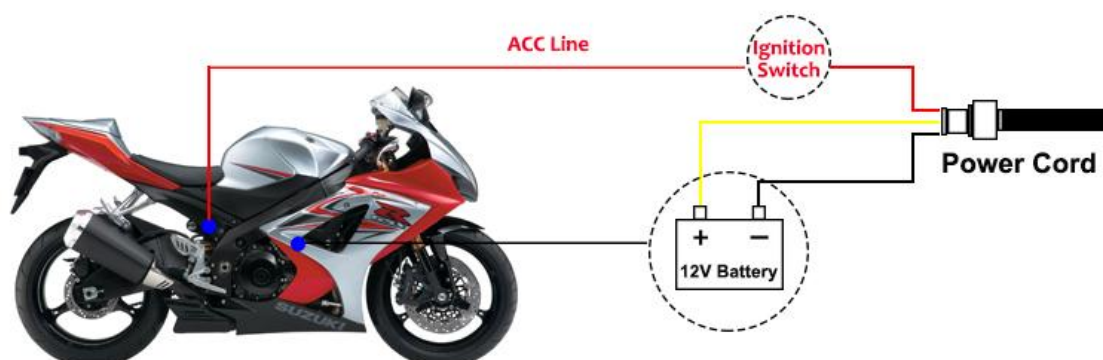

### 5. Overall installation diagram

#### Installation Reference Diagram



- |                |               |
|----------------|---------------|
| ① Main Device  | ② GPS Module  |
| ③ Wired Remote | ④ Power Cord  |
| ⑤ Front Camera | ⑥ Rear Camera |

## 5 Bracket Installation

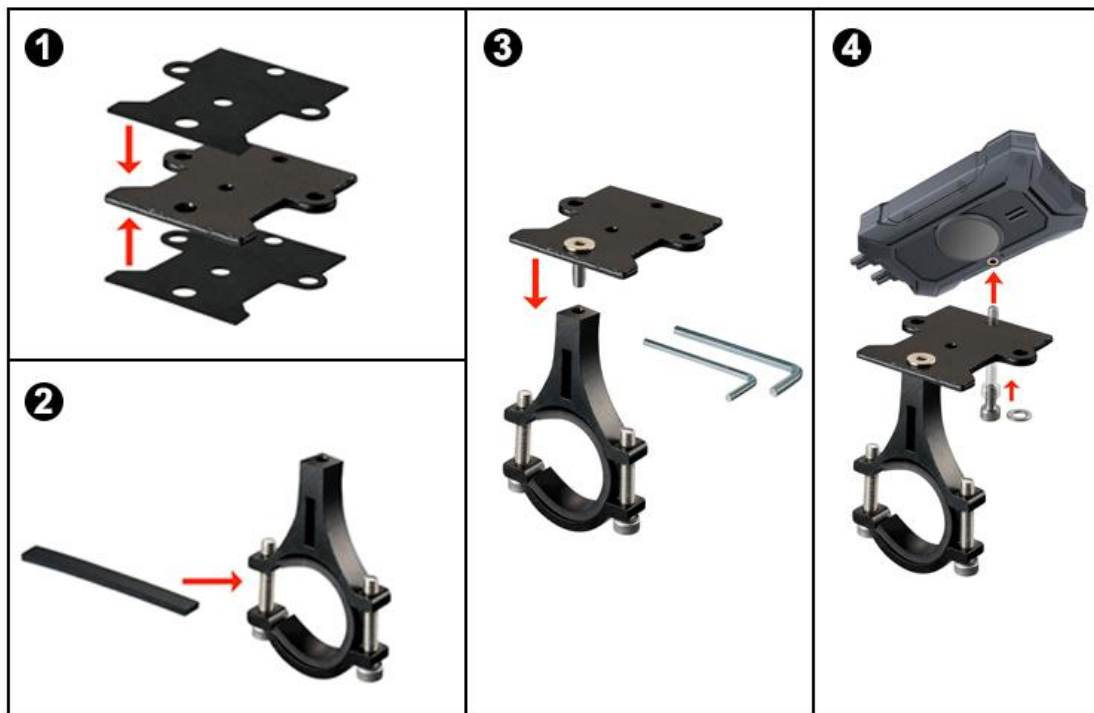

## 6 Remote Control

Keys Operation Instructions:

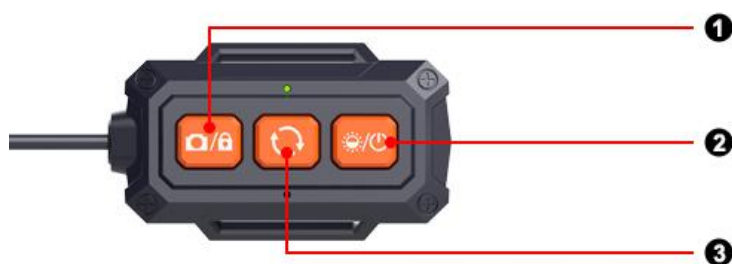

**1 Capturing Photos/Lock Files:** When the device is recording videos, short press this button to take snapshot, long press about 3 seconds to lock the file being recorded.

**2 Switch Image Display/Switch to Dashboard Display:** Short press this button to switch images display for the front and rear camera, long press about 3 seconds to switch to the dashboard display interface.

**3 Screen Saver:** Short press this button to turn on/off the screen.

## 7 GPS Module

**GPS :** Record driving tracks, map locations and speeds. It is recommended to place the GPS antenna in open air for better reception.

How to view GPS track?

- ① View the GPS track through the application "RoadCam", open the "RoadCam" app on your phone, click "Album", select the video to playback, there is a GPS option to view in the below of screen.
- ② Download and install application "GXPlayer" on your computer, remove the Micro SD card, use a card reader to connect to the computer, then open the "GXPlayer" program to read GPS data.

## 8 WIFI Connection

The device can be wirelessly connected to smartphone or tablet by following these steps. (The app is compatible with Android or IOS system):

1. Download and install the "RoadCam" application in the google store or in the apple store. Or scanning the QR code to download and install "RoadCam". The QR code is as follows:



2. After install "RoadCam", turn on the WIFI function in the settings of your phone or tablet, find the name: "FSY-909-XXX", Click to open and enter the password: 1234567890.
3. Running the "RoadCam" APP on your phone or tablet, you can view photos, videos or GPS track via the app. Also you can download, edit the video/photos and share them to social platforms.

## 9 Dashboard Display

When the "Safe Riding Display" menu is open, short press the "Down" key in the standby mode to open the dashboard interface, which can display the motorcycle's speed, GPS location, altitude, and atmospheric pressure. As shown in the below:



## 10 Menu Introduction

When the machine is in the standby state, short press the "Menu" button enter menu. Press

"up" or "down" buttons to go over settings, click "OK" to choose. Use "up" and "down" buttons to choose your sub menu settings, click "OK" to save and exit:

**1. Resolution: 2K(30fps)/1920\*1080P(60fps)/1920\*1080P(30fps)**

Choose the video resolution what you needs. It is recommended to choose 1920\*1080P (60fps), that can record a smooth and clear images.

**2. Loop Recording: OFF/1 minute/3 minutes/5 minutes/10 minutes**

Sets the length of your video files. By choosing OFF, the loop recording is disabled. The device will record in long 10minutes files each till memory card is full, and stops recording.

**3. Gravity Sensor: Off/Low/Medium/High**

Adjusts the sensitivity of force needed to triggers to lock the file.

**4. Audio: On/Off**

Turn on/off audio recording.

**5. Watermark: On/Date/Date+model**

Turn on or off date time display.

**6. Wi-Fi: On/Off**

Turn on or off the Wi-Fi signal. Default: On

**7. Race mode: 0-100km/h, 0-400m, Off**

You can test the acceleration performance of your motorcycle. When you select "0-100KM/H" or "0-400m", short press the "DOWN" button in the standby mode to open the race mode, then perform the speed test.

**8. GPS: On/Off**

You can choose to Open/Close the GPS track function.

**9. Time zone setting**

To set the time zone in your area. Default: GMT+08.00

**10. Date/Time**

Setting date and time.

**11. Beep Sound: On/Off**

Turns on and off the button sound.

**12. Language: English/German/French/Italian/Spanish/Japanese**

Choose the language menu what you want.

**13. Frequency: 50Hz/60Hz**

Set your power frequency based on your country.

**14. Screen Saver: Off/1 Minute/3 Minutes**

Choose the time for screen saver to be activated.

**15. Default Setting: Cancel/OK**

Erase all your changes to the setting and return the unit to the default factory settings.

**16. Rear Lens Mirroring: On/Off**

Change mirror effect display for your rear camera. Select Off, the rear camera will display the same direction images; select on, the rear camera will display the reverse images.

**17. Speed: KM/H, MPH**

Switch the speed unit between KM/H and MPH.

**18. Safe Riding Display: On/Off**

When you select "On", short press the "Down" button in the standby state to open the dashboard, which can display information such as speed, GPS, altitude, air pressure etc., when you select "Off", it is in the standby state Short press the "down" key to enter the screen saver mode directly.

**19. Switch Sound:On/Off**

Turn on/off the sound of the machine when turning on or off.

**20. Fatigue driving reminder: On/Off**

Select "On", the machine will remind the driver not to drive fatigued in every half an hour.

**21. Format: Cancel/OK**

Format your memory card. It is recommended once every few months. Please note that all data will be deleted.

**22. Version**

FW version number.

## **11 Product Specifications**

Resolution	Front&Rear 2K 30fps/1080P 60fps/1080P 30fps
Pixel	5 million
Lens	Sony, F=1.8
View Angle	Front&Rear: 150°
Waterproof Rating	Main Device: IP65, Lens: IP67
Display	3.0 Inch IPS
Video Format	H.265/TS



Voltage	5V / 2.0A
GPS	Support
Wi-Fi	Built in
Micro SD card	Support 8-256GB, class 10 above
Image Stabilization	Electronic Image Stabilization
G-sensor	Support
Loop recording	Support
Microphone	Built in the remote control
Speaker	Built in
Battery	Without
Operating temperature	14 to 140 F
Storage temperature	14 to 160 F
Operating Voltage	DC 12 / 24 V
Size	110*61*20mm
Weight	About 175g
Material	ABS

## 12 Precautions For Product Use

1. MD30 motorcycle dash cam can support 8-256GB Micro SD card, please use high-speed brand memory card with Class10, U3 or above. Please format the memory card in the machine before using, and often format the memory card to maintain the read and write stability of the memory card.
2. The waterproof rating of the main device and remote control is IP65, please do not wash under high pressure or put it in water.
3. Cleaning requirements: Do not use any chemicals for cleaning. If you need to clean, please slightly moisten the cotton cloth with water and wipe it gently. Since the camera lens is installed on the outside, it is easy to adhere to dust, please use a cloth to clean it frequently.
4. Do not break or squeeze the wire during installation, otherwise the signal will be weakened or interrupted. At the same time as far as possible away from the locomotive switchboard or relays and other devices to prevent signal interference.
5. If the machine screen occurs to freeze, please press the reset button to reset the factory setting.
6. If you have any questions, please log in to your Amazon account, find your order ID, and contact us via email. Our customer service team will serve you wholeheartedly.

**Manufacturer: Shen zhen shi zhong feng ke ji you xian gong si**

**Address: Shen zhen shi fu tian qu hua qiang bei jie dao fu qiang she qu hua qiang bei lu 1078 hao xian dai zhi chuang 2 ceng 2A23A-2A25**

**Contact: Liu Yua Hua**

**Tel: +86 18902842929**

This device complies with part 15 of the FCC Rules. Operation is subject to the following two conditions: (1) This device may not cause harmful interference, and (2) this device must accept any interference received, including interference that may cause undesired operation.

Any Changes or modifications not expressly approved by the party responsible for compliance could void the user's authority to operate the equipment.

**Note:** This equipment has been tested and found to comply with the limits for a Class B digital device, pursuant to part 15 of the FCC Rules. These limits are designed to provide reasonable protection against harmful interference in a residential installation. This equipment generates uses and can radiate radio frequency energy and, if not installed and used in accordance with the instructions, may cause harmful interference to radio communications. However, there is no guarantee that interference will not occur in a particular installation. If this equipment does cause harmful interference to radio or television reception, which can be determined by turning the equipment off and on, the user is encouraged to try to correct the interference by one or more of the following measures:

- Reorient or relocate the receiving antenna.
- Increase the separation between the equipment and receiver.
- Connect the equipment into an outlet on a circuit different from that to which the receiver is connected.
- Consult the dealer or an experienced radio/TV technician for help.

This equipment complies with FCC radiation exposure limits set forth for an uncontrolled environment. This equipment should be installed and operated with minimum distance 20cm between the radiator & your body.