

earshots™

LOCK AND LOAD.

INSTRUCTIONS AND FIT GUIDE.

Unboxing

Your all new earshots.

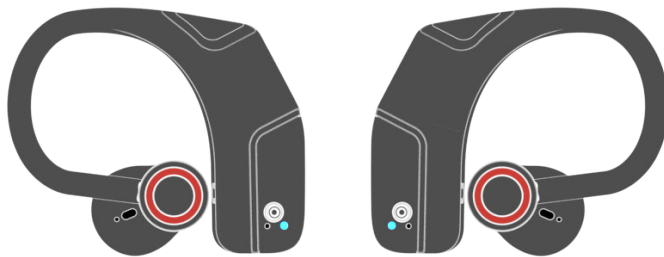
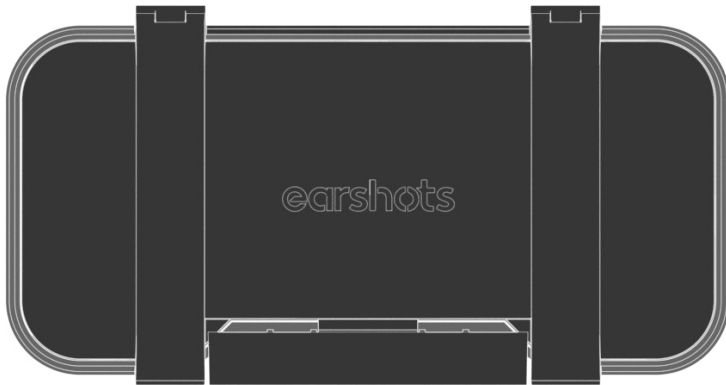

THE KIT

Left & Right earshots
Self-charging Case
USB-C to USB-A charging cable

Pairing

With your smartphone.

First time

1. Ensure the smartphone Bluetooth® is on.
2. Remove earshots from the charging case and put them on ready for use.
See [page 6](#) for assistance with fitting.
3. Using [one](#) of the earshots, press and hold the function button.
4. Listen for the tone, releasing once it beeps 3 times in succession. You will hear the audio prompt 'Pairing'.
5. Open the settings of your smartphone device and select Bluetooth® settings.
6. Select 'Earshots' from the device list.
7. If you don't see 'Earshots' in the device list, refer to [page 14](#) for troubleshooting.

NOTE: Android devices may show devices called 'LE Earshots'.

DO NOT select 'LE Earshots'.

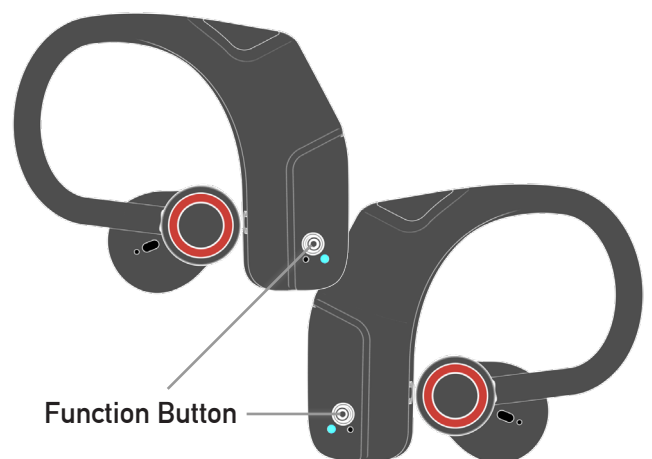
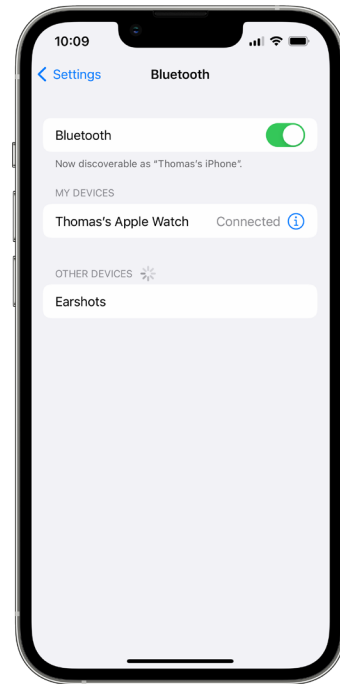

Pairing

With your smartwatch.

First time

1. Ensure the smartphone Bluetooth® is on.
2. Remove earshots from the charging case and put them on ready for use.
See [page 6](#) for assistance with fitting.
3. Using [one](#) of the earshots, press and hold the function button.
4. Listen for the tone, releasing once it beeps 3 times in succession. You will hear the audio prompt 'Pairing'.
5. Go to the Bluetooth® settings of your smartwatch device.
6. Select 'Earshots' from the device list.
7. If you don't see 'Earshots' in the device list, refer to [page 14](#) for troubleshooting.

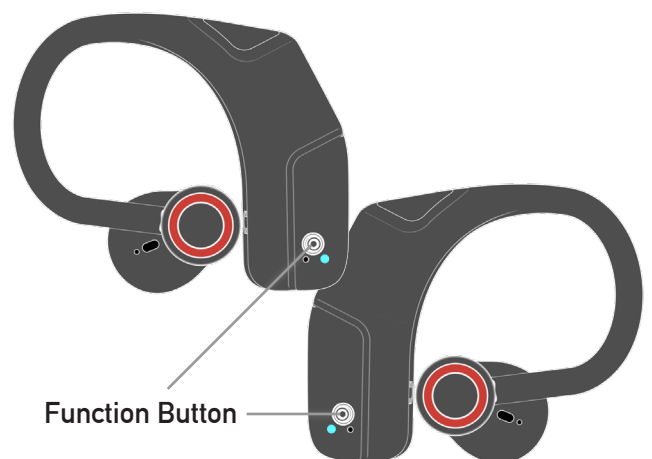

Turning on / off

Using the earshots.

1. Earshots automatically turn off when placed in the charging case.
2. To manually power off, press and hold the function button on both earshots.
3. Listen for the tone, releasing once it beeps 2 times. You will hear the audio prompt 'Power off'.

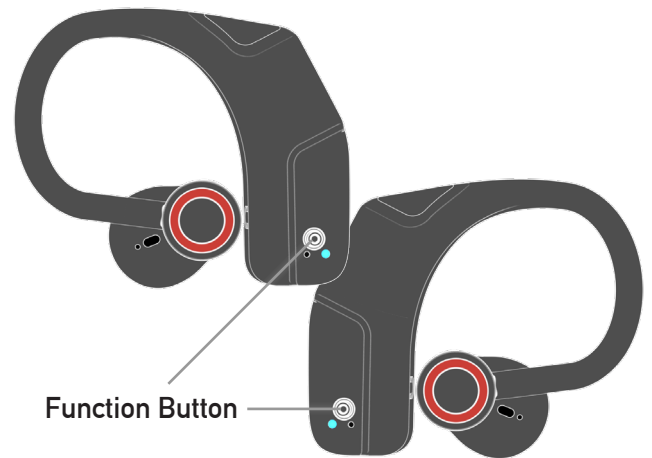

Fitting

Using the earshots.

1. Separate the magnetic clip between the bud and rear drive, holding the bud in one hand and rear drive in another.

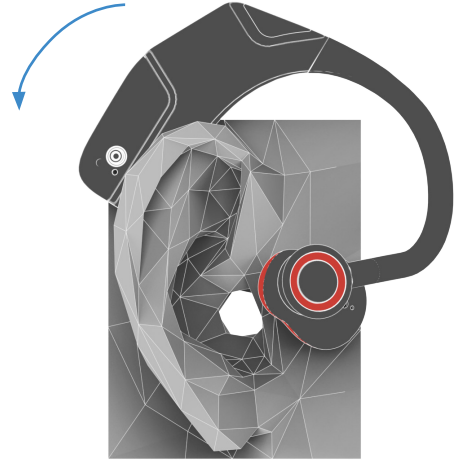

2. Slide the rear drive around the top and behind the ear, placing the tip in the canal.

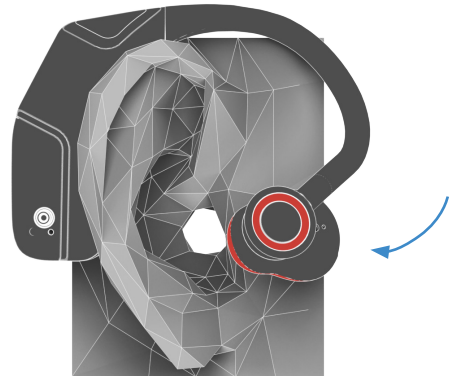

3. Feel the magnetic clip, lifting the bottom of the rear drive and feel it lock into place.

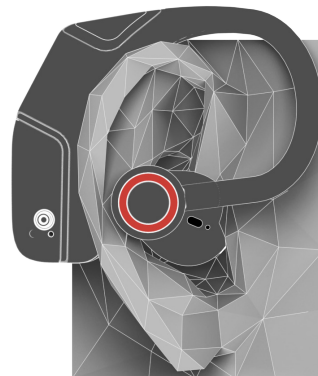

Position Settings

Fit for you.

Everyone has a unique shape and angle to their ear canal. The earshots feature **5 position settings**.

1. Using two hands, hold the outside of the earshots and the bud in another.
2. Rotate the bud to your preferred position.
3. The position can also be adjusted while secured in the ear, rotating the outside of the bud.



Solo mode

With just one earshots.

1. Take earshots out of the charging case.
2. Select which earshot you wish to power off.
3. Place back in the case or manually power off.
4. To manually power off, press and hold the function button on both earshots.
5. Listen for the tone, releasing once it beeps 2 times. You will hear the audio prompt 'Power off'.

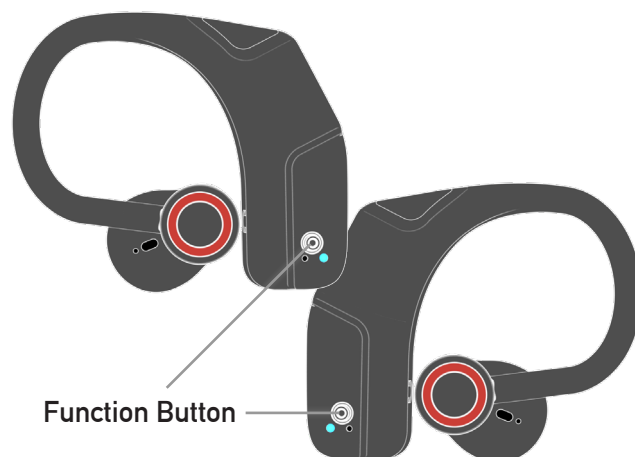

Connectivity

Switch between your devices.

Earshots pick up from where you left, **connecting automatically** to the device last used.

1. To switch devices, go to the settings of your current device and disconnect.
2. Ensure the next device Bluetooth® is on.
3. Go to the settings of the next device and select 'Earshots' from the pairing list. You will hear the audio prompt 'Connected'.

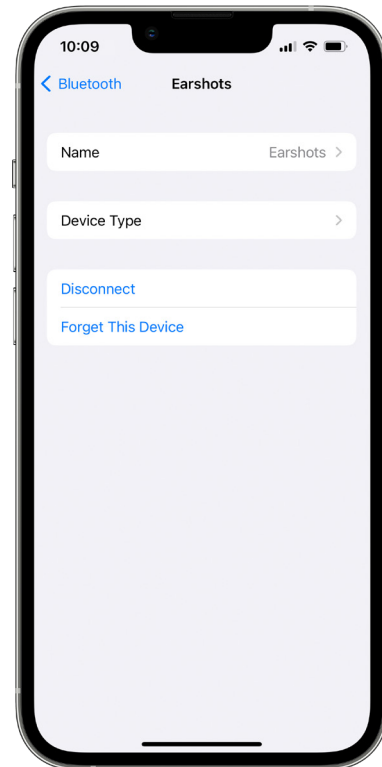

Music Controls

For all devices.

DUAL MODE

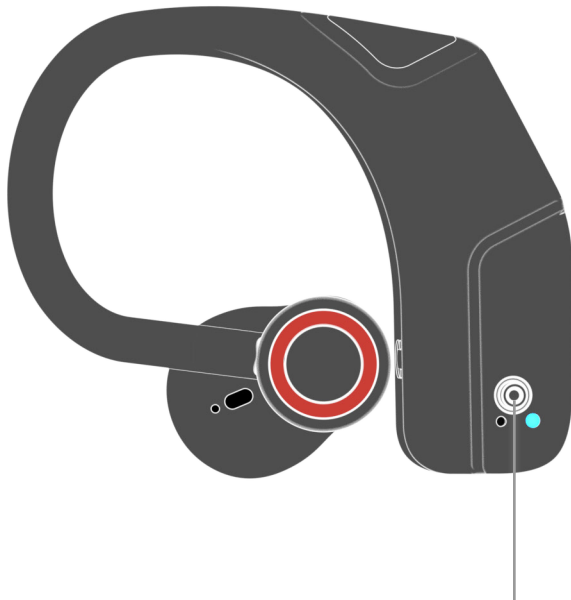

Previous Track ••
Quickly press the function button
twice on the L.

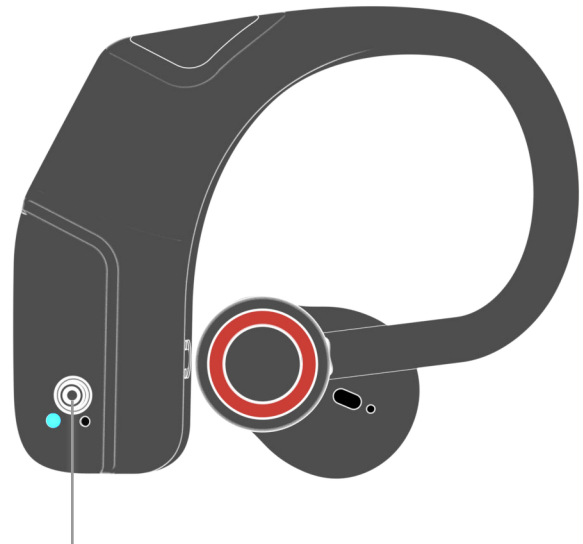

Next Track ••
Quickly press the function button
twice on the R.

Play / Pause •
Short press the function button once on the L or R.

SOLO MODE

Play / Pause •
Short press the function button once.

Next Track ••
Press the function button twice.

Previous Track ••
Long press the function button once.

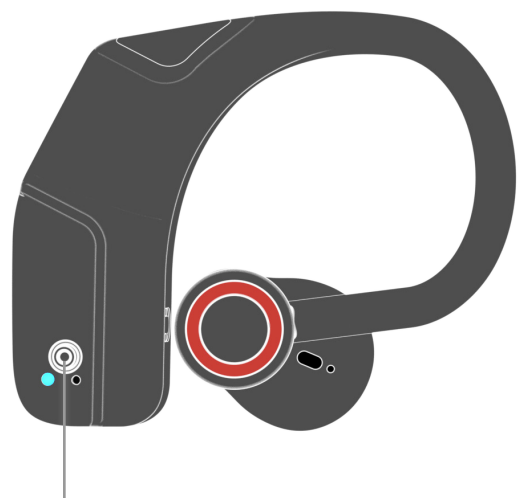

Function Button

Calling Controls

For your smartphone.

Answer a call •

Short press the function button.

Reject a call 

Long press the function button.

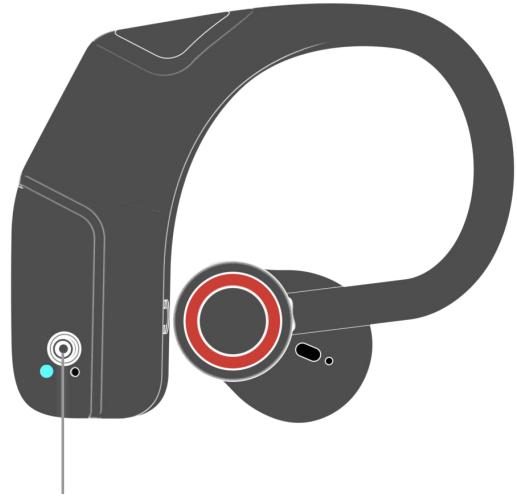

Function Button

Charging

Keep your earshots on.

Earshots **automatically charge** when placed in the charging case.

The indicator light will **shine red** while charging.

When fully charged, no indicator light will show.

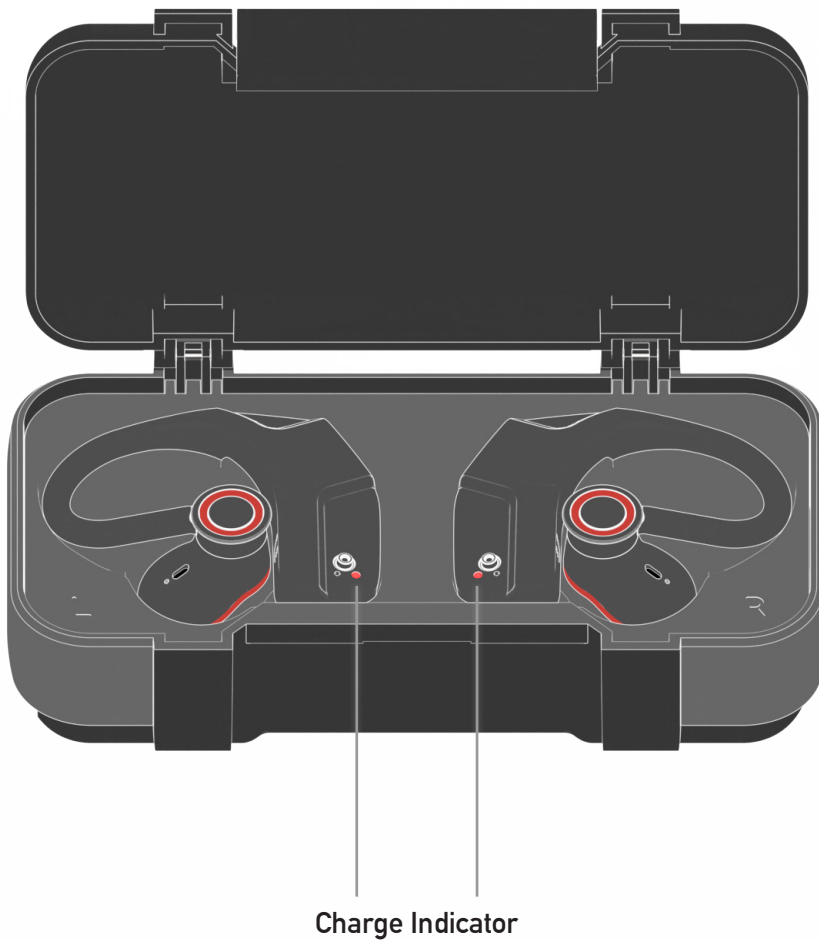

Charging Case

Keep on charging.

To check the battery level, press the function button on the left side.

The lights will illuminate displaying how much charge is in the case.

1 flashing	•	Battery needs charging
1 light on	•	Battery 30% - 60% full
2 lights on	• •	Battery 60% - 90% full
3 lights on	• • •	Battery full

If no battery level shows, the case needs to be charged.

To charge the case, plug in the provided USB-C cable.

The progress will display during the **charging**.

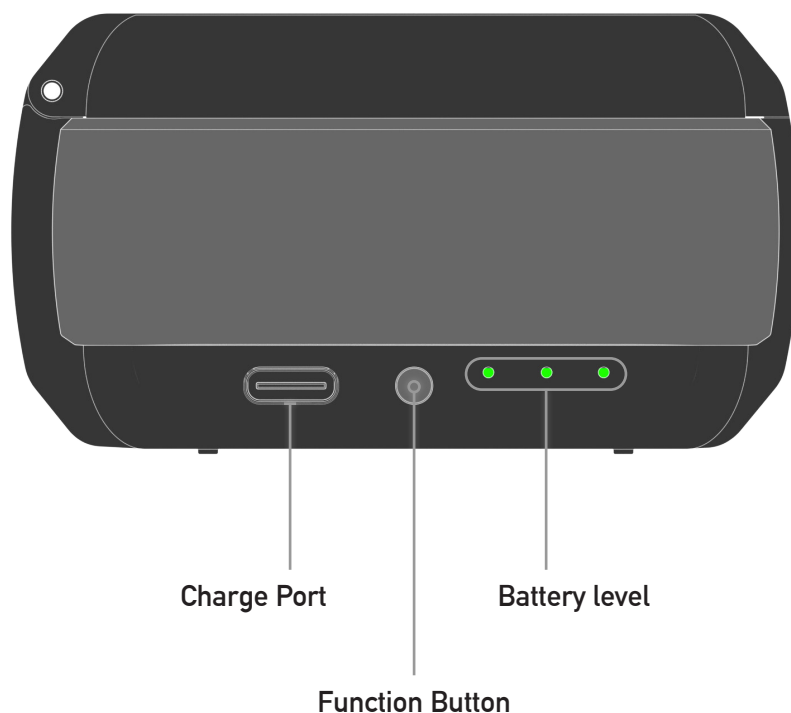

Troubleshooting

Factory reset using your smartphone.

Trouble pairing?

Firstly, ensure the charging case is charged.

1. Place the earshots in the charging case and close the lid.
2. Check the charge level by pressing the function button on the left side.
3. If the indicator lights shine green, the case is charged.
4. It is recommended during pairing to have a minimum of 2 bars of charge.

Once confirming the case is **charged**, open the case.

1. When fully charged, the earshots indicator light will not show.
2. If the earshots indicator is red, the device is charging.
3. If charging, leave the earshots for 15 minutes to perform a quick charge.
4. Once charged, perform a manual pairing process.

Manual

1. Ensure the smartphone Bluetooth® is on.
2. Remove earshots from the charging case and put them on ready for use.
See **page 6** for assistance with fitting.
3. Using **one** of the earshots, press and hold the function button.
4. Listen for the tone, releasing once it beeps 3 times in succession. You will hear the audio prompt 'Pairing'.
5. Open the settings of your smartphone device and select Bluetooth® settings.
6. Select 'Earshots' from the device list. If you don't see 'Earshots' in the device list, perform a factory reset.

Factory Reset

1. Turn your smartphone Bluetooth® on.
2. Go to settings, and remove Earshots from the device list.
3. Using both earshots, press and hold the function button for 15 seconds.
4. Place the earshots in the charging case.
5. The lights will rapidly flash white, then green. Once the lights shine **solid red**, the reset is complete.

ISED Statement

English: This device contains licence-exempt transmitter(s)/receiver(s) that comply with Innovation, Science and Economic Development Canada's licence-exempt RSS(s). Operation is subject to the following two conditions:

(1) This device may not cause interference.

(2) This device must accept any interference, including interference that may cause undesired operation of the device.

The digital apparatus complies with Canadian CAN ICES-3 (B)/NMB-3(B). French: Cet appareil contient des émetteurs/récepteurs exempts de licence qui sont conformes aux RSS exemptés de licence d'Innovation, Sciences et Développement économique Canada.

L'exploitation est soumise aux deux conditions suivantes :

(1) Cet appareil ne doit pas provoquer d'interférences.

(2) Cet appareil doit accepter toute interférence, y compris les interférences susceptibles de provoquer un fonctionnement indésirable de l'appareil.

L'appareil numérique du ciem conforme canadien peut - 3 (b) / nmb - 3 (b). This device meets the exemption from the routine evaluation limits in section 2.5 of RSS 102 and compliance with RSS 102 RF exposure, users can obtain Canadian information on RF exposure and compliance.

cet appareil est conforme à l'exemption des limites d'évaluation courante dans la section 2.5 du cnr - 102 et conformité avec rss 102 de l'exposition aux rf, les utilisateurs peuvent obtenir des données canadiennes sur l'exposition aux champs rf et la conformité.

This equipment complies with Canada radiation exposure limits set forth for an uncontrolled environment.

Cet équipement est conforme aux limites d'exposition aux rayonnements du Canada établies pour un environnement non contrôlé.

The device has been evaluated to meet general RF exposure requirement. The device can be used in portable exposure condition without restriction.

L'appareil a été évalué pour répondre aux exigences générales d'exposition aux radiofréquences. L'appareil peut être utilisé en condition d'exposition portable sans restriction.

FCC Warning

This device complies with part 15 of the FCC Rules. Operation is subject to the following two conditions:

(1) This device may not cause harmful interference, and (2) this device must accept any interference received, including interference that may cause undesired operation.

Any Changes or modifications not expressly approved by the party responsible for compliance could void the user's authority to operate the equipment.

Note: This equipment has been tested and found to comply with the limits for a Class B digital device, pursuant to part 15 of the FCC Rules. These limits are designed to provide reasonable protection against harmful interference in a residential installation. This equipment generates uses and can radiate radio frequency energy and, if not installed and used in accordance with the instructions, may cause harmful interference to radio communications. However, there is no guarantee that interference will not occur in a particular installation. If this equipment does cause harmful interference to radio or television reception, which can be determined by turning the equipment off and on, the user is encouraged to try to correct the interference by one or more of the following measures:

- ▶ -Reorient or relocate the receiving antenna.
- ▶ -Increase the separation between the equipment and receiver.
- ▶ -Connect the equipment into an outlet on a circuit different from that to which the receiver is connected.
- ▶ -Consult the dealer or an experienced radio/TV technician for help.

The device has been evaluated to meet general RF exposure requirement. The device can be used in portable exposure condition without restriction.