



INTELLIGENT DYNAMIC  
AND COOL LIGHTING

(The product is only suitable for children aged 6 and above)

## Remote control dog

### INTELLIGENT BIONIC ROBOTIC DOG

ENTERING THE ERA OF  
CYBER TECHNOLOGY

(Instruction  
manual)

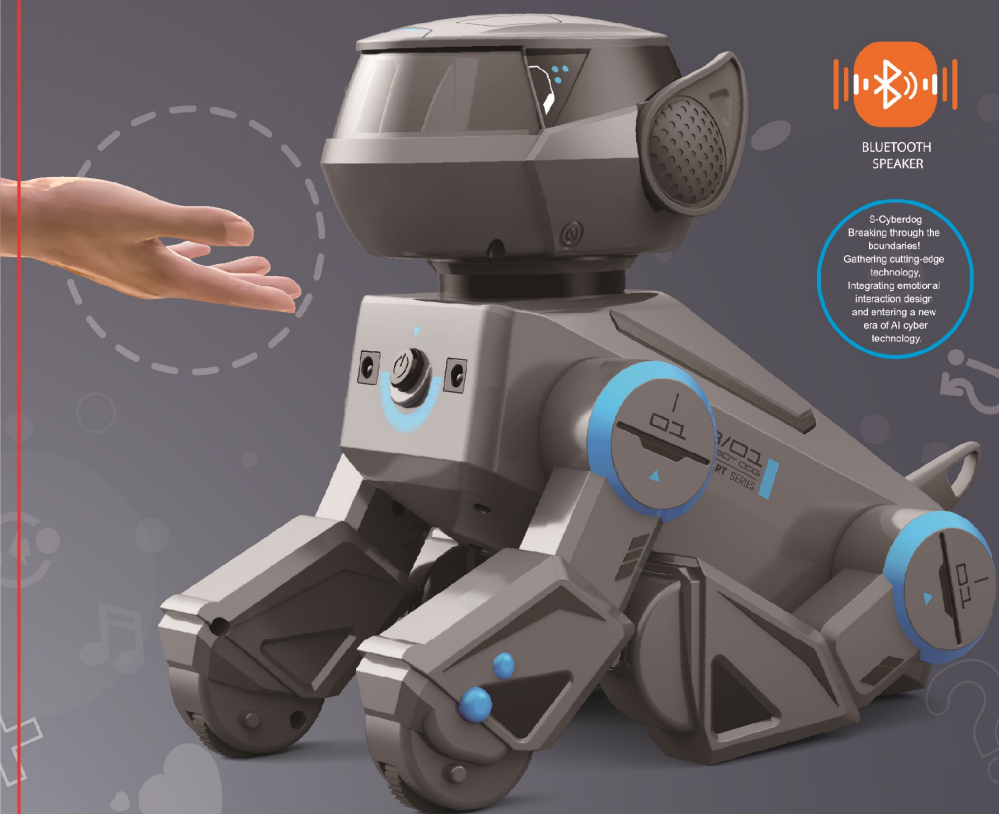

BLUETOOTH  
SPEAKER

S-Cyberdog  
Breaking through the  
boundaries!  
Gathering cutting-edge  
technology,  
Integrating emotional  
interaction design,  
and entering a new  
era of AI cyber  
technology.

The professional team carefully crafted it, endowing it with a dynamic technological appearance and intelligent core. It is not only a precise combination of machinery, but also integrates emotional interaction design, Connecting the soul with technology, entering a new era of cyber.

## ⚠ WARNING!

This product contains small parts and is not suitable for children under three years of age. This product includes electronic components and must not be used in water or a humid environment. The wires, plugs, casing, and other components of the battery charger should be checked for damages periodically. In case of damage, the usage of the product should be discontinued.

## ⚠ CAUTION PROCEEDING

1. Detachable small parts should be stored safely and out of reach of children.
2. Remote control will not function correctly if the batteries are low. Please replace the batteries.
3. Please discard old/used batteries in a safe manner. Consider your environment!
4. Please store your product in a dry and cool place.
5. Please do not store the product in a place near the fire, with high humidity or temperatures.
6. Please recharge the battery regularly if it is not used for a long time.
7. The rechargeable battery and its charger are not toys.

## ⚠ BATTERY USE CAUTION PROCEEDING

1. A 3.7V 1200mAh rechargeable battery is used for the product.
2. We recommend using two 1.5V AAA non-rechargeable alkaline batteries for the remote controller.
3. While installing batteries for the remote controller, please note that the battery polarity should correspond to the polarity identifications in the remote controller battery compartment.
4. The recharging process must be supervised by an adult when the battery in the product is out of power.
5. Do not mix new, old, or different battery models in the remote control.
6. The batteries in the remote control are non-rechargeable batteries which cannot be recharged.
7. Do not leave drained or used up batteries inside the remote controller.
8. To avoid accidents or pollution, do not short circuit or dissect the battery, or put it into fire or water.
9. DO NOT short circuit any terminals.
10. The rated input voltage of the adapter must match the local household voltage, and the output voltage must match the USB input voltage.
11. During charging it is quite normal for the charger and batteries to heat up.

1

## 1 Batteries and Instructions for Charging

### 1. The remote controller uses two 1.5V AAA-size batteries.

- (1). Remove the battery cover with a Phillips head screw driver.
- (2). Put batteries into the battery compartment, with correctly corresponded battery polarities.
- (3). Replace the battery cover and tighten the screws.

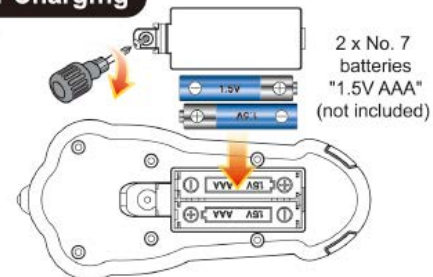

### 2. Charge with the USB cable

- (1). As shown in the picture, take the rechargeable battery out of the robot dog.
- (2). Charging mode  
① Computer Charging: First, insert the USB port into the computer's USB port, then insert the lithium battery plug into the USB charging plug, and the USB charging indicator light will remain on; After about 240 minutes of fully charging, the USB charging indicator light will turn off, indicating that charging is complete.  
② DC device charging: Connect the input interface of the USB charging cable to a USB related power source with an output DC voltage of 5V and a current greater than or equal to 500mA. Insert the other end into a lithium battery socket, and the USB charging indicator light will remain on; After about 240 minutes of fully charging, the USB charging indicator light will turn off, indicating that charging is complete.

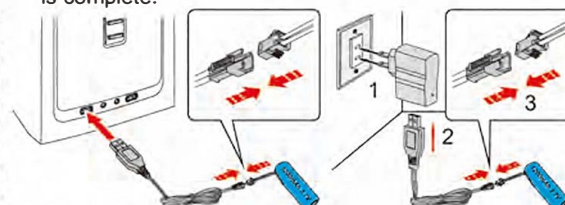
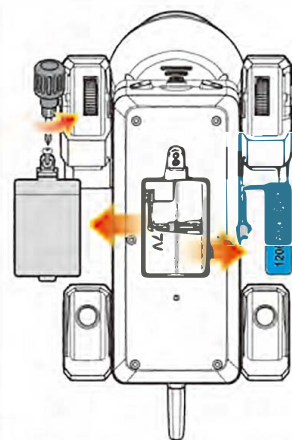

- (3). As shown in the figure, connect the electrodes correctly and then install the battery into the battery slot, cover the battery cover, and tighten the screws.

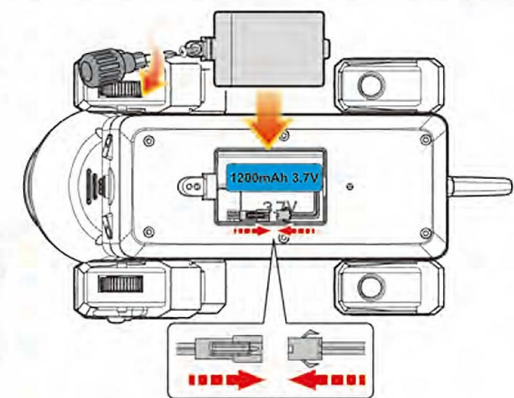

### ⚠ Notice:

1. Only use the USB charging cable provided by our factory to recharge the product.
2. The recharging process must be supervised by an adult.

2

## 2 Name of Functions

### 1. Remote controller function diagram

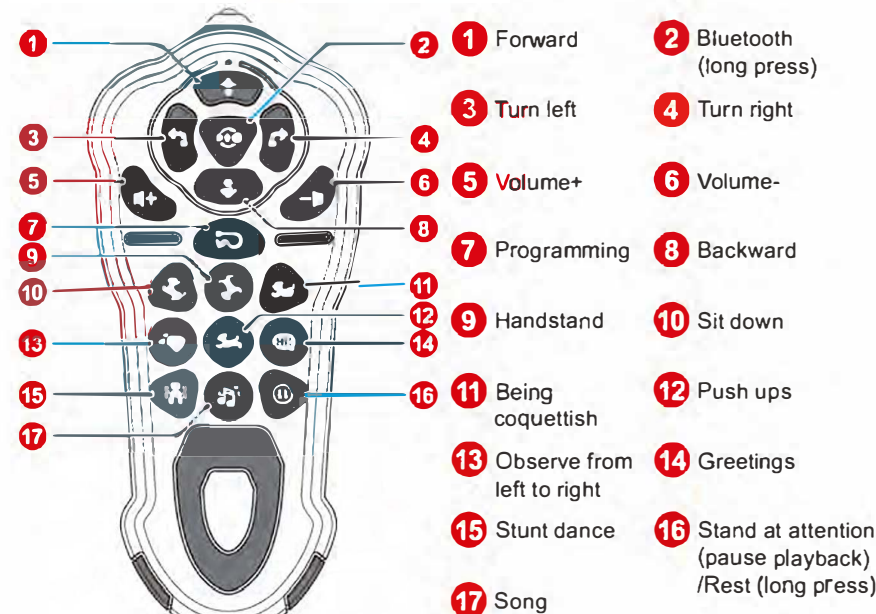

### 2. Diagram of functions

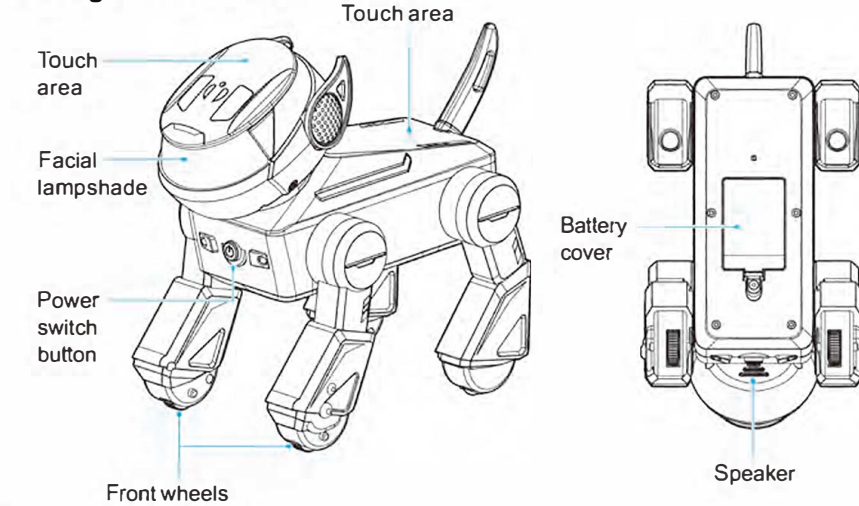

3



### 3 Product function demonstration explanation

1. Power on: Press the power switch button "⏻" on the robot dog to turn it on. The robot dog will play the power on sound effect while turning left and then right, displaying the corresponding flowing light show. Then the robot dog will enter standby mode.
2. Standby: During the standby process, six basic actions will be demonstrated, with no sound or action. Two types of constant light will be displayed for 10 seconds each, and then a random basic action will be demonstrated (each basic action is accompanied by a corresponding light show). After demonstrating the six basic actions once, there will be no sound or action for 3 minutes, and only one constant light will be displayed every 10 seconds.
3. Sleep: If there are no instructions during the standby process of about 6 minutes and 30 seconds, then play the sleep sound and enter sleep. (After entering sleep mode, it can only be awakened by turning off the device again and then turning it back on.)
4. Shutdown: In the power on state, press the power switch button "⏻" on the robot dog to turn off the power of the robot dog.

5. Forward: Press the forward button "➡" on the remote control, and the robotic dog will move forward for a distance. Press and hold this button, and the robotic dog will continue to move forward. Release this button and the robotic dog will immediately stop moving forward and enter standby mode.



6. Backward: Press the back button "⬅" on the remote control, and the robotic dog will move back a distance. Press and hold this button, and the robotic dog will continue to move backwards. Release this button and the robotic dog will immediately stop moving backwards and enter standby mode.

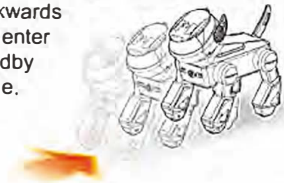

7. Turn left: Press the left turn button "↶" on the remote control, and the robot dog will turn left. Long press this button, and the robot dog will continue to turn left. Release this button, and the robot dog will immediately stop turning left and enter standby mode.

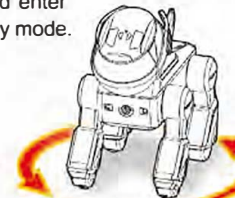

8. Turn right: Press the right turn button "↷" on the remote control, and the robot dog will turn right. Long press this button, and the robot dog will continue to turn right. Release this button, and the robot dog will immediately stop turning right and enter standby mode.



9. Programming: Press the programming button "⌂" on the remote control, and the robotic dog will play programming sound effects and enter programming mode (flashing lights). At this time, click the "Forward, Backward, Left turn, Right turn, Sit down, Inverted, Coquettish, Left and Right watch, Push up, Greetings, Stunt dance, Nursery song function keys" on the remote control to program. In programming mode, press the programmed function key once

to play a recording prompt sound "beep" and the light will change a flashing color (the number of editable function keys that can be recorded is 1 to 100, and if more than 100 are edited, the robotic dog will play a prompt sound "beep" that does not record the excess part). After completing the programming, press the programming button "⌂" again or wait for 10 seconds. After the programming of the second robotic dog is completed and the sound effects are played, the stunt dog will demonstrate one by one according to the order of editing records. After the demonstration is completed, enter standby mode.

#### Remarks:

- (1). Triggering the standing/resting button and long pressing the Bluetooth button during programming will exit programming and execute the corresponding function (pressing the Bluetooth button is not programmable).
- (2). Trigger volume+ and volume - in programming or programming demonstrations to directly adjust the volume.
- (3). During programming playback, triggering the button on the remote control will exit the programming playback and immediately execute the button function.

#### 10. Volume adjustment:

- (1). Pressing this button "⏮" will increase the volume, with a total of five levels (pressing this button will play the volume adjustment sound effect, and the blue flashing light will turn to red constant light. Pressing this button will not interrupt the ongoing action).
- (2). Pressing this button "⏭" will decrease the volume, with a total of five levels (pressing this button will play the volume adjustment sound effect, and the blue flashing light will turn to red constant light. Pressing this button will not interrupt the ongoing action).

11. Sit down: Press the "⏴" button on the remote control to perform the sitting action, while emitting a sitting sound effect and a sitting light show, and then enter standby mode.



12. Handstand: Press the inverted button "⏵" on the remote control to perform the inverted action, while emitting an inverted sound effect and inverted light show, and then enter standby mode.



13. Observe from left to right: Press the left and right observation button "👁" on the remote control, and the robot dog will immediately turn left for inspection, then rub its feet twice. Then turn right for inspection and jump a few feet. Then sit down and wave your hand.

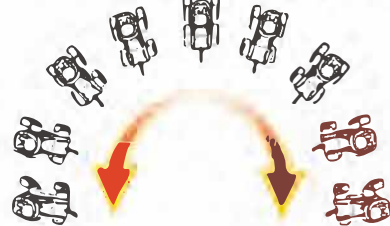

14. Push ups: Press the push up button "💪" on the remote control to perform the push up action, while emitting the push up sound effect and the horizontal support light show, and then enter standby mode.



15. Being coquettish: Press the coquettish button "💕" on the remote control to perform the "coquettish action", while emitting the "coquettish sound effect" and "coquettish light show", and then enter standby mode.
16. Greetings: Press the hello button "👋" on the remote control to perform the "hello action", while emitting the "hello sound effect" and "hello light show", and then enter standby mode.
17. Stunt Dance: Press the "💃" button on the remote control once to play 1 dynamic dance song and supporting movements while displaying a light show (3 songs in total). Then enter standby mode.
18. Song: Press the song button "🎵" on the remote control once to play 1 song and its accompanying actions while the light show displays (3 songs in total), then enter standby mode.
19. Stand still (pause playback)/Rest (long press):
  - (1) Standing up: In the robot dog mode, press the "⏸" button on the remote control to stop the current action and return to standing up, while emitting sound effects and standing up light show, and then execute standby and sleep.
  - (2) Rest: In the robot dog mode, long press the "⏸" button on the remote control to stop the current action and return to the upright position, while emitting a sound effect. Switch to a different color of light for 10 seconds. After 5 minutes of inactivity, enter sleep mode.
  - (3) Pause: In Bluetooth mode, press the "⏸" button on the remote control to execute the pause command for the current Bluetooth playback content.

20. Touch: When in standby mode and there is no sound or action, touch the touch point on the head or back, and the robot dog will play a touch sound effect and action, while displaying a light show. After each touch, wait for the robot dog to complete the sound effect or action before touching again.

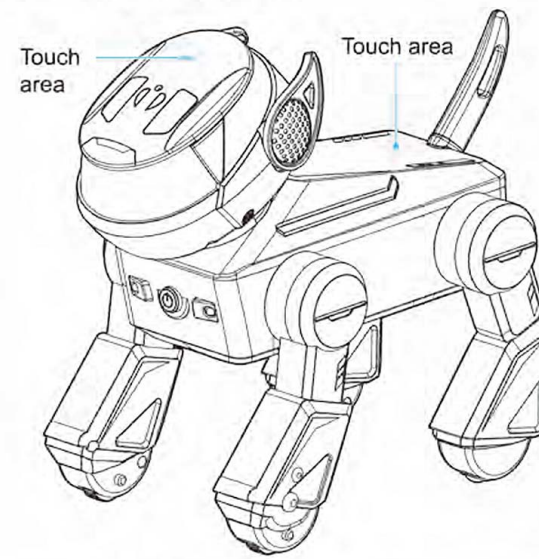

21. Bluetooth: Long press the Bluetooth button "📶" and the robot dog will emit a long sound, beep---elongated sound (indicating that Bluetooth is turned on), and all lights will flash in colorful water before entering Bluetooth standby. Click on the phone's Bluetooth, search for "Cyberdog" and connect. When the robot dog emits a beep---elongated sound (indicating that Bluetooth is connected), all lights will flash in colorful water, and then enter Bluetooth standby. When playing a song, the lights will also flash in standby mode. Press and hold the Bluetooth button "📶" again, and the robotic dog will emit beeps (indicating that Bluetooth is turned off). All lights will flash in seven colors and then enter normal standby mode. The robotic dog emits a beep beep (indicating that Bluetooth has been disconnected) and all lights flash in rainbow colors before entering normal standby mode. At this point, the remote control can control all actions normally. In Bluetooth mode, only the volume key and pause playback key can be controlled.

#### Remarks:

- (1). The volume key controls the volume, and the pause key controls the playback of content.
- (2). Bluetooth standby mode with 7 colors, all lights are breathing and flashing. For example, after flashing blue breath for 5 seconds, switch to flashing red breath for 5 seconds. Cycle for 5 minutes. Without sound or operation, enter sleep directly. Restart and wake up.
- (3). Pause: In Bluetooth mode, press the "⏸" button on the remote control to execute the pause command for the current Bluetooth playback content.

### 4 Solutions to possible problems

Symptom	Cause	Correction
The remote controller fails to function	1. Fail to put the battery into the right electrodes.	1. Check and make sure that the battery is put in according to the signs of the electrodes on the battery box.
	2. Low battery.	2. Replace with new batteries.
	3. Control distance exceeded.	3. Control the remote control distance within 3 meters.
The robot dog does not react to commands.	1. The robot dog is not turned on.	1. Press the power switch button on the machine dog to turn on the power.
	2. Mis-connection between the electrodes of the robot dog and the rechargeable batteries.	2. Check to make sure the rechargeable batteries are properly connected to the electrodes of the robot dog.
	3. Low battery.	3. Replace with new batteries.
	4. Slurred voices and dim lights.	4. Recharge the batteries or replace them with fully charged ones.



**FCC Statement**

Any Changes or modifications not expressly approved by the party responsible for compliance could void the user’s authority to operate the equipment.  
This device complies with part 15 of the FCC Rules. Operation is subject to the following two conditions:  
(1) This device may not cause harmful interference, and  
(2) This device must accept any interference received, including interference that may cause undesired operation.

**For Remote controller  
RF warning for Portable device:**

The device has been evaluated to meet general RF exposure requirment. The device can be used in portable exposure condition without restriction.

**For Remote control robot dog  
FCC Radiation Exposure Statement:**

This equipment complies with FCC radiation exposure limits set forth for an uncontrolled environment .This equipment should be installed and operated with minimum distance 20cm between the radiator& your body. This transmitter must not be located or operating in conjunction with any other antenna or transmitter.

Note : This equipment has been tested and found to comply with the limits for a Class B digital device, pursuant to part 15 of the FCC Rules. These limits are designed to provide reasonable protection against harmful interference in a residential installation. This equipment generates, uses and can radiate radio frequency energy and, if not installed and used in accordance with the instructions, may cause harmful interference to radio communications. However, there is no guarantee that interference will not occur in a particular installation. If this equipment does cause harmful interference to radio or television reception, which can be determined by turning the equipment off and on, the user is encouraged to try to correct the interference by one or more of the following measures:  
—Reorient or relocate the receiving antenna.  
—Increase the separation between the equipment and receiver.  
—Connect the equipment into an outlet on a circuit different from that to which the receiver is connected.  
—Consult the dealer or an experienced radio/TV technician for help.