

76 mm

60 mm

## 3 in1 Wireless Charger User Manual

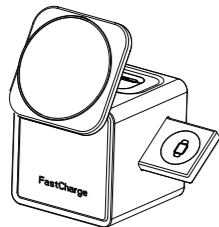

CE FC RoHS  
Made in China

**Mobile phone charging area**  
Suitable for iPhone 8 -16 series  
Suitable for mobile phones  
compatible with Qi wireless  
charging standard.

The charging display area  
shows a breathing light  
state when the phone or  
headphones are charging.  
Press and hold the side  
touch key for a long time  
to turn off the light.

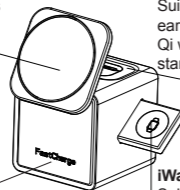

**Earphone charging area**  
Suitable for Airpods Pro 4/  
3/2(wireless version only)  
Suitable for TWS Bluetooth  
earphone compatible with  
Qi wireless charging  
standard.

**iWatch charging area**  
Suitable for Apple iWatch  
whole series.

**TYPE-C Input jack**  
The charging cable can be  
adjusted according to  
different lengths  
requirement. It is  
magnetically attached to  
the back of the product.



**Touch buttons**  
Touch button for rotation,  
Press and hold to turn on/  
off the light display.

Touch button for rotation, Touch again or manually adjusted the charging  
part can be positioned at different angles.

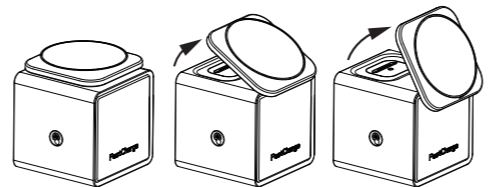

Pressing to open and  
close the charging area  
of iWatch.

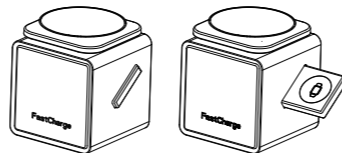

Pulling the cable to find the appropriate length.

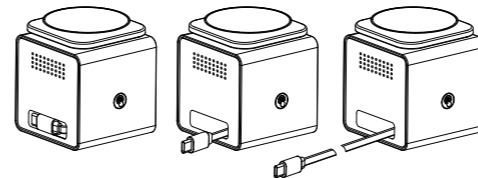

### Product Usage Guide

- 1.Please connect the product through the TYPE-C cable to the QC or PD  
above power adapter,to ensure that is supports fast wireless charging.
- 2.After the power is connected, the charging display area will flash for 3  
seconds, the charging display area will be in a breathing state When the  
phone or headphones are charging, If the led is flashing that it is the metal  
abject or abnormal charging are detected.
- 3.When charging, if the device is a Qi enabled mobile phone,iWatch or TWS  
Bluetooth earphone, just put the device on the corresponding charging area  
and it will start charging 1 second. When the device is fully charged or you  
want to terminate the charging, just remove it from the charging area.

### Product Parameters

Product Name: 3 in 1 Wireless Charger  
Input: 5V/3A, 9V/2.22A  
Mobile Phone Output: 5W/7.5W/10W/15W  
Headphone Output: 5W (max)  
Watch Output: 2.5W (max)

### Accessory List

Wireless Charger x1  
User Manual x1  
18W C-Port Adapter x1

### Indicator status

Night lamp	Indicator status
Power on	Light on after flashes 3 seconds
Standby	Lights on
Charging for iPhone or Airpods	Lights Breathing
Charging for iWatch	Lights on
Long press lights off	Lights off

### FAQ

1. Please put the iPhone/AirPods/iWatch at the center of charging area.
2. To achieve the fast charging, Please use a charger above QC18W or  
PD20W to supply power to the wireless charger.
3. The charging distance is 0-2mm, please don't wear protective case  
which is thicker than 2mm.  
(Magnetic and metal attachments or credit cards will influence the  
charging stability, please remove them before charging).
4. The watch has temperature control feature, when the temperature  
reaches 45°C, device will stop charging automatically. If the temperature  
become normal, it will continue to charge.
5. The lower temperature is, the faster charging speed is. The charging  
speed is faster in winter than in summer.
6. Please don't charge in high temperature and humid environments to  
avoid damage of circuit.
7. Put it at the place that children can't reach to avoid unnecessary  
accidents.
8. Please place the charger away from flammable and explosive liquids or  
gases.
9. If you have any problems on this wireless charger, please feel free to  
contact the seller service, we will offer you a best solution within 24  
hours. Your safety and experience is our top priority, we got it all  
covered.

456 mm

FCC Warning Statement

This device complies with part 15 of the FCC Rules.

Operation is subject to the following two conditions:

- (1) this device may not cause harmful interference, and
- (2) this device must accept any interference received, including interference that may cause undesired operation. Any changes or modifications not expressly approved by the party responsible for compliance could void the user's authority to operate the equipment.

Note: This device has been tested and found to comply with the limits for a Class B digital device, pursuant to Part 15 of the FCC Rules.

These limits are designed to provide reasonable protection against harmful interference in a residential installation.

This equipment generates, uses and can radiate radio frequency energy and, if not installed and used in accordance with the instructions, may cause harmful interference to radio communications.

However, there is no guarantee that interference will not occur in a particular installation.

If this device does cause harmful interference to radio or television reception, which can be determined by turning the device off and on, the user is encouraged to try to correct the interference by one or more of the following measures:

- Reorient or relocate the receiving antenna.
- Increase the separation between the device and receiver.
- Connect the device into an outlet on a circuit different from that to which the receiver is device.
- Consult the dealer or an experienced radio/TV technician for help.

Changes or modifications not expressly approved by the party responsible for compliance could void the user's authority to operate the equipment.

FCC Radiation Exposure Statement

This device complies with FCC RF radiation exposure limits set forth for an uncontrolled environment. When use the device, a distance of 20 cm between the radiator and user's body shall maintain.

