

Table of Contents

1. Specifications	2
2. Packing List	2
3. Installation Steps	3
3.1 Installation of the headphone and the microphone	3
3.2 Installation through an iron clip base	4
3.3 Base installation by foam adhesive	5
4. Main Unit Disassembly Steps	5
5. Product Introduction	6
6. Function Introduction	7
7. Button operation instructions	7
7.1 Power button	7
7.2 Multi-function button	10
7.3 +Button	11
7.4 - Button	11
7.5 Switching languages	12
8. Bluetooth Status Indication & Prompt	12
9. Pairing Mode	12
9.1 Two ways for BT-S6 to go to the pairing mode ..	12
9.2 Pairing of two sets of BT-S6 Bluetooth	13
9.3 BT-S6 Bluetooth and Mobile Phone/GPS/MP3 Pairing	13
9.4 Intercom pairing of BT-S6 with BT-S2 /BT-S3 ..	14
9.5 Intercom pairing of BT-S6 with other Bluetooth headphones	15
9.6 Description of BT-S6 three-party intercom pairing	16
10. Description of function priority	17
11. Notes	18

1. Specifications

Bluetooth version	5.3
Operating distance	1000 meters
Standby duration	370 hours
Working duration	30 hours
Charging duration	About 1.5 hours
Charging interface	TYPE-C interface
Power supply requirements	5V=1A
Battery type	Chargeable lithium polymer battery
Operating temperature	14°F~122°F (-10°C~50°C)
Storage environment	5°F~131°F (-15°C~55°C)

- * The working duration and mobile phone types are related to the operating status, so the actual duration may be somewhat different.
- * There may be deviation in the operating distance due to effects such as environments and climates, etc.

2. Packing List

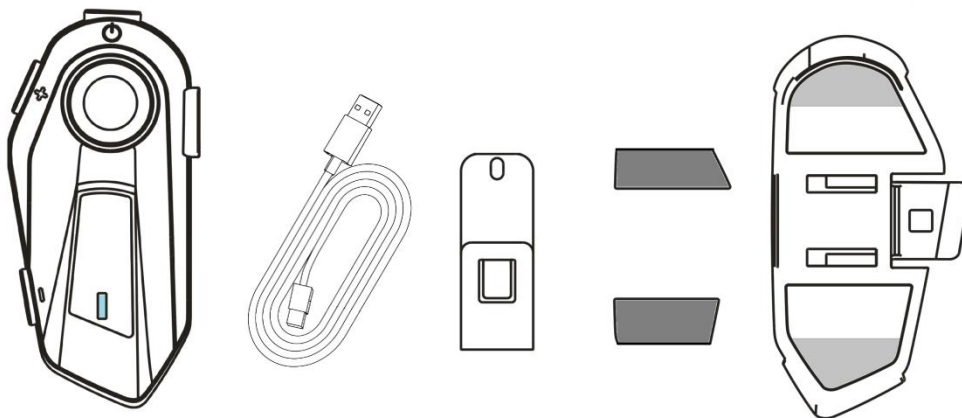

Main unit

Charging cord

Iron clamp

Foam adhesive

Base

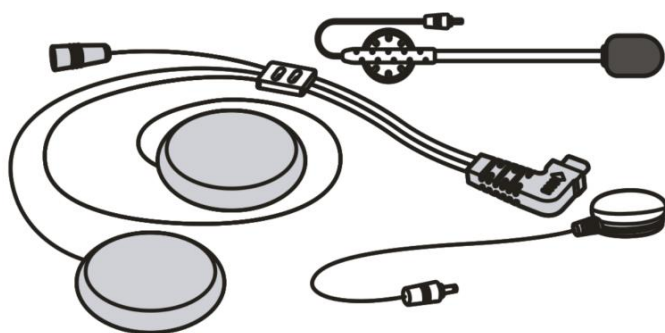

Headphone cord

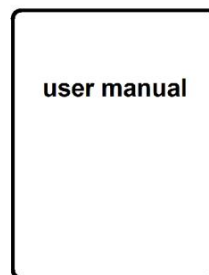

Operation instructions

3. Installation Steps

3.1 Installation of the headphone and the microphone

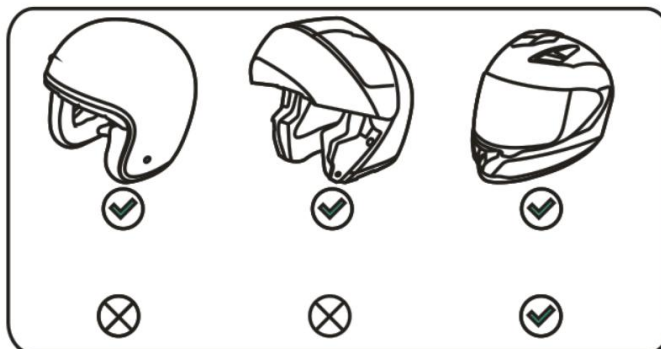
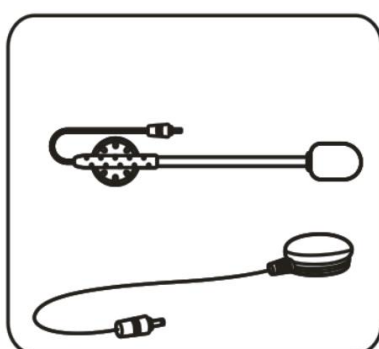
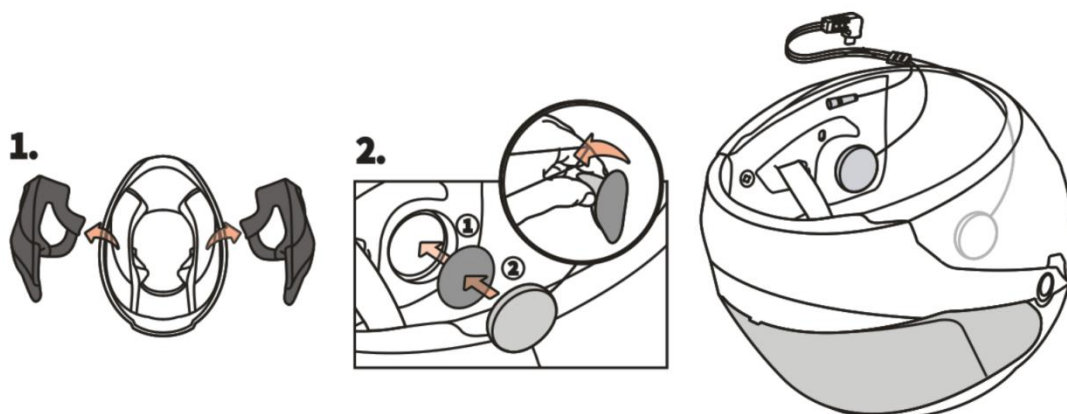

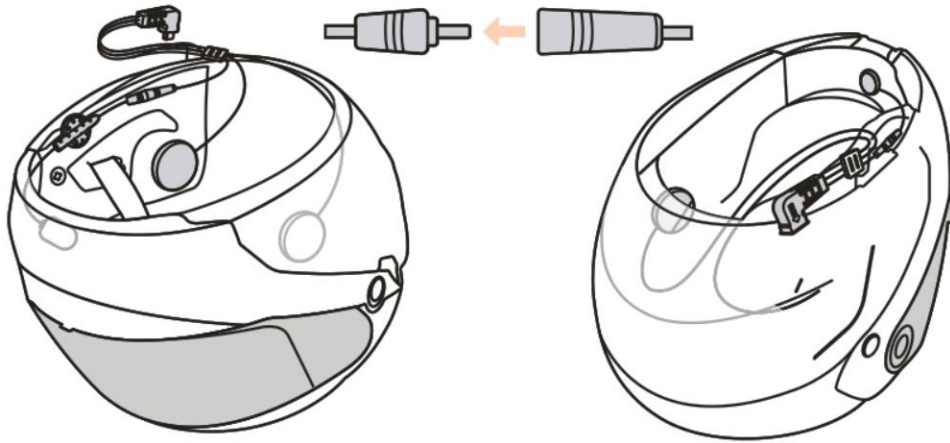

Open inner lining at ear position of helmet and attach velcro surface on speaker of the headphone cable.	Attach speaker hook surface to fur surface.	Place the microphone at a suitable position on the left side of the helmet, aim the microphone at the mouth, and adjust the line and inner pad.
--	---	---

3.2 Installation through an iron clip base

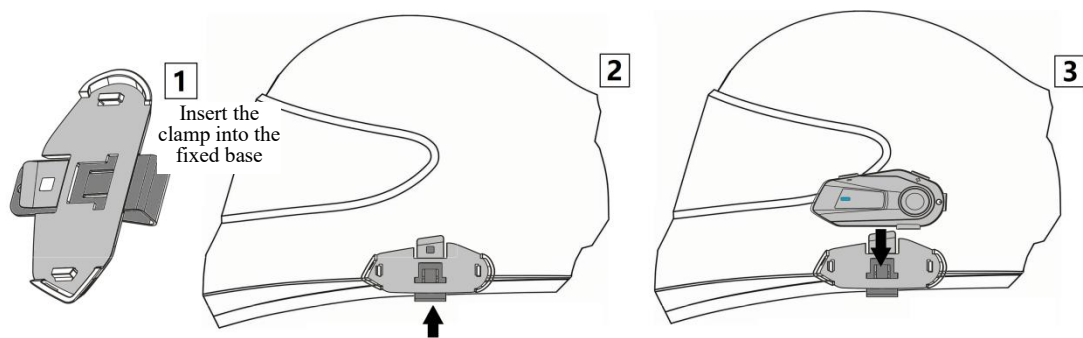

Insert the iron clip into the fixed base.	Open the left inner pad of the helmet and get the clip into the appropriate	Align the host card with the clip slot and move the clip in the direction of the arrow to secure it. Align the host position at the clamp inlet, and move
---	---	---

	position.	and tighten the host in the direction of the arrow.
--	-----------	---

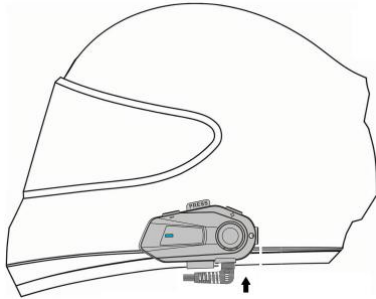

Insert the plug into the headphone jack and the installation is over.

3.3 Base installation by foam adhesive

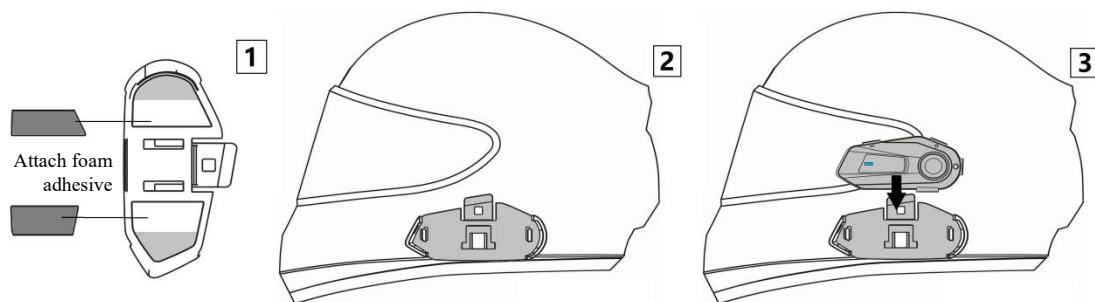

Attach the foam adhesive at the position as shown in the figure.	Tear off the foam adhesive release paper and attach the fixed base to the appropriate position on the left side of the helmet.	Align the host card position at the clamp inlet, and move and tighten the host in the direction of the arrow.
--	--	---

4. Main Unit Disassembly Steps

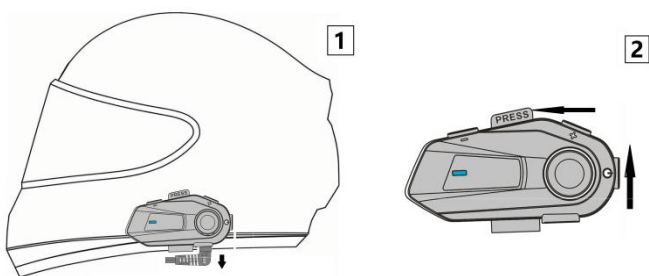

Remove headphone plug.

Press and hold the 'press' position, slide the host upwards to remove it.

5. Product Introduction

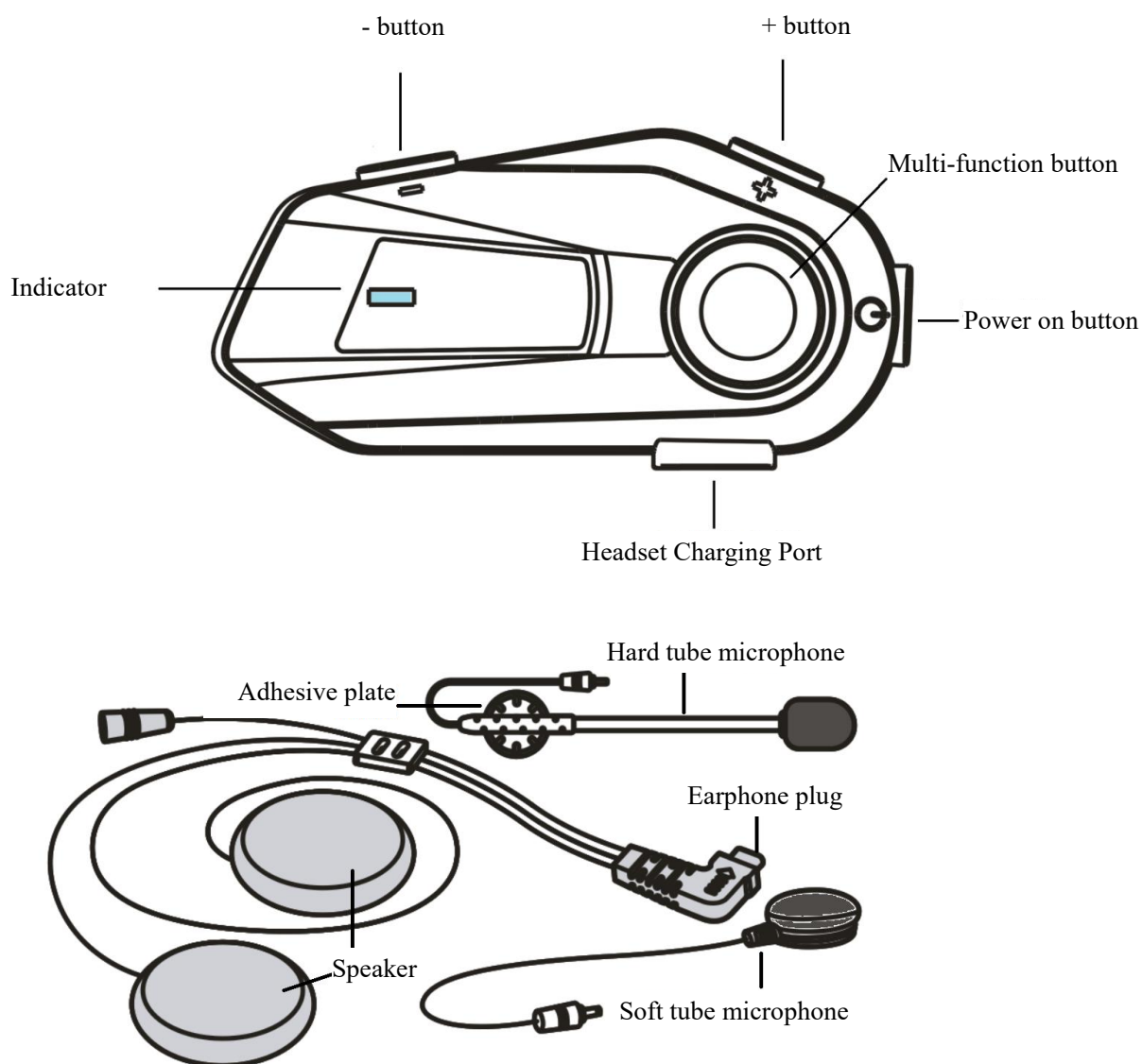

6. Function Introduction

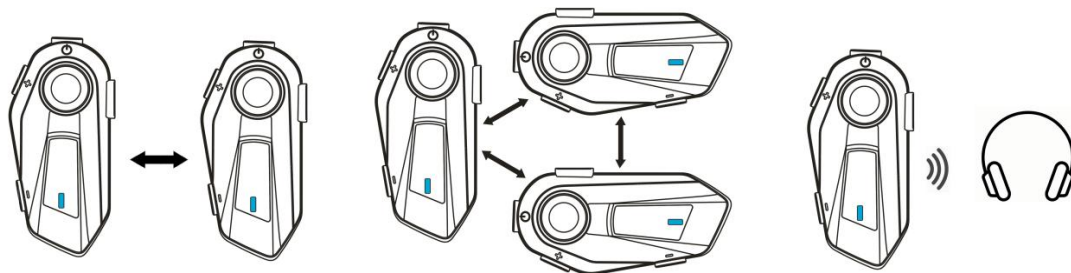

Two-vehicle Communication 1000 M	Three-party intercom, and button switching for two-way intercom	Connect Other Bluetooth Headsets
--	---	--



Connect Mobile Phone	Stereo Music	Voice Calls	Built-in FM Radio
-------------------------	-----------------	-------------	----------------------



Music sharing	DSP Processing	Play Control	Waterproof
------------------	-------------------	--------------	------------

7. Button operation instructions

7.1 Power button

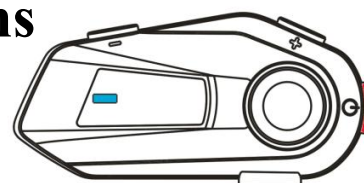

. **Power on** - In the power off state, hold it for 2 seconds, and there will be change into a regular flash until you hear the ‘Welcome’ blue indicator flash rapidly for 3

times. After it is powered on, the current battery level will be reported. (Note: Bluetooth that has cleared pairing records will automatically enter the pairing mode once powered on, with alternating red and blue lights flashing.)

. **Power off** - Hold it for 5 seconds in the power on state. The blue light is normally on for 1 second until 'Goodbye' is heard.

. **Pairing mode** - In the power off state, hold it for 4 seconds until the red and blue lights alternate flashing.

. **Enable the intercom pairing** - Two Bluetooth devices enter the pairing mode. Press one of the power buttons. After successful pairing, both Bluetooth devices will turn blue and flash. When 'Intercom Connected' is heard, press the power button again to disconnect it, and press the intercom button again to reconnect.

Note: If the way of starting the intercom for each party in the three-party intercom state is different, please read 9.6 Instructions for Steps.

. **End Bluetooth intercom talk** - Shortly press once during intercom, and you will hear 'Intercom disconnected'.

. Power on button and other button combination functions

1. Clear pairing records (hold the power on button for 8 seconds at the time of power off until a beep is heard. After it is cleared, it will automatically power off. Pairing again will be required for the next power on)

2. Pairing with other Bluetooth headset (First, clear the BT-S6 Bluetooth record, then long press the BT-S6 Bluetooth power on button to go to the red and blue light alternate flash. Turn on other Bluetooth headset to the pairing mode, and meanwhile, shortly press the BT-S6 power on/off button and multi-function button, wait for the BT-S6 Bluetooth to turn blue light flashing or after the 'Bluetooth Connected' prompt tone is heard, which means successfully pairing)

3. Go to the pairing mode once again to connect the phone (After power on, pair the intercom first, after hanging up the intercom, hold the power on button and multi-function button for 2 seconds to go to the red and blue flashing mode. Now, you can use your mobile phone to search and connect)

7.2 Multi-function button

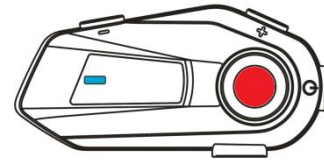

- . **Answer a phone call** - When connected to a mobile phone state, shortly press it to answer a call or automatically answer it if there is no operation for 8 seconds after the call.
- . **Reject a phone call** - When a phone is connected, hold it for 2 seconds to reject a phone call.
- . **During a phone call, the sound switches between the Bluetooth headset and the phone** - hold it for 2 seconds during a call, and the sound will switch to your mobile phone.
- . **End a phone call** - Press once during a phone call to hang it up.
- . **Music play pause** -- When connecting to your mobile phone, press the button.
- . **Voice call** -- When there is no call, long press it for 2 seconds to be able to enable the voice assistant, and you will hear a tone like 'DU'.
- . **Enable FM** -- When there is no call or music, double click on the button. After you hear 'Turn on radio', the outdoor result will be even better.

7.3 +Button

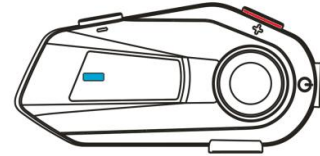

- . **Volume +** -- Long press the + button, and the volume will be higher. When it becomes the highest, you will hear the tone like 'toot'.
- . **Last** -- When playing music, shortly press it to switch it to the last music.
- . **FM tuning** -- In the FM mode, shortly press it to search radio stations upward.
- . **Music sharing** -- In the mode of successful intercom, after hanging up the intercom, double-click the volume + button while playing music, wait for a prompt to connect successfully, and then you can share music (also double-click on the volume + button to exit music sharing).

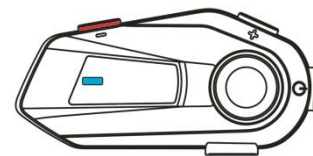

7.4 - Button

- . **Volume -** -- Long press the - button, and the volume will be lower.
- . **Next** -- When playing music, shortly press it to switch to the next music.
- . **FM Tuning** -- In the FM mode, shortly press it to search radio stations downwards.

7.5 Switching languages

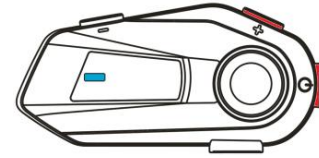

--- Shortly press power on button and volume + button simultaneously.

(to switch among three languages such as English, Japanese and Italy)

8. Bluetooth Status Indication & Prompt

. **Power On Status**---When power is on, you can hear 'Welcome', when intercom is connected, you can hear 'Intercom Connected', when intercom hangs up, you can hear 'Intercom disconnected', and blue light flashes every 2 seconds.

. **Charging Status**---The red light is always on when charging, and red light is off when it is fully charged.

. **Low battery alarm** - the current level of battery is displayed when the power is on; the battery level is divided into three levels of prompts, namely: 'Battery High' when the battery level is sufficient; 'Battery Medium' when the battery level is moderate, and 'Battery Low' when the battery level is low. When the battery is low during operation, it will prompt 'Battery Low' every 20 seconds and the red light will light up once.

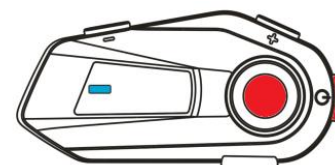

9. Pairing Mode

9.1 Two ways for BT-S6 to go to the pairing mode

Way 1: When the Bluetooth is in the power off status, long press the start button for 4 seconds, and the red and

blue lights flash alternately.

Way 2: When the Bluetooth is in the power on status, long press the power on button and the multi-function button for 2 seconds, and the red and blue lights flash alternately.

9.2 Pairing of two sets of BT-S6 Bluetooth

Step 1: Place two Bluetooth devices within a range of 1 meter and follow Way 9.1 to put both Bluetooth devices into the pairing mode.

Step 2: Press one of the Bluetooth power buttons, and it will automatically search for the other Bluetooth for pairing. After successful pairing, you will hear ‘Intercom Connected’ and can start the intercom.

Remarks: The Bluetooth intercom is provided with functions as pairing, recording and storing. If two Bluetooth devices were provided with pairing intercom, just press the start button of either set directly next time when it is powered on before intercom can be performed.

9.3 BT-S6 Bluetooth and

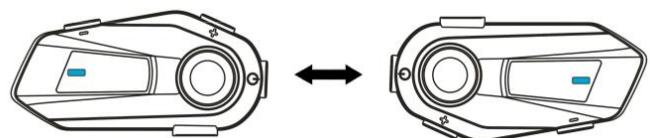

Mobile Phone/GPS/MP3 Pairing

Step 1: Place two devices within a range of 1 meter.

Step 2: Follow the first step in 9.1 to put Bluetooth into the pairing mode. Enable your phone's Bluetooth to search for Bluetooth devices. Select BT-S6, click to connect, and when the connection is successful, you will hear 'Bluetooth connected'.

Remarks: Steps for pairing intercom by two Bluetooth devices and simultaneously connecting your mobile phone: First, follow steps in 9.2 to pair intercom. After the intercom connection is OK, press one of the power on/off buttons to hang up the intercom. Then, use Way 2 in the steps in 9.1 to go to the pairing mode for the Bluetooth that needs to be connected. Now, enable the mobile phone Bluetooth and search for BT-S6 to connect.

9.4 Intercom pairing of BT-S6 with BT-S2 /BT-S3

Step 1: First, power on to clear pairing records, and place two Bluetooth devices within the range of 1 meter.

Step 2: Long press the power on button of BT-S6 Bluetooth until the red and blue lights flash alternately.

Step 3: For BT-S2/S3 Bluetooth, long press the power on button for 4 seconds to go to the red and blue lights flashing mode.

Step 4: Shortly press the power on button of BT-S2/S3 to automatically search BT-S6 Bluetooth pairing. After 'Intercom Connected' is heard, it indicates that the connection is OK.

9.5 Intercom pairing of BT-S6 with other Bluetooth headphones

Step 1: First, power on to clear pairing records, and then place the two Bluetooth devices within the range of 1 meter.

Step 2: Long press the BT-S6 Bluetooth power button until the red and blue lights flash alternately.

Step 3: Enable other Bluetooth devices and go to the red and blue flashing mode.

Step 4: Press the power button and multi-function button of BT-S6 Bluetooth simultaneously, and it will automatically search for BT-S6 Bluetooth for pairing, and after 'Bluetooth connected' is heard, it indicates that connection is OK.

9.6 Description of BT-S6 three-party intercom pairing

Note: Before pairing, clear pairing records of each machine.

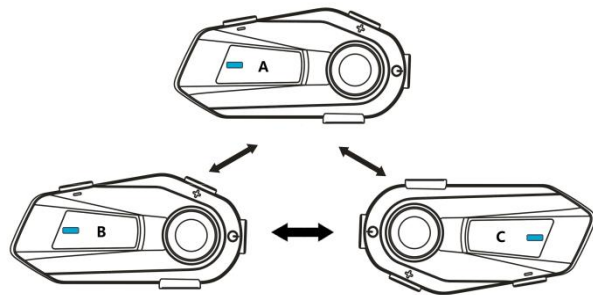

Step 1: Clear pairing records of A, B and C.

First, turn on A, B and C, and then hold the power on button for 8 seconds respectively. When ‘toot’ is heard, the red and blue lights flash simultaneously for power off.

Step 2: Pair in order.

1. A and B pairing: Hold the power on buttons of A and B simultaneously to go to the red and blue lights flashing. Press A’s power on button until A and B change into blue lights simultaneously or ‘Intercom Connected’ is heard.

2. Press the power on button of B to hang up intercom between A and B. Hold the power on button of B and multi-function button for 2 seconds to go to the red and blue light flashing, and then hold the power on button of C to go to red and blue lights flashing. Finally, press the power on button of B to start pairing until B and C change into blue lights simultaneously or ‘Intercom

Connected' is heard.

3. Press the power on button of C to hang up intercom between B and C, and then hold the power on button of C and the multi-function button for 2 seconds to go to the red and blue lights flashing. Hold the power on button and multi-function button of A simultaneously for 2 seconds to go to the red and blue lights flashing. Finally, press the power on button of C to start pairing until C and A change into blue lights simultaneously or 'Intercom Connected' is heard.

4. Now the call mode among A, B and C has been set. For example, A: Press the power on button to hang up intercom. When it is not in the intercom mode, press the power on button to reconnect for intercom with B. Press the power on button twice continuously to reconnect and perform intercom with C;

B: Press the power on button to go to C, and press it twice continuously to go to A;

C: Press the power on button to go to A, and press the power on twice continuously to go to B.

10. Description of function priority

Level 1: Phone

Level 2: Bluetooth intercom

Level 3: Mobile phone music

Level 4: FM

11. Notes

1. If you stop using this unit for long, please store it at a dry place, and charge the unit regularly (charge once three months) to ensure that the unit can work normally;
2. The storage temperature of the unit is -15°C to 55°C , so please do not store it under an environment where temperature is too high or too low. Otherwise it may have an adverse effect on the service life of the unit;
3. Please do not expose this unit to open flames to avoid explosion;
4. TYPE-C and reset charging.

FCC Caution

This device complies with part 15 of the FCC Rules. Operation is subject to the following two conditions: (1) This device may not cause harmful interference, and (2) this device must accept any interference received, including interference that may cause undesired operation.

Any changes or modifications not expressly approved by the party responsible for compliance could void the user's authority to operate the equipment.

NOTE: This equipment has been tested and found to comply with the limits for a Class B digital device, pursuant to Part 15 of the FCC Rules. These limits are designed to provide reasonable protection against harmful interference in a residential installation. This equipment generates, uses and can radiate radio frequency energy and, if not installed and used in accordance with the instructions, may cause harmful interference to radio communications. However, there is no guarantee that interference will not occur in a particular installation.

If this equipment does cause harmful interference to

radio or television reception,

which can be determined by turning the equipment off and on, the user is encouraged to try to correct the interference by one or more of the following measures:

- Reorient or relocate the receiving antenna.
- Increase the separation between the equipment and receiver.
- Connect the equipment into an outlet on a circuit different from that to which the receiver is connected.
- Consult the dealer or an experienced radio/TV technician for help.

The device has been evaluated to meet general RF exposure requirement. The device can be used in portable exposure condition without restriction.