

pet automatic feeder Instruction manual

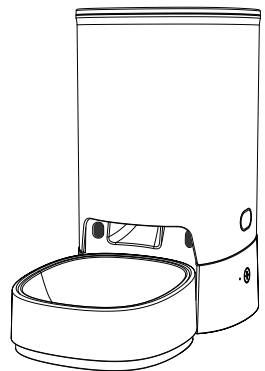

Please read the instruction manual carefully before using the product

2305

Statement

Thank you for purchasing the Petree automatic feeder. Petree Technology is committed to making pet-raising life better through the power of design. This manual will help you better understand and use this product. Enjoy your using!

Notice to users

1. Please install and use this product strictly according to the instructions.
2. This feeder is only suitable for dry food. Do not put wet food in.
3. The shape and size of food particles can cause a certain deviation in the weight of the food released.
4. Top cap, food barrel, and stainless steel bowl can be washed with water. The host and bowl holder are forbidden to wash.
5. Except for maintenance personnel, no one else is allowed to disassemble and repair this product.
6. Please use the battery safely. Improper use of the battery can cause electrolyte leakage and cause a fire.
7. Please use the battery safely. Improper use of the battery may cause electrolyte leakage and cause a fire.
8. Please keep the feeder away from heat sources, open flames, or other high-temperature countertops.

1

Product list

Please check the product list and quantity carefully

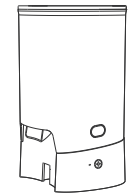

Automatic feeder host
x 1



Bowl holder
x 1



stainless steel bowl
x 1

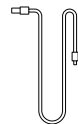

type-c x 1



Adapter x 1



Desiccant x 1



Instructions x 1

2

Product introduction

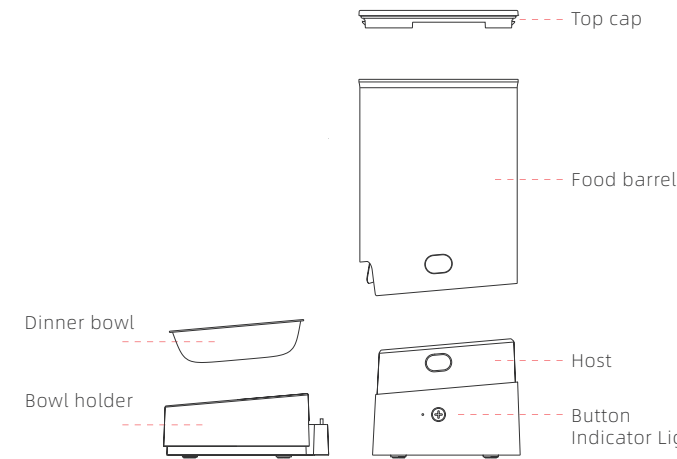

3

Installation instructions

1. Install the desiccant

Open the fixed cover and put the desiccant into the slot.

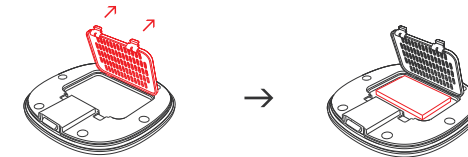

2. Install the food barrel

Press the host buckle with both hands at the same time, and the food barrel can be disassembled.

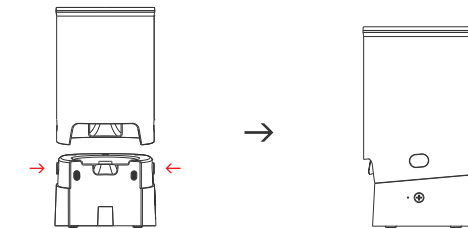

4

3. Install the bowl and the holder

Place the dinner bowl in the bowl holder, insert the bowl holder fixing part into the host positioning groove.

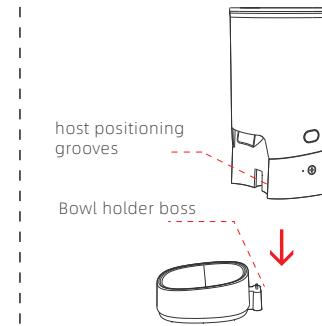

4. Disassemble the food barrel

Rotate the leakage port. Then food barrel, stirring blades, and distributing blades can be disassembled and cleaned.

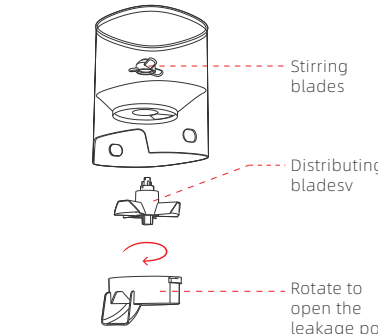

5

Button and light descriptions

Touch button	Single press	No response
	Double press	Release a portion of pet
	Press for 3 seconds	Enter the network configuration mode

Indicator light	White light	Always on	Device standby
		flashing	Distribution network
	Red light	Always on	Motor failure
		flashing	Lack of food/low battery power

Distribution network

Precautions for network distribution

- 1.Scan QR code to download the app
- 2.In standby mode, press and hold the button, the indicator light will flash quickly and enter the distribution network.
- 3.Open the app, follow the instructions to add devices and connect to the network.
- 4.After successful network distribution, the indicator light will stay white.
- 5.This product only supports 2.4G Wi-Fi and does not support 5G Wi-Fi.
- 6.When distributing the network, the phone needs to turn on Bluetooth.
- 7.If the app cannot discover the device, please power off the device for 5 seconds and then power it on and restart.
- 8.A device can only be bound to one account.



Function description

1. Manual feeding function

Double press the button to release one portion of the food. If multiple portions are needed, the operation can be repeated.

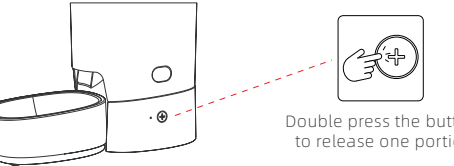

Double press the button to release one portion

2. Automatic food dispensing function

Connect the device to the app and set a feeding plan in the app. The feeder will automatically release food by the plan every day. Notification information of feeding will be sent on time.

- (1) The feeder is suitable for: puffed pet food, freeze-dried food.
- (2) Maximum supported freeze-drying size: 14 * 14 * 14mm.
- (3) Do not put oversized particles in.

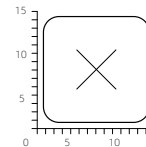

3. Meal tray weighing function

(Not available for non weighing feeders)

- (1) Display the remaining amount in the bowl. You can remotely check the condition of the feeder through the app, making it easy to observe and check feeding situation.
- (2) Display feeding data. The device records the weight of each pet's meal and generates a data table for you to update feeding plans.
- (3) Set the maximum food output. The feeder can set the maximum capacity of the bowl to avoid food accumulation and becoming stale.

Quick troubleshooting

1. The indicator light flashes red

- 1、Check whether the machine is short of food, please replenish it in time.
- 2、Please check whether the machine battery is low and replace the battery in time.

2. Indicator light staying red

- 1、Check whether food is stuck and clean up the blockage.
- 2、After troubleshooting, double-click the button to produce food normally.

3. The life of the desiccant

The desiccant of the feeder has a usage time of 30 days, which can extend the storage time of food. If the desiccant expires, please replace it in time.

Cleaning instructions

1. Disassemble the machine

There are fixed switches on both sides of the barrel, which can be pressed to remove the barrel. Pour out the remaining food from the machine and twist open the leakage port, then you can clean the leakage port and the brush.

2. Dismantling and washing equipment

The components can be washed with water, except for the bowl holder and the host

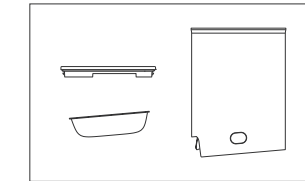

Washable

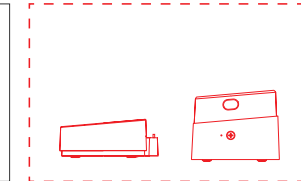

Non washable

3. Dry out and install

After cleaning, wait air drying to complete. And then install the barrel, the bowl holder, and the bowl in sequence.

Hazardous Substance Description

Part	Hazardous substances					
	Pb	Hg	Cd	Cr(VI)	PBB	PBDE
Cover	○	○	○	○	○	○
PCBA	×	○	○	○	○	○
Wire	×	○	○	○	○	○
Metal	×	○	×	○	○	○
Adapter	×	○	×	○	○	○
○: Indicates that the content of the hazardous substance in all homogeneous materials of the component is below the limit specified in GB / T 26572. ×: Indicates that the content of the hazardous substance in at least one homogeneous material of the component exceeds the limit specified in GB / T 26572.						

Product parameters

Product name	Petree pet automatic feeder
Product model	ACF-23-02
size	186 x 318 x 326 (mm)
net weight	1.8 KG
Rated voltage	5V \approx 1A
Execution standards	GB4706.1-2005

FCC Statement

This equipment has been tested and found to comply with the limits for a Class B digital device, pursuant to Part 15 of the FCC Rules. These limits are designed to provide reasonable protection against harmful interference in a residential installation. This equipment generates uses and can radiate radio frequency energy and, if not installed and used in accordance with the instructions, may cause harmful interference to radio communications. However, there is no guarantee that interference will not occur in a particular installation. If this equipment does cause harmful interference to radio or television reception, which can be determined by turning the equipment off and on, the user is encouraged to try to correct the interference by one or more of the following measures:

- Reorient or relocate the receiving antenna.
- Increase the separation between the equipment and receiver.
- Connect the equipment into an outlet on a circuit different from that to which the receiver is connected.
- Consult the dealer or an experienced radio/TV technician for help.

This device complies with part 15 of the FCC Rules. Operation is subject to the following two conditions:
(1) This device may not cause harmful interference, and
(2) this device must accept any interference received, including interference that may cause undesired operation.

Changes or modifications not expressly approved by the party responsible for compliance could void the user's authority to operate the equipment

600*100mm, 正反面印刷, 6折页, 157g铜版纸不覆膜