

INSTRUCTION MANUAL

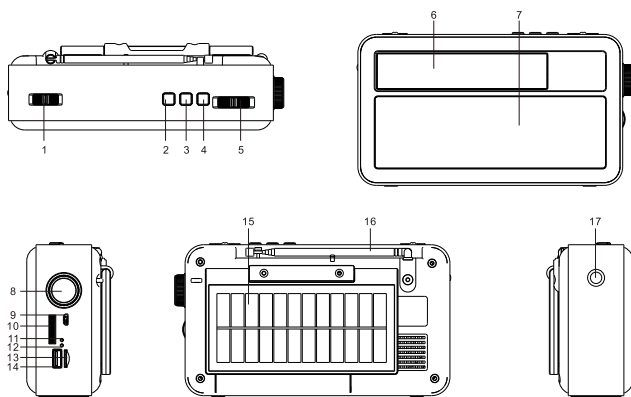

INDEX TO PARTS & CONTROLS

- | | |
|-------------------------|--------------------------|
| 1. FLASHLIGHT(Torch) | 9. DC 5V IN |
| ON/OFF Switch | 10. VOLUMN/POWER |
| 2. PRE/REW | 11. CHARGE INDICATOR |
| 3. PLAY/PAUSE/TWS | 12. POWER INDICATOR |
| 4. NEXT/F F.W | 13. TF CARD SLOT |
| 5. BAND | 14. USB PORT |
| 6. FREQUENCY INDICATING | 15. SOLAR CHARGING PANEL |
| WINDOW | 16. ANTENNA |
| 7. SPEAKER | 17. FLASHLIGHT |
| 8. TUNING | |

OPERATION & FUNCTION

· Radio

1. Turn on the power by turning the volume knob.

E-1

2. Push BAND to choose AM/FM/SW. When listen to AM radio, you can get a better signal reception by rotating the unit body direction. When listen to FM/SW radio, pull out the antenna and adjust its length/direction to get a better signal reception.
3. When tuning the radio, please slowly adjust the TUNING knob.

· BT

1. When the USB/TF card is not inserted, turn on the volume and power switch knob of the unit and push BAND to MUSIC position. You will hear "waiting for pairing" from the unit.
2. Search and connect our Bluetooth device "BT03". You will hear "connected" from the unit when Bluetooth connection is done.
3. After successful connection, you can play music from your cellphone music app.
4. During playback, press PREV/NEXT button to select previous/next song.
5. During playback, press PAUSE button to stop music, press again for playing music. Double-click the PAUSE button to switch Bluetooth /USB/ TF playing music.
6. Interconnection: When one machine is playing music in Bluetooth mode, turn on another same model machine(REF. STEP1). You will hear "waiting for pairing" from another machine. Long press the PAUSE button on both machines at the same time till you hear "ding dong" sound. When two machines interconnection is done, you will hear "connected". To disconnect, please long press the PAUSE button for 2 seconds on both machine or short press PAUSE button on one machine.

· Play USB Stick/TF Card

Audio Format: MP3, WMA, WAV.

1. Turn on the volume and power switch knob to push the BAND to the MUSIC position.
2. Inserted into the USB/TF socket, the unit will automatically play music files from your USB Stick/ TF Card. (Make sure there are only audio files in you USB stick or TF card.)
3. During playback, press PREV/NEXT button to select previous/next song.
4. During playback, press PAUSE button to stop music, press again for playing music. Double-click the PAUSE button to switch Bluetooth /USB/ TF playing music.
5. When USB stick and TF card are inserted at the same time, the unit will play audio files from the last device inserted by default.

· PC Speaker

Use USB DOUBLE HEADER DATA CORD (purchased by the user) to connect the PC

E-2

and our Radio. Push the BAND to music position and then the radio can be used as PC speaker.

· Charging

When the power is insufficient, the sound of the machine will become smaller, please charge the machine with USB cable via DC 5V IN. Charging time is about 4-6 hours. Charge indicator light off means that charging is complete.

· Solar Charging

Turn the solar charging panel toward the sunlight and the charging indicator light is on. Under strong light, charging can be completed in 7-9 hours. Charge indicator light off means that charging is complete.

· Flashlight

Turn on/off the flashlight by push the flashlight(torch) switch to on/off position.

SPECIFICATION

1. Frequency Range: AM 530 - 1710 KHz FM 88 - 108 MHz SW 5.9-18.0 MHz Bluetooth 2.4G
2. Power Supply: DC 3V(UM - 1X2) Maximum Loss Power: 4W
3. USB Charging Time: 4- 6 hours Solar Charging Time: 7-9 hours (Under Strong Sun Light)
4. USB Stick/TF Card Audio Files Format: MP3/WMA/WAV

WARNINGS

1. To protect the life of the rechargeable battery, ensure that the battery is charged at least once every three months.
2. Avoid strong shocks and falls.
3. Keep away from heat and humidity.
4. The AM radio signal will be interfered when AC is charging.

AFTERSALES SERVICE

We offer a free after-sales service for the first twelve months from the date of

E-3

purchase. For after-sales issue, please send e-mail to kennykwok@gkeni.com with your order ID.

FCC Warning Statement

Changes or modifications not expressly approved by the party responsible for compliance could void the user's authority to operate the equipment. This equipment has been tested and found to comply with the limits for a Class B digital device, pursuant to Part 15 of the FCC Rules. These limits are designed to provide reasonable protection against harmful interference in a residential installation. This equipment generates uses and can radiate radio frequency energy and, if not installed and used in accordance with the instructions, may cause harmful interference to radio communications. However, there is no guarantee that interference will not occur in a particular installation. If this equipment does cause harmful interference to radio or television reception, which can be determined by turning the equipment off and on, the user is encouraged to try to correct the interference by one or more of the following measures:

- Reorient or relocate the receiving antenna.
- Increase the separation between the equipment and receiver.
- Connect the equipment into an outlet on a circuit different from that to which the receiver is connected.
- Consult the dealer or an experienced radio/TV technician for help.

This device complies with part 15 of the FCC Rules. Operation is subject to the following two conditions: (1) This device may not cause harmful interference, and (2) this device must accept any interference received, including interference that may cause undesired operation.

The device has been evaluated to meet general RF exposure requirement.

E-4