



WARNING

!

• **INGESTION HAZARD:** This product contains a button cell or coin battery.

• **DEATH** or serious injury can occur if ingested.

• A swallowed button cell or coin battery can cause **Internal Chemical Burns** in as little as **2 hours**.

• **KEEP** new and used batteries **OUT OF REACH of CHILDREN**

• **Seek immediate medical attention** if a battery is suspected to be swallowed or inserted inside any part of the body.

a) Remove and immediately recycle or dispose of used batteries according to local regulations and keep away from children. Do NOT dispose of batteries in household trash or incinerate.

b) Even used batteries may cause severe injury or death.

c) Call a local poison control center for treatment information.

d) The compatible battery type (e.g., LR44, CR2032).

e) The nominal battery voltage

f) Non-rechargeable batteries are not to be recharged.

g) Do not force discharge, recharge, disassemble, heat above or incinerate. Doing so may result in injury due to venting, leakage or explosion resulting in chemical burns.

a) Ensure the batteries are installed correctly according to polarity (+ and -).

b) "Do not mix old and new batteries, different brands or types of batteries, such as alkaline, carbon-zinc, or rechargeable batteries.

c) Remove and immediately recycle or dispose of batteries from equipment not used for an extended period of time according to local regulations.

d) Always completely secure the battery compartment. If the battery compartment does not close securely, stop using the product, remove the batteries, and keep them away from children.

FCC Statement
This equipment has been tested and found to comply with the limits for a Class B digital device, pursuant to part 15 of the FCC Rules. These limits are designed to provide reasonable protection against harmful interference in a residential installation. This equipment generates, uses and can radiate radio frequency energy and, if not installed and used in accordance with the instructions, may cause harmful interference to radio communications. However, there is no guarantee that interference will not occur in a particular installation. If this equipment does cause harmful interference to radio or television reception, which can be determined by turning the equipment off and on, the user is encouraged to try to correct the interference by one or more of the following measures:
—Reorient or relocate the receiving antenna.
—Increase the separation between the equipment and receiver.
—Connect the equipment into an outlet on a circuit different from that to which the receiver is connected.
—Consult the dealer or an experienced radio/ TV technician for help.
This device complies with part 15 of the FCC Rules. Operation is subject to the following two conditions: (1) This device may not cause harmful interference, and (2) this device must accept any interference received, including interference that may cause undesired operation.
Caution
Any changes or modifications not expressly approved by the party responsible for compliance could void the user's authority to operate the equipment.

FCC Radiation Exposure Statement
This equipment must be installed and operated in accordance with provided instructions and the antenna(s) used for this transmitter must be installed to provide a separation distance of at least 20 cm from all persons and must not be co-located or operating in conjunction with any other antenna or transmitter. End-users and installers must be provided with antenna installation instructions and transmitter operating conditions for satisfying RF exposure

Product Overview
The Beelink mini PC is designed to serve as an intelligent data management center for family and individual users, studios, and enterprises. After being connected to mobilephones, computers, tablets, TVs, and other terminal devices, it enables centralized data storage.

0 3

0 2

0 1

SSD 3

SSD 2

SSD 1

0 4

0 5

0 6

SSD 4

SSD 5

SSD 6

!

Note: The default OS is pre-installed on the onboard eMMC. To install it on an SSD, it is recommended to use system drive 4, which runs at PCIe 3.0 x2 speed and is compatible with SATA3 hard drives. Drives 1, 2, 3, 5, and 6 function as storage drives, operating at PCIe 3.0 x1 speed.

01

SSD Installation or Replacement

Warning: Always power off the device before installation/removal to prevent data loss or hardware damage. It is recommended to install two SSDs of the same specifications and capacity for dual backup and enhanced data security.
① Detach the four silicone plugs at the bottom. Unscrew the four screws and remove the top cover.

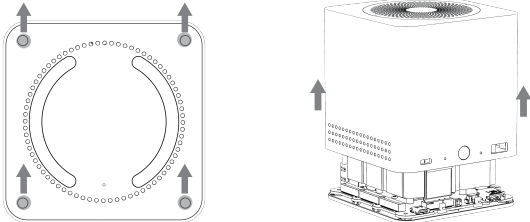

② Peel off the silicone protective film from the location where you intend to install the hard drive, remove the screws, and install the hard drive.

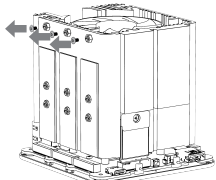

③ Align the SSD's notch with the M.2 slot on the motherboard and slide it in. Then, press down the opposite end and secure it with the screw.

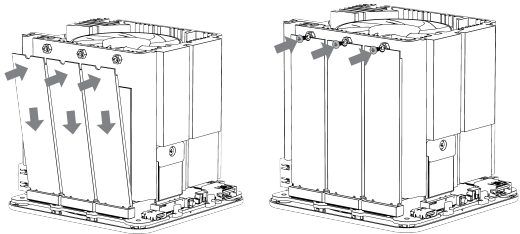

④ Put back the protective cover, tighten the four screws, and reinsert the silicone plugs.

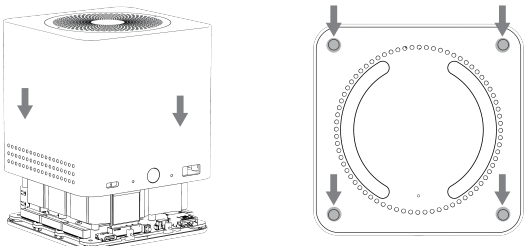

Interfaces

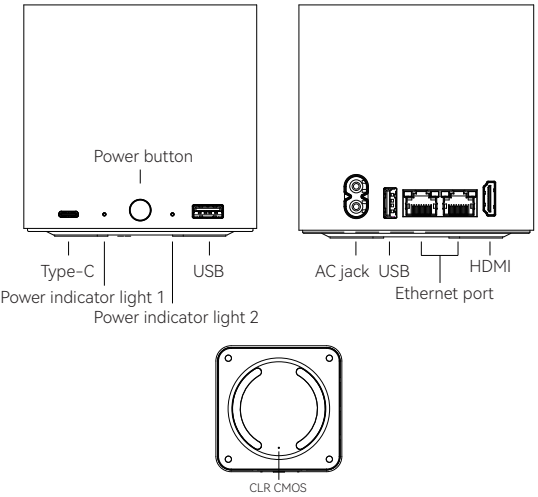

Note: Power indicator light 1 glows white when the ME mini is in operation; Power indicator light 2 glows orange when the ME mini is in sleep mode.

Cable Connections

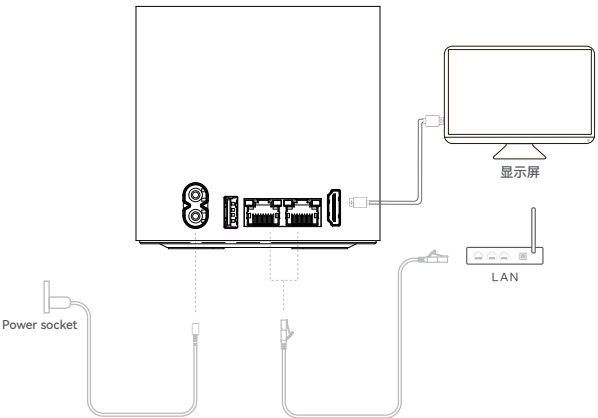

- ① Network Setup: Connect the ME mini's LAN port to the LAN port of your router/modem using an Ethernet cable.
- ② Connect the included AC power cord to the ME mini's power port, and then insert the plug into a power socket.
- ③ Display: Use an HDMI cable to connect the ME mini to a monitor.



After service
Email:
Mini PC: Support-pc@bee-link.com
TV BOX: Support-box@bee-link.com
Sales: Wholesale@bee-link.com
Call us! +86-755-36633117

