

Smart String Light (WiFi)

- User Manual -



Three in One connection mode



WiFi

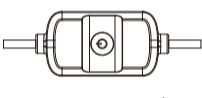

Button Control

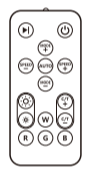

Remote Controller

Smart String Light (WiFi)

User Manual

Thank you for purchasing Smart Point Control String Light, please read this user manual carefully first, we will introduce some of the important features and operating procedures of this products, please keep this manual in a safe place for future reference.

Package Lists

1* LED String Light
1* DC12V 1A Adapter
1* RF Remote Controller
1* User Manual

Specifications

Power	12W
Voltage	AC100-240V 50/60Hz
Light Source	LED
String Length	48ft/15m
Bulb Qty	15pcs
Color Temperature	RGBW
Waterproof Rated	IP65 (String Light) IP40(Power Supply)
Adapter	DC12V 2A
Connection Mode	WiFi + RF Remote controller + Button control (Three in One connection mode)
Usage Method	Can support Alexa and Google assistant voice control

-1-

Operation Instructions

1. Plug and play.
2. Just insert the adapter into an appropriate power socket to turn on the string light and unplug it to turn off the light, no need to install bulbs.

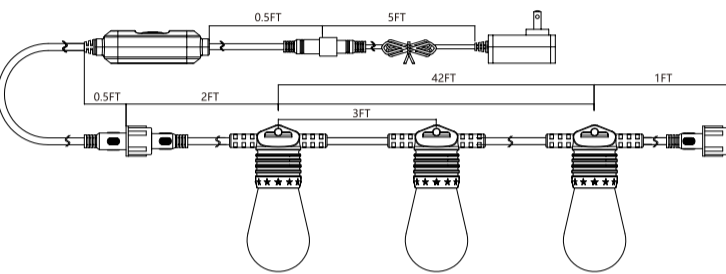

A. Wi-Fi Connection

WIFI

1. APP Download

Download the "Tuya" or "Smart Life" APP from APP store (for IOS) and Google play store (for Android), or scan the below QR code to download the software, and register with phone number/ email/social media account.



Tuya



Smart Life



-2-

2. How to link APP to string lights

- Step 1.** Plug in adapter to the socket, all bulbs will be red color, long press the "on/off" button 5 seconds until the string light to quickly blink status .
- Step 2.** Open APP---press "Add Device" ---select "Lighting Devices" ---press "String Lights (Wi-Fi)".
- Step 3.** Follow the App instructions, select 2.4G Wi-Fi network and enter password.
- Step 4.** Confirm the light is blinking status, then press the next step, until confirming device is added to the APP successfully.
- Note:** Please make sure these steps are done within 2 minutes, if over time, the string light will stop blinking, please restart step 1-4 then finish the connection.

-3-

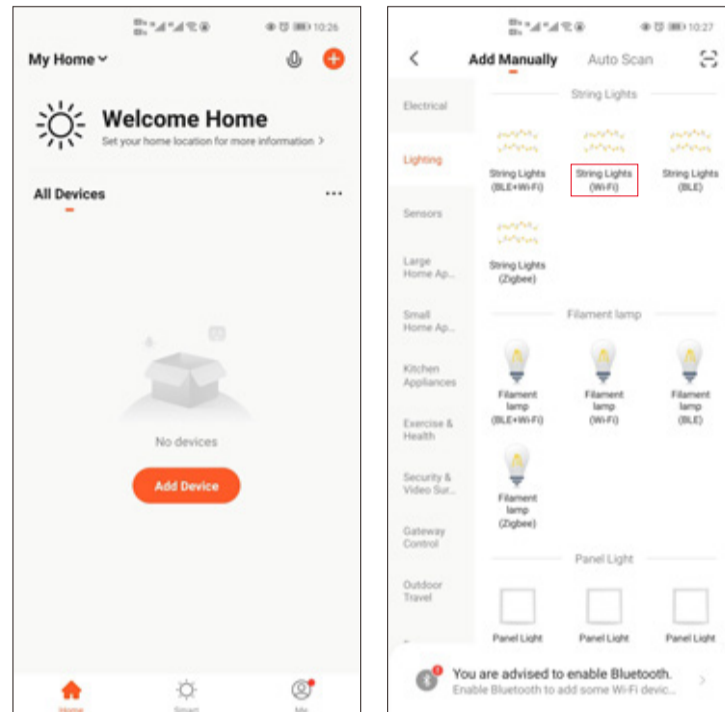

1

2

-4-

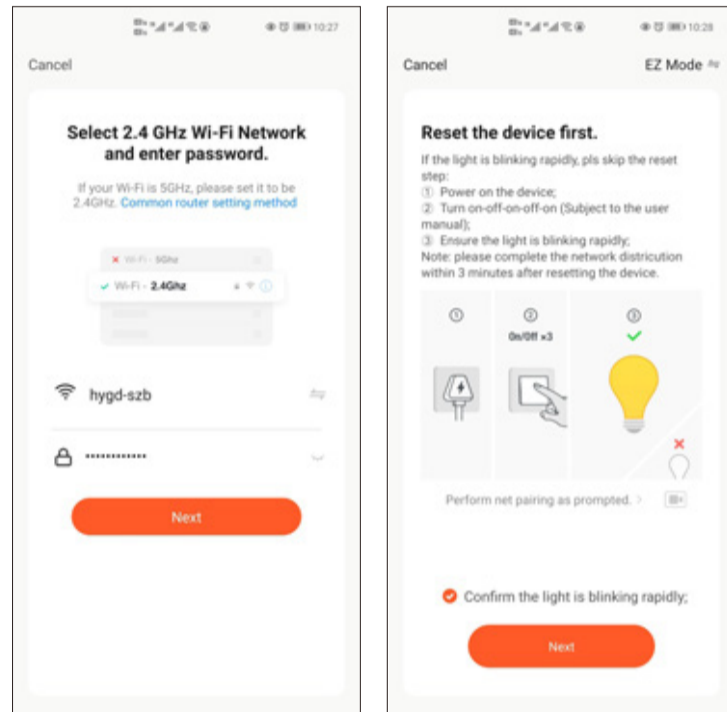

3

4

-5-

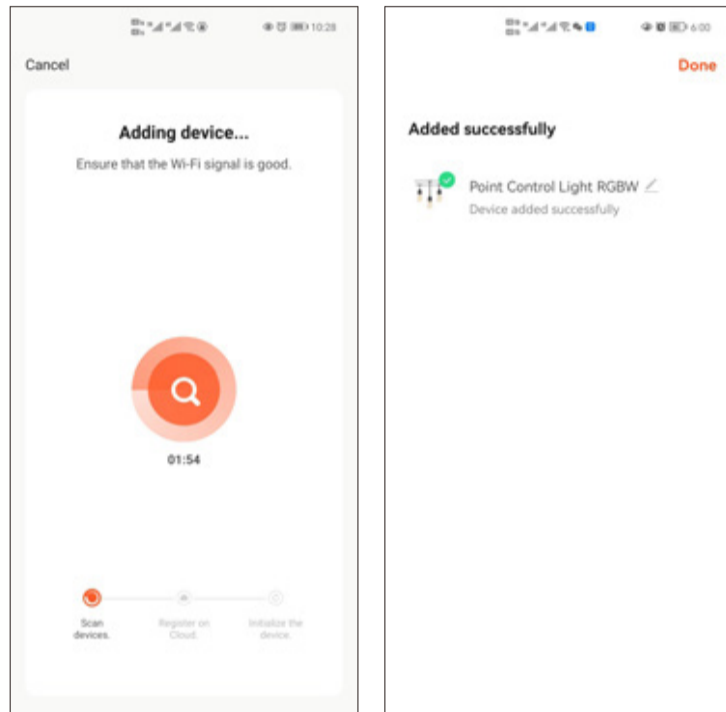

5

6

-6-

3. APP more functions choices for you

Color changing: Change the light color to be RGB or White

Brightness adjusting: Dim or brighten the string light

Point control light off: Can individually point control each bulb to be OFF.

Individual Bulb control: Change bulb's color and brightness individually

8 Scene modes optional: Flow-Rainbow-Chase-Dazzle-Gradient-

3 Music modes: The lighting flashes and changes colors according to the music beat.

Timer setting: Turn on/off at preset time automatically.

Group control: Support individual bulb or group bulbs control.

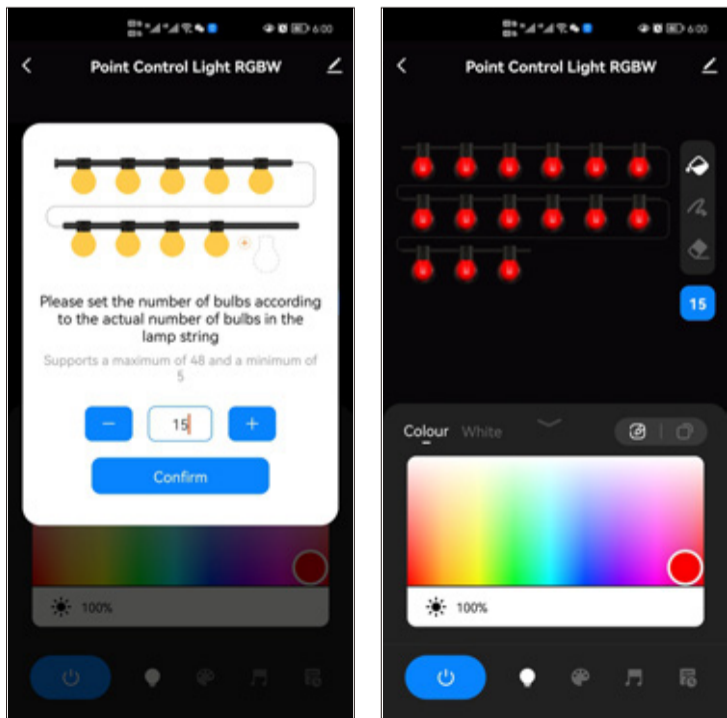

1

2

-8-

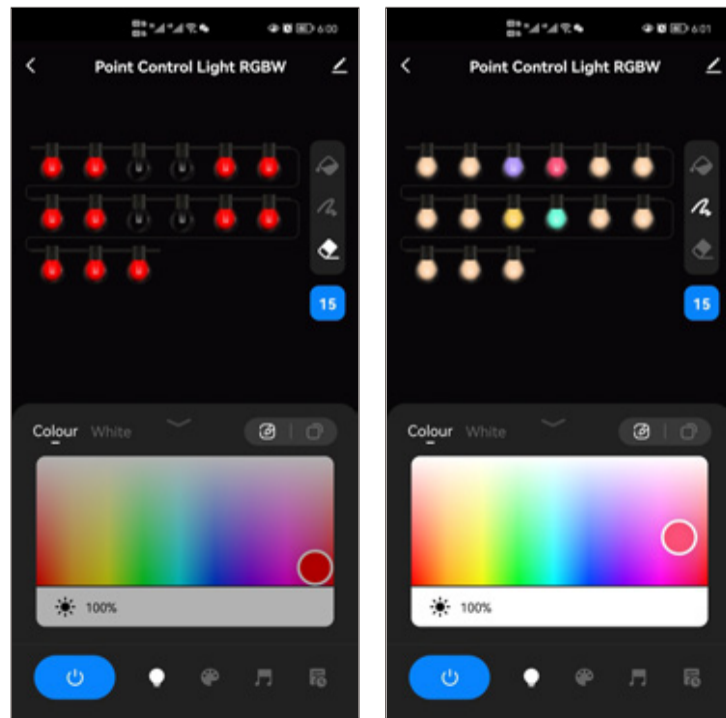

3

4

-9-

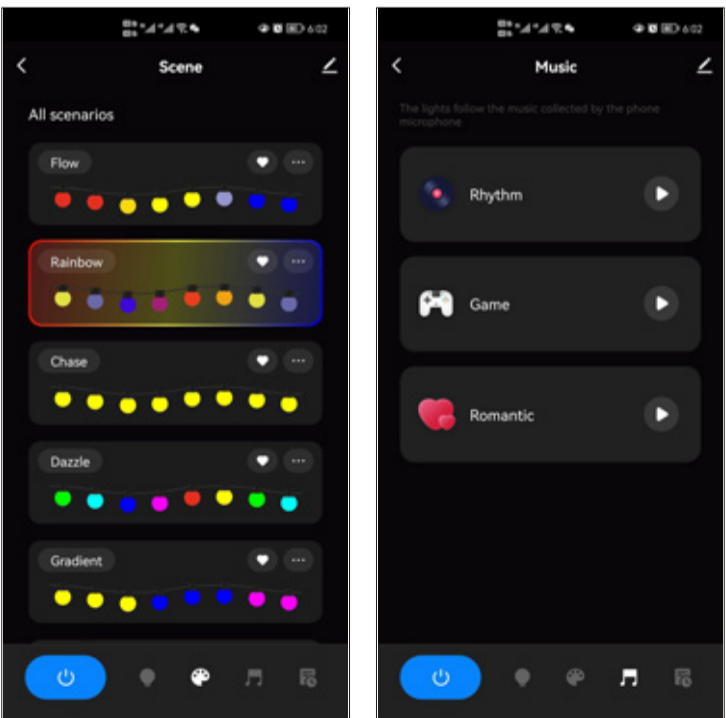

5

6

-10-

B. Remote Controller Operation

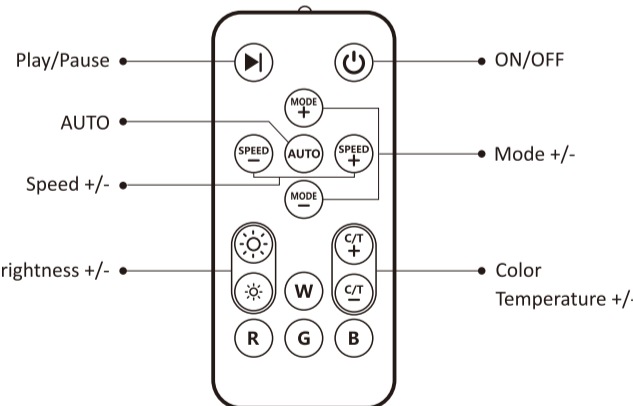

Remote function description

ON/OFF

Play/Pause

Mode +/-: 8 scene modes +/-

Speed +/-: Dynamic status speed +/-

AUTO: 8 scene modes can be changed automatically

Brightness +/-: Adjust the RGB&W brightness +/-

C/T+/-: In the RGB mode, the 18 preset colors can be changed cyclically.

In the white light mode, 11 preset colors can be changed cyclically.

RGBW: Click to change to relevant colors.

Note: 1. RF Remote controller can work when the led string light not in quick blink status.

2. If over 2 minutes, the APP can not connect the string lights successfully, then can use the RF Remote controller to control the string lights.

-11-

C. Switch control on the control box

1. Quickly press the button two times, then be ON or OFF status. (when the string light not in quick blink status)
2. After finish the network connection, the lights stop blinking, then can use switch control the string lights.
Or over 2 minutes, the network connection is fail, then can use switch control the string lights.
3. Long press the button, go to Wi-Fi connection mode (details pls refer to APP control)

Cautions & Warnings

1. The bulb is 12V only, please do not put the bulb into other fixtures.
2. Do not repair, disassemble, or modify the product without approval.
3. Do not place the light near any heat sources.
4. Please keep it away from children.
5. Please keep the light dry and clean.
6. Please do not hang anything from the string lights as the extra weight may break the light wire and cause potential fire hazard.
7. Although our lights are built with safety measures, we do not recommended leaving the light unattended or turning on permanently.
8. Please unplug the switch when it is not in use.
9. Please cut off the power before installing the bulb.
10. If you want to connect more sets string lights, need to change a bigger power adapter.

Correct Disposal of This Product



(Waste Electrical & Electronic Equipment)

-12-

This marking shown on the product, or its literature, indicate that it should not be disposed with other household wastes at the end of its working life.

To prevent possible harm to the environment or human health from uncontrolled waste disposal, please separate this from other types of wastes and recycle it responsibly to promote the sustainable reuse of material resources.

Household user should contact either the retailer where they purchasing this product, or their local government office, for details of there and how they can take this items for environmentally safe recycling.

Business users should contact their supplier check the terms and conditions of the purchase contacts, this products should not be mixed with other commercial waste for disposal.

-13-

FCC Warning

This device complies with part 15 of the FCC rules. Operation is subject to the following two conditions: (1) this device may not cause harmful interference, and (2) this device must accept any interference received, including interference that may cause undesired operation.

Changes or modifications not expressly approved by the party responsible for compliance could void the user's authority to operate the equipment.

NOTE: This equipment has been tested and found to comply with the limits for a Class B digital device, pursuant to part 15 of the FCC Rules. These limits are designed to provide reasonable protection against harmful interference in a residential installation. This equipment generates uses and can radiate radio frequency energy and, if not installed and used in accordance with the instructions, may cause harmful interference to radio communications. However, there is no guarantee that interference will not occur in a particular installation. If this equipment does cause harmful interference to radio or television reception, which can be determined by turning the equipment off and on, the user is encouraged to try to correct the interference by one or more of the following measures:

- Reorient or relocate the receiving antenna.
- Increase the separation between the equipment and receiver.
- Connect the equipment into an outlet on a circuit different from that to which the receiver is connected.
- Consult the dealer or an experienced radio/TV technician for help.

Radiation Exposure Statement

This equipment complies with FCC radiation exposure limits set forth for an uncontrolled environment. This equipment should be installed and operated with minimum distance 20cm between the radiator and your body.



MADE IN CHINA