

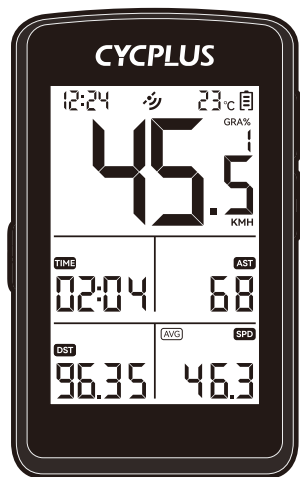

# GPS BIKE COMPUTER M3



User manual

【01 - 10】

用户手册

【11 - 20】

## GPS Location – Quick Start Guide

\* To receive satellite signals, please remain static and make sure your device is used in an open and unobstructed area.  
For a faster GPS fix, connect this device to the CYCPLUS Fit app and download the ephemeris data before riding.

- ❶ Long press [L button ►||] to power on.
- ❷ Acquiring a GPS signal after startup may take a few minutes.  
📶 appears to indicate the device is ready.
- ❸ Press [L button ►||] again to start recording.  
▶ appears when recording starts.
- ❹ Long press [R2 button ■] to save the recorded data.  
The 'SAVE' message will blink for 4 seconds. Once the ▶ or || icon disappears, the recording is successfully saved.
- ❺ Long press [L button ►||] to power off.

## Specifications

Name: GPS Bike Computer

Model: M3

Product Size: 88 × 52 × 20 mm

Screen Size: 2.8 inch LCD

Product Weight: 80 g

Memory Capacity: 150 hours

Battery: 1500 mAh 3.7 V

Battery Life: 100 hours

Charging Time: ≈ 2.5 hours

Charging Port: USB Type-C

APP Connection: BLE 5.0

Peripheral Connection: ANT+

Supported Peripherals: Speed sensor, Cadence sensor,  
Heart rate monitor, Powermeter.

Waterproof: IPX6 (Water-resistant, not submersible)

# About Buttons

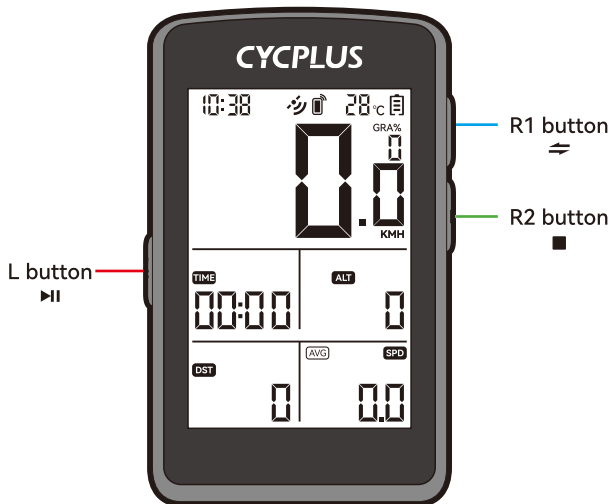

The button functions in normal use are as follows. Please refer to the setting instructions for button operations in the settings.

Button	Symbol	Operation	Function
L	▶	Long Press	Power On/Off
		Short Press	Start/Pause Recording
R1	⇐⇒	Long Press	Enter/Quit Settings
		Short Press	Go to Next Page
R2	■	Long Press	Save Record
		Short Press	—

# Data Display

- 1 This device has 4 data pages, which can be easily accessed by short pressing the R1 button.

The data displayed with the factory settings is as follows:

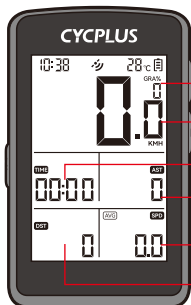

Current  
Gradient

Current  
Speed

Riding  
Time

Elevation  
Gain

Average  
Speed

Riding  
Distance

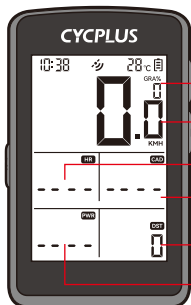

Current  
Gradient

Current  
Speed

Current  
Heart Rate

Current  
Cadence

Riding  
Distance

Current  
Power

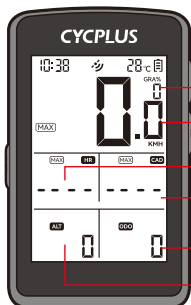

Current  
Gradient

Current  
Speed

Max  
Heart Rate

Max  
Cadence

Odograph

Elevation

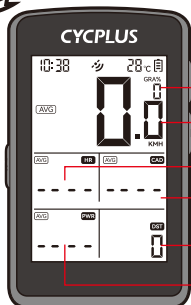

Average  
Gradient

Average  
Speed

Average  
Heart Rate

Average  
Cadence

Riding  
Distance

Current  
Power

- ② The upper section of the screen displays fixed data fields that cannot be customized. The display content on each page is as follow:

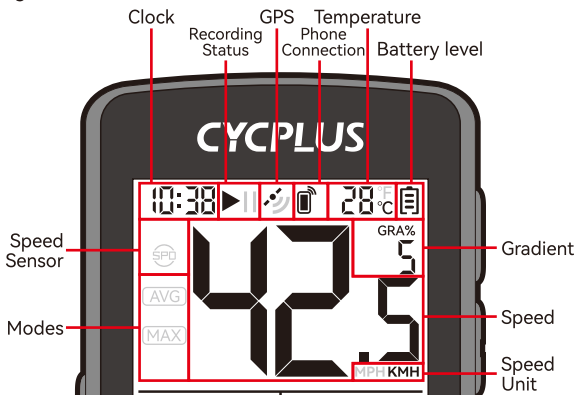

**Clock:** Displays the current time, with the option to set the time zone in the settings.

**Recording Status:** No symbol - No trip recording in progress.

▶ - Trip recording is active.

|| - Trip recording is paused.

Flashing || - Auto-pause is activated when stopped; recording resumes automatically upon movement.

**GPS:** ✖ - No GPS signal, 📶 - GPS is working properly.

**Phone Connection:** 📱 Indicates that the device is already connected to the phone.

**Temperature:** Display the current temperature, choose °C or °F in the settings.

**Speed Sencer:** 🚲 Indicates that the device is connected to a speed sensor, and the speed data comes from the speed sensor

**Modes:** No symbol - Speed and gradient data are shown as real-time values

AVG - Speed and gradient data are shown as average values

MAX - Speed and gradient data are shown as maximum values

**Speed Unit:** Choose between metric (KMH) or imperial (MPH) units in the settings. This will also affect distance and elevation gain/loss display.

- 3 Each page displays 4 customizable data fields in the lower half of the screen. You can customize these fields using the CYCPLUS Fit app.

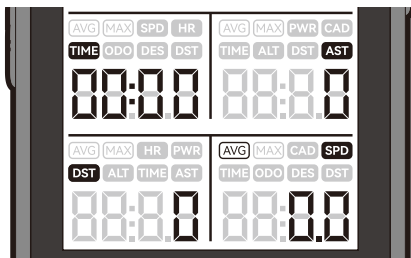

Customizable Data Fields

- TIME** Riding Time
- DST** Riding Distance
- ODO** Odograph
- SPD** Speed, shown in the same unit as your setting
- HR** Heart rate (requires heart rate monitor)
- PWR** Power (requires power meter)
- CAD** Cadence (requires cadence sensor)
- ALT** Elevation, always shown in meters
- AST** Elevation Gain
- DES** Elevation Loss
- AVG** Indicates average data.
- MAX** Indicates maximum data.

# About Settings

For quick setup, open the CYCPLUS Fit app to connect and configure the device. Or use buttons to set the device as follows:

Long press [R1 button ⇨] to enter settings.

Short press [R1 button ⇨] to cycle through 8 setting pages.



ANT+ Sensors



Wheel Circumference



Time Zone



Speed Unit



Temperature Unit



Factory Reset



Odograph



Unpair Sensors

Long press [R1 button ⇨] to return to the home page after finishing.

## ANT+ Sensors Connection

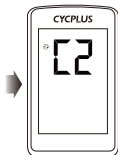

Press the L button to start searching for ANT+ sensors.

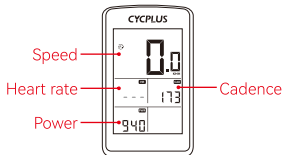

When the search starts, the device will check for four types of sensors: speed, heart rate, power, and cadence. If a sensor is detected, its data will be displayed. If no sensor is found, a horizontal line will appear in its place.



The device will return to the home page after 10 seconds.

## Unpair The Paired Sensors



Go to the C9 page in the settings menu. Press the L button to unpair all connected sensors.

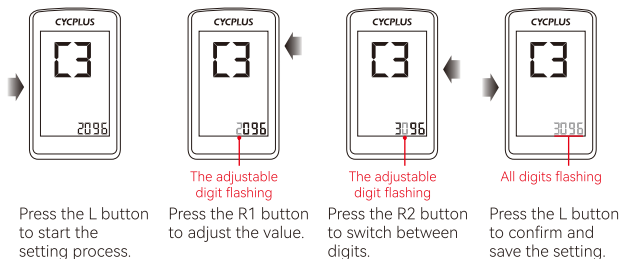

## Time Zone Setting

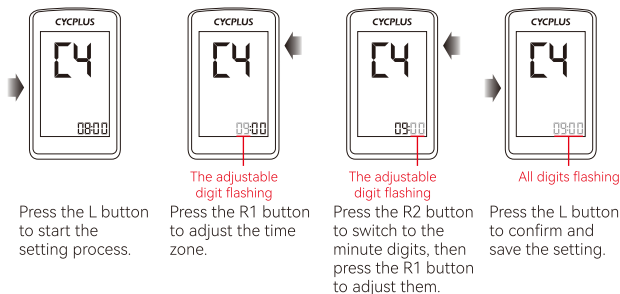

## Speed Unit Setting

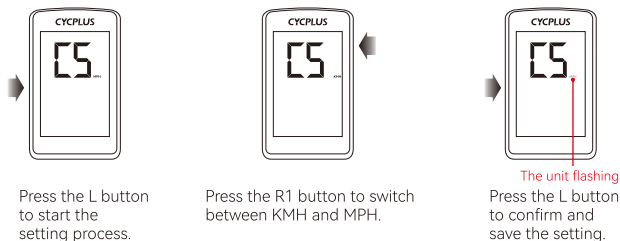



## Temperature Unit Setting



Press the L button to start the setting process.

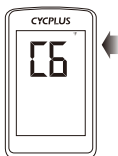

Press the R1 button to switch between °C or °F.



Temperature unit flashing  
Press the L button to confirm and save the setting.

## Factory Reset

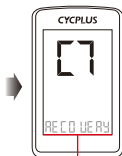

All digits flashing

Press the L button to start the setting process.

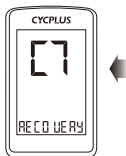

Press and hold the R2 button to restore factory settings, then the device will power off.

## Odograph Setting



All digits flashing

Press the L button to start the setting process.

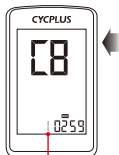

The adjustable digit flashing

Press the R1 button to adjust the value.

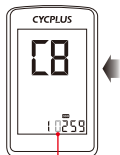

The adjustable digit flashing

Press the R2 button to switch between digits.



All digits flashing

Press the L button to confirm and save the setting.

## APP Connection

Download and use CYCPLUS Fit APP, which can help you to use this device more conveniently and provides additional services support.

Scan the QR code or search for "CYCPLUS Fit" on Google Play or the App Store to download the app



For iOS



For Android

## Notes

### ① Data recording:

Long press the L button to power on the device, then press the L button to start recording the trip.

Long press the R2 button to save the record after finished the ride. The device will save the current record when it shuts down.

### ② Memory: Once the memory is full, the device will overwrite previous records in chronological order.

### ③ Backlight:

After setting the time zone, the screen backlight will automatically turn on from 18:00 to 09:00 each day. When the button is pressed, the backlight will turn on and turn off after 10 seconds.

## Package List



GPS Bike Computer



Bike Computer Mount



Rubber Pad

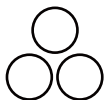

Rubber Band x 3



Charging Cable



User Manual

## About Installation

- ❶ CYCPLUS Z1/Z3 bike mount  
(Sold separately)

- ❷ Use the standard bike  
computer mount

Cross-fix the mount with  
rubber bands.

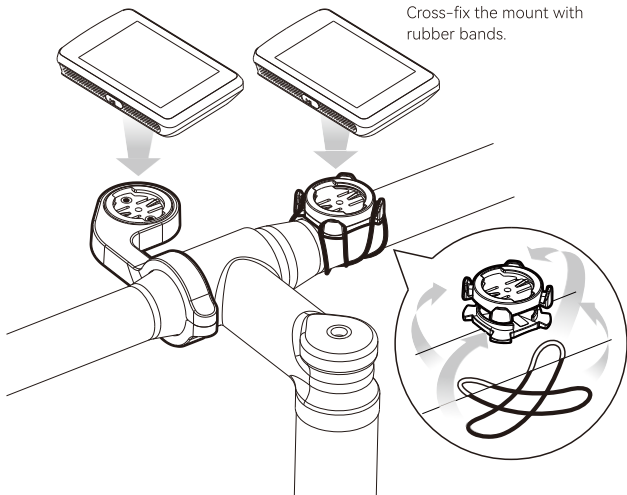

## Manufacturer Information

Company: Chengdu Chendian Intelligent Technology Co., Ltd.

Address: No. 88 Tianchen Road, Chengdu, Sichuan Province, China.

Warranty: Free repair or replacement within 2 years for non-user-induced damage.

Contact: [steven@cycplus.com](mailto:steven@cycplus.com)

## Tire Circumference Chart

Please use this chart for your reference. Tire size is shown on the side of a tire.  
Tire circumference may vary depending on tire pressure

ETRTO	Size	L(mm)	Inch
47-203	12x1.75	935	
54-203	12x1.95	940	12
40-254	14x1.50	1020	14
47-254	14x1.75	1055	
40-305	16x1.50	1185	
47-305	16x1.75	1195	16
54-305	16x2.00	1245	
28-349	16x1-1/8	1290	
37-349	16x1-3/8	1300	
32-369	17x1-1/4(369)	1340	
40-355	18x1.50	1340	
47-355	18x1.75	1350	18
32-406	20x1.25	1450	
35-406	20x1.35	1460	
40-406	20x1.50	1490	
47-406	20x1.75	1515	
50-406	20x1.95	1565	
28-451	20x1-1/8	1545	
37-451	20x1-3/8	1615	20
37-501	22x1-3/8	1770	22
40-501	22x1-1/2	1785	
47-507	24x1.75	1890	24
50-507	24x2.00	1925	
54-507	24x2.125	1965	
25-520	24x1(520)	1753	
	24x3/4 Tubular	1785	
28-540	24x1-1/8	1795	
32-540	24x1-1/4	1905	
25-559	26x1(559)	1913	
32-559	26x1.25	1950	
37-559	26x1.40	2005	
40-559	26x1.50	2010	
47-559	26x1.75	2023	
50-559	26x1.95	2050	
54-559	26x2.10	2068	
57-559	26x2.125	2070	
58-559	26x2.35	2083	
75-559	26x3.00	2170	

ETRTO	Size	L(mm)	Inch
28-590	26x1-1/8	1970	
37-590	26x1-3/8	2068	
37-584	26x1-1/2	2100	26
	650C Tubular 26x7/8	1920	
20-571	650x20C	1938	
23-571	650x23C	1944	
25-571	650x25C 26x1(571)	1952	
40-590	650x38A	2125	
40-584	650x38B	2105	
25-630	27x1(630)	2145	
28-630	27x1-1/8	2155	27
32-630	27x1-1/4	2161	
37-630	27x1-3/8	2169	
40-584	27.5x1.50	2079	
50-584	27.5x1.95	2090	
54-584	27.5x2.1	2148	27.5
57-584	27.5x2.25	2182	
18-622	700x18C	2070	
19-622	700x19C	2080	
20-622	700x20C	2086	
23-622	700x23C	2096	
25-622	700x25C	2105	
28-622	700x28C	2136	
30-622	700x30C	2146	
32-622	700x32C	2155	
	700C Tubular	2130	700C
35-622	700x35C	2168	
38-622	700x38C	2180	
40-622	700x40C	2200	
42-622	700x42C	2224	
44-622	700x44C	2235	
45-622	700x45C	2242	
47-622	700x47C	2268	
54-622	29x2.1	2288	29
56-622	29x2.2	2298	
60-622	29x2.3	2326	

## FCC Warning

This device complies with part 15 of the FCC Rules. Operation is subject to the following two conditions: (1) This device may not cause harmful interference, and (2) this device must accept any interference received, including interference that may cause undesired operation.

Any Changes or modifications not expressly approved by the party responsible for compliance could void the user's authority to operate the equipment.

**Note:** This equipment has been tested and found to comply with the limits for a Class B digital device, pursuant to part 15 of the FCC Rules. These limits are designed to provide reasonable protection against harmful interference in a residential installation. This equipment generates uses and can radiate radio frequency energy and, if not installed and used in accordance with the instructions, may cause harmful interference to radio communications. However, there is no guarantee that interference will not occur in a particular installation. If this equipment does cause harmful interference to radio or television reception, which can be determined by turning the equipment off and on, the user is encouraged to try to correct the interference by one or more of the following measures:

- Reorient or relocate the receiving antenna.
- Increase the separation between the equipment and receiver.
- Connect the equipment into an outlet on a circuit different from that to which the receiver is connected.
- Consult the dealer or an experienced radio/TV technician for help.

The device has been evaluated to meet general RF exposure requirement. The device can be used in portable exposure condition without restriction.

# CYCPLUS



FR

Cet appareil,  
ses accessoires,  
et batterie  
se recyclent

À DÉPOSER  
EN MAGASIN



À DÉPOSER  
EN DÉCHÈTERIE



OU

Points de collecte sur [www.quefairedemesdechets.fr](http://www.quefairedemesdechets.fr)  
Privilégiez la réparation ou le don de votre appareil !



Made in China