

# User Manual

## Venterior Wireless Fish Finder



Model Number: VT-FF005  
Country of origin: China

Brand Name: Venterior

# Contents

Introduction to the Fish Finder .....	1
How to Use the Sonar Sensor .....	3
Setting of the Handheld Host .....	6
Storage of the Fish Finder .....	12
Product Specification .....	12
Frequently Asked Questions .....	13
Warranty and After-sale Support .....	17
Compliance .....	17

# Introduction to the Fish Finder

## 1. What's in the Box

Please check if the following product and accessories are in the box before using this product. Write to [venerior@yahoo.com](mailto:venerior@yahoo.com) if anything is missing or broken.

- A sonar sensor
- A handheld host
- A charging cord for sonar sensor
- A charging cord for handheld host
- A Neck strap
- A copy of user manual

## 2. Fish finder display



## 3. Charge the fish finder

- 1) There are 2 charging cords in the package, the Micro USB for the host and the DC for the sonar sensor.
- 2) When the battery indicator icon on the screen flashes, please stop using the fish finder and charge the fish finder.
- 3) When the host is charging, the indicator light is red. It will turn green if the host is fully charged. When the sensor is charging, the indicator light is red. It will turn off if the sensor is fully charged.
- 4) When the sensor is out of water, it is off and will NOT connect with the host. If you would like to check the sensor's battery status from the screen, you need to put the sensor in water first.

**Note:** Please use 5V USB charger (not included). The cover of the sensor should be removed when charging, and should NOT be removed when working.

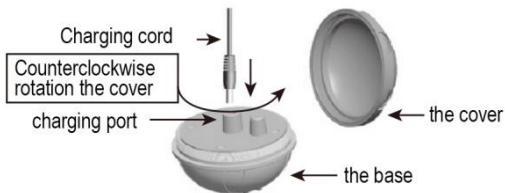
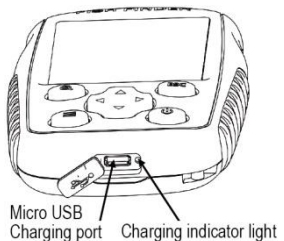

## 4. Attentions

- 1) The host is not waterproof. If water splashes on the host, please dry it immediately.
- 2) The sensor is supposed to float on water when working. Please don't drag it into water bottom, or submerge and hold the whole sensor under water.
- 3) Its reading might be interfered with other high power sonar device close to your sonar sensor.
- 4) If water wave is too strong, please protect the sensor from crashing into rock. Otherwise it will cause irreparable damage to the sensor.
- 5) The fish finder will only operate properly in open water that is deeper than 2.6 feet.

## How to Use the Sonar Sensor

### 1. How the sonar fish finder works

- 1) The system uses sonar to locate and define structure, bottom contour, and depth directly below the sensor. It transmits sound pulse from the sensor, and then measures the time it takes for the echoes to return to the sensor. Different objects in water echo the pulse at a



different intensity. The built-in computer then organizes all of this information and shows it on the display screen.

2) Sonar usually determines there is fish when it detects the air in fish swim bladders. That is also why the small bubbles in water might affect the fish finder's performance.

3) The first column of fish indicators on the right of the screen shows the most current information. This icon is then moved to the left as a new reading is displayed. This motion in no way reflects actual movement of the fish.

## 2. Sonar sensor

### 1) How to turn on the sensor

There are 2 pins on the sonar bottom, which are the automatic switch of the sensor. The sensor will turn on only when you toss it in water.

**Note:** Please dry water on the sensor after it is out of water. Otherwise the sensor might keep working.

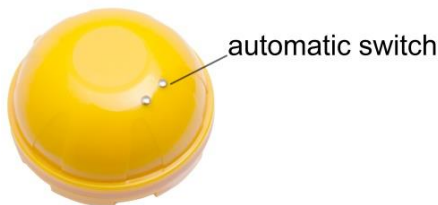

## 2) How to use the sensor

There are 2 small holes on the sensor. Tether the sensor with fishing line (not included) and toss it into water. You can use a rod to guide the sensor to a fix spot or use a remote-controlled boat to send the sensor to the fishing spot.



Small Holes to Tether  
with Fishing Line

## 3. Application methods

1) Toss the sensor into water, drag it at a very slowly and stable speed. It will display information of water under the sensor, including water depth, bottom contour, and fish location.

2) Toss the sensor into water, guide it to a desirable position and let it undisturbed. It will float on water and monitor submarine news in a real-time method. Information will be automatically updated on the screen once fish enter the sensor detection range.

# Setting of the Handheld Host

## 1. Keys on the host/display unit



**Power Key** --- Press and hold the power key for 2 seconds, the display unit will power on. The display unit starts working. Press and hold the power key for 3 seconds, the display unit will power off.

**Menu Key** --- Press this key to enter menu setting. There are 3 menu pages: Sonar, Setup, and Senior. Press Menu Key to enter “Sonar” menu, press the Menu Key again, to enter the next menu page “Setup”, and press Menu Key once again, to enter the 3rd menu page “Senior”.

**Exit Key** --- Press this key to exit menu or preference setting

**Zoom Key** --- Press this key to magnify the image display.

**Direction Key** --- Press the direction key to select and adjust the preference you would like to set.



## 2. Feature Setup (Preference Setting)

There 3 setting/menu pages (Sonar, Setup, and Senior).

Press Menu Key to enter and switch setting page.

Sonar	Setup	Senior
Sensitivity	◀ 100% ▶	
Depth Range	◀ AUTO ▶	
Noise Filter	◀ OFF ▶	
Fish Depth	◀ ON ▶	
Fish Symbols	◀ ON ▶	

Sonar	Setup	Senior
Units	◀ Ft / °F ▶	
Chart Speed	◀ 100% ▶	
Backlight	◀ 50% ▶	
Fish Alarm	◀ ON ▶	
Depth Alarm	◀ OFF ▶	

Sonar	Setup	Senior
Background	◀ White ▶	
Volume	◀ High ▶	
Simulator	◀ OFF ▶	
Language	◀ English ▶	
Restore factory settings	◀ NO ▶	

### 1) Sensitivity

There are 20 levels of sensitivity setting for user to choose from. It greatly depends on the clarity and depth of the water. Very clear water allows for a moderate sensitivity setting. Conversely, dirty water requires a higher sensitivity setting to target detail but will increase the irritating false readings. Targeting fish in deep water generally requires higher sensitivity, especially in dirty water. Otherwise, the sensitivity can be lowered in shallow water. Salt and brackish water also require a comparatively higher sensitivity setting. As the sensitivity is enhanced, smaller details show on the screen (but trash & debris might be detected as fish).

**Operation guide:**

Press **Menu Key** to enter “Sonar” menu. Press up/down Direction Key to select the “Sensitivity”. When “Sensitivity” is selected, press left/right Direction Key to adjust the value (5% - 100%) of this feature.

Press up/down direction key to select other feature setting or press “ECS” to exit feature setting.

## **2) Depth Range**

This feature has 7 depth ranges (10 Ft, 20 Ft, 30 Ft, 60 Ft, 120 Ft, 164 Ft, AUTO). Depth range setting is used to adjust the bottom display width. For example, the actual water depth is 10 Ft, and the depth range is 20 Ft, the display width of the bottom will be 50% of the screen. User can adjust the depth range according to the actual water depth. Recommended depth range is set to be larger than and closest to the actual depth of water, in order to obtain the best display. Or it can be set to be AUTO.

## **3) Noise Filter**

Noise Filter Setting is used for filtering sonar noise. The fish finder has 4 Noise Filtering levels (off, low, medium, high) for user to choose from.

## **4) Fish Depth**

Fish depth will display above the fish icon when this feature is turned on. Otherwise it will only display the fish icon when fish is detected.

## 5) Fish Symbols

When this feature is on, fish icon will display on the screen if fish is detected. Otherwise it will not display any fish icon even fish is detected.

## 6) Units

Units of measure for depth and temperature can be set as M/°C or Ft/°F.

### Operation guide:

Press **Menu Key** to enter “Sonar” menu. Press **Menu Key** again to enter the next menu page “Setup”. Press up/down Direction Key to select the “Units”. When “Units” is selected, press left/right Direction Key to adjust the value (M/°C or Ft/°F) of this feature.

## 7) Chart Speed

The fish finder has ten levels (10-100%) of chart speed for the user to choose from. 10% chart speed is the slowest while the 100% is the fastest.

## **8) Backlight**

Setting the backlight to be highest will greatly reduce the battery life. It is suggested to adjust the backlight at a proper number.

## **9) Fish Alarm**

An alarm sounds when a group of fish is detected. The alarm feature can be turn off if you prefer quiet fishing.

## **10) Depth Alarm**

The depth alarm can be turned off or range from 7Ft/2M to 164Ft/50M. When the detected water depth is equal or less than setting value of depth alarm, it will alarm.

This feature is mainly used for ships. Users can set a depth alarm value according to actual needs to avoid hitting rocks. It is also a great function for sea fishing users looking for reefs. It helps to find good fishing spots.

## **11) Background**

There are 2 Background modes available --- Black or White. The default setting of background is Black. Please change the background to white in bright sunlight. White background will make the readout more visible.

## **Operation guide:**

Press **Menu Key** 3 times to enter “Senior” menu. Press up/down Direction Key to select the “Background”.

## **12) Volume**

There are 4 volume levels for users to choose from --- off, low, medium, high. Select the proper volume level according to the fishing environment.

## **13) Simulator**

Simulator mode helps beginner to learn readings on the display quickly.

### **Operation guide:**

When “Simulator” is selected, press left/right Direction Key to change the value (on/off) of this feature. Press “ECS” to exit feature setting, the device is now in Simulator mode.

## **14) Language**

The language is available in both English and Russian.

## **15) Restore factory setting**

This feature allows you to restore factory setting quickly. When “Restore factory setting” is selected, press left/right Direction Key to change the value (yes/no) of this feature.

Once “yes” is selected, the device will restore factory setting.

## Storage of the Fish Finder

1. Clean the sensor with fresh water and dry off. Do not submerge or spray the screen with water.
2. Keep the sensor and the display unit in dry condition after use. Don't place them in wet condition. Don't place the sensor in metal container.
3. Never leave the fish finder in temperatures over 113° Fahrenheit (45° Celsius) as the extreme temperatures can damage the electronic components.
4. Keep the unit in temperatures above 14° Fahrenheit (-10° Celsius).

**Note:** Please leave sensor in air for a few days if there is water in the sensor.

## Product Specification

### 1. Display

Display Size: 2.6 inches

Display resolution: 240\*320

Backlight: LED backlight

### 2. Sonar & Radio

Depth Range: 2.6-164Ft/0.8-50M

Maximum Wireless Distance Range: 262Ft/80M

Sonar Beam Angle: 105 degree

Operational Temperature: 14°F to 113°F(-10°C to 45°C)

### **3. Power Supply**

Display unit: Built in Polymer battery 3.7V

Sensor: Built in Polymer battery 3.7V

## **Frequently Asked Questions**

### **1. It will not power on**

Press and hold the power key for 2 seconds to turn on the display unit. If the display unit does not turn on under properly operation, please send your order number and fish finder issue to ***venterior@yahoo.com*** for help.

### **2. Depth reading is “—” or incorrect**

1) Ship motor or other high power sonar fish finder close to the fish finder will interfere with the fish finder's sonar and cause incorrect reading.

2) Oil, dirt would adhere to the surface of the sensor and will affect the sonar sensor's performance. Please make sure

the surface of the sensor is clean.

3) Please make sure the water is within the depth range of 2.6Ft/0.8M to 164Ft/50M.

4) Suspended matter, muddy water, or extremely heavy vegetation may also confuse the sonar and cause misreading of depth.

5) Please make sure the sonar is not out of power and floats on water in peace. If water wave is too strong, the depth reading might be incorrect.

6) Please make sure the sensor is vertically downward.

7) Please make sure the temperature is above  $-10^{\circ}\text{C}/14^{\circ}\text{F}$ .

8) When fishing on ice or “shooting-through” the hull of a boat, depth reading might be unstable or displays as “---” if there is bubble under the sonar. Sonar will not travel through air. So the smallest air bubble between the sensor and the water will cause the unit to operate incorrectly.

### **3. It shows fish / It is not working in my pool**

The fish finder will NOT function properly in a bath tub, swimming pool, bucket, or any body of water that has hard sides. It must be used in an open body of water to function properly.

### **4. Is the display waterproof?**



The display is not waterproof. Do NOT submerge or spray the fish finder screen with water.

### **5. How long is the battery duration (fully charged)?**

It depends on the backlight level you set. It usually lasts about 4-6 hours in continuous use. Reduce the backlight level to extend battery life.

### **6. There are fish in water, but the fish finder shows nothing.**

The fish finder can only detect fish in detectable area (105 degrees beam angle under the sensor). And the fish finder will not detect any objects that are closer than 2 feet from the sensor. It is the blind area of sonar. If you're fishing in water that is less than 3 feet deep, it is recommended to discontinue use of the fish finder. Besides that, the fish finder might not be able to distinguish fish from weeds if fish swimming too close to the water bottom.

### **7. False fish indications**

Tall weed may cause false fish indications. If weeds grow taller than 50% of the total water depth, the sonar will mistake it for fish. Trash & debris may also result in false fish indications. Adjusting the sensitivity setting to the lowest

level may reduce these false readings, but if they do not go away, it is suggested that you discontinue use of the fish finder under these conditions.

### **8. Will it work for ice fishing?**

It can work for ice fishing. It is suggested to drill hole on ice and put the sensor into the water.

### **9. How far do you cast it out?**

The maximum wireless distance range is about 262Ft/80M.

### **10. Does it show the size of fish?**

It displays fish symbol by 3 different fish sizes --- small, medium, big.

### **11. How to make it more visible in bright sunlight?**

The default setting of background is Black. Please change the background to white in bright sunlight. White background will make the readout more visible.

### **12. Can this be mounted to the boat?**

There are 2 holes in the sensor for you to tether with fishing line. You can mount it to your boat. Please make sure it is

floating vertically downward.

## Warranty and After-sale Support

### 1. Warranty

This fish finder is eligible for a 2-year warranty. To get a 2-year warranty for your fish finder, please register your product on our brand website *www.venterior.com*, or just send your order number to **venterior@yahoo.com** directly (we will register it in our system for you).

### 2. After-sale Support

If there is any issue with your fish finder or you would like to get any of our technical support, please feel free to write to **venterior@yahoo.com**. We are always happy to assist you.

## Compliance

### FCC Statement

This device complies with Part 15 of the FCC Rules. Operation is subject to the following two conditions: (1) this device may not cause harmful interference, and (2) this

device must accept any interference received, including interference that may cause undesired operation.

**CAUTION: Modification or changes to this equipment not expressly approved by Radio Systems Corporation may void the user's authority to operate the equipment.**

**NOTE:** This equipment has been tested and found to comply with the limits for a Class B digital device, pursuant to part 15 of the FCC Rules. These limits are designed to provide reasonable protection against harmful interference in a residential installation. This equipment generates, uses, and can radiate radio frequency energy and, if not installed and used in accordance with the instructions, may cause harmful interference to radio communications. However, there is no guarantee that interference will not occur in a specific installation. If interference does occur to radio or television reception, which can be determined by turning the equipment off and on, the user is encouraged to try to correct the interference by one or more of the following measures:

- Reorient or relocate the receiving antenna.
- Increase the separation between the equipment and the receiver.

- Connect the equipment to an outlet on a circuit different from that to which the receiver is connected.
- Consult customer care, the dealer, or an experienced radio/TV technician for help.