

成型尺寸：78x135mm

印刷颜色：4色

成型方式：风琴折页

78mm

135mm

TESSAN

Smart Wall Outlet Extender

User Manual

Model:TS-WM106S

Thank you for purchasing TESSAN Power Strip, please read this instruction manual carefully and keep it for future use.

OVERVIEW

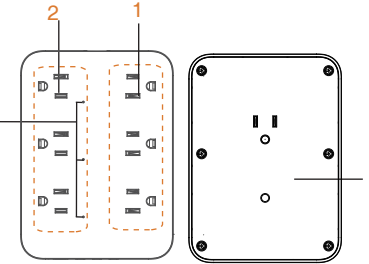

FEATURES

1. 3 Always-on Outlets - Controlled only by the master switch. If the master switch is on, these outlets are on. If the master switch is off, these outlets are off.
2. 3 Smart Control Outlets - 3 independently controlled smart outlets works with Alexa or Google Assistant for Voice Control, Remote Control Your Home appliances from Anywhere. NOTE: Please make sure you have 2.4G WiFi before buying, this product does not support 5G wifi network and not work with encrypted WiFi networks, or open end public networks with no password.
3. 3 USB Charging Ports - Intelligently detect and charge at ideal output. Perfect for camera, smartphone, tablet, bluetooth speaker, power bank and etc. Does not support Qualcomm Quick Charge.
4. ON/OFF Switch - Controls the AC outlets and USB ports all together. The built-in circuit breaker will trip off automatically to protect your devices from overload and over-current.
5. WiFi LED Indicator -Power ON/Wi-Fi connected Constant in green, Pairing Mode Blinks Quickly in green.
6. Smart Outlets LED Indicator - Light on indicates the presence of power; there is an LED next to each controllable outlet to indicate whether or not it's powered.
7. Fireproof Shell - Made of ABS plastic and PC 94V0 making it fireproof of up to 1382 °F. The insulating material can protect you from electric shock.

NOTE: Before installing Smart Life App, please check your home network setting as following:

1. Check your home routers or related: please use 2.4G Wi-Fi network. Recommend set your 2.4G network and 5G network different names.
2. Your phone is connected with your home 2.4G Wi-Fi network.
3. To stay strong Wi-Fi connection, please keep smart device close to router.
4. Whether connected devices have reached the maximum number of router connections, If so, remove the device from the filter list and make sure that router is not prohibiting device from connection.
5. Please use English and numbers to name your Wi-Fi router. Otherwise the Smart Device may not recognize it when you try to add it into Smart Life.

- STEP 1
How to Download Smart Life App
1. Scan the QR code to download and install Smart Life app for iOS or Android phone.
 2. If you cannot download Smart Life app, please search "Smart Life" on Google Play (for Android phone) or Apple Store (for iOS phone) to download.



- STEP 2
How to Sign Up an Account
- You will need to sign up for an account after downloading the app. There are two ways to sign up for an account, using your cell phone number or your email address. Select the country you living in, and enter your cell phone number or email whichever makes you feel comfortable.

- STEP 3
How to Add a Device via Quick Connection
1. Open the Smart Life app and click the button "+" at the top right corner to add device.
 2. Plug your Smart Plug into an electrical outlet. Make sure your smart phone is connected with your home 2.4G Wi-Fi network. The LED night light on the Smart Plug will flash warm green light 3 times per second when it is ready to pair. Confirm indicator rapidly blink" to add your Smart Plug.

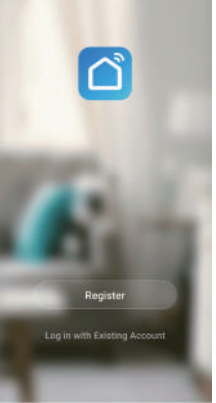

- STEP 3
How to Add a Device via Quick Connection
1. Open the Smart Life app and click the button "+" at the top right corner to add device.
 2. Plug your Smart Plug into an electrical outlet. Make sure your smart phone is connected with your home 2.4G Wi-Fi network. The LED night light on the Smart Plug will flash warm green light 3 times per second when it is ready to pair. Confirm indicator rapidly blink" to add your Smart Plug.

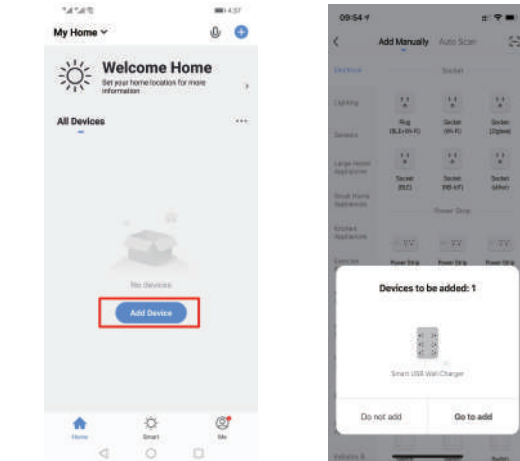

- STEP 3
How to Add a Device via Quick Connection
1. Open the Smart Life app and click the button "+" at the top right corner to add device.
 2. Plug your Smart Plug into an electrical outlet. Make sure your smart phone is connected with your home 2.4G Wi-Fi network. The LED night light on the Smart Plug will flash warm green light 3 times per second when it is ready to pair. Confirm indicator rapidly blink" to add your Smart Plug.



- STEP 3
How to Add a Device via Quick Connection
1. Open the Smart Life app and click the button "+" at the top right corner to add device.
 2. Plug your Smart Plug into an electrical outlet. Make sure your smart phone is connected with your home 2.4G Wi-Fi network. The LED night light on the Smart Plug will flash warm green light 3 times per second when it is ready to pair. Confirm indicator rapidly blink" to add your Smart Plug.

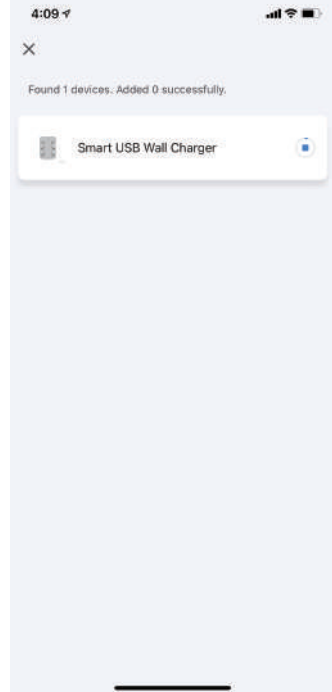

FCC Caution.

- (1) § 15.19 Labeling requirements.
This device complies with part 15 of the FCC Rules. Operation is subject to the following two conditions: (1) This device may not cause harmful interference, and (2) this device must accept any interference received, including interference that may cause undesired operation.
- § 15.21 Changes or modification warning
Any Changes or modifications not expressly approved by the party responsible for compliance could void the user's authority to operate the equipment.
- § 15.105 Information to the user.
Note: This equipment has been tested and found to comply with the limits for a Class B digital device, pursuant to part 15 of the FCC Rules. These limits are designed to provide reasonable protection against harmful interference in a residential installation. This equipment generates uses and can radiate radio frequency energy and, if not installed and used in accordance with the instructions, may cause harmful interference to radio communications. However, there is no guarantee that interference will not occur in a particular installation. If this equipment does cause harmful interference to radio or television reception, which can be determined by turning the equipment off and on, the user is encouraged to try to correct the interference by one or more of the following measures:
-Reorient or relocate the receiving antenna.
-Increase the separation between the equipment and receiver.
-Connect the equipment into an outlet on a circuit different from that to which the receiver is connected.
-Consult the dealer or an experienced radio/TV technician for help.

RF warning for Mobile device:
This equipment complies with FCC radiation exposure limits set forth for an uncontrolled environment. This equipment should be installed and operated with minimum distance 20cm between the radiator & your body.

5. After successfully connecting, you can modify the Smart Plug's name.

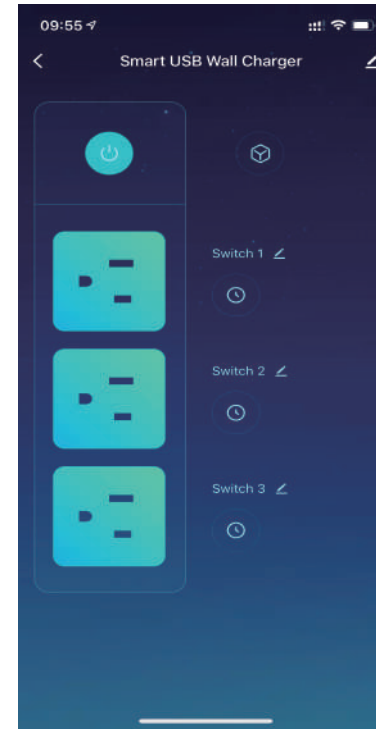

FAQ

1. If you cannot add your Smart Device - please check:
1) Whether the Smart Device is powered on.
2) Whether the phone is connected with 2.4GHz Wi-Fi network.
3) Whether the Smart Device is ready for configuration.
To get it ready before configuration, if the LED night light flashes warm green light 3 times per second (rapidly blink) , it means that it is ready for configuration.
- 4) Please check routers or related: if your router is dual-band, please select 2.4GHz Wi-Fi network to connect your phone and Smart Plug.
- 5) Setting up Wi-Fi router: setting encryption method as WPA2-PSK and authorization type as AES, or set both as auto. Wireless mode cannot be 11n only.
- 6) Please use English and numbers to name your Wi-Fi router. Otherwise our Smart Plug may not recognize it when you try to add it into Smart Life.
- 7) To stay strong Wi-Fi connection, please keep smart device close to router.
- 8) Whether connected devices have reached the maximum number of router's connections. If so, please turn off some devices connected to the router and try again.
- 9) How to reconnect the device? You can remove the device on the mobile APP, wait for the distribution network to flicker, and then reconnect to WiFi.
- 10) Do the three wifi sockets have power-off memory?
After operating the wifi socket for 5 seconds, the corresponding socket will automatically remember the last power-off state.

Getting to know "Smart Life" APP

1. Add Smart Devices
You can add listed smart devices by tap the "+" at the top right at this page.
2. Switches
Switches allow you to turn ON/OFF your Smart Device anywhere, as long as your phone is connected to your home network or communication network.
3. Schedule the smart device to automatically power ON/OFF as desired.

How to connect it to Alexa or Google Assistant

1. Link "Smart Life" to Alexa or Google Assistant
Go to Smart Life "More" More for instructions to link Alexa or Google Assistant.
Note: Please log in with your Smart Life account.

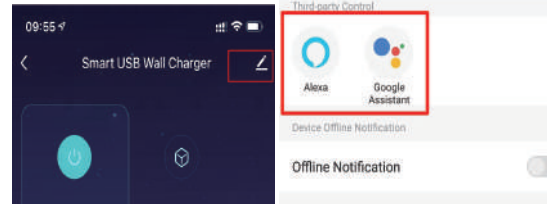

2. Key Steps to Link the Alexa Skill

1. Click the Alexa icon, sign in to your Amazon account, and open the "Alexa Skills" link from the "Echo & Alexa" Menu.
2. Search for the "Smart Life", and tap "Enable".
3. Enter your "Smart Life" APP Account and Password, then tap "Link Now" to enable the Skill.

WARNINGS

1. Water & Moisture - To reduce the risk of fire or electric shock, do not use it in a humid environment.
2. Ventilation - This power strip should always be located in such a way that it maintains proper ventilation. Do not cover it with anything to prevent overheating.
3. Periods Of Non-use - Make sure to unplug the power strip when it is not expected to be used for several months.
4. Power Rated for 1875W - The equipment plugged into the surge protector must not exceed 1875W, especially high power devices, such as air conditioners, refrigerators and hair dryers. Please check their power before using.
5. Voltage - This power strip supports 100-250V input, but does not convert voltage. If your power source is 220V, please make sure your appliances can work under 220V.
6. Modifications - Do not disassemble or modify it by yourself. Changes or modifications are not approved by the manufacturer and could void the product warranty.

SPECIFICATION

Smart Wall Outlet Extender	
Model:	TS-WM106S
Rated Power:	1875W-15A MAX. 125V~
USB Output:	5V=3A (2.4A Max Per Port)
Total DC Output:	15W

WARRANTY

TESSAN warrants all products to be of the highest quality in material, craftsmanship and service for 18 months from the date of purchase.
We will replace any product found to be defective due to manufacturer flaws based on eligibility. Refunds are available within the first 30 days after purchase.

SUPPORT

If you have any issues with your product or to quickly help resolve any other issue you're experiencing, for purchases made through TESSAN's authorized resellers, please contact them directly. For purchases made through TESSAN's online store, please contact the store directly.



MADE IN CHINA