

MTB-CUT M188智能膜切机

使用说明书

产品清单

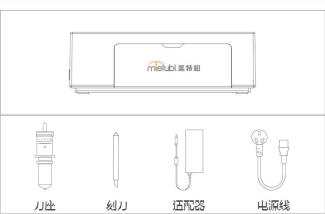

外观及功能

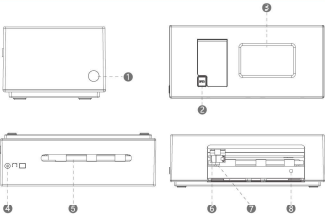

- ①电源线：启动设备
- ②储物盒开关：存放刀座、刻刀
- ③操作显示屏：多国语言
- ④电源接口
- ⑤压纸轴：固定膜纸
- ⑥刀座夹：固定刀座
- ⑦刀头：切割膜纸
- ⑧传感器：自动感应进膜

- ⑨顶针更换刀针时按压，取出需要更换的刀针。
- ⑩刀针调节旋钮，调节档位控制刀头的长度“+”符号方向可调长刀“-”符号方向为缩短刀头。
- ⑪刀柄底座：旋紧刀头卡位以锁定刀柄。
- ⑫刀尖：根据材料厚度调整露出长度。

使用说明

一、电源连接、开机

将电源线与适配器连接，电源线一端接入电源插座，将适配器电源线一端接入设备膜切机电源接口，将刀头安装至拆卸膜纸的刀架卡位上，确保固定。

连接完毕后，按下【电源键】启动设备。

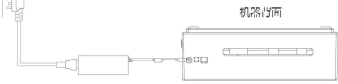

二、安装膜切机刀头

- ①先打开储物盒开关。
- ②打开刀座夹的刀片，调整好刀尖长度后，垂直放入刀头（建议刀头档位5档）。
- ③拨回刀片，固定刀头。
- ④盖好储物盒。

三、放置材料

- ①准备一张待裁切的保护膜，确认保护膜平整且膜层无气泡、折痕或缺层现象。
- ②放置膜片至所示区域。
- ③机器会自动感应收入膜纸。
- ④如需要更换其他膜纸，可按一下电源键退出膜纸。

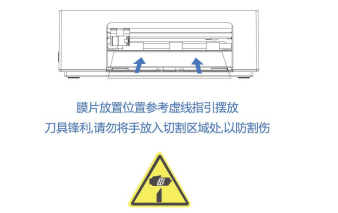

膜片放置位置参考虚线指引摆放
刀具锋利,请勿将手放入切割区域处,以防划伤

四、WiFi设置

在首页点击【设置键】，进入设置界面，点击【WiFi设置】，连接WiFi并输入密码，等待机器成功连接WiFi网络。



五、开始切割

在主页选择您需要切割的手机品牌、型号。点击【开始切割】

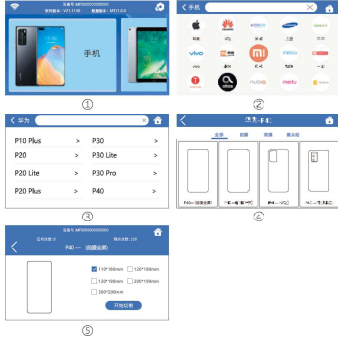

六、切割完成

膜纸切割完成后，等待设备报警，即可取出膜纸。



机器设置

一、语言切换

在首页，点击【设置键】，进入设置界面，点击【语言设置】图标即可。



二、刀压/速度/感应设置

在首页，点击【设置键】，进入设置界面，点击【刀压/速度/感应】图标，根据实际情况进行调节。



三、固件系统升级/数据更新

在首页，点击【设置键】，进入设置界面，点击【版本更新】，进入更新界面，1212，等待升级完成。

在首页，点击【设置键】，进入设置界面，点击【重置】，等待重置后，数据即可成功。



产品参数

型号	M188
最大进纸尺寸	200mm
最大切割尺寸	195mm
切割精度	0.1mm
重复精度	0.1mm
最大直线切割速度	250mm/s
最大曲线切割速度	200mm/s
最大切割压力	9.8N
通讯方式	WiFi 2.4G
工作电压	110V-240V
功率	<100W
工作环境温度	-5°C ~ +35°C
包装外箱尺寸	387.5*183.5*128.5mm
包装外箱重量	6.6kg
净重	4.7kg

注意事项

不可用手触摸刀片尖端，以免手指受伤并导致刀片钝化。
在雷雨闪电天气禁止使用，以免雷电击穿机器。
机内不可渗入液体、灰尘、金属碎片等。这些物体会导致火灾。
不可拔下或随意更改电源线接线，不可使电源线短路或过载，避免引起火灾。此设备使用变压器，导致电压波动。

保修卡

产品名称		设备编号	
出厂编号			
生产厂家		地址	
销售		电话	
购买日期		发票号码	
代理人			

保修说明

日期	保修情况	处理经过	接收人	修理人

保修说明
①本保修卡适用于本产品，以作保修凭证；
②保修期限为自产品出厂之日起一年，如有损坏，
③保修设备必须非人为损坏，天经非本公司授权人员修理。

MTB-CUT M188 Protector Film Cutter

User manual

Standard Accessories

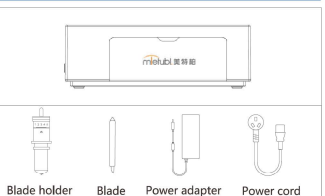

Appearance and function

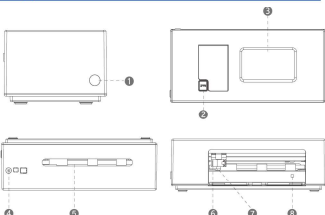

- ①Power button: Turn on the device
- ②Storage box switch: store blade holders, blades
- ③LCD Screen
- ④Power connector
- ⑤Axis: Fix the protector sheet film
- ⑥Blade holder clamp: fixed blade holder
- ⑦Blade holder: Cutting protector sheet film
- ⑧Sensor: Auto feed sheet film

- ⑨ Press the top to replace the blade.
- ⑩ Blade adjustment: Rotate to adjust gear to control the length of the blade tip.
- ⑪ Blade holder
- ⑫ Blade tip: Adjust the exposure length according to the material thickness.
“+” direction means to lengthen blade tip;
“-” direction means to shorten blade tip.

Instructions

1、Power on

- ①Connect the power supply with the adaptor and insert to the socket. Use 100-240V AC power supply to make the device operate normally.
- ②Insert the other end of the adaptor port into the power interface.
- ③Press the power button to power on the cutter.



2、Install the blade holder & blade

- ①Open the storage box
- ②Pull the paddle of holder clamp, adjust the length of the blade tip, and put the blade holder inside (Gear 5 for the blade holder is recommended).
- ③Push back the paddle and fix the blade holder.
- ④Cover the storage box.

3、Place materials

- ①Prepare a sheet film to be cut, confirm that the protective film is flat and the film layer is complete without bending, folding or missing layers
- ②Place the sheet film to the area shown.
- ③The machine will automatically pick up the film paper.
- ④If need to exchange another sheet film, please click the power on button, the protector film will feed out.

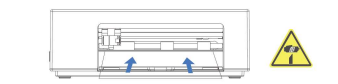

Refer to the dotted line for the placement of sheet film
Do not put your hands in the cutting area in case of harm

4、WiFi Setting

Click [Setting] on the homepage, enter the setting interface, click [WiFi Settings], connect to WiFi, enter the password, and wait for the machine to successfully connect to the WiFi network.

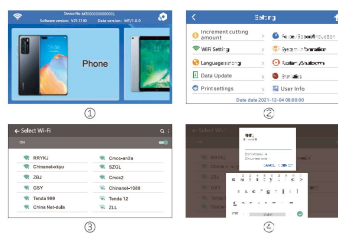

5、Start cutting

Select the brand and model of the device to be cut on the homepage and click [Start Cutting] to start cutting.

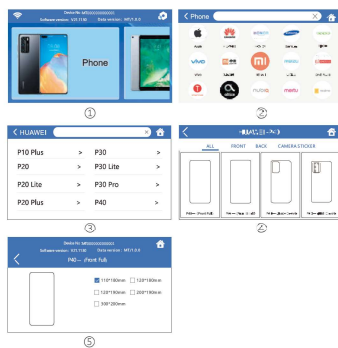

6、Complete cutting

The protector film will be pushed out when the cutting finished.

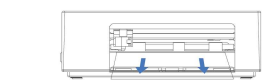

Machine settings

1、Language setting

On the homepage, click [Setting] to enter the setting interface, and click [Language Setting] to switch.

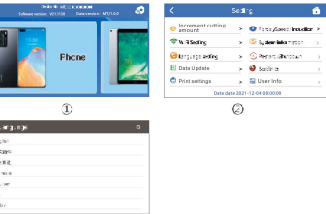

2、Blade force/Speed/Automatic

On the home page, click [Setting] to enter the setting interface, click [Force/Speed/Automatic], please adjust according to actual usage.

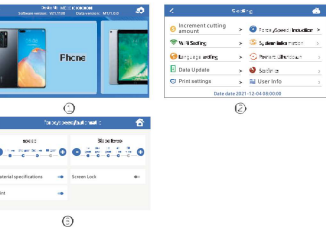

3、Firmware system upgrade

①Tap [Setting] - [System Information] on the homepage to update the firmware version. The password is 1212.
②Tap [Setting] - [Restart] on the home page to restart cutter for data updating.

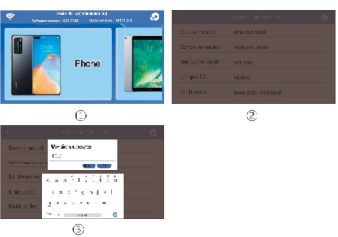

Specification

Model	M188
Max. media width	200mm
Max. cutting width	195mm
Cutting precision	0.1mm
Repeat precision	0.1mm
Max. straight line cutting speed	250mm/s
Max. curve cutting speed	200mm/s
Max. force	9.8N
Our test interface	WiFi 2.4G
Input	110V-240V
Power	<100W
Working environment	+5°C ~ +35°C
Packing size	387.5*183.5*128.5mm
Packing gross weight	6.6kg
Net weight	4.7kg

Safety information

Never touch the tip of the blade with your fingers. This will hurt your fingers and passivate the blade.
Never use the cutter when fingers are on the blade.
Hands or metal objects falling into the cutter may cause fire disaster.
Don't damage or replace the original supply power randomly, never make the power cable excess ve bend or forced to pull arc bundled or force heavy object, which may cause the power supply and lead electric shock or fire disaster.

Warranty card

Model NO		Model	
Product NO			
Name		Address	
Zip code		Phone	
Date		Invoice	
Agent			
Date			

Warranty description

Date	Condition	Processed	Receiver	Repair

Warranty notice
①This warranty card is requested to be kept by the user for maintenance certificate.
②The warranty period is valid for one year from the date of invoice.
③The warranty equipment must be non-artificially damaged and not repaired by personnel not authorized by the company.