

Automatic pet feeder

User Manual

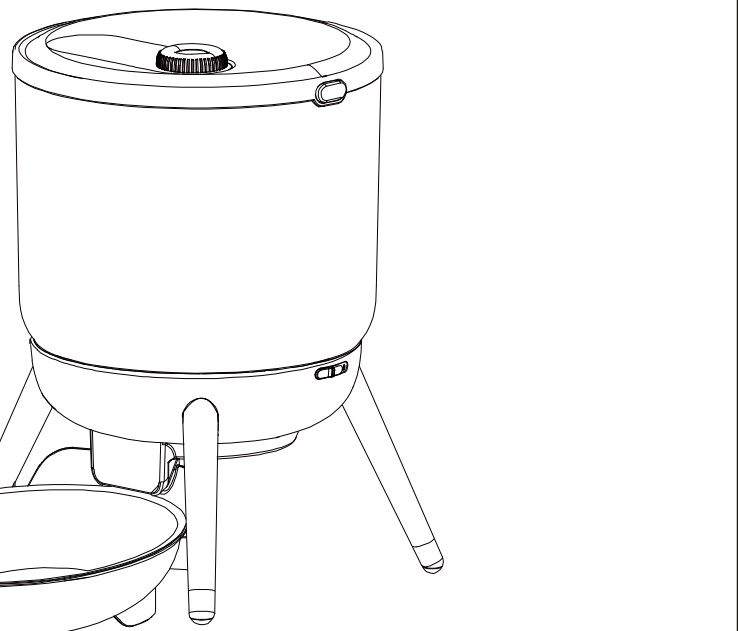

PTM-40A1

List of materials



Product Introduction

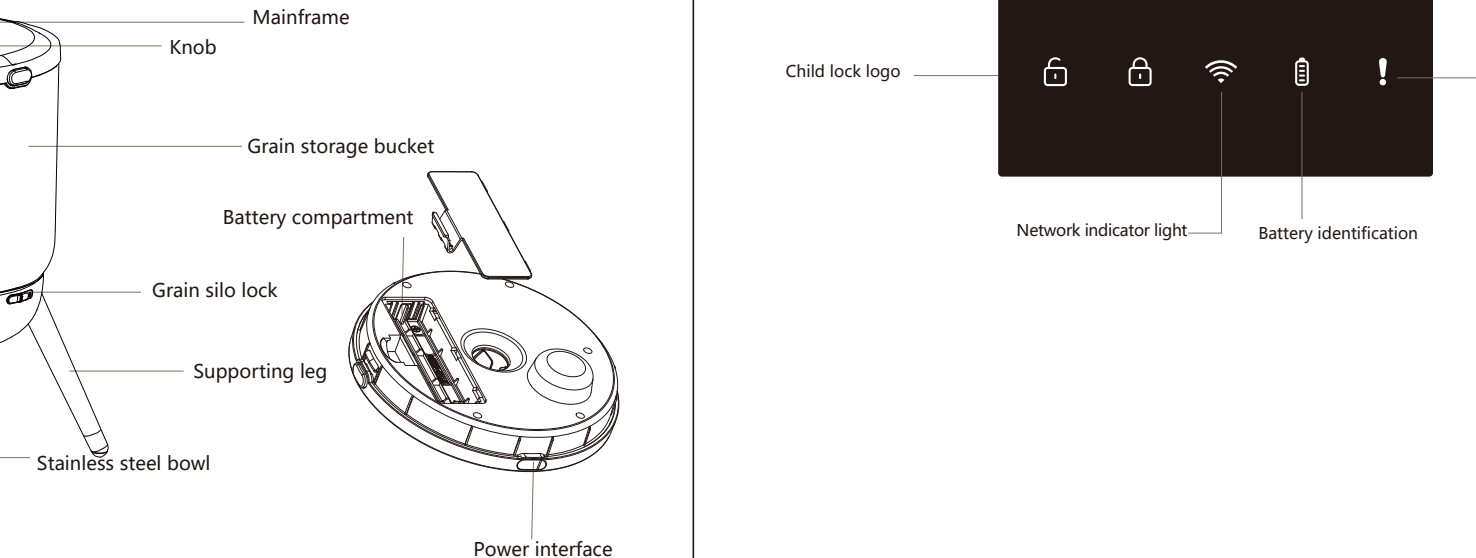

Display screen Function Description

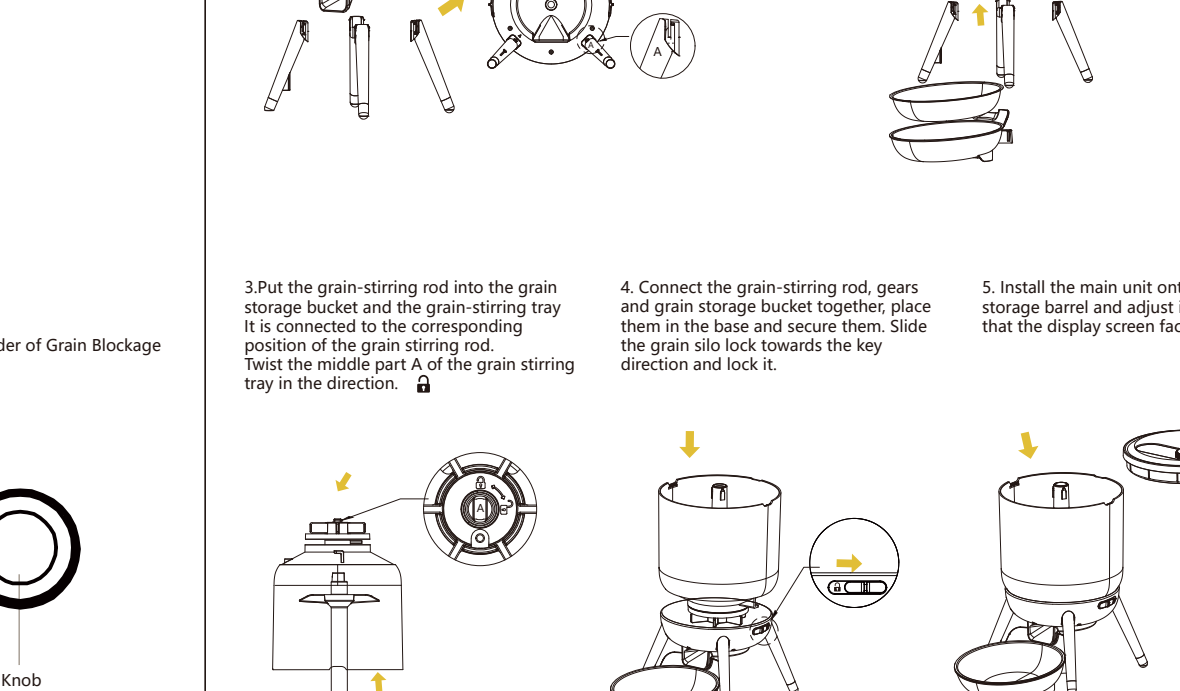

Product assembly

1. As shown in the figure, the support rods A correspond to A and B correspond to B, which are installed in the slots.

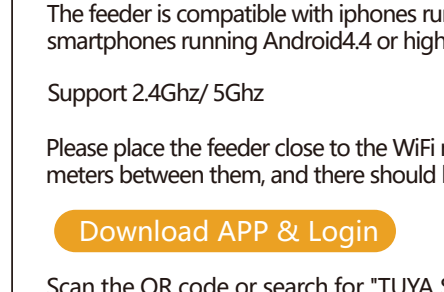

2. Assemble the stainless steel bowl and the plastic bowl, install them in front of the grain outlet, then fix their positions.

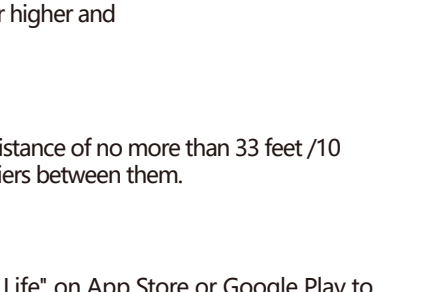

3. Put the grain-stirring rod into the grain storage bucket and the grain-stirring tray. It is connected to the corresponding position of the grain stirring rod. Twist the middle part A of the grain stirring tray in the direction.

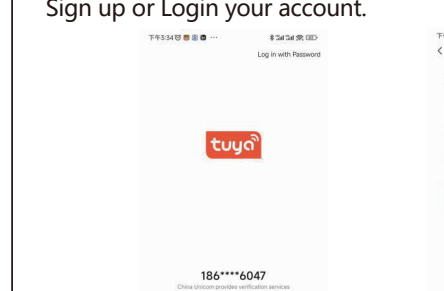

4. Connect the grain-stirring rod, gears and grain storage bucket together, place them in the base and secure them. Slide the grain silo lock towards the key direction and lock it.

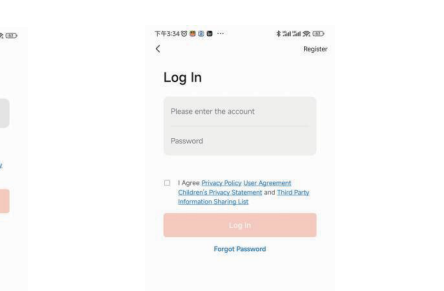

5. Install the main unit onto the grain storage barrel and adjust its position so that the display screen faces forward.

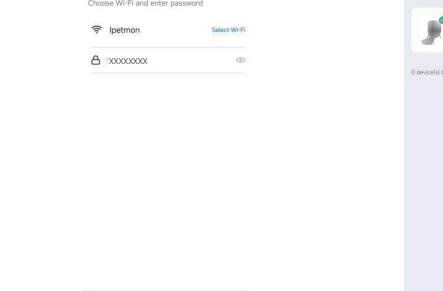

Note: APP language depends on your mobile default language.

How To Set Pet Feeder

Preparation Process

The feeder is compatible with iPhones running iOS9.0 or higher and smartphones running Android4.4 or higher.

Support 2.4Ghz/ 5Ghz

Please place the feeder close to the WiFi router, with a distance of no more than 33 feet /10 meters between them, and there should be no wall barriers between them.

Download APP & Login

Scan the QR code or search for "TUYA Smart, SmartLife" on App Store or Google Play to download the app.



Sign up or Login your account.

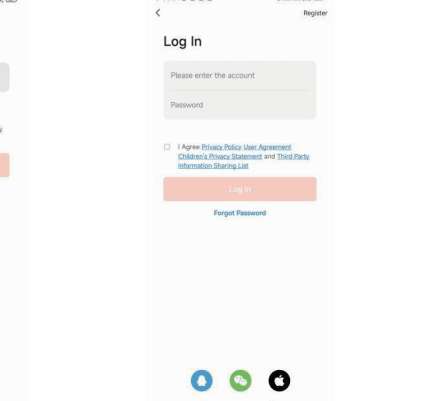

Add Device

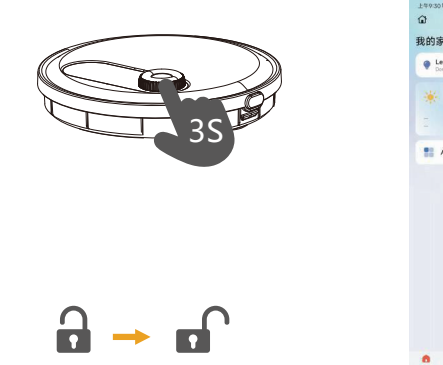

1. Long press the knob for 3 seconds to unlock, select (RESET), long press the knob for 5 seconds to enter the distribution state.

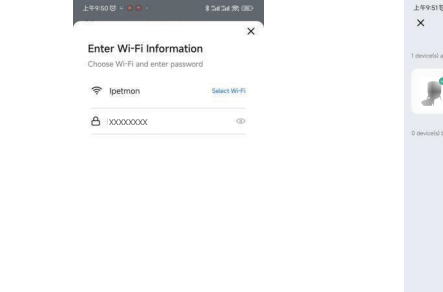

2. Make sure the Bluetooth function of your mobile phone is turned on and connect it. Connect to the WiFi network and simultaneously enable the GPS positioning of your mobile phone. In the right side of the APP operation interface, click the "+" sign to add a new feeder.

4. When connecting to the network for the first time or switching to a new Wi-Fi network, the system will prompt you to enter the Wi-Fi password. Please provide the password in the field and then click "Next". Button continue.

Add Meal Plan

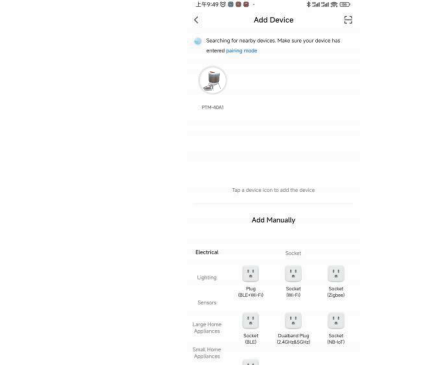

1. Click "Meal Plan" to enter the setting page.

2. Click "Add" button to add feeding plan.

3. Set the schedule & portion based on needs. Click "Save" to finish.

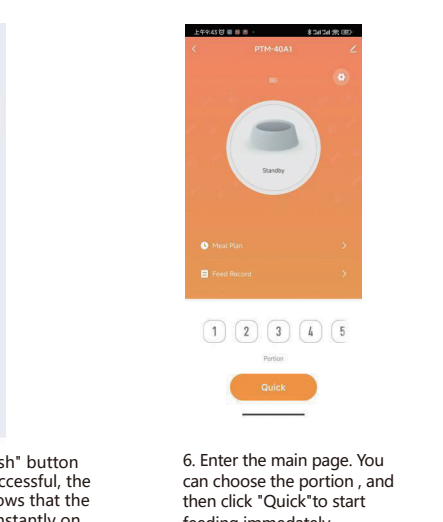

Feeding Records

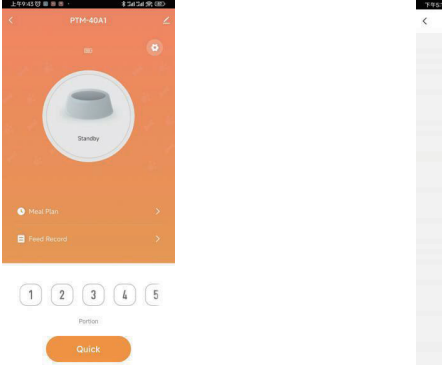

1. Click on "Feeding Records".

2. Enter "Feeding History" page.

Note: After disconnecting your network, machine will keep feeding your pet according to your feeding plan without feeding record.

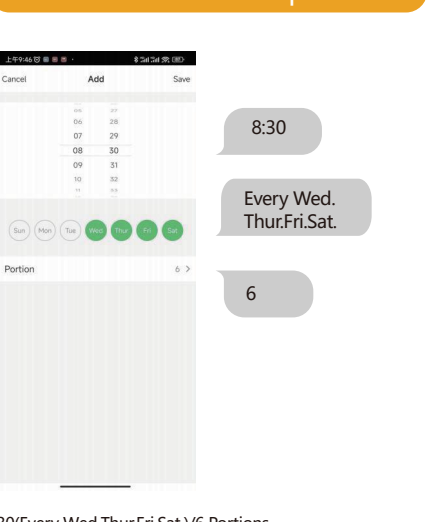

Manual Feeding

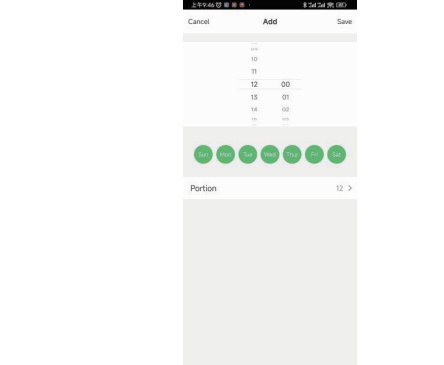

Press and hold the knob for 3 seconds to unlock, turn the knob clockwise to the FEED menu, and click the knob to exit the grain one copy.

Note: When two beeps appear, it means the feeder restores the factory settings successfully.

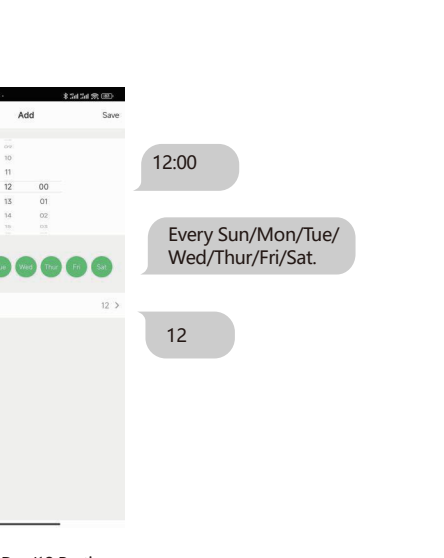

Reset

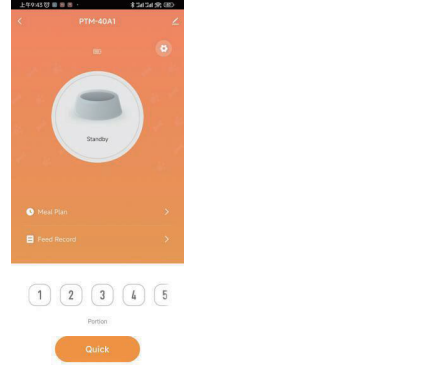

Press and hold the knob for 3 seconds to unlock, then turn the knob clockwise to the reset icon and hold it for 5 seconds to restore the factory settings.

Note: When two beeps appear, it means the feeder restores the factory settings successfully.

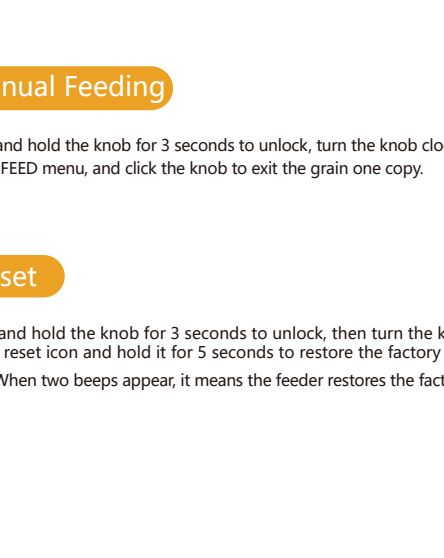

Product cleaning



1. Please unplug the charging cable before cleaning.

2. Please do not soak or rinse the main unit.

3. Twist the middle part A of the mixing pan to the unlocking position, as shown in the figure below, and the mixing pan and the mixing rod can be separated.

4. Remove the stainless steel bowl and the plastic bowl. And unscrew all the support rods.

5. Clean the grain storage tank, support rods, grain mixer disc, grain mixer rod, stainless steel bowls and plastic bowls, and then air-dry or wipe them dry.

6. Please do not soak or rinse the main unit.

7. If the desiccant bag is found to be damaged, please stop using it immediately and contact us to obtain a replacement desiccant bag.

8. If you stop using the feeder, unplug the power cable and remove the batteries properly. installed in the cover and store them properly.

Product parameters

Model	PTM-40A1
Size	196*192*206mm
Capacity	3L
Material	ABS+304 Stainless steel
Input	5V=1A
Food	Dry food with a diameter of less than 1.2CM
Adapter	It is recommended to use a power cord cable.

Precautions for Use

1. This feeder is recommended for pets over 6 months.
2. This feeder is designed for indoor use. Please avoid placing it in direct sunlight and away from any potential fire or heat sources.
3. Please be sure to use the adapter that comes with this product to power the feeder. Using other adapters may cause the machine to malfunction or damage.
4. Never immerse the host in water or other liquids. It is important to keep the host dry.
5. To prevent pets from knocking over the feeder, it is recommended to place it against a wall or in a safe location.
6. When children use the feeder, they should be supervised and guided by adults to ensure safe operation.
7. If the desiccant bag is found to be damaged, please stop using it immediately and contact us to obtain a replacement desiccant bag.
8. If you stop using the feeder, unplug the power cable and remove the batteries properly. installed in the cover and store them properly.

Fault resolution

Problem	Solution
The feeder doesn't work	Check whether the power cord is properly connected Suspend the use of the battery and use the charging cable to see if it can continue to work Unplug the power cord, replace it with a new battery and check if it works
The screen doesn't respond	Press and hold for 3 seconds to unlock the display screen
The machine is stuck with grain or the display screen is not lit	Check whether the grain storage bucket and the grain outlet are kept dry Check if the food remains dry. Do not use wet food If you are not using the power cord, please replace the battery

FCC Warning

FCC Caution:

Any Changes or modifications not expressly approved by the party responsible for compliance could void the user's authority to operate the equipment.

This device complies with part 15 of the FCC Rules. Operation is subject to the following two conditions: (1) This device may not cause harmful interference, and (2) this device must accept any interference received, including interference that may cause undesired operation.

IMPORTANT NOTE:

Note: This equipment has been tested and found to comply with the limits for a Class B digital device, pursuant to part 15 of the FCC Rules. These limits are designed to provide reasonable protection against harmful interference in a residential installation. This equipment generates, uses and can radiate radio frequency energy and, if not installed and used in accordance with the instructions, may cause harmful interference to radio communications. However, there is no guarantee that interference will not occur in a particular installation. If this equipment does cause harmful interference to radio or television reception, which can be determined by turning the equipment off and on, the user is encouraged to try to correct the interference by one or more of the following measures:

- Reorient or relocate the receiving antenna.
- Increase the separation between the equipment and receiver.
- Connect the equipment into an outlet on a circuit different from that to which the receiver is connected.
- Consult the dealer or an experienced radio/TV technician for help.

FCC Radiation Exposure Statement:

This equipment complies with FCC radiation exposure limits set forth for an uncontrolled environment. This equipment should be installed and operated with minimum distance 20cm between the radiator& your body.

FCC Warning

FCC Caution:

Any Changes or modifications not expressly approved by the party responsible for compliance could void the user's authority to operate the equipment.

This device complies with part 15 of the FCC Rules. Operation is subject to the following two conditions: (1) This device may not cause harmful interference, and (2) this device must accept any interference received, including interference that may cause undesired operation.

IMPORTANT NOTE:

Note: This equipment has been tested and found to comply with the limits for a Class B digital device, pursuant to part 15 of the FCC Rules. These limits are designed to provide reasonable protection against harmful interference in a residential installation. This equipment generates, uses and can radiate radio frequency energy and, if not installed and used in accordance with the instructions, may cause harmful interference to radio communications. However, there is no guarantee that interference will not occur in a particular installation. If this equipment does cause harmful interference to radio or television reception, which can be determined by turning the equipment off and on, the user is encouraged to try to correct the interference by one or more of the following measures:

- Reorient or relocate the receiving antenna.
- Increase the separation between the equipment and receiver.
- Connect the equipment into an outlet on a circuit different from that to which the receiver is connected.
- Consult the dealer or an experienced radio/TV technician for help.

FCC Radiation Exposure Statement:

This equipment complies with FCC radiation exposure limits set forth for an uncontrolled environment. This equipment should be installed and operated with minimum distance 20cm between the radiator& your body.

FCC Warning

FCC Caution:

Any Changes or modifications not expressly approved by the party responsible for compliance could void the user's authority to operate the equipment.

This device complies with part 15 of the FCC Rules. Operation is subject to the following two conditions: (1) This device may not cause harmful interference, and (2) this device must accept any interference received, including interference that may cause undesired operation.

IMPORTANT NOTE:

Note: This equipment has been tested and found to comply with the limits for a Class B digital device, pursuant to part 15 of the FCC Rules. These limits are designed to provide reasonable protection against harmful interference in a residential installation. This equipment generates, uses and can radiate radio frequency energy and, if not installed and used in accordance with the instructions, may cause harmful interference to radio communications. However, there is no guarantee that interference will not occur in a particular installation. If this equipment does cause harmful interference to radio or television reception, which can be determined by turning the equipment off and on, the user is encouraged to try to correct the interference by one or more of the following measures:

- Reorient or relocate the receiving antenna.
- Increase the separation between the equipment and receiver.
- Connect the equipment into an outlet on a circuit different from that to which the receiver is connected.
- Consult the dealer or an experienced radio/TV technician for help.

FCC Radiation Exposure Statement:

This equipment complies with FCC radiation exposure limits set forth for an uncontrolled environment. This equipment should be installed and operated with minimum distance 20cm between the radiator& your body.

FCC Warning

FCC Caution:

Any Changes or modifications not expressly approved by the party responsible for compliance could void the user's authority to operate the equipment.

This device complies with part 15 of the FCC Rules. Operation is subject to the following two conditions: (1) This device may not cause harmful interference, and (2) this device must accept any interference received, including interference that may cause undesired operation.

IMPORTANT NOTE:

Note: This equipment has been tested and found to comply with the limits for a Class B digital device, pursuant to part 15 of the FCC Rules. These limits are designed to provide reasonable protection against harmful interference in a residential installation. This equipment generates, uses and can radiate radio frequency energy and, if not installed and used in accordance with the instructions, may cause harmful interference to radio communications. However, there is no guarantee that interference will not occur in a particular installation. If this equipment does cause harmful interference to radio or television reception, which can be determined by turning the equipment off and on, the user is encouraged to try to correct the interference by one or more of the following measures:

- Reorient or relocate the receiving antenna.
- Increase the separation between the equipment and receiver.
- Connect the equipment into an outlet on a circuit different from that to which the receiver is connected.
- Consult the dealer or an experienced radio/TV technician for help.

FCC Radiation Exposure Statement:

This equipment complies with FCC radiation exposure limits set forth for an uncontrolled environment. This equipment should be installed and operated with minimum distance 20cm between the radiator& your body.

FCC Warning

FCC Caution:

Any Changes or modifications not expressly approved by the party responsible for compliance could void the user's authority to operate the equipment.

This device complies with part 15 of the FCC Rules. Operation is subject to the following two conditions: (1) This device may not cause harmful interference, and (2) this device must accept any interference received, including interference that may cause undesired operation.

IMPORTANT NOTE:

Note: This equipment has been tested and found to comply with the limits for a Class B digital device, pursuant to part 15 of the FCC Rules. These limits are designed to provide reasonable protection against harmful interference in a residential installation. This equipment generates, uses and can radiate radio frequency energy and, if not installed and used in accordance with the instructions, may cause harmful interference to radio communications. However, there is no guarantee that interference will not occur in a particular installation. If this equipment does cause harmful interference to radio or television reception, which can be determined by turning the equipment off and on, the user is encouraged to try to correct the interference by one or more of the following measures:

- Reorient or relocate the receiving antenna.
- Increase the separation between the equipment and receiver.
- Connect the equipment into an outlet on a circuit different from that to which the receiver is connected.
- Consult the dealer or an experienced radio/TV technician for help.

FCC Radiation Exposure Statement:

This equipment complies with FCC radiation exposure limits set forth for an uncontrolled environment. This equipment should be installed and operated with minimum distance 20cm between the radiator& your body.

FCC Warning

FCC Caution:

Any Changes or modifications not expressly approved by the party responsible for compliance could void the user's authority to operate the equipment.

This device complies with part 15 of the FCC Rules. Operation is subject to the following two conditions: (1) This device may not cause harmful interference, and (2) this device must accept any interference received, including interference that may cause undesired operation.

IMPORTANT NOTE:

Note: This equipment has been tested and found to comply with the limits for a Class B digital device, pursuant to part 15 of the FCC Rules. These limits are designed to provide reasonable protection against harmful interference in a residential installation. This equipment generates, uses and can radiate radio frequency energy and, if not installed and used in accordance with the instructions, may cause harmful interference to radio communications. However, there is no guarantee that interference will not occur in a particular installation. If this equipment does cause harmful interference to radio or television reception, which can be determined by turning the equipment off and on, the user is encouraged to try to correct the interference by one or more of the following measures:

- Reorient or relocate the receiving antenna.
- Increase the separation between the equipment and receiver.
- Connect the equipment into an outlet on a circuit different from that to which the receiver is connected.
- Consult the dealer or an experienced radio/TV technician for help.

FCC Radiation Exposure Statement:

This equipment complies with FCC radiation exposure limits set forth for an uncontrolled environment. This equipment should be installed and operated with minimum distance 20cm between the radiator& your body.

FCC Warning

FCC Caution:

Any Changes or modifications not expressly approved by the party responsible for compliance could void the user's authority to operate the equipment.

This device complies with part 15 of the FCC Rules. Operation is subject to the following two conditions: (1) This device may not cause harmful interference, and (2) this device must accept any interference received, including interference that may cause undesired operation.

IMPORTANT NOTE:

Note: This equipment has been tested and found to comply with the limits for a Class B digital device, pursuant to part 15 of the FCC Rules. These limits are designed to provide reasonable protection against harmful interference in a residential installation. This equipment generates, uses and can radiate radio frequency energy and, if not installed and used in accordance with the instructions, may cause harmful interference to radio communications. However, there is no guarantee that interference will not occur in a particular installation. If this equipment does cause harmful interference to radio or television reception, which can be determined by turning the equipment off and on, the user is encouraged to try to correct the interference by one or more of the following measures:

- Reorient or relocate the receiving antenna.
- Increase the separation between the equipment and receiver.
- Connect the equipment into an outlet on a circuit different from that to which the receiver is connected.
- Consult the dealer or an experienced radio/TV technician for help.

FCC Radiation Exposure Statement:

This equipment complies with FCC radiation exposure limits set forth for an uncontrolled environment. This equipment should be installed and operated with minimum distance 20cm between the radiator& your body.

FCC Warning

FCC Caution:

Any Changes or modifications not expressly approved by the party responsible for compliance could void the user's authority to operate the equipment.

This device complies with part 15 of the FCC Rules. Operation is subject to the following two conditions: (1) This device may not cause harmful interference, and (2) this device must accept any interference received, including interference that may cause undesired operation.

IMPORTANT NOTE:

Note: This equipment has been tested and found to comply with the limits for a Class B digital device, pursuant to part 15 of the FCC Rules. These limits are designed to provide reasonable protection against harmful interference in a residential installation. This equipment generates, uses and can radiate radio frequency energy and, if not installed and used in accordance with the instructions, may cause harmful interference to radio communications. However, there is no guarantee that interference will not occur in a particular installation. If this equipment does cause harmful interference to radio or television reception, which can be determined by turning the equipment off and on, the user is encouraged to try to correct the interference by one or more of the following measures:

- Reorient or relocate the receiving antenna.
- Increase the separation between the equipment and receiver.
- Connect the equipment into an outlet on a circuit different from that to which the receiver is connected.
- Consult the dealer or an experienced radio/TV technician for help.

FCC Radiation Exposure Statement:

This equipment complies with FCC radiation exposure limits set forth for an uncontrolled environment. This equipment should be installed and operated with minimum distance 20cm between the radiator& your body.