

# Automatic Cat Feeder with Camera

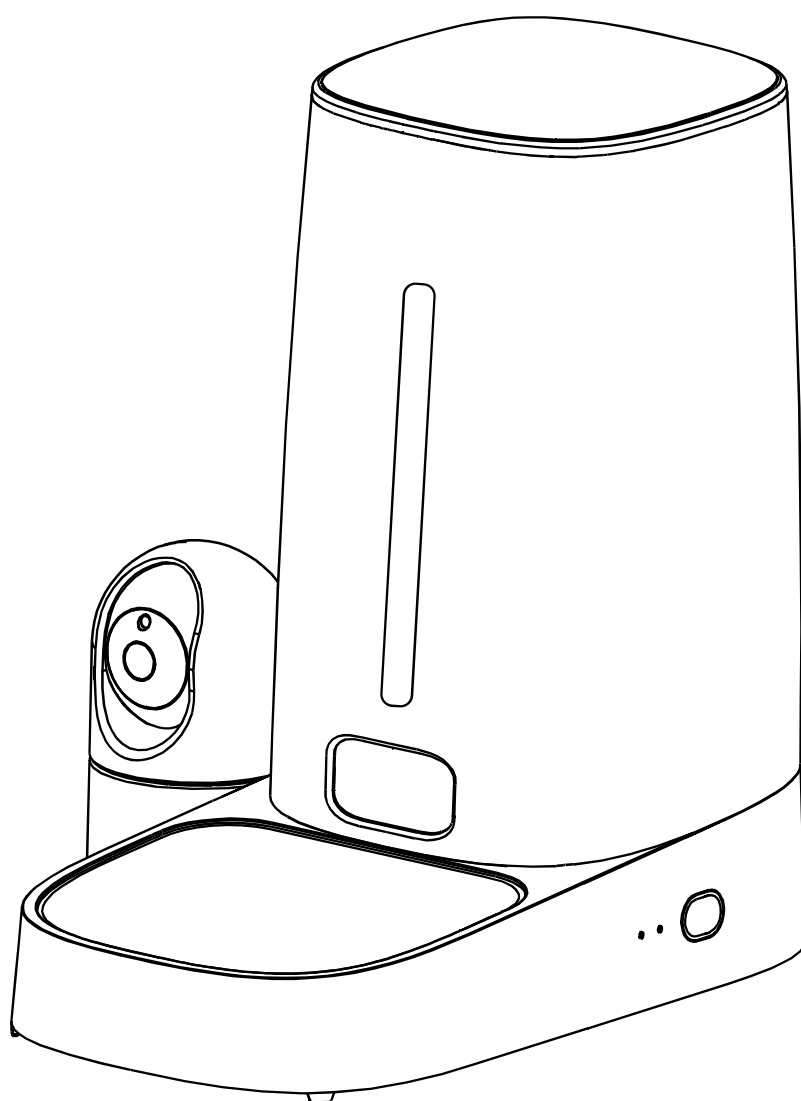

## User Manual

Please read this manual carefully before use.

# 一、Product Description

## Front View

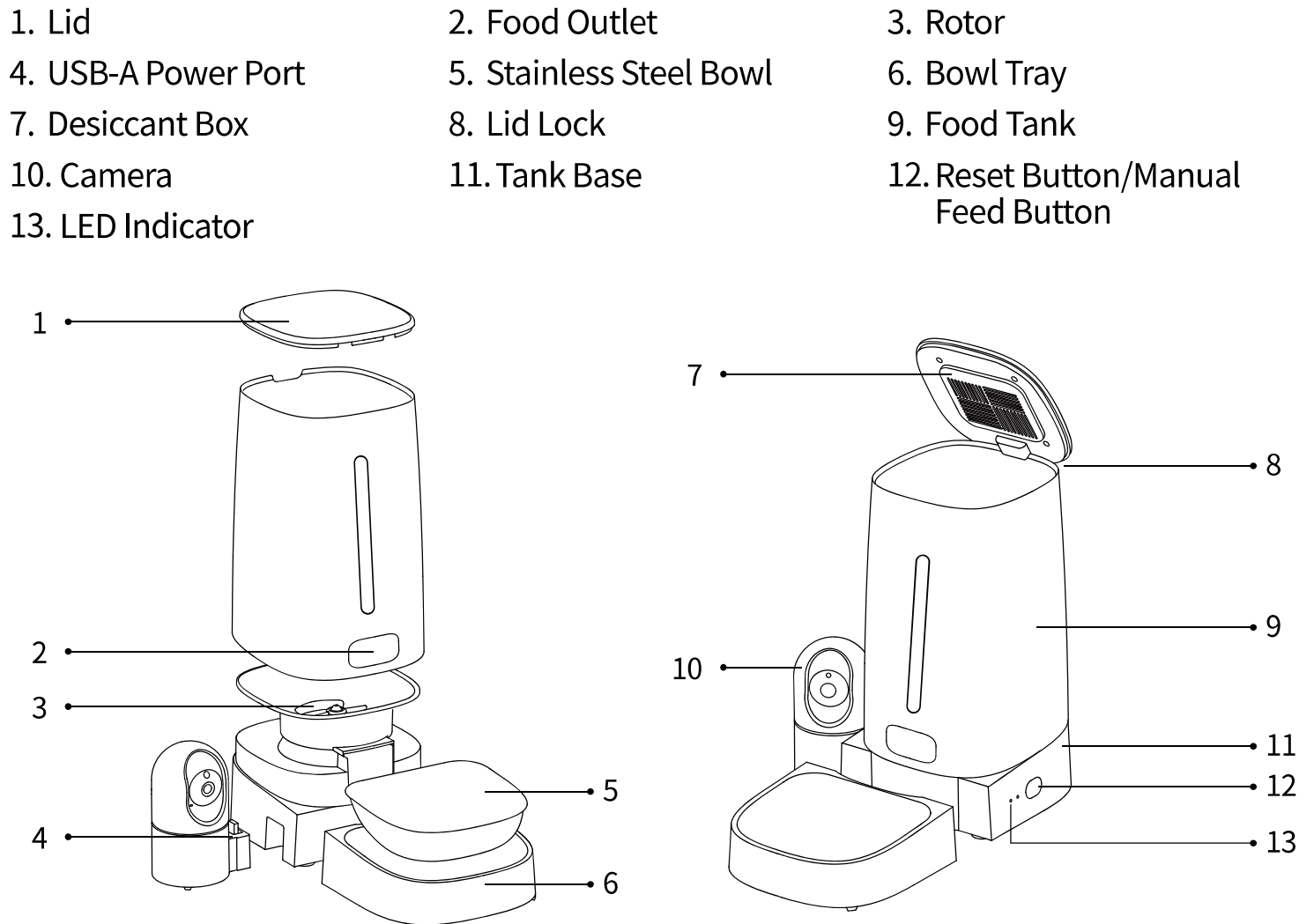

## Bottom View

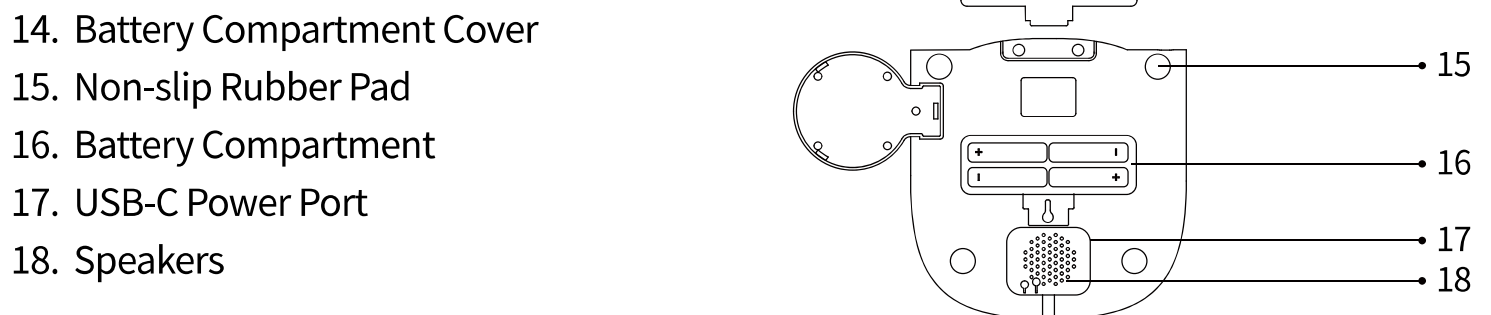

## 二、How to Install

### 1. Remove all accessories from the feeder.

Note: Before assembling the feeder, wash and completely air dry the removable parts.

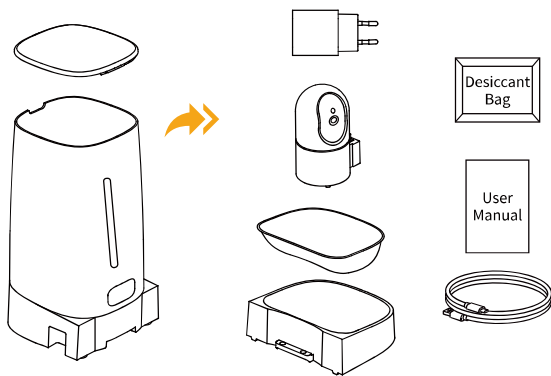

### 2. Plug in the power adapter. If you want, install 4\*AA alkaline batteries (Not included) in case of a power failure.

Note: Batteries are powered for back-up only and should not be used as the main power source.

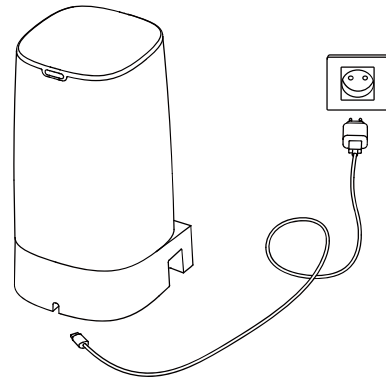

### 3. Lift up the feeder's grain bucket base, align the USB-A power connector on the camera's main unit with the USB connector in the groove on the left side of the grain bucket base, make sure that the connection ports are perfectly aligned, and then press down until it is securely fastened to the base.

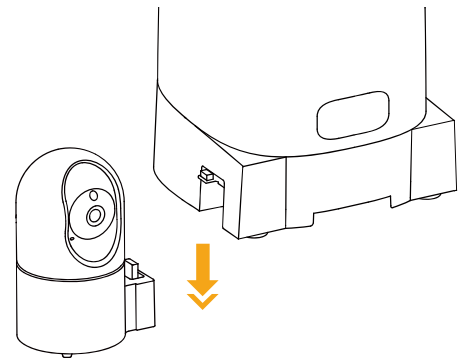

### 4. Install the grain drum by aligning the drum with the slot and pressing down.

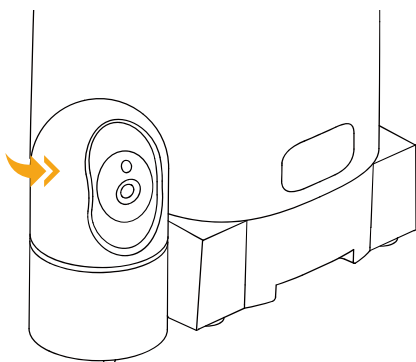

### 5. Place stainless steel bowl into the food tray. Lift feeder and slide the holder into the groove on the bottom of the feeder.

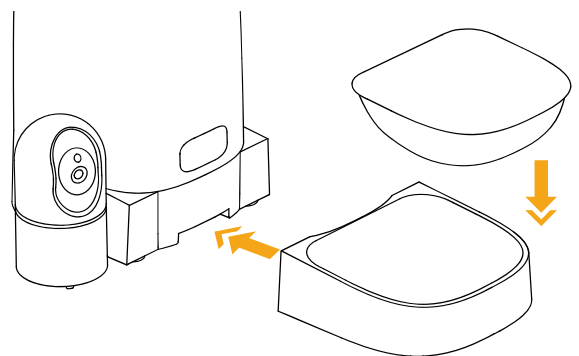

6. Fill the food bin with your pet's favourite dry food. Place the desiccant bag in the desiccant box and close the lid.

Note: It is recommended to use desiccant bag and replace it every 30 days, remove the desiccant bag before cleaning the lid.  
Note: Suitable for dry food with kibble size ranging from 2-15mm(0.07-0.6in) in diameter. Larger kibble may get stuck at the food outlet.

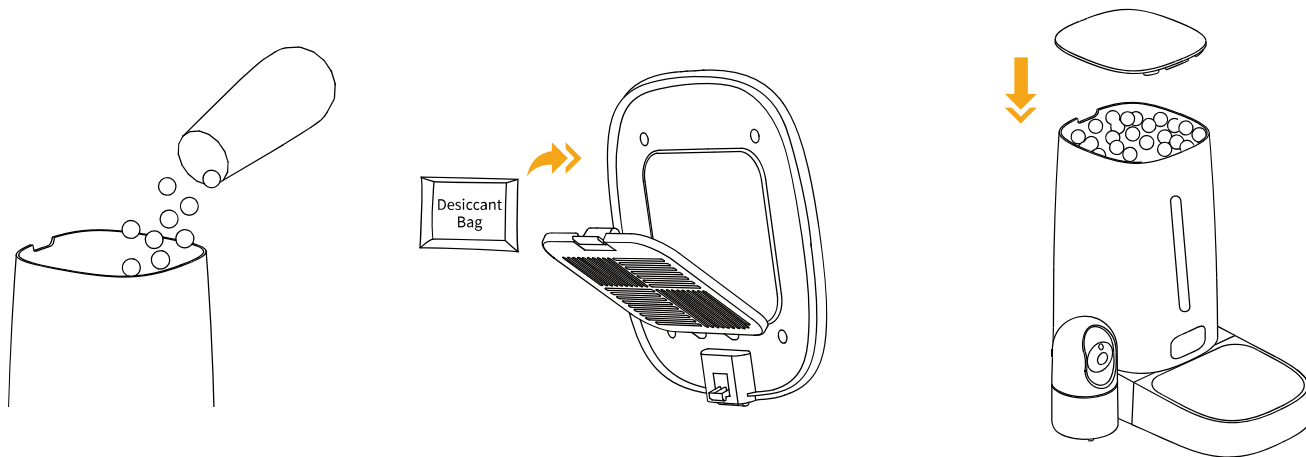

## 三、How To Set Pet Feeder

### Preparation Process

- System: iPhone ios system 9.0 or above; Smartphone Android system 4.4 or above.
- Mobile phone should connect with 5G or 2.4G WiFi.
- The WiFi password is composed of no more than 12 digits and letters.No special symbols are supported. Do not use Chinese.
- Make sure Bluetooth and Location Services "on" on your phone.
- Please keep the feeder close to the WiFi router . The distance between pet feeder and WiFi router doesn't exceed 33ft/10m and there is no wall barriers between them.

### Download APP & Login

- Scan the OR code or search for " Smart Life " on App Store or Google Play to download the app.



Smart Life



App Store



Google Play

- Sign up or Login your account.

Note: APP language depends on your mobile default language.

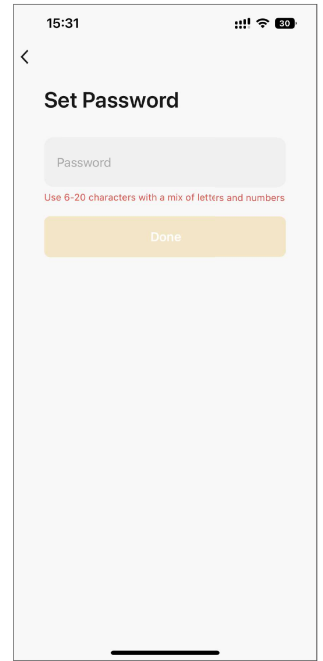
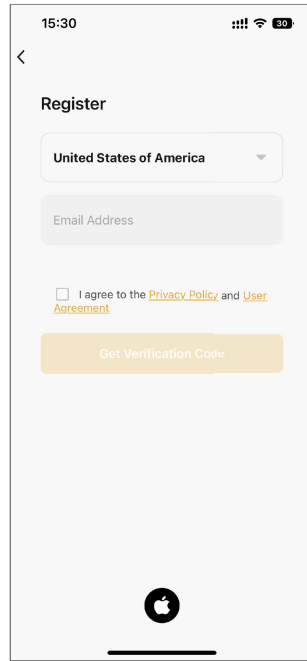
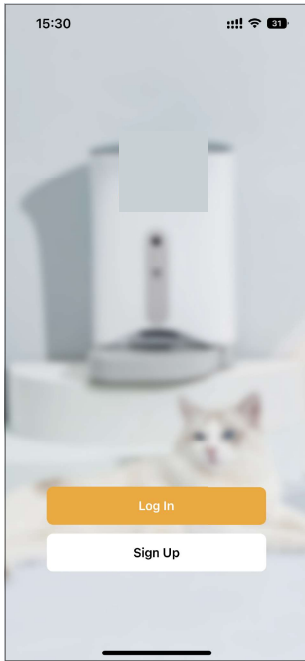

## Power on the Device

Power on the device, turn on the WiFi and Bluetooth of the mobile phone, long press the on/off button for 5s, the green light flashes, after the device starts up and you hear the tone of the distribution network, you can carry out the distribution network.

## Add Device

### Mode 1: Bluetooth WiFi Connection

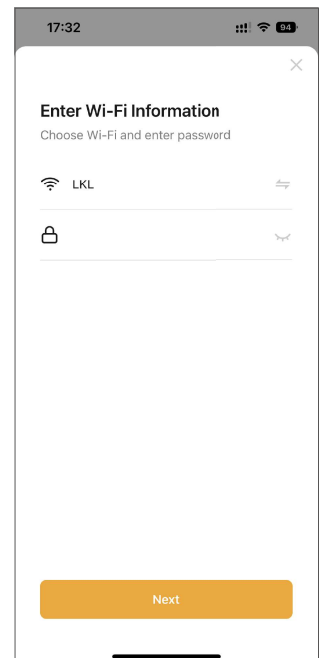
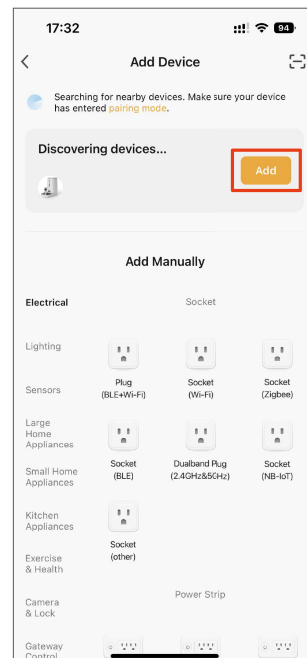
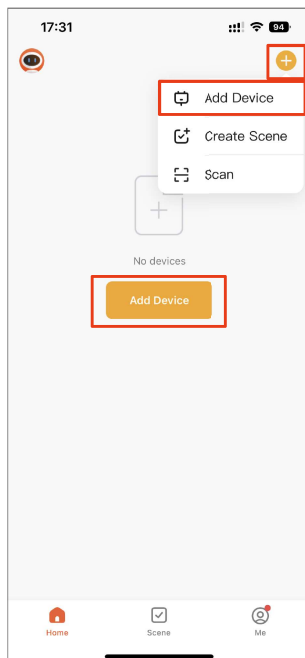

1. Click the **"Add Device"** button on the home page, or click the **"+"** sign in the upper right corner and then select **"Add Device"** to configure.

2. After adding devices, the app will automatically search for nearby devices, click **"Add"**. Select 5G or 2.4G WiFi and fill in the correct password, confirm and click next.

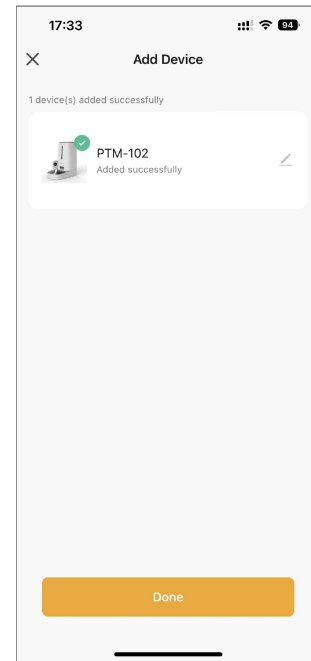
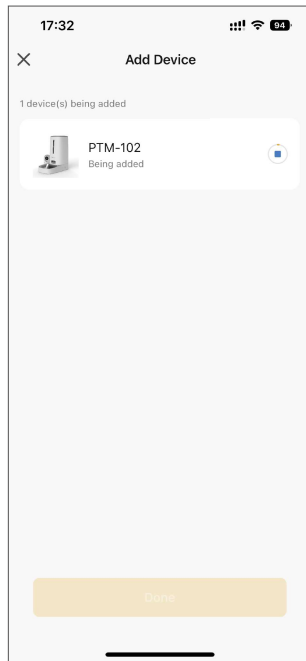

3. You can select the device you want to add, wait for the device to be configured successfully, then click the button below to finish.

4. After successfully adding the device, it will automatically jump to the home page and enter the control panel interface of the device.

## Mode 2: AP Configuration

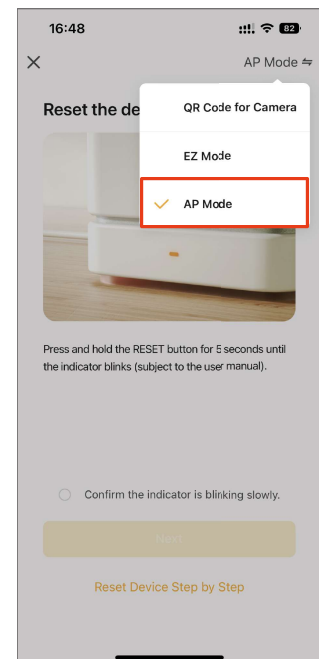
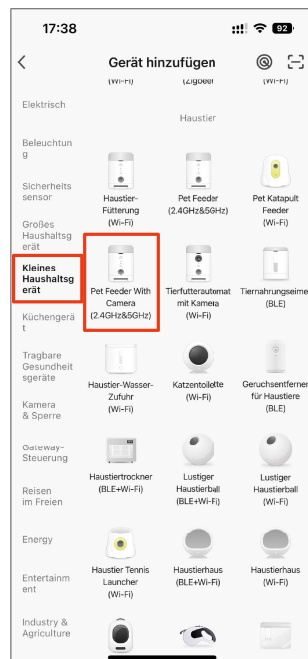
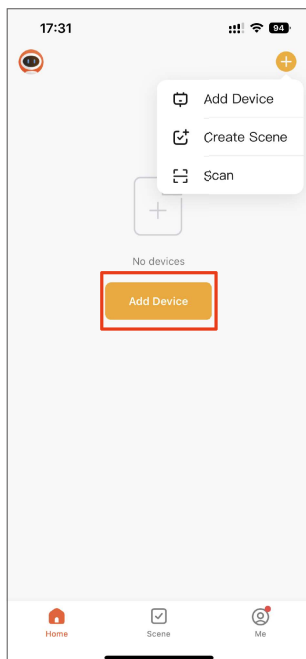

1. Click Add Device, select **"Small Home Appliances"** on the left side, and find **"Pet Feeder with Camera (2.4GHz&5GHz)"**.

2. Click the upper right corner to switch the network mode to **"AP Mode"**, and click to confirm the indicator light blinks **"slowly"**.

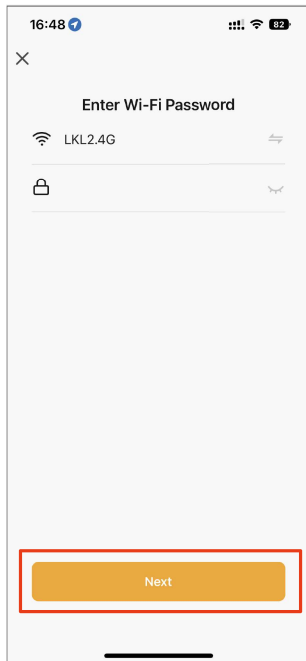

3. Select the 5G or 2.4G WiFi you want to connect to and fill in the correct password, confirm and click **"Next"**.

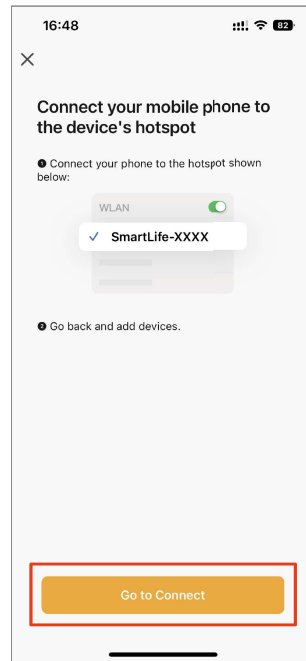

4. Click **"Go to Connect"** button, follow the instruction of APP to connect the Wi-Fi name with the word SmartLife, then return to the app and wait for the configuration.

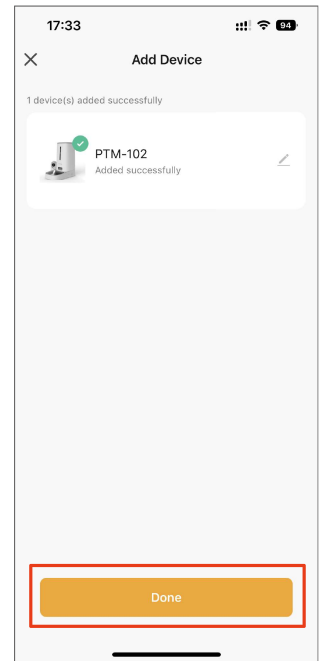

5. When the configuration is successful, the interface of adding device will pop up, click **"Done"**. If the connection fails, you can try to restart the device and try again.

## Menu Functions

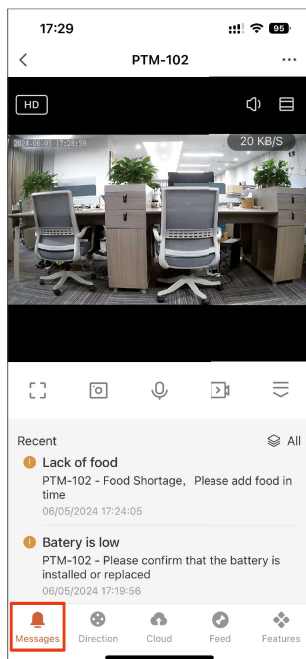

### Messages

The message page can be queried for the history of the device's alarm records.

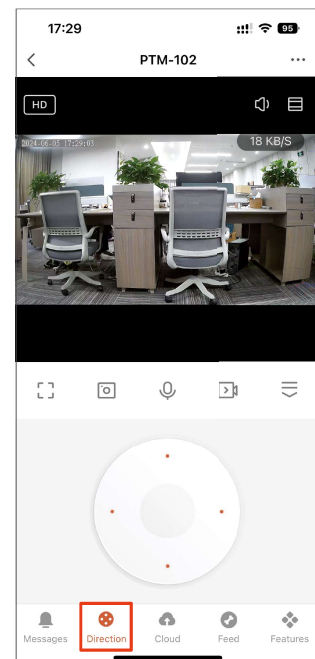

### Direction

Control the camera rotation direction through the panel.

## Feed

### ① Manual Feeding

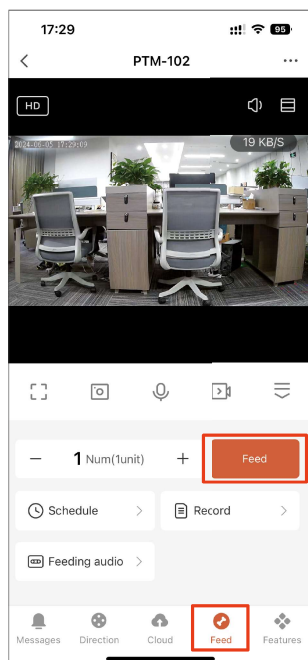

Click on the **"Feed"** menu at the bottom, select the number of servings you want to feed, and click the **"Feed"** button at the top.

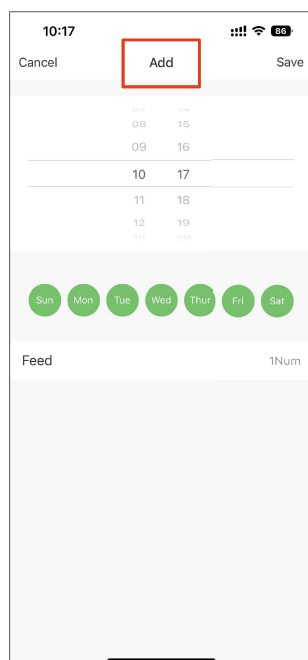

2. Click **"Add"** button to add feeding plan.

### ② Add Meal Plan

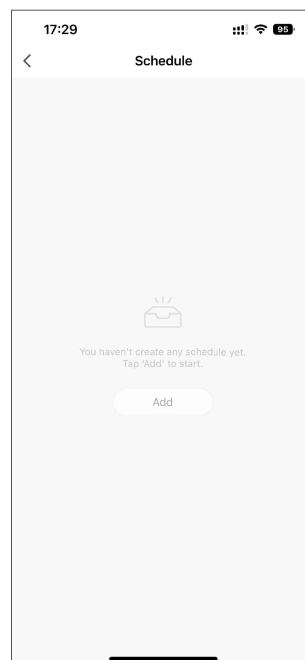
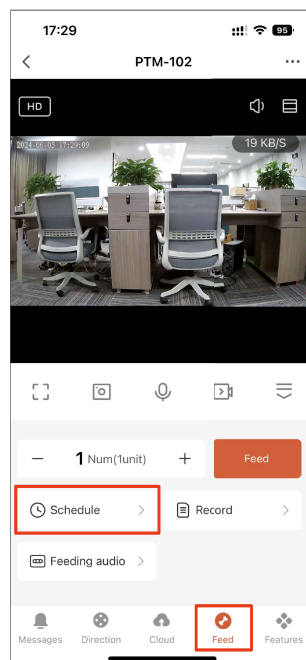

1. Click on **"Feed"** below, click on **"Schedule"** to enter the timing page.

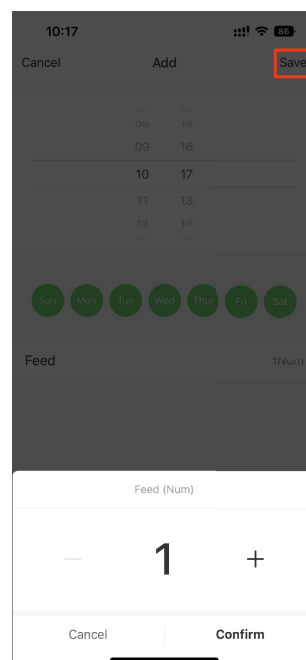

3. Set the schedule & portion based on needs. Click **"Save"** to finish.



### ③ Add Meal Interface Explanation

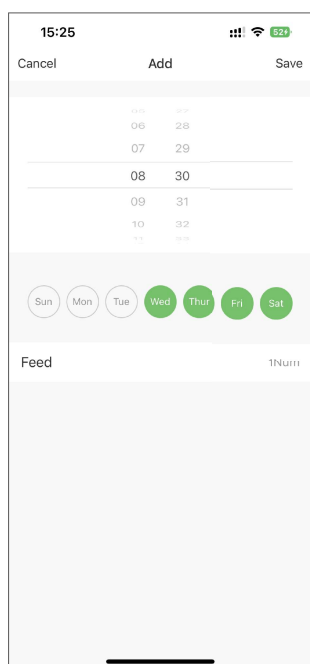

8:30

Every Wed.  
Thur.Fri.Sat.

6

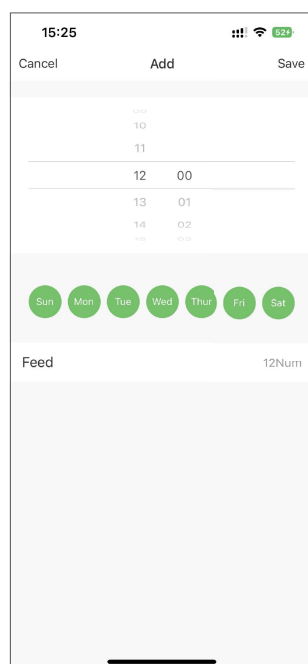

12:00

Every Sun.Mon.Tue.  
Wed.Thur.Fri.Sat.

12

#### Plan1

08:30(Every Wed.Thur.Fri.Sat.)/6 Portions.

#### Plan2

12:00 Every Day/12 Portions.

### ④ Feed Record

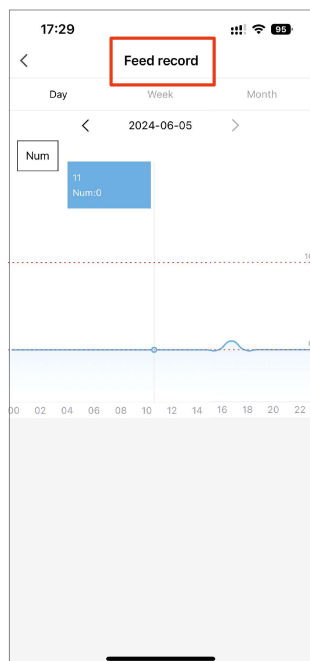
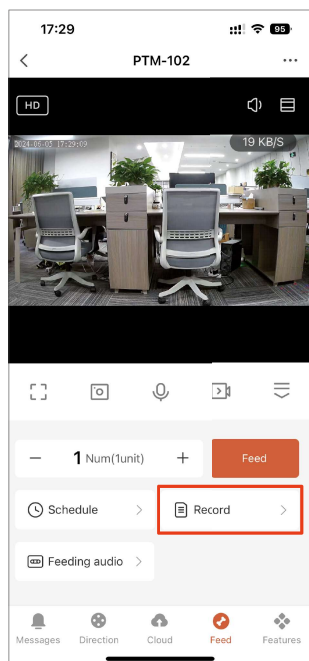

1. Click "**Record**".

2. Enter "**Feed record**" page.

Note: After disconnecting your network, machine will keep feeding your pet according to your feeding plan without feeding record.

### ⑤ Voice Recording

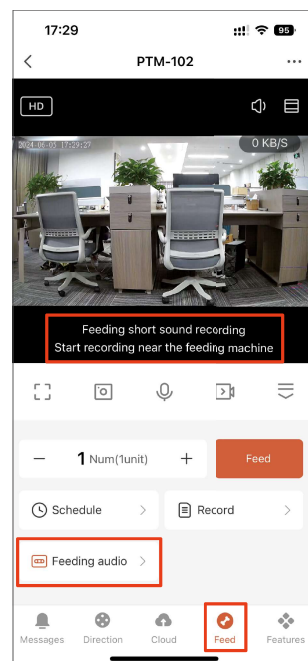

Click "**Feed Audio**", please approach the feeder to start recording, click again, the recording will be saved.

Note: Recordings play automatically when feeding.

## Setup Functions

In the upper right corner, click "... " to enter the setting page

### ① Share Device

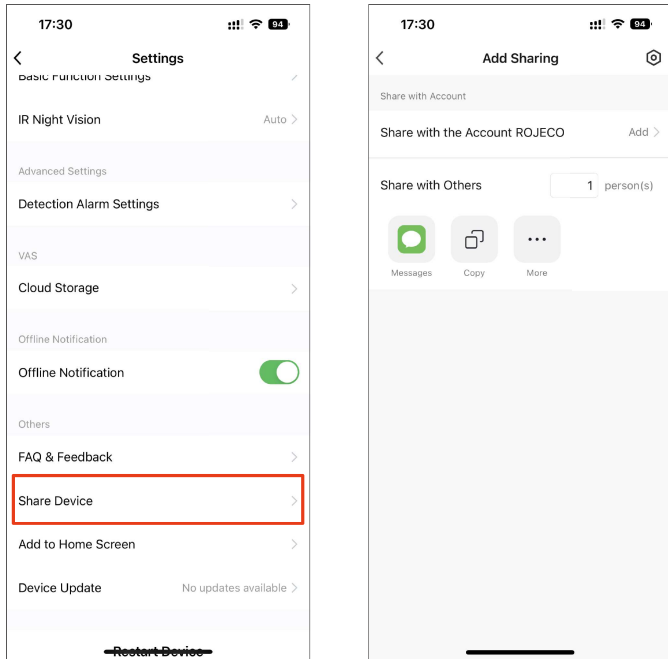

Scroll down to find the **"Share Device"**, you can share the link to others, and then others can also control the device.

### ② Remove Device

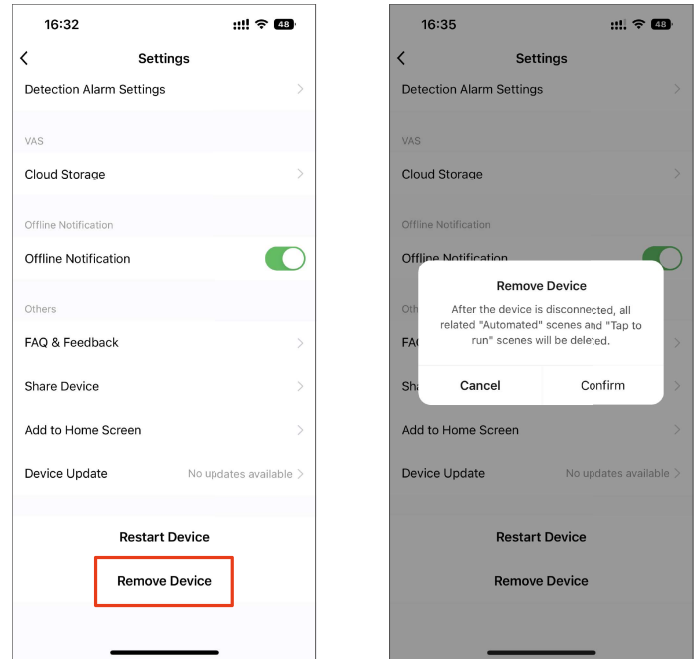

Enter the setting page and click **"Remove Device"**. The device will be reset after removing the device, and the data will be cleared after restarting and need to be re-networked.

## 四、Indicators Lights

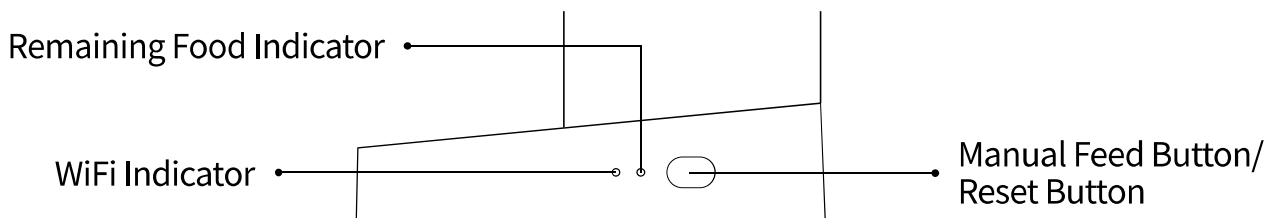

### Status Indicator

Action	Meaning
Green light always on	Successful networking
Green light flashes quickly	WiFi connection
Red light flashes	Lack of food/ jammed food/ low battery reminder

	<ul style="list-style-type: none"> <li>● Double-click the button to manually dispense a serving of grain.</li> <li>● Keep pressing the button for 5-7s, the feeder is reset.</li> </ul>
--	---

## 五、Disassemble for Cleaning

1. Unplug the power cord, remove the cover and take out the desiccant.

Note: It is recommended that the desiccant bag be replaced every 30 days.

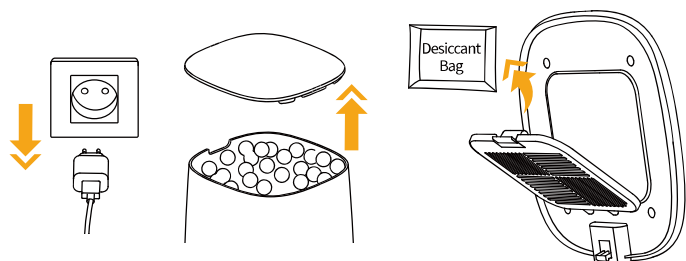

2. Remove the bowl tray by pulling the grain drum upwards.

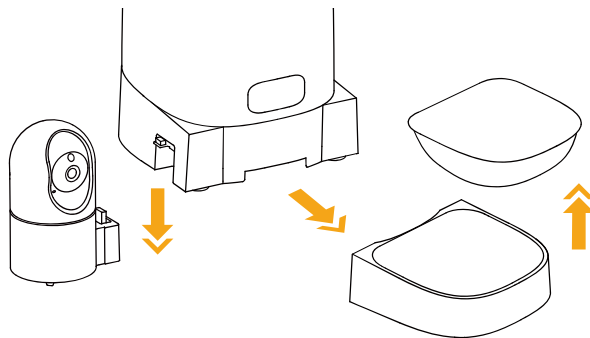

3. Slide the grain dispensing dial to the left to unlock it.

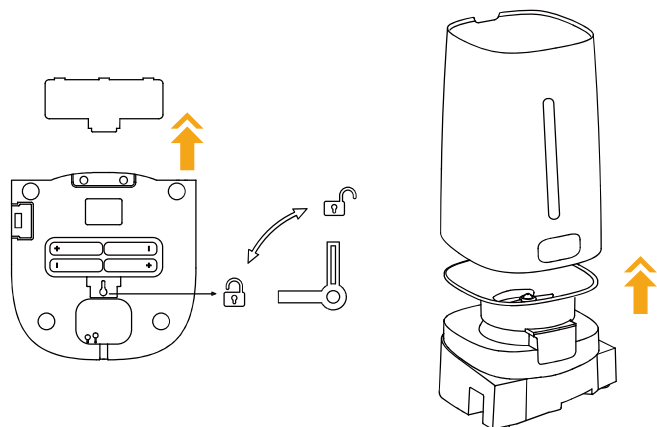

Note: The camera mainframe and base cannot be washed, just wipe it clean with a damp cloth.

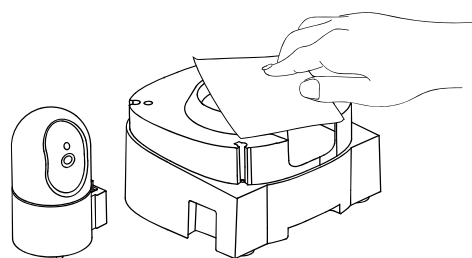

4. Bowl tray, stainless bowl, hopper and lid can be washed by water.

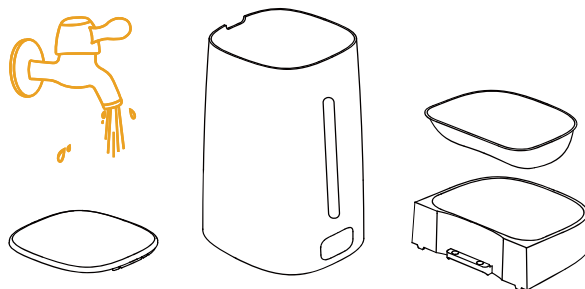

## 七、Specifications

Model	PTM-102	Dimension	330*252*335mm
Input	5V/2A DC	Weight	1.4kg
Capacity	4L	Material	ABS
Dual power supply	DC Power or 4 * AA Battery (Not included)	Cable length	1.5m
Product List	Pet Feeder, Stainless Steel Bowl & Food Tray, Camera Host, Power Adapter, Type-C Charging Cable, Desiccant Bag, Instruction Manual		

## 八、WiFi Version Troubleshooting

Problem	Solution
Can't configure the feeder on your phone	<ol style="list-style-type: none"> <li>1) The WiFi account and password is composed of no more than 12 digits and letters. No special symbols are supported. Do not use Chinese.</li> <li>2) Mobile phone should connect with 2.4G WiFi. If your WiFi is 5G WiFi, set it to 2.4G WiFi.</li> <li>3) Make sure Bluetooth and Location Services "on" on your phone.</li> <li>4) Program problem, some Application conflicts may happen. Please restart your mobile.</li> </ol>
Feeder appears disconnected from WiFi	Weak disconnection, please check that the distance between your feeder and router is no more than 33ft/10m, and no concrete walls or too many obstacles between them. Otherwise the WiFi network can be weak and cause unstable connection.
The feeder can't dispense food or the feed portion is not accurate	<ol style="list-style-type: none"> <li>1) Please empty the food bowl before feeding.</li> <li>2) Please check if the food dispenser outlet is blocked, if yes, fix it before feeding.</li> <li>3) Clean the battery box and replace with new batteries.</li> </ol>
The pet feeder is not working when turned on	<ol style="list-style-type: none"> <li>1) Please check the power source is working and the powercord is connected properly.</li> <li>2) Please try to use the battery as power source to check if the pet feeder will work normally. (When the device is powered by battery backup power, you can't use the APP to remote control, but at this time the device still has a memory function and can be feed according to the feeding plan you set.)</li> </ol>
The color live videostream turns black and white	<p>Night Vision is set to Auto by default, the infrared light will automatically turn on when it is dark, and the real-time video stream will appear in black and white. Night vision turns off when there's enough ambient light.</p> <p>You can manually select the night vision to Auto/Always On/Always Off. Tap the Setting icon in the upper right corner-IR Night Vision.</p>
Is the camera device waterproof	The camera is not waterproof, please do not clean the camera main unit, just wipe it clean with a damp cloth.
Can the camera work without internet	No, the camera can only work properly if it is connected to the internet.

## **FCC Warning Statement**

Changes or modifications not expressly approved by the party responsible for compliance could void the user's authority to operate the equipment. This equipment has been tested and found to comply with the limits for a Class B digital device, pursuant to Part 15 of the FCC Rules. These limits are designed to provide reasonable protection against harmful interference in a residential installation. This equipment generates uses and can radiate radio frequency energy and, if not installed and used in accordance with the instructions, may cause harmful interference to radio communications. However, there is no guarantee that interference will not occur in a particular installation. If this equipment does cause harmful interference to radio or television reception, which can be determined by turning the equipment off and on, the user is encouraged to try to correct the interference by one or more of the following measures:

- Reorient or relocate the receiving antenna.
- Increase the separation between the equipment and receiver.
- Connect the equipment into an outlet on a circuit different from that to which the receiver is connected.
- Consult the dealer or an experienced radio/TV technician for help.

## **FCC Radiation Exposure Statement**

The antennas used for this transmitter must be installed to provide a separation distance of at least 20 cm from all persons and must not be co-located for operating in conjunction with any other antenna or transmitter.

## **This device complies with Part 15 of the FCC Rules. Operation is subject to the following two conditions:**

- (1) This device may not cause harmful interference.
- (2) This device must accept any interference received, including interference that may cause undesired operation.