

折线

正面

Display Unit



- 1 Arrow icon indicates the direction the temperature is trending
- 2 Channel, there are 3 RF channels selectable
- 3 Current Outdoor Temperature
- 4 Receive signal
- 5 Outdoor Sensor Low Battery Indicator

Outdoor Sensor

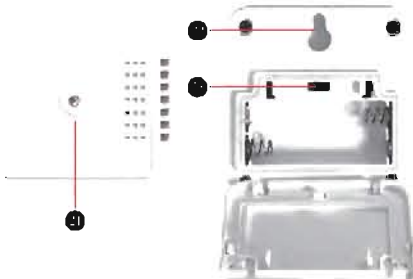

- 1 Arrow icon indicates the direction the humidity is trending
- 2 The Outdoor Temperature/Humidity of last 24 hours
- 3 Maximum or Minimum Outdoor Temperature/Humidity Record
- 4 Current Outdoor Humidity
- 5 Arrow icon indicates the direction the temperature is trending
- 6 Indoor thermometer

- 7 Maximum or Minimum Indoor Temperature/Humidity Record
 - 8 Arrow icon indicates the direction the humidity is trending
 - 9 Current Indoor Temperature
 - 10 Current Indoor Humidity
 - 11 Channel Selection/Search
 - 12 MAX/MIN/CLEAR button
 - 13 Backlight
 - 14 °F/°C/History Button
 - 15 Wireless Signal Indicator
- Flashes when data is being sent to the display unit
- 16 Hanging hole
 - 17 Slide to set channel 1,2 or 3

Product Specifications

Total 4 functional buttons:
CH/SEARCH , BACKLIGHT , °F/°C/HISTORY,
MAX/MIN/CLEAR.

Displays the indoor&outdoor humidity, temperature, trend and record maximum and minimum humidity/temperature.	
Indoor Temperature Range	14°F~122°F (-10°C~50°C)
Outdoor Temperature Range	-40°F~158F(-40°C~70°C)
Temperature Resolution	0.1°C/°F
Temperature Accuracy	±1°C/±1.8°F
Humidity Range	20%~95%
Humidity Resolution	1%
Humidity Range Accuracy	±5%RH(The humidity between 30%~70%)
Wireless Range	328ft/100m depending on empty place
Wireless Frequency	433 MHz

Weight:Main unit	About 131g
Weight: Sensor	About 40g
Size:Main unit	115*89*22mm
Size: Sensor	65*65*19.5mm
Power: Display	2 * AAA 1.5V
Power: Sensor	2 * AAA 1.5V
The Display Unit is capable of displaying the readings from up to 3 outdoor remote sensors to ensure you can monitor multiple locations at the same time such as your bedroom, baby's room and your outdoor temp. (There is 1 remote sensor in the package, extra sensors sold separately).	
Remarks: The outdoor sensor start reading the exact value and transmitting the signal after 30 minutes.	

反面

Product Back

Display Unit

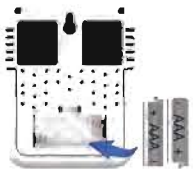

1. Open the battery compartment cover.
2. Insert 2 x AAA batteries into the battery compartment, as shown. Follow the polarity (+/-) diagram in the battery compartment.
3. Replace the battery cover.

Outdoor Sensor



Turn on the Backlight

Press 1 once to turn on the light and press 1 again to turn off the light. It will be auto off within 10 seconds without any operation.

Select Degrees Fahrenheit or Celsius

To select between degrees Fahrenheit (°F) or Celsius (°C) temperature units, press the 8 once.

Select Channel and SYNC

Press 1 once to display the temperature and humidity readings from up to 3 outdoor remote sensors. Press and hold 8 for 3 seconds to re-synchronize or re-pair the units. It may take a few minutes for synchronization to complete.

To Check All Time/24 HRs History Data

Press 1 once, in MAX/MIN mode, then press and hold the 8 button for 3 seconds to view the past (all times) or past 24 hours of temperature/humidity.

Using the MAX/MIN Records

MAXMIN Records reflect the minimum and maximum temperature recorded since the unit was powered on, since the batteries were changed or since it was manually reset (whichever was most recent). To view the MAX record, press the 7 once, the MAX icon appears on the display. To view the MIN record, press the 8 once, the MIN icon appears on the display. To reset the MAX/MIN records, press and hold the 1 for 3 seconds. Dashes will display to confirm all values have been cleared.

Placement for Maximum Accuracy

Sensors are sensitive to surrounding environmental conditions. Proper placement of both the display unit and outdoor sensor are critical to the accuracy and performance of this product.

Sensor must be placed outside to observe outdoor conditions. Sensor is rain-proof and is designed for general outdoor use, however, to extend its life place the sensor in an area protected from direct weather elements. (Warning: Sensor must be vertical placement.) Hang the sensor using the integrated hang holes or hanger, or by using string (not included) to hang it from a suitable location, like a well-covered tree branch. The best location is 4 to 8 feet, above the ground with permanent shade and plenty of fresh air to circulate around the sensor.

No Outdoor Sensor Reception

Replace the display unit and/or the outdoor sensor. The units must be within 328ft/100m of each other. Make sure both units are placed at least 3 feet (9m) away from electronics that may interfere with the wireless communication (such as TVs, microwaves, computers, etc.).

Outdoor Temperature is Flashing or Showing Dashes

Bring both the sensor and display unit indoors and remove at least one battery from each. Reinstall the battery in the outdoor sensor or display unit. Let the unit sit within a couple feet of each other for about 20 minutes to gain a strong connection.

Inaccurate Temperature

Make sure both the display unit and sensor are placed out of direct sunlight and away from any heat sources or vents.

Care Maintenance

Clean with a soft, damp cloth. Do not use caustic cleaners or abrasives. Keep away from dust, dirt and moisture. Clean ventilation ports regularly with a gentle puff of air.

FCC Statement

This equipment has been tested and found to comply with the limits for a Class B digital device, pursuant to Part 15 of the FCC Rules. These limits are designed to provide reasonable protection against harmful interference in a residential installation. This equipment generates uses and can radiate radio frequency energy and, if not installed and used in accordance with the instructions, may cause harmful interference to radio communications. However, there is no guarantee that interference will not occur in a particular installation. If this equipment does cause harmful interference to radio or television reception, which can be determined by turning the equipment off and on, the user is encouraged to try to correct the interference by one or more of the following measures:

- Reorient or relocate the receiving antenna.
- Increase the separation between the equipment and receiver.
- Connect the equipment into an outlet on a circuit different from that to which the receiver is connected.
- Consult the dealer or an experienced radio/TV technician for help.

This device complies with part 15 of the FCC Rules. Operation is subject to the following two conditions: (1) This device may not cause harmful interference, and (2) this device must accept any interference received, including interference that may cause undesired operation.

Changes or modifications not expressly approved by the party responsible for compliance could void the user's authority to operate the equipment.