



**METRO  
VSPR-800**

**Dual Bluetooth® Suitcase Turntable**



## **Instruction Manual**

Please read carefully before use and keep for future reference

# WARNING



**CAUTION:** To reduce the risk of fire or electric shock, do not expose this appliance to rain or moisture.



**WARNING:** Invisible laser radiation when open and interlock failed or defeated. Avoid direct exposure to laser beam.



This equipment is a Class II or double insulated electrical appliance. It has been designed in such a way that it does not require a safety connection to electrical earth.



Correct Disposal of this product. This marking indicates that this product should not be disposed with other household wastes throughout the EU. To prevent possible harm to the environment or human health from uncontrolled waste disposal, recycle it responsibly to promote the sustainable reuse of material resources. To return your used device, please use the return and collection systems or contact the retailer where the product was purchased. They can take this product for environmental safe recycling.

## Important Safety Instructions

1. Read these instructions – All the safety and operating instructions should be read before this product is operated.
2. Keep these instructions – The safety and operating instructions should be retained for future reference.
3. Heed all warnings – All warnings on the appliance and in the operating instructions should be adhered to.
4. Follow all instructions – All operating and use instructions should be followed.
5. Do not use this apparatus near water – The appliance should not be used near water or moisture – for example, in a wet basement or near a swimming pool, and the like.
6. Clean only with a dry cloth.
7. Do not block any ventilation openings. Install in accordance with the manufacturer's instructions.
8. Do not install near any heat sources such as radiators, heat registers, stoves, or other apparatus (including amplifiers) that produce heat.
9. Protect the power cord from being walked on or pinched particularly at the plugs, power outlets, and at the point where they exit from the apparatus.
10. Only use attachments/accessories specified by the manufacturer.
11. Use only with the cart, stand, tripod, bracket, or table specified by the manufacturer, or sold with the apparatus. When a cart or rack is used, use caution when moving the cart/apparatus combination to avoid injury from tip-over.
12. Unplug the apparatus during lightning storms or when unused for long periods of time.
13. Refer all servicing to qualified personnel. Servicing is required when the apparatus has been damaged in any way, such as power supply cord or plug is damaged, liquid has been spilled or objects have fallen into the apparatus has been exposed to rain or moisture, does not operate normally, or has been dropped.
14. The mains plug is used as disconnect device, the disconnect device shall remain readily operable.
15. **WARNING:** To reduce the risk of fire or electric shock, do not expose this apparatus to rain or moisture. The apparatus shall not be exposed to dripping or splashing and that no objects filled with liquids, such as vases, shall not be placed on apparatus.
16. The use of the equipment in moderate climate.
17. The ventilation should not be impeded by covering the ventilation openings with items, such as newspapers, tablecloths, curtains, etc.
18. Do not place open flame sources, such as lighted candles, on the apparatus.
19. The symbol  $wi\sim$  indicates AC voltage.
20. **CAUTION,** These servicing instructions are for use by qualified service personnel only. To reduce the risk of electric shock do not perform any servicing other than that contained in the operating instructions unless you are qualified to do so.



This lightning flash with arrowhead symbol within an equilateral triangle is intended to alert the user to the presence of non-insulated "dangerous voltage" within the product's enclosure that may be of sufficient magnitude to constitute a risk of electric shock. Warning: To reduce the risk of electric shock, do not remove cover (or back) as there are no user-serviceable parts inside. Refer servicing to qualified personnel. The exclamation point within and equilateral triangle is intended to alert the user to the presence of important operating and maintenance instructions in the literature accompanying the appliance.



# TABLE OF CONTENTS

FEATURES.....	3
SPECIFICATIONS .....	3
PRODUCT OVERVIEW .....	4
SET UP & BASIC OPERATION.....	5
MAINTENANCE .....	6
FCC NOTICE .....	8
CAUTION ON MODIFICATIONS .....	9
SUPPORT .....	9

# FEATURES

The Metro Suitcase Record Player has a full assortment of features at a popular, entry level price point! The 3-speed turntable will play 33 1/3, 45, and 78 RPM records. The Dual Bluetooth Feature allows you to stream music from another source through the Metro's built-in stereo speakers or stream your vinyl albums to any external Bluetooth speaker. With a convenient carrying handle and latches, the Metro is ready to travel to where ever the Music goes. The 3.5mm Auxiliary & Headphone input all for even further playback options.

- 3-Speed record player will play 33 1/3, 45, 78 RPM records
- Bluetooth® In connectivity allows you to stream music from another source up to 33 feet away
- Bluetooth® Out Connectivity allows you to stream vinyl playback through any external Bluetooth Speaker
- Premium Carrying Handle and Metal Hardware allows for portability while giving the Metro a great look
- Includes a 3.5mm Aux input & Headphone Jack for additional connectivity options
- Red Vinyl Finish with Silver Hardware & Black Carrying Handel
- Built in Stereo Speakers for playback convenience

# SPECIFICATIONS

Product Name	METRO (Dual Bluetooth Suitcase Turntable)
Turntable Speed	33 1/3, 45, 78 RPM
Bluetooth® Version	Bluetooth® V5.0
Bluetooth® Frequency	2.40 GHz
Bluetooth® Operating Distance	Up to 33 Feet (10 Meters)*
Input	Aux In
Output	Line Out
Built-in Speakers	2" x 2
Speaker Output Power	1W x 2
Power Source	AC/DC 100-240V 50-60Hz 5V/1A
Accessories Included	ETL Approved Power Adaptor, User Manual, Quick Set Up Guide

\*Distance may vary depending on any objects or interference between devices.

SPECIFICATIONS AND ACCESSORIES ARE SUBJECT TO CHANGE WITHOUT NOTICE

# PRODUCT OVERVIEW

1. Secure case latch
2. Corner protectors
3. Protective dust cover and carrying case
4. Adapter for use with 45 RPM records with cut out centers.
5. Tone arm lift
6. Auto stop control
7. Bluetooth LED indicator
8. Bluetooth switch
9. Speed selector (33.3, 45, 78 rpm)
10. Power switch / Volume control
11. Headphone jack
12. Cartridge
13. Left & Right Speakers



14. Aux in
15. Line out R channel
16. Line out L channel
17. DC power jack

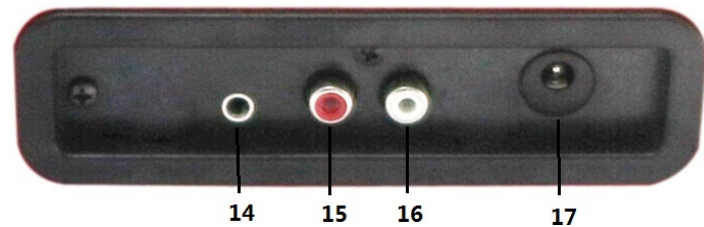

# SET UP & BASIC OPERATION

## Power Connection

Ensure that the voltage of your home corresponds to the operating voltage of the unit. Your unit is ready to be connected to a 5V DC adaptor.

## Playing a Record

1. Place the record of your choice on the turntable. If required, use the 45 RPM adaptor on the record spindle.
2. Choose the desired playing speed using the speed selection switch (33.3, 45 or 78 RPM).
3. Turn on the Rotary Power Switch. Note that this also controls volume.
4. Release the tone arm lock.
5. Raise the arm with your hand lightly.
6. Place the stylus vertically over the first track of the record, the turntable will start turning automatically.
7. Put down the stylus slowly on to the record to play.
8. When a record comes to the end, the turntable will stop automatically if the auto-stop switch is in the ON position. If the switch is in the OFF position the turntable will keep revolving until the tone arm is returned to the tone arm rest.
9. Lift up the tone arm and put it on the rest when finished.
10. Replace the protective cap on the stylus and close the tone arm lock.
11. Turn off power.

## Connect to External Audio System

You can listen to your new turntable using the built-in speakers but you may wish to connect it to your existing audio system. Connect the audio plugs to the Line input on your mixer or amplifier using an RCA cable (not supplied).

- Red plug into R/H channel input.
- White plug into L/H channel input.

## Connect a Bluetooth® Device to the Turntable

1. Switch the knob to Bluetooth® mode. A blue LED will begin flashing and a voice indicates the turntable is in pairing mode.
2. Search for the turntable in the list of Bluetooth® devices named “VICTOR VSRP-800” and connect.
3. A chime and a steady blue LED light will indicate you have paired with the turntable successfully.

## Connect the Turntable to an External Bluetooth® Speaker

1. Turn on pairing mode on your Bluetooth® speaker.
2. Turn the Bluetooth® knob to the “BT Out” position on the turntable. The LED light flashes to indicate the device is searching for an available Bluetooth® speaker.
3. When the turntable connects to the Bluetooth® speaker, the LED light stays lit. After the speaker is paired successfully, turntable audio signal can be transmitted.

# MAINTENANCE

## Maintaining the Turntable Needle (“Stylus”)

To extend the life of your stylus, dust the stylus occasionally with a very soft brush dipped in rubbing alcohol, brushing from the back to the front of the cartridge.

## Maintaining Vinyl Records

To maximize sound quality and extend the life of your vinyl records, it is recommended you clean your records with an anti-static cloth after every use.

## Transporting the Turntable

1. Place the protective cap on the stylus.
2. Put the rest clip into the pick-up arm.
3. Ensure the case is closed and the latch is secure.

## Installing or Replacing the Stylus

The stylus needs to be replaced periodically. It is recommended the stylus be replaced after 250 hours of play. To install a new stylus or replace the existing stylus, follow the steps below:

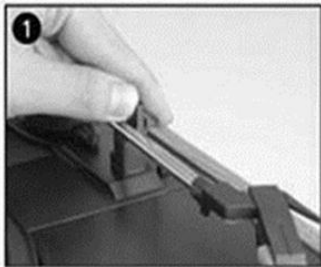

1 Push the arm lock to release the tone-arm.

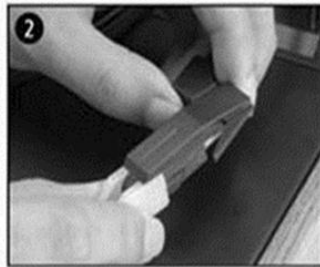

2 Remove the cartridge cap to expose the needle.

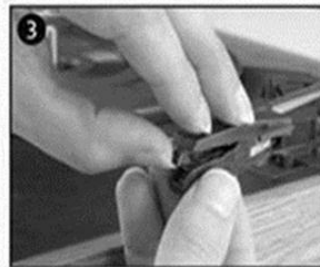

3 Gently separate the cartridge from the socket.



4 Remove the audio-line from the cartridge.

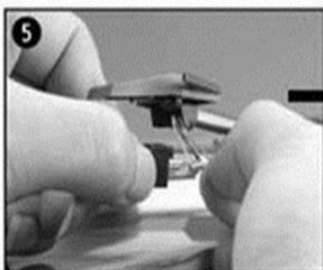

5 Align the audio-line with the new cartridge.

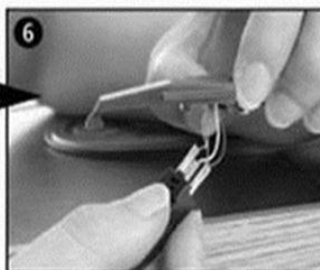

6 Insert the audio-line into the new cartridge.

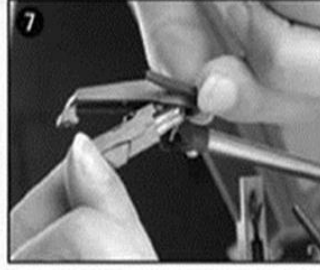

7 Gently insert the cartridge into the socket.

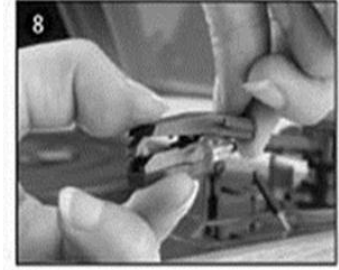

8 Attach the cartridge cap.

**NOTE:** Please exercise extreme care whilst performing this operation so as to avoid the tone arm and audio line wires from any damage.

## Re-Attaching the Turntable Drive Belt

If your turntable fails to revolve, the drive belt may have come detached. Follow the steps below to reattach the turntable drive belt:

### Step 1

Remove the turntable anti-slip mat from the platter. Looking through one of the holes in the platter, check if the belt has indeed come off the turntable pulley. Use a screwdriver to remove the black iron 'C'-clip (iron binder) and lift the turntable off the Turntable mechanism.

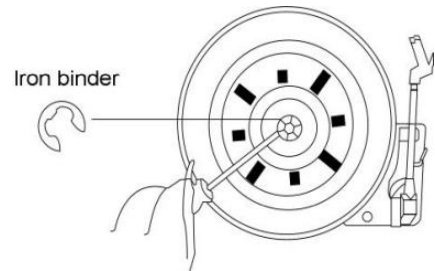

### Step 2

Retrieve the detached black rubber band (the drive belt) and place it around the platter base - then pull the belt out gently from underneath the platter without overstretching.

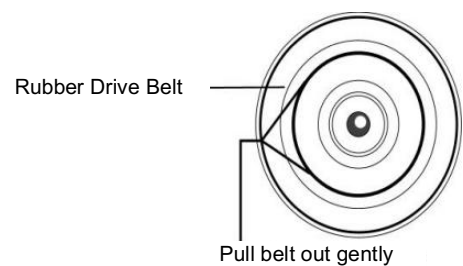

Turn the platter over while holding on to the belt.

### Step 3

Looking through one of the holes in the platter, locate the small Brass Pulley (the pulley is attached to the turntable motor). Then proceed to hook the pulled out part of the rubber belt by hand around the Pulley and then line up the center of the platter with the silver turntable spindle.

Lower the platter gently onto the deck and let go until it is back in position.

### Step 4

When the turntable platter is in the correct position, check the belt is still around the pulley and then replace the 'C'-clip to secure the turntable to the spindle.

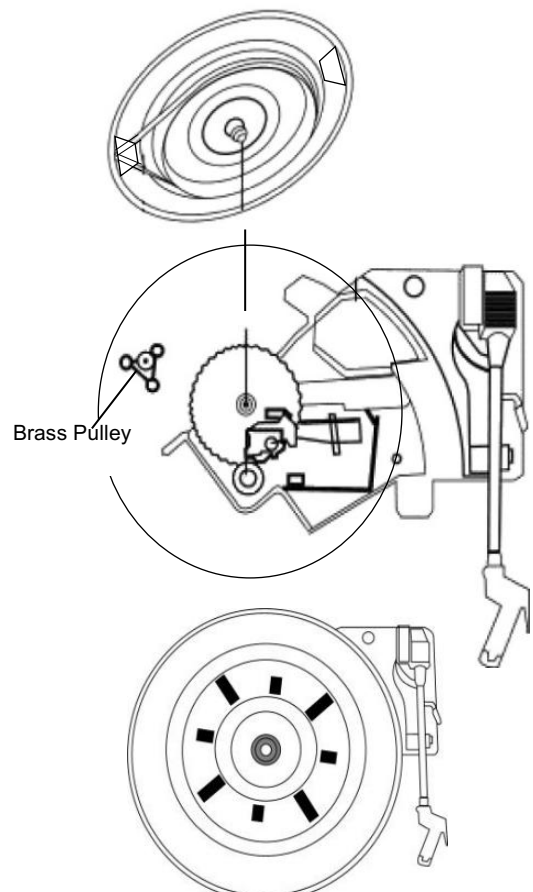

### Step 5

Place the turntable anti-slip mat on the platter. Use the turntable as normal to confirm the turntable now revolves appropriately.



# FCC NOTICE

This device complies with Part 15 of the FCC Rules. Operation is subject to the following two conditions: (1) this device may not cause harmful interference, and (2) this device must accept any interference received, including that may cause undesired operation.

NOTE: This equipment has been tested and found to comply with the limits for a Class B digital device, pursuant to Part 15 of the FCC Rules. These limits are designed to provide reasonable protection against harmful interference in a residential installation. This equipment generates, uses, and can radiate radio frequency energy and, if not installed and used in accordance with the instructions, may cause harmful interference to radio communications. However, there is no guarantee that interference will not occur in a particular installation. If this equipment does cause harmful interference to radio or television reception, which can be determined by turning the equipment on and off, the user is encouraged to try to correct the interference by one or more of the following measures:

- Reorient or relocate the receiving antenna.
- Increase the separation between the equipment and receiver.
- Connect the equipment into an outlet on a circuit different from that to which the receiver is connected.
- Consult the dealer or an experienced radio/TV technician for help.

WARNING: Any changes or modifications not expressly approved by the party responsible for compliance could void the user's authority to operate this equipment.

The device must not be colocated or operating in conjunction with any other antenna or transmitter.

To maintain compliance with the FCC's RF exposure guidelines, place the product at least 20cm from nearby persons.

# IC STATEMENT

This device complies with RSS247 of Industry Canada. Cet appareil se conforme à RSS247 de Canada d'Industrie. This device complies with Industry Canada license-exempt RSS standard(s). Operation is subject to the following two conditions: (1) this device may not cause interference, and (2) this device must accept any interference, including interference that may cause undesired operation of the device. appareils radio exempts de licence.

Son fonctionnement est sujet aux deux conditions suivantes: (1) le dispositif ne doit pas produire de brouillage préjudiciable, et (2) ce dispositif doit accepter tout brouillage reçu, y compris un brouillage susceptible de provoquer un fonctionnement indésirable.

The device must not be co-located or operating in conjunction with any other antenna or transmitter. L'appareil ne doit pas être localisé ou fonctionner avec d'autres antennes ou transmetteurs.

This device complies with IC radiation exposure limits set forth for an uncontrolled environment. Cet appareil est conforme aux limites d'exposition aux rayonnements de la IC établies pour un incontrôlé environnement.

The device should be installed and operated with a minimum distance of 20cm between the radiator and your body.

L'appareil doit être installé et utilisé avec une distance minimale de 20 cm entre le radiateur et votre corps.

# CAUTION ON MODIFICATIONS

Any changes or modifications not expressly approved by the grantee of this device may void the authority granted by the FCC to operate this equipment. Electric and electronic equipment contains materials, components and substances that can be hazardous to your health and the environment, if the waste material (discarded electric and electronic equipment) is not handled correctly. Electric and electronic equipment is marked with the crossed out trash can symbol, seen below. This symbol signifies that electric and electronic equipment should not be disposed of with other household waste, but should be disposed of separately. All cities have established collection points, where electric and electronic equipment can either be submitted free of charge at recycling stations and other collection sites, or be collected from the households. Additional information is available at the technical department of your city.



## CALIFORNIA PROP 65 WARNING

“WARNING” This product contains chemicals known to the State of California to cause birth defects or other reproductive harm. For more information on these regulations and a list of chemicals, visit the following website address: <http://www.oehha.ca.gov/prop65.html>

# SUPPORT

We do our best to offer high quality products to our customers. If you experience any issues or problems with your product, please contact customer support as many issues can be quickly resolved.

If you have problems with your device, please consult the instructions in this manual. Please also visit us on the web at [www.naxa.com](http://www.naxa.com) to get up to the minute news, alerts, and documentation for your device. For additional assistance, please contact Naxa Technical Support.

### Naxa Technical Support

2320 East 49<sup>th</sup> St.  
Vernon, CA 90058  
(866) 411-6292

<http://www.naxa.com/supportcenter>

*\*This product has been manufactured and sold under the responsibility of NAXA ELECTRONICS INC.*

*VICTOR and the DOG & GRAMOPHONE logo are trademarks used under license by NAXA ELECTRONICS INC.*

*Further information at [www.victor-brand.com](http://www.victor-brand.com).*

*All other products, services, companies, trademarks, trade or product names and logos referenced herein are the property of their respective owners.*