

# XAG RevoSling

## User Manual

Version 1.0 **EN**

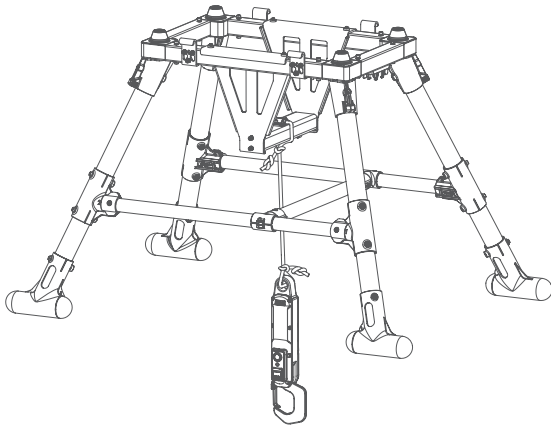

## **To User**

Dear user, thank you for choosing XAG's products.

For safety purposes and better user experience, it is highly recommended that you read this manual carefully and strictly follow the instructions hereof.

## **Contact Us**

Manufacturer: Guangzhou Xaircraft Technology Co., Ltd.

Add: XSpace, No.115, Gaopu Road, Guangzhou, Guangdong Province, China

Technical Support Team: support@xa.com

# Table of Contents

<b>Operating Instructions</b>	1
<b>List of Items</b>	2
<b>Main Components</b>	3
<b>Assembly</b>	5
Install Lifting Frame	5
Install Cable Holder	5
Install Landing Gear	6
Install Smart Hook	8
Remove RevoSpray	9
Install RevoSling	10
<b>Use of RevoSling</b>	11
Charging	11
Power On/Off	11
Bind Device	11
Firmware Update	11
App UI	12
Manual Test	13
RevoSling Operation	13
Operation Safety Requirements	13
<b>Maintenance</b>	14
<b>Transportation and Storage</b>	14
<b>Battery Warnings</b>	14
<b>Specifications</b>	15
<b>Disclaimer</b>	16
<b>Warning</b>	17

# Operating Instructions

- **XAG RevoSling** (Model: M4XRSP80A) is exclusively designed for use with the XAG P150 Max Agricultural Drone (2025 model) and is intended for lifting operations in farming, forestry, animal husbandry, and fishery scenarios. It must not be used with other products or for other purposes.
- This product should be operated in clear, cloudy, or overcast weather conditions with a wind scale of force 3 or below. It is prohibited to use the product in adverse weather conditions such as rain, snow, frost, fog, thunderstorms, hail, sandstorms, or strong winds, at altitudes above 2,000 meters, or in environments with strong magnetic interference.
- Exercise extreme caution when using this product. When taking off, landing, hovering, or operating a drone with RevoSling, ensure that no personnel, animals, or obstacles are present within a 10-meter radius of the drone's area. When planning flight routes, observe the surrounding environment and avoid areas with people, animals, or obstacles to ensure safety.
- When operating the agricultural drone, maintain visual line-of-sight and continuously monitor the flight status. If people or animals approach, issue warnings promptly and control the drone accordingly. If abnormalities occur with the carried load, monitor closely and initiate a return or emergency landing to prevent accidents.
- For safety, operators must wear helmets, protective gloves, and other safety gear when performing lifting operations with the agricultural drone.
- The maximum allowable load for this product is 80 kg, and the lifting rope length must be between 5 and 15 meters. Exceeding these limits may affect normal operation or cause safety hazards.
- Before operation, ensure that all spray rods of the agricultural drone have been removed to prevent contact or entanglement between the lifting rope, cargo, and spray rods or other situations that could damage spray rods or lead to accidents.
- Conduct a thorough inspection before each operation: verify that all structural components are properly installed, the landing gear is stable, the lifting rope is securely attached to the rope tube (without excessive wear) and smart hook (functional), the wireless link is stable, and no mechanical abnormalities are present.
- Inspect the lifting rope before each operation. Replace it immediately if significantly worn to prevent accidents.
- Do not load or unload cargo until the agricultural drone comes to a complete stop after landing.
- When the product is not in use, perform a comprehensive cleaning and inspection. Ensure that the spring snap and the rope hole are unobstructed and free of abnormalities, then store the product in a dry, cool, and secure location.
- Modification, alteration, or repurposing of this product is strictly prohibited, as it may lead to safety hazards.
- The use of non-genuine XAG parts, lifting ropes, or accessories may severely compromise product safety and lifespan. Damage or losses caused by non-genuine XAG accessories are not covered under warranty. If non-genuine parts result in malfunction, operational issues, or product damage, the user assumes full financial and legal responsibility.
- When operating conventional agricultural drones for lifting tasks at altitudes exceeding 30 meters, users must hold a medium-sized drone operator license issued by the national civil aviation authority and obtain prior approval from air traffic control authorities before operations.
- Users must strictly follow the product's User Manual and operating instructions for installation, use, and maintenance. Any product damage, losses, or legal liabilities arising from non-compliance with this manual are the sole responsibility of the user.

# List of Items

The list of items contains two packages - the **RevoSling Main Unit** and the **Landing Gear**. When unboxing, check the package contents against the list. Immediately contact your seller regarding any missing items.

## RevoSling Main Unit



Smart Hook  
×1



Side Mount  
×2

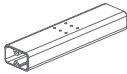

Rope Tube  
×1



Vertical Bar  
×1



Fixing Clamp  
×2



T-Connector  
×2



Saddle Mount  
×1

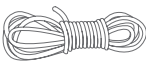

15-meter Rope  
×1



Screw Kit  
×1

---

## Landing Gear

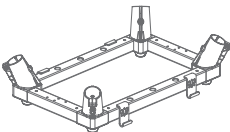

Frame  
×1



Landing Gear 1  
×2



Landing Gear 2  
×2



Fixing Clamp  
×4



Horizontal Bar  
×2



Cable Holder  
×1



Screw Kit  
×1

⚠ Components from the RevoSpray System are compatible for reassembly into the RevoSling System's landing gear.

# Main Components

## RevoSling

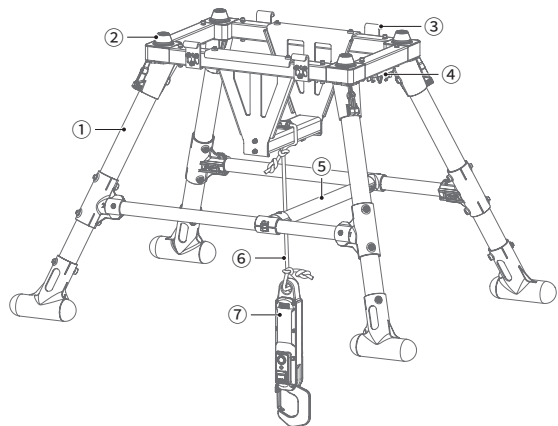

- ① Landing Gear
- ② Boss
- ③ Hook
- ④ Cable Holder
- ⑤ Vertical Bar
- ⑥ Rope
- ⑦ Smart Hook

## Smart Hook

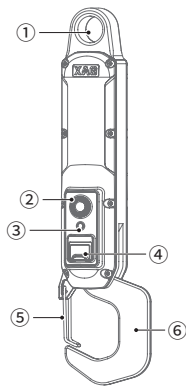









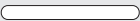

- ① Rope Hole
- ② Button
- ③ Status Indicator
- ④ Charging Port
- ⑤ Safety Latch
- ⑥ Adjustable Hook

## Button Instructions

Status	Action	Description
Sleep	Long Press for 2s	Power on
Powered On	Press Once	Open hook
	Long Press for 2s	Power off
	Short press + Long press	Unbind hook

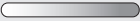
## Indicator Instructions

Status Indicator		Description
Off		Powered off
Solid Yellow		Disconnected from drone (bound)
Slow Flashing Yellow		Disconnected from drone (unbound)
Slow Flashing Green		Normal
Slow Flashing Red		Low battery
Solid Red		Malfunction
Breathing Green		Charging in progress
Solid Green		Charging complete
Breathing Red		Charging chip failure
Breathing Purple		Update in progress

# Assembly

## Install Lifting Frame

- ① Use four (4) M5×10 screws to secure two side mounts onto the two longer sides of the frame.
- ② Align and install the saddle mount onto the rope tube, then secure with two (2) M4×8 screws to assemble the rope tube component.
- ③ Use four (4) M5×16 screws to fix the rope tube component onto the side mounts.

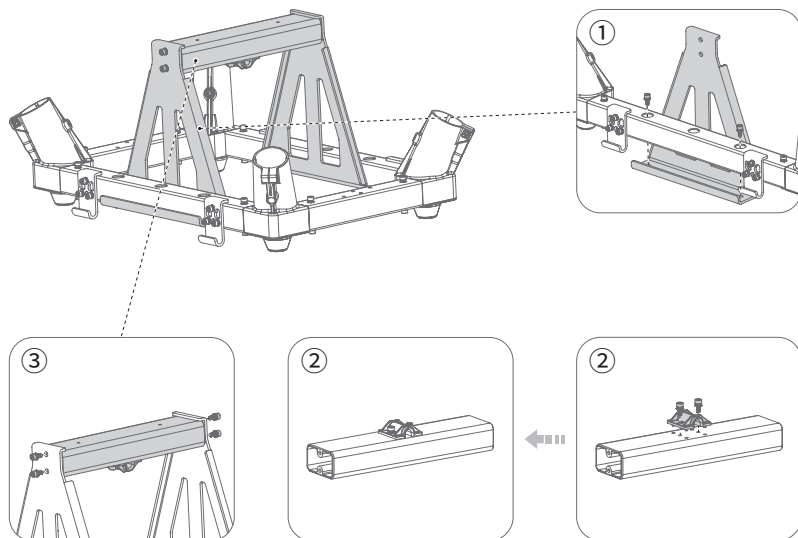

## Install Cable Holder

Position the cable holder at the rear end of the frame and secure with two (2) M4×12 screws.

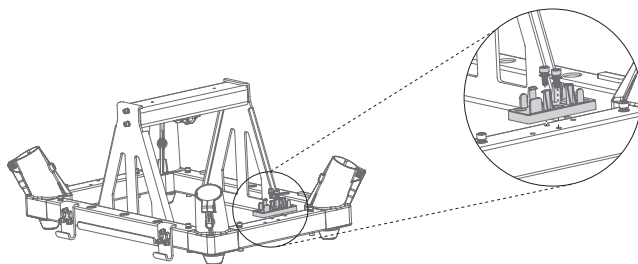



## Install Landing Gear

- ① Insert **Landing Gear 2** into the front-left hole of the frame (ensure the longer end of the ground contact piece faces outward). Loosely fix with one (1) M4×45 screw. Temporarily tighten with one (1) M4×12 screw. After adjustment, fully tighten all screws to secure the landing gear to the frame.

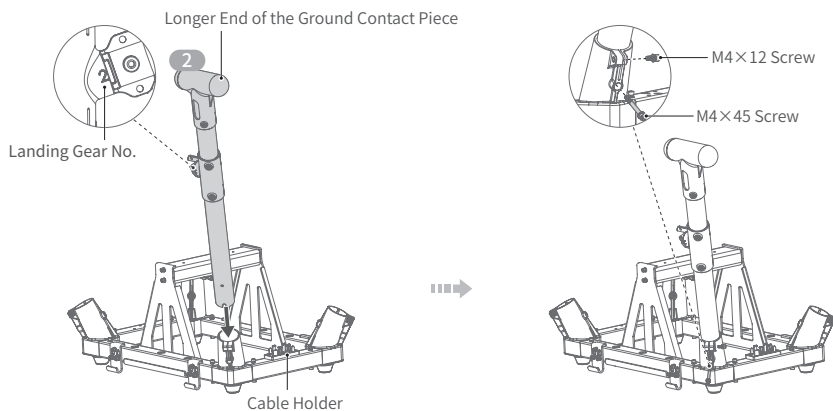

### Note

- ⚠ **Reference Orientation:** When the lifting frame is inverted, the cable fixing bracket faces the rear. Landing Gear 1 is installed on the front-left, and Landing Gear 2 on the rear-left. Diagonal pairs share the same landing gear number.
- ② Repeat the above steps to install the **Landing Gear 1** on the front-left.

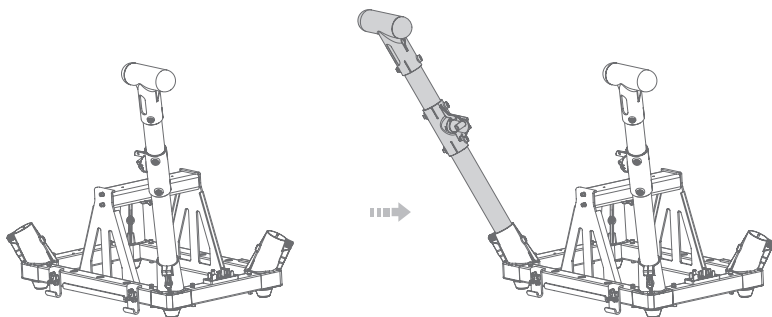

- ③ Slip the T-connector over the horizontal bar, then loosely secure with one (1) M4×16 screw to complete the horizontal bar component.

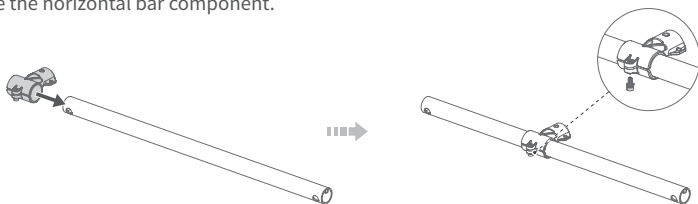

- ④ Align the horizontal bar component with the locating pins of T-connectors on both landing gears. Snap into place, install two (2) fixing clamps, and temporarily secure with two (2) M4×16 screws. After final adjustments, fully tighten all screws to complete the left-side landing gear installation.

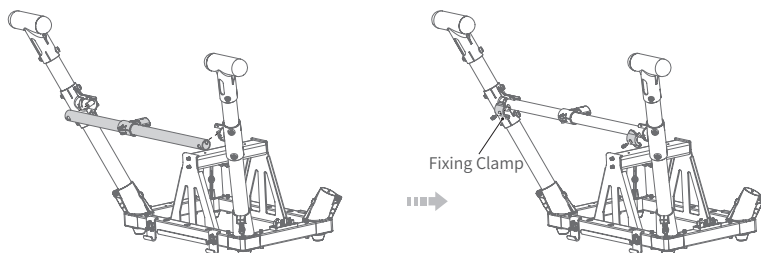

- ⑤ Repeat the process for the opposite side.

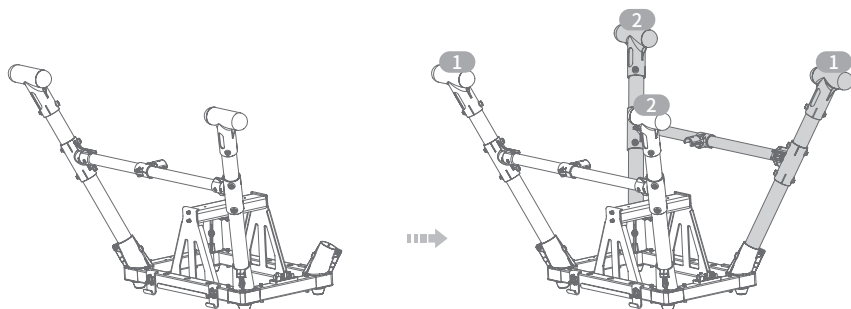

- ⑥ Flip the frame to its upright position. Slide the T-connector toward the rear end of the horizontal bar (approximately 160 mm from the end) and tighten the set screw. Align the vertical bar with the locating pin of the T-connector and snap into place. Secure with two (2) fixing clamps and two (2) M4×16 screws to complete the landing gear installation.

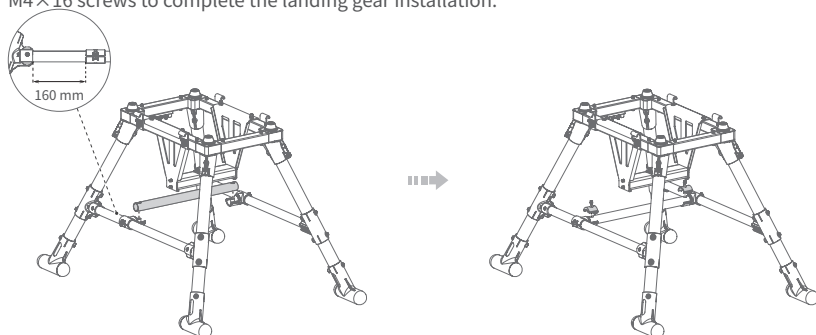

#### **Note**

- ⚠ Always install Landing Gear 1 and Landing Gear 2 in their designated positions. Swapping them will result in installation failure or damage.
- ⚠ To prevent rope entanglement, fix the vertical bar around 160 mm from the rear end of the horizontal bar.

## Install Smart Hook

- ① Pass the rope through the saddle mount, tie a self-locking knot, and then tie a safety knot to ensure the rope is securely fastened.
- ② Pass the other end of the rope through the hole at the top of the hook, then tie a safety knot to complete the installation of the smart hook.

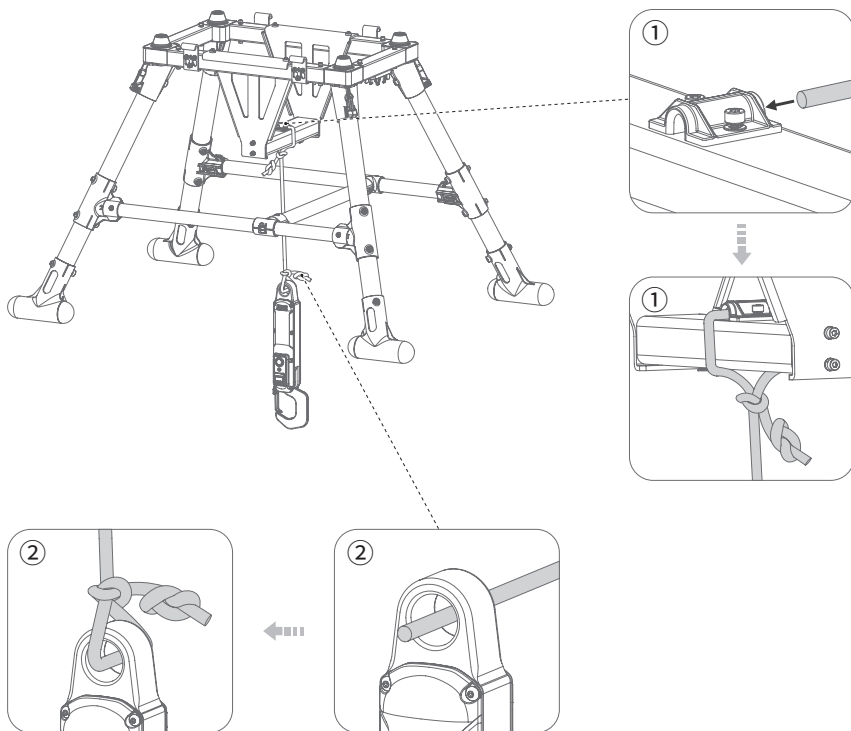

### Note

- ⚠ The knot in the figure is for reference only. Please refer to the actual product during operation.
- ⚠ To ensure the rope is securely fastened, safety knots must be added to both ends of the rope.