

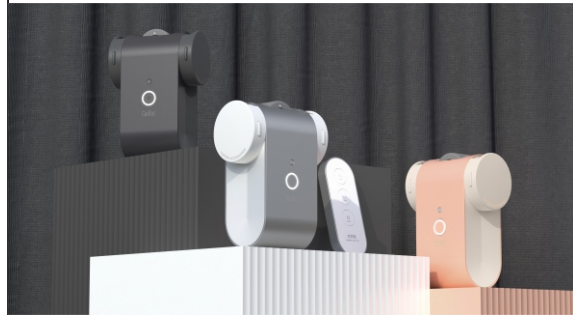

www.oter-group.com



CurBot 1S
Enjoy Your Spiritual Home

CurBot 1S

Smart Curtain Robot

In The Box	01
CurBot Instruction	02
Track preparation	03-04
CurBot preparation	05-06
Installation	07-16
Charge	17
Control	18-31
Specifications	32
Return and Refund	33
Contact and Support	34

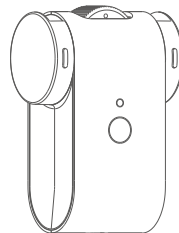

CurBot 1S

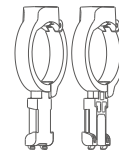

Rod hooks

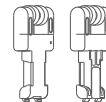

I-rail hooks

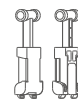

U-rail hooks

Remote

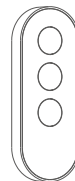

Hub 1S

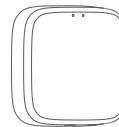

Type-C

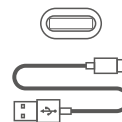

Micro-USB

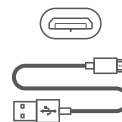

CurBot Instructions

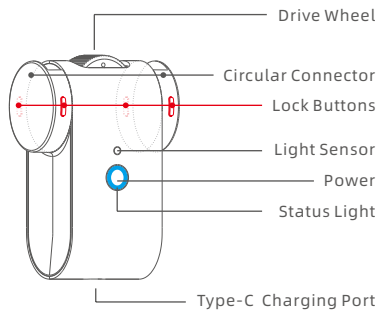

* LED description

Function	LED status
Pairing	Breathing White
Complete pair	White
Charging	Breathing White
Full Charge	White

* Power button description

Function	Time to Press
Power on / off	2 s

Function	Press Times
Add Remote	2 times
Reset	6 times

Track Preparation

1. Watch the track to find the matching hook

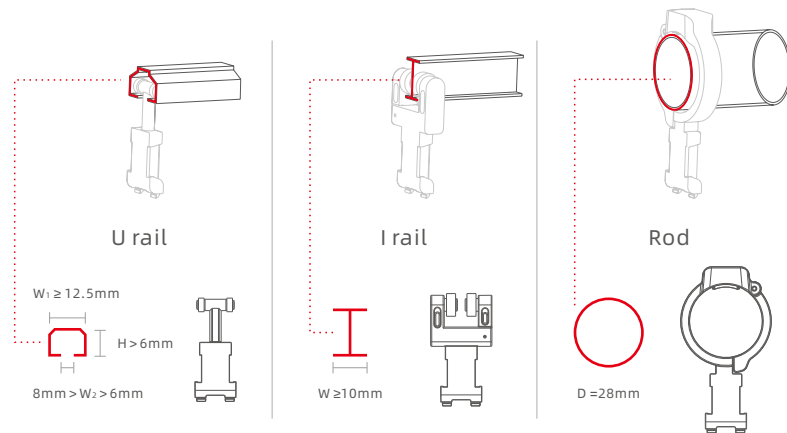

2. Wipe off the dust in advance to keep the track clean and smooth.

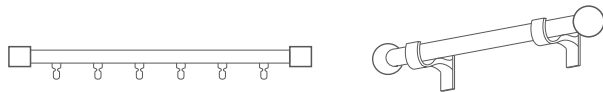

3. Close the curtains completely



* The bottom of the track should be smooth, not raised or spliced.

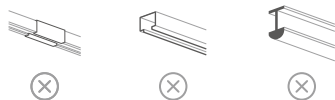

* The thickness of the rod uniform

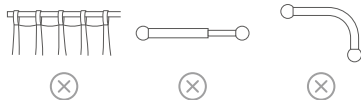

CurBot Preparation

1. Press the 2 locking buttons of the circular connector to remove it.

(Remove the circular connector on the other side in the same way)

Push the lock buttons

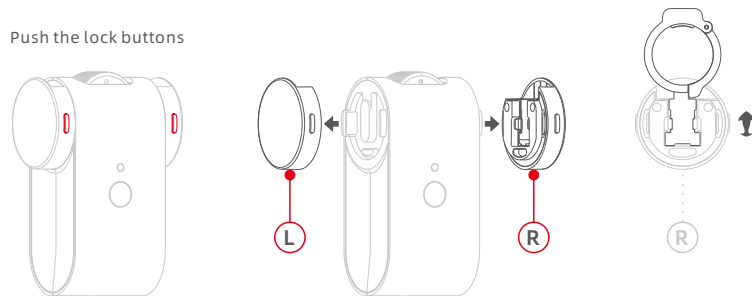

2. Attach the track hook to the circular connector until 2 the locking buttons out.

(Attach the hook to other circular connector in the same way)

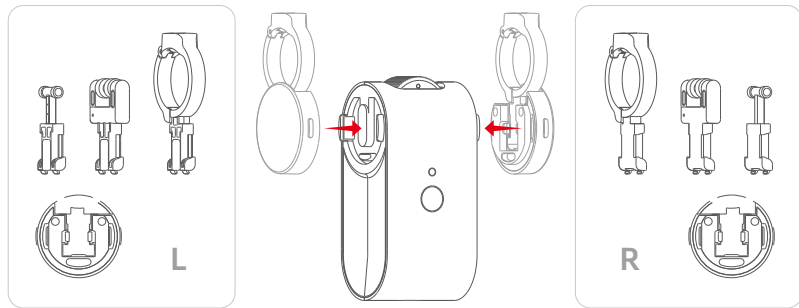

Note: The left and right ends of the rod and U rail are different

1. Attach U-rail hooks to the circular connector until 2 locking buttons out.

U Rail

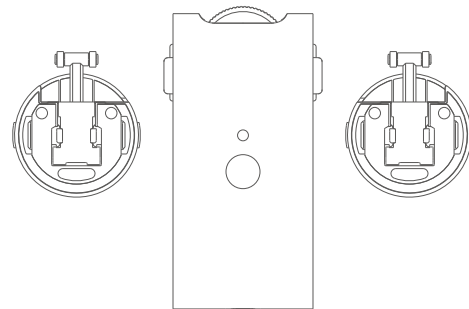

2. Hang the hooks on the curtain rail, between the first and the second curtain clips.
3. Rotate and align the 2 circular connectors until they face each other.

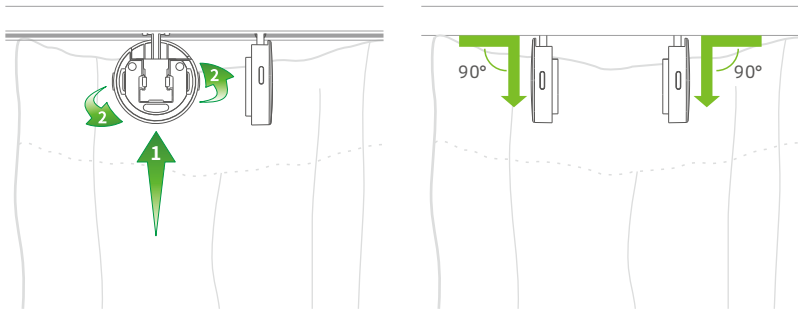

4. Assemble the 2 circular connectors with the main body in sequence.
5. ① The drive wheel should stick to the rail, If not, the hooks may be too tight. Remove and reassemble.
② The CurBot must be perpendicular to the rail..

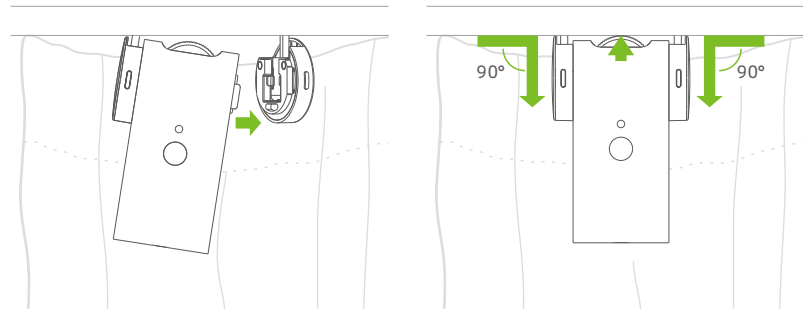

1. Attach I-rail hooks to the circular connector until the 2 locking buttons are out.

I Rail

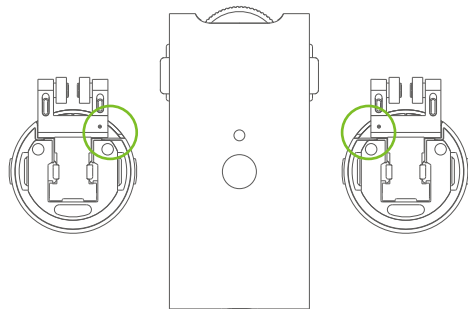

Note: hooks are different on the left and right, and install them according to the picture.

2. Hang the hooks on the curtain rail, between the first and the second curtain clips.
3. Rotate and align the 2 circular connectors until they face each other..

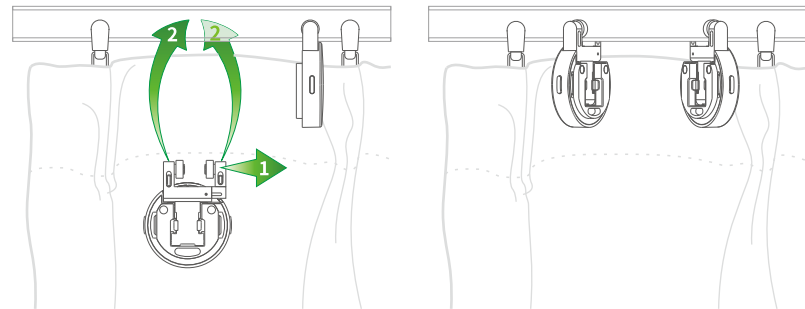

4. Assemble the 2 circular connectors with the main body in sequence.
5. ① The drive wheel should stick to rail, If not, the hooks may be too tight.
Remove and reassemble.
- ② The CurBot must be perpendicular to the rail.

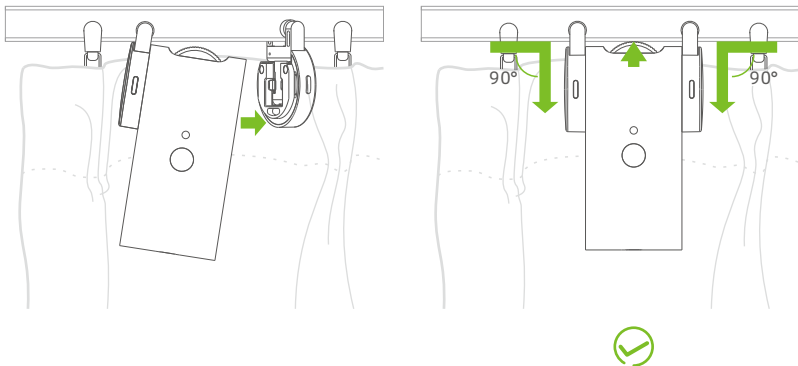

1. Attach the I-rail hooks the o circular connector until the 2 locking buttons are out.

Rod

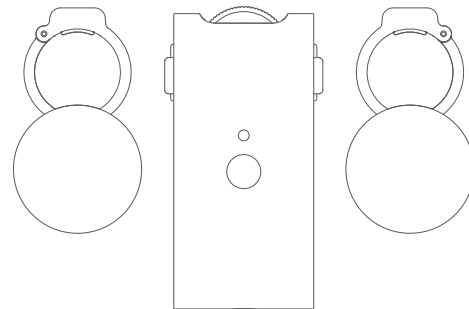

Note: hooks are different on the left and right. Install them according to the picture.

2. Open the hooks

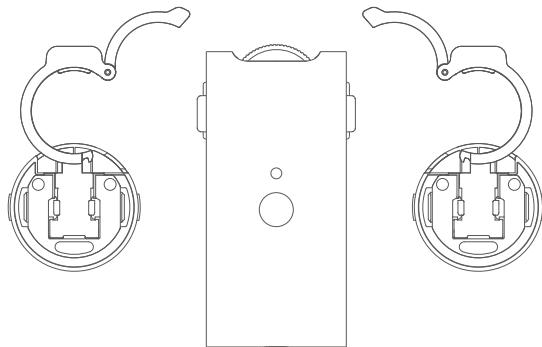

3. Hang on the hooks on the curtain rail, between the first and the second curtain clips.

(The hook of rod has a snap lock and needs to be pressed tightly)

4. Rotate and align the 2 circular connectors until they face each other, Lock clasp.

5. Assemble the 2 circular connectors with the main body.

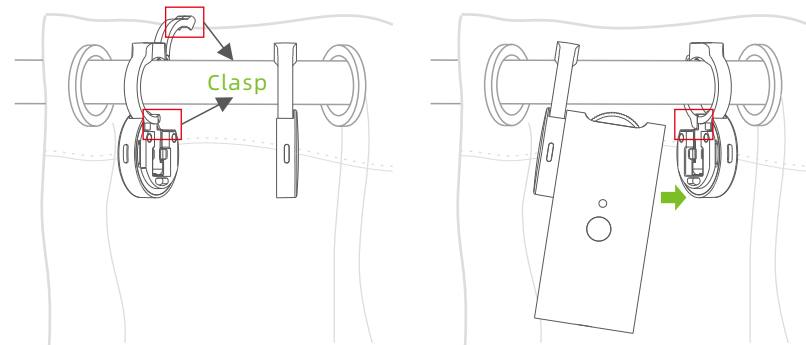

6. ① The drive wheel should stick to the rail, If not, the hooks may be pulled too tight.

Remove and reassemble.

② The CurBot must be perpendicular to the rail.

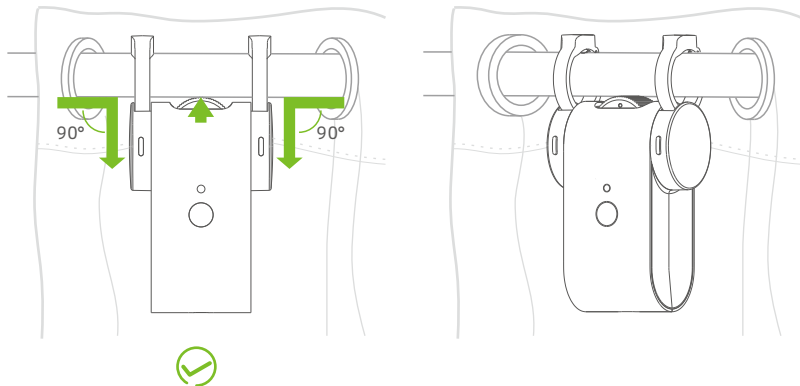

Charge

When the CurBot battery is lower than 10%, the APP pls prepare to charge :

- 1.Remove device: Hold the CurBot by hand, press 2 locking buttons of the circular connector to separate 2 circular connectors from the main body in turn.
- 2.Use the USB charging cable.
Insert the Type-C plug into the charging port on the body, the status light will start to flash.
- 3.When the status light stop flash, the charging is complete.

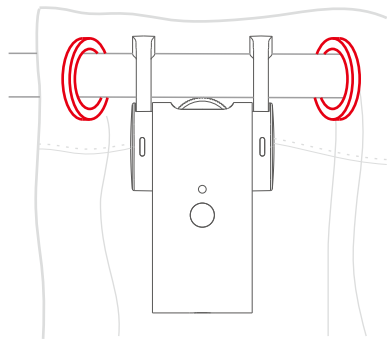

CurBot Scene

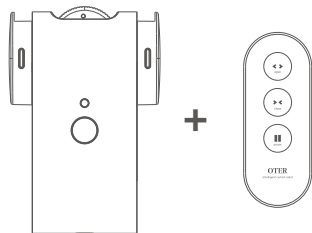

Open, Close and Pause controls available

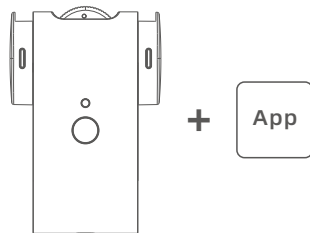

In addition to scene 1, add light sensing and percentage control、touch&go.)

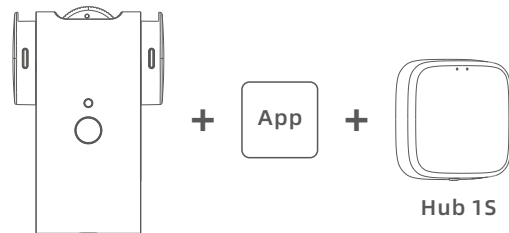

In addition to scene 2, add voice control, scene control (linked to 30k+ Tuya equipment), etc.

Remote Control

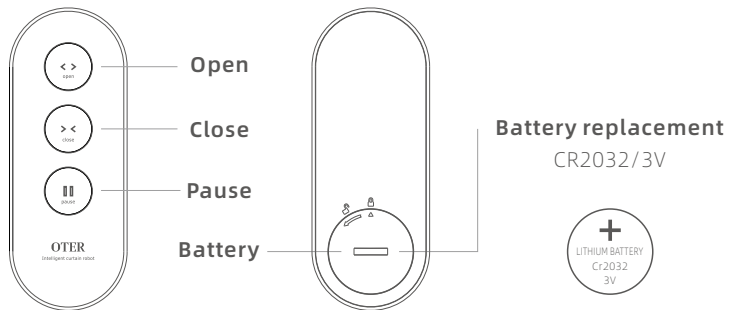

Add Remote

Method 1:

Enter Setting->Remote->Add Remote enter to be paired, Follow the prompts to the next step.

Method 2:

1. Press CurBot power button "  " twice continuously enter to be paired.
- 2.. Press any button on remote until the status light to white.

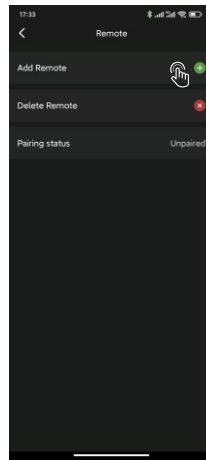
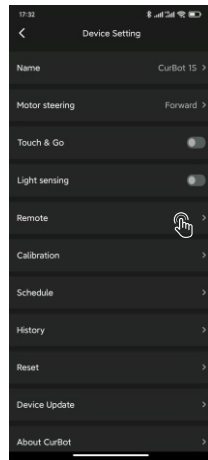

APP Control

1.Download the OTER app.

(The App is regularly updated, and operation is subject to app)



2. Click "LOG IN" and complete registration.

3.Turn on your phone's bluetooth.

4.Add device.

5. Select the curtain open mode.

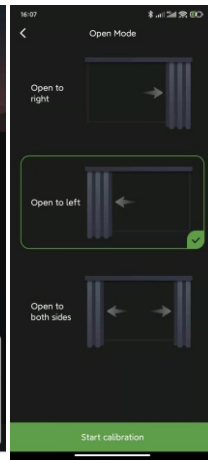
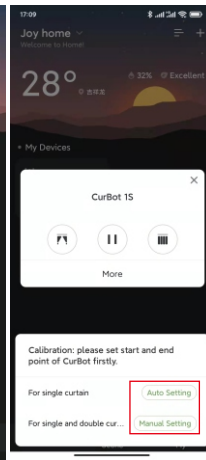
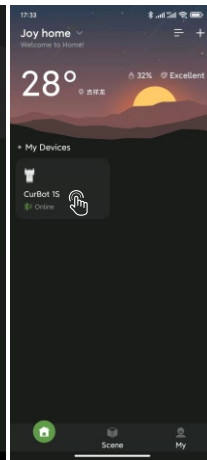
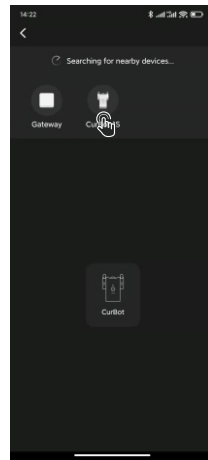
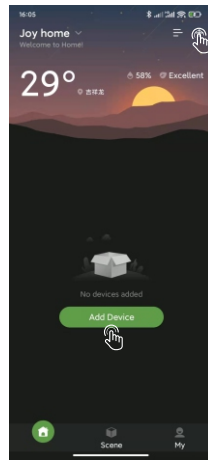
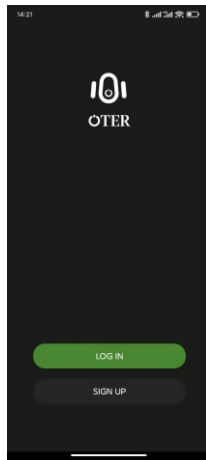

Double Curtains

(Open to both sides)

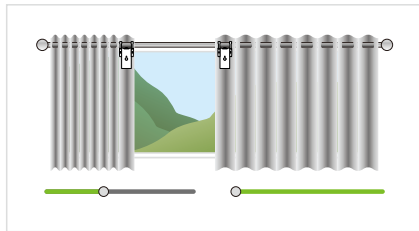

1. Ready 2 CurBot and Hud 1S first.
2. Select "Open to both sides" to start calibration.
3. Add another CurBot to complete binding.
4. Complete calibration.

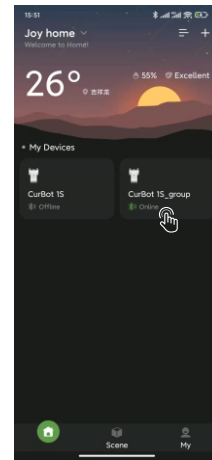
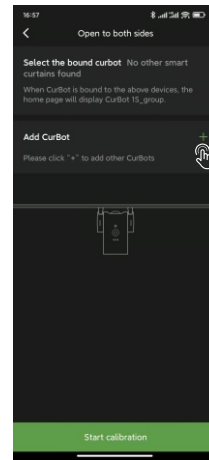
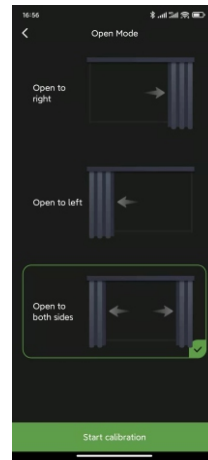

Light Sensing

(Set curtains to open/close automatically under different light levels)

1. Open the OTER app, enter the CurBot settings, and turn on the switch for light sensing.
2. Turn off the switch if it isn't needed.

Note: default is off.

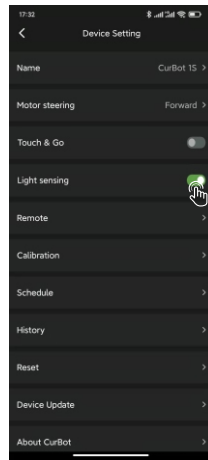

Touch & Go

(Pull curtain by hand, and CurBot will automatically move the curtain to open/close)

Open the OTER app, enter the CurBot settings, and turn on the switch for touch&go.

Note: default is off

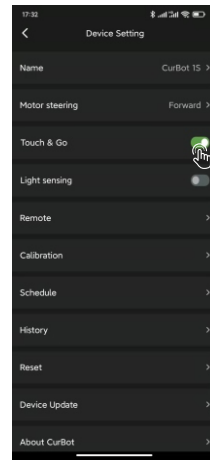

Hub Control

(Connect your CurBot and add functions such as timing, temperature sense, and scene settings)

1. Hub uses Micro-USB cable to power on.
2. Add "Gateway" in OTER app.
3. Add sub-devices, select CurBot.

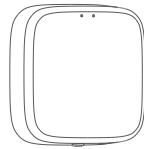

Hub 1S

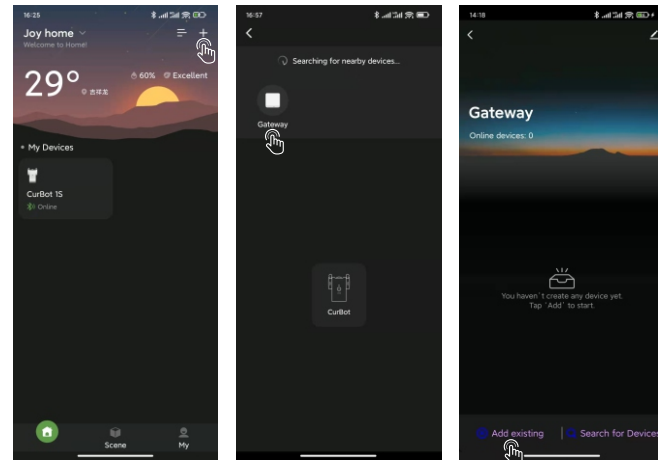

Voice Control

(Control your curtains with Alexa and Google assistant)

1. Make sure Alexa or Google Assistant are connected to the Internet.
2. Use the OTER app to complete connection between the CurBot and Alexa or Google Assistant.



Alexa



Google

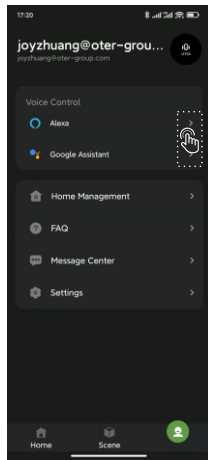

About Update

The version of the device is continuously updated, which can be viewed and updated from Setting.

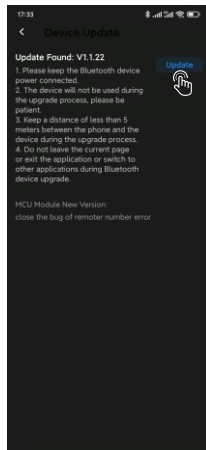
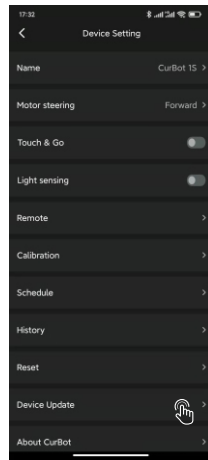

Specifition

Brand	OTER
Model	CurBot 1S
Color	Space Grey / Moon Sliver / Sakura Pink
Size(Main Body)	117*78*48mm
Weight(Main Body)	282g
Power	5200mAh
Connectivity	Bluetooth 5.0
Sensor	light Sensor
Strength	Up to 8KG
Timing Function	Add with Hub 1
Long-range Control	Add with Hub 1
Connectable Platform	Alexa, Google Assistant

WARRANTY

» If the following failures occur, you can enjoy a free return within 7 days after purchase.

- 1.The indicator light fails;
- 2.The button fails (including remote and CurBot)
- 3.The motor control fails (Except for misuse)

» enjoy free maintenance services within 1 year from the purchase date.

NON-WARRANTY

» It has been more than one year from the day after the purchase date.

» Misuse of equipment and accessories.

» Unauthorized repair, misuse, collision, abuse, fluid ingress, accidents, alterations, and improper use of non-product accessories.

SUGGESTION

If you have suggestions for product optimization, please contact us: support@oter-group.com

NOTICE:

1. Make sure circular connectors are buckled, otherwise the CurBot could fall off.
2. Do not place the CurBot near heat sources.
3. Do not spill liquids such as water on the CurBot.
4. If the CurBot fails, contact us at Support@oter-group.com Do not disassemble and maintain it by yourself.



The manual and APP will be continuously updated, please check the APP for the latest version.

FCC Warning statement:

This device complies with part 15 of the FCC Rules. Operation is subject to the following two conditions:

(1) This device may not cause harmful interference, and (2) this device must accept any interference received, including interference that may cause undesired operation.

Changes or modifications not expressly approved by the party responsible for compliance could void the user's authority to operate the equipment.

Note:

This equipment has been tested and found to comply with the limits for a Class B digital device, pursuant to part 15 of the FCC Rules. These limits are designed to provide reasonable protection against harmful interference in a residential installation. This equipment generates, uses and can radiate radio frequency energy and, if not installed and used in accordance with the instructions, may cause harmful interference to radio communications. However, there is no guarantee that interference will not occur in a particular installation. If this equipment does cause harmful interference to radio or television reception, which can be determined by turning the equipment off and on, the user is encouraged to try to correct the interference by one or more of the following measures:

- Reorient or relocate the receiving antenna.
- Increase the separation between the equipment and receiver.
- Connect the equipment into an outlet on a circuit different from that to which the receiver is connected.
- Consult the dealer or an experienced radio/TV technician for help.

FCC RF exposure statement:

The equipment complies with FCC Radiation exposure limit set forth for an uncontrolled environment. The equipment should be installed and operated with a minimum distance of 20cm between the product and your body.

FCC ID: 2A46D-CURBOT03