



Function Description

ON / OFF :

Swing the needle/paddle arm left onto the top of the rotating disk to turn ON. Swing arm right to turn OFF.

Volume :

Turn this knob to adjust the volume.  
Turn left to lower sound, turn right for higher sound

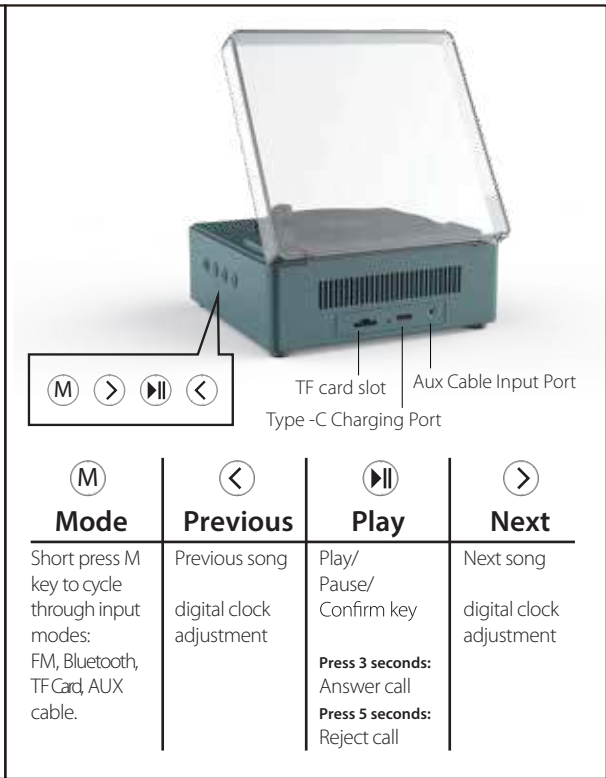

**Bluetooth Pairing**

- After turning on this device, please use **M** (mode) button to change to Bluetooth mode.
- Turn on mobile phone Bluetooth search,
- Click this Bluetooth pairing Name to connect.

**Bluetooth Pairing Name:**  
**SKY&VI RETRO VINYL**

**Alarm / Time Setting/Music adjustment:**  
Hold down the **M** key to enter the clock setting, when the clock number blinks, press **<** to increase the number, press **>** to decrease the number Press **Play/Pause** to confirm

Long press **M** again to set minutes, press **<** to increase the number, press **>** to decrease the number, and press **Play/Pause** to confirm

Time and alarm clock operation :  
1. In the time display mode, press the **Play/Pause** to switch between the time display and the alarm clock display.  
2. In the display time state, long press the **Play/Pause** to enter the time setting, short press **Play/Pause** to switch, hour, minutes, up and down music and hour, minutes adjust. Long press **Play/Pause** to confirm or wait for timeout to confirm automatically, Reset the time when out of power.  
3. In the display time state, Short press **Play/Pause** to display the alarm

clock, Press and hold **Play/Pause** to enter the alarm Settings, Short press **Play/Pause** to switch, hour, minutes and alarm switch Settings, up and down music and hour, minutes adjust. Long press **Play/Pause** to confirm or wait for timeout to confirm automatically. Press any key to turn off the alarm clock.

When playing music, press **<** for Previous song, press **>** for next song

**Safety Guidelines**

Please read this product carefully before use and keep it for future reference.

- Keep away from heat, fire and sun exposure
- Do not insert sharp objects and metal into this product to avoid short circuit
- This product could not be repaired by itself, but should be repaired by professionals or returned to the factory.
- If this product is overheated or damaged and falls into the liquid, please stop using it.
- If customers want to use the power adapter to charge with the product, it should purchase a power adapter that has obtained CCC certification and meets this standard requirements.

**Internal Battery Care**

- Before using, Please charge this product , and it could be used when fully charged.
- Do not charge for too long. Generally, please charge it about 2-3 hours. Do not charge too full, which will affect this cycle times of this battery.
- If this product is not used for a long time, this full load power may be lost generally.
- When charging, please use this standard 5V DC adapter. Using othsr types of adapters might damage or destroy this product.
- This indicator light is red when this audio is charged and blue when is fulfilled.
- Charge and use this product according to this instruction.

**Packaging Accessories**

1x Retro Record Player Wireless Speaker with Clock  
1x TYPE-C charging cable  
1x Manual

**Product Parameters**

Name : Retro Record Player Wireless Speaker with Clock Product  
Model : 2SVSK1991E0G7  
Input : 5V-1A  
Speaker : 5W Battery  
Capacity : 1200mAh  
Bluetooth Distance : 10M  
Input : Bluetooth, AUX, TF Card, TYPE-C

**SUPPORT: 877-543-3540**

©2023 Lifeworks Technology Group LLC. New York, NY 10018. All rights reserved. Manufactured, marketed and distributed by Lifeworks Technology Group LLC. The Bluetooth® word mark and logos are registered trademarks owned by Bluetooth SIG, Inc. and any use of such marks by Lifeworks Technology Group LLC. is under license. All other brands are registered trademarks of their respective companies.  
\* Actual product may differ slightly from images. Made in China

**California Proposition 65 Warning:**  
**WARNING:** Cancer and Reproductive Harm  
- www.P65Warnings.ca.gov

CE, FCC, and other certification logos.

## **FCC STATEMENT :**

This device complies with Part 15 of the FCC Rules. Operation is subject to the following two conditions:

- (1) This device may not cause harmful interference, and
- (2) This device must accept any interference received, including interference that may cause undesired operation.

**Warning:** Changes or modifications not expressly approved by the party responsible for compliance could void the user's authority to operate the equipment.

NOTE: This equipment has been tested and found to comply with the limits for a Class B digital device, pursuant to Part 15 of the FCC Rules. These limits are designed to provide reasonable protection against harmful interference in a residential installation.

This equipment generates uses and can radiate radio frequency energy and, if not installed and used in accordance with the instructions, may cause harmful interference to radio communications. However, there is no guarantee that interference will not occur in a particular installation. If this equipment does cause harmful interference to radio or television reception, which can be determined by turning the equipment off and on, the user is encouraged to try to correct the interference by one or more of the following measures:

- ☐ Reorient or relocate the receiving antenna.
- ☐ Increase the separation between the equipment and receiver.
- ☐ Connect the equipment into an outlet on a circuit different from that to which the receiver is connected.
- ☐ Consult the dealer or an experienced radio/TV technician for help.

## **RF warning statement:**

The device has been evaluated to meet general RF exposure requirement. The device can be used in portable exposure condition without restriction.