

Qortex User Manual

This document covers the details of interacting with a Qortex system at home.

In general, two categories of people can interact with Qortex: users (aka patients) and caregivers. Both groups have many common functionalities such as viewing health records or how to use the remote. Whether you are a caregiver or a user start by reviewing the ‘Common Notes’ section and then continue on with the ‘What you need to know’ section that applies to your role. Qortex is easy to interact with and this guide will get you familiar with its functionality quickly

- Please use the Qortex quick installation guides for details on how to set up Qortex and its remote.

- Keep Qortex turned on:

Qortex works between your TV source (e.g. cable box, dish, etc.) and your TV. If turned off, you will not be able to view this source on your Television.

Important buttons for the Qortex Remote:

- Menu Button: Toggles Qortex menu on and off on your TV screen.

- **Back Button:** Always goes back one menu.
- **UP/Down/Left/Right:** Navigate through the Qortex menu items on the screen.
- **OK:** Selects the current action.
- **Power button:** If programmed, turns the TV off.
- **Volume/Channel Buttons:** If programmed, are used to change TV sound volume and channels accordingly.
- **Remote power Button:** Located at the bottom of the remote. Leave the remote on at all times with the switch on the left. When not in use, leave it in its cradle

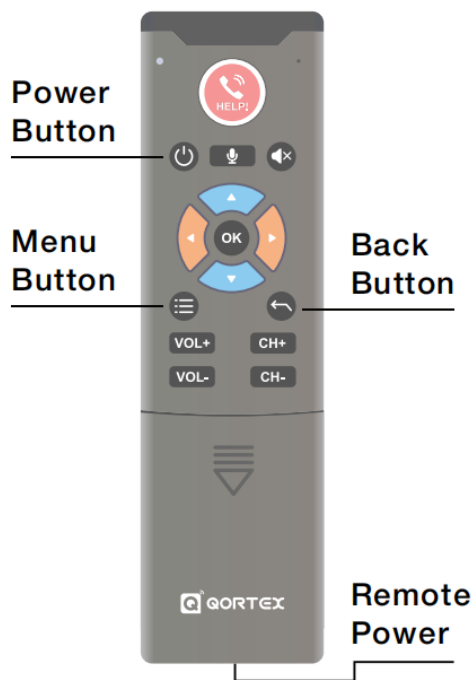

To respond to a call you are receiving, simply press OK. To reject the call, Press the Right arrow and then press OK.

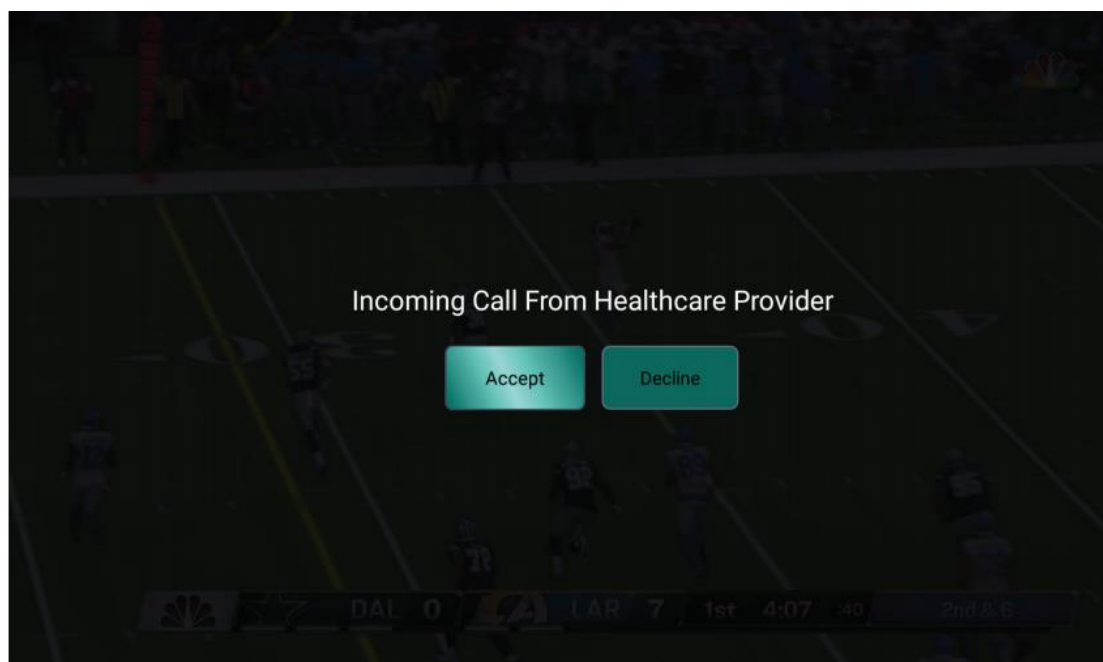

To respond to a reminder, select the desired response (e.g. OK or Cancel) using Left or Right button and then by pressing OK. If you select to cancel or close a reminder, you need to provide an explanation. To do so, turn the remote over and use the keyboard provided in the back by opening its cover

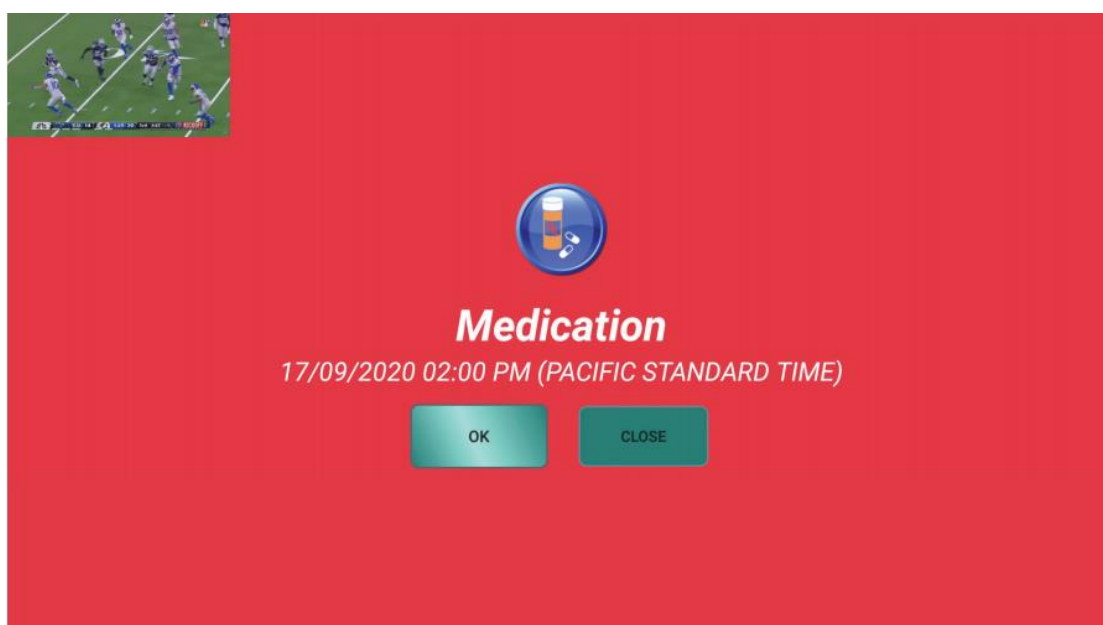

Basic Use:

- Push the Remote's Menu Button.
 - Choose Option you need:
 - › Calendar: Show activities scheduled
 - › Utilities: Check Qortex setup configuration
 - › Health Record: View your health record
 - › Emergency: Same functionality as the remote Help button
- Note:** Caregiver option is for your caregiver and Applications option will be set up by your care provider (if needed).

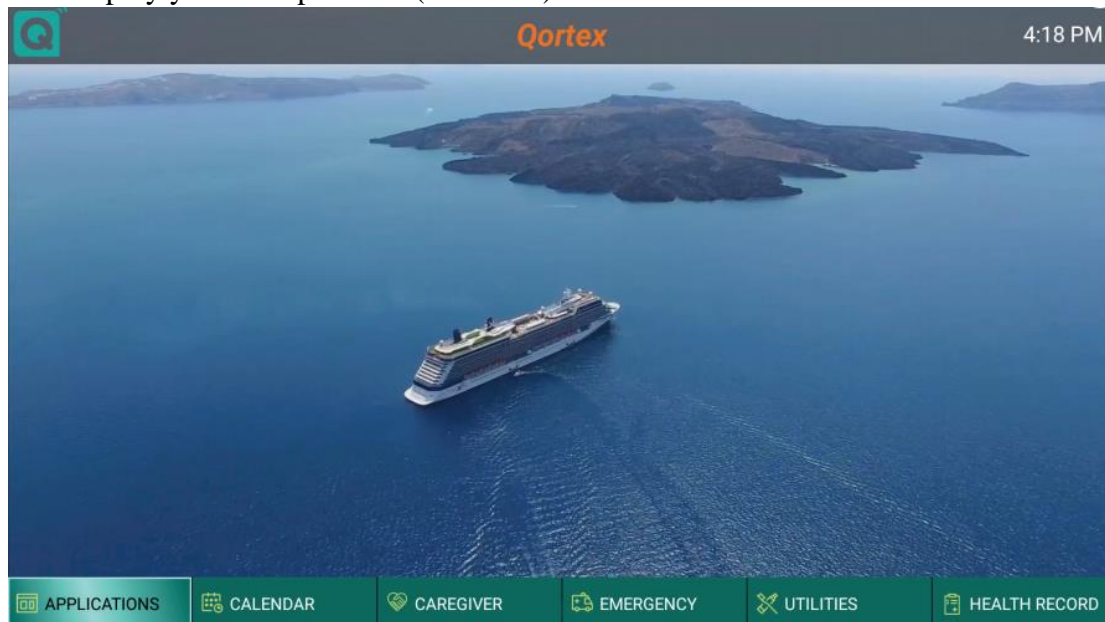

Calendar Page

This menu option shows upcoming events for the user (aka: patient) at home. The events will be caregiver appointments or reminders. Caregiver appointments are set by the

Healthcare Provider.

Today Reminders			
Type	From Time	To Time	Completed
Medication	09/17/2020 02:00 PM	09/17/2020 02:00 PM	No
Note			

Utilities Page

This section is only needed if you have configuration or functionality issues. It displays the options for technical trouble-shooting and set-up for Qortex. Use Up/Down arrows to navigate to the desired option and press OK. Press the Back button when done.

About Qortex

Displays summary of setup status and system information for: USB Camera, Bluetooth, Wifi, Ethernet, Push server, App Version, Firmware Version, Sql version.

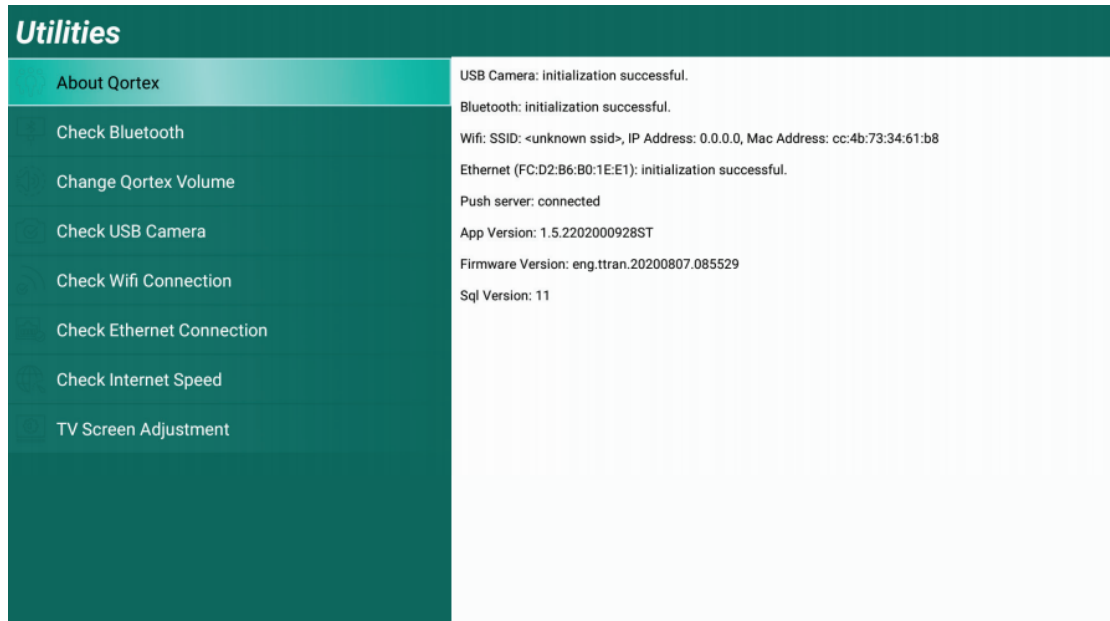

Check Bluetooth

- Default is for this option to be turned off.
- This option may be turned on to allow for other devices to be connected to the Qortex box.
- Future examples of devices include heart rate monitors, blood pressure measurement devices, etc

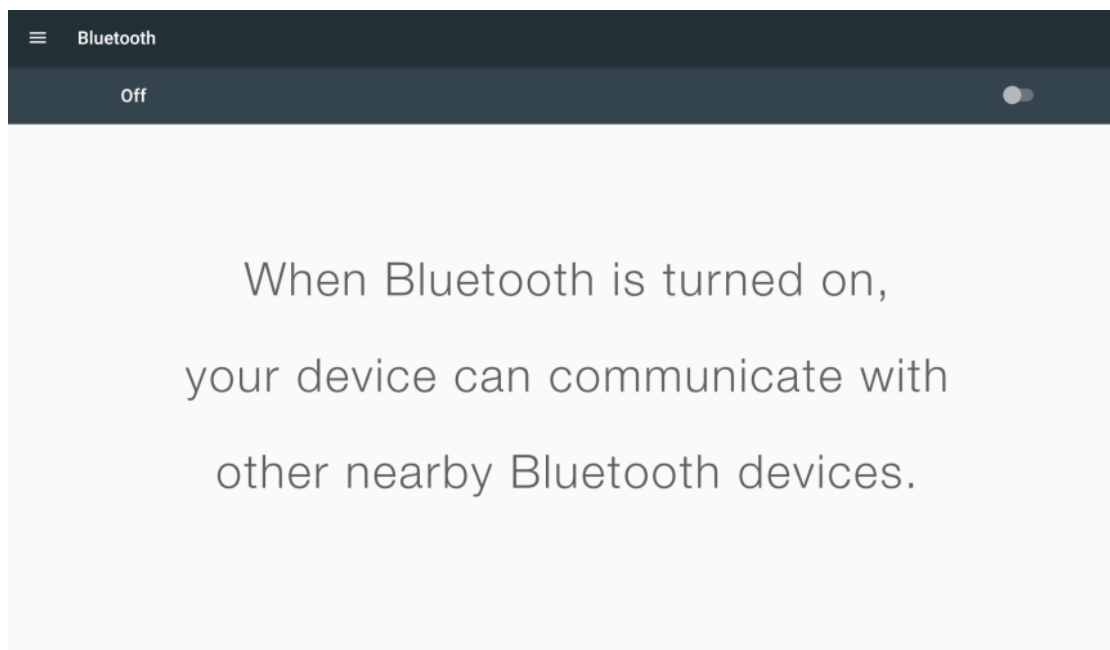

Check USB Camera

- This option will display the web camera image.
- This can be used to check if the web camera is connected and positioned correctly



Check WiFi Connection

By default, Wifi is off and must be enabled. To do so, turn the remote over and use the keyboard and touchpad to toggle Wifi on.

- Once on, a list of available networks is displayed. Click on the desired network and type in the password.
- The local Wifi should show as “Connected” when properly connected.
- If Qortex is still not able to connect to internet, please make sure
 - › Two antennas are properly connected to Qortex.

› Your network firewall is not blocking Qortex from connecting to internet

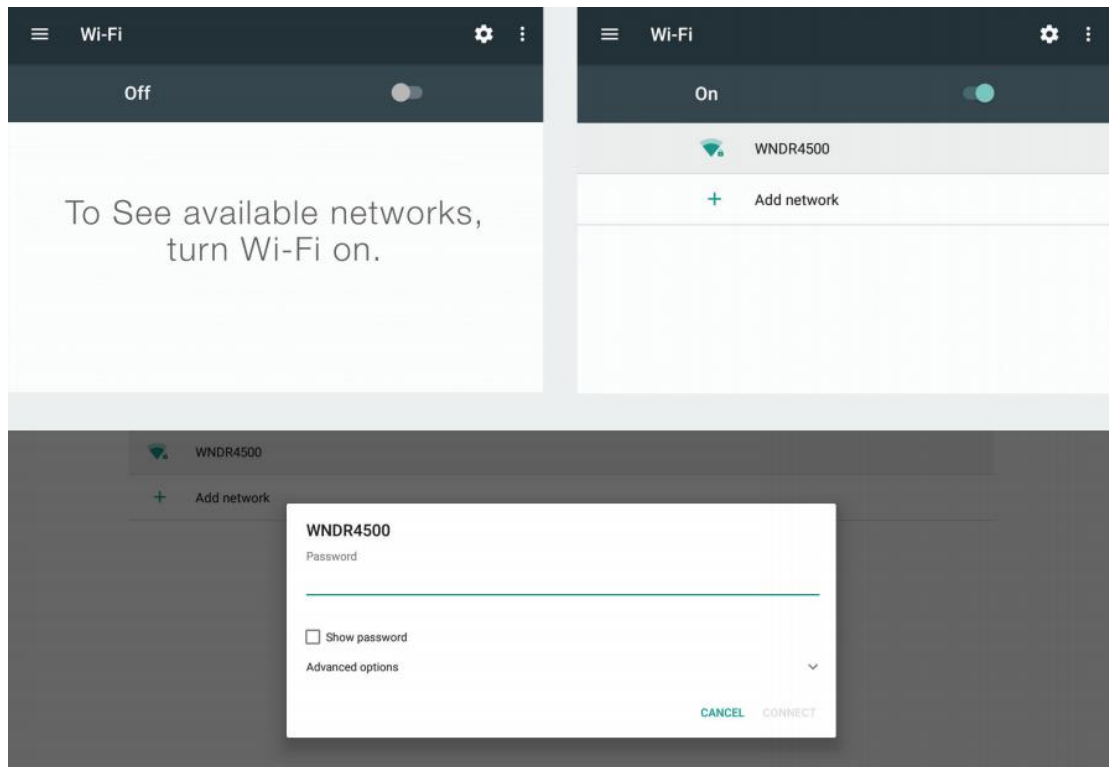

Check Ethernet Connection

- The local Ethernet should show as “Connected” when properly connected using a cable (e.g. CAT 6).
- Either Wifi or Ethernet should be connected, not both.

Ethernet connection by cable is preferred if possible

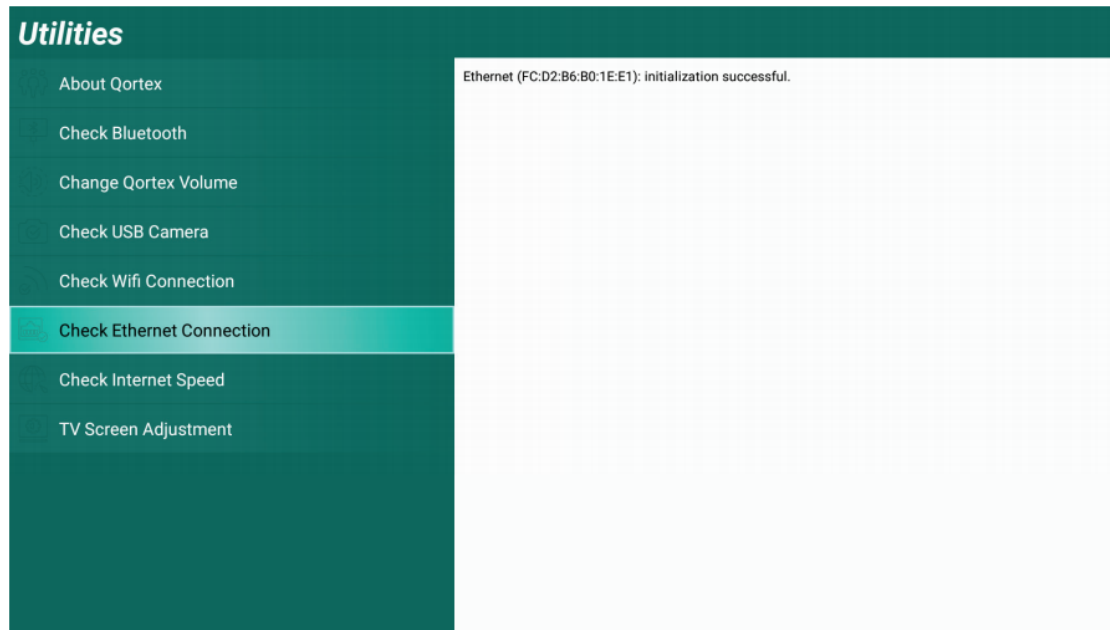

Check Internet Speed

- Performs a test to measure connection speed

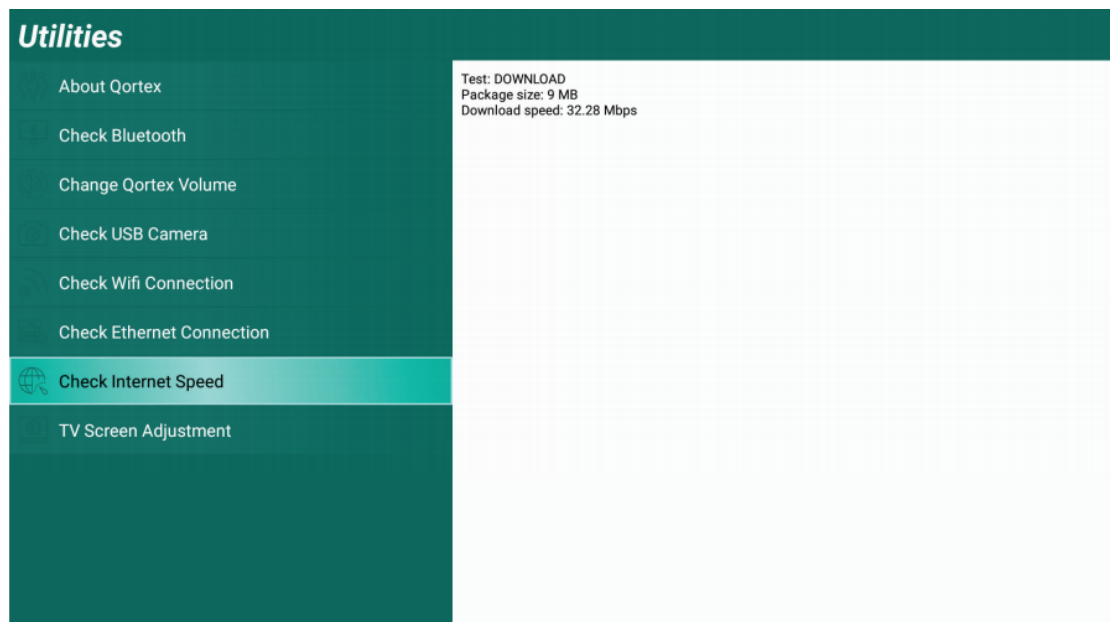

TV Screen Adjustment

- Opens an option to manually adjust the Qortex display on the TV screen.
- › Use the Left/Right buttons to change the width of Qortex screens.

› Use the Up/Down buttons to change the height of Qortex screens.

› **Note:** This option only effects the adjustments to Qortex screens and not your TV broadcast



FCC Statement

Changes or modifications not expressly approved by the party responsible for compliance could void the user's authority to operate the equipment.

This equipment has been tested and found to comply with the limits for a Class B digital device, pursuant to Part 15 of the FCC Rules. These limits are designed to provide reasonable protection against harmful interference in a residential installation. This equipment generates uses and can radiate radio frequency energy and, if not installed and used in accordance with the instructions, may cause harmful interference to radio communications. However, there is no guarantee that interference will not occur in a particular installation. If this equipment does cause harmful interference to radio or television reception, which can be determined by turning the equipment off and on, the user is encouraged to try to correct the interference by one or more of the following measures:

- Reorient or relocate the receiving antenna.
- Increase the separation between the equipment and receiver.
- Connect the equipment into an outlet on a circuit different from that to which the receiver is connected.
- Consult the dealer or an experienced radio/TV technician for help

This device complies with part 15 of the FCC rules. Operation is subject to the following two conditions (1) this device may not cause harmful interference, and (2) this device must accept any interference received, including interference that may cause undesired operation.

This equipment complies with FCC radiation exposure limits set forth for an uncontrolled environment. This equipment should be installed and operated with minimum distance 20cm between the radiator & your body.