

Wireless Mouse



MODEL:M8W

xtrfy

Function layout

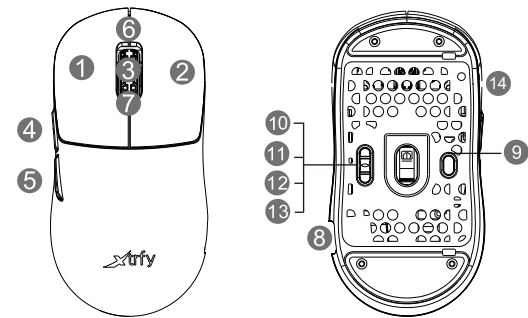

- 1 Left click
- 2 Right click
- 3 Middle click
- 4 Forward
- 5 Backward
- 6 Scroll up
- 7 Scroll down
- 8 Type-c connection
- 9 Setting
- 10 Power Off
- 11 DPI Mode
- 12 Polling rate
- 13 Debounce time
- 14 Led indicator

Instruction

Mouse instruction:

- Take out the wireless USB Nano receiver from package
- Plug the receiver into your computer USB port
- Turn on the mouse power by switching the power switch on the bottom of the mouse
- Waiting for computer installation finished

DPI setting and indication:

- DPI level: 400-800-1200-1600-3200-4000-7200-26000, total 8 levels DPI
- By pressing the setting button on the top of mouse when the mode switch is in DPI mode to change DPI circularly

Polling rate:

125(red)-500(blue)-1000Hz(green)

Mode switch and setting function:

- Setting button is DPI change function when the mode is in DPI mode
- Setting button is polling rate function when the mode is in polling rate mode
- Setting button is debounce function when the mode is in Debounce mode
- Power off the mouse when the mode switch is in Power off mode

Wired and wireless function:

- Wired and wireless mode switch automatically, when you plug the receiver into computer without cable connection, it will work as wireless mode.
- If you connect the cable from computer to the mouse, it will switch to wired mode automatically and work as wired mode.

Low power and charging indication

- Low power indication: when mouse battery power is low, the Red color will blink, you need charge the mouse
- During charging the yellow color led turn on, after the battery charging full, the LED color will back to previous effect.

Pairing

Use pairing tool to pair the mouse and receiver if lost connection or change to new receiver

Main Specification

Size:	118x60.5x38.5mm
Weight:	Around 55g
Switch:	Kailh GM8.0
Sensor:	PAW3395
Max DPI:	26000
Default DPI:	400-800-1200-1600-3200-4000-7200-26000DPI
IPS:	400ips
Acceleration:	50g(Max)
Polling rate:	125-500-1000Hz
Interface:	USB 2.0
Battery type:	Li-ion Polymer Battery
Rating:	5V \pm 400mA
Battery:	3.7V/300mA

CAUTION

- Keep the battery dry.
- Avoid locating the battery terminals near metallic object.
- Do not short-circuit and avoid metallic or water come into mouse to cause battery short
- Use computer USB and specified cable to charge the mouse
- There is a risk of explosion if the battery is replaced with the wrong model. Please Dispose of used batteries according to the instructions

IC Caution

This device contains licence-exempt transmitter(s)/receiver(s) that comply with Innovation, Science and Economic Development/Canada's licence-exempt RSS(s). Operation is subject to the following two conditions:

- This device may not cause interference.
- This device must accept any interference, including interference that may cause undesired operation of the device.

(3) The device has been evaluated to meet general RF exposure requirement. The device

(4) can be used in portable exposure condition without restriction.

Cet appareil contient des émetteurs/récepteurs exempts de licence qui sont conformes aux flux RSS exempts de licence de Innovation, Science et développement économique Canada.

L'exploitation est soumise aux deux conditions suivantes:

- cet appareil ne doit pas causer d'interférences.
- ce dispositif doit accepter toute interférence, y compris toute interférence susceptible de provoquer un fonctionnement indésirable du dispositif.
- l'appareil a été évalué pour répondre aux exigences générales d'exposition aux RF. Le dispositif
- peut être utilisé dans des conditions portatives d'exposition sans restriction.

FCC Statement

Changes or modifications not expressly approved by the party responsible for compliance could void the user's authority to operate the equipment.

This equipment has been tested and found to comply with the limits for a Class B digital device, pursuant to Part 15 of the FCC Rules. These limits are designed to provide reasonable protection against harmful interference in a residential installation. This equipment generates uses and can radiate radio frequency energy and, if not installed and used in accordance with the instructions, may cause harmful interference to radio communications. However, there is no guarantee that interference will not occur in a particular installation. If this equipment does cause harmful interference to radio or television reception, which can be determined by turning the equipment off and on, the user is encouraged to try to correct the interference by one or more of the following measures:

- Reorient or relocate the receiving antenna.
- Increase the separation between the equipment and receiver.
- Connect the equipment into an outlet on a circuit different from that to which the receiver is connected.
- Consult the dealer or an experienced radio/TV technician for help.

This device complies with part 15 of the FCC rules. Operation is subject to the following two conditions: (1) this device may not cause harmful interference, and (2) this device must accept any interference received, including interference that may cause undesired operation.

This equipment complies with FCC radiation exposure limits set forth for an uncontrolled environment.