

Instruction for users

Turn the watch & the sensor ON before wearing them. It will help with wearing them correctly.

How to Wear the Sensor

1 Soulder Exercises

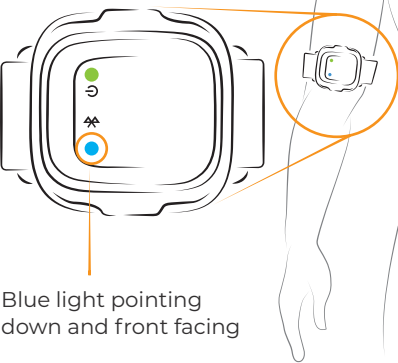

2 Device at Knee

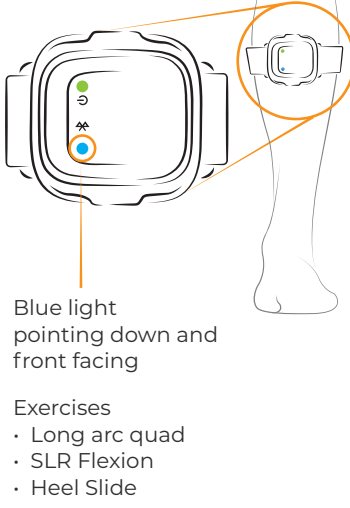

3 Device at Thigh

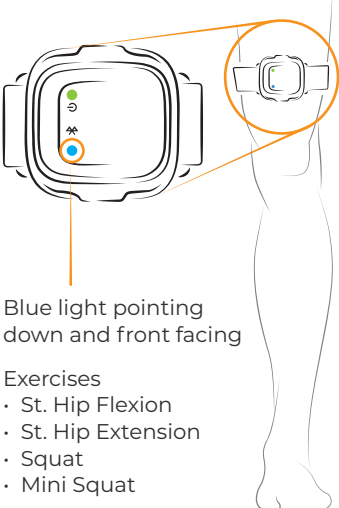

Do Calibration

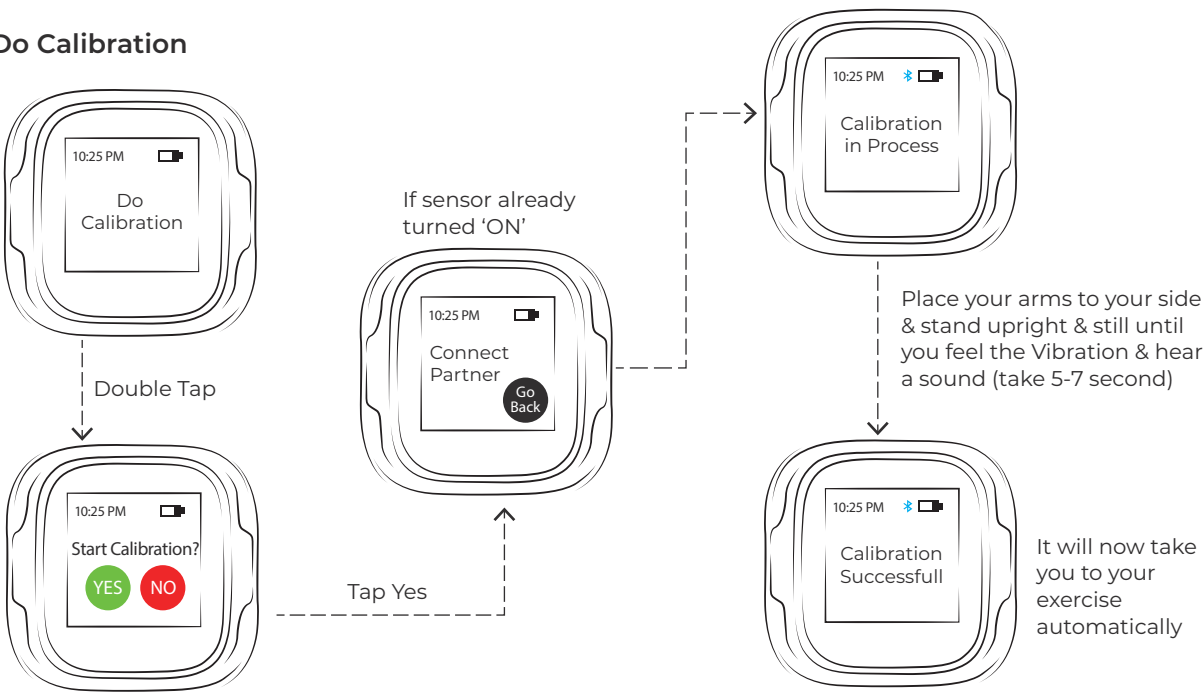

Start Exercise

Double tap on any exercise to start

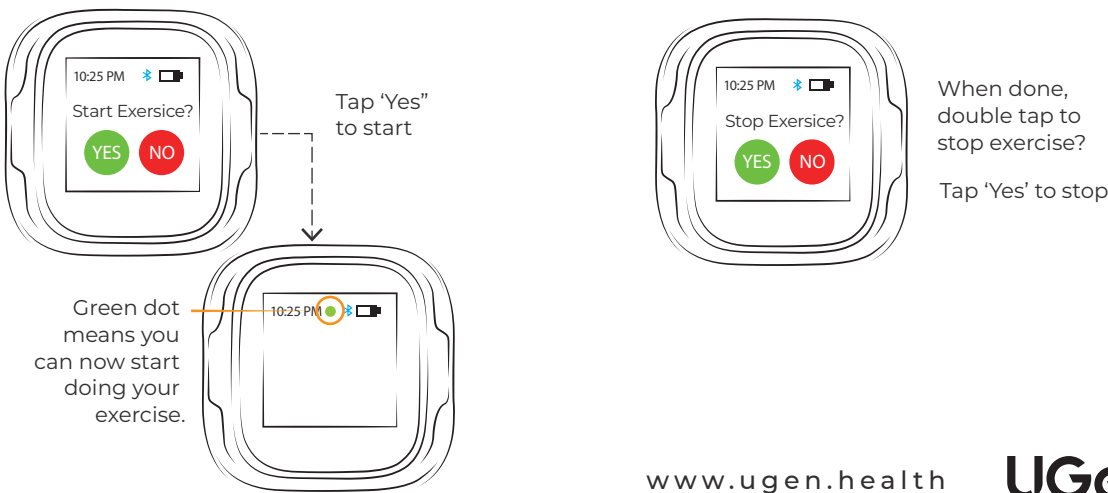



You & I Work Together



Movement
Tracking



Real Time
Feedback



Touchscreen



Bluetooth



Water & Dust
Resistant

Caution Statements

- Any changes or modifications not expressly approved by the party responsible for compliance could void the user's authority to operate this equipment.
- Do not puncture or harm the exterior surface of the product in any way.

Information to the User

This equipment has been tested and found to comply with the limits for a Class B digital device, pursuant to part 15 of the FCC Rules. These limits are designed to provide reasonable protection against harmful interference in a residential installation. This equipment generates, uses and can radiate radio frequency energy and, if not installed and used in accordance with the instructions, may cause harmful interference to radio communications. However, there is no guarantee that interference will not occur in a particular installation. If this equipment does cause harmful interference to radio or television reception, which can be determined by turning the equipment off and on, the user is encouraged to try to correct the interference by one or more of the following measures:

- Reorient or relocate the receiving antenna.
- Increase the separation between the equipment and receiver.
- Connect the equipment into an outlet on a circuit different from that to which the receiver is connected.
- Consult the dealer or an experienced radio/TV technician for help.

Disclaimer

This product is an electronic monitoring product and is not intended as a medical reference. We reserve the right to modify or to improve any of the functions described in this manual without any prior notice. At the same time, we hold the right to continuously update the product content.

Compliance Statement

This device complies with part 15 of the FCC Rules. Operation is subject to the following two conditions:
(1) This device may not cause harmful interference, and
(2) This device must accept any interference received, including interference that may cause undesired operation

Cet appareil est conforme à la partie 15 des règles de la FCC. Le fonctionnement est soumis aux deux conditions suivantes :
(1) Cet appareil ne doit pas causer d'interférences nuisibles, et
(2) Cet appareil doit accepter toute interférence reçue, y compris les interférences pouvant provoquer un fonctionnement indésirable.

Technical Description

The main purpose of the document to provide design information for the Hardware of UGen wearable device. The UGen wearable device will be used for monitor and tracking the body movements for prescribed exercise.

The UGen wearable device has an IMU, which will detect motion of device along with movements. This movements will be checked using the software algorithm. Movements of devices is measured and compared using algorithm and if it's not correct it will give user an indication using Vibrations/ buzzer. Device will be used to store some specified movement used in Exercise. Device will send information to BLE server for tracking/monitoring the data.

Watch

The Watch device contains LCD Touch display in it. By using Watch device only, we can start the exercise or calibration with Sensor. To start the Watch device, first we must press and hold the user button until the user does not feel the vibration of the device. The device has vibration motor in its architecture for better prospect of application. The device will start, and it has been indicated by one beep sound and display will indicate the welcome message and its particular MAC ID on which the device will work. To do the Hard reset of the device, user need to press and hold the user button for 14 to 15 seconds.

Back view master

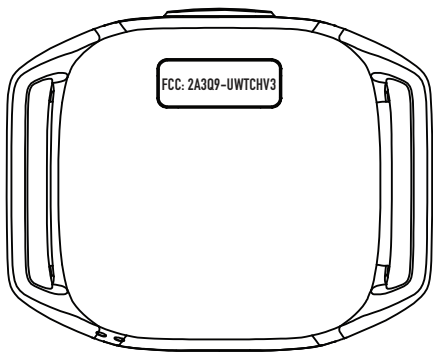

Back view slave

