

**Document:**  
**AWC 66T0 – User Manual**

**Date: 21-Sept-2021**

**Device Details:**

Device Name	:	Automotive Wireless Charger
Type No. / Model No.	:	66T0

- **Wireless Charging of the mobile phone:**

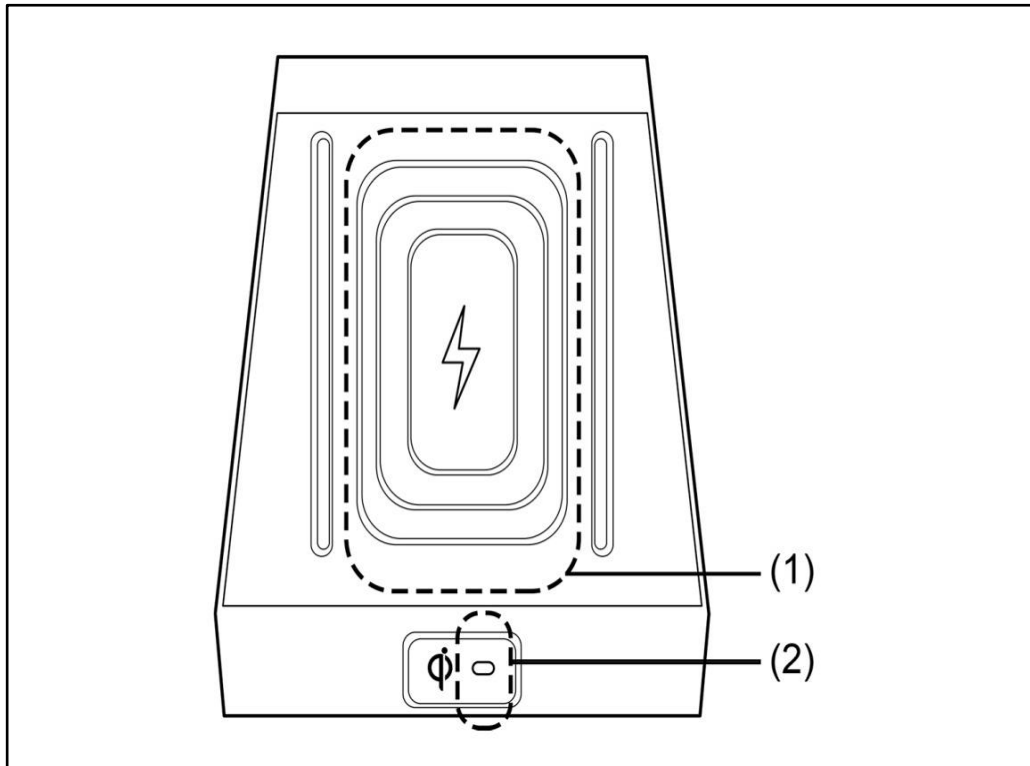

- 1) Wireless Charging Pad
- 2) Wireless Charging Status Indicator LED
- 3) **Charging Unit :**

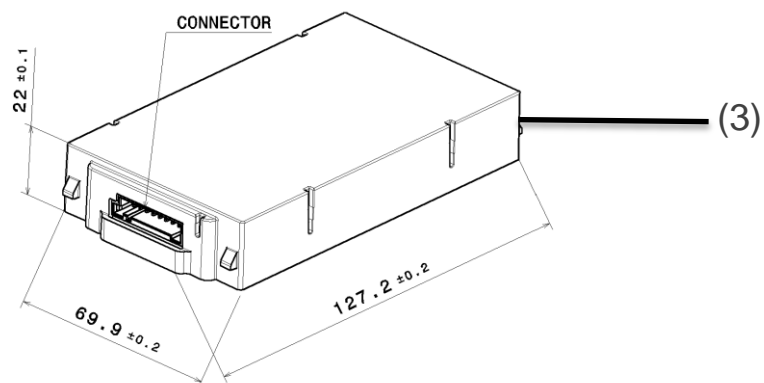

- **Information:**

The wireless charger charges only the Qi-compliant mobile phones. Read the mobile phone user manual or visit your mobile phone manufacturer's website to check whether your mobile phone is Qi-compliant and support Qi Wireless Charging.

<b>1. <u>Electrical / General Characteristics</u></b>		
OPERATING GUARANTEED VOLTAGE RANGE		7V to 16V
NOMINAL VOLTAGE		12 VDC
OUTPUT POWER (AT RECEIVER DEVICE)		15W @ 12V
+B CURRENT	STANDBY CURRENT	~50mA (PING NOT INCLUDED)
	TYPICAL CURRENT (@12V)	2.1A
	MAX CURRENT CONSUMPTION (@9V)	3.0A
	DARK CURRENT	LESS THAN 1mA
	INRUSH CURRENT	4.5A
OPERATING FREQUENCY		127±2 KHz
EFFICIENCY		MIN 70%
ACC CURRENT		100mA(MAX)

## **2. TEMPERATURE CHARACTERISTIC**

RANGE OF STORAGE TEMPERATURE	-40~+85(C)
RANGE OF OPERATING TEMPERATURE	-40~+80(C)

## **3. GENERAL CHARACTERISTIC**

INGRESS PROTECTION (FROM TOP SIDE)	IP 65
WEIGHT (gm)	300±10
COMPATIBLE DEVICES	Qi COMPLIANT RECEIVER

- **Application: Charging Mobile phone:**

1. To Start Wireless charging, clear all objects from the wireless charging pad including Key FOB.
2. Objects including Key FOB may interrupt the wireless charging if placed along with the mobile phone on wireless charging pad.
3. Place the mobile phone with wireless charging feature on the Wireless Charging Pad. Close all the doors and turn ACC ON.
4. Align the mobile phone to the centre of wireless charging pad if wireless charging is not initiated after mobile phone placement.
5. Wireless charging can be enable/disable from Infotainment system.
6. Charging status will be shown on Wireless Charging Status Indicator LED & Infotainment System.

- **Wireless Charging Status Indicator:**

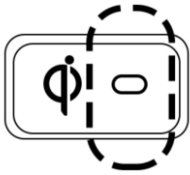
Wireless Charging Status Indicator LED			Status
	Pattern	Color	
	No Light	-	No Charging. (Vehicle Key OFF / Door open / Key FOB operation)
	Light Up	Amber	Ready for charging
	Light Up	Blue	Charging in progress
	Light Up	Green*	Charging completed
	Light Up	Red	Wireless Charging malfunction
	Blinks (20 blink 10 sec OFF)	Red	Metal object present in charging tray / Mobile phone placement not aligned to center / Mobile phone over heated / Non-Qi standard mobile phone / Charging error

\*Applicable only for mobile phones publishing Charging Complete Status

### Mobile Left Out Alert:

1. At the end of the drive, while leaving the vehicle, Wireless Charger will detect the presence of mobile phone.
2. Mobile left out alert will be published on Instrument Cluster as soon as driver door is open.

## AWC Installation in the vehicle:

AWC is located in the centre console of the vehicle, the AWC is located in such way that the compatible device (phone) can be placed and removed easily from the end user. The charging face (coil face) of the AWC is facing the A pad area where the phone is placed in coin Box

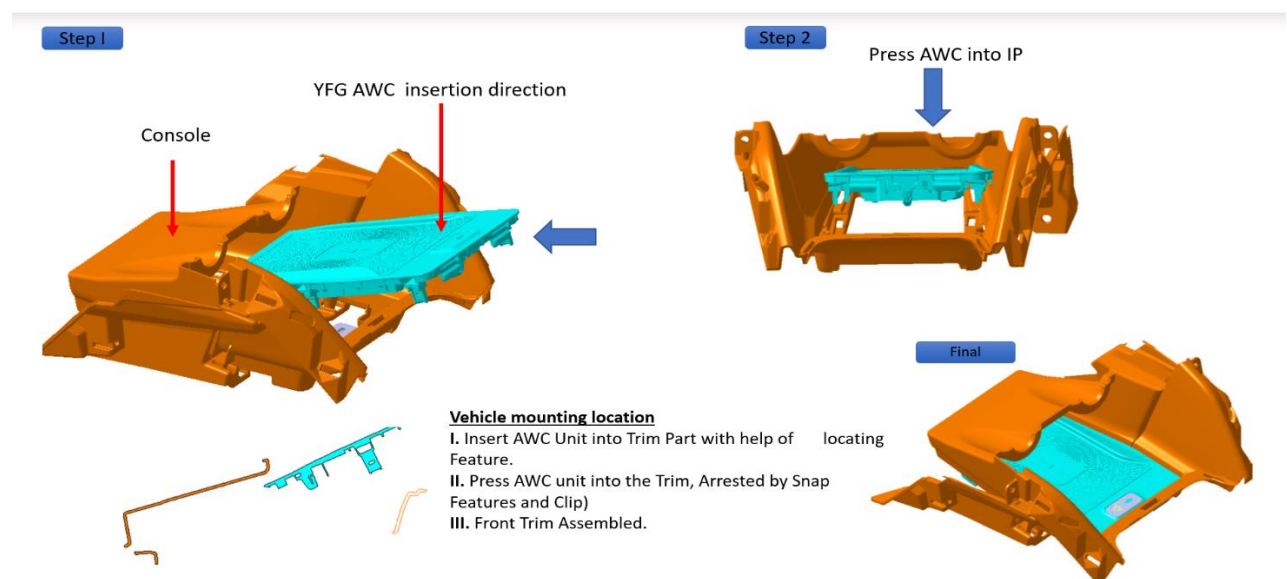
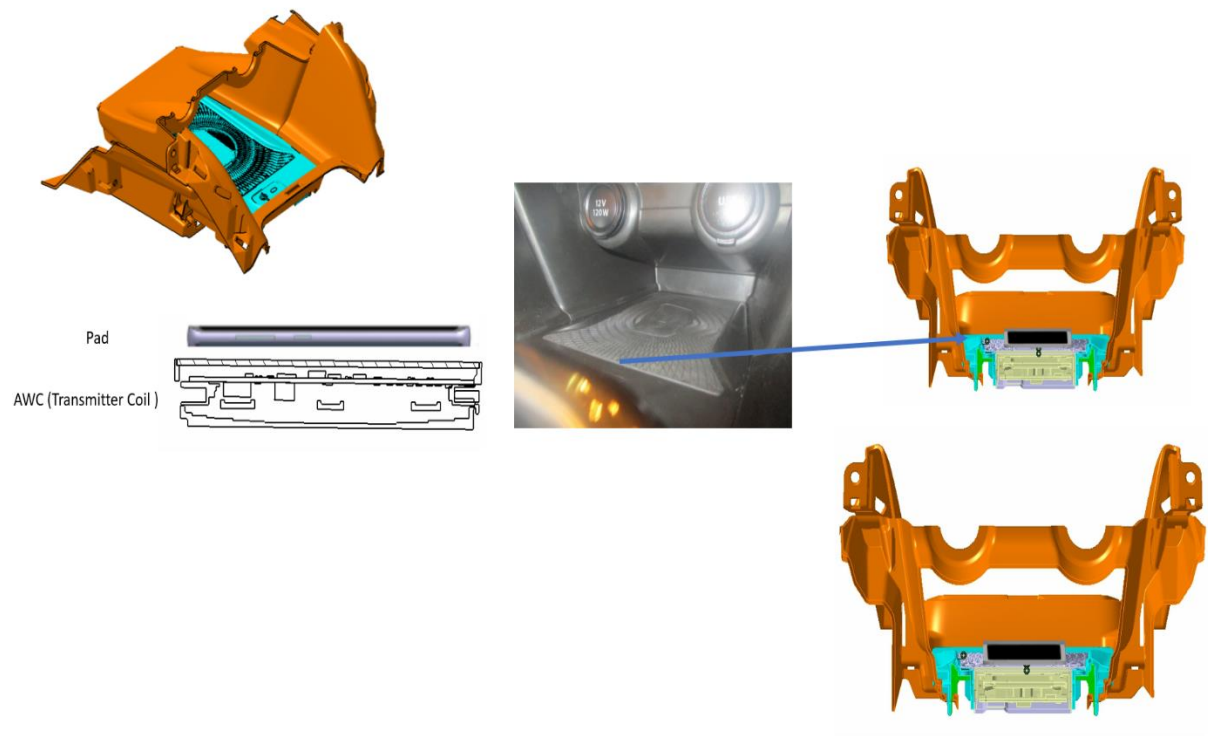

- **Warning Statements :**

1. Place the mobile phone always at the center of the charging pad for best charging experience. If the mobile phone is not aligned to the centre, slow charging may be experienced and for few mobile phones will experience higher heating during charging.
2. Charging will be interrupted (Indicator LED blinking with RED color) if the mobile phone orientation/alignment is not correct or if any foreign metal object or KEY FOB is present & detected on the wireless charging pad. Indicator LED continues to blink with RED Color till the phone is not re-placed/re-aligned or metal object/KEY FOB is not removed from the wireless charging pad.
3. Presence of metal objects on charging pad during charging may result in heating/safety issue.
4. Wireless charging may be interrupted due to abnormal temperature level in the mobile phone. Remove the mobile phone from the wireless charging pad and wait till the mobile phone temperature reaches to suitable level for wireless charging.
5. Do not place Credit Cards, Debit Cards, Access Cards, Data Storage cards, or other objects sensitive to Electromagnetic fields on the wireless charging pad. They may get damaged by electromagnetic fields of wireless charger.
6. If liquids enter the wireless charging pad, the charging pad may be damaged.

- **Compliance Statements:**

**FCC §15.19 Labelling Requirement:**

This device complies with Part 15 of the FCC Rules. Operation is subject to the following two conditions: (1) this device may not cause harmful interference, and (2) this device must accept any interference received, including interference that may cause undesired operation.

**FCC §15.21 Information to user:**

Changes or modifications not expressly approved by the party responsible for compliance could void the user's authority to operate the equipment.

**FCC §15.105(b) Warning Statement :**

NOTE: This equipment has been tested and found to comply with the limits for a Class B digital device, pursuant to part 15 of the FCC Rules. These limits are designed to provide reasonable protection against harmful interference in a residential installation. generates, uses and can radiate radio frequency energy and, if not installed and used in accordance with the instructions, may cause harmful interference to radio communications. However, there is no guarantee that interference will not occur in a particular installation. If this equipment equipment does cause harmful interference to radio reception, which can be determined by turning the equipment off and on, the user is encouraged to try to correct the interference by the following measures:

-Consult the dealer or an experienced technician for help.

- **RF Warning Statement:**

This equipment complies with FCC radiation exposure limits set forth for an uncontrolled environment. This equipment should be installed and operated with minimum distance 20cm between the radiator & your body.